

MCCLURE CONTROL POINTS:
 C.P. #97: N 1742666.7450 E 2207824.8346 ELEV - 572.73

QU002

NOTE: FILL EXISTING POST HOLES IN PAVED AREAS WITH COMPACTED CA-6 TO WITHIN 6" OF EXISTING SURFACE. FILL REMAINDER WITH 3500 PSI CONCRETE OR BIT. SURFACE COURSE. (INCIDENTAL TO CLASS E FENCE - 10')

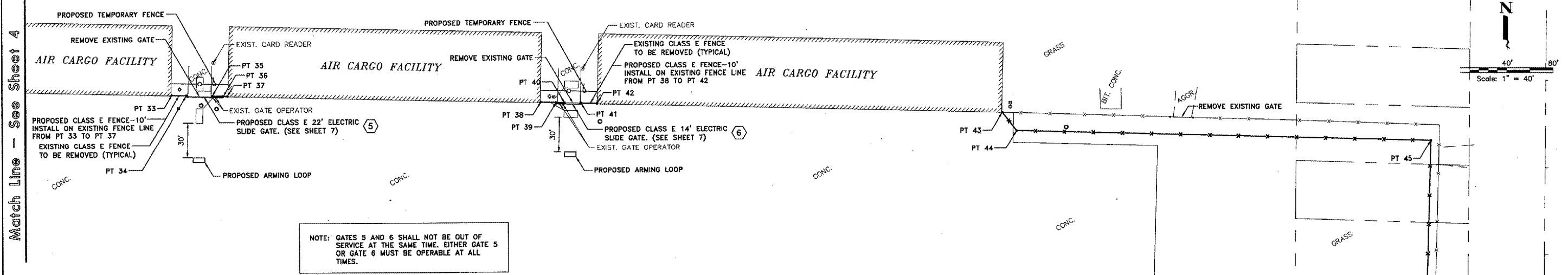
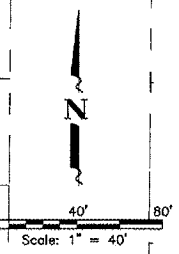

NOTE: GATES 5 AND 6 SHALL NOT BE OUT OF SERVICE AT THE SAME TIME. EITHER GATE 5 OR GATE 6 MUST BE OPERABLE AT ALL TIMES.

FROM POINT #	TO POINT #	LENGTH OF FENCE
PT 33	PT 34	13.01
PT 34	PT 35	22' GATE
PT 35	PT 36	9.67
PT 36	PT 37	3.55

POINT #	NORTHING	EASTING
PT 33	1743013.6330	2206978.6656
PT 34	1743013.3422	2206991.6758
PT 35	1743012.8433	2207014.0002
PT 36	1743012.6273	2207023.6678
PT 37	1743012.5479	2207027.2218

FROM POINT #	TO POINT #	LENGTH OF FENCE
PT 38	PT 39	13.43
PT 39	PT 40	7.17
PT 40	PT 41	14' GATE
PT 41	PT 42	13.94

POINT #	NORTHING	EASTING
PT 38	1743008.1421	2207298.6330
PT 39	1743005.8044	2207312.0612
PT 40	1743005.6241	2207319.2290
PT 41	1743005.2637	2207333.5544
PT 42	1743004.9132	2207347.4897

FROM POINT #	TO POINT #	LENGTH OF FENCE
PT 43	PT 44	20.00
PT 44	PT 45	359.76
PT 45	PT 46	498.12
PT 46	PT 47	10.00

POINT #	NORTHING	EASTING
PT 43	1742995.6834	2207698.3464
PT 44	1742980.0419	2207710.8101
PT 45	1742971.6146	2208070.4683
PT 46	1742473.6651	2208057.4673
PT 47	1742466.4119	2208064.3514

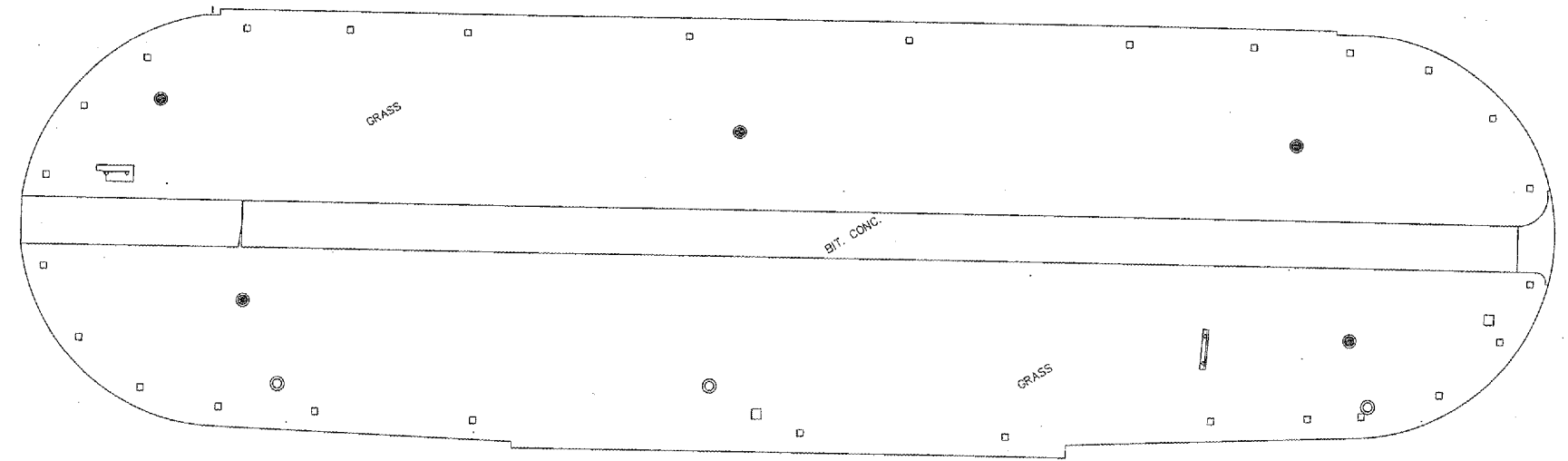

C.P. #97

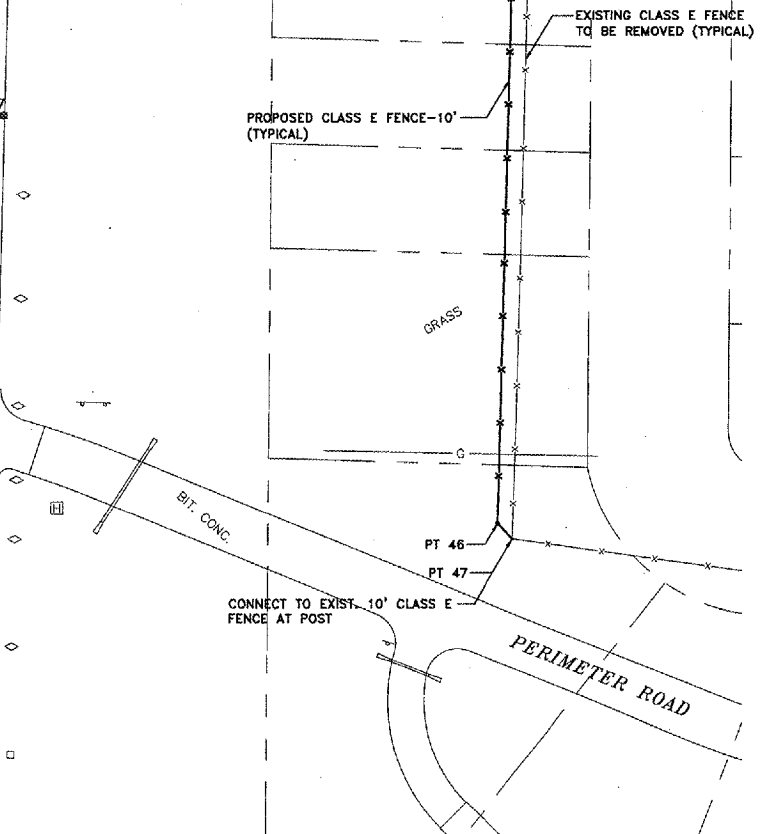

IL. PROJ: MLI - 3638 AIP PROJ: 3-17-0068-58

QUAD CITY INTERNATIONAL AIRPORT Moline, IL 	REVISIONS <table border="1" style="width: 100%; border-collapse: collapse;"> <thead> <tr> <th>NO.</th> <th>ITEM</th> <th>DATE</th> </tr> </thead> <tbody> <tr> <td> </td> <td> </td> <td> </td> </tr> </tbody> </table>	NO.	ITEM	DATE				PLOTTING SCALE: 1" = 40' DRAWN BY: SPM CHECKED BY: DATE: SEPTEMBER 2006	McCLURE ENGINEERING ASSOCIATES, INC. <small>4700 Kennedy Drive (309) 782-9350 East Moline, Illinois 61244 Fax (309) 782-8874 Design Firm License: Illinois #184-000618 Copyright 2006 by McClure Engineering Associates, Inc.</small>	GENERAL CONSTRUCTION PLAN QUAD CITY INTERNATIONAL AIRPORT SECURITY FENCE - PHASE IV FILE NAME: X:\M0106.008\DWG\06008M04.DWG(C21) Moline, Illinois JOB NUMBER: 01-29-06-191	SHEET NO. 5 OF 7
	NO.	ITEM	DATE								
QUAD CITY INTERNATIONAL AIRPORT SECURITY FENCE - PHASE IV											