

F.A.I. RTE.	SECTION	COUNTY	TOTAL SHEETS	SHEET NO.
55,80	99-1(K, BY & AC-B)	WILL	497	298
FED. ROAD DIST. NO.	ILLINOIS	FED. AID PROJECT	CONTRACT NO. 80906	

VOLUME 2 OF 2

FOR INDEX OF SHEETS, SEE SHEET NO. 2

DESIGN DESIGNATION

RAMPS=550 (10) CONNECTOR AND LOOP RAMPS (RIGID-20)

TRAFFIC DATA

1987 ADT = 24,700	(F.A.I. 80)
29,900	(F.A.I. 55)
2010 ADT = 36,000	(F.A.I. 80)
40,000	(F.A.I. 55)

IMPROVEMENT LOCATED IN THE TOWNSHIP OF TROY

J.U.L.I.E.
JOINT UTILITY LOCATION INFORMATION FOR EXCAVATION
1-800-892-0123
BP PIPELINES (NORTH AMERICA) INC.
1-800-548-6482

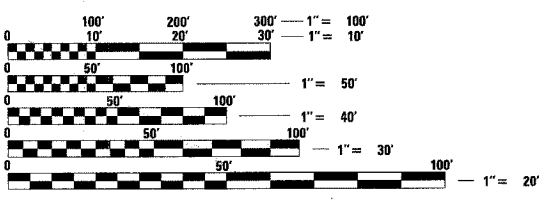

FULL SIZE PLANS HAVE BEEN PREPARED USING STANDARD ENGINEERING SCALES, REDUCED SIZED PLANS WILL NOT CONFORM TO STANDARD SCALES, IN MAKING MEASUREMENTS ON REDUCED PLANS, THE ABOVE SCALES MAY BE USED.

CONTRACT NO. 80906

STATE OF ILLINOIS
DEPARTMENT OF TRANSPORTATION
DIVISION OF HIGHWAYS
PLANS FOR PROPOSED HIGHWAY

SCALES PLAN 1:50
PROFILE HORIZ. 1:50
PROFILE VERT. 1:5
CROSS SECTIONS 1:10 HORIZONTAL, 1:5 VERTICAL

F.A.I. ROUTE 80 AT F.A.I. ROUTE 55
SECTION 99-1 (K, BY & AC-B)
INTERCHANGE RECONSTRUCTION
& FRONTAGE ROAD BRIDGE CONSTRUCTION
WILL COUNTY
C-91-425-90
PROJECT

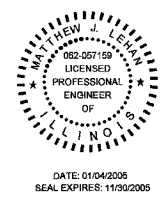
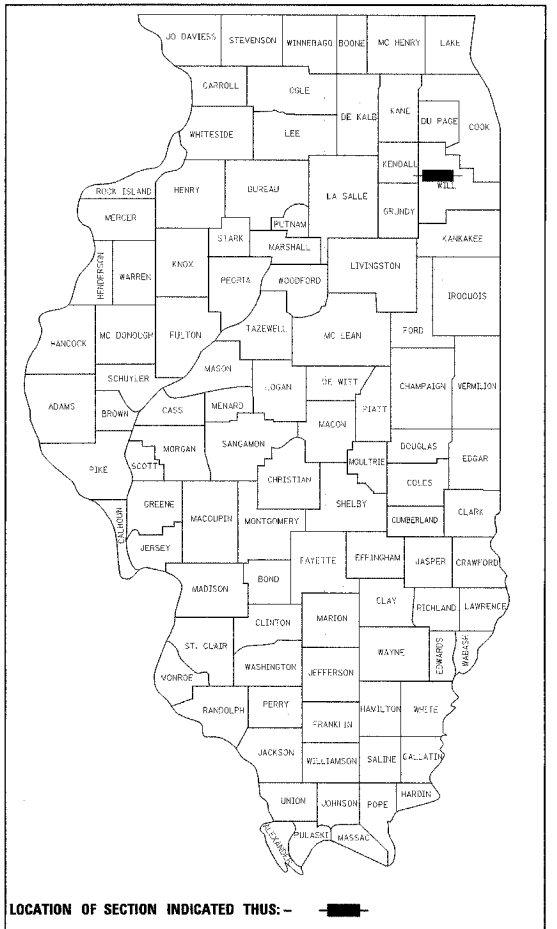

SIGNATURE & SEAL APPLY TO SHEETS
1 - 182
193 - 202
298 - 299
321 - 497

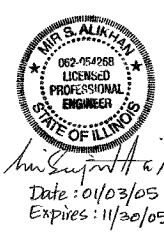

SIGNATURE & SEAL APPLY TO SHEETS
251 - 297

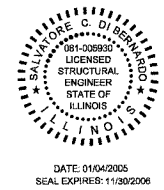

SIGNATURE & SEAL APPLY TO SHEETS
300 - 320

STATE OF ILLINOIS
DEPARTMENT OF TRANSPORTATION
DIVISION OF HIGHWAYS

SUBMITTED _____ 20 _____

_____ 20 _____ DISTRICT ENGINEER

_____ 20 _____ ENGINEER OF DESIGN AND ENVIRONMENT

_____ 20 _____ DIRECTOR, DIVISION OF HIGHWAYS

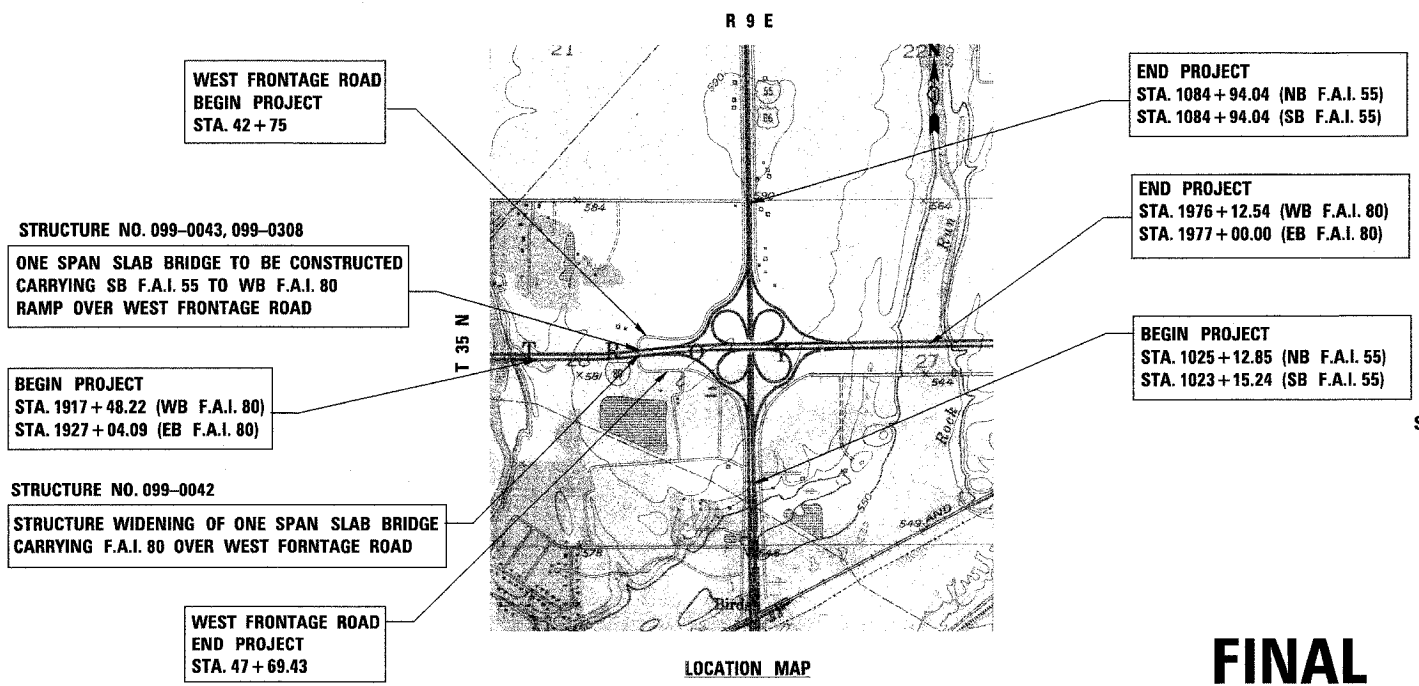

STRUCTURE NO. 099-0043, 099-0308
ONE SPAN SLAB BRIDGE TO BE CONSTRUCTED
CARRYING SB F.A.I. 55 TO WB F.A.I. 80
RAMP OVER WEST FRONTAGE ROAD

BEGIN PROJECT
STA. 1917+48.22 (WB F.A.I. 80)
STA. 1927+04.09 (EB F.A.I. 80)

STRUCTURE NO. 099-0042
STRUCTURE WIDENING OF ONE SPAN SLAB BRIDGE
CARRYING F.A.I. 80 OVER WEST FRONTAGE ROAD

WEST FRONTAGE ROAD
END PROJECT
STA. 47+69.43

END PROJECT
STA. 1084+94.04 (NB F.A.I. 55)
STA. 1084+94.04 (SB F.A.I. 55)

END PROJECT
STA. 1976+12.54 (WB F.A.I. 80)
STA. 1977+00.00 (EB F.A.I. 80)

BEGIN PROJECT
STA. 1025+12.85 (NB F.A.I. 55)
STA. 1023+15.24 (SB F.A.I. 55)

LOCATION MAP
NOT TO SCALE

F.A.I. 80 GROSS AND NET LENGTH OF PROJECT = 10,860.23 FT = 2.06 MI.
F.A.I. 55 GROSS AND NET LENGTH OF PROJECT = 12,159.99 FT = 2.30 MI.
WEST FRONTAGE ROAD GROSS AND NET LENGTH OF PROJECT = 494.43 FT = 0.09 MI.

FINAL

Ciorba Group, Inc.
DESIGN FIRM
REGISTRATION NUMBER
184-001016
CONSULTING ENGINEERS
SUITE 402, 5507 NORTH CUMBERLAND AVE
CHICAGO, ILLINOIS 60656 :: (773) 775-4009

CONSULTANT PROJECT MANAGER - CATHERINE KIBBLE, (847) 705-4269

LIST OF STATE STANDARDS

Table with columns: STANDARD NO., DESCRIPTION. Lists various engineering standards for symbols, erosion control, pavements, bridges, drainage, etc.

VOLUME 1

Table with columns: SHEET NO., DESCRIPTION. Lists sheet numbers and descriptions for Volume 1, including title sheets, indexes, general notes, quantities, and plans.

INDEX OF SHEETS

VOLUME 2

Table with columns: SHEET NO., DESCRIPTION. Lists sheet numbers and descriptions for Volume 2, including structural general plans, notes, staging, drawings, and details.

Summary table with columns: F.A.I. ROUTE, SECTION, COUNTY, TOTAL SHEETS, SHEET NO. Includes project information like '80-55 99-1(K,B,Y&AC-B) WILL 497 299' and 'CONTRACT NO. 80906'.

Table with columns: SHEET NO., DESCRIPTION. Lists sheets 203-250 related to lighting and signing plans.

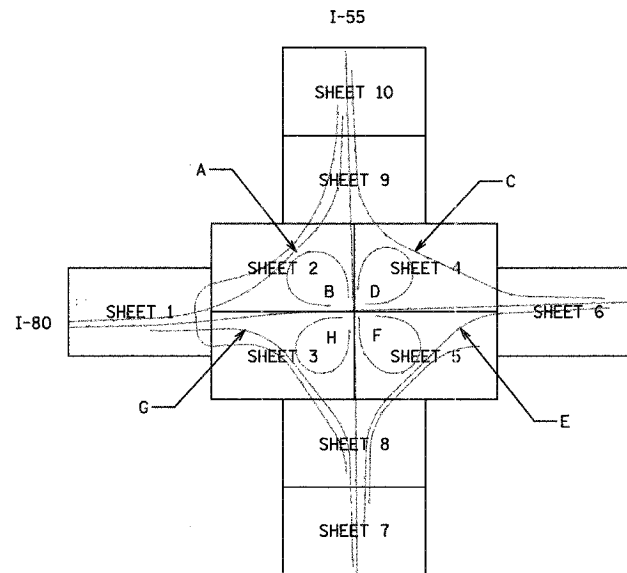

SHEET SEQUENCE FOR EXISTING, PROPOSED AND LANDSCAPING PLANS

PIPE CULVERT OR STORM SEWER NOTATION

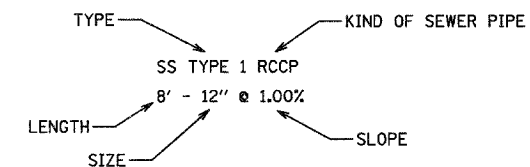

END SECTION NOTATION

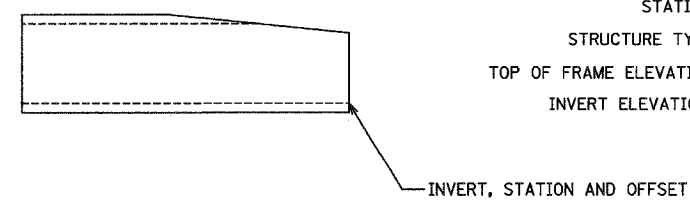

CONCRETE HEADWALL FOR PIPE DRAIN NOTATION

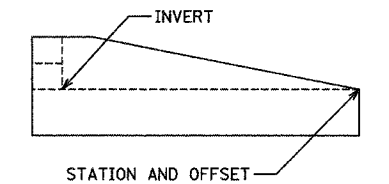

STRUCTURE NOTATION

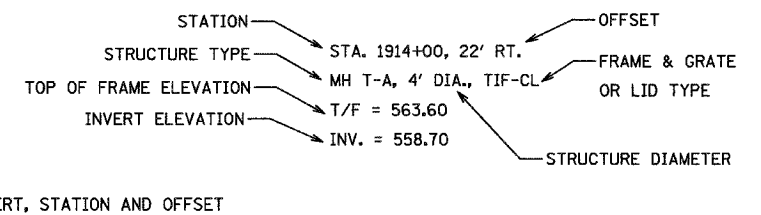

Table with columns: REVISIONS, NAME, DATE. A grid for recording design changes.

Project title block: STATE OF ILLINOIS DEPARTMENT OF TRANSPORTATION F.A.I. 80 & F.A.I. 55 INTERCHANGE VOLUME 2 OF 2 INDEX OF SHEETS, STATE STANDARDS AND LEGEND. Includes scale (SCALE: N.T.S.) and drawing information (DRAWN BY: IMG, CHECKED BY: MJL).

DATE: 07/04/2005 FILENAME: N:\PROJ\22850\22850-02\Drawings\Structs\22850-Index2-ar05.dgn

Bench Mark #35: "□" Cut on N.W. Wingwall of I-80 Westbound Bridge over Frontage Road Elev. 604.71

Existing Structure: Sta. 1931+99.35 FAI-80 Section 99-1 Built in 1960. Existing Structure Number 099-0042 (Eastbound) and 099-0043 (Westbound).
 Proposed structure number 099-0308 (Ramp A).
 Superstructure: Reinforced concrete slab.
 Substructure: Closed Abutments. Existing and Proposed Structure Length 28'-0" back to back of Abutments, width variable.
 Eastbound bridge to be widened on one side (Ramp G). Existing wingwall to be partially removed.
 New bridge, wingwalls, and Retaining Walls to be Constructed for Ramp A.
 Traffic to be maintained utilizing stage construction.
 No Salvage

Note: The width between the guard rails shall be the width between the bridge parapets which will require approach shoulder widening. See Roadway Plans.

STATION 1931+99.35
 REBUILT 200 BY
 STATE OF ILLINOIS
 FAI RT. 80 SEC. 99-1K, BY & AC-B)
 LOADING HS20
 STR. NO. 099-0042

STATION 1931+99.35
 REBUILT 200 BY
 STATE OF ILLINOIS
 FAI RT. 80 SEC. 99-1K, BY & AC-B)
 LOADING HS20
 STR. NO. 099-0308

F.A.I. RTE.	SECTION	COUNTY	TOTAL SHEETS	SHEET NO.
80	99-1K, BY & AC-B)	COOK	497	300
STA.	TO STA.			
FED. ROAD DIST. NO.	ILLINOIS	FED. AID PROJECT		
		CONTRACT	80906	

Sheet S-1 of S-21

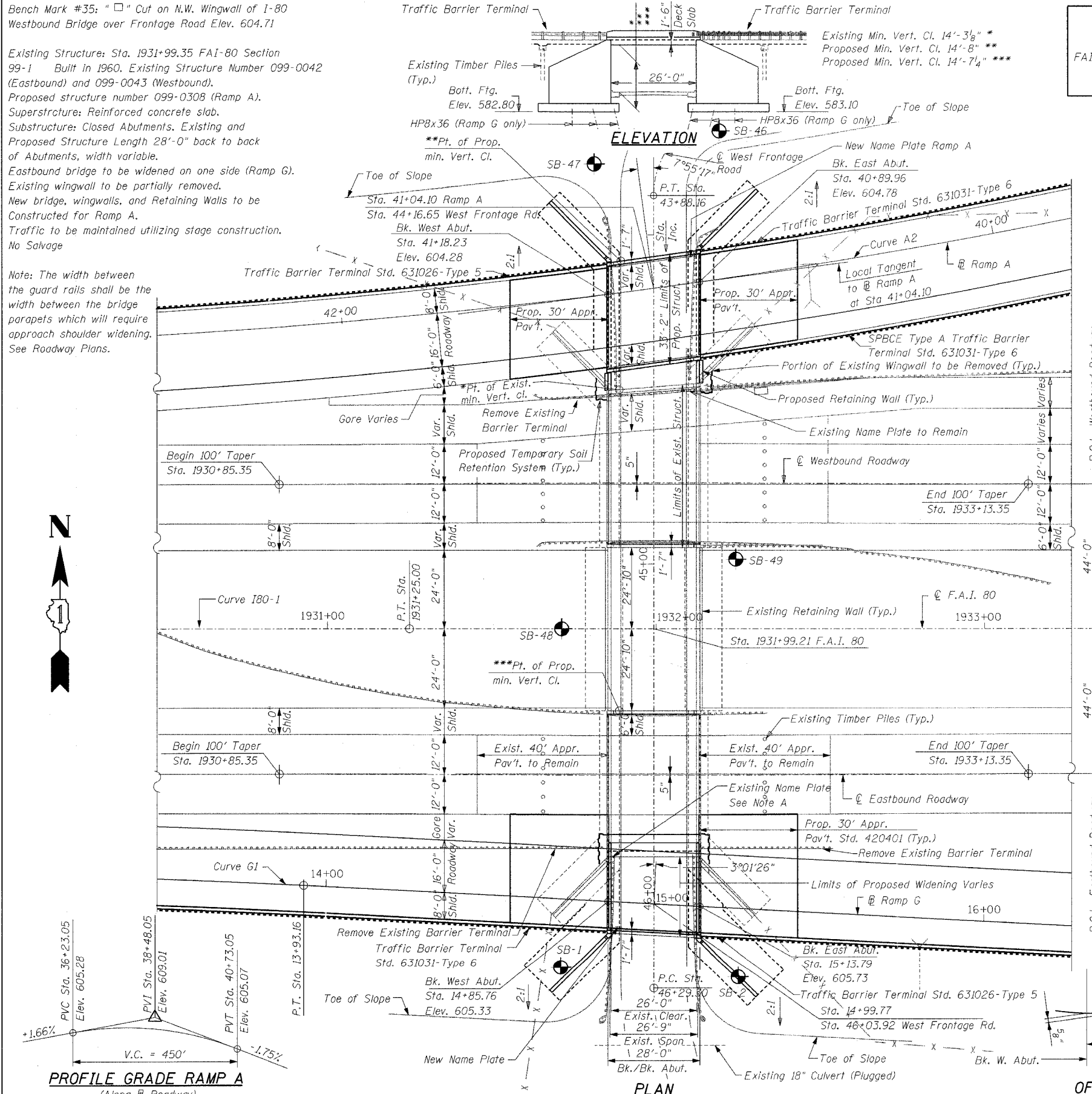

NAME PLATE
 See Std. 515001 I-80 (EB)

NAME PLATE
 See Std. 515001 RAMP A

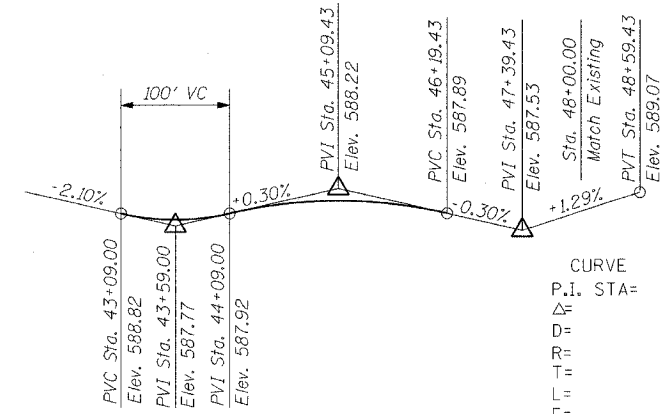
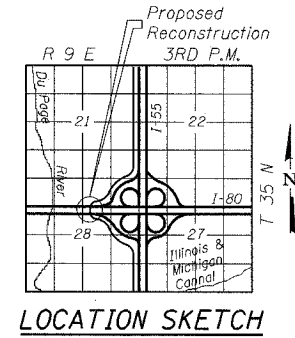

PROFILE GRADE WEST FRONTAGE ROAD
 (Along Centerline Roadway)

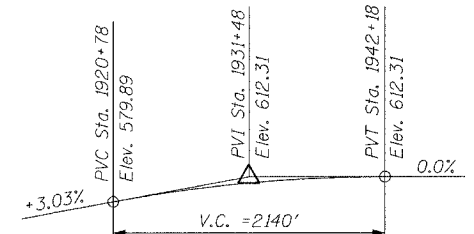

PROFILE GRADE FAI 80
 (Along P.G.L. Eastbound Lanes)

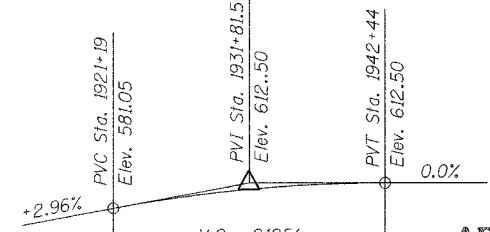

PROFILE GRADE FAI 80
 (Along P.G.L. Westbound Lanes)

CURVE	1801	RAMP A2	RAMP G1
P.I. STA=	1928+14.09	37+03.27	11+96.66
Δ=	4°33'08"(LT.)	37°27'28"(RT.)	03°57'11"(LT.)
D=	0°45'00"	2°54'32"	1°00'20"
R=	7638.78'	1969.66'	5698.35'
T=	303.62'	667.80'	196.66'
L=	606.93'	1287.68'	393.16'
E=	6.03'	110.13'	3.39'
P.C. STA=	1925+10.47	30+35.47	10+00.00
P.T. STA=	1931+17.39	43+23.15	13+93.16

LOADING HS20-44
 Allow 50#/sq. ft. for future wearing surface.
DESIGN SPECIFICATIONS
 2002 AASHTO

DESIGN STRESSES
FIELD UNITS
 $f_c = 3,500$ psi
 $f_y = 60,000$ psi (reinforcement)
 $f_y = 50,000$ psi (M270 Grade 50)
SEISMIC DATA
 Seismic Performance Category (SPC) = A
 Bedrock Acceleration Coefficient (A) = 0.04 g
 Site Coefficient (S) = 1.0

APPROVED
 FOR STRUCTURAL ADEQUACY ONLY
Ralph E. Anderson
 ENGINEER OF BRIDGES AND STRUCTURES

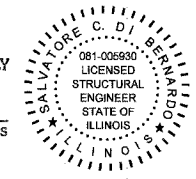

Note A:
 Existing Name Plate to be Cleaned and Relocated Adjacent to New Name Plate (Cost Included with Name Plates)

LEGEND:
 Soil Boring Location

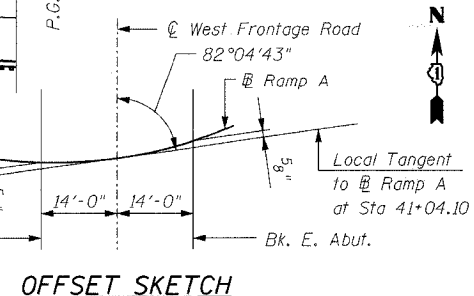

OFFSET SKETCH

REVISIONS	NAME	DATE

Clorba Group, Inc.
 CONSULTING ENGINEERS
 107 NORTH CLEVELAND AVENUE - CHICAGO, ILLINOIS 60608 - (773) 775-4000
 ILLINOIS DEPARTMENT OF TRANSPORTATION
 GENERAL PLAN
 FAI-80 OVER WEST FRONTAGE ROAD
 FAI-80 SECTION 99-1 (K, BY & AC-B)
 WILL COUNTY
 FAI-80 STA. 1931+99.35
 STRUCTURE NO. 099-0042, 099-0043, 099-0308
 SCALE: NONE DRAWN BY IMG
 DATE: OCTOBER 2004 CHECKED BY GDW

GENERAL NOTES:

Reinforcement bars shall conform to the requirements of AASHTO M 31, or M 322 Grade 60.

Back fill shall be placed behind the abutment after the superstructure has been in poured and the false work removed. See article 502.10 of The Standard Specifications.

The Contractor shall make allowance for the deflection of forms, shrinkage and settlement of false work, in addition to allowance for dead load deflection.

Plan dimensions and details relative to existing structure have been taken from existing plans and are subject to nominal construction variations. It shall be The Contractor's responsibility to verify such dimensions and details in the field and make necessary approved adjustments prior to construction or ordering of materials. Such variation shall not be cause for additional compensation for a change in the scope of the work, however, the Contractor will be paid for the quantity actually furnished at the unit price bid for the work.

The Contractor shall drive two HP 8x36 test piles in a permanent location at the Ramp G Bridge as directed by the Engineer before ordering the remainder of piles.

A cantilevered sheet piling design does not appear feasible and additional members or other retention systems may be necessary. The Contractor shall submit a temporary retention system design including plan details and calculation for review and acceptance by the Engineer.

The Contractor shall not drive construction equipment directly behind the existing retaining walls located in the median of FAI-80.

The Contractor shall maintain a minimum 12'-0" vertical clearance during construction to allow access for emergency vehicles into Camelot Subdivision in the southwest corner of the I-80/I-55 Interchange.

Before construction begins, The Contractor shall notify all residences and Businesses in the Southwest corner of the I-80/I-55 Interchange of the start and end dates for the 12'-0" minimum clearance. The Contractor shall post a low clearance sign during construction.

All Construction joints shall be bonded.

F.A.I. RTE.	SECTION	COUNTY	TOTAL SHEETS	SHEET NO.
80	99-1K, BY & AC-B)	COOK	497	301
STA.		TO STA.		
FED. ROAD DIST. NO.	ILLINOIS	FED. AID PROJECT		
Sheet S-2 of S-21				CONTRACT 80906

TOTAL BILL OF MATERIAL

ITEM	UNIT	SUPER	SUB	TOTAL
Concrete Removal	Cu. Yd.	19.1	30.3	49.4
Structure Excavation	Cu. Yd.	-	680	680
Concrete Superstructure	Cu. Yd.	114.3	-	114.3
Protective Coat	Sq. Yd.	47	-	47
Concrete Structures	Cu. Yd.	-	351.1	351.1
*** Formed Concrete Repair (Depth Equal to or Less than 5")	Sq. Ft.	-	333	333
Reinforcement Bars, Epoxy Coated	Pound	20,470	46,480	66,950
Furnishing Steel Piles HP 8x36	Foot	-	833	833
Driving Steel Piles	Foot	-	833	833
Test Pile Steel HP 8x36	Each	-	2	2
Metal Shoes	Each	-	49	49
*** Temporary Soil Retention System	Sq. Ft.	-	1027	1027
Name Plates	Each	2	-	2
*** Pipe Underdrains for Structures 6"	Lin. Ft.	-	240	240
Bridge Deck Grooving	Sq. Yd.	178	-	178
Epoxy Crack Sealing	Foot	-	379	379
Geocomposite Wall Drain	Sq. Yd.	-	494	494

*** Special Provisions

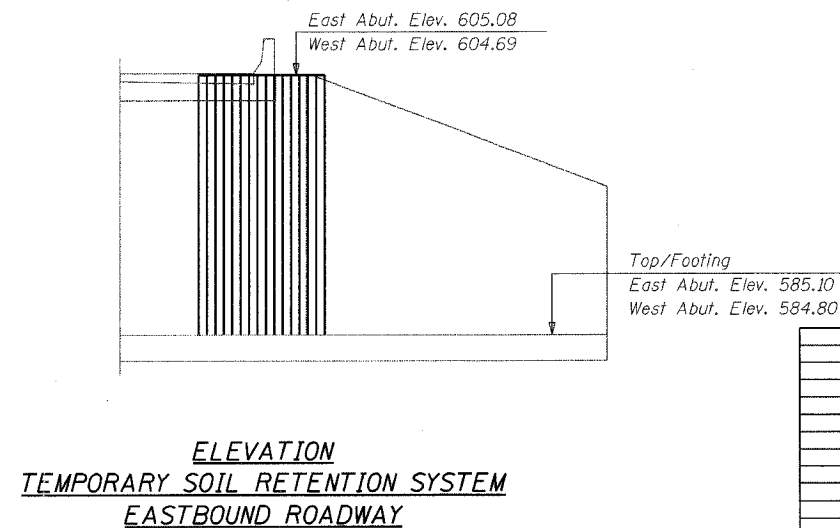
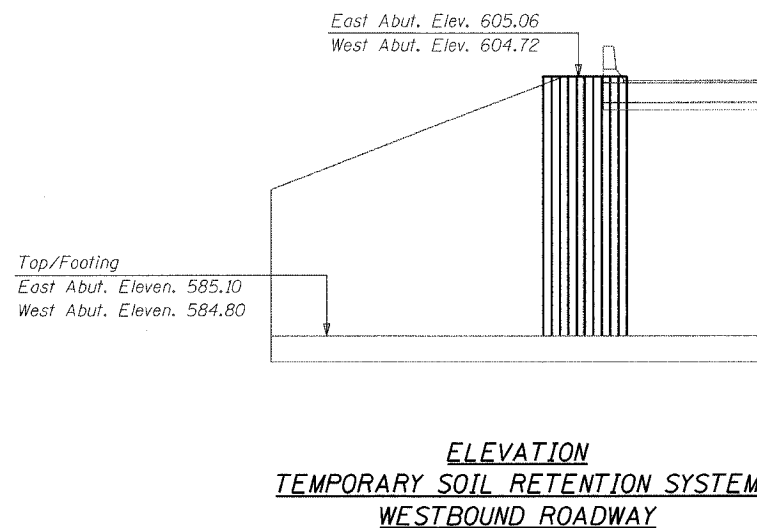
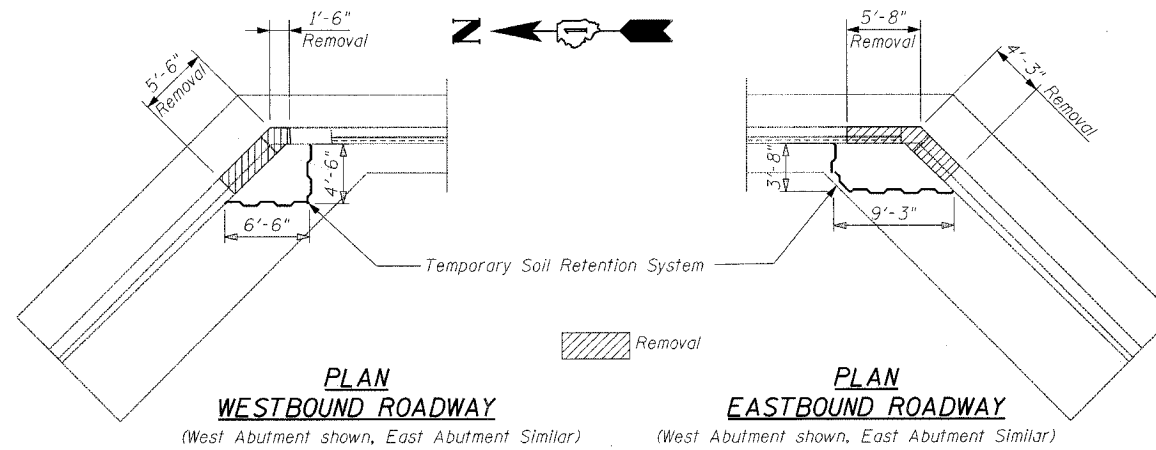

REVISIONS	
NAME	DATE

Clorba Group, Inc.
CONSULTING ENGINEERS
5807 NORTH CUMBERLAND AVENUE • CHICAGO, ILLINOIS 60656 • (773) 775-4009

ILLINOIS DEPARTMENT OF TRANSPORTATION
GENERAL NOTES & TOTAL BILL OF MATERIAL
FAI-80 OVER WEST FRONTAGE ROAD
FAI-80 SECTION 99-1 (K, BY & AC-B)
WILL COUNTY
FAI-80 STA. 1931+99.35
STRUCTURE NO. 099-0042, 099-0043, 099-0308
SCALE: NONE DRAWN BY IMG
DATE: OCTOBER 2004 CHECKED BY GDW

DATE: 10/20/05 FILENAME: n:\proj\2890\2890-02\design\structural\2890-02-s-02-gemnotes.dgn

F.A.I. RTE.	SECTION	COUNTY	TOTAL SHEETS	SHEET NO.
80	99-1(K, BY & AC-B)	COOK	497	302
STA.	TO STA.			
FED. ROAD DIST. NO.	ILLINOIS	FED. AID PROJECT		
Sheet S-3 of S-21				CONTRACT 80906

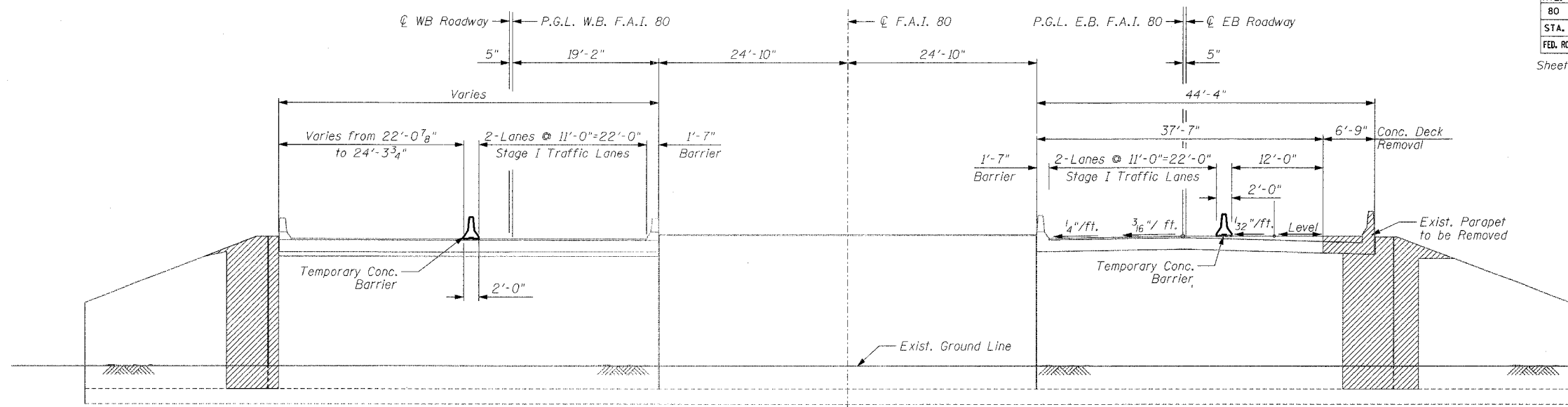

REMOVAL
(Looking East)

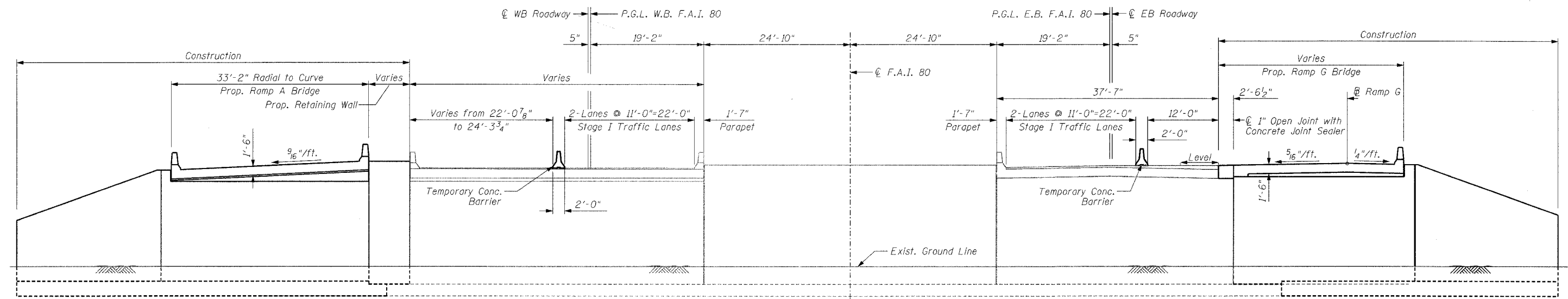

CONSTRUCTION
(Looking East)

Concrete Removal

Notes: All quantities and dimensions are approximate and must be verified in the field.

Pay item for temporary concrete barrier is included in the Roadway Plan.

For detail of temporary concrete barrier see Sheet S-18

REVISIONS	
NAME	DATE

Clorba Group, Inc.
CONSULTING ENGINEERS
5207 NORTH CUMBERLAND AVENUE - CHICAGO, ILLINOIS 60630 - (773) 775-6909

ILLINOIS DEPARTMENT OF TRANSPORTATION
CONSTRUCTION STAGING
FAI-80 OVER WEST FRONTAGE ROAD
FAI-80 SECTION 99-1 (K, BY & AC-B)
WILL COUNTY
FAI-80 STA. 1931+99.35
STRUCTURE NO. 099-0042, 099-0043, 099-0308
SCALE: NONE
DATE: OCTOBER 2004

DRAWN BY BWS & IMG
CHECKED BY GDW

DATE: 10/20/05
FILENAME: n:\proj\2890\2890-02\design\structural\2890-02-s-03-stageconst.dgn

F.A.I. RTE.	SECTION	COUNTY	TOTAL SHEETS	SHEET NO.
80	99-10(K, BY & AC-B)	COOK	497	303
STA.	TO STA.			
FED. ROAD DIST. NO.	ILLINOIS	FED. AID PROJECT		
Sheet S-4 of S-21			CONTRACT 80906	

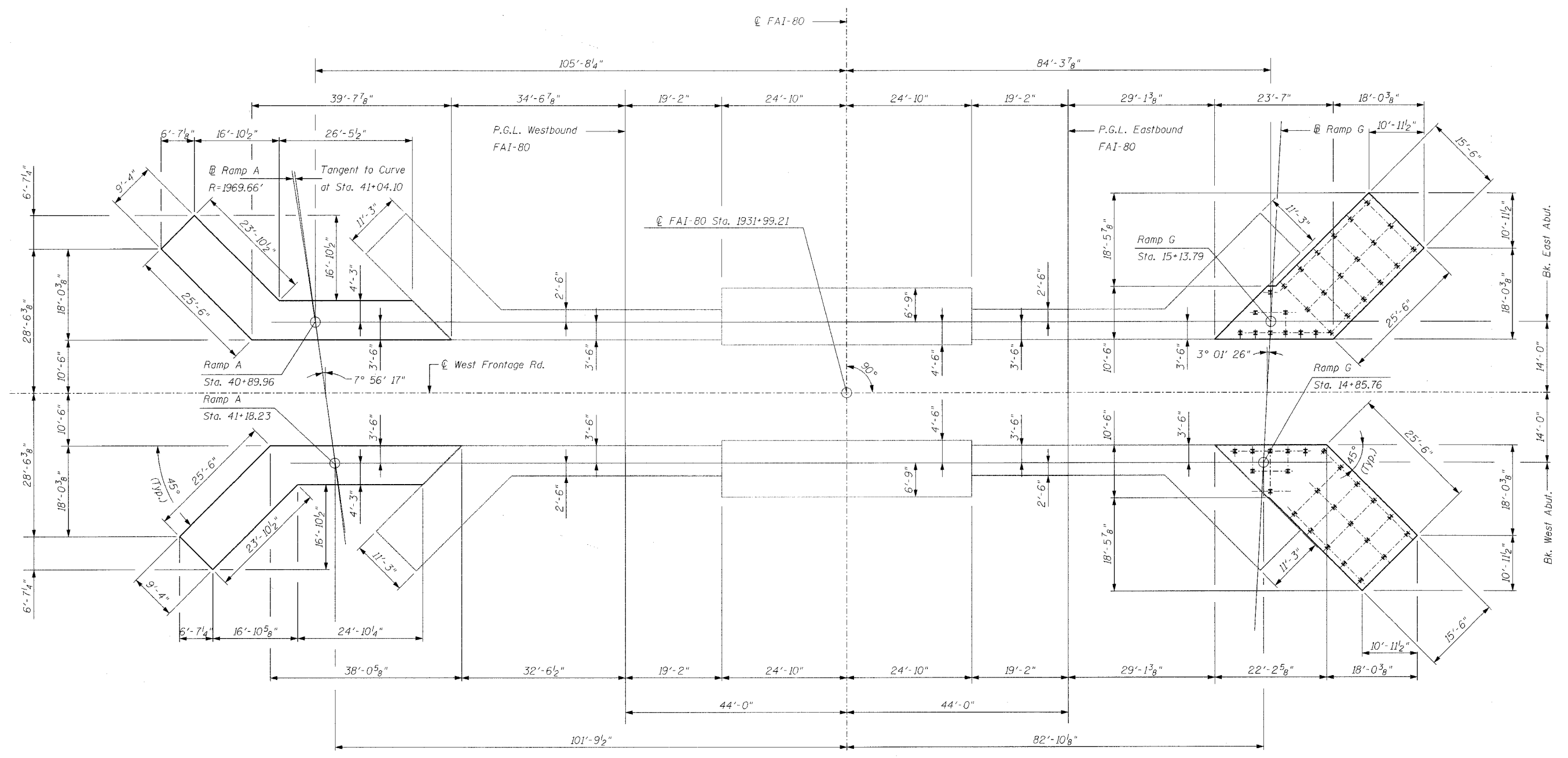

FOOTING LAYOUT

REVISIONS	
NAME	DATE

Clorba Group, Inc.
 CONSULTING ENGINEERS
 5201 NORTH CUMBERLAND AVENUE • CHICAGO, ILLINOIS 60630 • (773) 778-4200

ILLINOIS DEPARTMENT OF TRANSPORTATION
 FOOTING LAYOUT
 FAI-80 OVER WEST FRONTAGE ROAD
 FAI-80 SECTION 99-1 (K, BY & AC-B)
 WILL COUNTY
 FAI-80 STA. 1931+99.35
 STRUCTURE NO. 099-0042, 099-0043, 099-0308
 SCALE: NONE DRAWN BY IMG
 DATE: OCTOBER 2004 CHECKED BY GDW

DATE: 10/20/05
 FILENAME: n:\proj\2890\2890-02\design\structural\2890-02_s-04-footinglayout.dgn

F.A.I. RTE.	SECTION	COUNTY	TOTAL SHEETS	SHEET NO.
80	99-1(K, BY & AC-B)	COOK	497	304
STA.		TO STA.		
FED. ROAD DIST. NO.		ILLINOIS FED. AID PROJECT		CONTRACT 80906
Sheet S-5 of S-21				

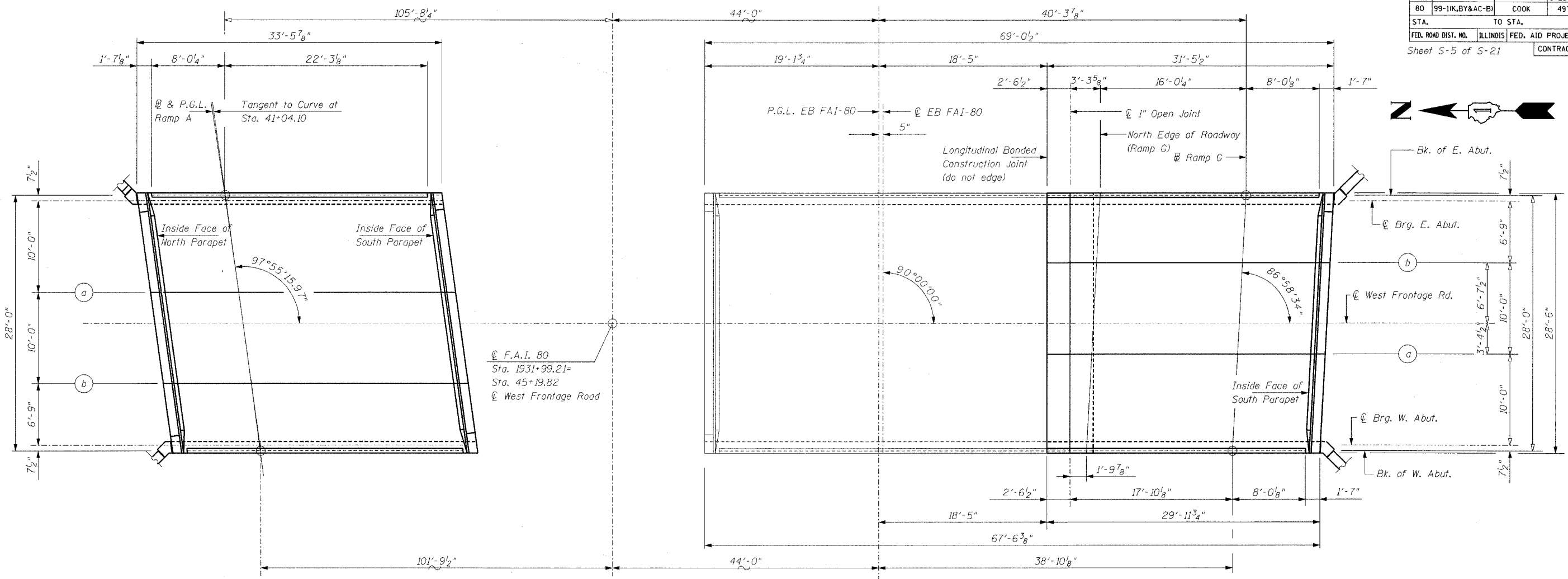

PLAN

RAMP A ELEVATIONS

Face of North Parapet

Location	Station	Offset	Theo. Grade Elev.
Bk. E. Abut.	4088.77	7.994	604.44
☉ Brg. E. Abut.	4089.40	7.997	604.43
a	4099.54	8.020	604.25
b	4109.69	7.993	604.07
☉ Brg. W. Abut.	4116.53	7.944	603.95
Bk. W. Abut.	4117.17	7.938	603.94

☉ & P.G.L.

Location	Station	Offset	Theo. Grade Elev.
Bk. E. Abut.	4089.96	0.000	604.78
☉ Brg. E. Abut.	4090.59	0.000	604.77
a	4100.69	0.000	604.59
b	4110.79	0.000	604.41
☉ Brg. W. Abut.	4117.60	0.000	604.29
Bk. W. Abut.	4118.23	0.000	604.28

Face of South Parapet

Location	Station	Offset	Theo. Grade Elev.
Bk. E. Abut.	4093.18	-21.988	605.71
☉ Brg. E. Abut.	4093.80	-21.987	605.70
a	4103.79	-21.984	605.52
b	4113.78	-22.034	605.35
☉ Brg. W. Abut.	4120.53	-22.097	605.23
Bk. W. Abut.	4121.15	-22.104	605.22

RAMP G ELEVATIONS

Longitudinal Bonded Construction Joint

Location	Station	Offset	Theo. Grade Elev.
Bk. W. Abut.	1484.56	-20.360	604.79
☉ Brg. W. Abut.	1485.18	-20.393	604.80
a	1495.17	-20.920	604.95
b	1505.15	-21.448	605.09
☉ Brg. E. Abut.	1511.89	-21.804	605.18
Bk. E. Abut.	1512.52	-21.837	605.19

Longitudinal Open Joint

Location	Station	Offset	Theo. Grade Elev.
Bk. W. Abut.	1484.81	-17.822	604.85
☉ Brg. W. Abut.	1485.43	-17.855	604.86
a	1495.42	-18.382	605.03
b	1505.41	-18.910	605.15
☉ Brg. E. Abut.	1512.15	-19.266	605.21
Bk. E. Abut.	1512.77	-19.299	605.22

North Edge of Roadway

Location	Station	Offset	Theo. Grade Elev.
Bk. W. Abut.	1484.91	-16.000	604.90
☉ Brg. W. Abut.	1485.53	-16.000	604.91
a	1495.55	-16.000	605.09
b	1505.56	-16.000	605.23
☉ Brg. E. Abut.	1512.32	-16.000	605.29
Bk. E. Abut.	1512.94	-16.000	605.30

Base Line

Location	Station	Offset	Theo. Grade Elev.
Bk. W. Abut.	1485.75	0.000	605.33
☉ Brg. W. Abut.	1486.38	0.000	605.34
a	1496.39	0.000	605.53
b	1506.40	0.000	605.65
☉ Brg. E. Abut.	1513.16	0.000	605.72
Bk. E. Abut.	1513.79	0.000	605.73

Face of South Parapet

Location	Station	Offset	Theo. Grade Elev.
Bk. W. Abut.	1486.17	8.000	605.18
☉ Brg. W. Abut.	1486.80	8.000	605.19
a	1496.81	8.000	605.37
b	1506.83	8.000	605.50
☉ Brg. E. Abut.	1513.59	8.000	605.56
Bk. E. Abut.	1514.21	8.000	605.57

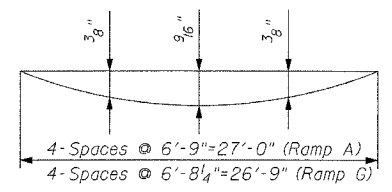

DEAD LOAD DEFLECTION DIAGRAM

In addition to dead load deflection the Contractor shall allow for settlement of forms and shrinkage.

Note:
All elevations are to top of concrete.



REVISIONS	
NAME	DATE

ILLINOIS DEPARTMENT OF TRANSPORTATION
TOP OF SLAB ELEVATIONS & LOCATION
FAI-80 OVER WEST FRONTAGE ROAD
FAI-80 SECTION 99-1 (K, BY & AC-B)
WILL COUNTY
FAI-80 STA. 1931+99.35
STRUCTURE NO. 099-0042, 099-0043, 099-0308
SCALE: NONE
DATE: OCTOBER 2004
DRAWN BY IMG
CHECKED BY CDW

DATE: 10/20/05
FILENAME: n:\proj\2890-02\design\structural\2890-02-s-05-deckelev.dgn

F.A.I. RTE.	SECTION	COUNTY	TOTAL SHEETS	SHEET NO.
80	99-10(K,BY&AC-B)	COOK	497	305
STA.	TO STA.			
FED. ROAD DIST. NO.	ILLINOIS	FED. AID PROJECT		
Sheet S-6 of S-21			CONTRACT 80906	

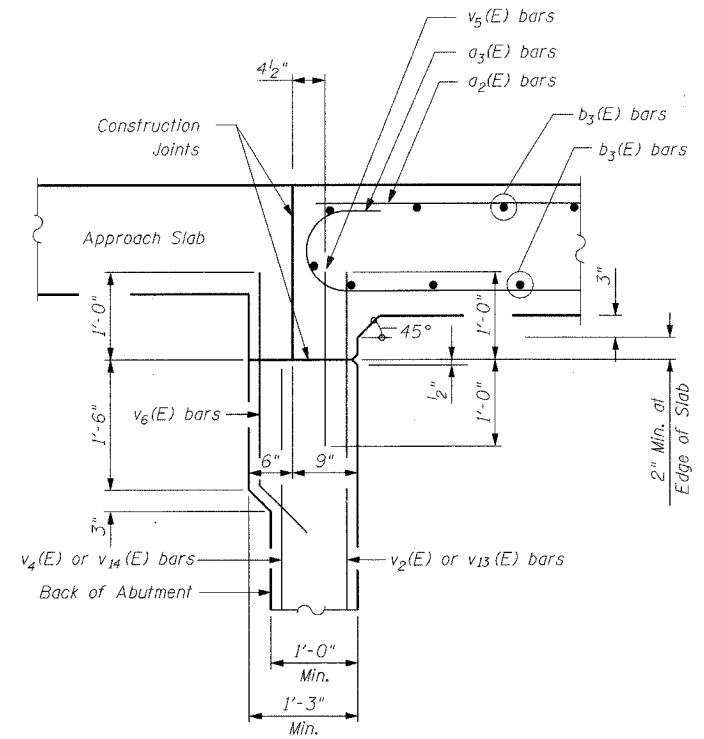
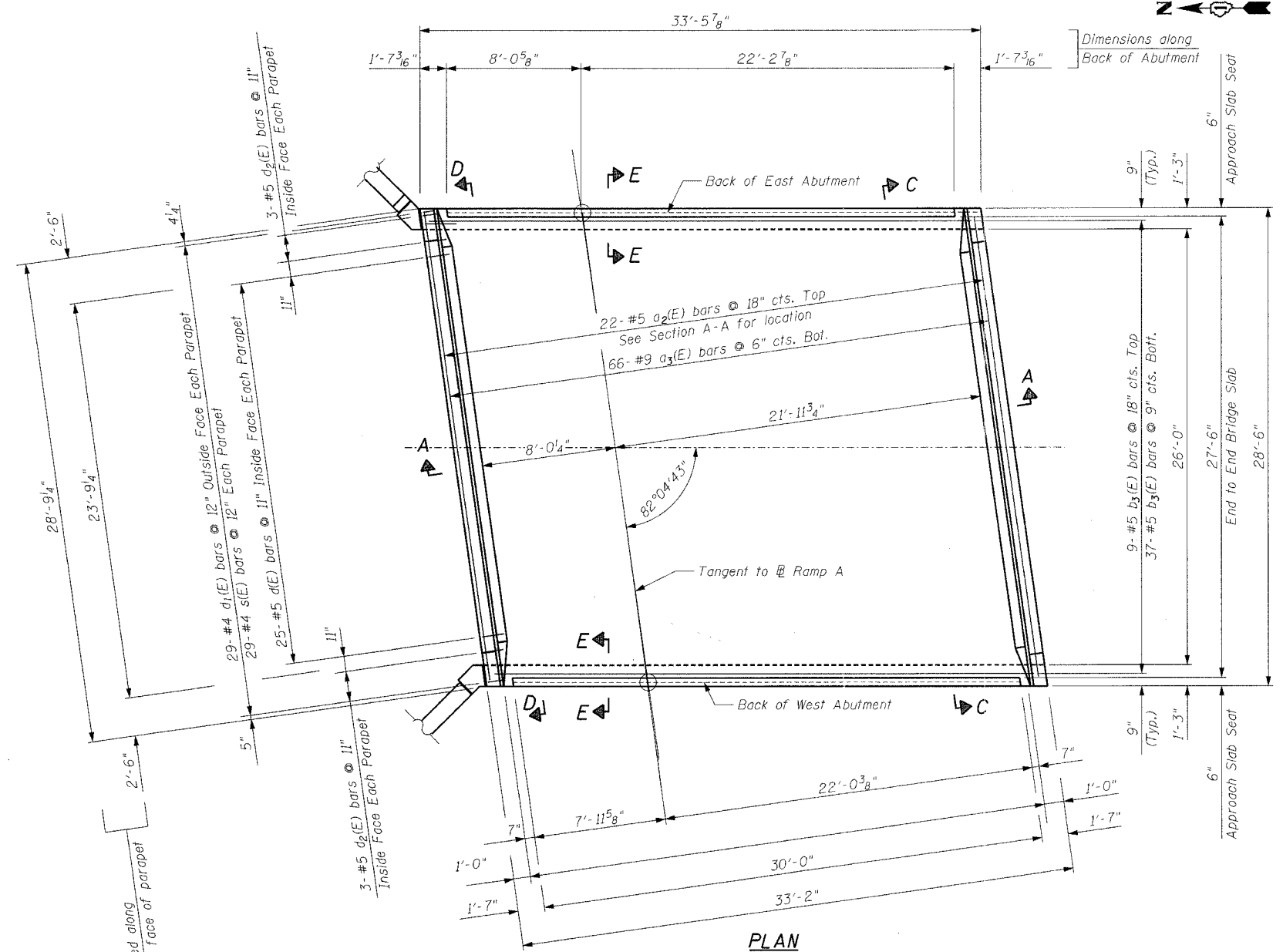

SECTION E-E

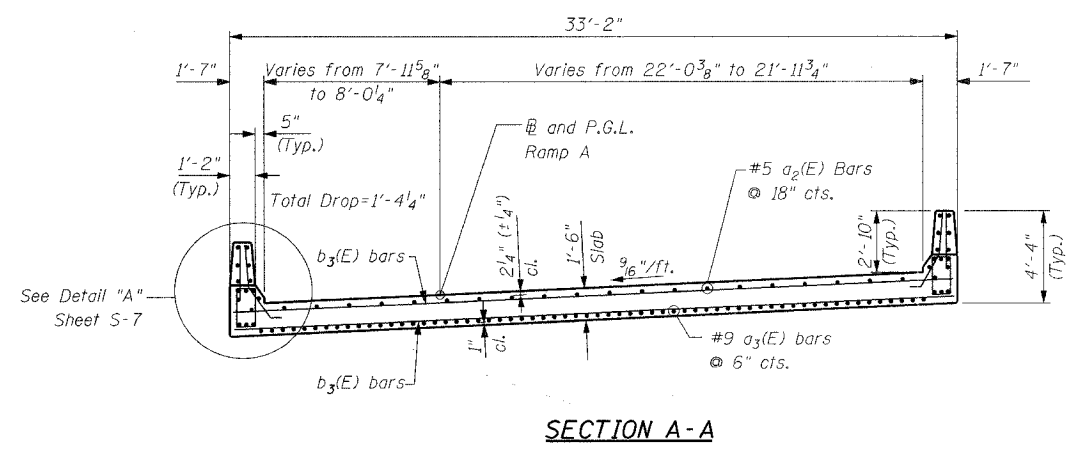

SECTION A-A

Notes:
 Reinforcement bars designated (E) shall be epoxy coated.
 For Bill of Material and Superstructure Details See Sheet S-7.

REVISIONS	
NAME	DATE

Ciorba Group, Inc.
 CONSULTING ENGINEERS
 2007 NORTH CUMBERLAND AVENUE - CHICAGO, ILLINOIS 60664 - (773) 775-4000

ILLINOIS DEPARTMENT OF TRANSPORTATION
 RAMP A DECK SLAB
 FAI-80 OVER WEST FRONTAGE ROAD
 FAI-80 SECTION 99-1 (K,BY & AC-B)
 WILL COUNTY
 FAI-80 STA. 1931+99.35
 STRUCTURE NO. 099-0042, 099-0043, 099-0308
 SCALE: NONE DRAWN BY BWS & IMG
 DATE: OCTOBER 2004 CHECKED BY GDW

DATE: 10/20/05
 FILENAME: n:\proj\2890\2890-02\design\structural\2890-02-06-ramp-a-deck.dgn

F.A.I. RTE.	SECTION	COUNTY	TOTAL SHEETS	SHEET NO.
80	99-1(K, BY & AC-B)	COOK	497	307
STA.	TO STA.			
FED. ROAD DIST. NO.	ILLINOIS	FED. AID PROJECT		
Sheet S-8 of S-21			CONTRACT 80906	

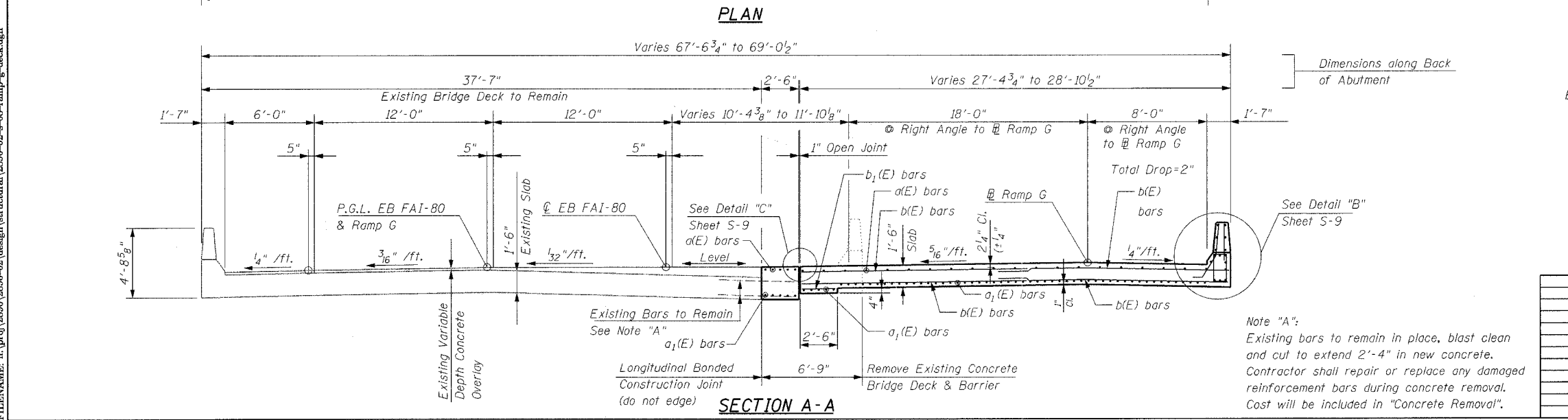
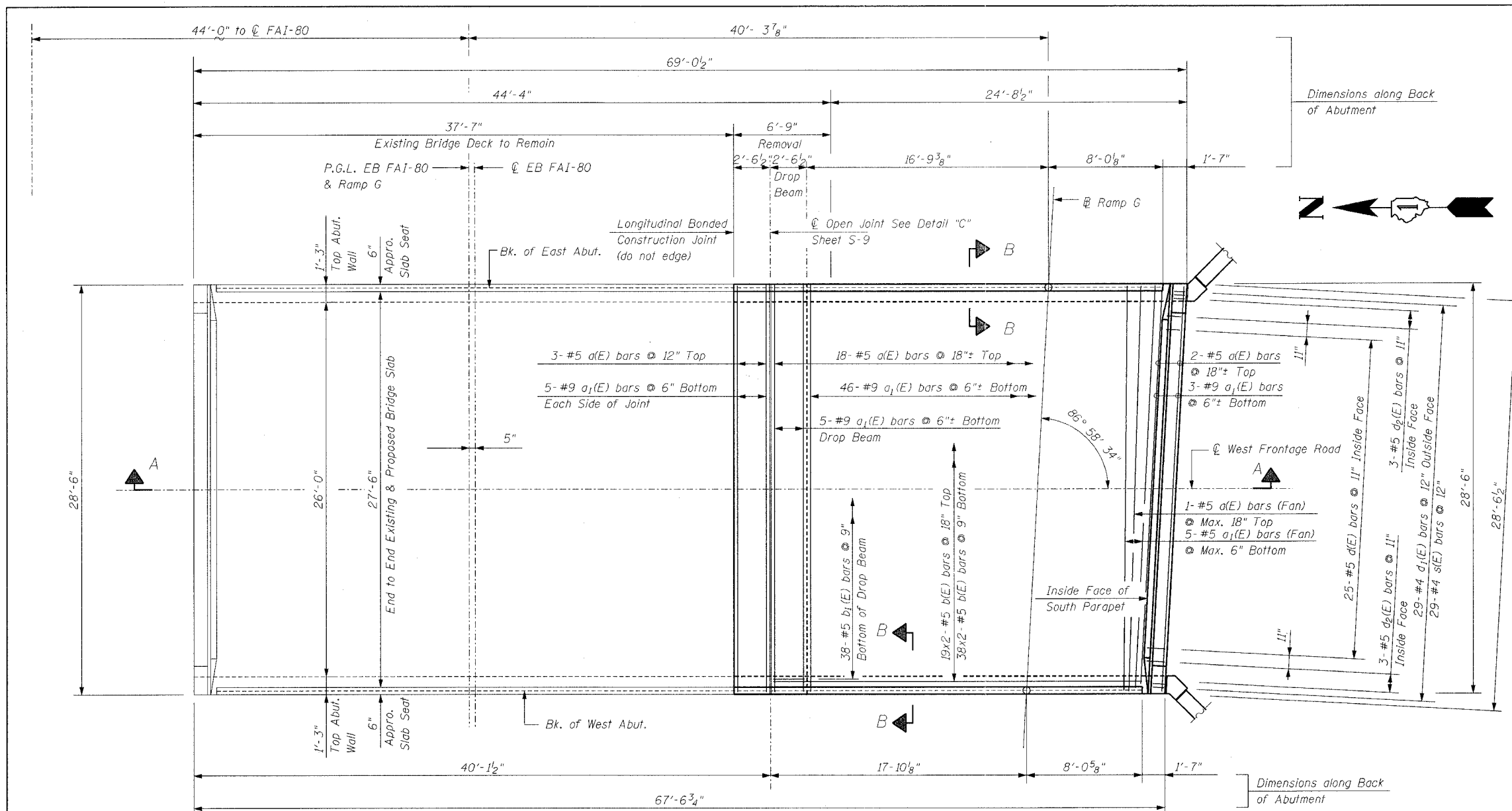

Notes:
 See Sheet S-8 for superstructure details, parapet reinforcement and Bill of Material.
 Reinforcement bars designated (E) shall be epoxy coated.
 Bars indicated thus 20 x 3- #5 etc. indicates 20 lines of bars with 3 lengths per line.
 Minimum lap splice shall be 2'-2" for #5 bars.

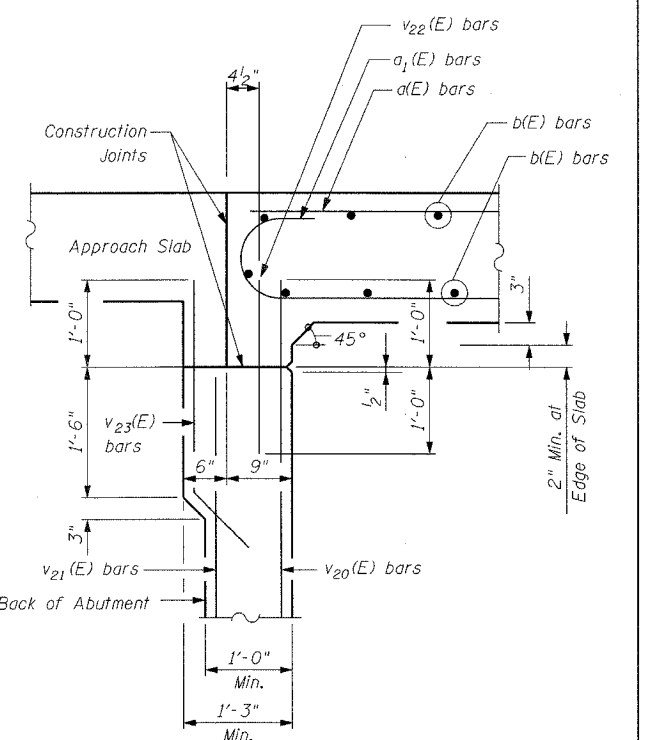

DATE: 10/20/05
 FILENAME: n:\proj\2890\2890-02\design\structural\2890-02-s-08-ramp-g-deck.dgn

Note "A":
 Existing bars to remain in place, blast clean and cut to extend 2'-4" in new concrete. Contractor shall repair or replace any damaged reinforcement bars during concrete removal. Cost will be included in "Concrete Removal".

REVISIONS	
NAME	DATE

Clorba Group, Inc.
 CONSULTING ENGINEERS
 2807 NORTH CUMBERLAND AVENUE - CHICAGO, ILLINOIS 60638 - (773) 775-6000

ILLINOIS DEPARTMENT OF TRANSPORTATION
 EASTBOUND FAI-80 & RAMP G DECK SLAB
 FAI-80 OVER WEST FRONTAGE ROAD
 FAI-80 SECTION 99-1 (K, BY & AC-B)
 WILL COUNTY
 FAI-80 STA. 1931+99.35
 STRUCTURE NO. 099-0042, 099-0043, 099-0308
 SCALE: NONE DRAWN BY IMG
 DATE: OCTOBER 2004 CHECKED BY GDW

F.A.I. RTE.	SECTION	COUNTY	TOTAL SHEETS	SHEET NO.
80	99-10(K,BY&AC-B)	COOK	497	308
STA. TO STA.				
FED. ROAD DIST. NO.			ILLINOIS FED. AID PROJECT	
Sheet S-9 of S-21			CONTRACT 80906	

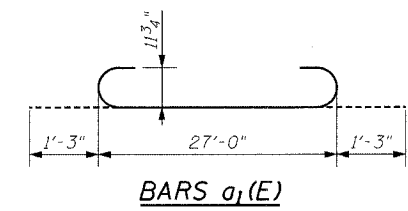
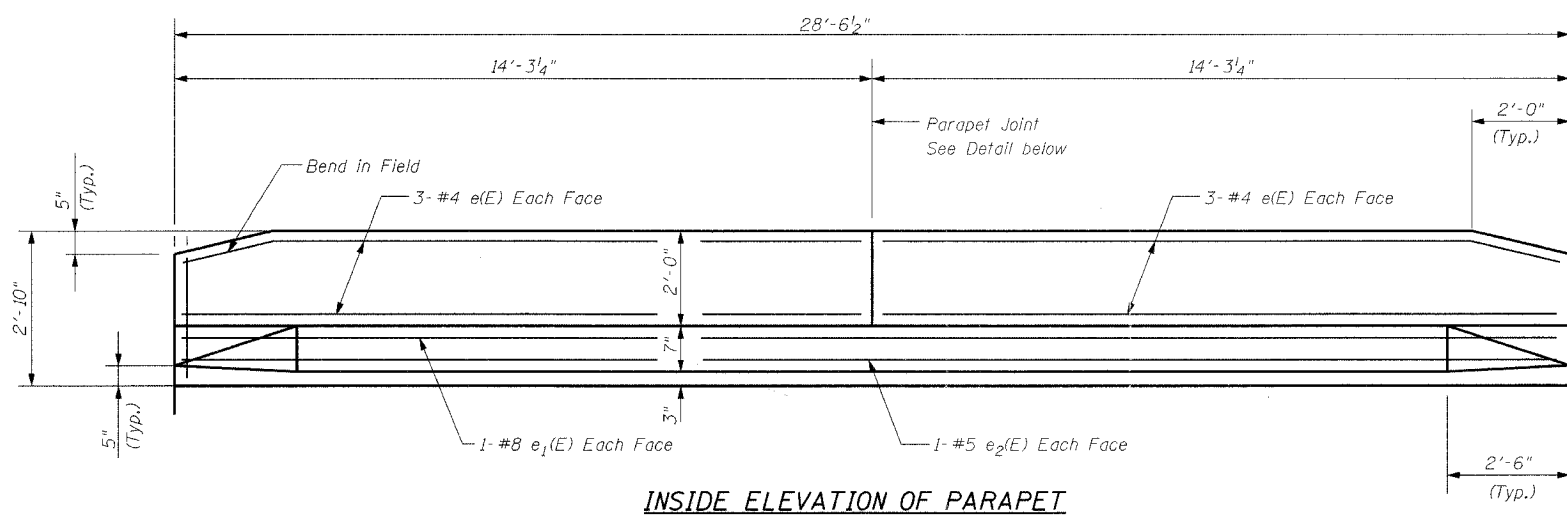

BARS a₁(E)

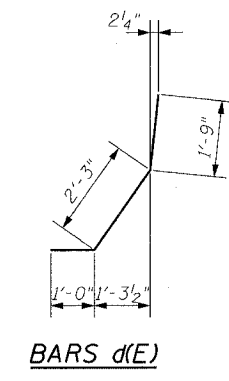

BARS d(E)

INSIDE ELEVATION OF PARAPET

SUPERSTRUCTURE BILL OF MATERIAL

Bar	No.	Size	Length	Shape
d(E)	24	#5	27'-0"	
a ₁ (E)	64	#9	29'-6"	
b(E)	114	#5	15'-5"	
b ₁ (E)	38	#5	2'-0"	
d(E)	25	#5	5'-0"	
d ₁ (E)	29	#4	3'-0"	
d ₂ (E)	6	#5	3'-2"	
e(E)	12	#4	14'-0"	
e ₁ (E)	2	#8	28'-2"	
e ₂ (E)	2	#5	28'-2"	
s(E)	29	#4	6'-9"	

Item	Unit	Quantity
Concrete Removal	Cu. Yd.	19.1
Reinforcement Bars, Epoxy Coated	Pound	9,730
Concrete Superstructure	Cu. Yd.	54.6
Protective Coat	Sq. Yd.	23
Bridge Deck Grooving	Sq. Yd.	89

Reinforcement bars designated (E) shall be epoxy coated.

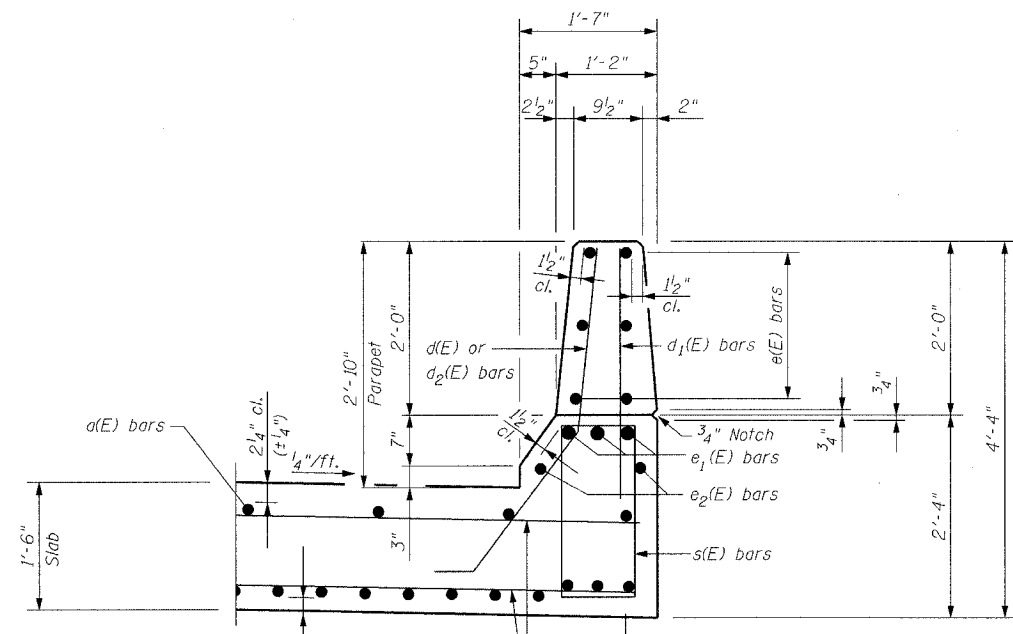

DETAIL "B"

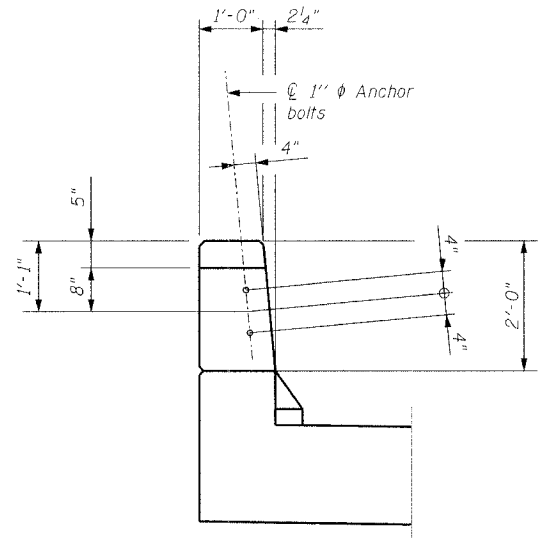

VIEW A-A

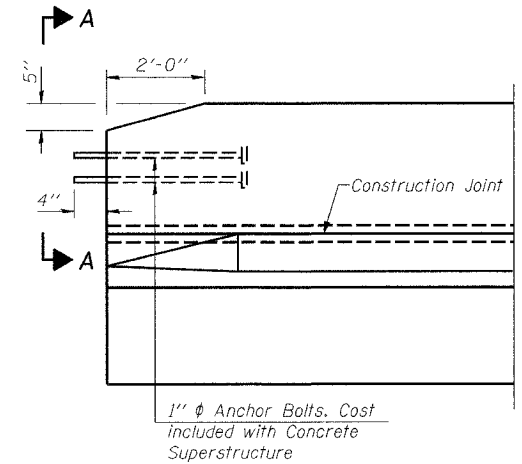

PARTIAL ELEVATION SOUTHEAST PARAPET

BAR d₂(E)

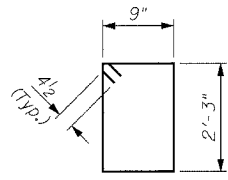

BAR s(E)

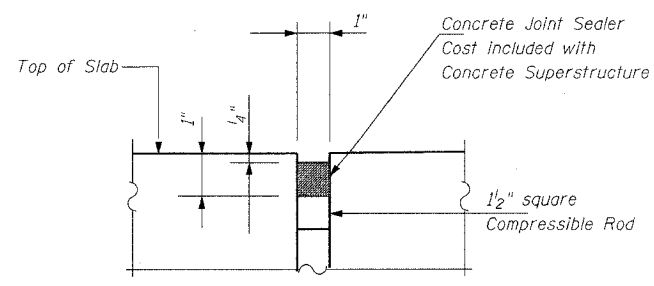

DETAIL "C"

For Location of Detail "C" See Sheet S-8

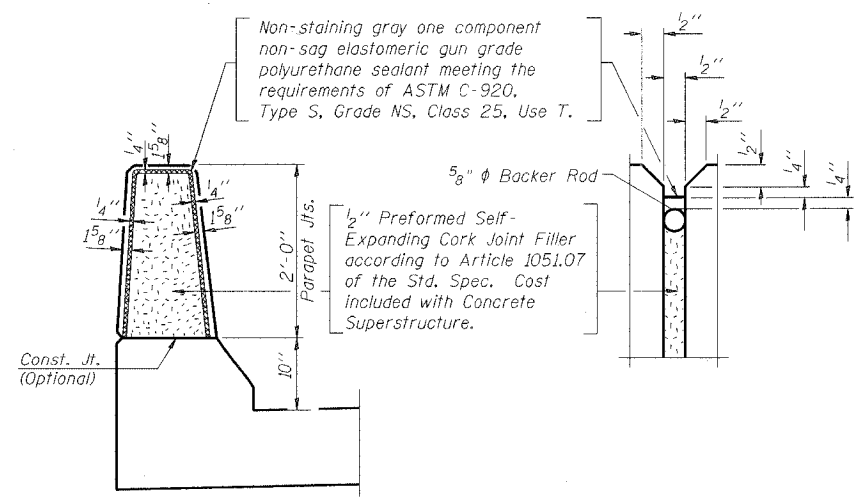

PARAPET JOINT DETAILS

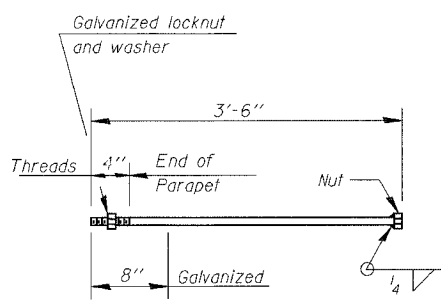

1" ANCHOR BOLT

(Cost included with Concrete Superstructure)

REVISIONS	
NAME	DATE

Clorba Group, Inc.
CONSULTING ENGINEERS
300 NORTH CUMBERLAND AVENUE - CHICAGO, ILLINOIS 60610 - (773) 735-1000

ILLINOIS DEPARTMENT OF TRANSPORTATION
RAMP G SUPERSTRUCTURE DETAILS
FAI-80 OVER WEST FRONTAGE ROAD
FAI-80 SECTION 99-1 (K,BY & AC-B)
WILL COUNTY
FAI-80 STA. 1931+99.35
STRUCTURE NO. 099-0042, 099-0043, 099-0308
SCALE: NONE DRAWN BY IMG
DATE: OCTOBER 2004 CHECKED BY GDW

DATE: 10/20/05
FILENAME: n:\proj\2890\2890-02\design\structural\2890-02-s-09-ramp-g-check.dgn

F.A.I. RTE.	SECTION	COUNTY	TOTAL SHEETS	SHEET NO.
80	99-10(K,BY&AC-B)	COOK	497	309
STA.	TO STA.			
FED. ROAD DIST. NO.	ILLINOIS	FED. AID PROJECT		
Sheet S-10 of S-21				CONTRACT 80906

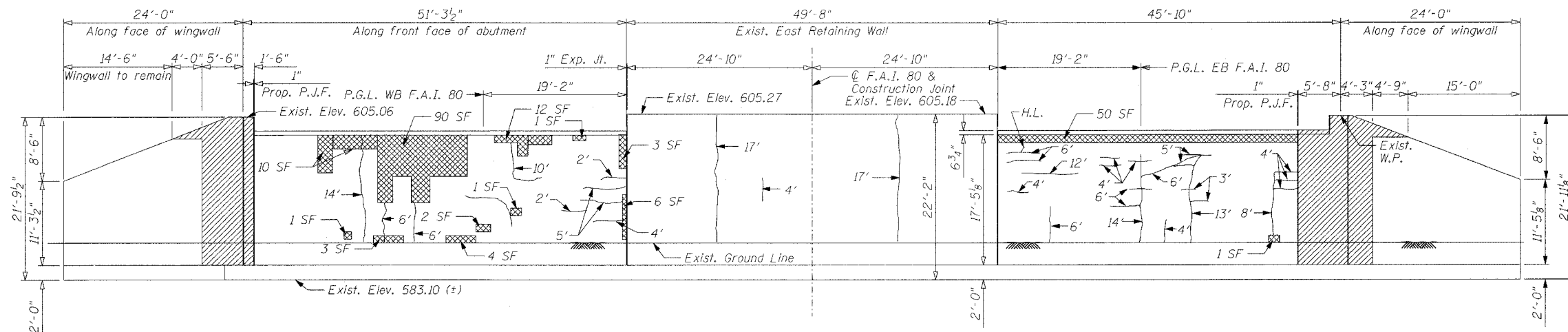

ELEVATION
(Looking East)

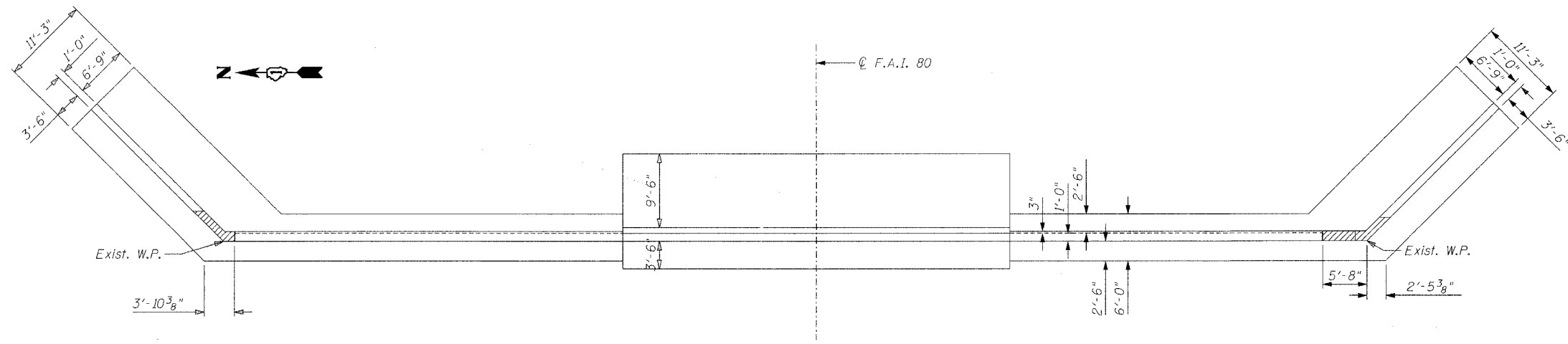

PLAN

BILL OF MATERIAL

ITEM	UNIT	QUANTITY
Concrete Removal	Cu. Yd.	15.1
Formed Concrete Repair (Depth Equal to or Less than 5")	Sq. Ft.	194
Epoxy Crack Sealing	Lin. Ft.	235

- Formed Concrete Repair
- Concrete Removal

Note: All quantities and dimensions are approximate and must be verified in the field.

REVISIONS	
NAME	DATE

Clorba Group, Inc.
CONSULTING ENGINEERS
507 NORTH CUMBERLAND AVENUE • CHICAGO, ILLINOIS 60654 • (773) 775-6109

ILLINOIS DEPARTMENT OF TRANSPORTATION
EAST ABUTMENT REMOVAL AND REPAIR
FAI-80 OVER WEST FRONTAGE ROAD
FAI-80 SECTION 99-1 (K,BY & AC-B)
WILL COUNTY
FAI-80 STA. 1931+99.35
STRUCTURE NO. 099-0042, 099-0043, 099-0308
SCALE: NONE DRAWN BY BWS
DATE: OCTOBER 2004 CHECKED BY GDW

DATE: 10/20/05
FILENAME: n:\proj\2890\2890-02\design\structural\2890-02-s-10-eastabut-repair.dgn

F.A.I. RTE.	SECTION	COUNTY	TOTAL SHEETS	SHEET NO.
80	99-1(K,BY&AC-B)	COOK	497	310
STA.		TO STA.		
FED. ROAD DIST. NO.		ILLINOIS	FED. AID PROJECT	
Sheet S-11 of S-21		CONTRACT 80906		

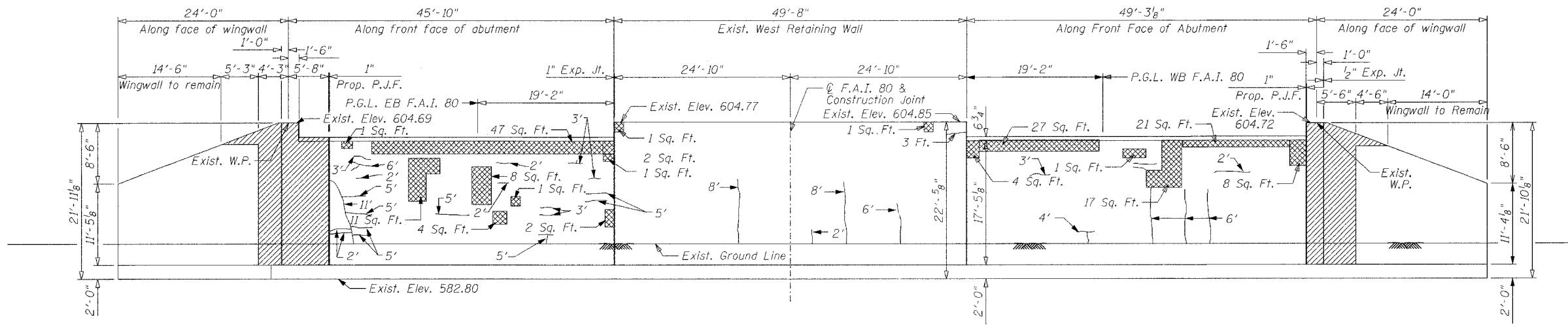

ELEVATION
(Looking West)

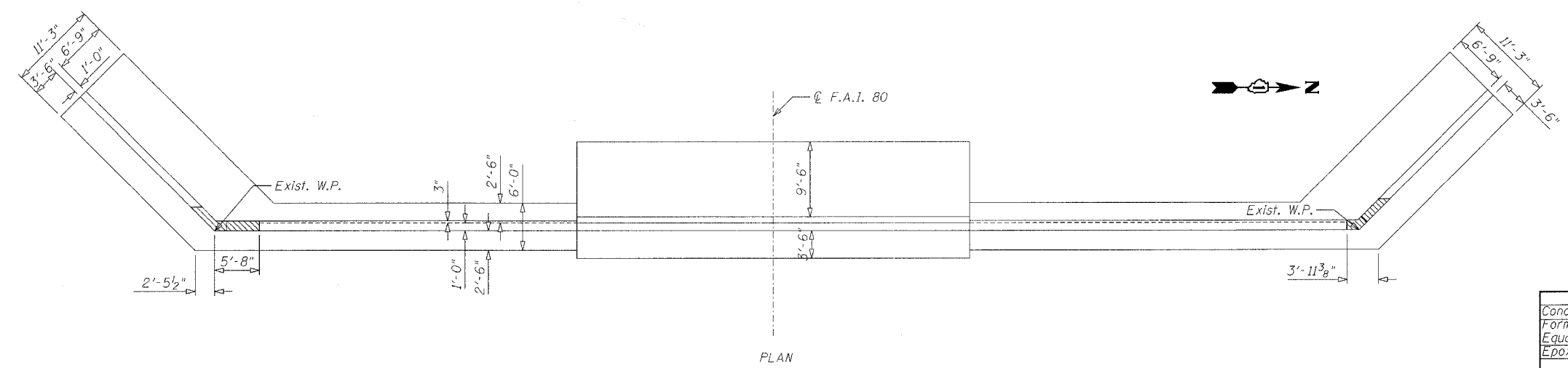

PLAN

BILL OF MATERIAL

ITEM	UNIT	QUANTITY
Concrete Removal	Cu. Yd.	15.2
Formed Concrete Repair (Depth Equal to or Less than 5")	Sq. Ft.	138
Epoxy Crack Sealing	Lin. Ft.	144

- Formed Concrete Repair (Depth Equal to or Less than 5")
- Concrete Removal

Note: All quantities and dimensions are approximate and must be verified in the field.

REVISIONS	
NAME	DATE

CC Ciorba Group, Inc.
CONSULTING ENGINEERS
2007 NORTH CUMBERLAND AVENUE - CHICAGO, ILLINOIS 60608 - (773) 778-4000

ILLINOIS DEPARTMENT OF TRANSPORTATION
WEST ABUTMENT REMOVAL AND REPAIR
FAI-80 OVER WEST FRONTAGE ROAD
FAI-80 SECTION 99-1 (K,BY & AC-B)
WILL COUNTY
FAI-80 STA. 1931+99.35
STRUCTURE NO. 099-0042, 099-0043, 099-0308
SCALE: NONE
DATE: OCTOBER 2004

DRAWN BY BWS
CHECKED BY GDW

DATE: 10/20/05
FILENAME: n:\proj\2890\2890-02\design\structural\2890-02-s-11-westabut-repair.dgn

F.A.I. RTE.	SECTION	COUNTY	TOTAL SHEETS	SHEET NO.
80	99-10K, BY&AC-B)	COOK	497	311
STA.	TO STA.			
FED. ROAD DIST. NO.	ILLINOIS	FED. AID PROJECT		
Sheet S-12 of S-21			CONTRACT 80906	

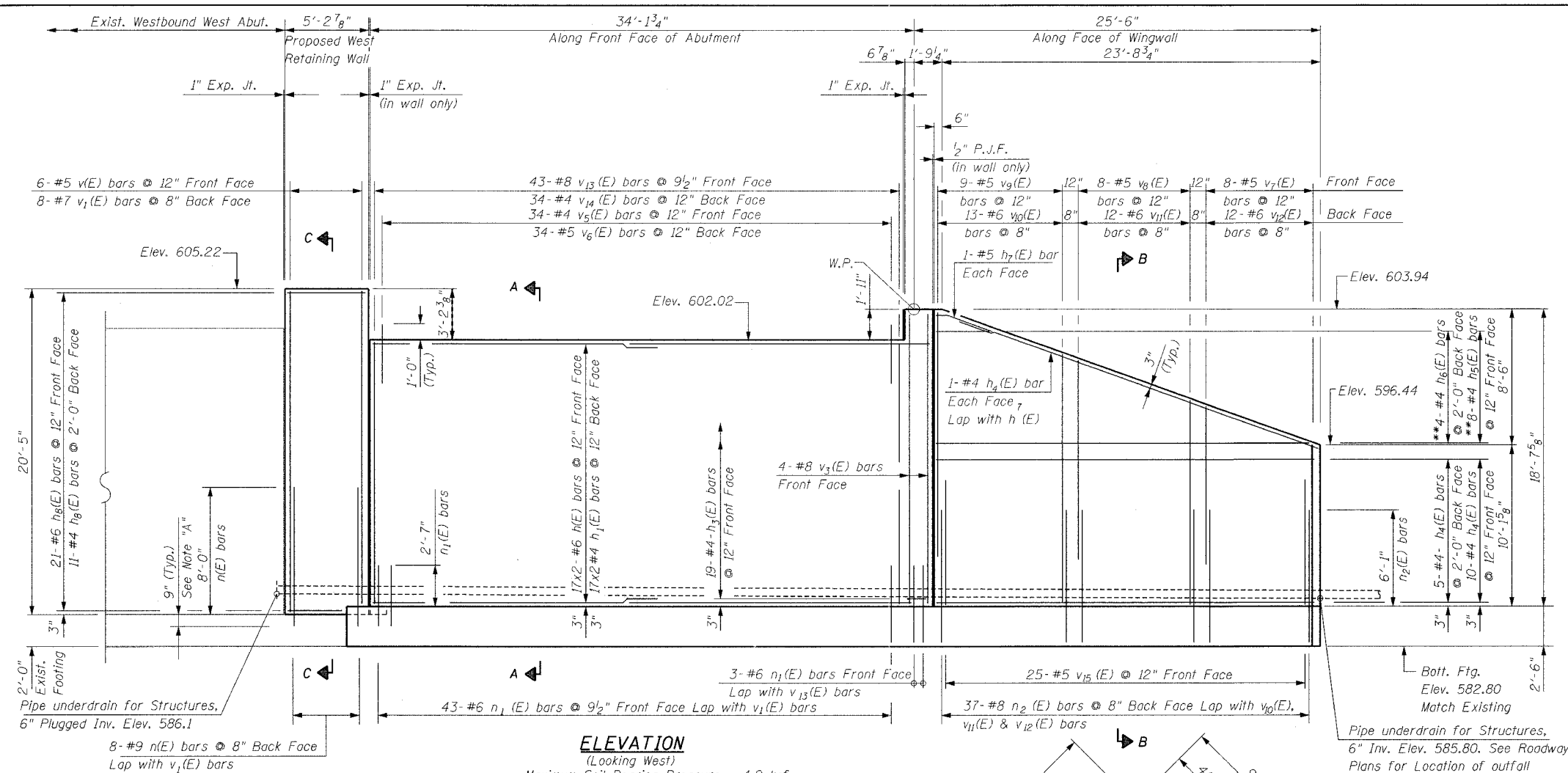

ELEVATION
(Looking West)
Maximum Soil Bearing Pressure = 4.0 ksf

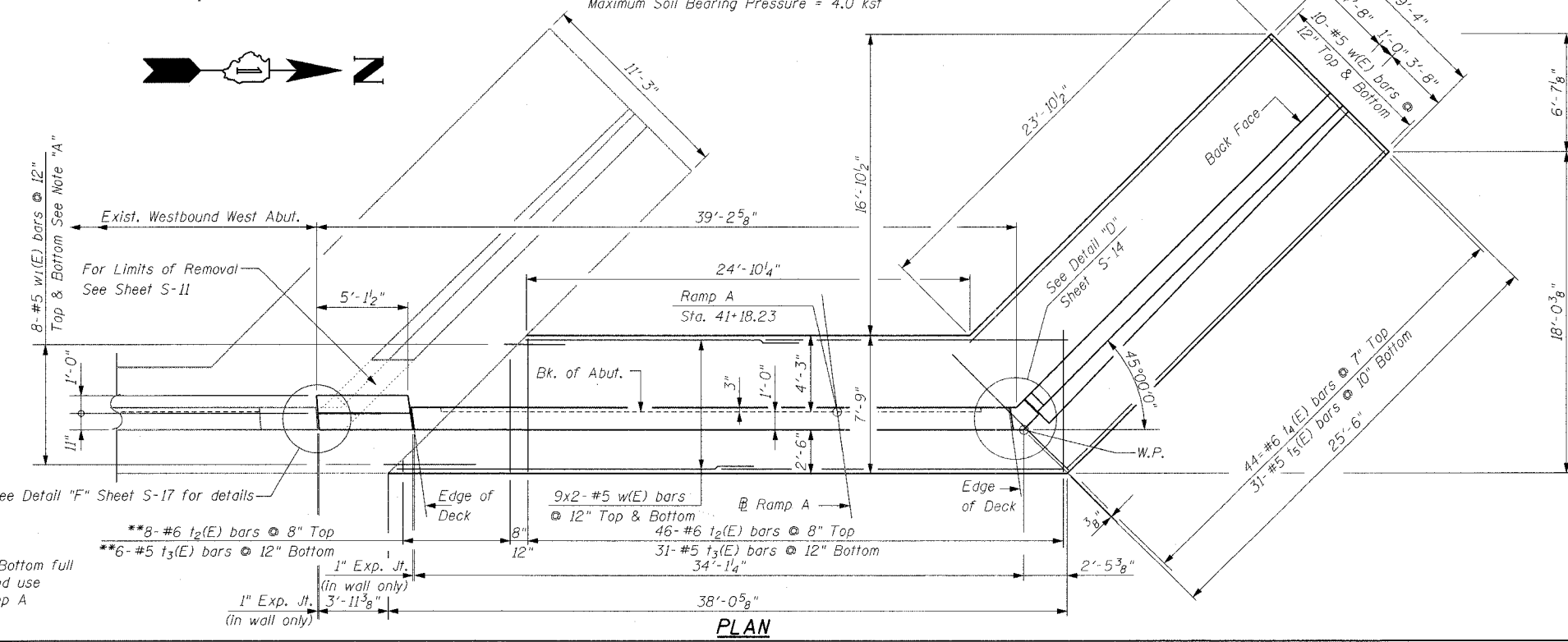

PLAN

Note "A":
Epoxy grout n₁(E) and w(E) bars in 9" minimum drilled holes according to Section 584 of Standard Specifications.



REVISIONS	
NAME	DATE

ILLINOIS DEPARTMENT OF TRANSPORTATION
 RAMP A WEST ABUTMENT
 FAI-80 OVER WEST FRONTAGE ROAD
 FAI-80 SECTION 99-1 (K, BY & AC-B)
 WILL COUNTY
 FAI-80 STA. 1931+99.35
 STRUCTURE NO. 099-0042, 099-0043, 099-0308
 SCALE: NONE
 DATE: OCTOBER 2004
 DRAWN BY: IMG
 CHECKED BY: GDW

DATE: 10/20/06
 FILENAME: n:\proj\2890\2890-02\design\structural\2890-02-s-12-ramp-a-w-abut.dgn

** Order t₂(E) Top & t₃(E) Bottom full length. Cut to fit skew and use remainder of bars in Ramp A East Abutment.

F.A.I. SECTION	COUNTY	TOTAL SHEETS	SHEET NO.
BD 99-1K, BY & AC-B)	COOK	497	312
STA. TO STA.			
FED. ROAD DIST. NO.	ILLINOIS	FED. AID PROJECT	
			CONTRACT 80906

BILL OF MATERIAL

Bar	No.	Size	Length	Shape
h(E)	68	#6	18'-4"	
h ₁ (E)	68	#4	17'-10"	
h ₂ (E)	32	#4	6'-7"	
h ₃ (E)	39	#4	1'-8"	J
h ₄ (E)	34	#4	23'-10"	
h ₅ (E)	8	#5	26'-6"	
h ₆ (E)	4	#5	29'-0"	
h ₇ (E)	4	#4	4'-4"	
h ₈ (E)	32	#4	4'-9"	
n(E)	19	#9	8'-9"	
n ₁ (E)	92	#6	5'-6"	
n ₂ (E)	74	#8	9'-3"	
t ₂ (E)	102	#6	7'-3"	
t ₃ (E)	70	#5	7'-3"	
t ₄ (E)	88	#6	8'-10"	
t ₅ (E)	62	#5	8'-10"	
v(E)	13	#5	20'-3"	
v ₁ (E)	18	#7	20'-3"	
v ₂ (E)	43	#8	17'-11"	
v ₃ (E)	8	#8	18'-5"	
v ₄ (E)	34	#4	16'-9"	
v ₅ (E)	68	#4	2'-0"	
v ₆ (E)	68	#5	3'-9"	
v ₇ (E)	16	#5	9'-11"	
v ₈ (E)	16	#5	12'-9"	
v ₉ (E)	18	#5	15'-7"	
v ₁₀ (E)	26	#6	15'-7"	
v ₁₁ (E)	24	#6	12'-9"	
v ₁₂ (E)	24	#6	9'-11"	
v ₁₃ (E)	43	#8	16'-6"	
v ₁₄ (E)	34	#4	16'-6"	
v ₁₅ (E)	50	#5	5'-0"	
w(E)	72	#5	20'-10"	
w ₁ (E)	32	#5	5'-0"	
w ₂ (E)	40	#5	25'-0"	
Item	Unit	Quantity		
Concrete Structures	Cu. Yd.	179.3		
Reinforcement Bars, Epoxy Coated	Pound	22,840		
Structure Excavation	Cu. Yd.	320		
Pipe Underdrain for Structures, 6"	Lin. Ft.	130		
Geocomposite Wall Drain	Sq. Yd.	267		

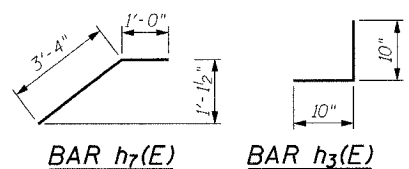

FIELD CUTTING DIAGRAM

**Order h₅(E) & h₆(E) full length. Cut as shown and use remainder of bars in opposite end.

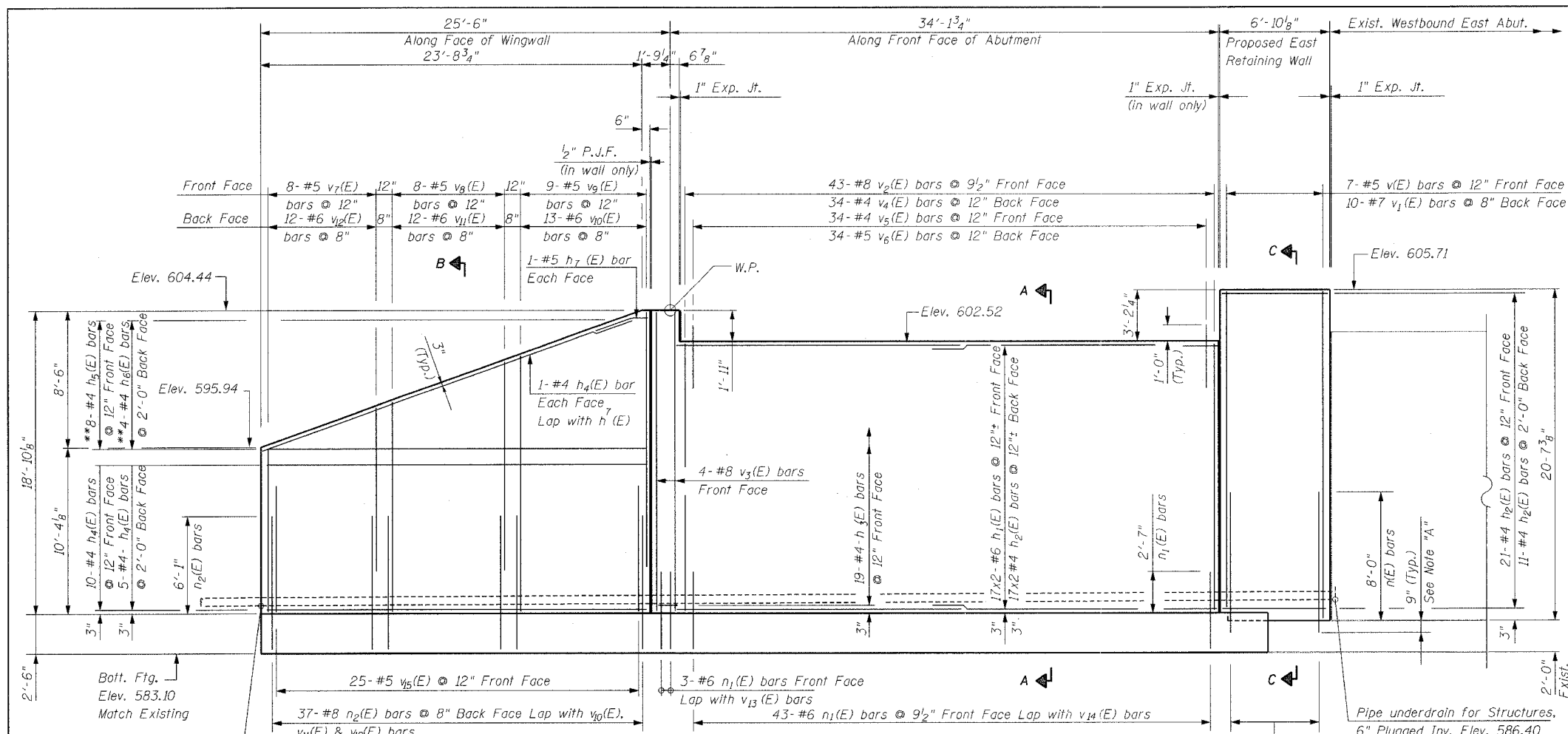

ELEVATION
(Looking East)

Maximum Soil Bearing Pressure = 4.0 ksf

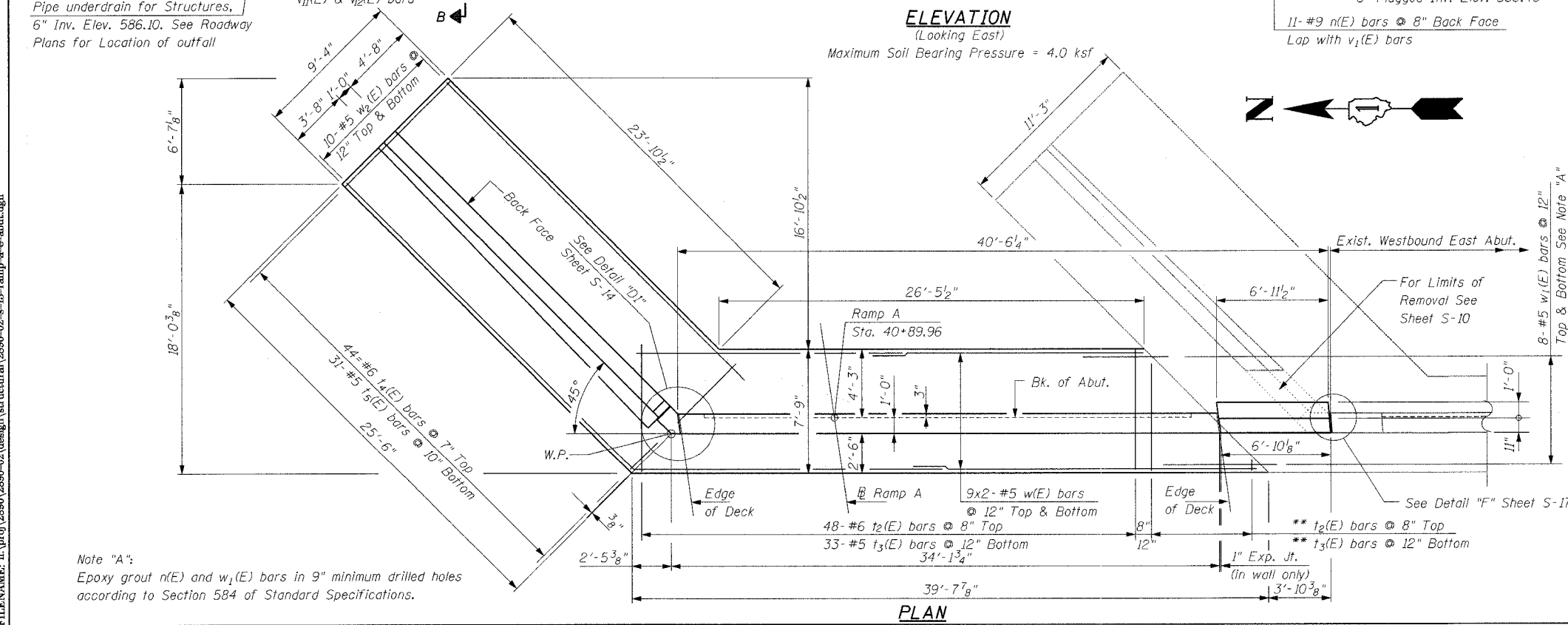

PLAN

Note "A": Epoxy grout n(E) and w₁(E) bars in 9" minimum drilled holes according to Section 584 of Standard Specifications.

** Cut bars from Ramp A West Abutment. See Sheet S-9.

Notes:
See Sheet S-14 for sections & details
Reinforcement bars designated (E) shall be epoxy coated.
Bars indicated thus 20 x 3-#5 etc. indicates 20 lines of bars with 3 lengths per line.
Minimum lap splices 1'-8" for #4 bars, 2'-2" for #5 bars, 2'-7" for #6 and 3'-5" for #7 bars.

REVISIONS	
NAME	DATE

Clorba Group, Inc.
CONSULTING ENGINEERS
5907 NORTH CUMBERLAND AVENUE - CHICAGO, ILLINOIS 60630 - (773) 775-0099

ILLINOIS DEPARTMENT OF TRANSPORTATION
RAMP A EAST ABUTMENT
FAI-80 OVER WEST FRONTAGE ROAD
FAI-80 SECTION 99-1 (K, BY & AC-B)
WILL COUNTY
FAI-80 STA. 1931+99.35
STRUCTURE NO. 099-0042, 099-0043, 099-0308
SCALE: NONE
DATE: OCTOBER 2004
DRAWN BY: IMC
CHECKED BY: GDW

DATE: 10/20/05
FILENAME: n:\proj\2890\2890-02\design\structural\2890-02-s-13-ramp-a-e-abut.dgn

F.A.I. RTE.	SECTION	COUNTY	TOTAL SHEETS	SHEET NO.
80	99-1K, BY & AC-B	COOK	497	313
STA.	TO STA.			
FED. ROAD DIST. NO.	ILLINOIS	FED. AID PROJECT		
Sheet S-14 of S-21			CONTRACT 80906	

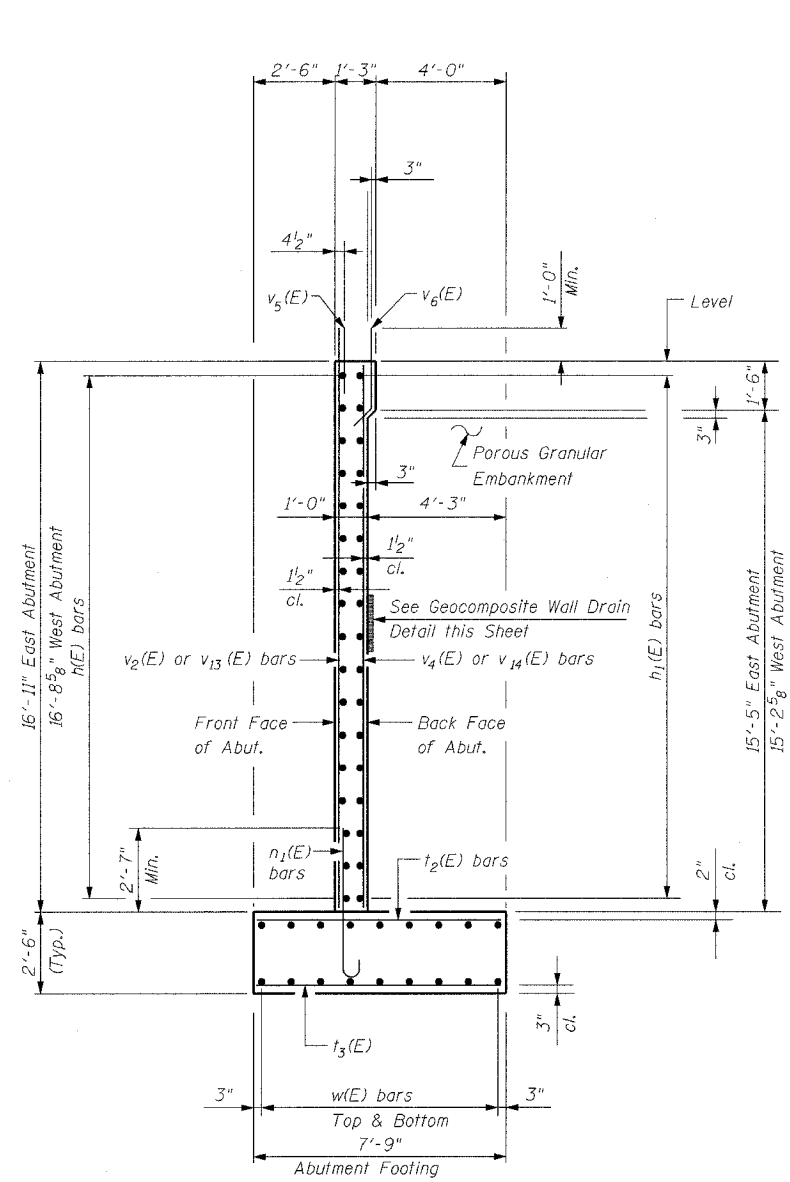

SECTION A-A

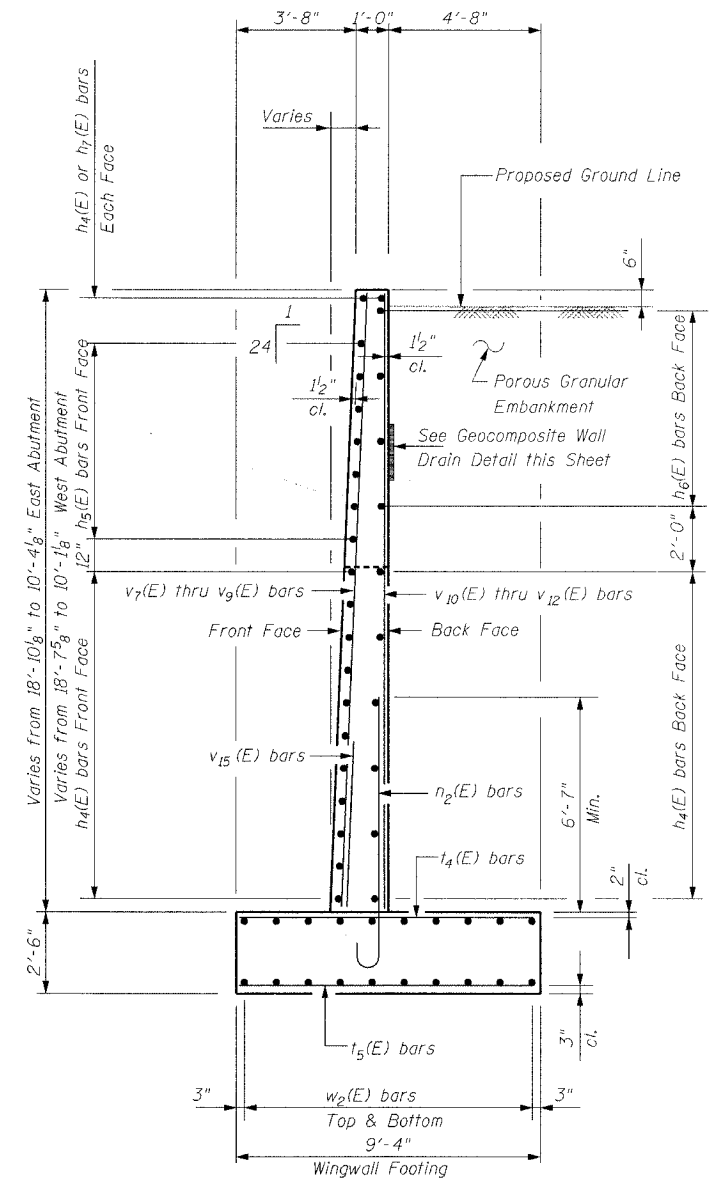

SECTION B-B

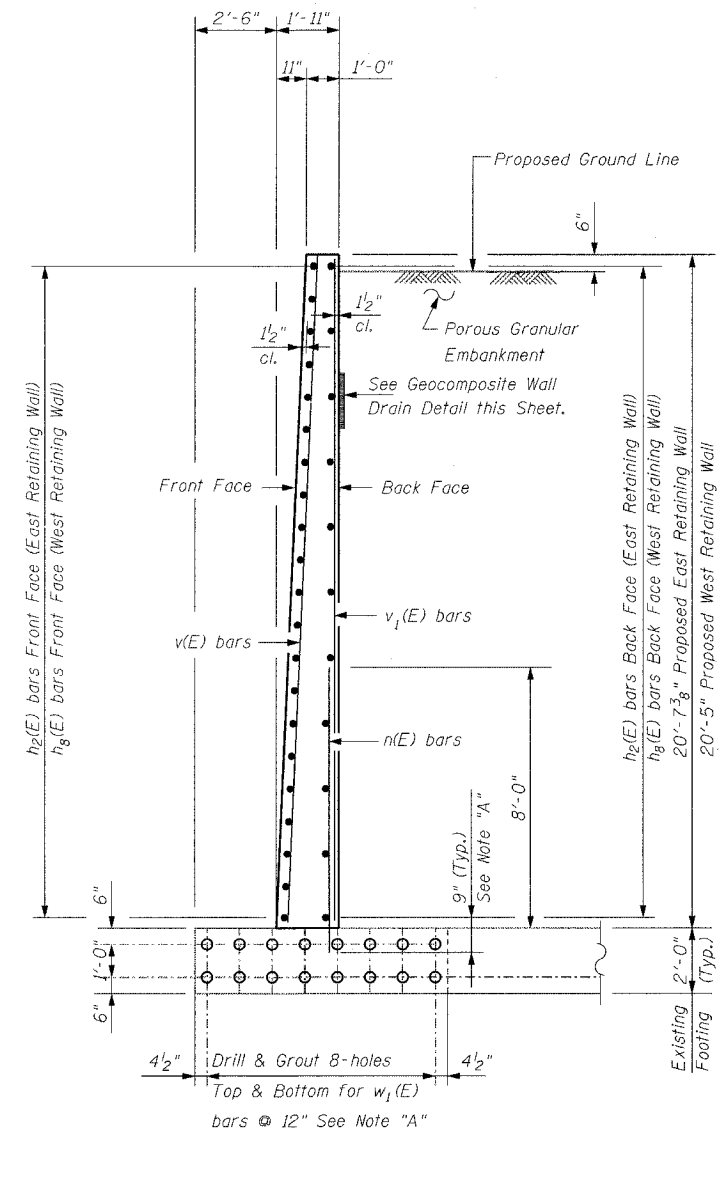

SECTION C-C

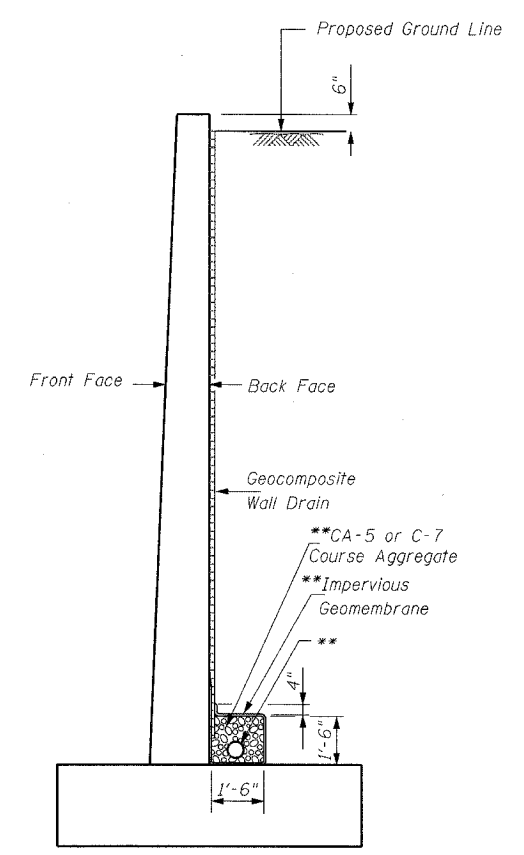

** 6" perforated drain pipe encased in 18" of CA-5 or CA-7 course aggregate. Cost of course aggregate, geotechnical fabric, impervious geomembrane included in the cost of "Pipe Underdrains for Structures 6" ". See Special Provisions

GEOCOMPOSITE DRAIN DETAIL

Note "A": Epoxy grout n(E) and w1(E) bars in 9" minimum drilled holes according to Section 584 of Standard Specifications.

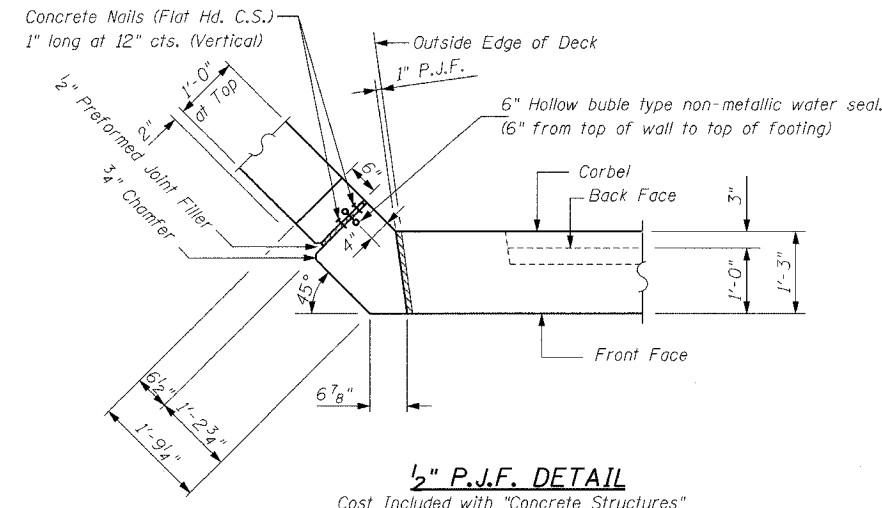

1/2" P.J.F. DETAIL
Cast Included with "Concrete Structures" East Abutment Shown, West Abutment Similar Except as Shown in West Abutment Corner Detail.

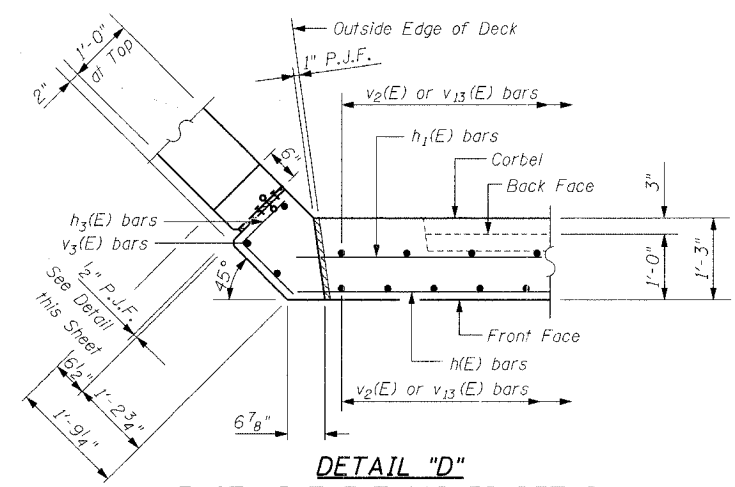

DETAIL "D" EAST ABUTMENT CORNER DETAIL
East Abutment Shown, West Abutment Similar Except as Shown in West Abutment Corner Detail.

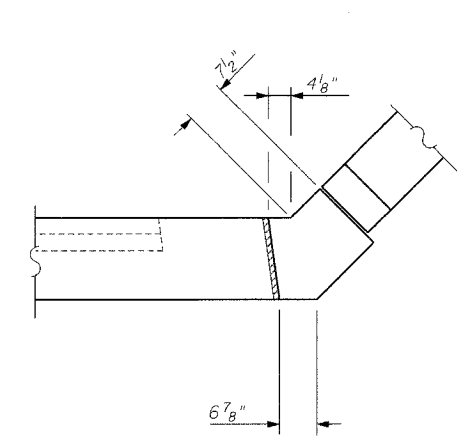

DETAIL "DI" WEST ABUTMENT CORNER DETAIL
West Abutment Shown

REVISIONS	
NAME	DATE

Clorba Group, Inc.
CONSULTING ENGINEERS
2007 NORTH CUMBERLAND AVENUE - CHICAGO, ILLINOIS 60608 - (773) 775-4009

ILLINOIS DEPARTMENT OF TRANSPORTATION
RAMP A ABUTMENTS SECTIONS & DETAILS
FAI-80 OVER WEST FRONTAGE ROAD
FAI-80 SECTION 99-1 (K, BY & AC-B)
WILL COUNTY
FAI-80 STA. 1931+99.35
STRUCTURE NO. 099-0042, 099-0043, 099-0308
SCALE: NONE DRAWN BY IMG
DATE: OCTOBER 2004 CHECKED BY GDW

DATE: 10/20/05
FILENAME: n:\proj\2890-02\design\structural\2890-02-s-14-ramp-a-abutdetails.dgn

F.A.I. RTE.	SECTION	COUNTY	TOTAL SHEETS	SHEET NO.
80	99-10K, BY&AC-B)	COOK	497	314
STA.		TO STA.		
FED. ROAD DIST. NO.		ILLINOIS	FED. AID PROJECT	
Sheet S-15 of S-21		CONTRACT 80906		

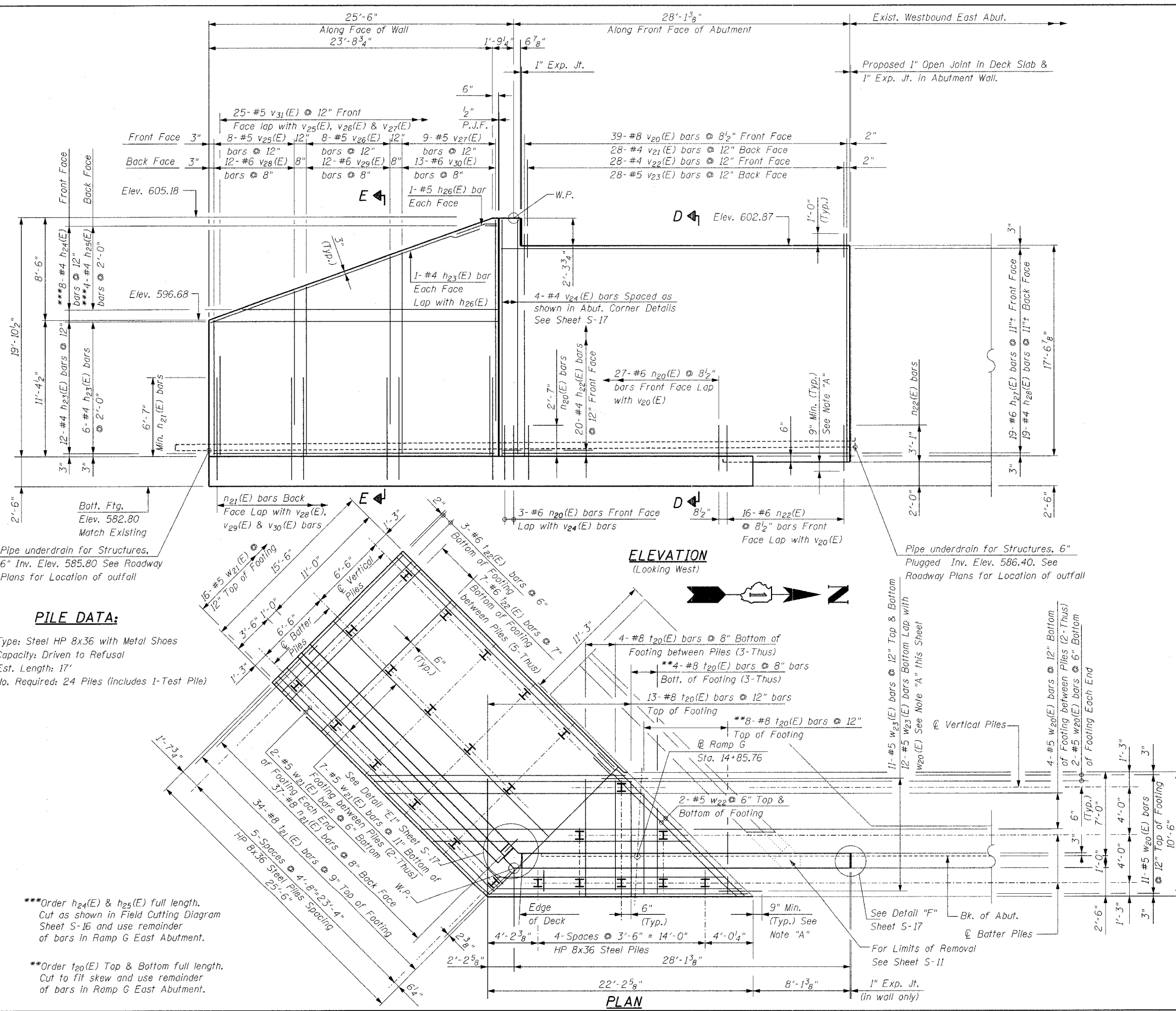

Pipe underdrain for Structures, 6" Inv. Elev. 585.80 See Roadway Plans for Location of outfall

PILE DATA:
 Type: Steel HP 8x36 with Metal Shoes
 Capacity: Driven to Refusal
 Est. Length: 17'
 No. Required: 24 Piles (includes 1-Test Pile)

***Order h24(E) & h25(E) full length. Cut as shown in Field Cutting Diagram Sheet S-16 and use remainder of bars in Ramp G East Abutment.
 ***Order t20(E) Top & Bottom full length. Cut to fit skew and use remainder of bars in Ramp G East Abutment.

Note "A":
 Epoxy grout n22(E) and w23(E) bars in 9" minimum drilled holes according to Section 584 of Standard Specifications.

Notes:
 See Sheet S-17 for sections & details
 Reinforcement bars designated (E) shall be epoxy coated.
 Bars indicated thus 2 x 2-#5 etc. indicates 2 lines of bars with 2 lengths per line.
 Minimum lap splices 1'-8" for #4 bars, 2'-2" for #5 bars, 2'-7" for #6 bars.

REVISIONS	
NAME	DATE

Ciorba Group, Inc.
 CONSULTING ENGINEERS
 2047 NORTH CUMBERLAND AVENUE - CHICAGO, ILLINOIS 60641 - (773) 778-4200

ILLINOIS DEPARTMENT OF TRANSPORTATION
 RAMP G WEST ABUTMENT
 FAI-80 OVER WEST FRONTAGE ROAD
 FAI-80 SECTION 99-1 (K, BY & AC-B)
 WILL COUNTY
 FAI-80 STA. 1931+99.35
 STRUCTURE NO. 099-0042, 099-0043, 099-0308
 SCALE: NONE
 DATE: OCTOBER 2004
 DRAWN BY IMG
 CHECKED BY GDW

DATE: 10/20/05 FILENAME: n:\proj\2890\2890-02\design\structural\2890-02-g-15-ramp-g-w-abut.dgn

DATE: 12/20/05
 FILENAME: N:\PROJ\2890\2890-02\Design\Structural\2890-02-S-16-Ramp-G-E-Abut.dgn

F.A.I. SECTION	COUNTY	TOTAL SHEETS	SHEET NO.
80 99-10K, BY & AC-B	COOK	497	315
STA. TO STA.			
FED. ROAD DIST. NO. ILLINOIS FED. AID PROJECT			
Sheet S-16 of S-21 CONTRACT 80906			

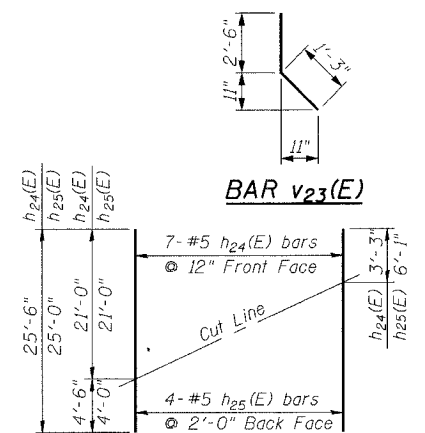
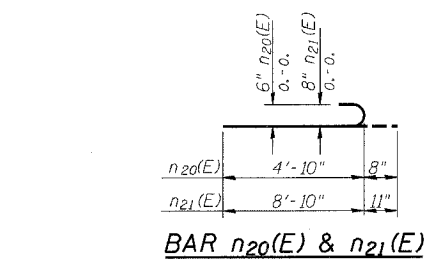
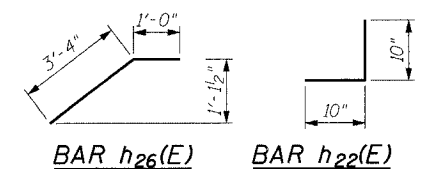
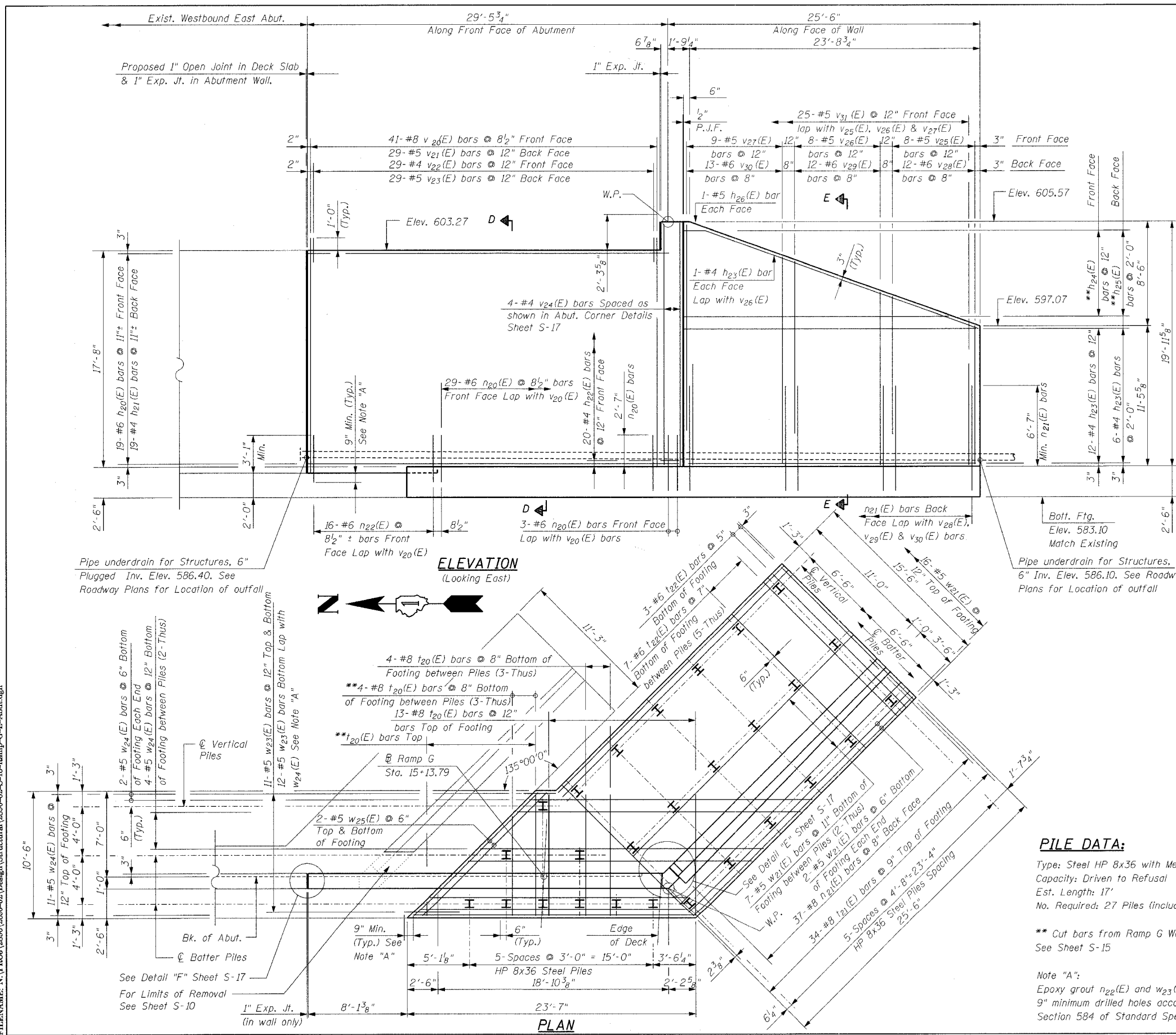

FIELD CUTTING DIAGRAM
 Order h24(E) & h25(E) full length.
 Cut as shown and use remainder of bars in Ramp G West Abutment.

Notes:
 See Sheet S-17 for sections & details
 Reinforcement bars designated (E) shall be epoxy coated.
 Bars indicated thus 2 x 2-#5 etc. indicates 2 lines of bars with 2 lengths per line.
 Minimum lap splices 1'-8\"/>

PILE DATA:
 Type: Steel HP 8x36 with Metal Shoes.
 Capacity: Driven to Refusal
 Est. Length: 17'
 No. Required: 27 Piles (includes 1-Test Pile)

** Cut bars from Ramp G West Abutment. See Sheet S-15

Note "A":
 Epoxy grout n22(E) and w23(E) bars in 9\"/>

BILL OF MATERIAL

Bar	No.	Size	Length	Shape
h20(E)	19	#6	29'-0"	
h21(E)	19	#4	29'-0"	
h22(E)	40	#4	1'-8"	J
h23(E)	40	#4	23'-10"	
h24(E)	7	#4	25'-6"	
h25(E)	4	#4	25'-0"	
h26(E)	4	#4	4'-4"	
h27(E)	19	#6	27'-7"	
h28(E)	19	#4	27'-7"	
n20(E)	62	#6	5'-6"	
n21(E)	70	#8	9'-9"	
n22(E)	32	#6	3'-10"	
v20(E)	74	#8	10'-0"	
v21(E)	68	#8	15'-0"	
v22(E)	76	#6	15'-0"	
v23(E)	80	#8	18'-8"	
v24(E)	57	#4	17'-4"	
v25(E)	57	#4	2'-0"	
v26(E)	57	#5	3'-9"	
v27(E)	8	#4	19'-8"	
v28(E)	16	#5	11'-1"	
v29(E)	16	#5	13'-11"	
v30(E)	24	#6	16'-9"	
v31(E)	24	#6	13'-11"	
w20(E)	23	#5	21'-10"	
w21(E)	68	#5	25'-0"	
w22(E)	4	#5	18'-0"	
w23(E)	46	#5	5'-0"	
w24(E)	23	#5	22'-10"	
w25(E)	4	#5	14'-3"	
Item Unit Quantity				
Concrete Structures	Cu. Yd.	171.8		
Reinforcement Bars, Epoxy Coated	Pound	23,640		
Furnishing Steel Piles HP8x36	Lin. Ft.	833		
Driving Steel Piles HP8x36	Lin. Ft.	833		
Test Piles Steel HP8x36	Lin. Ft.	2		
Metal Shoes	Each	49		
Structure Excavation	Cu. Yd.	320		
Pipe Underdrain for Structures, 6"	Lin. Ft.	110		
Geocomposite Wall Drain	Sq. Yd.	227		

REVISIONS	
NAME	DATE

Clorba Group, Inc.
 CONSULTING ENGINEERS
 307 NORTH COLUMBIAN AVENUE - CHICAGO, ILLINOIS 60664 - (773) 776-8000

ILLINOIS DEPARTMENT OF TRANSPORTATION
 RAMP G EAST ABUTMENT
 FAI-80 OVER WEST FRONTAGE ROAD
 FAI-80 SECTION 99-1 (K, BY & AC-B)
 WILL COUNTY
 FAI-80 STA. 1931+99.35
 STRUCTURE NO. 099-0042, 099-0043, 099-0308
 SCALE: NONE DRAWN BY IMG
 DATE: OCTOBER 2004 CHECKED BY GDW

F.A.I. RTE.	SECTION	COUNTY	TOTAL SHEETS	SHEET NO.
80	99-1(K, BY & AC-B)	COOK	497	316
STA.	TO STA.			
FED. ROAD DIST. NO.	ILLINOIS	FED. AID PROJECT		
Sheet S-17 of S-21				CONTRACT 80906

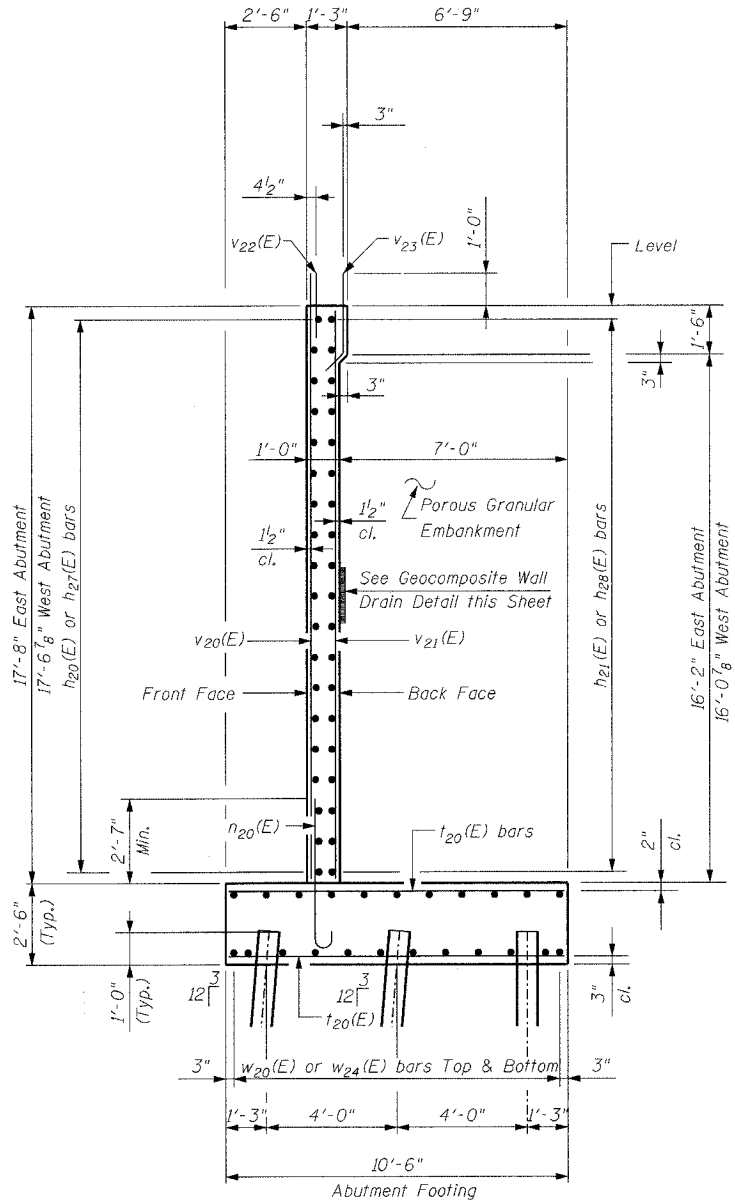

SECTION D-D

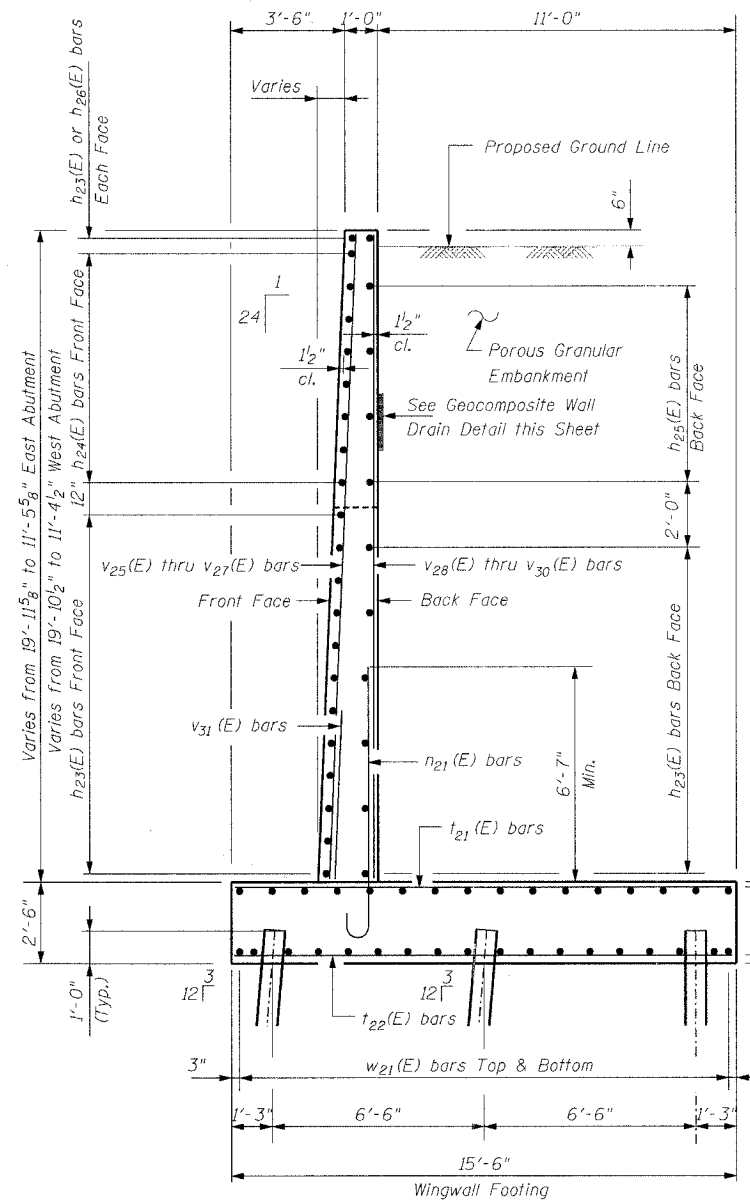

SECTION E-E

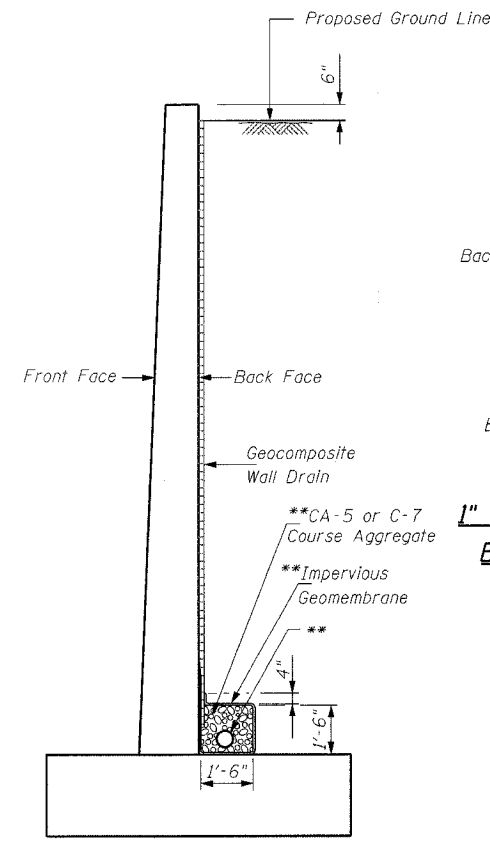

GEOCOMPOSITE DRAIN DETAIL

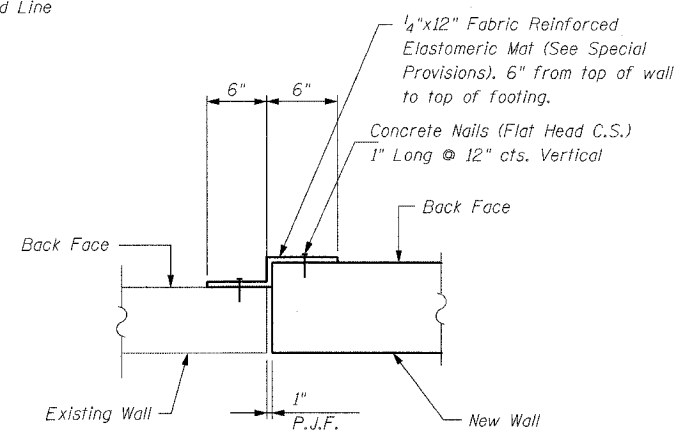

DETAIL "F"
1" EXPANSION JOINT DETAIL BETWEEN EXISTING & NEW ABUTMENT WALL (RAMPS A & G)

Cost of Fabric Reinforced Elastomeric Mat, Concrete Nails and Preformed Joint Filler included in "Concrete Structures"

** 6" perforated drain pipe encased in 18" of CA-5 or CA-7 course aggregate. Cost of course aggregate, geotechnical fabric, impervious geomembrane included in the cost of "Pipe Underdrains for Structures 6". See Special Provisions

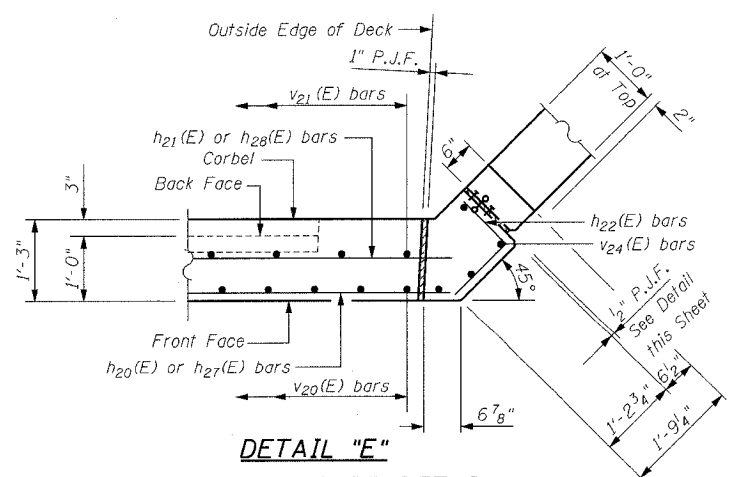

DETAIL "E"
ABUTMENT CORNER DETAIL
East Abutment Shown, West Abutment Similar
Except as Shown in West Abutment Corner Detail.

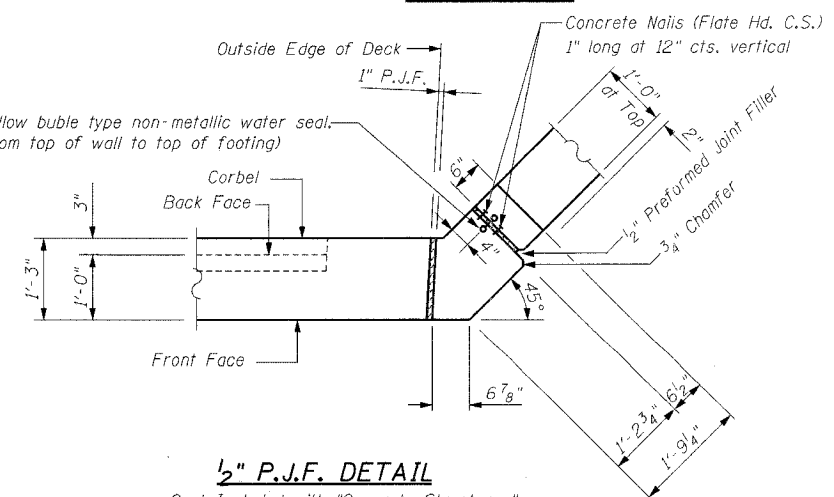

1/2" P.J.F. DETAIL
Cost Included with "Concrete Structures"
East Abutment Shown, West Abutment Similar
Except as Shown in West Abutment Corner Detail.

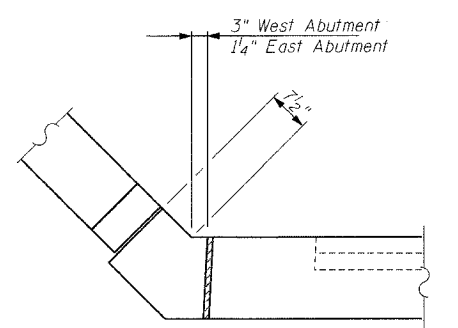

DETAIL "E1"
WEST ABUTMENT CORNER DETAIL
West Abutment Shown

REVISIONS	
NAME	DATE

Clorba Group, Inc.
CONSULTING ENGINEERS
507 NORTH CUMBERLAND AVENUE - CHICAGO, ILLINOIS 60660 - (773) 735-4200

ILLINOIS DEPARTMENT OF TRANSPORTATION
RAMP G ABUTMENTS SECTIONS & DETAILS
FAI-80 OVER WEST FRONTAGE ROAD
FAI-80 SECTION 99-1 (K, BY & AC-B)
WILL COUNTY
FAI-80 STA. 1931+99.35
STRUCTURE NO. 099-0042, 099-0043, 099-0308
SCALE: NONE
DATE: OCTOBER 2004

DRAWN BY IMG
CHECKED BY GDW

DATE: 10/20/05
FILENAME: n:\proj\2890\2890-02\design\structural\2890-02-17-ramp-g-abutdetails.dgn

F.A.I. RTE.	SECTION	COUNTY	TOTAL SHEETS	SHEET NO.
80	99-1(K,BY&AC-B)	COOK	497	317
STA.	TO STA.			
FED. ROAD DIST. NO.	ILLINOIS	FED. AID PROJECT		
Sheet S-18 of S-21			CONTRACT 80906	

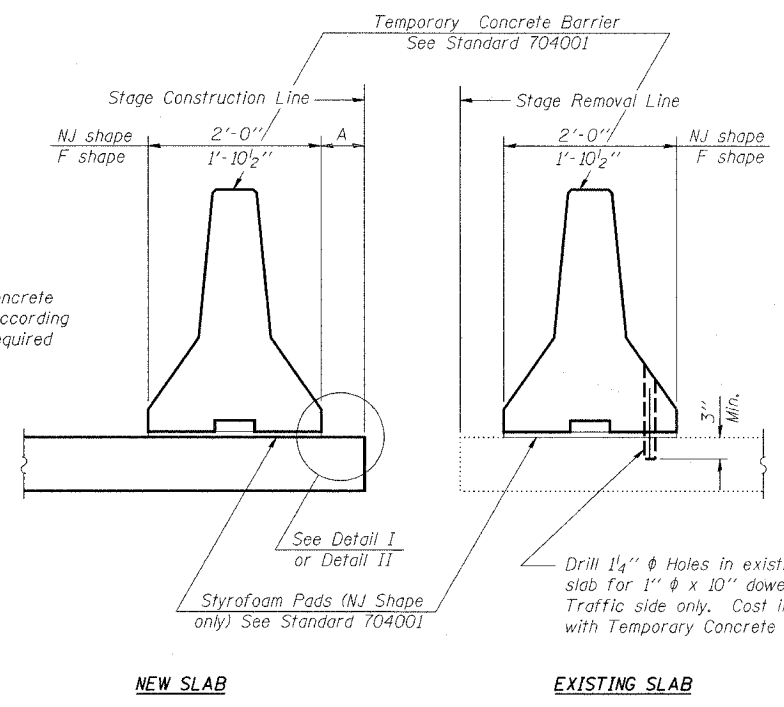

When "A" is 3'-6" or less, the temporary concrete barrier shall be Anchored to the new slab according to Detail I or Detail II. No anchorage is required when "A" is greater than 3'-6".

NOTES

Detail I - With Bar Splicer or Couplers:
Connect one (1) 1"x7"x10" steel \bar{E} to the top layer of couplers with 2-5/8" ϕ bolts screwed to coupler at approximate \bar{C} of each barrier panel.

Detail II - With Extended Reinforcement Bars:
Connect one (1) 1"x7"x10" steel \bar{E} to the concrete slab with 2-5/8" ϕ Expansion Anchors or cast in place inserts spaced between the top layer of reinforcement at approximate \bar{C} of each barrier panel.

Cost of anchorage is included with Temporary Concrete Barrier.

SECTIONS THRU SLAB

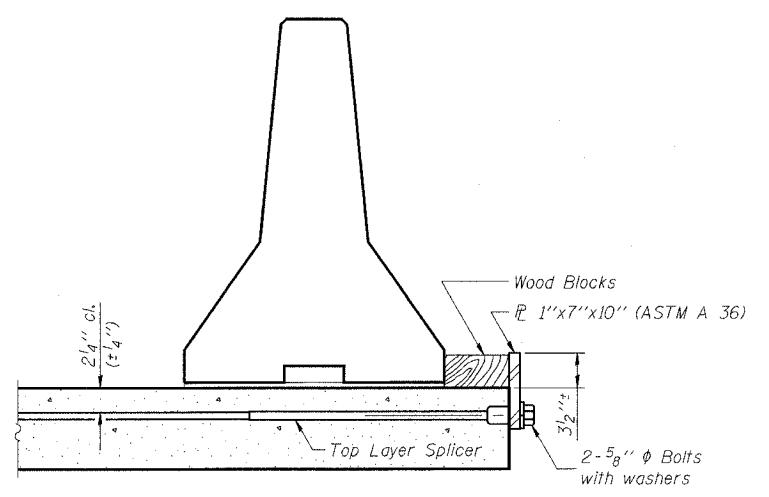

DETAIL I

The 1"x7"x10" Plate shall not be removed until Stage II Construction forms and reinforcement bars are in place.

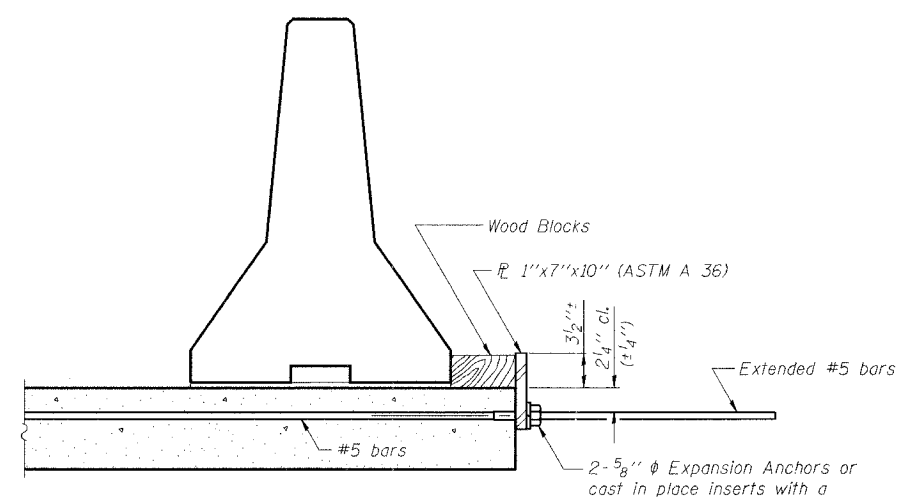

DETAIL II

The 1"x7"x10" Plate shall not be removed until Stage II Construction forms and all reinforcement bars are in place and the concrete is ready to be placed.

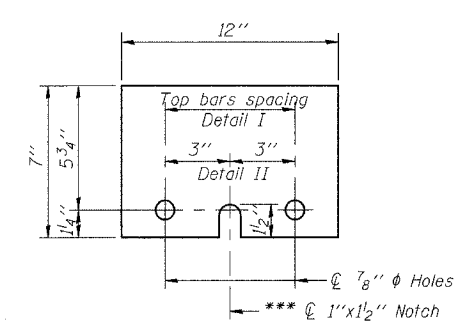

1"x7"x12"

*** Required only with Detail II

TEMPORARY CONCRETE BARRIER FOR STAGE CONSTRUCTION



REVISIONS	
NAME	DATE

ILLINOIS DEPARTMENT OF TRANSPORTATION
 TEMPORARY CONCRETE BARRIER
 FAI-80 OVER WEST FRONTAGE ROAD
 FAI-80 SECTION 99-1 (K,BY & AC-B)
 WILL COUNTY
 FAI-80 STA. 1931+99.35
 STRUCTURE NO. 099-0042, 099-0043, 099-0308
 SCALE: NONE DRAWN BY IMG
 DATE: OCTOBER 2004 CHECKED BY GDW

DATE: 10/20/05 FILENAME: n:\proj\2890\2890-02\design\structural\2890-02-s-18-tempconcretebarrier.dgn

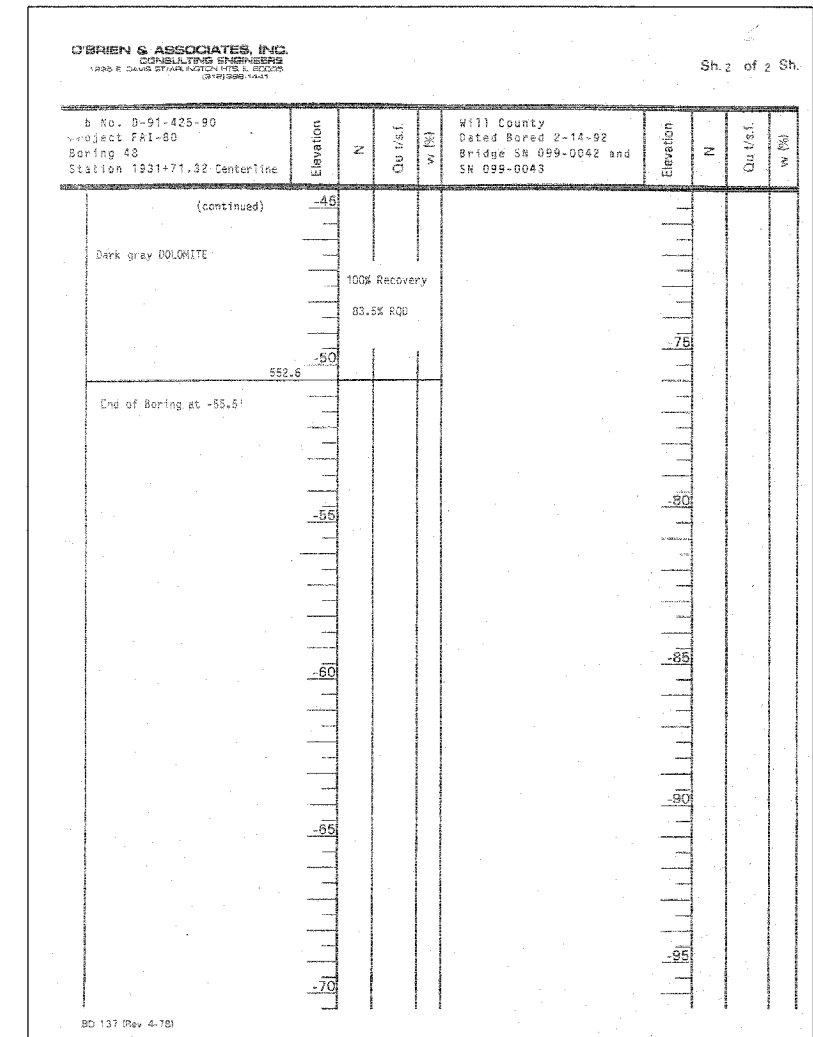
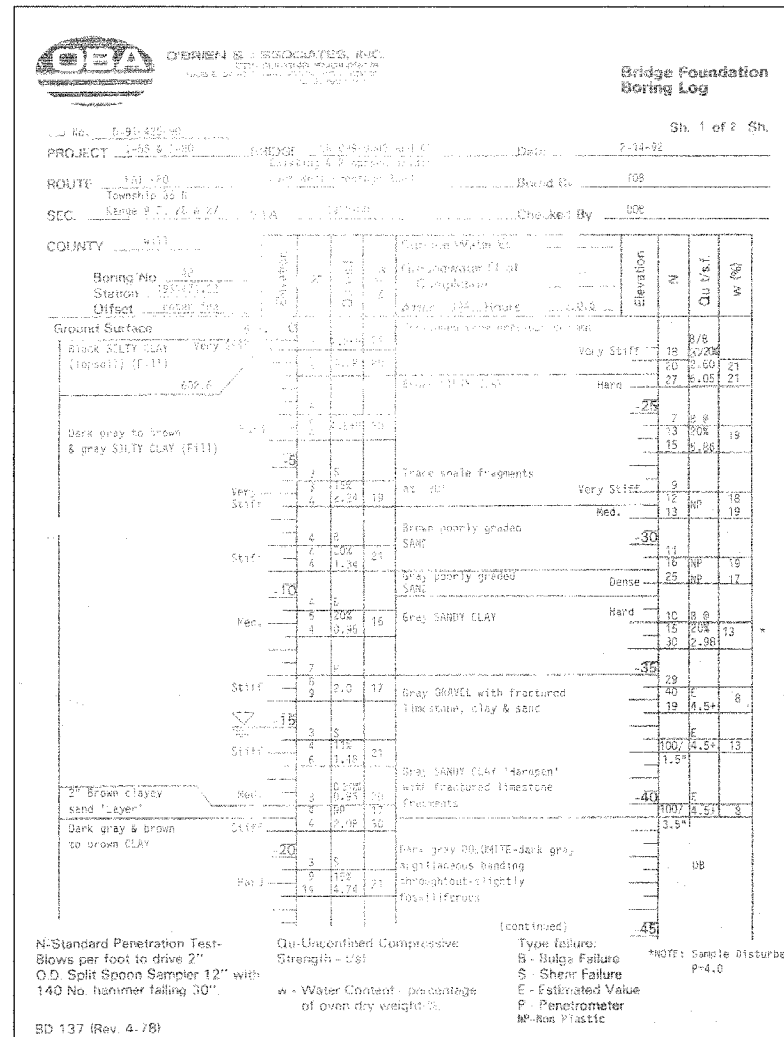
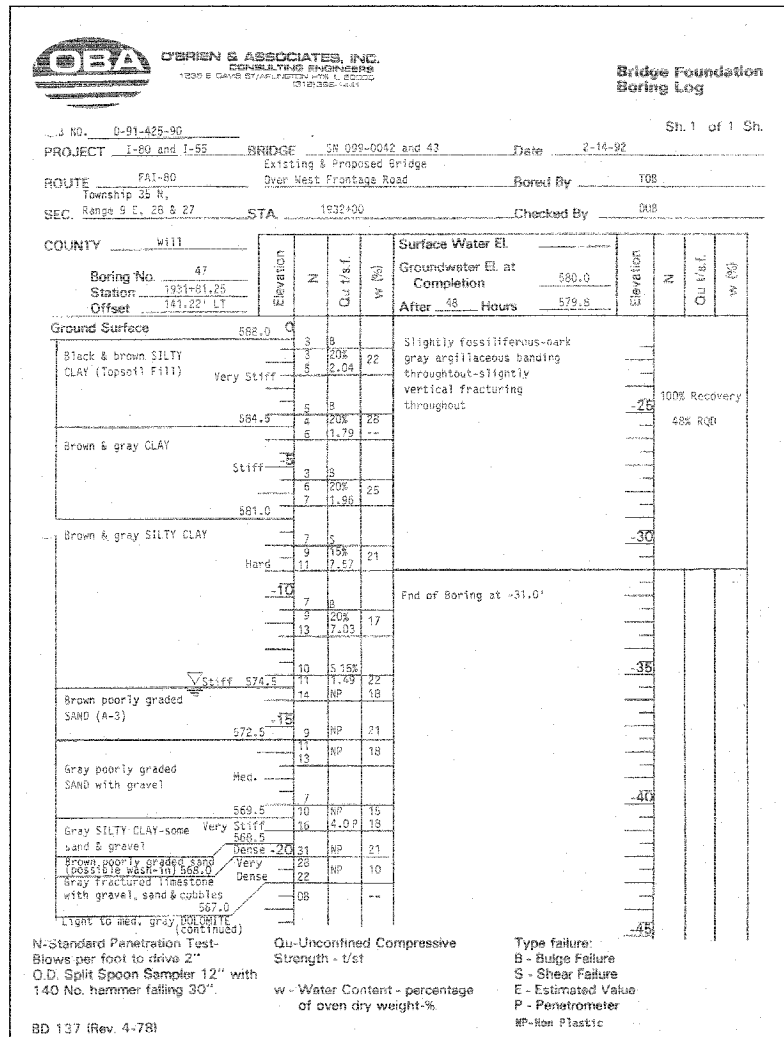

DATE: 12/2005
 FILENAME: n:\proj\2890\2890-02\design\structural\2890-02-e-20-borings2.dgn

REVISIONS	
NAME	DATE

Clorba Group, Inc.
 CONSULTING ENGINEERS
 3007 NORTH CUMBERLAND AVENUE - CHICAGO, ILLINOIS 60664 - (773) 778-4909

ILLINOIS DEPARTMENT OF TRANSPORTATION
 SOIL BORINGS 2
 FAI-80 OVER WEST FRONTAGE ROAD
 FAI-80 SECTION 99-1 (K, BY & AC-B)
 WILL COUNTY
 FAI-80 STA. 1931+99.35
 STRUCTURE NO. 099-0042, 099-0043, 099-0308
 SCALE: NONE DRAWN BY BWS
 DATE: OCTOBER 2004 CHECKED BY GDW

F.A.I. RTE.	SECTION	COUNTY	TOTAL SHEETS	SHEET NO.
80	99-1(K,BY&AC-B)	COOK	497	320
STA.		TO STA.		
FED. ROAD DIST. NO.		ILLINOIS	FED. AID PROJECT	
Sheet S-21 of S-21			CONTRACT 80906	

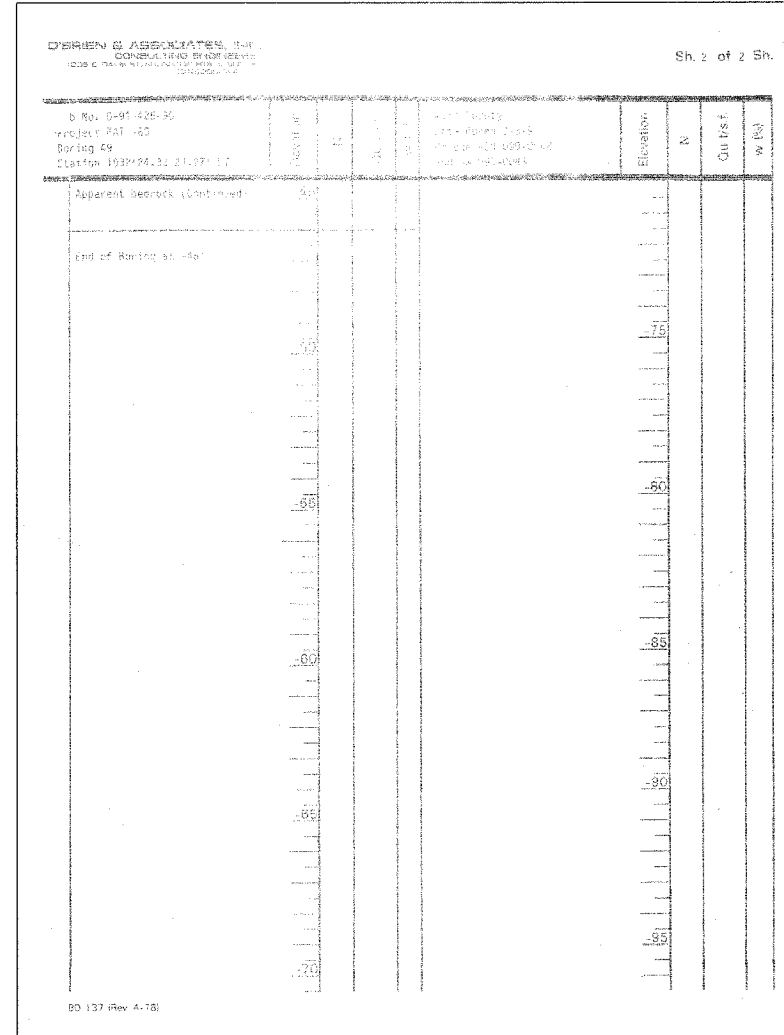
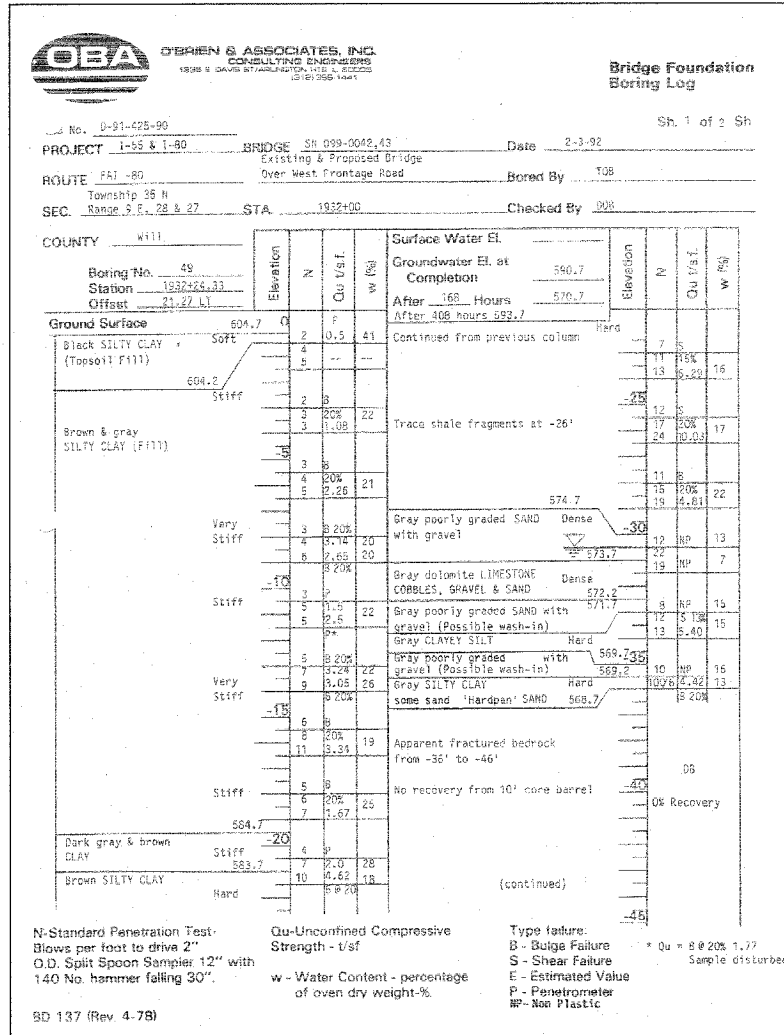

DATE: 12/20/05 FILENAME: n:\proj\2890\2890-02\design\structural\2890-02-s-21-borings.dgn

REVISIONS	
NAME	DATE

Ciorba Group, Inc.
 CONSULTING ENGINEERS
 2001 NORTH CUMBERLAND AVENUE - CHICAGO, ILLINOIS 60664 - (773) 772-4800

ILLINOIS DEPARTMENT OF TRANSPORTATION
 SOIL BORINGS 3
 FAI-80 OVER WEST FRONTAGE ROAD
 FAI-80 SECTION 99-1 (K,BY & AC-B)
 WILL COUNTY
 FAI-80 STA. 1931+99.35
 STRUCTURE NO. 099-0042, 099-0043, 099-0308
 SCALE: NONE DRAWN BY BWS
 DATE: OCTOBER 2004 CHECKED BY GDW