

**STATE OF ILLINOIS
DEPARTMENT OF TRANSPORTATION
DIVISION OF HIGHWAYS
PLANS FOR PROPOSED
FEDERAL AID INTERSTATE HIGHWAY**

FOR INDEX OF SHEETS
SEE SHEET NO. 4.

F.A.I. ROUTE 80
SECTION 99 - 1B - BR-79
PROJECT I-IR-80-4(140)123
WILL COUNTY

C-91-115-79

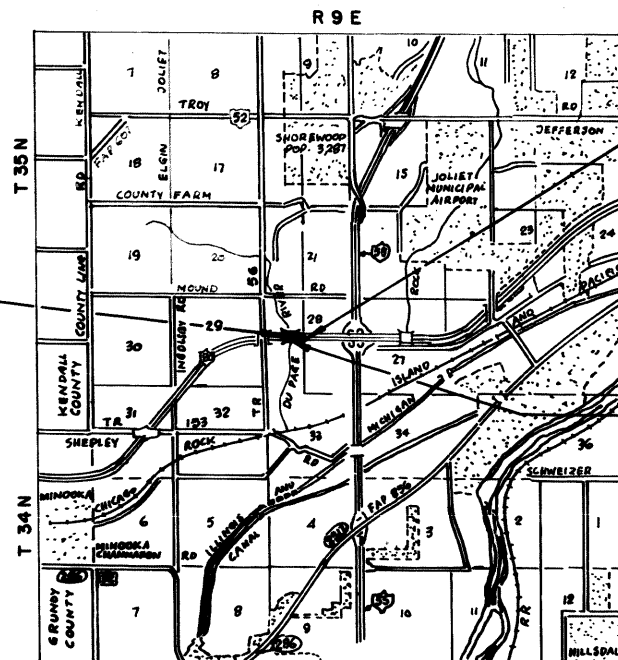

LAYOUT
SCALE 1"=1 MILE

NET LENGTH OF PROJECT = 332.75 LIN. FT. OR 0.63 MILES

F. A. I. ROUTE NO.	SEC.	COUNTY	TOTAL SHEETS	SHEET NO.
80	*	WILL		1
ILLINOIS PROJECT I-IR-80-4(140)123 *99-1B-BR-79				
P-91-079-78				

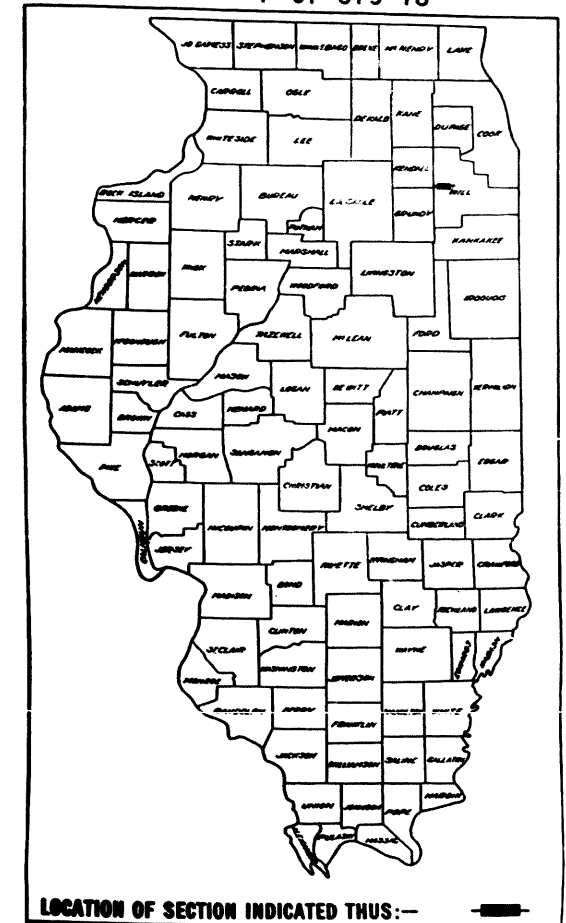

PROJECT I-IR-80-4(140)123
ENDS STA. 1912+74.42

PROJECT I-IR-80-4(140)123
BEGINS STA. 1909+41.67

SECTION 99-1B-BR-79 INCLUDES WIDENING THE EXISTING TWO (2) PARALLEL 5 SPAN PRECAST REINFORCED CONCRETE I-BEAM GIRDER STRUCTURES (CARRYING F.A.I. ROUTE 80 OVER THE DU PAGE RIVER) ON REINFORCED CONCRETE PIERS AND PILE BENT ABUTMENTS. IT INCLUDES THE REMOVAL OF THE EXISTING DECK AND CONSTRUCTION OF A NEW DECK, SPANS 2@57'-0 1/2", 3@58'-0" AT STATION 1911+08.05.

STATE OF ILLINOIS
DEPARTMENT OF TRANSPORTATION
DIVISION OF HIGHWAYS

SUBMITTED June 30 1980

EXAMINED Oct 1 1980

PASSED Oct 1 1980

APPROVED Oct 1 1980

Sigmund C. Zajacki
DISTRICT ENGINEER
W. Wilson
ENGINEER OF PLANS AND CONTRACTS
Thomas B. Bryant
ENGINEER OF DESIGN
John Thompson
DIRECTOR OF HIGHWAYS

U.S. DEPARTMENT OF TRANSPORTATION
FEDERAL HIGHWAY ADMINISTRATION

APPROVED _____

DIVISION ADMINISTRATOR DATE

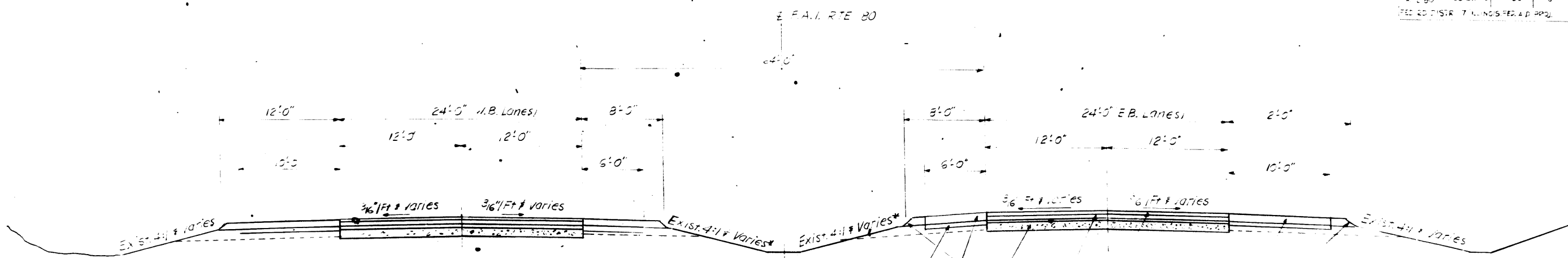

* 10:1 - SEE STANDARD 2339

- EXIST. Bit. Shoulders
 - 4" on 6" Aggregate Base
 - Shoulders (See Detail)
 - Existing PCC Pavement
 - Prop. Bit. Conc. Binder Cse 3" 2 Lifts
 - & additional Binder for Crown Correction
 - Prop. Bit. Conc. Surf. Cse Mix E, Class I 12"
 - Prop. Aggregate Shoulders Type A
- Items apply to both EB & WB Lanes

F.A.I. RTE 80 MAIN LINE
All existing Tangent Sections

Decrease Shoulder Thickness
1 1/2" from E.O.B. to Outer Edge
of Shoulder

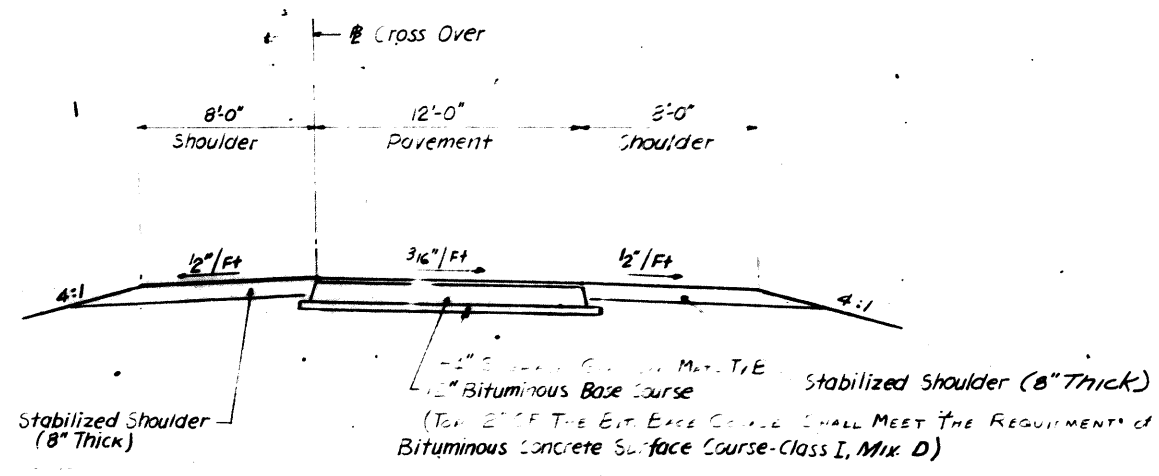

TEMPORARY CROSS OVER

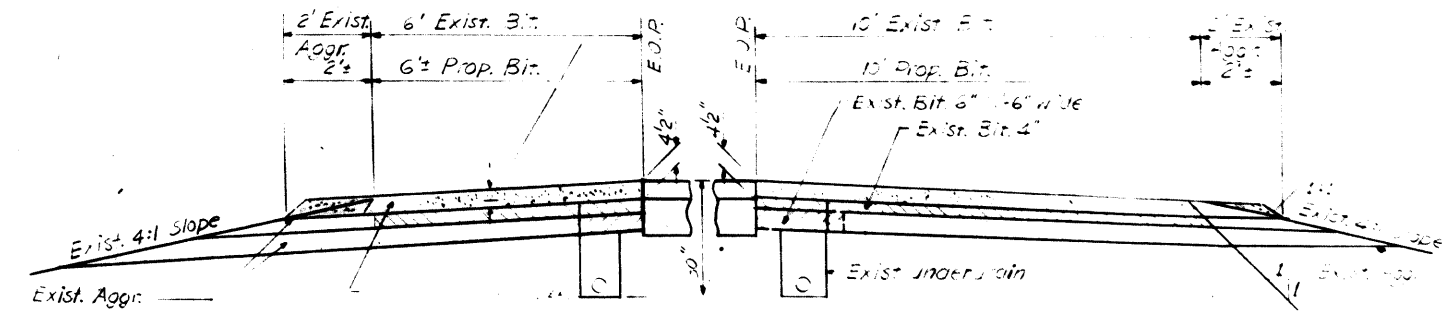

Items apply to both outside and median shoulder

MEDIAN SHOULDER

OUTSIDE SHOULDER

F.A.I. RTE 80 SHOULDER
(All existing Tangent Sections)

STATE OF ILLINOIS
DEPARTMENT OF TRANSPORTATION
F.A.I. ROUTE 80 DU PAGE RIVER
TYPICAL SECTIONS
SECTION 99-18-BR-79
WILL COUNTY
STATION 1911+03.33
P. XANTHAKOS LTD
CHICAGO, ILLINOIS

ROUTE NO.	SECTION	COUNTY	TOTAL SHEETS	SHEET NO.
RTE 80	99-18-BR-79	WILL	8	5
FED. RD. DIST. 71 ILL. UNIFORMED AID PROJ.				

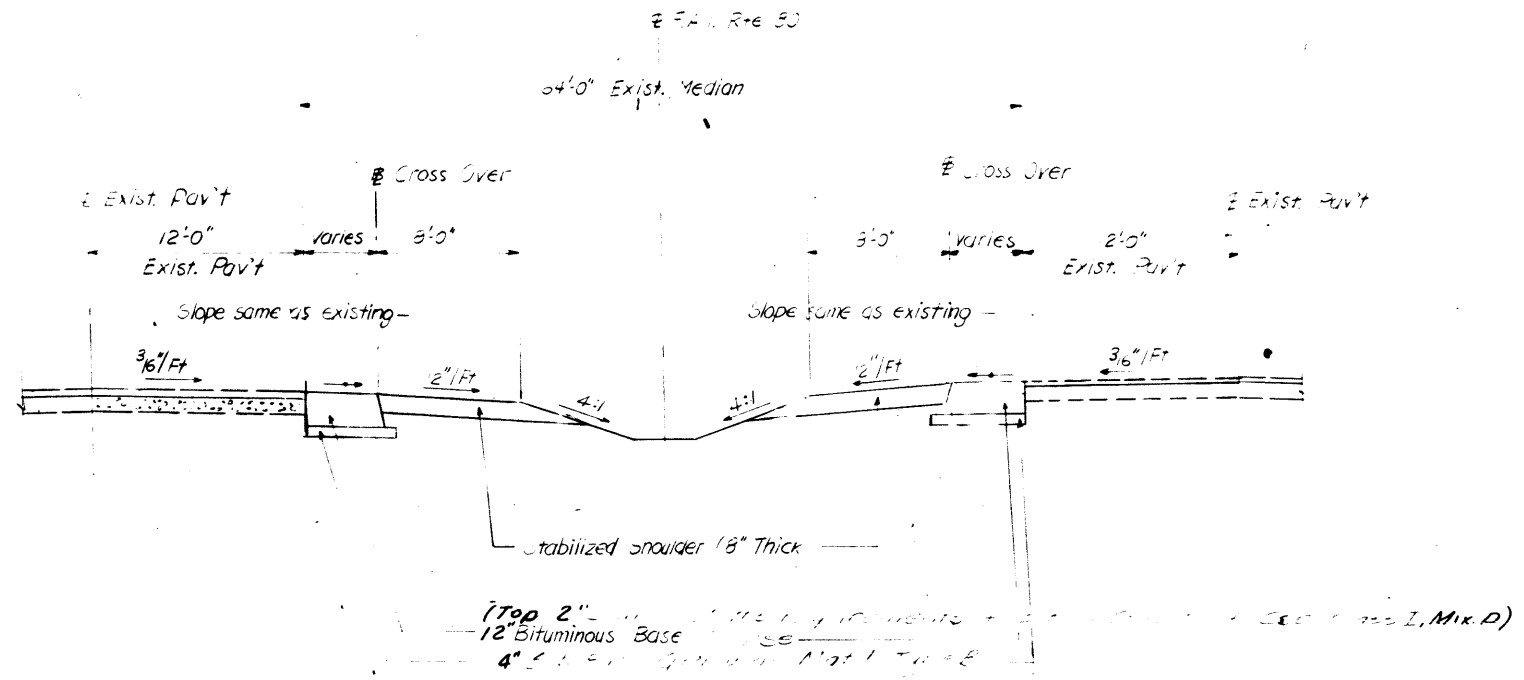

SECTION A-A
(SEE SHEET 5)

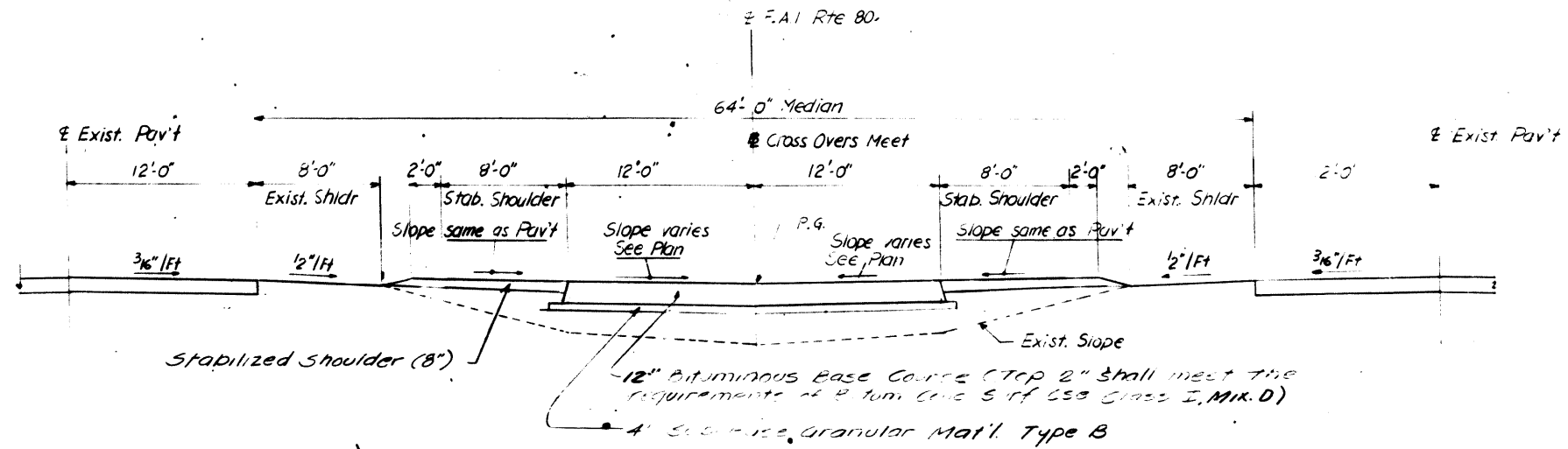

SECTION B-B
(SEE SHEET 5)

STATE OF ILLINOIS
DEPARTMENT OF TRANSPORTATION
F.A. ROUTE 80/DU PAGE RIVER
TYPICAL SECTIONS
SECTION 99-18-BR-79
WILL COUNTY
STATION 1911+03.33

XANTHAKOS LTD
CHICAGO, ILLINOIS

SHEET
3 OF 18

ROUTE NO	SECTION	COUNTY	TOTAL SHEETS	SHEET NO
F.A.I. RTE 90	99-18-BR-79	WILL	13	4
FED RD. DIST. 7	ILLINOIS	FED AID PROJ.		

SUMMARY OF QUANTITIES

BRIDGE	ROAD	TOTAL QUANTITY	UNIT	ITEM	CODE NO	IR FUNDING	I FUNDING
-	7563	7563	Cu. Yds	Special Excavation	205001	3176	4387
-	6430	6430	Cu. Yds	Embankment	207001	2700	3730
-	2016	2016	Sq. Yds	Bituminous Shoulders 8"	219006	896	1170
-	3375	3375	Sq. Yds	SUB BASE GRANULAR MATERIAL, TYPE B 4"	213012	1418	1957
-	3227	3227	Sq. Yds	Bituminous Base Course 12"	308009	1355	1872
-	98	98	TON	BITUMINOUS CONCRETE BINDER CSE	406007	98	-
-	112	112	TON	BITUMINOUS CONCRETE SURFACE CSE MIKE CL I	406014	-	112
33.6	-	33.6	Cu. Yds	Concrete Removal	501024	19.5	14.1
128.6	-	128.6	Cu. Yds	Cofferdam Excavation	502003	-	128.6
8.4	-	18.4	Cu. Yds	Rock Excavation for Structures	502004	-	18.4
8	-	8	Each	Cofferdams	502005	-	8
3356	-	3356	Sq. Yds	Protective Coat	503003	1952	1404
1114.0	-	1114.0	Cu. Yds	Class X Concrete	504003	377.0	737.0
576	-	576	Lin. Ft	Furn. and Erect. Precast Prest. Concr. I-Beams 42"	505009	-	576
7340	-	7340	Lbs	FURNISHING & ERECTING STRUCTURAL STEEL	507004	5242	2098
1232	-	1232	Lin. Ft.	Handrail Removal	508010	-	1232
-	1014	1014	Lin. Ft.	Pipe Culverts, Type L, 24" (Temporary)	511A05	425	589
95670	10090	107750	Lbs	Reinforcement Bars	512001	44955	62795
11152	-	11152	Lbs	Reinforcement Bars (Epoxy Coated) -	512002	71476	37716
470	-	470	Lin. Ft.	FURNISHING STEEL PILES HP 8 x 36	513013	-	470
2	-	2	Each	Name Plates	514001	-	2
470	-	470	Lin. Ft.	DRIVING STEEL PILES	513027	-	470
-	825	825	Lin. Ft.	Steel Plate Beam Guard Rail Type A	X62837	-	825
-	1060	1060	Lin. Ft.	Steel Plate Beam Guard Rail Removal	633003	-	1060
-	200	200	Lin. Ft.	Temporary Guard Rail	628028	84	116
-	4	4	Each	Temporary Terminal Section	628030	-	4
-	2	2	Each	Traffic Barrier Terminal Type 1A	X62835	-	2
-	2	2	Each	Traffic Barrier Terminal Type 2	628032	-	2
-	2	2	Each	Traffic Barrier Terminal Type 4	X62841	-	2
-	2	2	Each	Traffic Barrier Terminal Type 5	X62842	-	2
-	4	4	Each	Traffic Barrier Terminal Type 6	X62844	-	4
-	2	2	Acres	Seeding Class EB (SPECIAL)	X64203	0.8	1.2
134	134	134	TON	BITUMINOUS SHOULDERS	219010	134	-
118	118	118	GAL	BITUMINOUS MATERIALS (PR. CT.)	209001	118	-
384	384	384	SQ. YD.	BITUMINOUS CONCRETE SURFACE REMOVAL	617010	384	-
-	0.9	0.9	Acres	Temporary Seeding	628012	0.4	0.5
-	7350	7350	Lin. Ft.	Pavement Marking Tape	647001	3087	4263
1	-	1	L. Sum	TRAFFIC CONTROL & PROTECTION	648017	0.4	0.6
15	-	15	CAL. NO	ENGINEERS FIELD OFFICE TYPE A	646008	6	9
1130	-	1130	Sq. Yds	Slope Wall 6" INCH	618003	1130	-
600	-	600	Sq. Yds	Slope Wall Removal	617001	600	-
214	214	214	Sq. Yds	BRIDGE APPROACH PAVEMENT (STANDARD 238)	X40812	214	-
270	-	270	Lin. Ft.	Preformed Joint Seal 2 1/2"	X90313	180	90
48	-	48	Sq. Ft.	Repair Concrete Structures	* 210375	48	-
125	-	125	Lin. Ft.	Epoxy Crack Sealing	X21361	125	-
10	-	10	Each	Elastomeric Bearing Assembly Type I	X50315	10	-
138	-	138	Unit	Install & Remove Temporary Concrete Barrier	X07187	578	802
250	-	250	Each	Barrier Delineators	X06386	105	145
1380	-	1380	Lin. Ft.	REPLACE TEMPORARY CONCRETE BARRIER	X61682	578	802
-	104	104	SQ. YD.	P.C. CONCRETE BRIDGE APPROACH SURFACING	608001	44	60
1	-	1	L. Sum	MOBILIZATION	X04701	0.4	0.6
15	-	15	MIN. NO	FURNISHING AND MAINTAINING SUPPLEMENTARY VEHICLES	210800	6	9
-	26	26	TON	AGGREGATE SHOULDERS, TYPE A	219001	26	-
-	890	890	Lin. Ft.	THERMOPLASTIC PAVEMENT MARKING - LINE 4"	750001	-	890
-	110	110	Lin. Ft.	THERMOPLASTIC PAVEMENT MARKING - LINE 3"	750002	-	110
1	-	1	L. Sum	REMOVAL OF EXISTING CONCRETE DECK	209001	1	1

* NON-PARTICIPATING

INDEX OF SHEETS

SHEET NO 1 TITLE SHEET

- 2 TYPICAL SECTIONS
- 3 TYPICAL SECTIONS
- 4 SUMMARY OF QUANTITIES, INDEX OF SHEETS
- 5 CROSS OVER 16 1-4, ALIGNMENT
- 6 CROSS OVER PROFILES
- 7 TRAFFIC CONTROL AND PROTECTION-I
- 8 TRAFFIC CONTROL AND PROTECTION-II
- 9 GENERAL PLAN AND ELEVATION
- 10 GEN. NOTES, BILL OF MATERIAL, MISCEL. DETAILS
- 11 TOP OF SLAB ELEVATIONS
- 12 DECK PLAN AND REINFORCEMENT
- 13 DECK SECTIONS, DIAPHRAGM DETAILS
- 14 PARAPET, BILL OF MATERIAL
- 15 PRESTRESSED PRECAST CONCRETE BEAMS
- 16 BEARING DETAILS
- 17 ABUTMENTS
- 18 PIERS

LIST OF STANDARDS

- 1686-4
- 2113-2
- 2228-4
- 2230-13
- 2237-10
- 2262-4
- 2298-5
- 2299-8
- 2300-2
- 2316-6
- 2317-4
- 2324-5
- 2336-2
- 2337-1
- 2339-1
- 2340-3
- 2341-1
- 2345-1
- 2382-1
- 2383
- 2381

STATE OF ILLINOIS
DEPARTMENT OF TRANSPORTATION

F.A.I. ROUTE 90/DU PAGE RIVER
SUMMARY OF QUANTITIES, INDEX OF SHEETS
SECTION 99-18-BR-79
WILL COUNTY
STATION 1911+03.33

P. YANTHAPPA, LTD
CHICAGO, ILLINOIS

SHEET
4 OF 13

ROUTE NO.	SECTION	COUNTY	DATE
F.A.I. RTE 80	99-18-BR-79	WILL	11 80
FED. RD DIST. 7	ILLINOIS FED. AID PROJ.		

CURVES #1 AND #5 DATA

P.I. Sta. 1902+31.82 - E F.A.I.-80 - 32' Rt Curve #1
 Δ = 10° 18' 32"
 D = 2° 26' 02"
 R = 2354.00'
 T = 212.34'
 L = 423.54'

CURVES #2 AND #6 DATA

P.I. Sta. 1906+49.66 - E F.A.I.-80 - 44' Lt Curve #2
 Δ = 10° 18' 32"
 D = 2° 26' 02"
 R = 2354.00'
 T = 212.34'
 L = 423.54'

P.R.C. Sta. 1904+43.02
 6' Lt of E F.A.I.-80
 Sta. 1904+40.74

P.T. Sta. 1908+66.56
 End X-Over Base Line
 44' Lt of E F.A.I.-80 - 44' Rt of E F.A.I.-80
 P.O.T. Sta. 1908+62.00

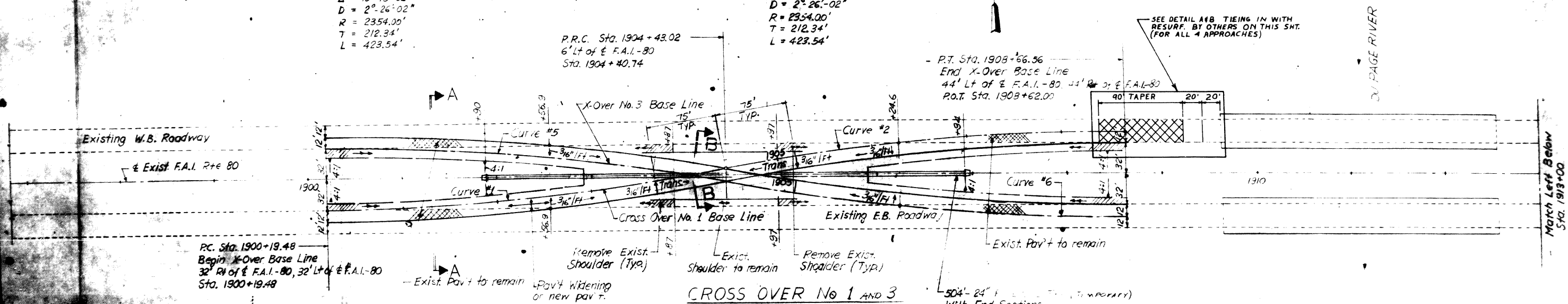

NOTE: EXISTING CROSS OVER, EAST OF STRUCTURE, SHALL BE REMOVED AND THE AREA REGRADED AND SEEDED.

Note: For Sections A-A and B-B see Sht 3

CURVES #3 AND #7 DATA

P.I. Sta. 1913+62.34 - E F.A.I.-80 - 44' Lt Curve #3
 Δ = 10° 18' 32"
 D = 2° 26' 02"
 R = 2354.00'
 T = 212.34'
 L = 423.54'

CURVES #4 AND #8 DATA

P.I. Sta. 1919+80.18 - E F.A.I.-80 - 32' Rt Curve #4
 Δ = 10° 18' 32"
 D = 2° 26' 02"
 R = 2354.00'
 T = 212.34'
 L = 423.54'

Sta. 1913+50.00
 End X-Over Base Line
 32' Rt of E F.A.I.-80 - 32' Lt of E F.A.I.-80
 Sta. 1913+50.00

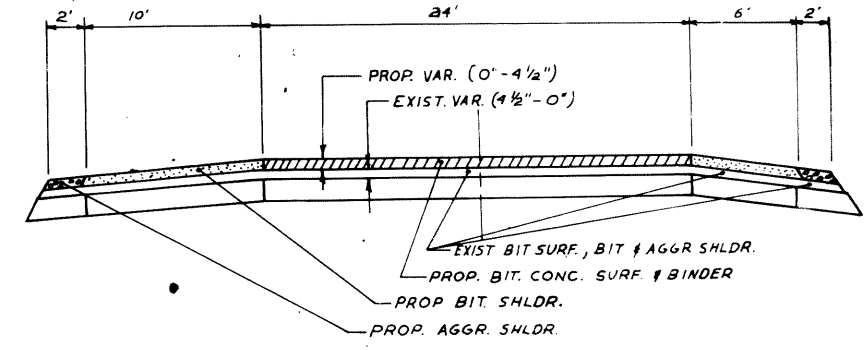
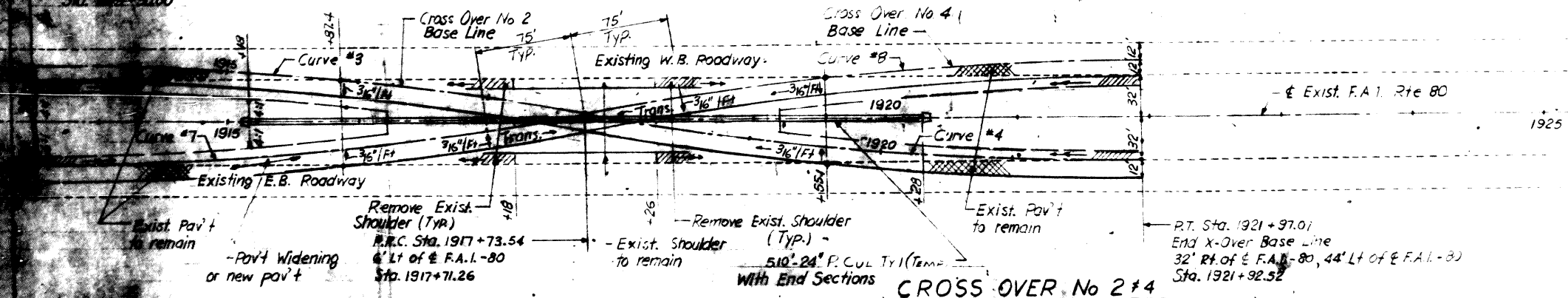

DETAIL A TYP SECTION

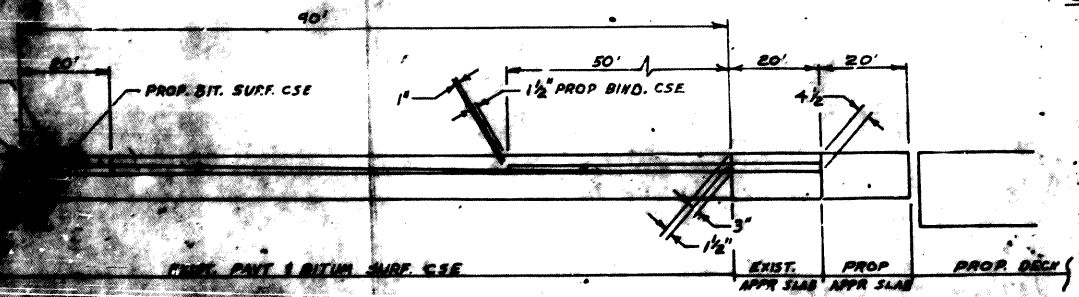

STATE OF ILLINOIS
 DEPARTMENT OF TRANSPORTATION
 F.A.I. ROUTE 80/DU PAGE RIVER
 CROSS OVER No 1 - ALIGNMENT
 SECTION 99-18-BR-79
 WILL COUNTY
 STATION 1917+03.33
 P. XANTHAKOS LTD
 CHICAGO, ILLINOIS

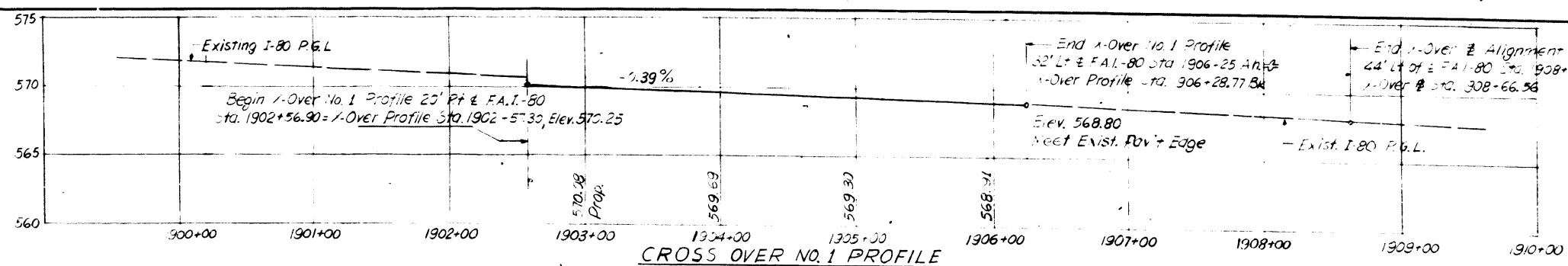

CROSS OVER NO. 1 PROFILE

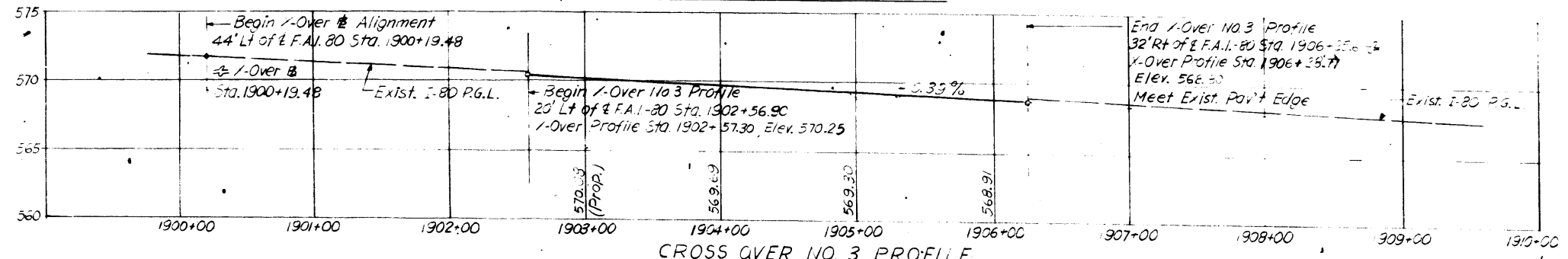

CROSS OVER NO. 3 PROFILE

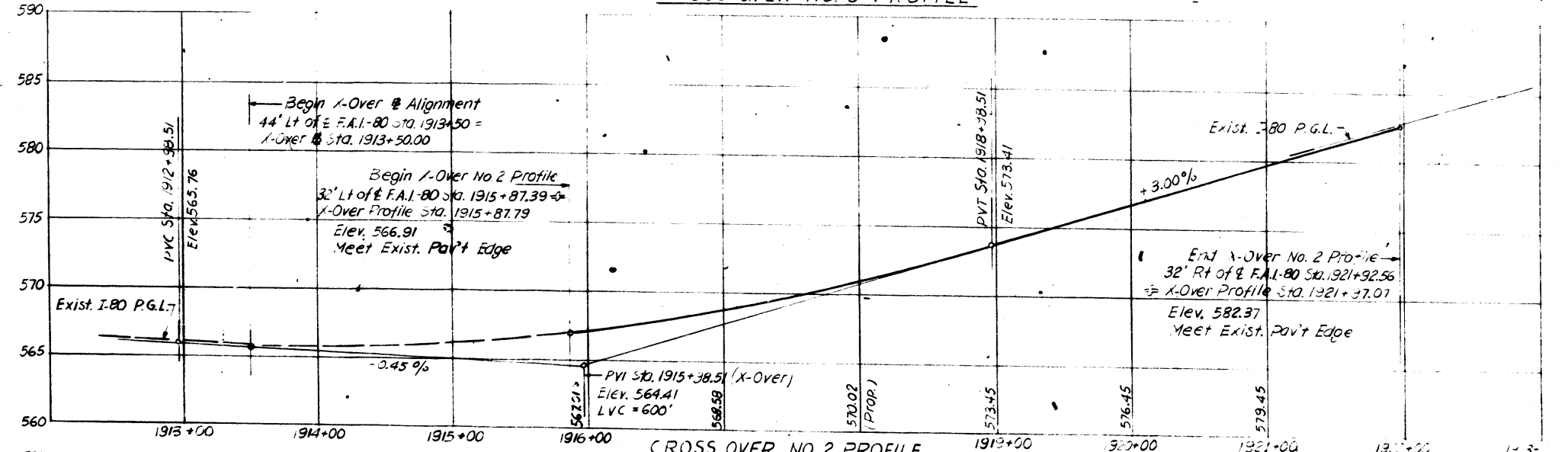

CROSS OVER NO. 2 PROFILE

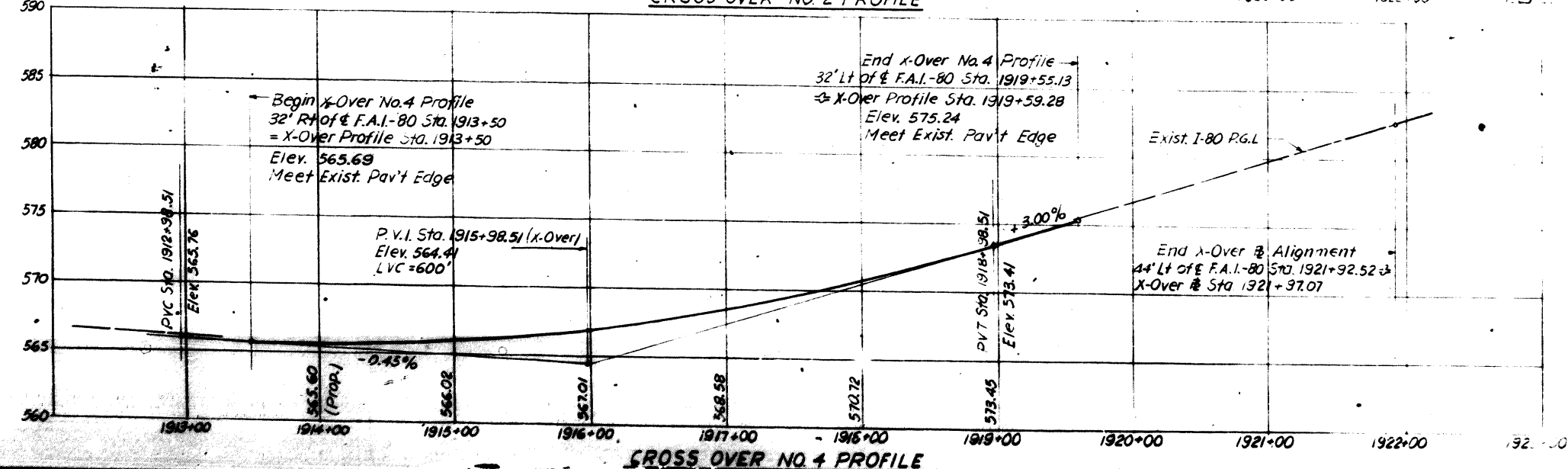

CROSS OVER NO. 4 PROFILE

STATE OF ILLINOIS
 DEPARTMENT OF TRANSPORTATION
 ILL. ROUTE 80 - PAGE RIVER
 CROSS OVER PROFILES
 SECTION 99-18-BR-79
 WILL COUNTY
 STATION 911+33.33
 KANHAMOS, LTD.
 CHICAGO, ILLINOIS

ROUTE NO.	SECTION	COUNTY	TOTAL SHEETS	SHEET NO.
F.A. RTE 80	99-1B-BR-79	WILL	18	7
FED RD DISTR 7 ILLINOIS FED AID PROJ.				

NOTE: THE FLASHING ARROW SHALL MEET THE LATEST REQUIREMENTS OF THE DEPT. IT SHALL BE LOCATED IN A "HEAD ON" POSITION WITHIN THE LANE CLOSURE TAPER

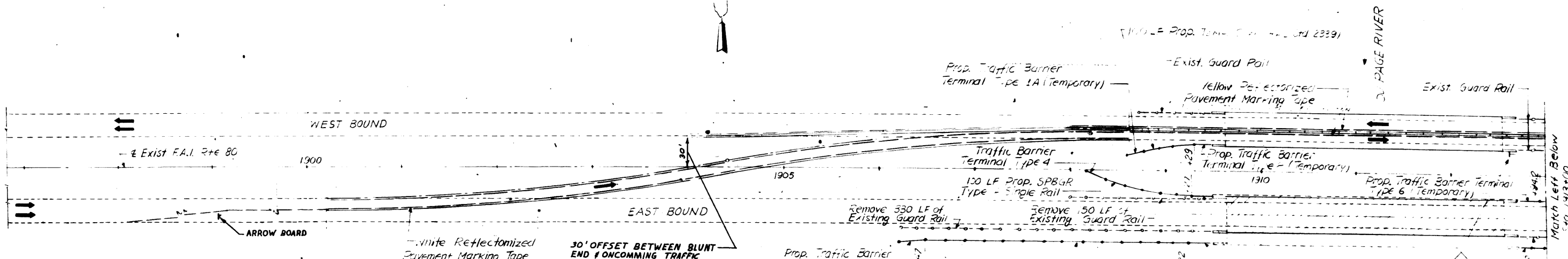
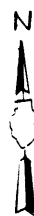

All Construction Signing, Striping & Barricading in accordance with Std. 2317 Straight Line Tapers at a Ratio of 70:1 (Typ.)

LEGEND

- Work Area
- Temp. Precast Concrete Median Barrier
- Pavement Marking Tape reflectorized Yellow or White
- Existing Guard Rail
- Proposed Guard Rail

CROSS OVER No 1

PHASE I

STRIPING NOTES

Contractor to use Temporary Reflectorized Pavement Marking Tape at Pavement Edges of Cross Overs and Existing Road.

Proposed Traffic Barrier Terminal Type 5
Remove 50 LF of Existing Guard Rail

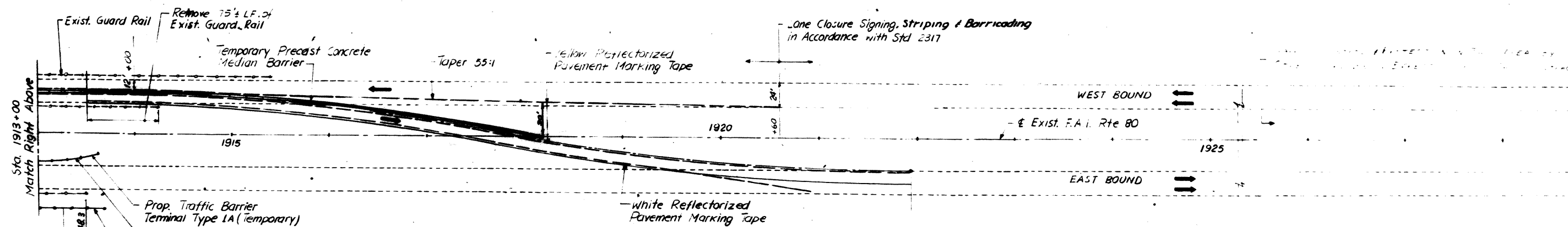

CROSS OVER No 2

PHASE I

STATE OF ILLINOIS
DEPARTMENT OF TRANSPORTATION
F.A.I. ROUTE 80/DU PAGE RIVER
TRAFFIC CONTROL AND PROTECTION-I
SECTION 99-1B-BR-79
WILL COUNTY
STATION 1911+03.33

P. XANTHAKOS LTD
CHICAGO, ILLINOIS

SHEET
7 OF 18

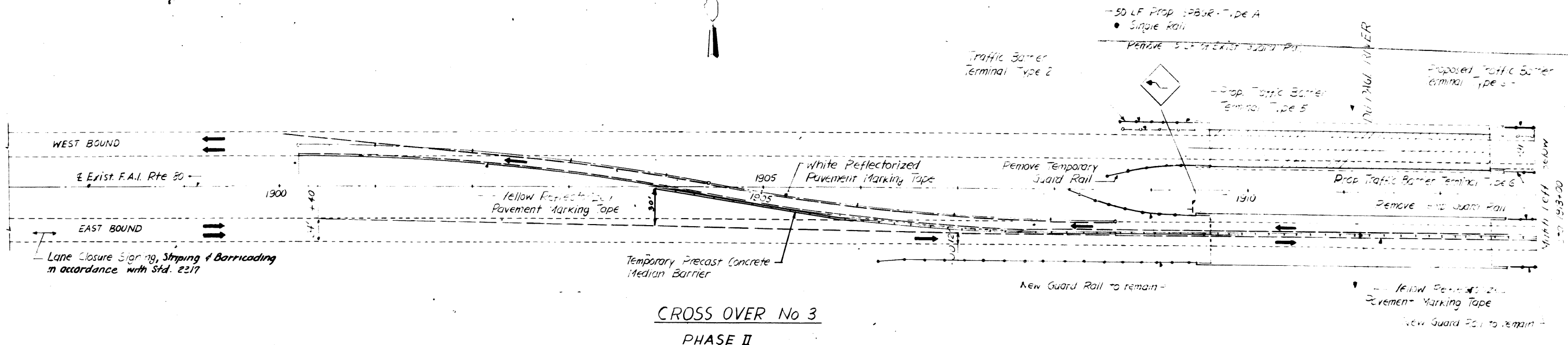

CROSS OVER No 3
PHASE II

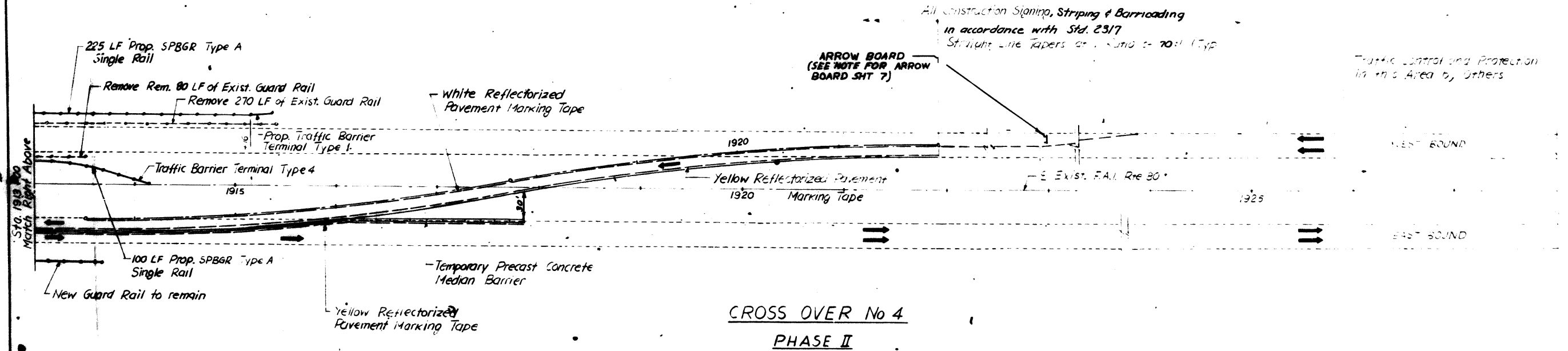

CROSS OVER No 4
PHASE II

Note: For Legend and Striping Notes see Sht. 7

STATE OF ILLINOIS
DEPARTMENT OF TRANSPORTATION
F.A.I. ROUTE 80 DU PAGE RIVER
TRAFFIC CONTROL AND PROTECTION - II
SECTION 99-18-BR-79
WILL COUNTY
STATION 1911+03.33

SHEETS
3 OF 8

Bench Mark #1 Elev. 536.52 nail in Walnut Tree,
 1/2 mi. S.W. Minwood Glen Subdivision.
 Existing Structure: 5-Span, PRC I Beams and
 Concrete Deck, Solid Piers and Open Abutments.

WATERWAY INFORMATION

Drainage Area: 333 Sq. Miles	Low Grade Elev. = @ Sta	
Flood Freq. Yr.	Opening Sq. Ft.	
Design 50	Exist. Prop. Nat. H.W.E. Exist. Prod. Headwater El.	
Base 100	15827	556.4 3.49 0.49
Overlapping		556.4 3.53 0.53
Max. Cal.	500	

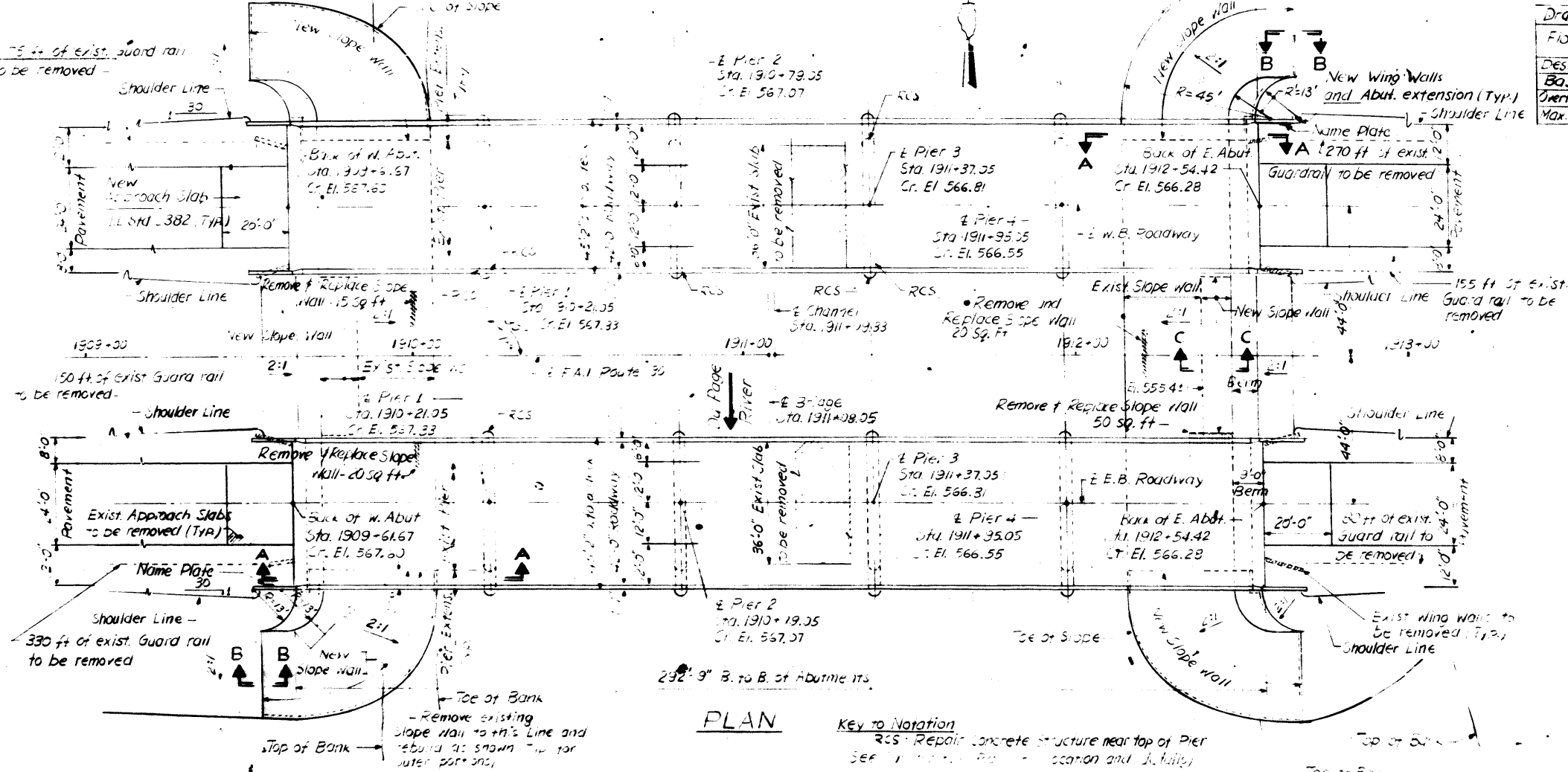

PLAN

Key to Notation
 RCS - Repair Concrete Structure near top of Pier
 See Notes for location and details.

DESIGN CRITERIA

A.A.S. - TO STATE DESIGN CRITERIA - 1979
 Bridges (1977) and (1975) 1979

DESIGN STRESSES - CONCRETE

- $f'_c = 4000$ psi
- $f'_c = 3500$ psi
- $f'_c = 24000$ psi
- $n = 8.5$

DESIGN STRESSES - PRECAST/PRESTRESSED UNITS, NEW

- $f'_c = 5000$ psi
- $f'_c = 4000$ psi
- $f'_c = 27000$ psi
- $f'_c = 159000$ psi

LOADING

HS 20-44
 From Existing Plans

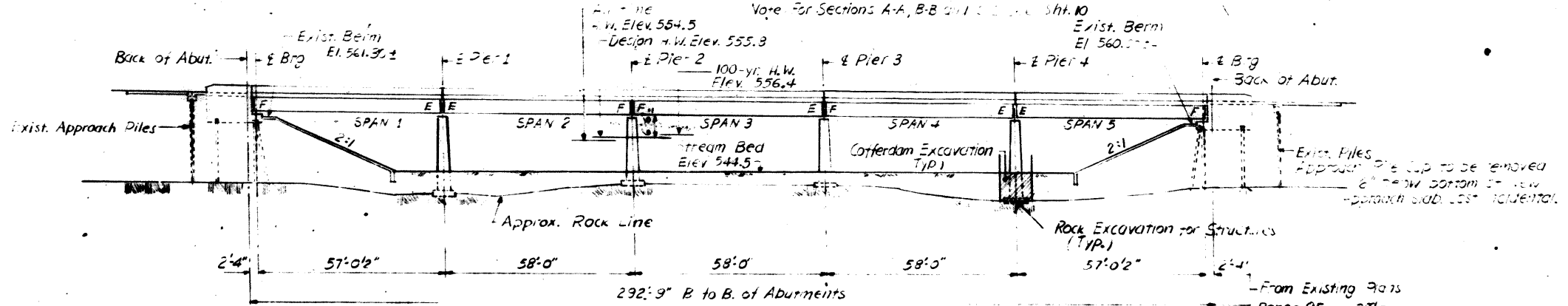

ELEVATION
 Scale: 1"=20'

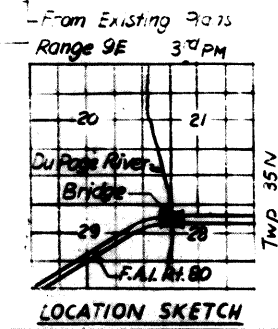

DESIGNED BY: P.X.
 DRAWN BY: B.B.
 CHECKED BY: P.X.

P. Nambler

STATE OF ILLINOIS
 DEPARTMENT OF TRANSPORTATION
 ILLINOIS ROUTE 80/00 PASE RIVER
 GENERAL PLAN AND ELEVATION
 SECTION 09 13-BR-79
 WILL COUNTY
 STATION 31+15.63
 XANTHAKOS LTD
 OF CHICAGO, ILLINOIS

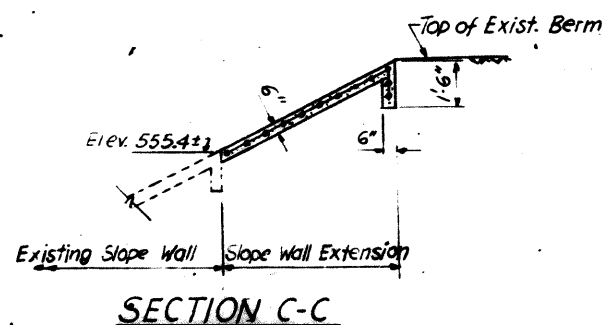
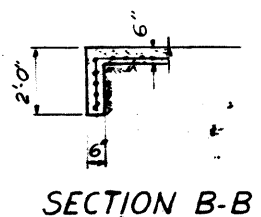
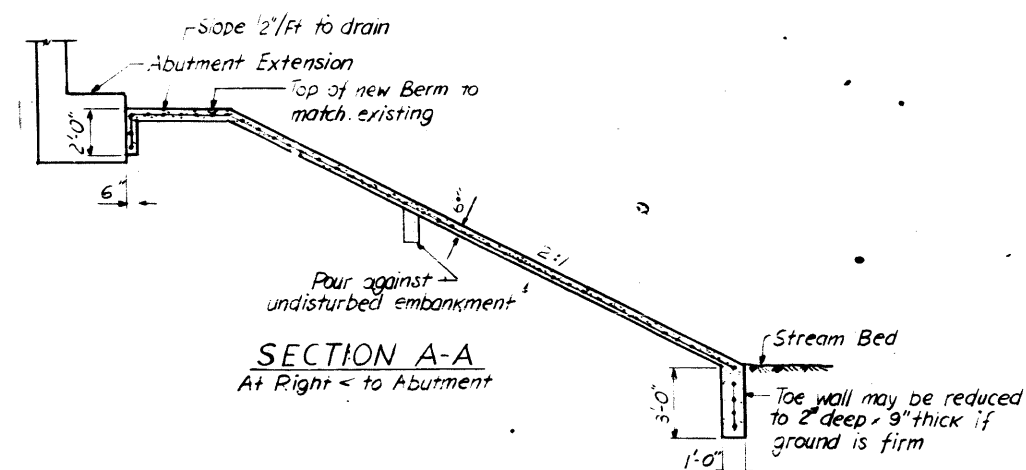

GENERAL NOTES

- Expansion joint angles and attached bars shall be AASHTO M 183 and shop painted with two coats of basic lead silico chromate paint.
- All bearing devices under existing beams shall be cleaned by method I and given one coat of the basic lead silico chromate primer and maroon field coat.
- Slope wall shall be reinforced with welded wire fabric, 6"x6"-W4.0xW4.0, weighing 58 lbs per 100 sq. ft.
- Layout of new slope wall may be varied in the field to suit ground conditions as directed by the Engineer.
- Plan dimensions, elevations and details relative to existing structure have been taken from existing plans and are subject to nominal construction variations. It shall be the Contractor's responsibility to verify such dimensions and details in the field and make necessary approved adjustments prior to construction or ordering of materials. Such variations shall not be cause for additional compensation for a change in the scope of the work, however, the Contractor shall be paid for the quantity actually furnished at the unit price bid for the work.
- Reinforcement bars shall conform to the requirements of AASHTO M-31 or M-53 Grade 60.

- Pier footing to be founded on the very dense grey shale strata or on a material having a safe bearing capacity of 6,000 Lbs per sq. ft.
- A Calcium Nitrite corrosion inhibitor as covered in the Special Provisions shall be used in the concrete for parapets.

TOTAL BILL OF MATERIAL

ITEM	UNIT	QUANTITY				TOTAL
		W.B. BRIDGE		E.B. BRIDGE		
		SUPER.	SUB.	SUPER.	SUB.	
Concrete Removal	Cu Yds		16.8		16.8	33.6
Protective Coat	Sq. Yds	1628		1628		3256
Epoxy Crack Sealing	Lin. Ft		75		50	125
Handrail Removal	Lin. Ft	616		616		1232
Cofferdam Excavation	Cu. Yds		61.5		67.1	128.6
Rock Excavation for Structures	Cu. Yds		9.2		9.2	18.4
Cofferdams	Each		4		4	8
Class X Concrete	Cu. Yds	430.0	126.1	430.0	127.9	1114
Steel Piles #P8x36	Lin. Ft		235		235	470
Elastomeric Bearings - Type I	Each	5		5		10
Reinforcement Bars	Lbs	36400	11390	36400	11480	95670
Reinforcement Bars Epoxy Coated	Lbs	55576		55576		111152
Furnishing and Erecting Precast Prestressed Concrete I-Beams 42"	Lin. Ft	288		288		576
Structural Steel	Lbs	3670		3670		7340
Name Plates	Each		1		1	2
Preformed Joint Seal 2 1/2"	Lin. Ft	135		135		270
Repair Concrete Structures	Sq. Ft		38		10	48
Slope Wall - 6"	Sq. Yds					1130
Slope Wall Removal	Sq. Yds					600
Removal of Existing Concrete Deck	L. Sum					1

STATION 1911+09.33
 BUILT 198 BY
 STATE OF ILLINOIS
 F.A.I. RT 80 SEC. 99-1B-BR-79
 F.A. PROJ. 180-80-4(NB)
 LOADING HS20 1 ALT.
 *STR. NO.

See State of Illinois Std. 2113

LETTERING OF NAME PLATES

Name Plates required: One (1) each for W.B. and E.B. Bridge

*Structure Number to be supplied by District

DESIGNED BY: P.A.
 DRAWN BY: B.A.
 CHECKED BY: P.A.

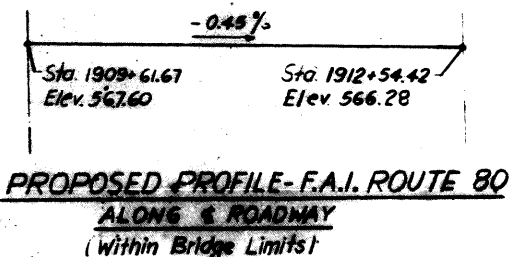

STATE OF ILLINOIS
 DEPARTMENT OF TRANSPORTATION
 F.A.I. ROUTE 80 DU PAGE RIVER
 GENERAL NOTES, BILL OF MATERIAL, M.S. DETAILS
 SECTION 99-1B-BR-79
 WILL COUNTY
 STATION 1911+09.33
 CHAI T-AKOS LTD
 CHICAGO, ILLINOIS

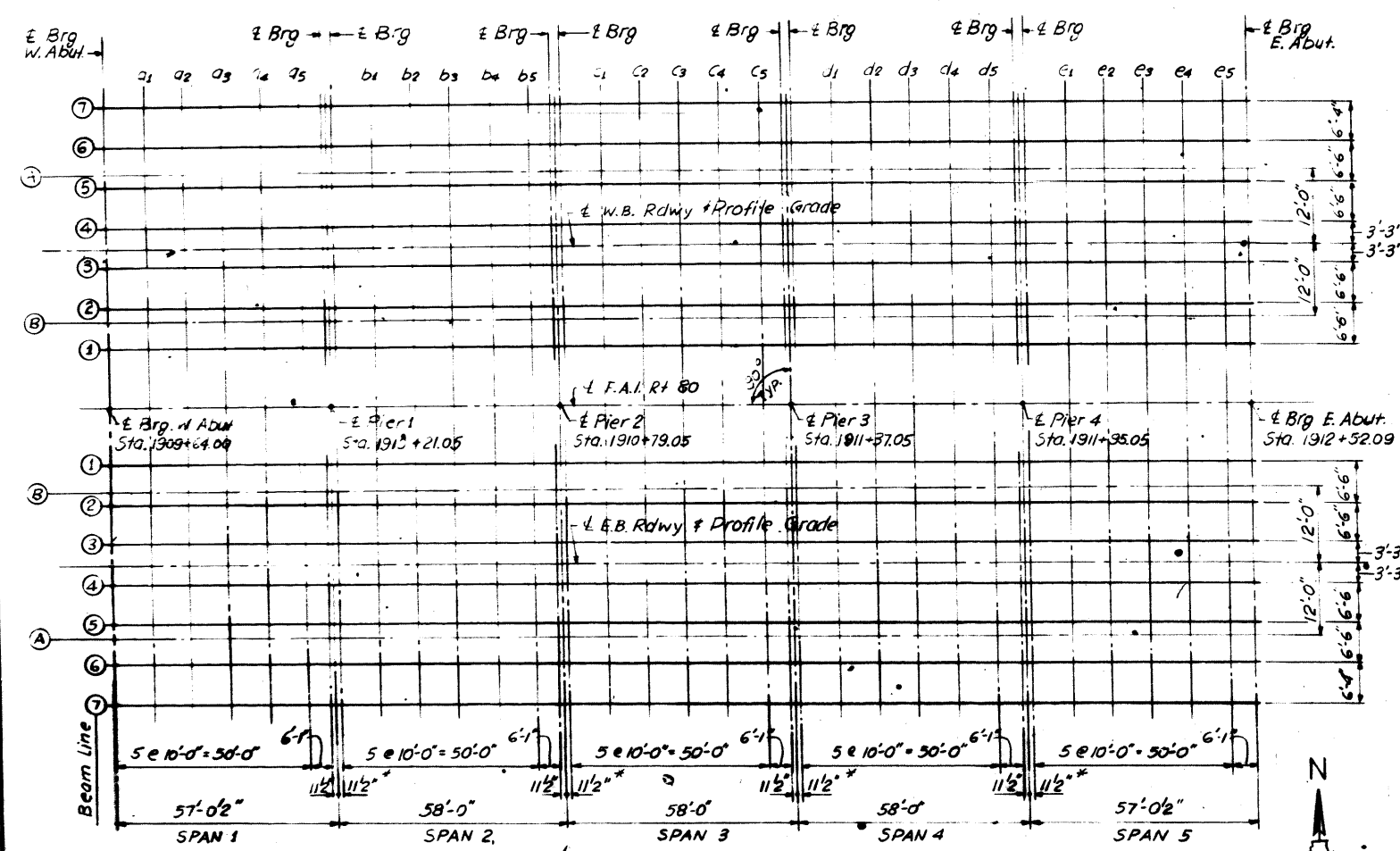

PLAN

Line A: North Edge of Pavement Line - W.B. South E.B.
 Line B: South W.B. North E.B.
 Beams 1 thru 6: Existing
 Beam 7: New

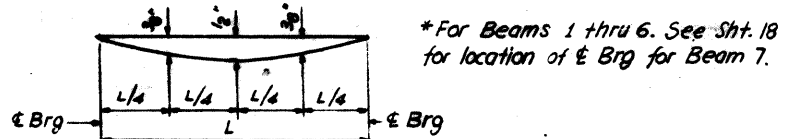

DEAD LOAD DEFLECTION DIAGRAM (ALL SPANS)

(Does not include weight of beam)

Note: The above deflections are not to be used in the field if the Engineer is working from the grade elevations adjusted for dead load deflections shown on this Sheet.

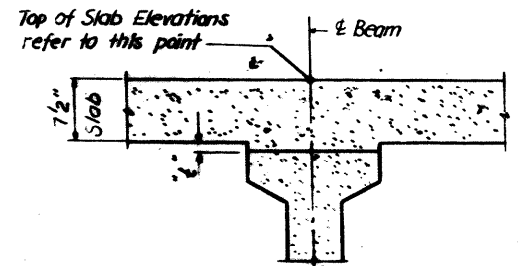

STANDARD FILLET DETAIL

To determine 't': After all precast prestressed beams have been erected, elevations of the top flanges of the beams shall be taken at intervals shown in the plan above. These elevations subtracted from the 'Theoretical Grade Elevations adjusted for Dead Load Deflections' minus slab thickness, equals the fillet height 't' above top flanges of beams.

DESIGNED BY: R.Y.
 DRAWN BY: B.B.
 CHECKED BY: P.F.

TABLE OF ELEVATIONS (TOP OF SLAB)

LOCATION-LINE	BEAM 1		BEAM 2		BEAM 3		BEAM 4		BEAM 5		BEAM 6		BEAM 7	
	Theor.	Adjust.	Theor.	Adjust.	Theor.	Adjust.	Theor.	Adjust.	Theor.	Adjust.	Theor.	Adjust.	Theor.	Adjust.
E Brg W. Abut.	567.313	567.313	567.437	567.437	567.538	567.538							567.178	567.178
a1	567.269	567.299	567.392	567.407	567.493	567.508							567.133	567.148
a2	567.223	567.253	567.347	567.376	567.448	567.478							567.088	567.118
a3	567.178	567.217	567.308	567.340	567.403	567.442							567.043	567.082
a4	567.133	567.157	567.257	567.281	567.358	567.382							566.998	567.022
a5	567.088	567.097	567.212	567.221	567.313	567.322							566.953	566.962
E Brg Pier 1	567.061	567.061	567.184	567.184	567.286	567.286							566.926	566.926
b1	567.052	567.052	567.176	567.176	567.271	567.271							566.917	566.917
b2	567.007	567.022	567.131	567.146	567.232	567.247							566.872	566.887
b3	566.962	566.988	567.086	567.115	567.187	567.217							566.827	566.857
b4	566.917	566.956	567.041	567.079	567.142	567.181							566.782	566.821
b5	566.872	566.896	566.996	567.020	567.097	567.121							566.737	566.761
E Brg Pier 2	566.800	566.800	566.923	566.923	567.025	567.025							566.665	566.665
c1	566.791	566.791	566.915	566.915	567.016	567.016							566.636	566.636
c2	566.746	566.761	566.870	566.885	566.971	566.986							566.611	566.626
c3	566.701	566.721	566.825	566.854	566.926	566.956							566.566	566.596
c4	566.656	566.695	566.780	566.818	566.881	566.920							566.521	566.560
c5	566.611	566.635	566.735	566.759	566.836	566.860							566.476	566.500
E Brg Pier 3	566.566	566.575	566.690	566.698	566.791	566.800							566.431	566.440
d1	566.539	566.539	566.662	566.662	566.764	566.764							566.404	566.404
d2	566.530	566.530	566.694	566.654	566.755	566.755							566.395	566.395
d3	566.485	566.500	566.609	566.628	566.710	566.725							566.350	566.365
d4	566.440	566.470	566.564	566.599	566.665	566.695							566.305	566.335
d5	566.395	566.494	566.579	566.557	566.620	566.659							566.260	566.299
E Brg Pier 4	566.350	566.374	566.474	566.498	566.575	566.599							566.215	566.239
e1	566.305	566.344	566.429	566.438	566.530	566.539							566.170	566.179
e2	566.270	566.278	566.401	566.401	566.503	566.503							566.143	566.143
e3	566.269	566.269	566.393	566.393	566.494	566.494							566.134	566.134
E Brg E. Abut.	566.017	566.017	566.140	566.140	566.248	566.248							565.982	565.982

LOCATION-LINE	LINE A		LINE B		LOCATION LINE	Back of W. Abut.		Back of E. Abut.	
	Theor.	Adjust.	Theor.	Adjust.		Theor.	Adjust.	Theor.	Adjust.
E Brg W. Abut.	567.589	567.589	567.402	567.402					
a1	567.544	567.579	567.357	567.371	Beam 1 #6	567.324	567.324	566.204	566.204
a2	567.499	567.529	567.312	567.341	Beam 2 #5	567.448	567.448	566.128	566.128
a3	567.440	567.493	567.267	567.305	Beam 3 #4	567.549	567.549	566.229	566.229
a4	567.409	567.439	567.222	567.245	Beam 7	567.192	567.192	565.872	565.872
a5	567.374	567.379	567.177	567.186	E Roadway	567.600	567.600	566.280	566.280
E Brg Pier 1	567.337	567.337	567.149	567.149	Line A	567.413	567.413	566.093	566.093
b1	567.328	567.328	567.141	567.141	Line B	567.413	567.413	566.093	566.093
b2	567.283	567.289	567.096	567.110					
b3	567.238	567.268	567.051	567.080					
b4	567.193	567.232	567.006	567.044					
b5	567.148	567.172	566.961	566.984					
E Brg Pier 2	567.103	567.112	566.916	566.925					
c1	567.076	567.076	566.888	566.888					
c2	567.067	567.067	566.880	566.880					
c3	567.022	567.037	566.835	566.849					
c4	566.977	567.007	566.790	566.819					
c5	566.932	566.971	566.745	566.783					
E Brg Pier 3	566.887	566.911	566.700	566.723					
d1	566.842	566.851	566.655	566.664					
d2	566.815	566.815	566.627	566.627					
d3	566.806	566.806	566.619	566.619					
d4	566.761	566.776	566.574	566.588					
d5	566.716	566.746	566.529	566.558					
E Brg Pier 4	566.671	566.710	566.484	566.522					
e1	566.626	566.650	566.439	566.462					
e2	566.581	566.581	566.391	566.391					
e3	566.536	566.536	566.346	566.346					
E Brg E. Abut.	566.491	566.491	566.299	566.299					

STATE OF ILLINOIS
 DEPARTMENT OF TRANSPORTATION
 F.A.I. ROUTE 80/DU PAGE RIVER
 TOP OF SLAB ELEVATIONS
 SECTION 91-1B-BR-79
 WILL COUNTY
 STATION 1911+03.33

ROUTE NO.	SECTION	COUNTY	TOTAL SHEETS	SHEET NO.
F.A.I. RTE 80	99-18-BR-79	WILL	19	12
FED RD DIST. 7 ILL. HIGHWAY AID PROJ.				

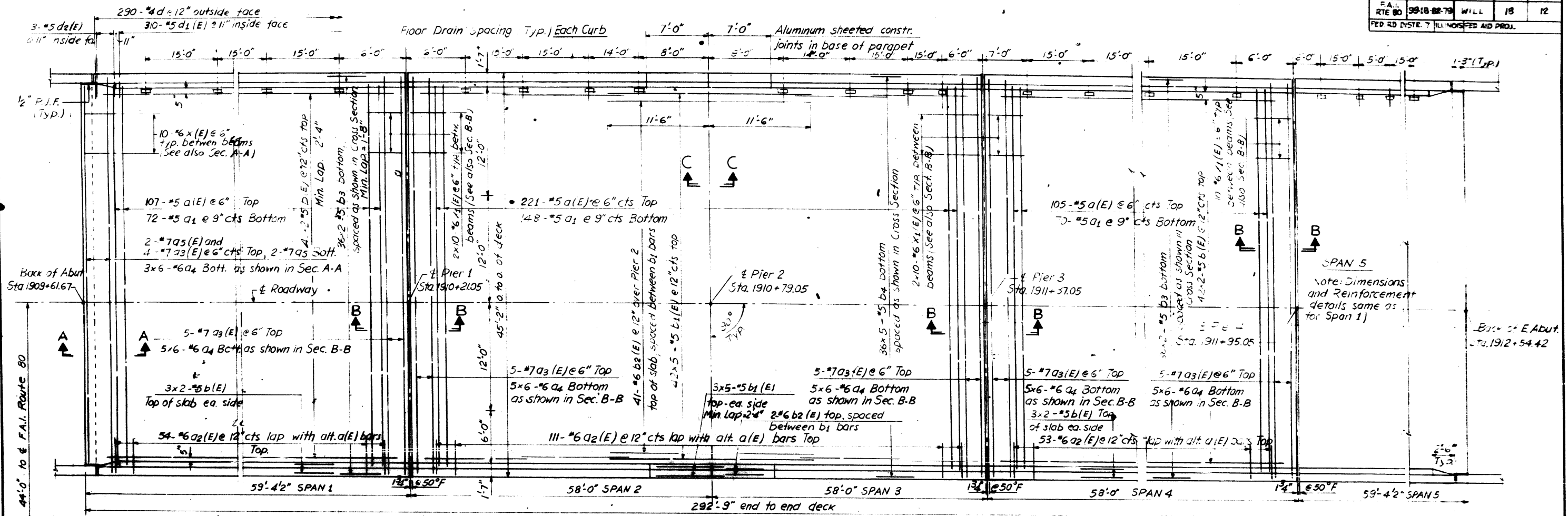

DECK PLAN (W.B. shown, E.B. symm about F.A.I. Route 80)

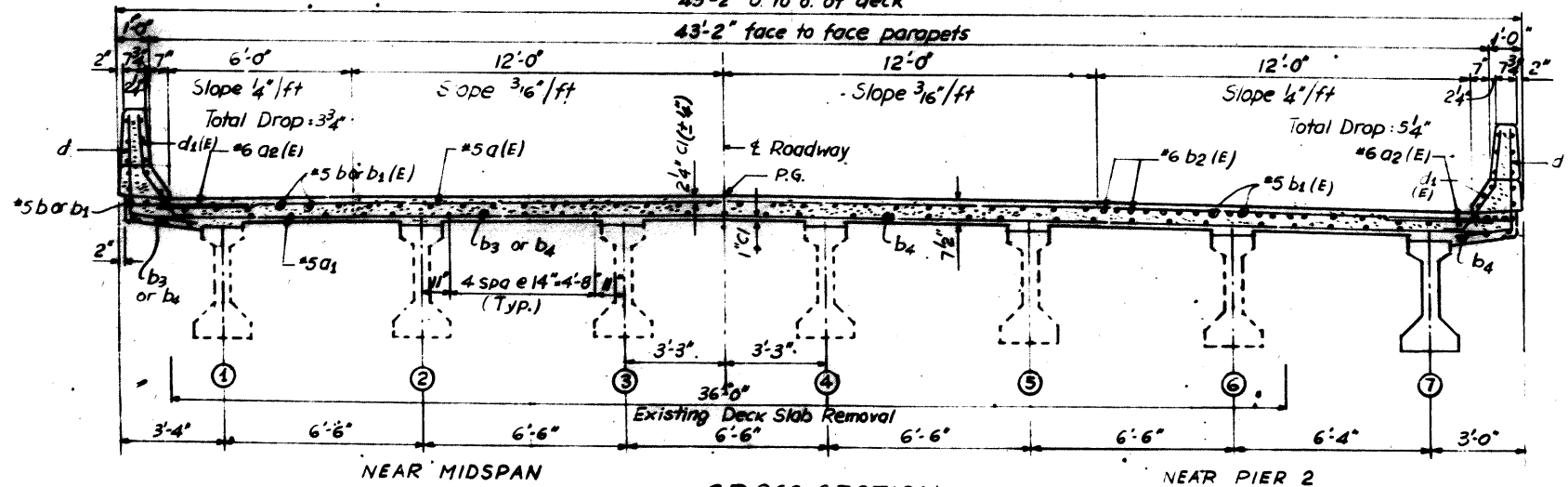

CROSS SECTION

W.B. Looking West
E.B. Looking East

NOTES
 See sheet 14 for Bill of Material and Parapet Details.
 See sheet 13 for Sections of Abutments and Piers.
 Reinforcement bars designated (E) shall be epoxy coated. See Special Provisions.
 Bars indicated thus 36x4-#5 etc. indicates 36 lines of bars with 4 lengths per line.
 Stations and dimensions between center lines of Piers and backs of Abutments were obtained from the original Bridge Plans. Contractor shall verify these dimensions in field.

Note: Beams 1 thru 6 are existing and shall remain in place

DESIGNED BY: P.X.
 DRAWN BY: B.B.
 CHECKED BY: P.X.

STATE OF ILLINOIS
 DEPARTMENT OF TRANSPORTATION
 F.A.I. ROUTE 80/DU PAGE RIVER
 DECK PLAN AND REINFORCEMENT
 SECTION 99-18-BR-79
 WILL COUNTY
 STATION 1911+03.33

P. XANTHAKOS LTD
 CHICAGO, ILLINOIS

SHEET
 12 OF 19

Rev. 10-22-80

ROUTE NO	SECTION	COUNTY	TOTAL SHEETS	SHEET NO.
F.A.I. RTE 80	99-1B-BR-79	WILL	18	13
FED RD DISTR 7 ILLINOIS FED AID PROJ.				

Shaded Area: Top of Existing Abut. Wall to be removed to Constr. Joint

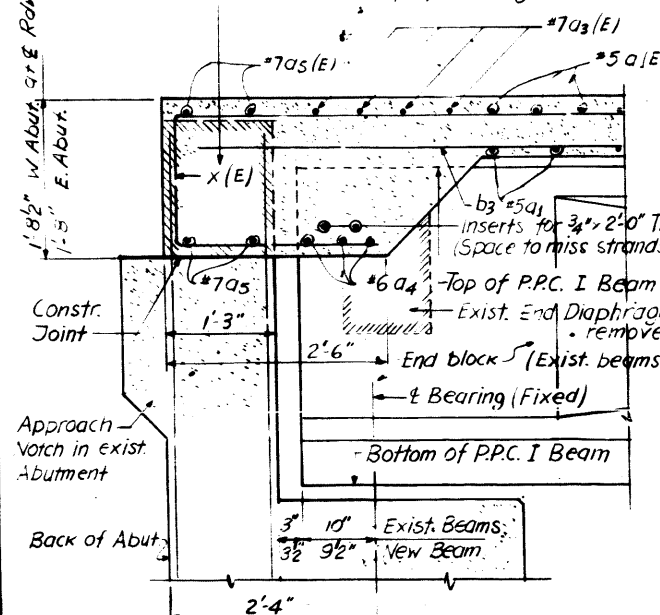

**SECTION A-A
AT ABUTMENTS**

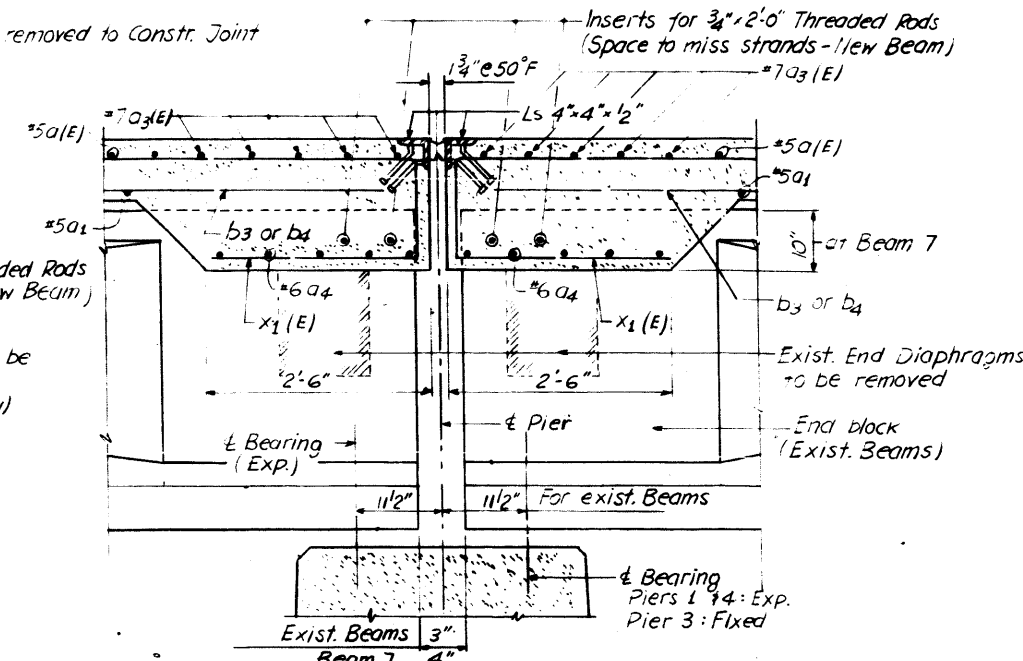

**SECTION B-B
AT PIERS 1, 3 & 4**

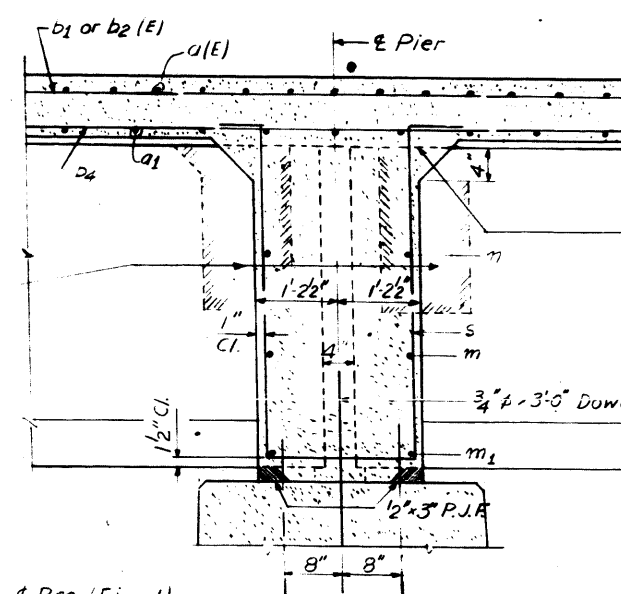

**SECTION C-C
AT FIXED PIER 2 (BEAM 7)**

Pour diaphragm flush with top of beam. Concrete in slab above this line shall be placed not less than 45 minutes nor more than 90 minutes after diaphragm has been poured.

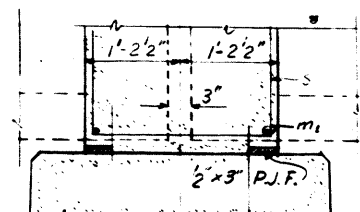

**SECTION C-C
AT FIXED PIER 2
(Existing Beams)**

Rods in exist. Beams shall be sawed or chipped off flush with face of beam, and inserts shall be grouted (Typ.)

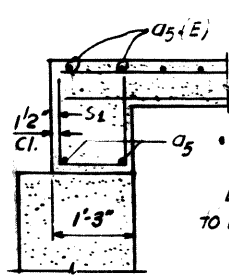

**SECTION D-D
AT ABUTMENTS**

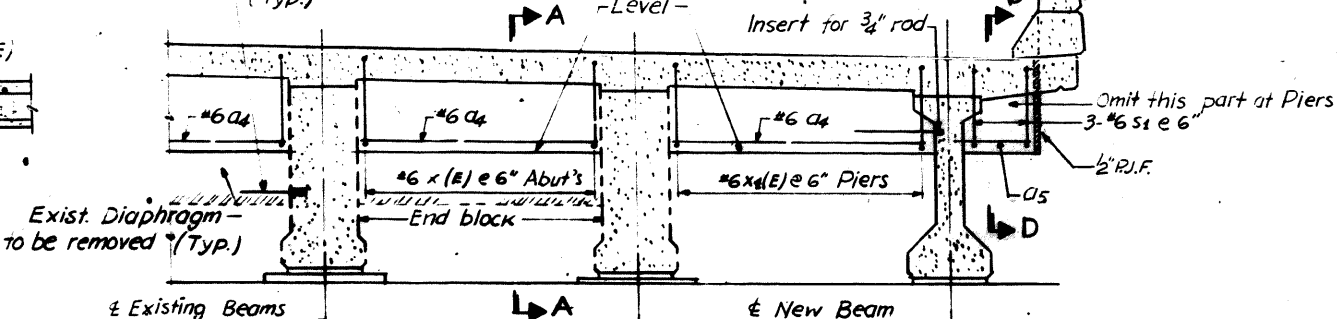

DIAPHRAGM AT ABUTMENTS

DIAPHRAGM AT PIERS 1, 3 & 4: SIMILAR EXCEPT AS NOTED

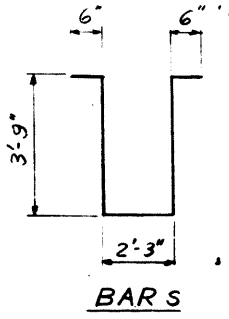

BAR S

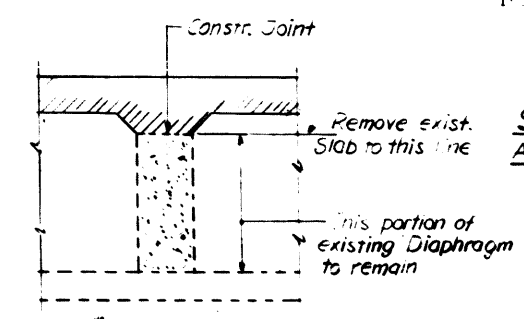

**SECTION AT EXISTING
INTERIOR DIAPHRAGMS**

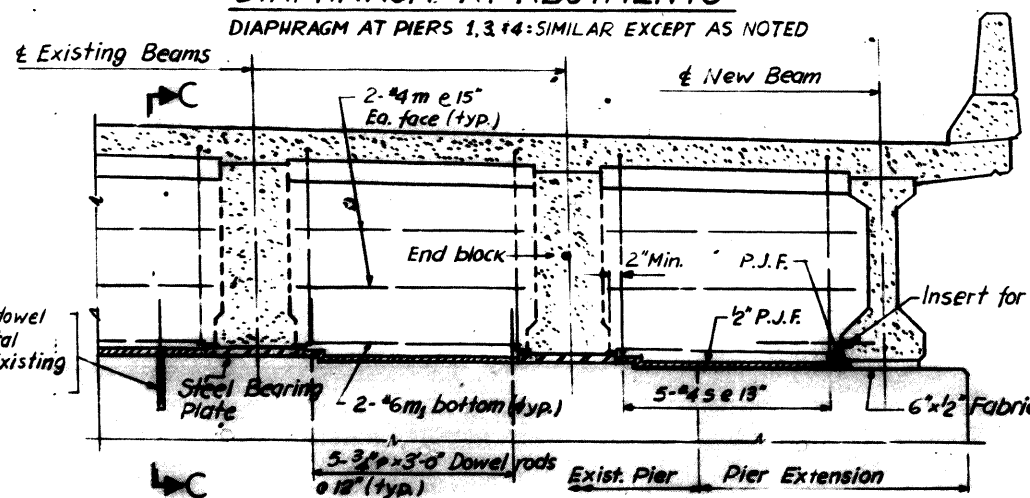

DIAPHRAGM AT FIXED PIER 2

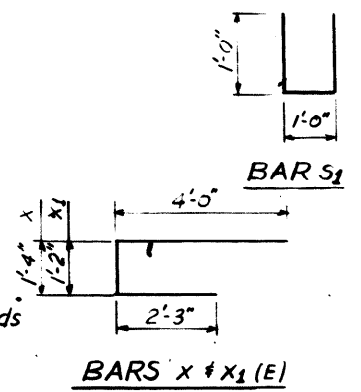

BARS X & X1 (E)

Drill 1/2\"/>

DESIGNED BY: P.P.
DRAWN BY: P.P.
CHECKED BY: P.P.

STATE OF ILLINOIS
DEPARTMENT OF TRANSPORTATION
F.A.I. ROUTE 80/00 PAGE RIVER
DECK SECTIONS, DIAPHRAGM DETAILS
SECTION 99-1B-BR-79
WILL COUNTY
STATION 1911+03.33

XANTHAKOS LTD
CHICAGO, ILLINOIS

SHEET
13 OF 16

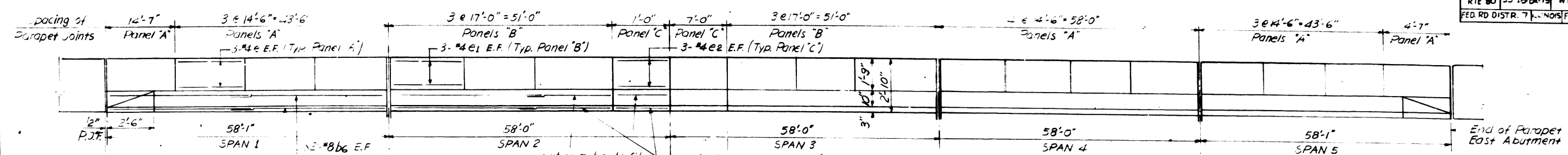

INSIDE ELEVATION OF NORTH PARAPET
SOUTH PARAPET: SIMILAR @ OUTSIDE ELEVATION

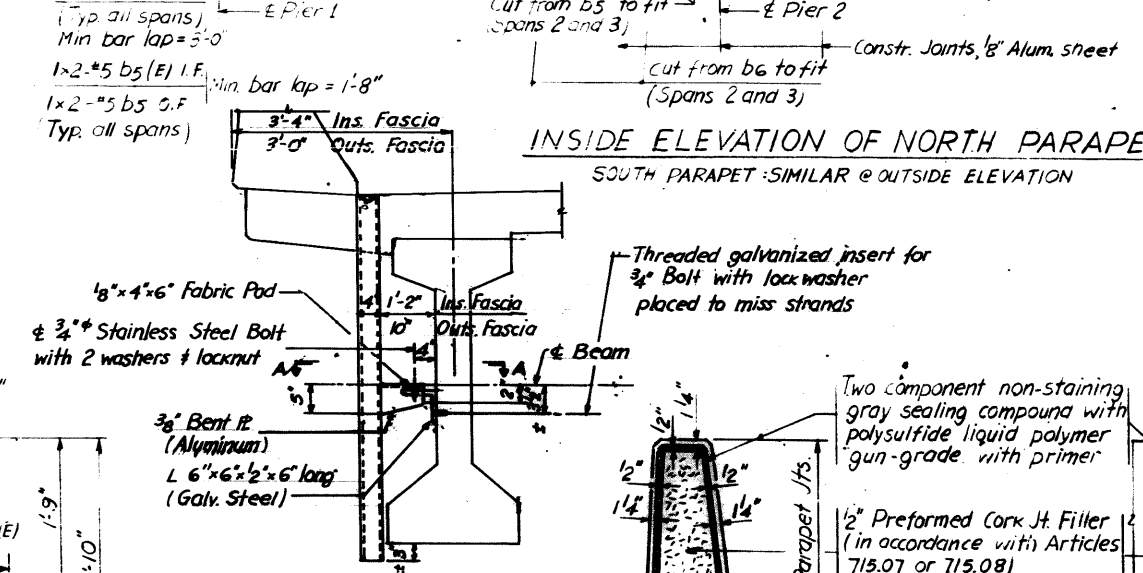

SUPERSTRUCTURE BILL OF MATERIAL *

Bar	No	Size	Length	Shape
a1(E)	540	#5	42'-9"	
a2(E)	362	#5	42'-9"	
a3(E)	544	#6	4'-0"	
a4(E)	38	#7	4'-6"	
a5	216	#6	2'-10"	
a6	4	#7	42'-9"	
a7	4	#7	42'-9"	
b1(E)	288	#5	28'-0"	
b2(E)	240	#5	23'-6"	
b3	45	#6	23'-0"	
b4	216	#5	30'-3"	
b5	180	#5	24'-0"	
b6	20	#5	29'-6"	
b7	20	#8	30'-6"	
d	580	#4	5'-2"	L
d1(E)	620	#5	3'-11"	L
d2(E)	12	#5	4'-2"	L
e	144	#4	14'-2"	
e1	72	#4	16'-8"	
e2	24	#4	0'-8"	
m	24	#4	4'-0"	
m1	2	#6	4'-3"	
s	30	#4	10'-9"	U
s1	12	#5	3'-0"	U
x(E)	120	#6	7'-7"	
x1(E)	360	#6	7'-5"	
Reinforcement Bars	Lbs		56400	
Reinforcement Bars (Epoxy Coated)	Lbs		339.0	
Class X Concrete	Cu. Yds		430	
Hand-off Removal	Sq. Ft		66	
Preformed Joint Seal	Lbs		5670	
Preformed Joint Seal	Sq. Yds		136	
Preformed Joint Seal	Sq. Yds		1628	

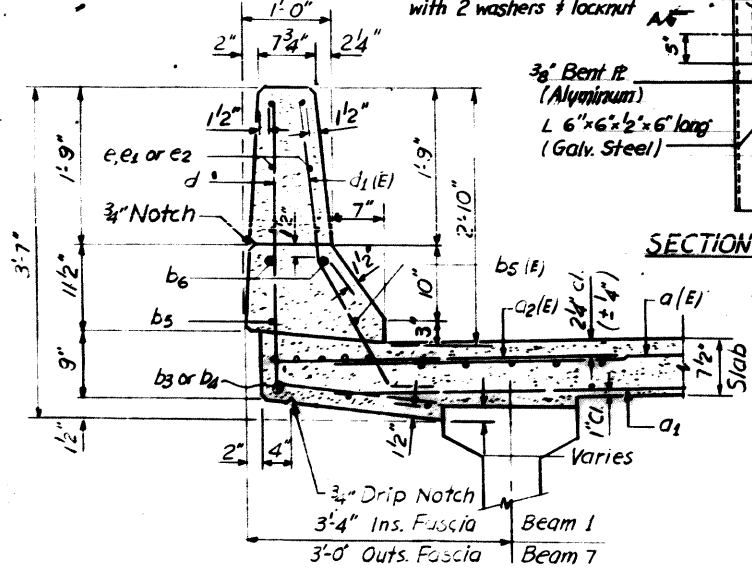

PARAPET JOINT DETAILS

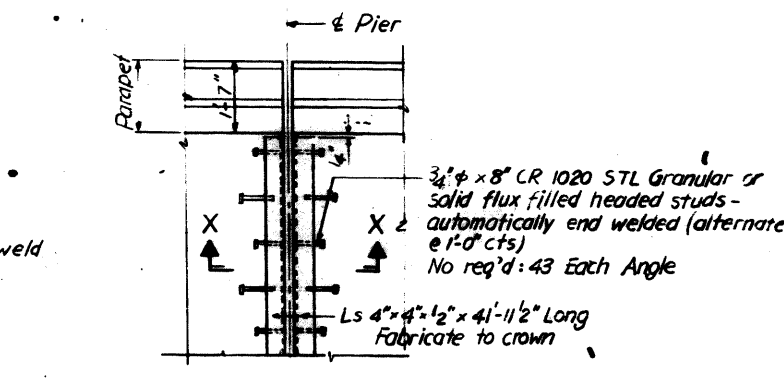

SECTION THRU PARAPET

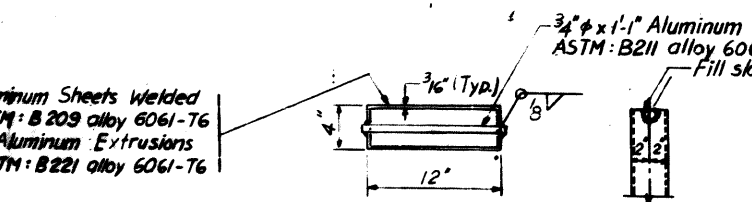

FLOOR DRAIN
Cost incidental to Class X Concrete

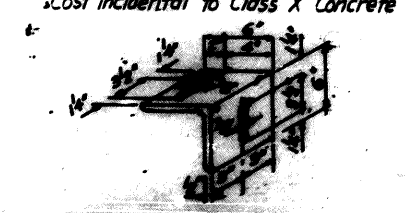

EXPANSION DEVICE PLAN
Piers 3 and 4

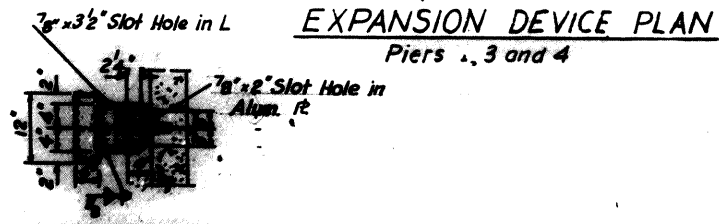

END OF SEAL TREATMENT

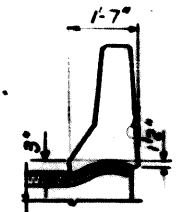

SECTION X-X

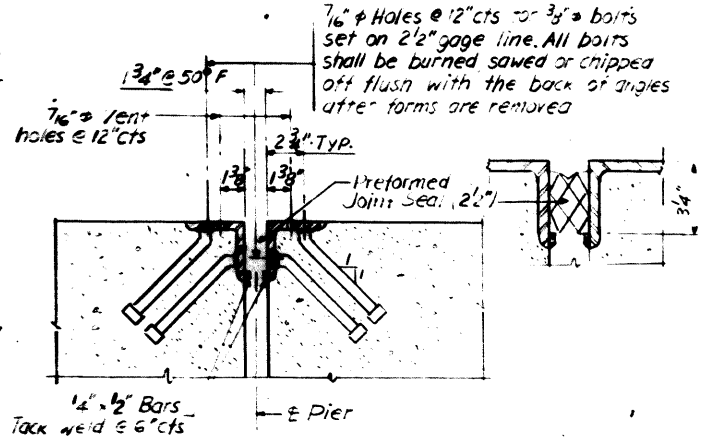

PREFORMED JOINT SEAL

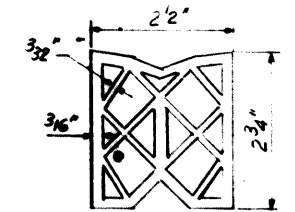

DESIGNED BY: P.X.
DRAWN BY: B.B.
CHECKED BY: P.X.

STATE OF ILLINOIS
DEPARTMENT OF TRANSPORTATION
F.A.I. ROUTE 80 DU PAGE RIVER
PARAPET, BILL OF MATERIAL
SECTION 99-18-BR-79
WILL COUNTY
STATION 1911+03.33
ZANTHAKOS LTD
CHICAGO, ILLINOIS

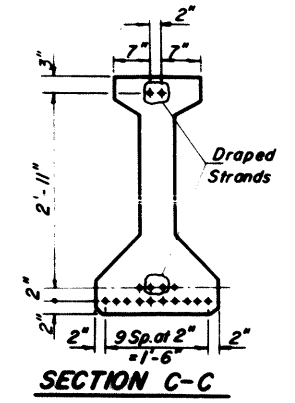
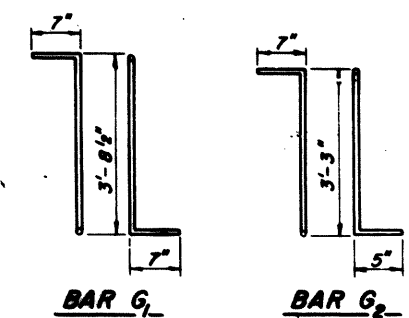
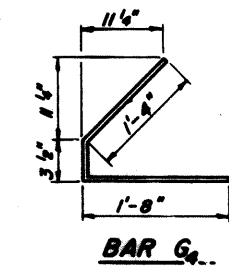
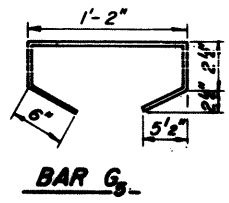
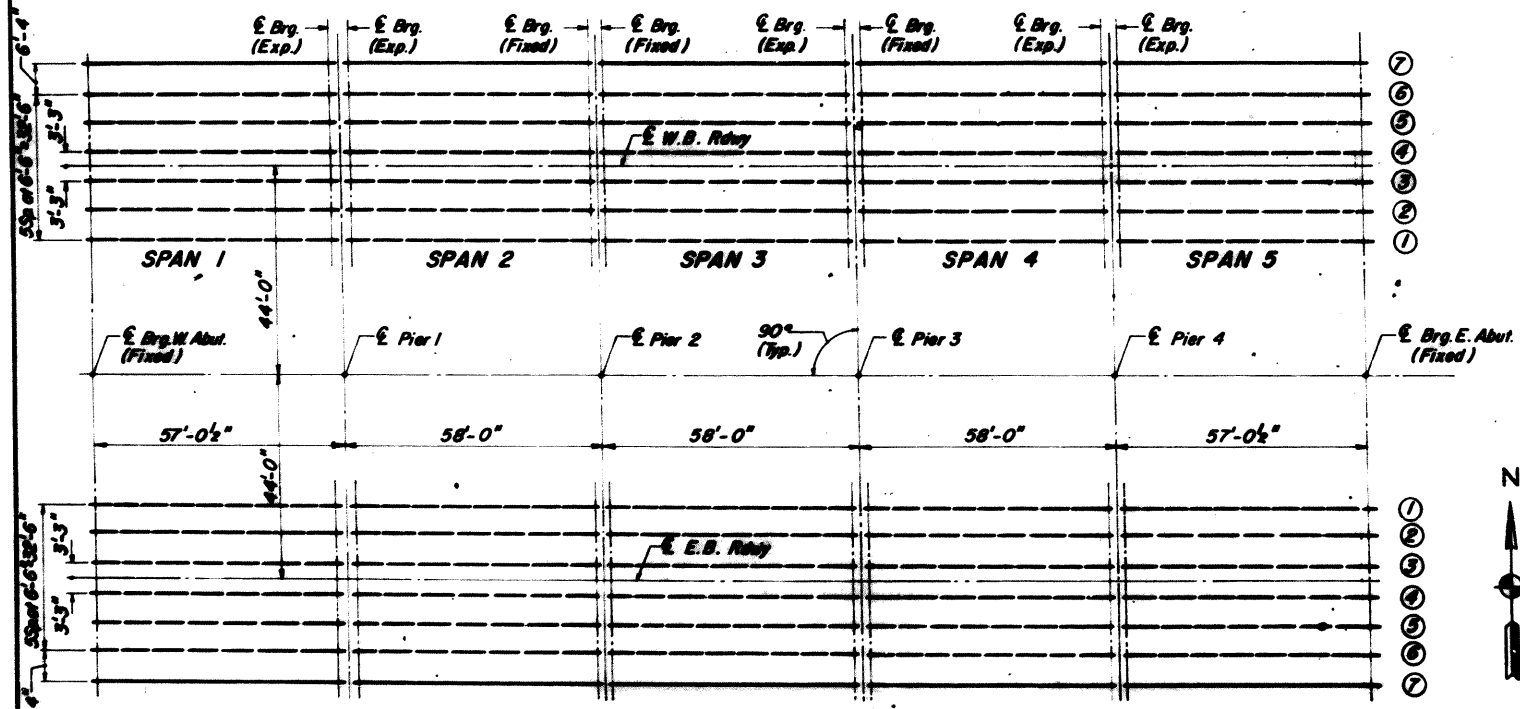
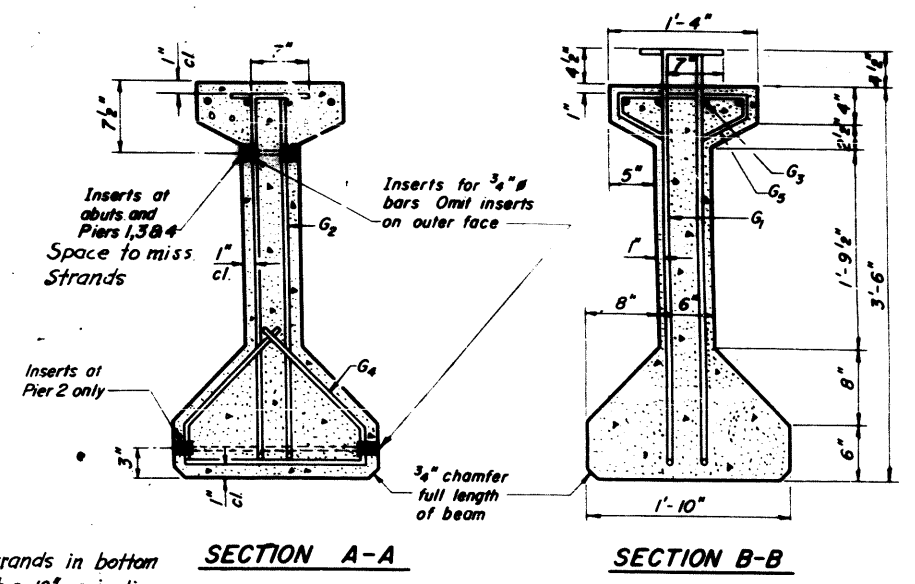
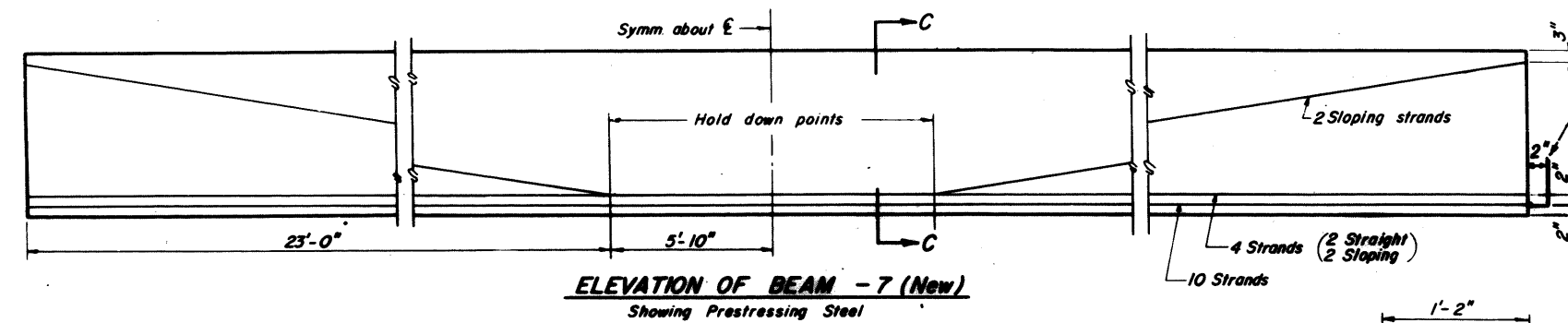
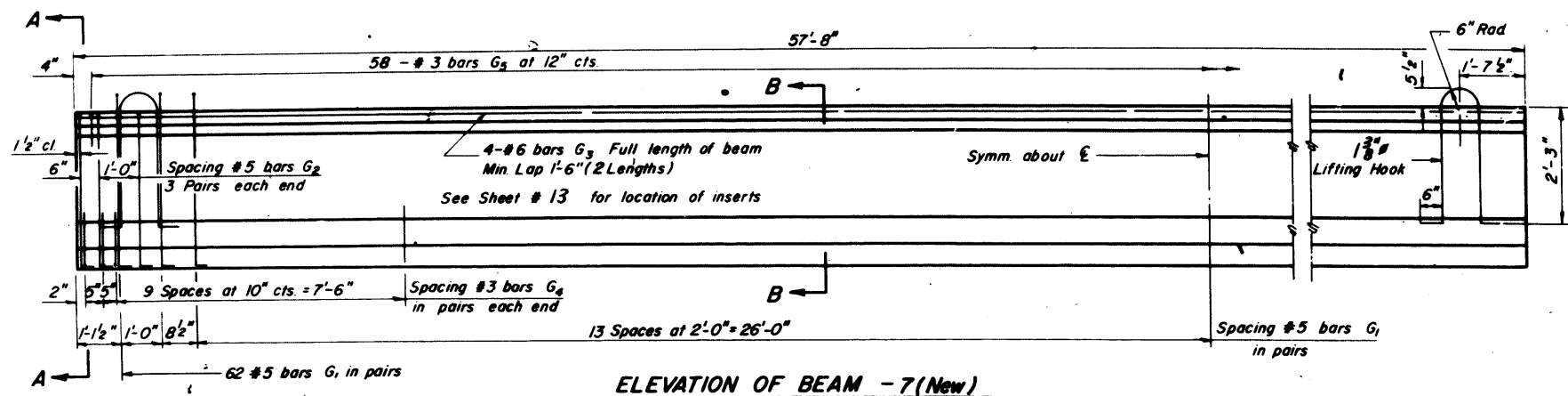

*** BAR LIST**

Bar	No	Size	Length	Shape
G1	62	#5	4'-10 1/2"	TL
G2	12	#5	4'-3"	TL
G3	8	#6	2'-6"	—
G4	48	#3	3'-3 1/2"	L
G5	58	#3	2'-7"	□

* For one beam only

NOTES

All inserts and, threaded rods for inserts, reinforcing and Prestressing Steel, and other items which are cast into the Precast Concrete I-Beams shall be included in the contract unit price per lineal foot of "Furnishing And Erecting Precast Prestressed Concrete I-Beams, 42 in."

Prestressing Steel shall have a nominal diameter of 1/2".

Inserts for 3/4" threaded rods are to be single coil, flared loop type.

Steel for lifting hooks shall be non-deformed bars fy = 40,000 psi.

BILL OF MATERIAL (ONE ROADWAY)

Item	Unit	Total
Furnishing & Erecting Precast Prestressed Concrete I-Beams, 42"	Lin Ft	288

STATE OF ILLINOIS
 DEPARTMENT OF TRANSPORTATION
 F.A.I. ROUTE 80/DU PAGE RIVER
 PRESTRESSED PRECAST CONCRETE BEAMS
 SECTION 99-18-BR-79
 WILL COUNTY
 STATION 1911+03.33

DESIGNED BY: P.X.
 DRAWN BY: G.C.
 CHECKED BY: P.X.

NOTE: Beam length shown above is based on dimensions and centers along E of roadway unless from existing plans. Any variations in field measurements of 1" may be compensated for by varying end beam distances. Dimensions of inserts and length of beams shall be checked.

ROUTE NO.	SECTION	COUNTY	TOTAL SHEETS	SHEET NO.
F.A.I. RTE 80	99-1B-BR-79	WILL	18	16
FED. RD. DISTR. 7 ILLINOIS FED. AID PROJ.				

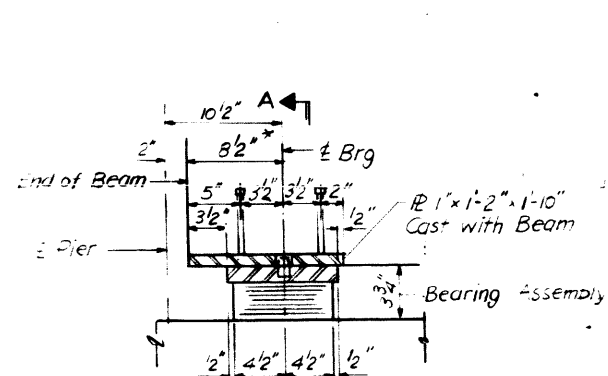

SECTION ALONG BEAM

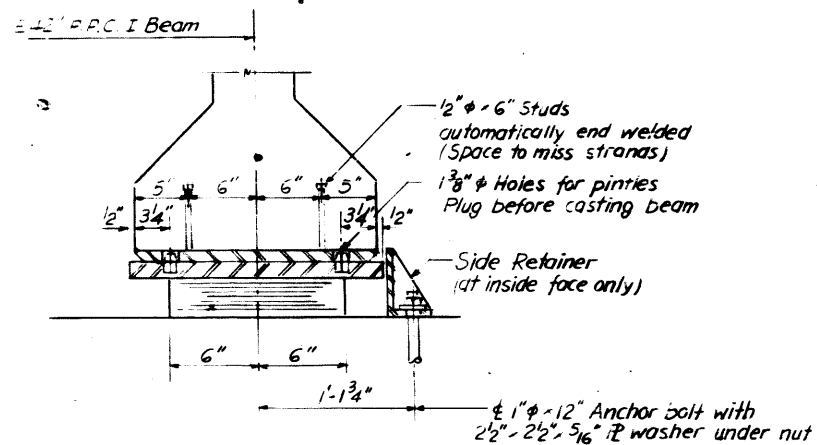

SECTION A-A

TYPE I ELASTOMERIC E/P BEARING

BEAM 7 at Pier 1 & 4 Both Sides
Pier 3 Span 3

1/2" x 6" Studs automatically end welded (Space to miss strands)
1 3/8" Holes for pintles Plug before casting beam
Side Retainer (at inside face only)
1" x 12" Anchor bolt with 2 1/2" x 2 1/2" x 5/16" P washer under nut

Note: After beams have been erected holes at expansion bearings shall be drilled and anchor bolts grouted in place

* End beam distance can be varied to accommodate variations in field measurements (See also Note about beam length Sht. 15)

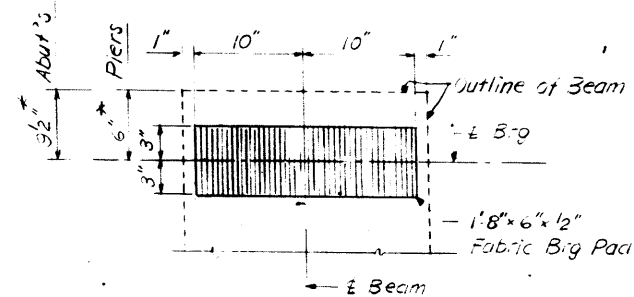

FIXED BEARING

BEAM 7: West and East Abutment
Pier 2 Both sides
Pier 3 Span 4

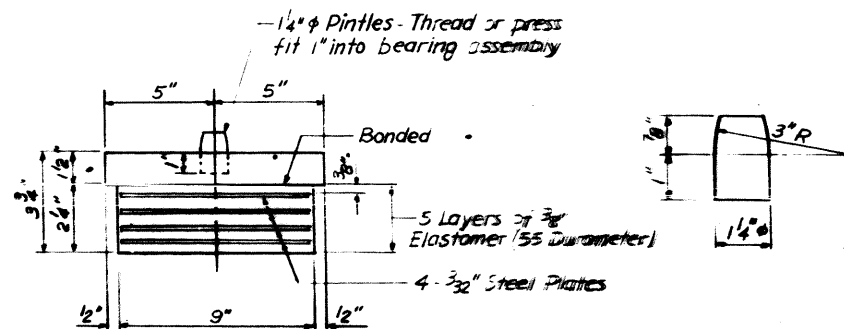

BEARING ASSEMBLY

Note: Shim plates shall not be placed under bearing assembly

BILL OF MATERIAL (one Bridge)

ITEM	QUANTITY
Elastomeric Bearings-Type I	5

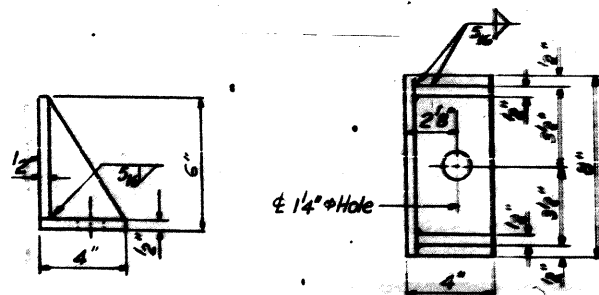

SIDE RETAINER

DESIGNED BY: J.S.
DRAWN BY: J.S.
CHECKED BY: J.S.

STATE OF ILLINOIS
DEPARTMENT OF TRANSPORTATION
F.A.I. ROUTE 80/DU PAGE RIVER
BEARING DETAILS
SECTION 99-1B-BR-79
WILL COUNTY
STATION 1911+03.33

P. XANTHAKOS LTD
CHICAGO, ILLINOIS

SHEET
16 OF 18

ROUTE NO.	SECTION	COUNTY	TOTAL SHEETS	SHEET NO.
F.A.I. RTE 80	99-18-BR-79	WILL	18	18
FED. RD DISTP	7	ILLINOIS	FED. AID PROJ.	

LOCATION	ELEV. "A"	ELEV. "B"	ELEV. "C"	DIM. "H"
Pier 1 W.B.	562.48	562.69	537.44	23'-0 1/2"
Pier 2 W.B.	562.49	562.49	540.49	20'-0"
Pier 3 W.B.	561.96	562.17	541.17	18'-9 1/2"
Pier 4 W.B.	561.69	561.91	535.91	23'-9 3/4"
Pier 1 E.B.	562.48	562.69	536.69	23'-9 1/2"
Pier 2 E.B.	562.49	562.49	540.49	20'-0"
Pier 3 E.B.	561.96	562.17	540.17	19'-9 1/2"
Pier 4 E.B.	561.69	561.91	535.91	23'-9 3/4"

Note: Elev. "B" (Top of Exist. Pier) shown in Table was obtained from the original Bridge Plans and checked in field. Variations up to 1/2" may be expected. Dimension "H" was computed from Elevations "A" and "C"

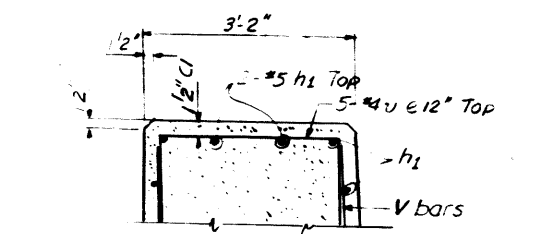

SECTION THRU TOP OF PIER (TYP)

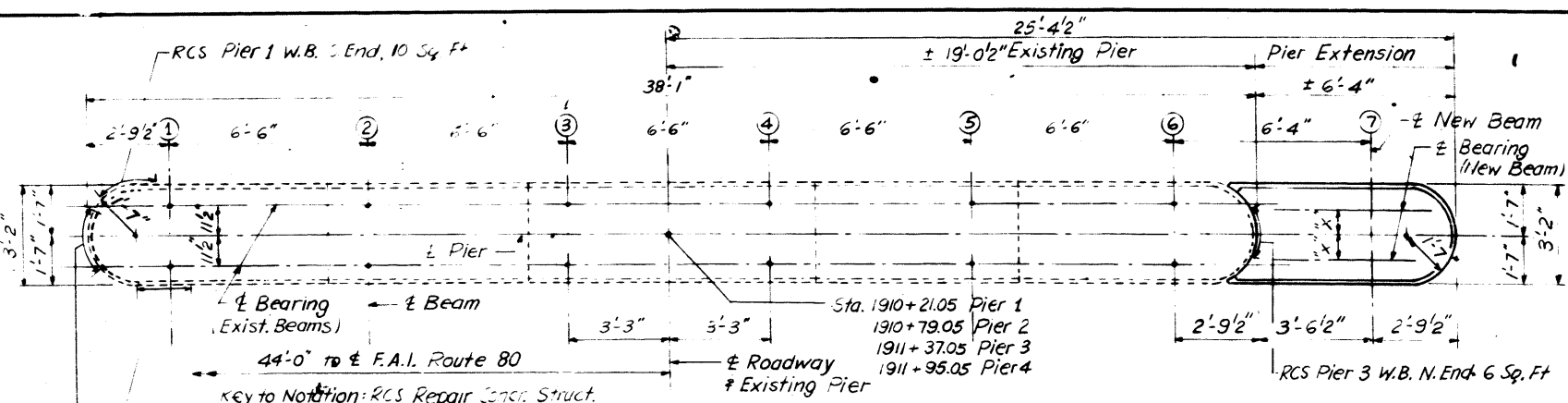

TOP PLAN

Key to Notation: RCS Repair Concr. Struct.
 RCS Pier 1 W.B. S. End, 10 Sq. Ft.
 RCS Pier 2 W.B. S. End, 6 Sq. Ft.
 RCS Pier 3 W.B. S. End, 6 Sq. Ft.
 RCS Pier 4 W.B. S. End, 6 Sq. Ft.
 RCS Pier 1 E.B. N. End, 10 Sq. Ft.

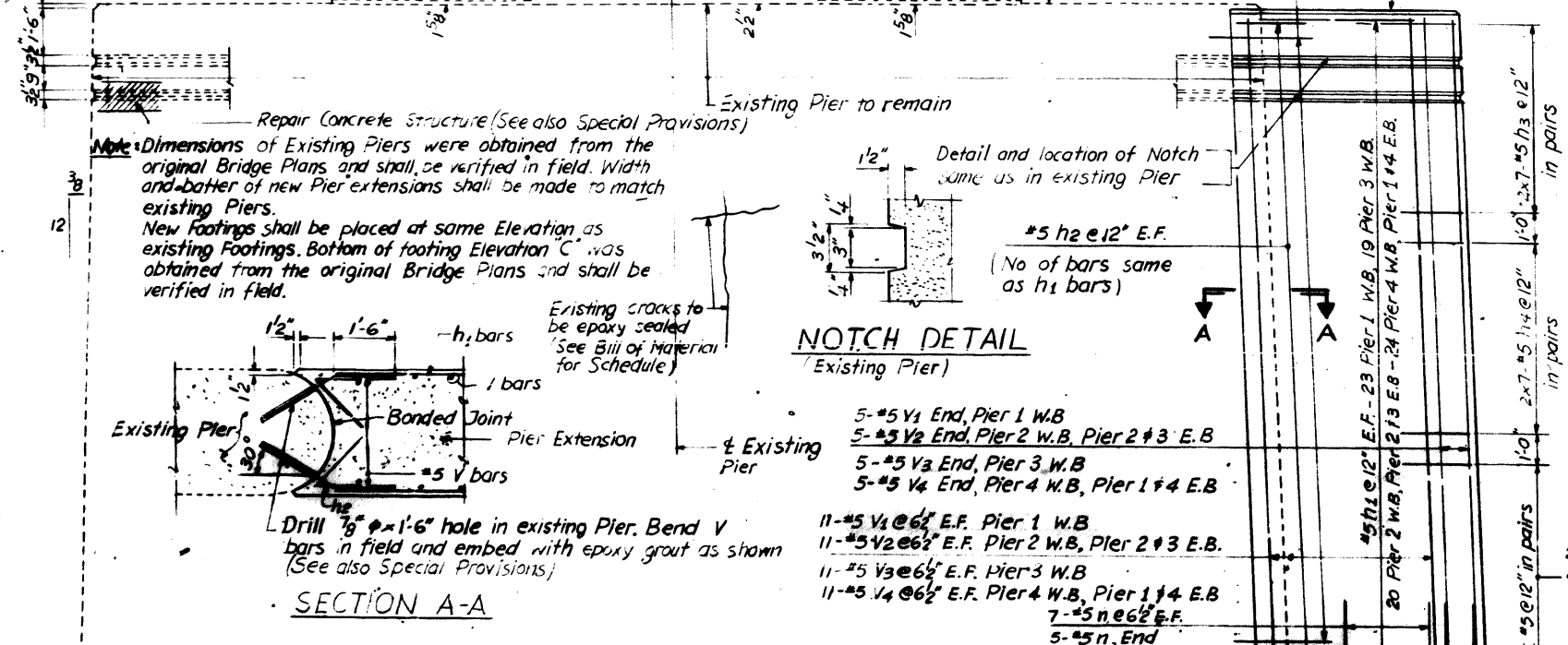

SECTION A-A

Repair Concrete Structure (See also Special Provisions)
 Note: Dimensions of Existing Piers were obtained from the original Bridge Plans and shall be verified in field. Width and batter of new Pier extensions shall be made to match existing Piers.
 New Footings shall be placed at same Elevation as existing Footings. Bottom of footing Elevation "C" was obtained from the original Bridge Plans and shall be verified in field.
 Existing cracks to be epoxy sealed (See Bill of Material for Schedule)

LOCATION	"X"
Pier 1 & 4 both sides	10'-2"
Pier 2, both sides	8"

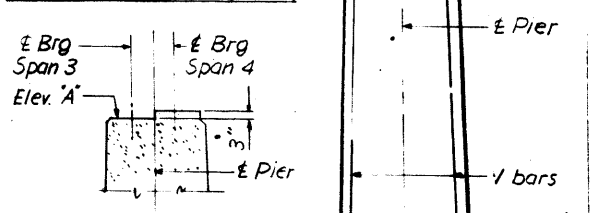

SECTION THRU TOP PIER 3 ONLY (PIER EXTENSION)

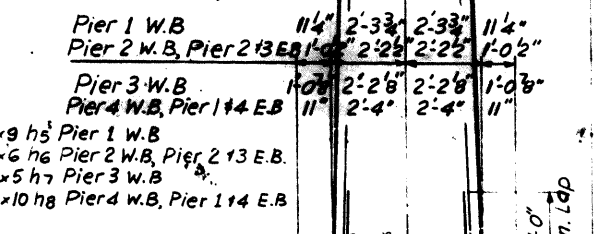

END VIEW

BILL OF MATERIAL

Bar	NO. W.B.				NO. E.B.				Size	Length	Shape
	Pier 1	Pier 2	Pier 3	Pier 4	Pier 1	Pier 2	Pier 3	Pier 4			
h1	48	22	40	50	50	42	42	50	#5	5'-0"	
h2	46	40	38	48	48	40	40	48	#5	4'-0"	L
h3	14	14	14	14	14	14	14	14	#5	4'-7"	
h4	14	14	14	14	14	14	14	14	#5	4'-11"	
h5	18								#5	5'-6"	
h6		12			12	12			#5	5'-3"	
h7		10							#5	5'-1"	
h8			20	20			20		#5	5'-8"	
n	19	19	19	19	19	19	19	19	#5	4'-4"	
t1	7	7	7	7	7	7	7	7	#6	6'-2"	
v	47	41	39	49	49	41	41	49	#5	3'-6"	
v1	27								#5	22'-9"	
v2		27			27	27			#5	19'-8"	
v3			27				27		#5	18'-6"	
v4				27				27	#5	23'-6"	
u	5	5	5	5	5	5	5	5	#4	5'-10"	
w1	3	3	3	3	3	3	3	3	#4	6'-0"	

WEST BOUND BRIDGE

ITEM	UNIT	QUANTITY			
		Pier 1	Pier 2	Pier 3	Pier 4
Class "X" Concrete	Cu. Yds	2.41	20.8	19.7	24.9
Reinforcement Bars	Lbs	1670	1510	450	1730
Cofferdam, Excavitation	Cu. Yds	19.6	9.7	7.6	24.6
Rock Excav. for Struct.	Cu. Yds	2.3	2.3	2.3	2.3
Repair Concrete Structure	Sq. Ft.	16	6	16	-
Cofferdams	Each	1	1	1	1

EAST BOUND BRIDGE

ITEM	UNIT	QUANTITY			
		Pier 1	Pier 2	Pier 3	Pier 4
Class "X" Concrete	Cu. Yds	24.9	20.8	20.7	24.9
Reinforcement Bars	Lbs	1730	1470	1470	1730
Cofferdam, Excavitation	Cu. Yds	22.0	9.7	10.8	24.6
Rock Excav. for Struct.	Cu. Yds	2.3	2.3	2.3	2.3
Repair Concrete Structure	Sq. Ft.	10	-	-	-
Cofferdams	Each	1	1	1	1

Epoxy Crack Sealing	-in. Ft.	QUANTITY		
		Pier 1 W.B.	Pier 3 W.B.	Pier 4 E.B.
		40	35	50

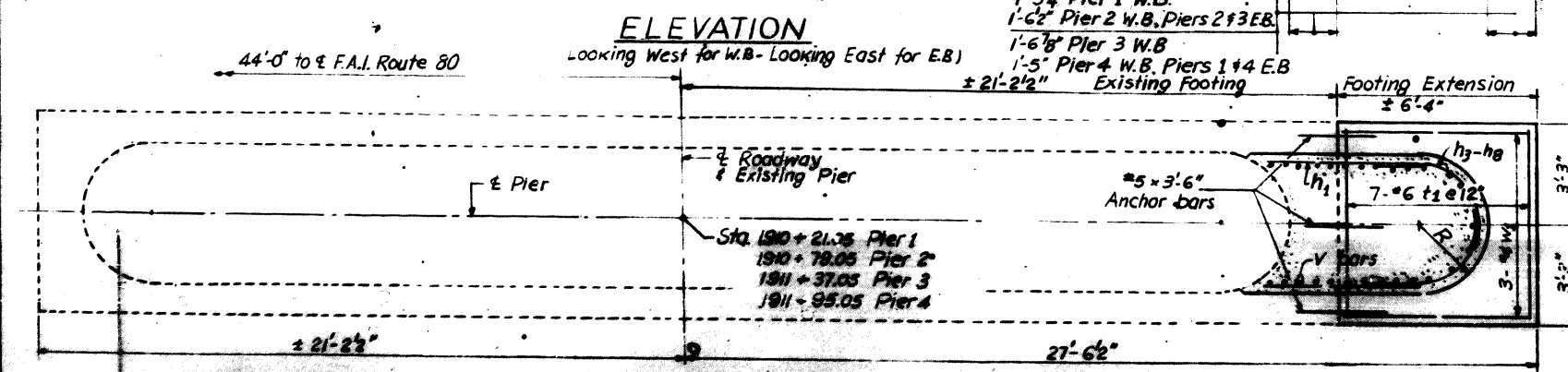

ELEVATION

FOOTING PLAN

Looking West for W.B. - Looking East for E.B.
 Stationing: Sta. 1910+21.05 Pier 1, 1910+79.05 Pier 2, 1911+37.05 Pier 3, 1911+95.05 Pier 4.
 Note: Undercut Shale layer 6" below Elev. "C" (bottom of exist. Footing) and immediately pour a 6" thick concrete seal coat. Cost incidental.

DESIGN FOOTING PRESSURE: 6000 Lbs per sq. ft.

DESIGNED BY: P.L.
 DRAWN BY: S.B.
 CHECKED BY: P.L.

STATE OF ILLINOIS
 DEPARTMENT OF TRANSPORTATION
 F.A.I. ROUTE 80/DU PAGE RIVER
 PIERS
 SECTION 99-18-BR-79
 WILL COUNTY
 STATION 1911+03.33
 P. XANTHAKOS LTD
 CHICAGO, ILLINOIS

SHEET 18 OF 18