

STATE OF ILLINOIS  
DEPARTMENT OF TRANSPORTATION

F.A.P. RTE.	SECTION	COUNTY	TOTAL SHEETS	SHEET NO.
320	D7 BRIDGE REPAIRS 2024-7	MACON	21	1
		ILLINOIS	CONTRACT NO. 74B33	

FOR INDEX OF SHEETS, SEE SHEET NO. 2  
ADT (2021) = 3800

PROPOSED  
HIGHWAY PLANS

FAP 320 (IL 121)  
SECTION D7 BRIDGE REPAIRS 2024-7  
PROJECT NHPP-6ZF7(276)  
BRIDGE DECK OVERLAY  
MACON COUNTY

C-97-101-22

D-97-054-22



LOGAN /MACON COUNTY LINE

JOB LOCATION  
SN: 058-0129



GROSS LENGTH = 768 FT. = 0.15 MILE

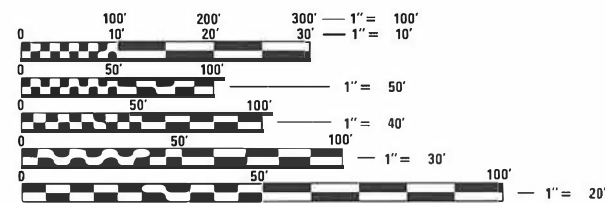

FULL SIZE PLANS HAVE BEEN PREPARED USING STANDARD ENGINEERING SCALES. REDUCED SIZED PLANS WILL NOT CONFORM TO STANDARD SCALES. IN MAKING MEASUREMENTS ON REDUCED PLANS, THE ABOVE SCALES MAY BE USED.

J.U.L.I.E.  
JOINT UTILITY LOCATION INFORMATION FOR EXCAVATORS  
1-800-892-0123  
OR 811

PROJECT ENGINEER - MATT BOWER  
PROJECT MANAGER - KYLE PRICE

CONTRACT NO. 74B33

STATE OF ILLINOIS  
DEPARTMENT OF TRANSPORTATION

SUBMITTED AUGUST 24 2023  
Jeffrey P. Mynors REGIONAL ENGINEER  
October 13, 2023  
Scott A. Etk  
ENGINEER OF DESIGN AND ENVIRONMENT  
October 13, 2023  
Stephen McAnis  
DIRECTOR OF HIGHWAYS PROJECT IMPLEMENTATION

PRINTED BY THE AUTHORITY  
OF THE STATE OF ILLINOIS

INDEX OF SHEETS

1	PLAN SHEET
2	GENERAL NOTES, INDEX STANDARDS
3-4	SUMMARY OF QUANTITIES
5	SCHEDULE OF QUANTITIES
6-7	TYPICAL SECTIONS
8-13	PLAN VIEWS
14-16	BRIDGE REPAIR PLANS
17	BUTT JOINT
18-21	DISTRICT STANDARD 78000001

GENERAL NOTES

THIS PROJECT IS LOCATED ON FAP ROUTE 320 (ILL 121) IN MACON COUNTY, AT SOUTH FORK CREEK 0.7 MILE EAST OF LOGAN COUNTY LINE. THE WORK INCLUDED IN SECTION D7 BRIDGE REPAIRS 2024-7 CONSISTS OF BRIDGE DECK OVERLAY, AND ANY OTHER WORK NECESSARY TO COMPLETE THE SECTION.

PLAN DIMENSIONS AND DETAILS RELATIVE TO THE EXISTING STRUCTURE HAVE BEEN TAKEN FROM EXISTING PLANS AND ARE SUBJECT TO NOMINAL CONSTRUCTION VARIATIONS. IT SHALL BE THE CONTRACTORS RESPONSIBILITY TO VERIFY DIMENSIONS AND DETAILS IN THE FIELD AND MAKE NECESSARY APPROVED ADJUSTMENTS PRIOR TO CONSTRUCTION OR ORDERING OF MATERIAL. SUCH VARIATIONS SHALL NOT BE CAUSE FOR ADDITIONAL COMPENSATION FOR A CHANGE IN THE SCOPE OF THE WORK. THE CONTRACTOR WILL BE PAID FOR THE QUANTITY FURNISHED AT THE UNIT PRICE BID FOR THE WORK.

THE EXISTING PAVEMENT MARKINGS THAT CONFLICT WITH STAGE I & II OF STANDARD 701321 SHALL BE COVERED WITH PAVEMENT MARKING BLACKOUT TAPE, 5".

MILLED PAVEMENT SHALL BE RESURFACED WITHIN 5 CALENDAR DAYS.

AGGREGATE WEDGE SHOULDERS SHALL BE RAP MILLINGS.

THE SHOULDERS SHALL BE RESURFACED SIMULTANEOUSLY AS THE MAINLINE UTILIZING THE SAME BINDER COURSE AND SURFACE COURSE MATERIALS AS THE MAINLINE RESURFACING TO ELIMINATE A JOINT BETWEEN SHOULDERS AND LANES.

STD. NO.	DESCRIPTION
000001 - 08	STANDARD SYMBOLS, ABBREVIATIONS, AND PATTERNS
001001 - 02	AREAS OF REINFORCEMENT BARS
001006	DECIMAL OF AN INCH AND OF A FOOT
420001-10	PAVEMENT JOINTS
701001 - 02	OFF-ROAD OPERATIONS, 2L, 2W, MORE THAN 15' (4.5 M) AWAY
701006 - 05	OFF-ROAD OPERATIONS, 2L, 2W, 15' (4.5 M) TO 24" (600 MM) FROM PAVEMENT EDGE
701011 - 04	OFF-ROAD MOVING OPERATIONS, 2L, 2W, DAY ONLY
701311 - 03	LANE CLOSURE 2L, 2W MOVING OPERATIONS-DAY ONLY
701321 - 18	LANE CLOSURE, 2L, 2W, BRIDGE REPAIR WITH BARRIER
701326 - 04	LANE CLOSURE, 2L, 2W, PAVEMENT WIDENING, FOR SPEEDS $\geq$ 45 MPH
701901 - 08	TRAFFIC CONTROL DEVICES
704001 - 08	TEMPORARY CONCRETE BARRIER
780001 - 05	TYPICAL PAVEMENT MARKINGS
781001 - 04	TYPICAL APPLICATIONS RAISED REFLECTIVE PAVEMENT MARKERS
782006 - 01	GUARDRAIL AND BARRIER WALL REFLECTOR MOUNTING DETAILS

THE FOLLOWING MIXTURE REQUIREMENTS ARE APPLICABLE TO THIS PROJECT:

LOCATION(S)	MIXTURE USE(S)	PG	DESIGN AIR VOIDS	MIXTURE COMPOSITION	FRICTION AGGREGATE	MIXTURE WEIGHT	QUALITY MANAGEMENT PROGRAM	SUBLOT SIZE	MATERIAL TRANSFER DEVICE (REQUIRED?)
MAINLINE	POLYMERIZED HMA SURFACE COURSE, IL-9.5, MIX "D", N90	PG 70-22	4.0% @ N=90	IL - 9.5	MIXTURE D	N90	QC/QA	3000	N/A
MAINLINE	POLYMERIZED HMA BINDER COURSE, IL-9.5FG, N90	PG 70-22	4.0% @ N=90	IL - 9.5FG	N/A	N90	QC/QA	3000	N/A

REV. - MS

MODEL: Default  
 FILE NAME: P:\Public\sw\_bentley.com\p\100001\Documents\DOT\_Offices\District\_7\Projects\74833\CADD\data\CAD\sheet\074833-18-gennote.dgn

USER NAME = Mona.Steffen	DESIGNED -	REVISED -	<b>STATE OF ILLINOIS DEPARTMENT OF TRANSPORTATION</b>	<b>GENERAL NOTES, INDEX OF SHEETS, STANDARDS &amp; MIX DESIGN</b>	F.A.P. RTE.	SECTION	COUNTY	TOTAL SHEETS	SHEET NO.
DRAWN -	REVISED -	320			D7 BRIDGE REPAIRS 2024-7	MACON	21	2	
PLOT SCALE = 100.0000' / in.	CHECKED -	REVISED -			CONTRACT NO. 74833				
PLOT DATE = 8/25/2023	DATE -	REVISED -			ILLINOIS FED. AID PROJECT				
				SCALE:	SHEET	OF	SHEETS	STA.	TO STA.

80% FED  
20% STATE

80% FED  
20% STATE

SUMMARY OF QUANTITIES			TOTAL QUANTITIES	CONSTRUCTION TYPE CODE		
CODE NO	ITEM	UNIT		0059		
35400400	PORTLAND CEMENT CONCRETE BASE COURSE WIDENING 9"	SQ YD	290	290		
40600290	BITUMINOUS MATERIALS (TACK COAT)	POUND	861	861		
40600990	TEMPORARY RAMP	SQ YD	80	80		
40603219	POLYMERIZED HOT-MIX ASPHALT BINDER COURSE, IL-9.5FG, N90	TON	94	94		
40604164	POLYMERIZED HOT-MIX ASPHALT SURFACE COURSE, IL-9.5, MIX "D", N90	TON	114	114		
44000155	HOT-MIX ASPHALT SURFACE REMOVAL, 1 1/2"	SQ YD	1116	1116		
44004250	PAVED SHOULDER REMOVAL	SQ YD	290	290		
48102100	AGGREGATE WEDGE SHOULDER, TYPE B	TON	32	32		
50300300	PROTECTIVE COAT	SQ YD	675	675		
67100100	MOBILIZATION	L SUM	1	1		
70100405	TRAFFIC CONTROL AND PROTECTION, STANDARD 701321	EACH	1	1		

SUMMARY OF QUANTITIES			TOTAL QUANTITIES	CONSTRUCTION TYPE CODE		
CODE NO	ITEM	UNIT		0059		
70100500	TRAFFIC CONTROL AND PROTECTION, STANDARD 701326	L SUM	1	1		
70106500	TEMPORARY BRIDGE TRAFFIC SIGNALS	EACH	1	1		
70106700	TEMPORARY RUMBLE STRIPS	EACH	6	6		
70107005	PAVEMENT MARKING BLACKOUT TAPE, 5"	FOOT	1061	1061		
70107025	CHANGEABLE MESSAGE SIGN	CAL DA	28	28		
70300100	SHORT TERM PAVEMENT MARKING	FOOT	266	266		
70300150	SHORT TERM PAVEMENT MARKING REMOVAL	SQ FT	531	531		
70400100	TEMPORARY CONCRETE BARRIER	FOOT	500	500		
70400125	PINNING TEMPORARY CONCRETE BARRIER	EACH	12	12		
70400200	RELOCATE TEMPORARY CONCRETE BARRIER	FOOT	500	500		
70600250	IMPACT ATTENUATORS, TEMPORARY (NON- REDIRECTIVE), TEST LEVEL 3	EACH	2	2		
70600350	IMPACT ATTENUATORS, RELOCATE (NON- REDIRECTIVE), TEST LEVEL 3	EACH	2	2		

MODEL: Default  
 FILE: \\nafe-pw-backend.com\FW\DOT\Documents\DOT Office\Director\_T\Project\74833\CAD\Drawings\CAD\Sheet\74833-415-500.dgn

USER NAME = Mona.Steffen	DESIGNED -	REVISED -
PLOT SCALE = 100,0000' / in.	DRAWN -	REVISED -
PLOT DATE = 8/23/2023	CHECKED -	REVISED -
	DATE -	REVISED -

**STATE OF ILLINOIS  
DEPARTMENT OF TRANSPORTATION**

**SUMMARY OF QUANTITIES**

SCALE: SHEET OF SHEETS STA. TO STA.

F.A.P. RTE.	SECTION	COUNTY	TOTAL SHEETS	SHEET NO.
320	D7 BRIDGE REPAIRS 2024-7	MACON	21	3
ILLINOIS FED. AID PROJECT			CONTRACT NO. 74833	



## PAVING, BUTT JOINTS, TEMP RAMPS

STATION	TO	STATION	LENGTH	WIDTH	AREA	AREA	BINDER COURSE	SURFACE COURSE	BITUMINOUS MATERIALS (TACK COAT)	POLYMERIZED HMA BINDER COURSE, IL-9.5FG, N90 (1 1/2")	POLYMERIZED HMA SURFACE COURSE, IL-9.5, MIX "D", N90 (1 1/2")	HOT-MIX ASPHALT SURFACE REMOVAL, 1 1/2"	TEMPORARY RAMP	AGGREGATE WEDGE SHOULDER, TYPE B
							THICKNESS	THICKNESS	40600290	40603219	40604164	44000155	40600990	48102100
			FEET	FEET	SQ FT	SQ YD	INCH	INCH	POUND	TON	TON	SQ YD	SQ YD	TON
477+25.00		477+55.00	30.0	36.0	1080.0	120.0	1.5	1.5	81.0	10.1	10.1	120.0	13.3	2.8
477+55.00		478+64.00	109.0	36.0	3924.0	436.0	1.5	1.5	294.3	36.6	36.6	436.0		10.3
478+64.00		478+94.00	30.0	36.0	1080.0	120.0		1.5	54.0		10.1		26.7	2.8
<b>BRIDGE OMISSION 478+94 TO 480+67</b>														
480+67.00		480+97.00	30.0	36.0	1080.0	120.0		1.5	54.0		10.1		26.7	2.8
480+97.00		482+07.00	110.0	36.0	3960.0	440.0	1.5	1.5	297.0	37.0	37.0	440.0		10.4
482+07.00		482+37.00	30.0	36.0	1080.0	120.0	1.5	1.5	81.0	10.1	10.1	120.0	13.3	2.8
							<b>TOTALS</b>		<b>861</b>	<b>94</b>	<b>114</b>	<b>1116</b>	<b>80</b>	<b>32</b>

## PCC BASE COURSE WIDENING

STATION	TO	STATION	LOCATION	PCC BASE COURSE WIDENING	PAVED SHOULDER REMOVAL
				35400400	44004250
				SQ YD	SQ YD
477+56		478+64	LT SHOULDER	72.0	72.0
477+55		478+64	RT SHOULDER	72.7	72.7
480+97		482+05	LT SHOULDER	72.0	72.0
480+97		482+07	RT SHOULDER	73.3	73.3
<b>TOTALS</b>				<b>290.0</b>	<b>290.0</b>

## PAVEMENT MARKINGS, RPMS

STATION	TO	STATION	LOCATION	PAVEMENT MARKING BLACKOUT TAPE, 5"	SHORT TERM PAVEMENT MARKING REMOVAL	SHORT TERM PAVEMENT MARKING	PAINT PAVEMENT MARKING - LINE 4"	TEMPORARY RUMBLE STRIPS	TEMPORARY BRIDGE TRAFFIC SIGNALS	RAISED REFLECTIVE PAVEMENT MARKER REMOVAL	RAISED REFLECTIVE PAVEMENT MARKER
				70107005	70300150	70300100	78001110	70106700	70106500	78300200	78100100
				FT	SQ FT	FT	FT	EACH	EACH	EACH	EACH
475+93		478+17	CENTERLINE	80	33						
481+45		483+61	CENTERLINE	80	33						
477+55		482+07	EOP RT	452	188						
477+56		482+05	EOP LT	449	187						
477+25		482+37	CENTERLINE		34	102	128			6	6
477+25		482+37	EOP RT		27	82	512				
477+25		482+37	EOP LT		27	82	512				
								3			
								3			
									1		
<b>TOTALS</b>				<b>1061</b>	<b>531</b>	<b>266</b>	<b>1152</b>	<b>6</b>	<b>1</b>	<b>6</b>	<b>6</b>

SKIPS  
SKIPS  
STAGE 1  
STAGE 2  
  
SKIPS  
EDGE  
EDGE

## BARRIER, ATTENUATORS

STATION	TO	STATION	LOCATION	TEMPORARY CONCRETE BARRIER	RELOCATE TEMPORARY CONCRETE BARRIER	IMPACT ATTENUATORS, TEMPORARY (NON-REDIRECTIVE), TEST LEVEL 3	IMPACT ATTENUATORS, RELOCATE (NON-REDIRECTIVE), TEST LEVEL 3	PINNING TEMPORARY CONCRETE BARRIER	NOTES
				70400100	70400200	70600250	70600350	70400125	
				FT	FT	FT	EACH	EACH	
477+28		482+34	CL	500.0		2		6	STAGE 1 (40 PCS)
477+28		482+34	CL		500.0		2	6	STAGE 2 (40 PCS)
<b>TOTALS</b>				<b>500.0</b>	<b>500.0</b>	<b>2</b>	<b>2</b>	<b>12</b>	

REV. - MS

MODEL: Default  
 FILE NAME: P:\Illinois\Bentley.com\PROJECTS\74833\CADD\DATA\CAD\DWG\74833-10-1-2023.dwg

USER NAME = Mona.Steffen	DESIGNED -	REVISED -
	DRAWN -	REVISED -
PLOT SCALE = 100.0000' / in.	CHECKED -	REVISED -
PLOT DATE = 8/23/2023	DATE -	REVISED -

**STATE OF ILLINOIS  
DEPARTMENT OF TRANSPORTATION**

### SCHEDULE OF QUANTITIES

SCALE: SHEET OF SHEETS STA. TO STA.

F.A.P. RTE.	SECTION	COUNTY	TOTAL SHEETS	SHEET NO.
320	D7 BRIDGE REPAIRS 2024-7	MACON	21	5
ILLINOIS FED. AID PROJECT			CONTRACT NO. 74833	

# TYPICAL PROPOSED CROSS SECTION

STA. 476+20 TO STA. 478+64

STA. 480+97 TO STA. 483+36

BRIDGE OMISSION

STA. 478+94 TO STA. 480+67

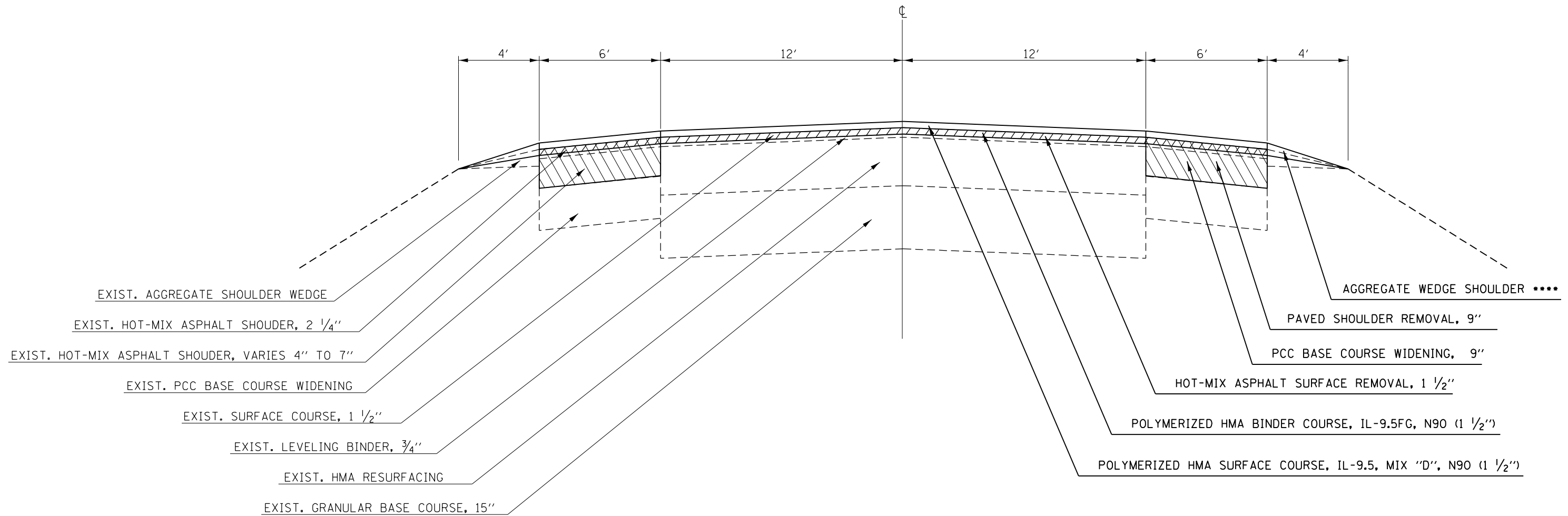

EXIST. AGGREGATE SHOULDER WEDGE

EXIST. HOT-MIX ASPHALT SHOULDER, 2 1/4"

EXIST. HOT-MIX ASPHALT SHOULDER, VARIES 4" TO 7"

EXIST. PCC BASE COURSE WIDENING

EXIST. SURFACE COURSE, 1 1/2"

EXIST. LEVELING BINDER, 3/4"

EXIST. HMA RESURFACING

EXIST. GRANULAR BASE COURSE, 15"

AGGREGATE WEDGE SHOULDER \*\*\*\*\*

PAVED SHOULDER REMOVAL, 9"

PCC BASE COURSE WIDENING, 9"

HOT-MIX ASPHALT SURFACE REMOVAL, 1 1/2"

POLYMERIZED HMA BINDER COURSE, IL-9.5FG, N90 (1 1/2")

POLYMERIZED HMA SURFACE COURSE, IL-9.5, MIX "D", N90 (1 1/2")

HOT-MIX ASPHALT SURFACE REMOVAL, 3/4"

\*\*\*\*\* AGGREGATE WEDGE SHALL BE RAP MILLINGS

NOTE: NOT DRAWN TO SCALE

MODEL: Default  
FILE: \\nafe-pw\ultra-pw-bead\p\com\p\w\DOT\Documents\DOT Office\Director\_7\Project\74833\CADD\DATA\CAD\Sheet\74833-4-1-23\p\scale.dgn

USER NAME = Mona.Steffen	DESIGNED -	REVISED -
	DRAWN -	REVISED -
PLOT SCALE = 30,0000 * / in.	CHECKED -	REVISED -
PLOT DATE = 8/23/2023	DATE -	REVISED -

**STATE OF ILLINOIS  
DEPARTMENT OF TRANSPORTATION**

**SECTION VIEW**

SCALE: SHEET OF SHEETS STA. TO STA.

F.A.P. RTE.	SECTION	COUNTY	TOTAL SHEETS	SHEET NO.
320	D7 BRIDGE REPAIRS 2024-7	MACON	21	6
CONTRACT NO. 74833				
ILLINOIS FED. AID PROJECT				

# TYPICAL PROPOSED CROSS SECTION

STA. 478+64 TO STA. 478+94

STA. 480+67 TO STA. 480+97

BRIDGE OMISSION

STA. 478+94 TO STA. 480+67

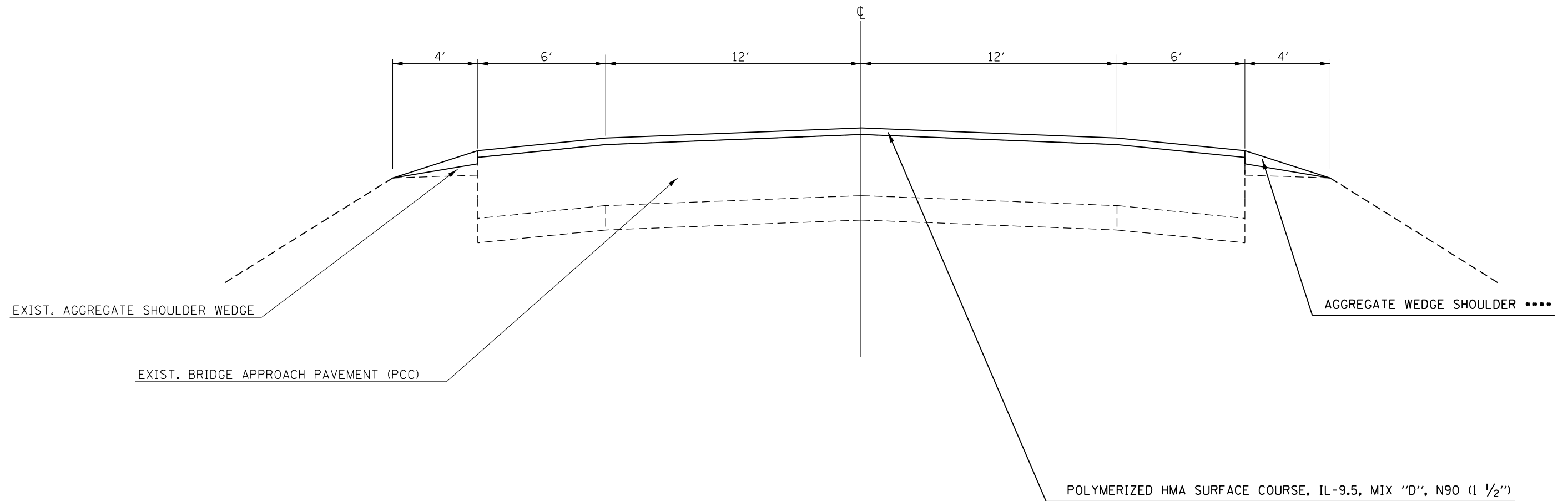

\*\*\*\* AGGREGATE WEDGE SHALL BE RAP MILLINGS

NOTE: NOT DRAWN TO SCALE

MODEL: Default  
 FILE NAME: p:\ultra\paw\beaufy.com\PIV\DOT\Documents\DOT Offices\Director\_7\Projects\74833\CADD\DATA\CAD\Sheets\74833-she\typical.dgn

USER NAME = Mona.Steffen	DESIGNED -	REVISED -
	DRAWN -	REVISED -
PLOT SCALE = 30,0000 * / in.	CHECKED -	REVISED -
PLOT DATE = 8/23/2023	DATE -	REVISED -

**STATE OF ILLINOIS  
DEPARTMENT OF TRANSPORTATION**

**SECTION VIEW**

SCALE: SHEET OF SHEETS STA. TO STA.

F.A.P. RTE.	SECTION	COUNTY	TOTAL SHEETS	SHEET NO.
320	D7 BRIDGE REPAIRS 2024-7	MACON	21	7
CONTRACT NO. 74833				
ILLINOIS FED. AID PROJECT				

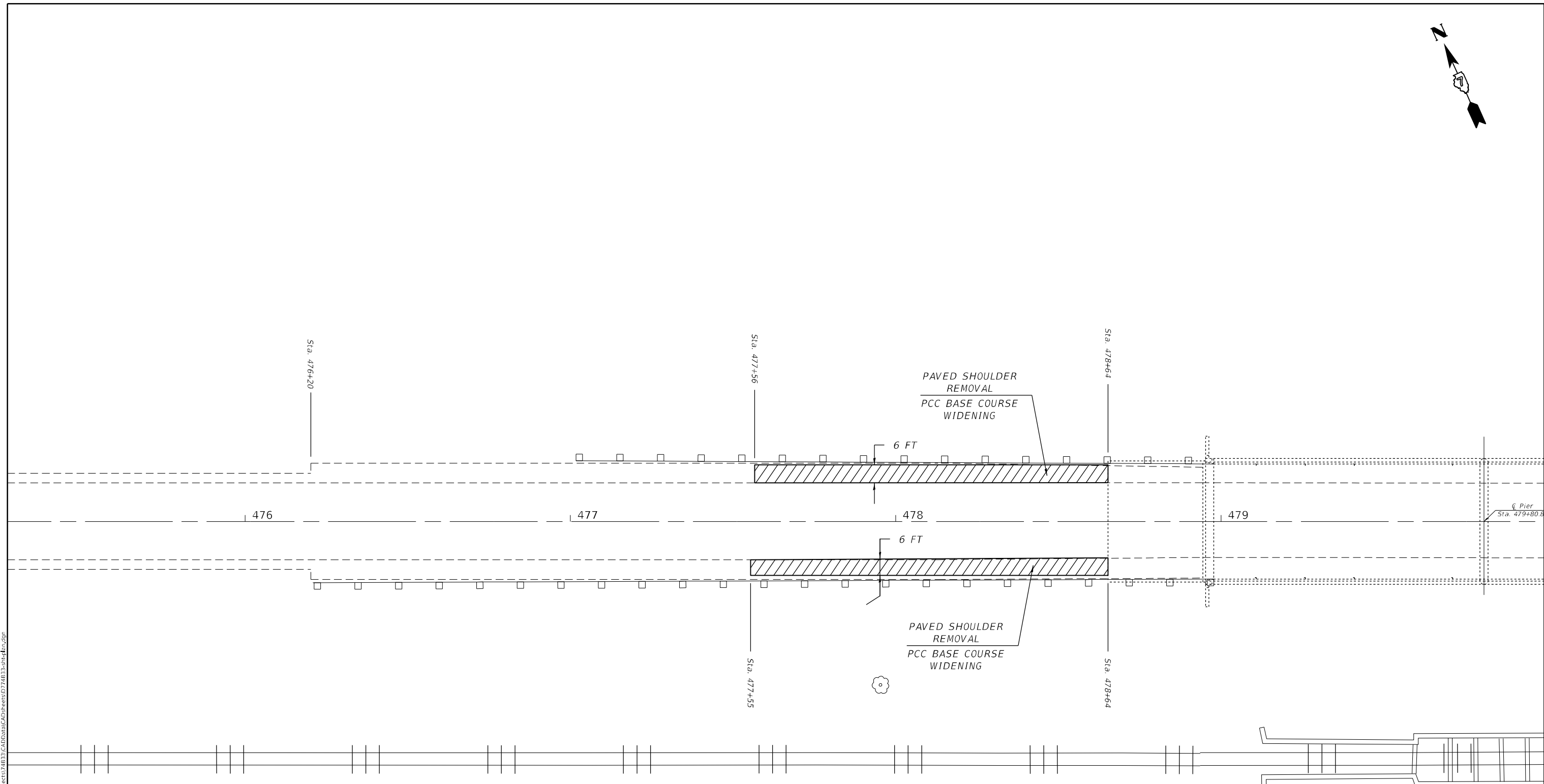
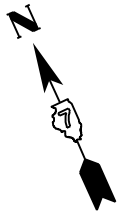

ILLINOIS CENTRAL RR

REFER TO STANDARD 701321 FOR LOCATIONS AND SPACING OF RUMBLE STRIPS, SIGNAGE, DETECTOR LOOPS

MODEL: Default  
 FILE NAME: p:\ultra\paw\bea\paw.com\PIV\DOT\Documents\DOT Offices\Dir\ref: 7\Projects\74833\CADD\DATA\CAD\Sheet\74833-she14n.dgn

USER NAME = Mona.Steffen	DESIGNED -	REVISED -
	DRAWN -	REVISED -
PLOT SCALE = 30,0000 * / in.	CHECKED -	REVISED -
PLOT DATE = 8/23/2023	DATE -	REVISED -

**STATE OF ILLINOIS  
DEPARTMENT OF TRANSPORTATION**

**PLAN VIEW - PCC BASE COURSE WIDENING**

SCALE: SHEET OF SHEETS STA. TO STA.

F.A.P. RTE.	SECTION	COUNTY	TOTAL SHEETS	SHEET NO.
320	D7 BRIDGE REPAIRS 2024-7	MACON	21	8
ILLINOIS FED. AID PROJECT			CONTRACT NO. 74833	



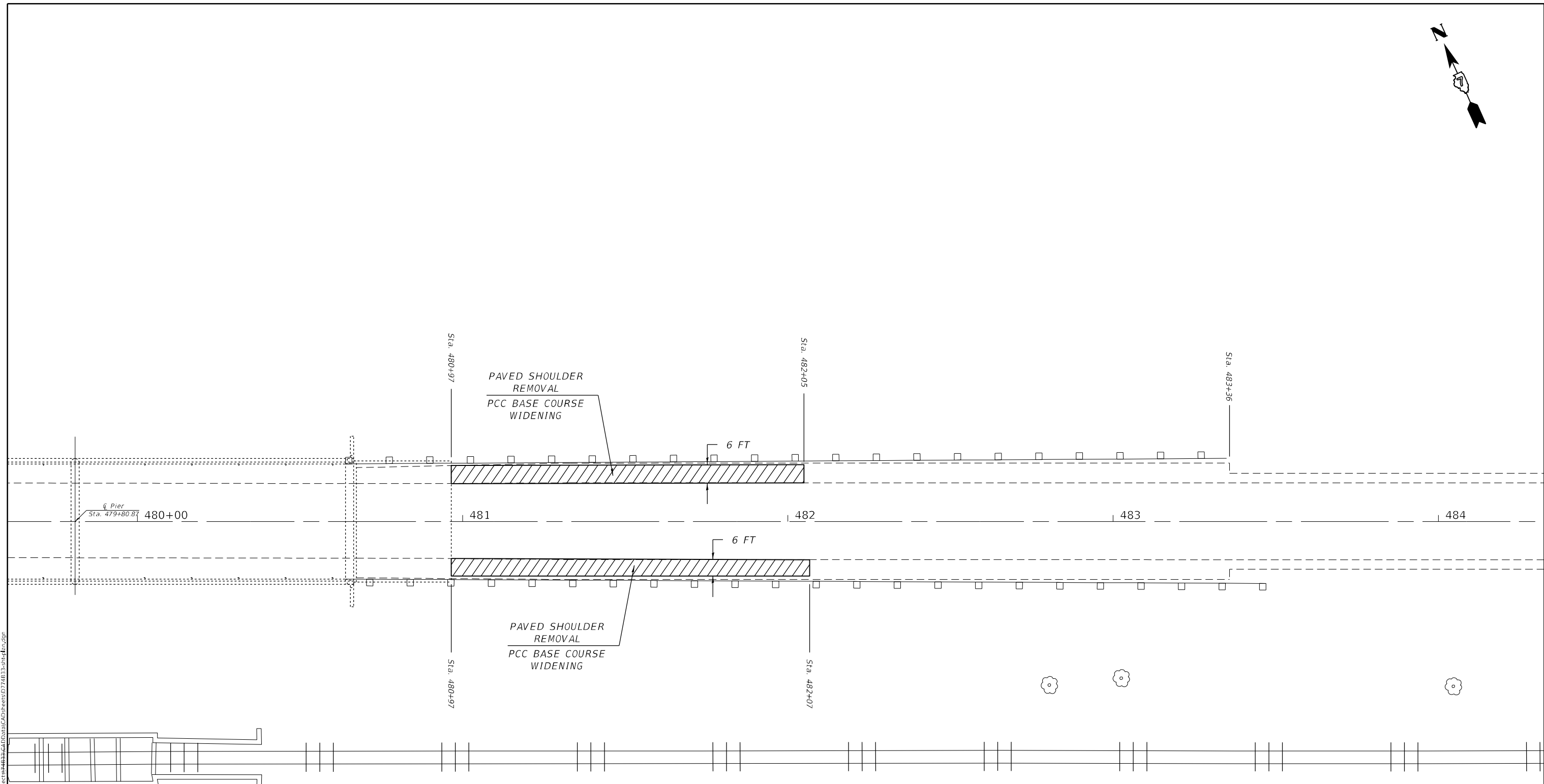
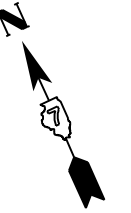

ILLINOIS CENTRAL RR

REFER TO STANDARD 701321 FOR LOCATIONS AND SPACING OF RUMBLE STRIPS, SIGNAGE, DETECTOR LOOPS

MODEL: Default  
 FILE: \\mdepc-pw-backend.com\PW\DOT\Documents\DOT Offices\Director\_7\Projects\74833\sheet.dgn

USER NAME = Mona.Steffen	DESIGNED -	REVISED -
	DRAWN -	REVISED -
PLOT SCALE = 30,0000 * / in.	CHECKED -	REVISED -
PLOT DATE = 8/25/2023	DATE -	REVISED -

**STATE OF ILLINOIS  
DEPARTMENT OF TRANSPORTATION**

**PLAN VIEW - PCC BASE COURSE WIDENING**

SCALE: SHEET OF SHEETS STA. TO STA.

F.A.P. RTE.	SECTION	COUNTY	TOTAL SHEETS	SHEET NO.
320	D7 BRIDGE REPAIRS 2024-7	MACON	21	9
ILLINOIS FED. AID PROJECT			CONTRACT NO. 74833	

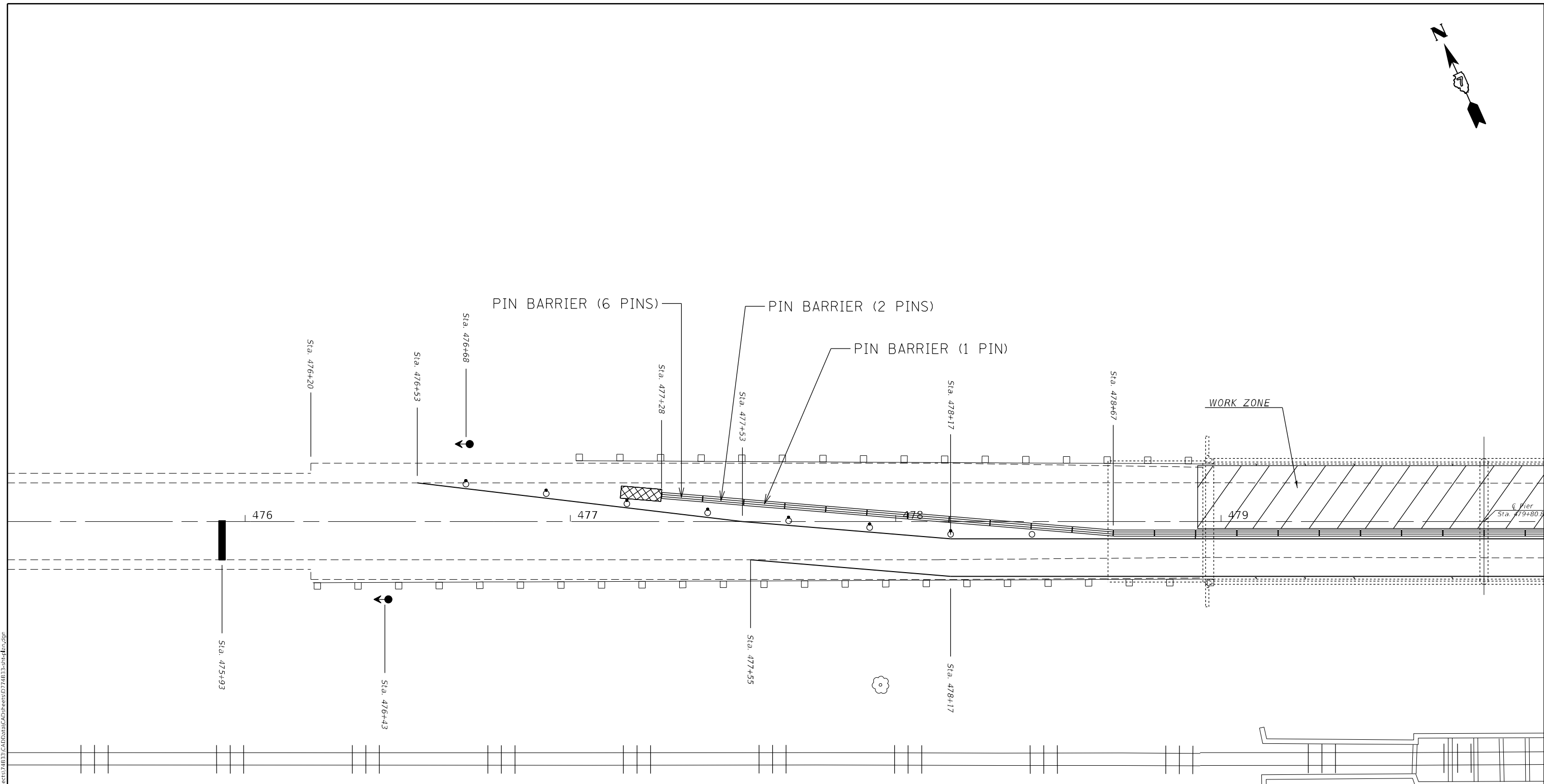
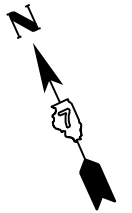

ILLINOIS CENTRAL RR

FOR BARRIER OFFSET AND TRAFFIC CLEAR WIDTH  
REFER TO SHEET 15 OF THE PLANS

REFER TO STANDARD 701321 FOR LOCATIONS AND SPACING  
OF RUMBLE STRIPS, SIGNAGE, DETECTOR LOOPS

MODEL: Default  
 FILE NAME: p:\i\dot\paw\beadefy.com\PIV\DOT\Documents\DOT Offices\Director\_7\Projects\74833\CADD\DATA\CAD\Sheet\15\74833-sh15.dwg

USER NAME = Mona.Steffen	DESIGNED -	REVISED -
	DRAWN -	REVISED -
PLOT SCALE = 30,0000 * / in.	CHECKED -	REVISED -
PLOT DATE = 8/23/2023	DATE -	REVISED -

**STATE OF ILLINOIS  
DEPARTMENT OF TRANSPORTATION**

**PLAN VIEW - STAGE 1**

SCALE: SHEET OF SHEETS STA. TO STA.

F.A.P. RTE.	SECTION	COUNTY	TOTAL SHEETS	SHEET NO.
320	D7 BRIDGE REPAIRS 2024-7	MACON	21	10
CONTRACT NO. 74833				
ILLINOIS FED. AID PROJECT				

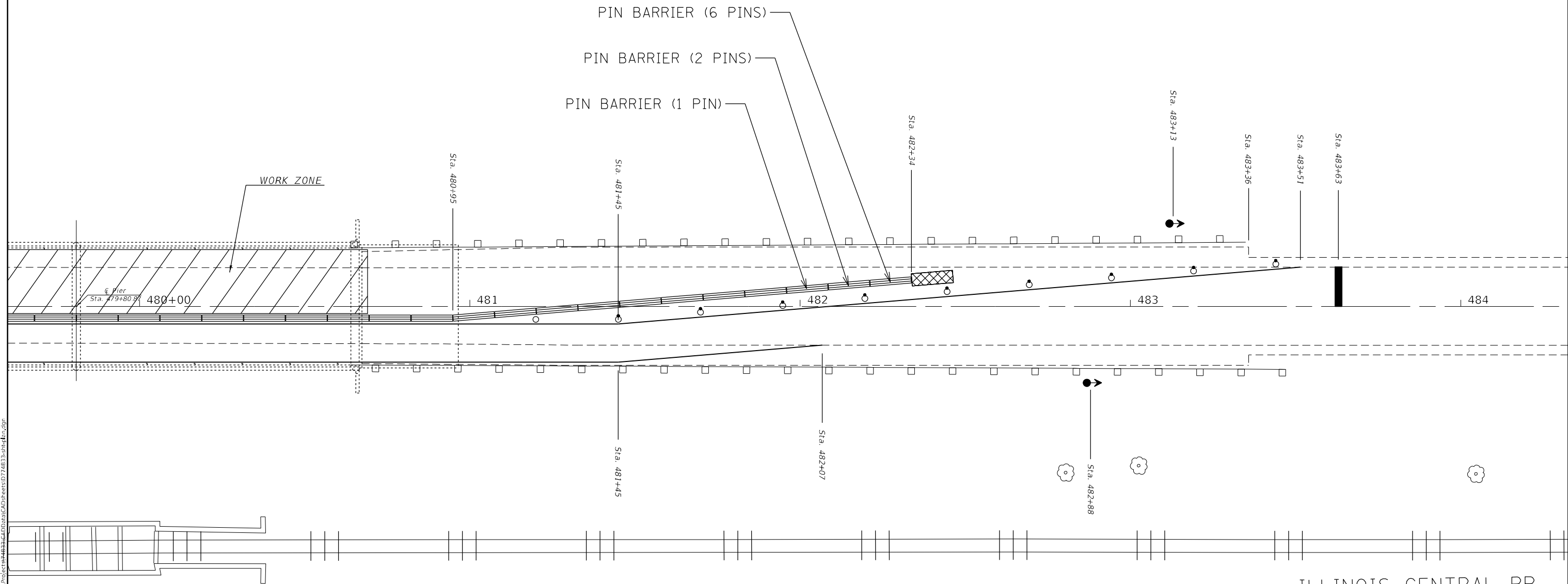
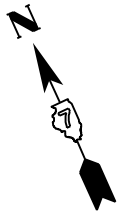

ILLINOIS CENTRAL RR

FOR BARRIER OFFSET AND TRAFFIC CLEAR WIDTH  
REFER TO SHEET 15 OF THE PLANS

REFER TO STANDARD 701321 FOR LOCATIONS AND SPACING  
OF RUMBLE STRIPS, SIGNAGE, DETECTOR LOOPS

MODEL: Default  
 FILE: \\maile.pva\uldet-cw-beadefy.com\PIV\DOT\Documents\1\DOT\_Offices\Dir\drf\_7\Project\474833\CAD\Drawings\74833-4833.dwg

USER NAME = Mona.Steffen	DESIGNED -	REVISED -
	DRAWN -	REVISED -
PLOT SCALE = 30,0000 * / in.	CHECKED -	REVISED -
PLOT DATE = 8/25/2023	DATE -	REVISED -

**STATE OF ILLINOIS  
DEPARTMENT OF TRANSPORTATION**

**PLAN VIEW - STAGE 1**

SCALE: SHEET OF SHEETS STA. TO STA.

F.A.P. RTE.	SECTION	COUNTY	TOTAL SHEETS	SHEET NO.
320	D7 BRIDGE REPAIRS 2024-7	MACON	21	11
CONTRACT NO. 74833				
ILLINOIS FED. AID PROJECT				

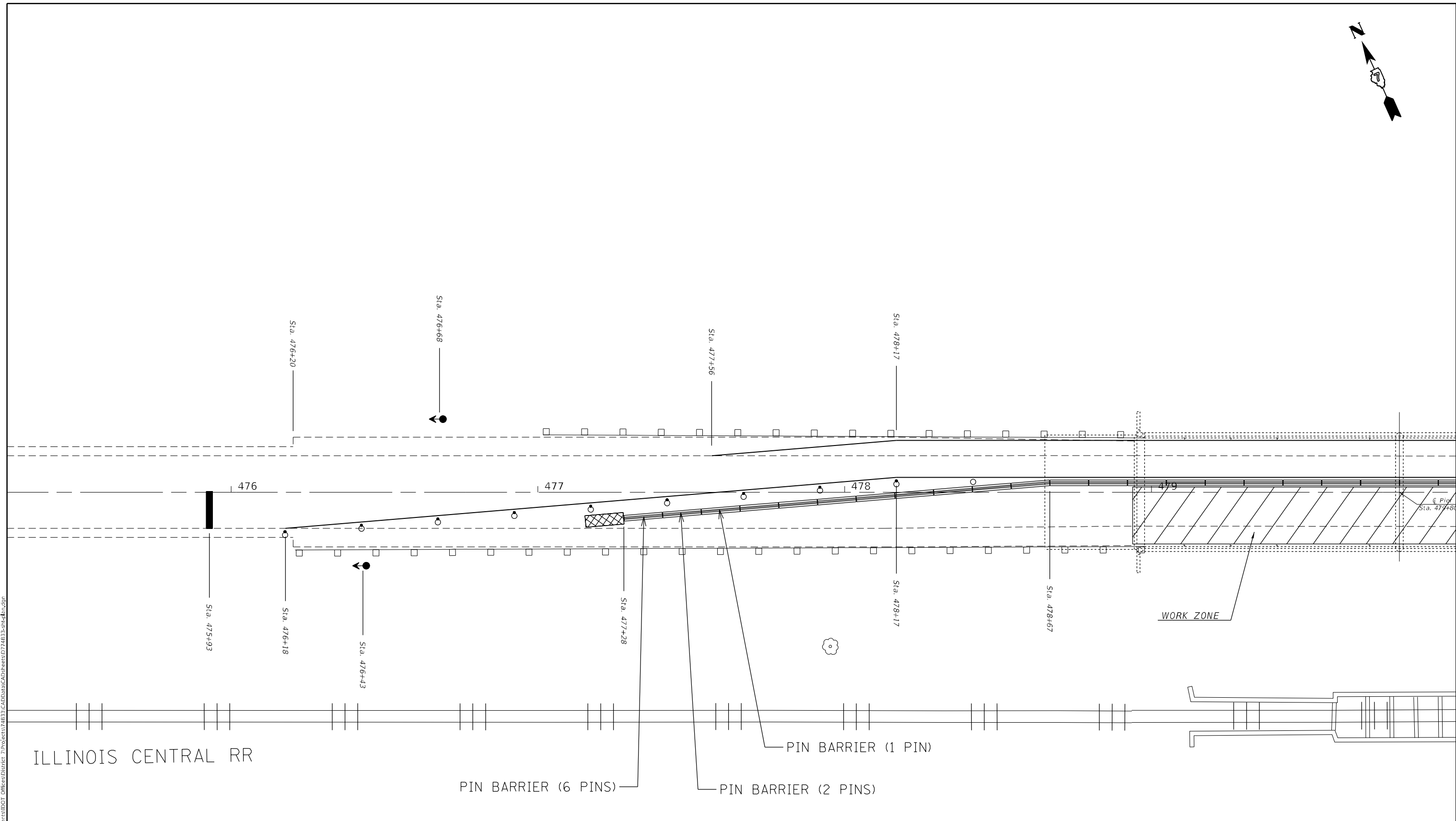
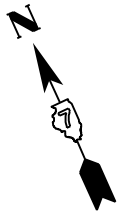

FOR BARRIER OFFSET AND TRAFFIC CLEAR WIDTH  
REFER TO SHEET 15 OF THE PLANS

REFER TO STANDARD 701321 FOR LOCATIONS AND SPACING  
OF RUMBLE STRIPS, SIGNAGE, DETECTOR LOOPS

MODEL: Default  
 FILE: \\nafe\pww\subsect-pw-bead\pww.com\PIV\DOT\Documents\DOT Offices\Director\_7\Projects\74B33\CADD\DATA\CAD\Sheet\15\74B33-sh15.dwg

USER NAME = Mona.Steffen	DESIGNED -	REVISED -
	DRAWN -	REVISED -
PLOT SCALE = 30,0000 * / in.	CHECKED -	REVISED -
PLOT DATE = 8/23/2023	DATE -	REVISED -

**STATE OF ILLINOIS**  
**DEPARTMENT OF TRANSPORTATION**

**PLAN VIEW - STAGE 2**  
 SCALE:      SHEET      OF      SHEETS      STA.      TO STA.

F.A.P. RTE.	SECTION	COUNTY	TOTAL SHEETS	SHEET NO.
320	D7 BRIDGE REPAIRS 2024-7	MACON	21	12
CONTRACT NO. 74B33				
ILLINOIS FED. AID PROJECT				

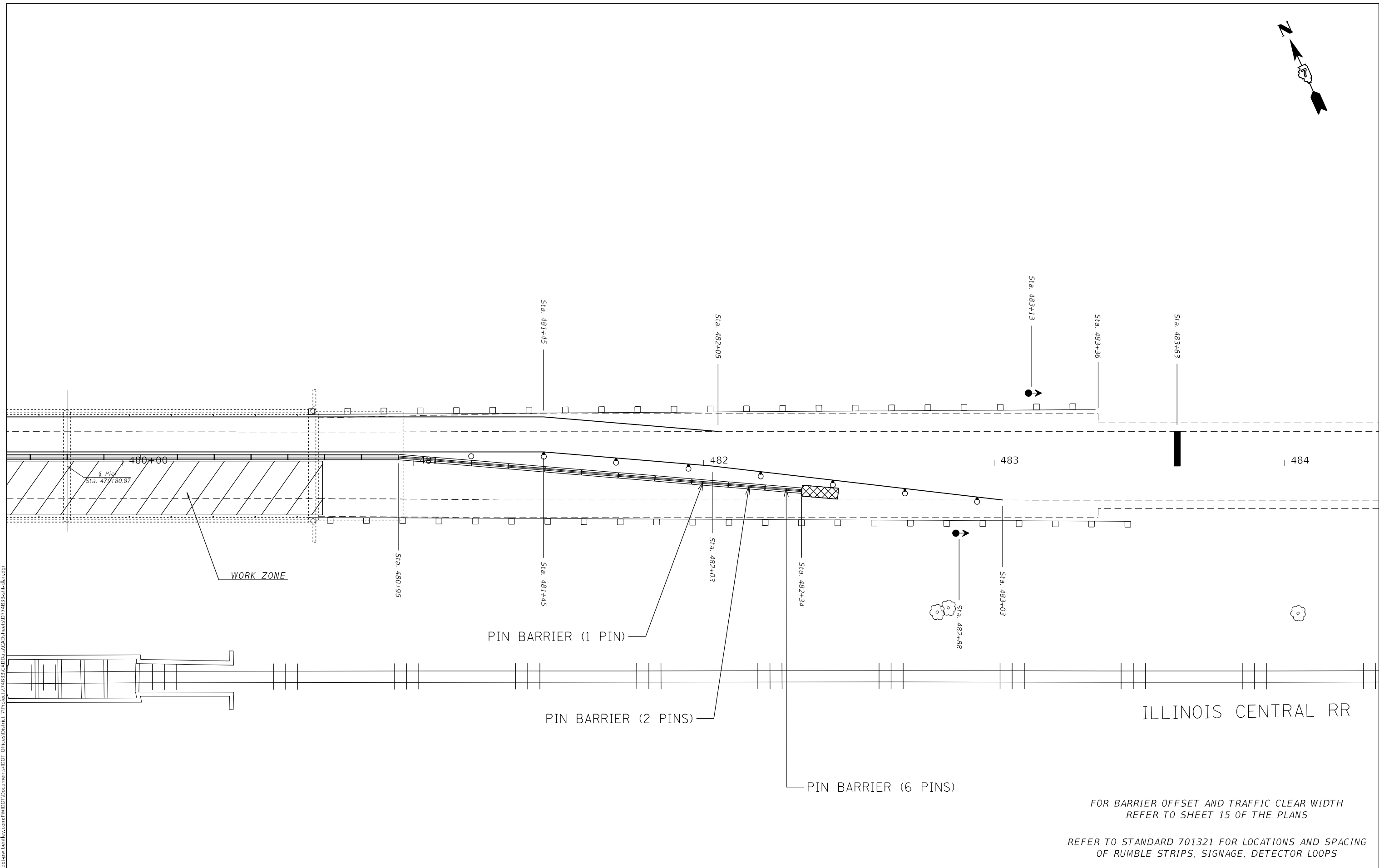
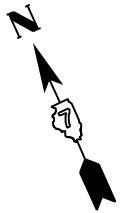

FOR BARRIER OFFSET AND TRAFFIC CLEAR WIDTH  
REFER TO SHEET 15 OF THE PLANS

REFER TO STANDARD 701321 FOR LOCATIONS AND SPACING  
OF RUMBLE STRIPS, SIGNAGE, DETECTOR LOOPS

MODEL: Default  
 FILE: \\mafe-pw\ultra-pw-bead\paw.com\PIV\DOT\Documents\DOT\Office\Director\_7\Projects\74833\CADD\DATA\CAD\Sheet\15\74833-spl-dwg.dgn

USER NAME = Mona.Steffen	DESIGNED -	REVISED -
	DRAWN -	REVISED -
PLOT SCALE = 30,0000 * / in.	CHECKED -	REVISED -
PLOT DATE = 8/25/2023	DATE -	REVISED -

**STATE OF ILLINOIS  
DEPARTMENT OF TRANSPORTATION**

**PLAN VIEW - STAGE 2**

SCALE: SHEET OF SHEETS STA. TO STA.

F.A.P. RTE.	SECTION	COUNTY	TOTAL SHEETS	SHEET NO.
320	D7 BRIDGE REPAIRS 2024-7	MACON	21	13
ILLINOIS FED. AID PROJECT			CONTRACT NO. 74833	

SN. 058-0129 carries ILL-121 (FAP 320) over South Fork. The existing two span, structure with P.P.C. I-beams was constructed in 1999. The proposed project consists of bridge deck scarification, deck patching, bridge deck overlay, and diamond grinding.

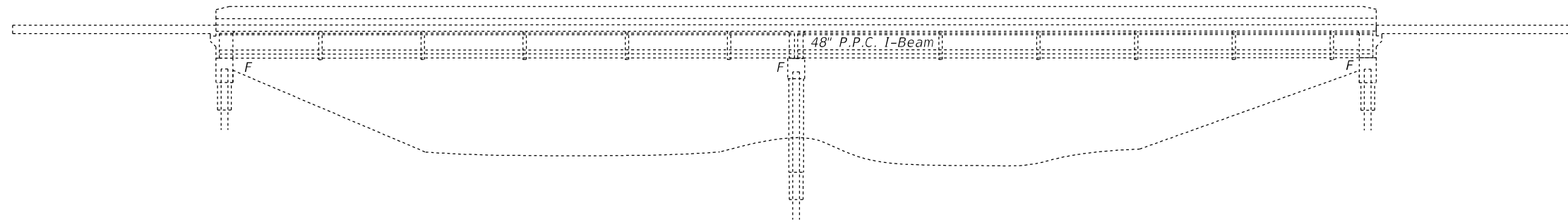

ELEVATION

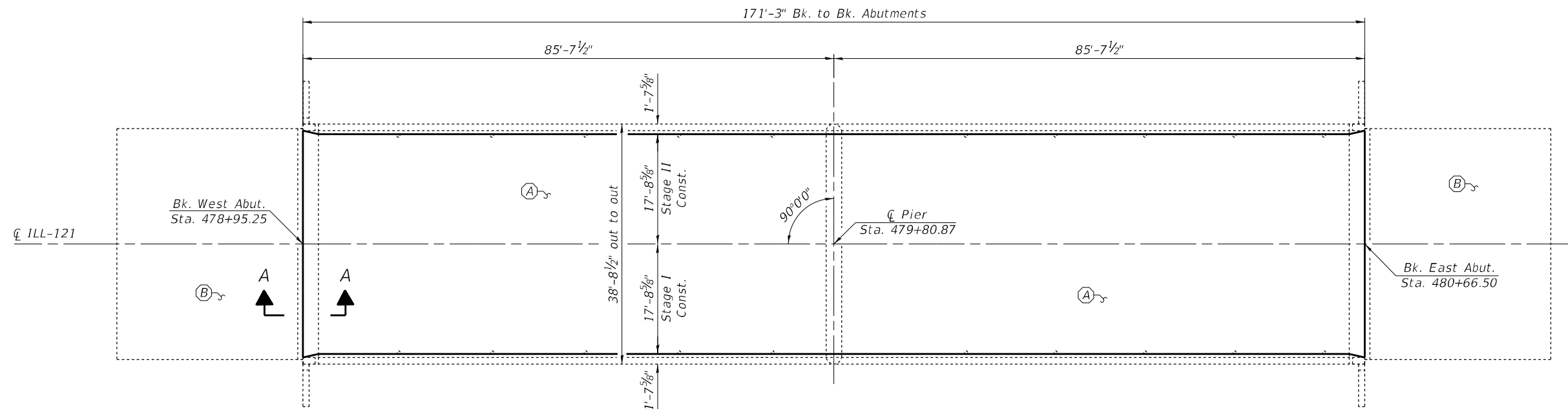

PLAN

- (A) - Bridge Deck Scarification  $\frac{3}{4}$ ", Deck Patching, & Bridge Deck Fly Ash or GGBF Slag Concrete Overlay  $2\frac{1}{2}$ ", Diamond Grinding (Bridge Section)
- (B) - Proposed HMA Overlay (See Roadway Plans)

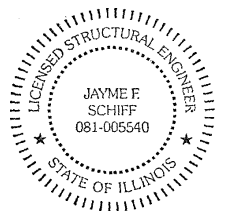

EXPIRES 11-30-2024

*Jayme F. Schiff*

MODEL: Default  
 FILE: \\nafe-pw-beadley.com\P\DOT\Documents\DOT Office\District 7\Projects\74833\CADD\Drawings\74833-058-0129 Bridge Repair Plans.dgn

USER NAME = Mona.Steffen	DESIGNED - T. Walk	REVISED -
	DRAWN - T. Walk	REVISED -
PLOT SCALE = 100,0000' / in.	CHECKED - D. Macklin	REVISED -
PLOT DATE = 8/23/2023	DATE - May 2023	REVISED -

**STATE OF ILLINOIS  
DEPARTMENT OF TRANSPORTATION**

**GENERAL PLAN & ELEVATION  
S.N. 058-0129**

SCALE: SHEET 1 OF 3 SHEETS STA. TO STA.

F.A.P. RTE.	SECTION	COUNTY	TOTAL SHEETS	SHEET NO.
320	D7 BRIDGE REPAIRS 2024-7	MACON	21	14
ILLINOIS FED. AID PROJECT			CONTRACT NO. 74833	

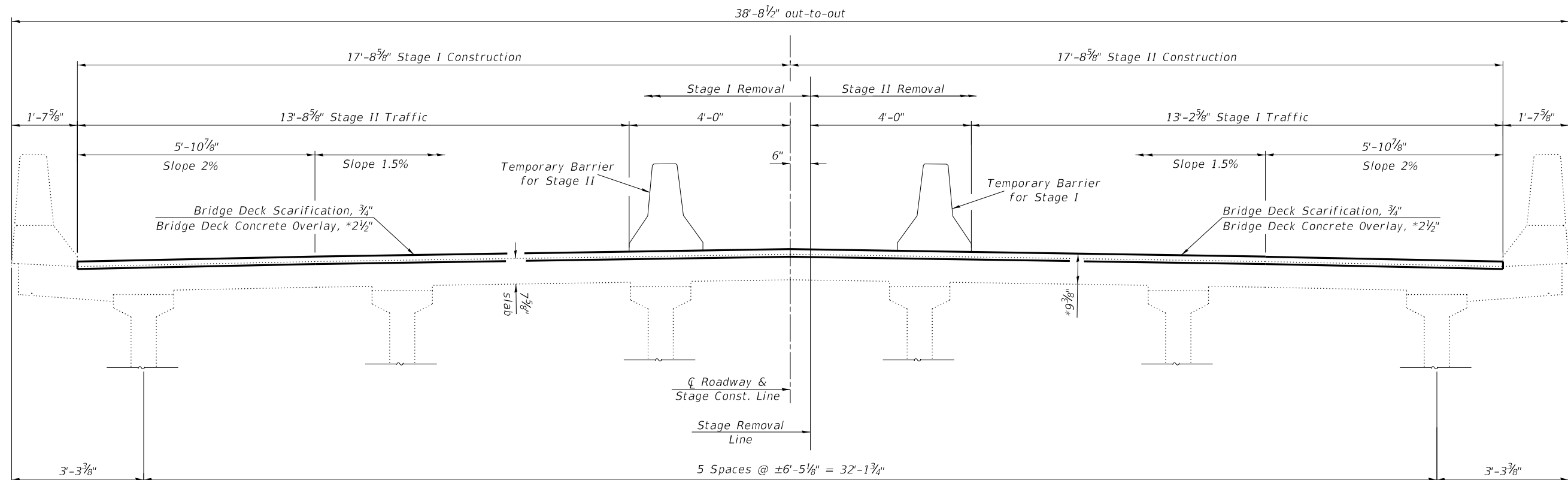

**DECK CROSS SECTION**  
Looking West

**GENERAL NOTES**

Plan dimensions and details relative to existing plans are subject to nominal construction variations. The Contractor shall field verify existing dimensions and details affecting new construction and make necessary approved adjustments prior to construction or ordering of materials. Such variations shall not be cause for additional compensation for a change in scope of the work, however, the Contractor will be paid for the quantity actually furnished at the unit price bid for the work.

Protective Coat to be applied to areas of new concrete only, including bridge deck concrete overlay.

Areas of deck repairs shown are estimated. The Engineer shall show actual locations of deck repairs on as-built plans.

Full depth deck slab repairs performed in the exterior bays of the bridge deck (between the parapet walls and the first interior beams) shall be limited to individual lengths no greater than 10'. In these portions of the deck, repair areas longer than 10' shall be divided into segments not greater than 10' in length, and the segments shall be poured in alternating sequence. Subsequent segments repaired in sequence shall not be removed until 72 hours shall have elapsed from the end of the previous, adjacent pour, and the adjacent pour shall have attained a minimum modulus of rupture of 650psi.

**TOTAL BILL OF MATERIAL**

ITEM	UNIT	QUANTITY
Bridge Deck Scarification, 3/4"	Sq. Yd.	675
Bridge Deck Fly Ash or GGBF Slag Concrete Overlay, 2 1/2"	Sq. Yd.	675
Diamond Grinding (Bridge Section)	Sq. Yd.	600
Bridge Deck Grooving (Longitudinal)	Sq. Yd.	455
Protective Coat	Sq. Yd.	675
Deck Slab Repair (Full Depth, Type I)	Sq. Yd.	4.0
Deck Slab Repair (Full Depth, Type II)	Sq. Yd.	10.0

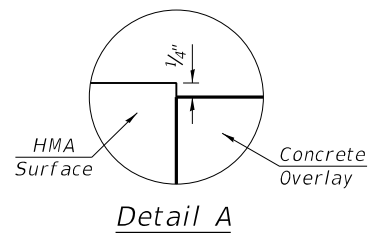

\* Overlay thickness prior to grinding

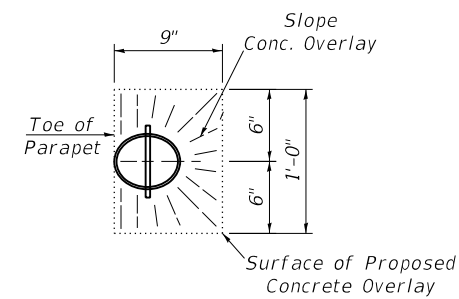

**TOP PLAN OF FLOOR DRAIN**

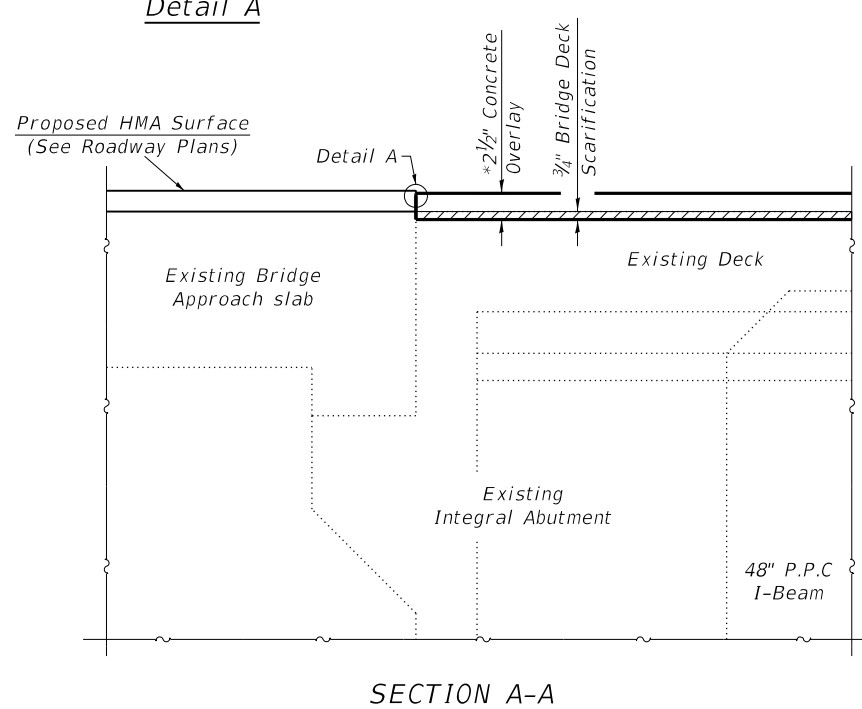

**SECTION A-A**

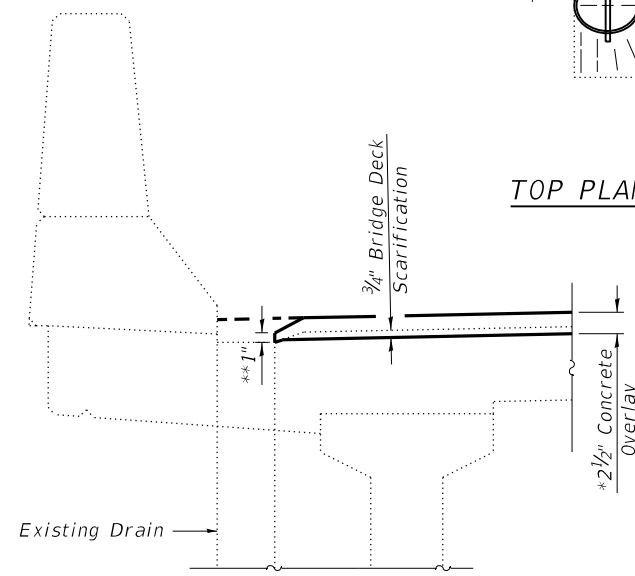

**FLOOR DRAIN PRESERVATION**

\*\* Minimum thickness of overlay at edge of drain = 1"

MODEL: S:\MODELS\NAMES FILE NAME: STEEL

USER NAME = \$USERS	DESIGNED - T. Walk	REVISED -
PLOT SCALE = \$SCALE\$	DRAWN - T. Walk	REVISED -
PLOT DATE = \$DATE\$	CHECKED - D. Macklin	REVISED -
	DATE - May 2023	REVISED -

**STATE OF ILLINOIS  
DEPARTMENT OF TRANSPORTATION**

**DECK CROSS SECTION, GENERAL NOTES, &  
BILL OF MATERIALS S.N. 058-0129**

SCALE: SHEET 2 OF 3 SHEETS STA. TO STA.

F.A.P RTE.	SECTION	COUNTY	TOTAL SHEETS	SHEET NO.
320	D7 BRIDGE REPAIRS 2024-7	MACON	21	15
CONTRACT NO. 74B33				
ILLINOIS FED. AID PROJECT				





# BUTT JOINT DETAILS

STATION 477+25

STATION 482+37

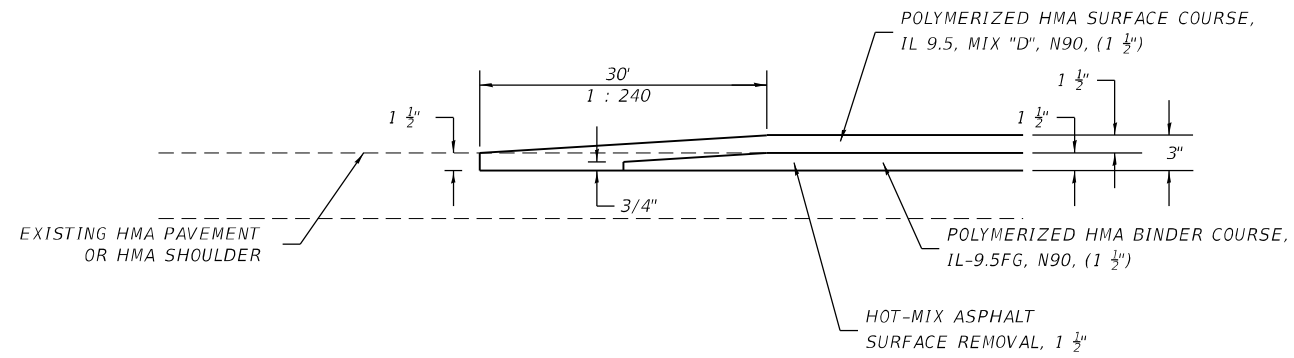

# BRIDGE APPROACH

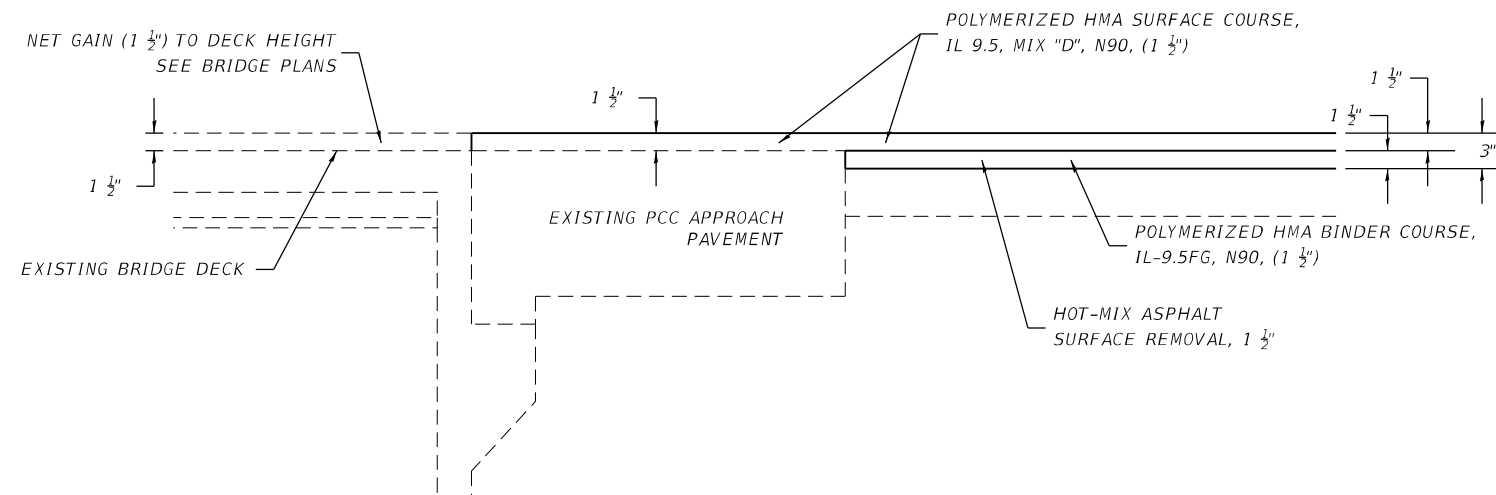

NOT TO SCALE

MODEL: Default  
 FILE: \\maile-pw-bentley.com\PW\DOT\Documents\DOT Office\Dir\drf\_7\Project\74833\CADD\Drawings\CAD\Sheet\74833-sh-decal.dgn

USER NAME = Mona.Steffen	DESIGNED -	REVISED -
	DRAWN -	REVISED -
PLOT SCALE = 100,0000' / in.	CHECKED -	REVISED -
PLOT DATE = 8/25/2023	DATE -	REVISED -

**STATE OF ILLINOIS  
DEPARTMENT OF TRANSPORTATION**

**BUTT JOINT DETAILS**

SCALE: SHEET OF SHEETS STA. TO STA.

F.A.P. RTE.	SECTION	COUNTY	TOTAL SHEETS	SHEET NO.
320	D7 BRIDGE REPAIRS 2024-7	MACON	21	17
			CONTRACT NO. 74833	
ILLINOIS FED. AID PROJECT				

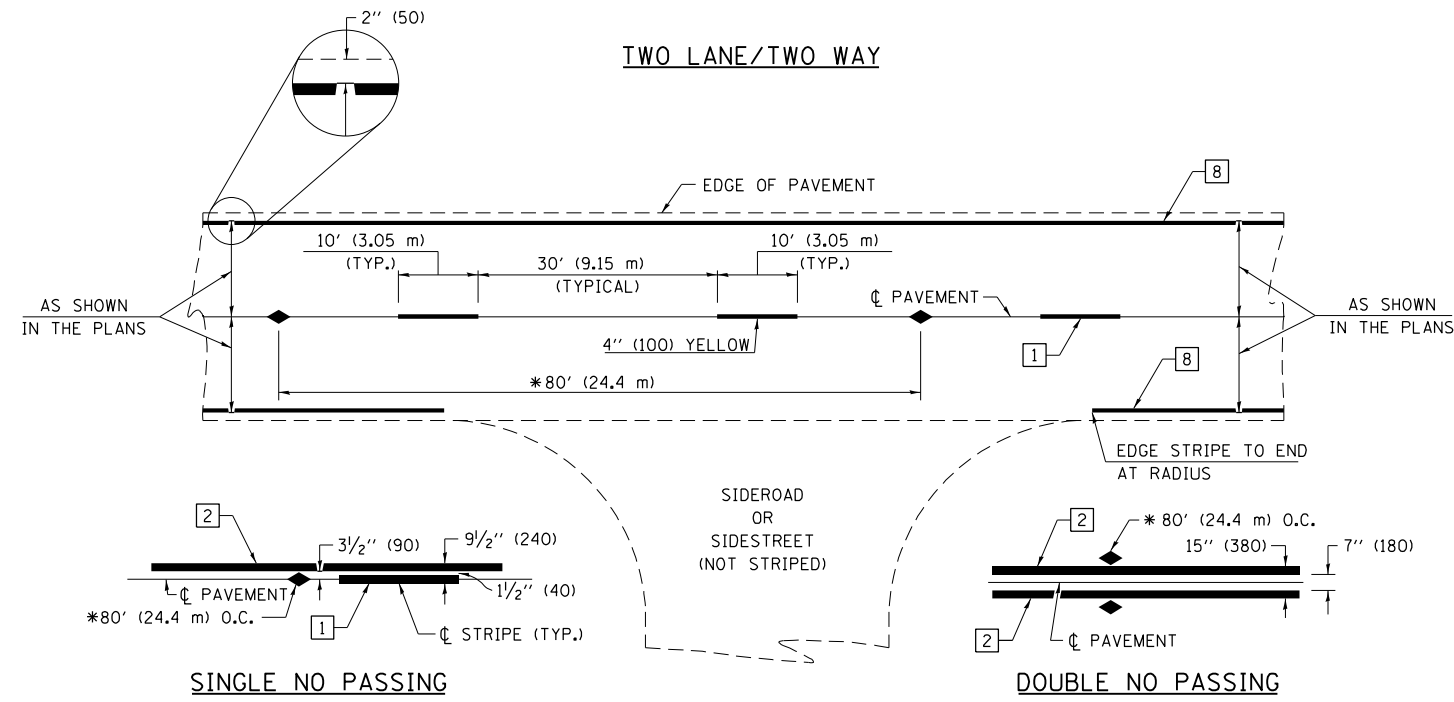

\* REDUCE TO 40' (12.2 m) O.C. ON CURVES WITH POSTED OR ADVISORY SPEEDS OF 45 mph (70 km/h) OR LESS.

PAVEMENT MARKING LEGEND

- 1 4" (100) SKIP-DASH (YELLOW)
- 2 4" (100) SOLID (YELLOW)
- 3 12" (300) DIAGONAL (YELLOW)
- 4 4" (100) DOUBLE YELLOW (NARROW)
- 5 12" (300) SOLID WHITE
- 6 RESERVED
- 7 6" (150) SKIP-DASH (WHITE)
- 8 4" (100) SOLID (WHITE)
- 9 12" (300) DIAGONAL (WHITE)
- 10 6" (150) SOLID (WHITE)
- 11 24" (600) STOP BAR (WHITE)
- 12 8" (200) SOLID (WHITE)
- 13 4" (100) PARKING WHITE

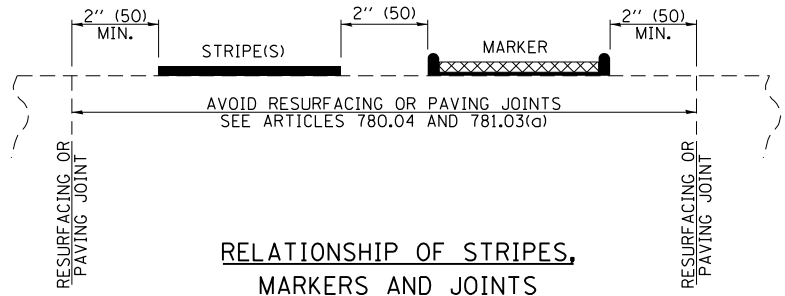

RELATIONSHIP OF STRIPES, MARKERS AND JOINTS

TYPICAL PAVEMENT MARKERS LEGEND

- ◆ TWO-WAY AMBER MARKER
- ▶ ONE-WAY AMBER MARKER
- ▷ ONE-WAY CRYSTAL MARKER

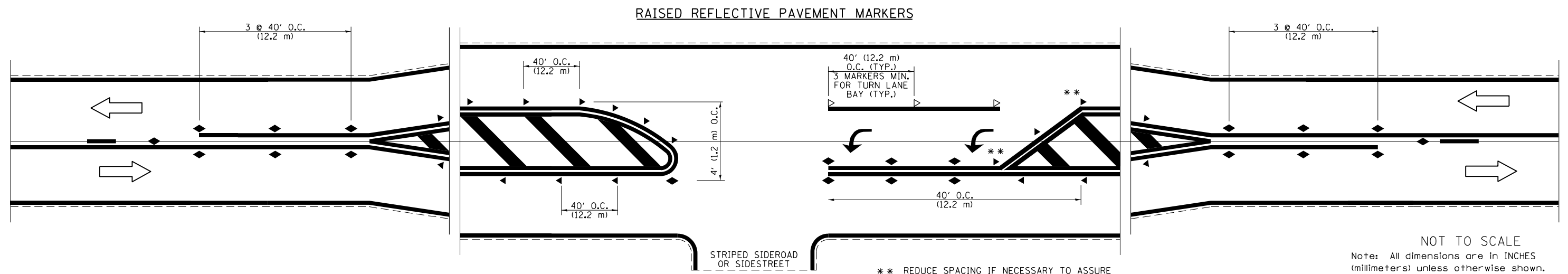

NOT TO SCALE  
Note: All dimensions are in INCHES (millimeters) unless otherwise shown.

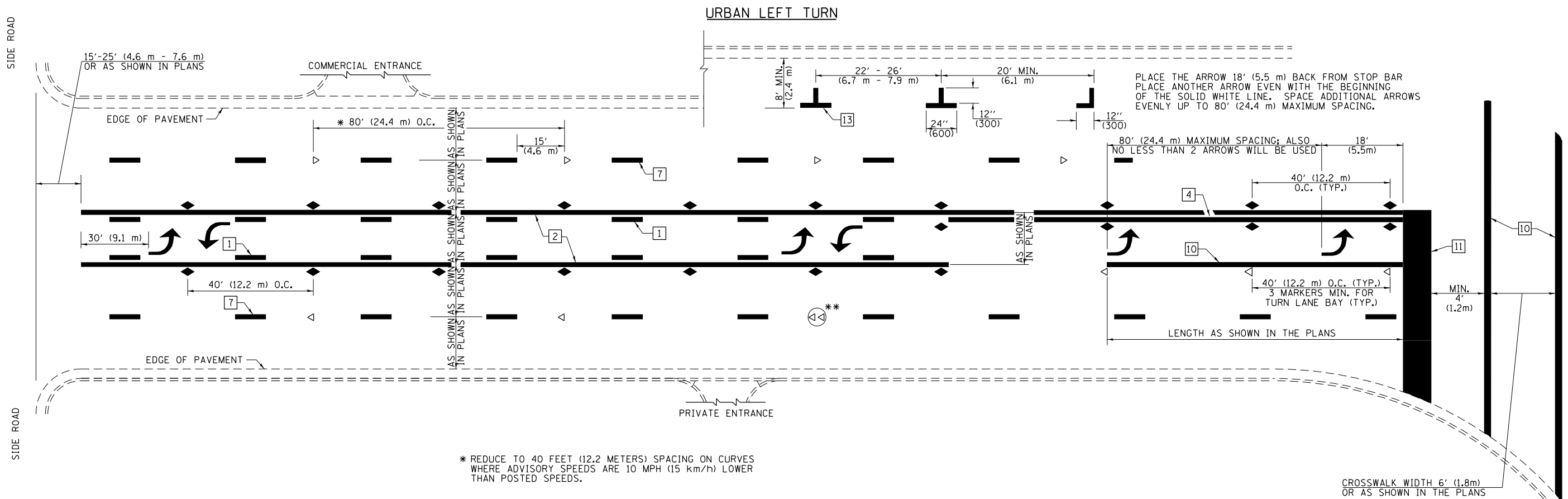

\* REDUCE TO 40 FEET (12.2 METERS) SPACING ON CURVES WHERE ADVISORY SPEEDS ARE 10 MPH (15 km/h) LOWER THAN POSTED SPEEDS.

\*\* DOUBLE LANE LINE MARKERS SHALL BE SPECIFIED AND SPACED AS SHOWN IN HIGHWAY STANDARD 781001 FOR MULTI-LANE DIVIDED AND UNDIVIDED HIGHWAYS.

**PAVEMENT MARKING LEGEND**

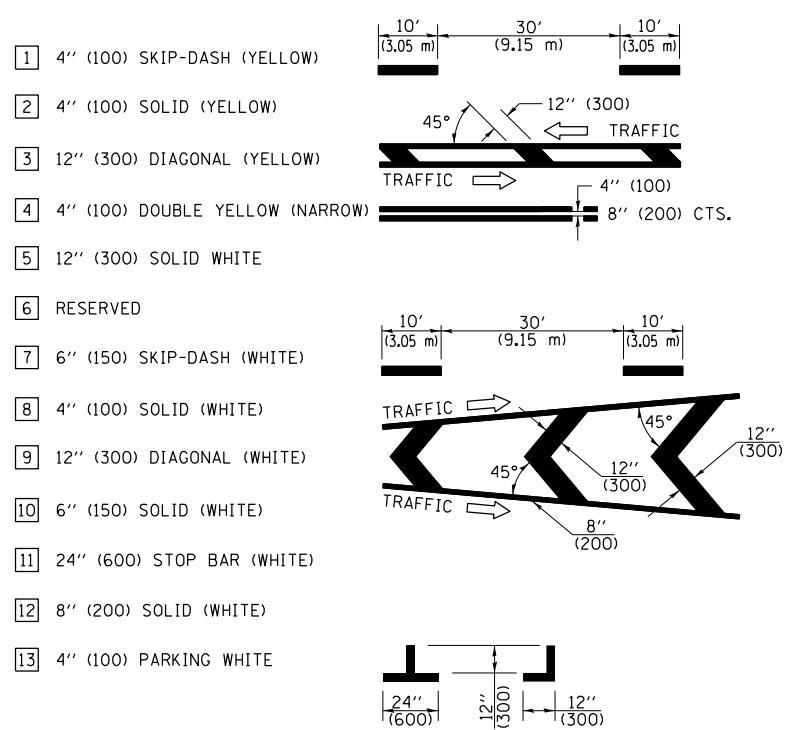

**GENERAL NOTES**

- TURN ARROW PAIRS SHALL BE PLACED AT 250' (75 m) INTERVALS AND SHALL BE EVENLY SPACED BETWEEN BOTH ENDS OF THE BIDIRECTIONAL LEFT TURN LANE. USE A MINIMUM OF TWO PAIRS PER BLOCK.
- THE SOLID YELLOW PAVEMENT MARKINGS [2] SHOULD GENERALLY START OR END NEAR THE RADIUS POINT OF EACH STREET RETURN EXCEPT WHERE ONE OR BOTH ENDS WOULD INCLUDE STOP BARS.
- THE SKIP-DASH PAVEMENT MARKINGS [1] OR [7] SHOULD BE CENTERED BETWEEN BOTH ENDS OF EACH CITY BLOCK AND SHALL BE PLACED SO THEY LINE UP ACROSS FROM EACH OTHER.
- USE LARGE ARROW SIZE FOR BOTH RURAL AND URBAN LOCATIONS. (SEE LAST PAGE OF SECTION 780x FOR SYMBOLS TABLE)
- LANE LINE EXTENSIONS SHALL BE THE SAME COLOR AND WIDTH AS THE LANE LINE BEING EXTENDED.

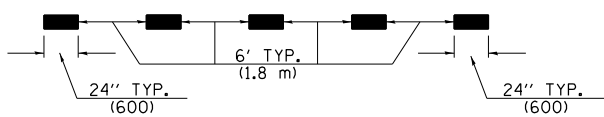

**LANE LINE EXTENSIONS**

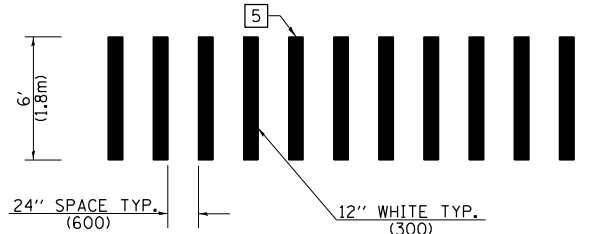

**CROSSWALK DETAIL (DECATUR CITY LIMITS ONLY)**

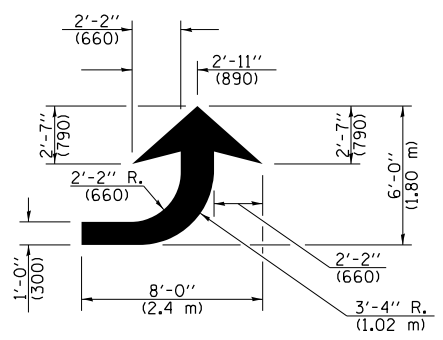

**LEFT ARROW**

REVERSE FOR RIGHT ARROW  
AREA = 15.6 SQ. FT. (1.47 m<sup>2</sup>)  
(WHITE)

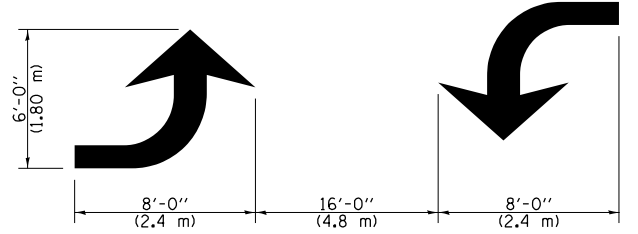

**TYPICAL DOUBLE TURN ARROWS (WHITE)**

NOT TO SCALE

Note: All dimensions are in INCHES (millimeters) unless otherwise shown.

FILE NAME =	USER NAME = Mono.Steffen	DESIGNED -	REVISED -	<b>STATE OF ILLINOIS DEPARTMENT OF TRANSPORTATION</b>	<b>PAVEMENT MARKING AND RAISED REFLECTIVE PAVEMENT MARKERS (RURAL &amp; URBAN APPLICATIONS)</b>	F.A.P. RTE.	SECTION	COUNTY	TOTAL SHEETS	SHEET NO.	
pw:\1ldot-pw.bentley.com\PWIDOT\Documents\DOT Offices\District 7\Projects\74B33\CADD\Drawings\74B33-sht-details.dgn	DRAWN	REVISD -	REVISD -			320	D7 BRIDGE REPAIRS 2024-7	MACON	21	19	
PLOT SCALE = 100.0000' / in.	CHECKED -	REVISD -	REVISD -			CONTRACT NO. 74B33					
PLOT DATE = 8/25/2023	DATE -	REVISD -	REVISD -			ILLINOIS FED. AID PROJECT					
SCALE:						SHEET NO. 2 OF 4 SHEETS		STA.		TO STA.	

**DISTRICT 7 DETAIL NO. 7800001**

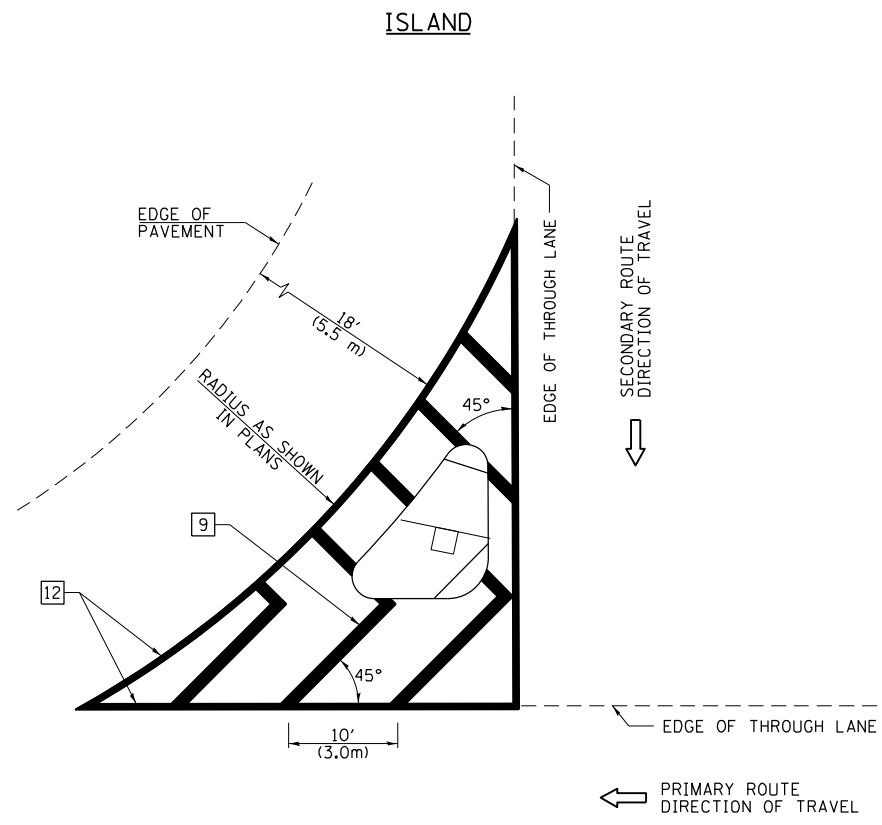

**GENERAL NOTES**

1. RAISED AND CORRUGATED MEDIANS SHALL BE OUTLINED WITH [2] IF PRESENT.
2. SOME OF THE INFORMATION INCLUDED WITH THIS DETAIL MAY NOT BE APPLICABLE TO THIS IMPROVEMENT.
3. PAVEMENT MARKINGS ARE TO BE EXTENDED THROUGH OMISSIONS WHEN APPLICABLE.
4. FINAL PAVEMENT MARKINGS SHALL BE IN PLACE PRIOR TO PLACING ANY RAISED REFLECTIVE PAVEMENT MARKERS.
5. THE FOLLOWING CRITERIA SHALL BE USED FOR SELECTING THE DIAGONAL PAVEMENT MARKING SPACING:
 

< 30 MPH (< 50 km/h)	15' (4.5 m)
30-45 MPH (50-75 km/h)	20' (6.0 m)
> 45 MPH (> 75 km/h)	30' (9.0 m)

**PAVEMENT MARKING LEGEND**

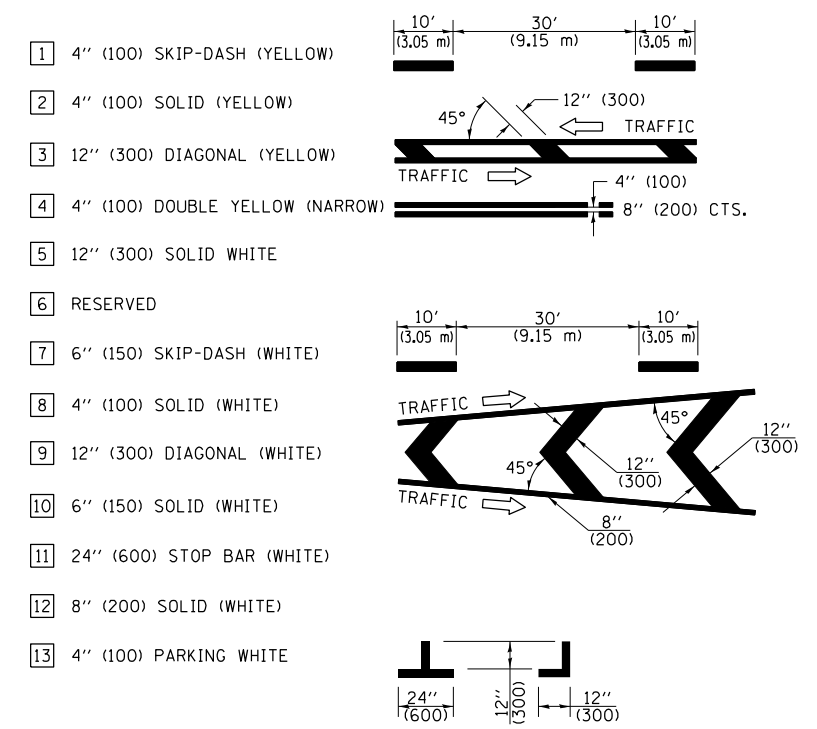

**RURAL LEFT TURN STRIPING**

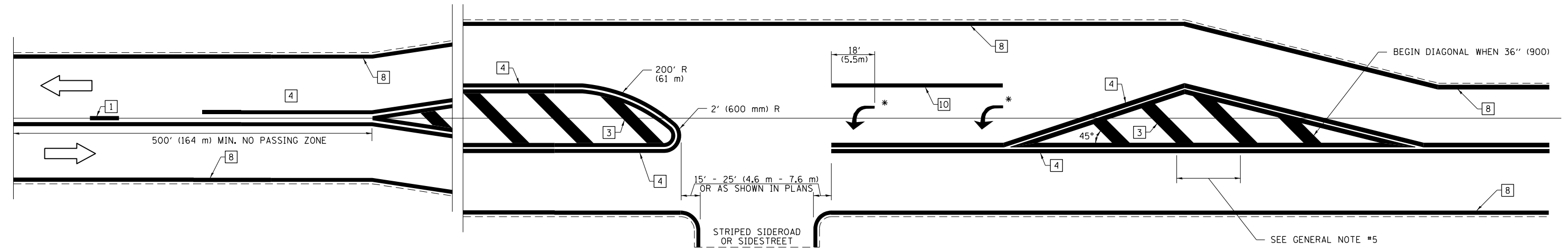

\* PLACE AN ARROW 18' (5.5 m) BACK FROM STOP BAR. PLACE ANOTHER ARROW EVEN WITH THE BEGINNING OF THE SOLID WHITE LINE. SPACE ADDITIONAL ARROWS EVENLY UP TO 80' (24.4 m) MAXIMUM SPACING. USE MINIMUM OF 2 ARROWS.

NOT TO SCALE  
 Note: All dimensions are in INCHES (millimeters) unless otherwise shown.

**DISTRICT 7 DETAIL NO. 7800001**

FILE NAME =	USER NAME = Mono.Steffen	DESIGNED -	REVISED -
pw:\idot-pw.bentley.com\PWIDOT\Documents\IDOT Offices\District 7\Projects\74833\CADD\Drawings\Drawings\74833-sht-details.dgn		CHECKED -	REVISED -
		DATE -	REVISED -

**STATE OF ILLINOIS  
 DEPARTMENT OF TRANSPORTATION**

**PAVEMENT MARKING AND RAISED REFLECTIVE PAVEMENT MARKERS  
 (RURAL & URBAN APPLICATIONS)**

SCALE: SHEET NO. 3 OF 4 SHEETS STA. TO STA.

F.A.P. RTE.	SECTION	COUNTY	TOTAL SHEETS	SHEET NO.
320	D7 BRIDGE REPAIRS 2024-7	MACON	21	20
CONTRACT NO. 74B33				
ILLINOIS FED. AID PROJECT				

PAVEMENT MARKINGS AT RAILROAD-HIGHWAY GRADE CROSSING

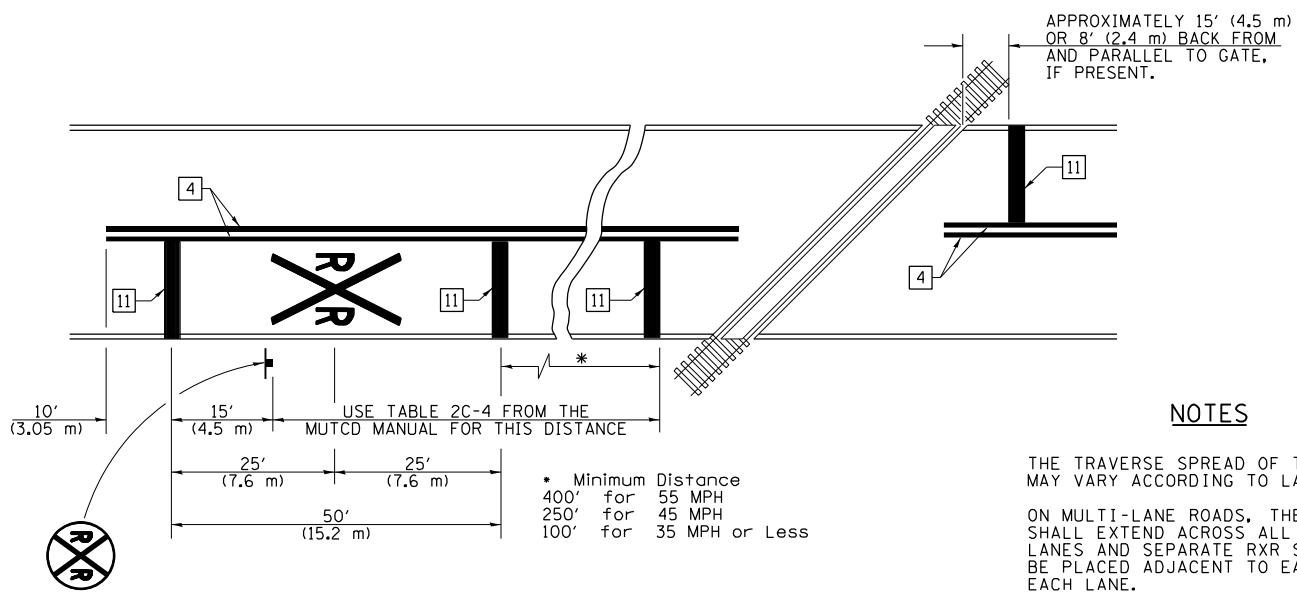

NOTES

THE TRAVERSE SPREAD OF THE "X" MAY VARY ACCORDING TO LANE WIDTH.

ON MULTI-LANE ROADS, THE STOP LINES SHALL EXTEND ACROSS ALL APPROACH LANES AND SEPARATE RXR SYMBOLS SHALL BE PLACED ADJACENT TO EACH OTHER IN EACH LANE.

WHEN THE PAVEMENT MARKING SYMBOL IS USED, A PORTION OF THE SYMBOL SHOULD BE LOCATED DIRECTLY ADJACENT TO THE ADVANCE WARNING SIGN (W10-1) AS PLACED BY TABLE II-1, CONDITION B OF THE MUTCD.

PAVEMENT MARKING LEGEND

- 1 4" (100) SKIP-DASH (YELLOW)
  - 2 4" (100) SOLID (YELLOW)
  - 3 12" (300) DIAGONAL (YELLOW)
  - 4 4" (100) DOUBLE YELLOW (NARROW)
  - 5 12" (300) SOLID WHITE
  - 6 RESERVED
  - 7 6" (150) SKIP-DASH (WHITE)
  - 8 4" (100) SOLID (WHITE)
  - 9 12" (300) DIAGONAL (WHITE)
  - 10 6" (150) SOLID (WHITE)
  - 11 24" (600) STOP BAR (WHITE)
  - 12 8" (200) SOLID (WHITE)
  - 13 4" (100) PARKING WHITE
- 

RAILROAD CROSSING WITH INTERCONNECT ONLY

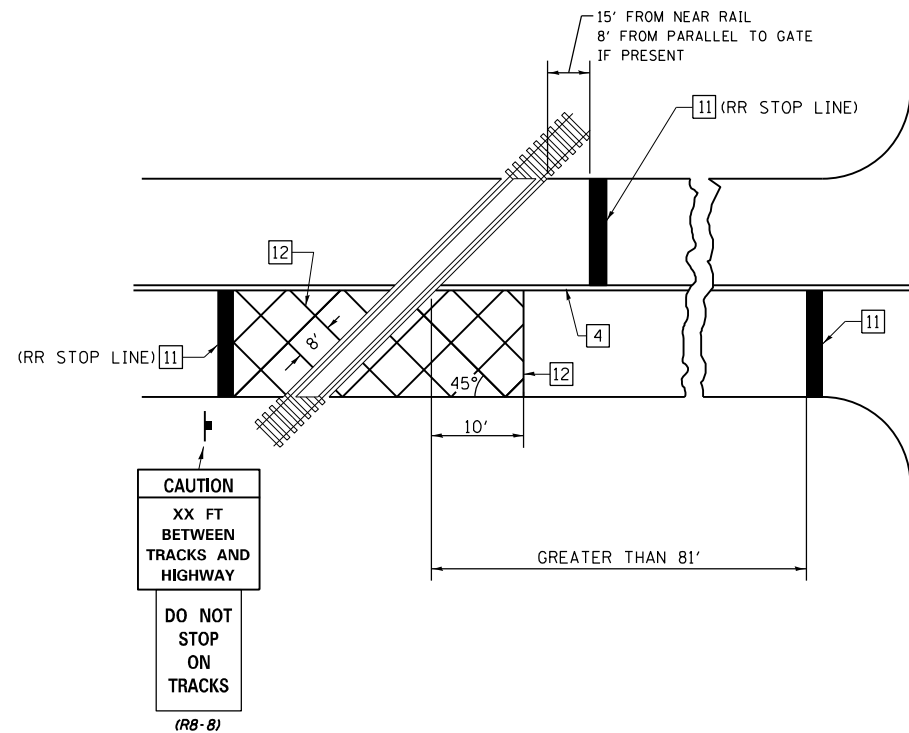

RAILROAD CROSSING WITH INTERCONNECT AND PRE-SIGNALS

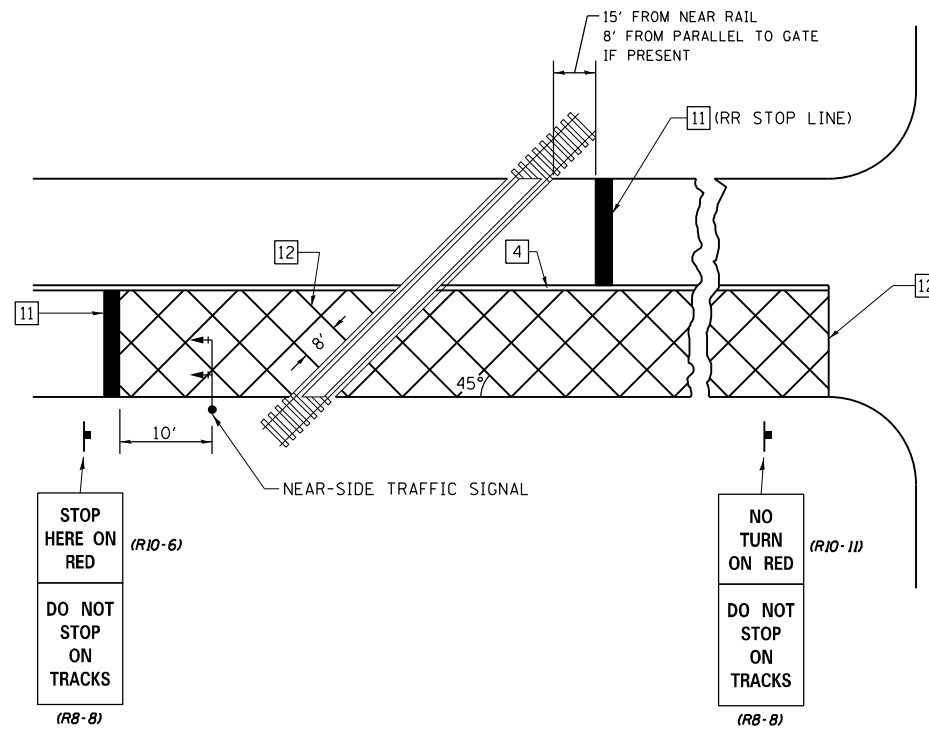

GENERAL NOTES

1. SUPPLEMENTAL PAVEMENT MARKINGS TO BE INSTALLED ONLY ON APPROACHES TO INTERSECTIONS CONTROLLED BY TRAFFIC SIGNALS WHICH ARE INTERCONNECTED WITH THE RAILROAD WARNING SIGNALS.
2. EXTEND PAVEMENT MARKINGS TO THE INTERSECTION ONLY WHERE NEAR-SIDE TRAFFIC SIGNALS ARE USED.

SUPPLEMENTAL PAVEMENT MARKING TREATMENT FOR RAILROAD-HIGHWAY GRADE CROSSING

NOT TO SCALE

Note: All dimensions are in INCHES (millimeters) unless otherwise shown.

DISTRICT 7 DETAIL NO. 78000001

FILE NAME =	USER NAME = Mono.Steffen	DESIGNED -	REVISED -	<b>STATE OF ILLINOIS DEPARTMENT OF TRANSPORTATION</b>	<b>PAVEMENT MARKING AND RAISED REFLECTIVE PAVEMENT MARKERS (RURAL &amp; URBAN APPLICATIONS)</b>	F.A.P. RTE.	SECTION	COUNTY	TOTAL SHEETS	SHEET NO.
p:\1\1dot-pw.bentley.com\PWIDOT\Documents\DOT Offices\District 7\Projects\74833\CADD\Drawings\74833-sht-details.dgn	PROJECT = 74833	CHECKED -	REVISED -			320	D7 BRIDGE REPAIRS 2024-7	MACON	21	21
PLOT SCALE = 100.0000' / 1" =	DATE = 8/25/2023	DATE -	REVISED -			CONTRACT NO. 74833				
						SCALE:	SHEET NO. 4 OF 4 SHEETS		STA. TO STA.	