

STATE OF ILLINOIS  
DEPARTMENT OF TRANSPORTATION

F.A.S. RTE.	SECTION	COUNTY	TOTAL SHEETS	SHEET NO.
2701	D7 BRIDGE REPAIRS 2024-8	EFFINGHAM	23	J
		ILLINOIS	CONTRACT NO. 74B34	

FOR INDEX OF SHEETS, SEE SHEET NO. 2

ADT = 2050

# PROPOSED HIGHWAY PLANS

FAS ROUTE 2701 (IL 37)  
SECTION D7 BRIDGE REPAIRS 2024-8  
PROJECT HBFP-1PLT(920)  
BRIDGE REPAIR  
EFFINGHAM COUNTY

C-97-102-22

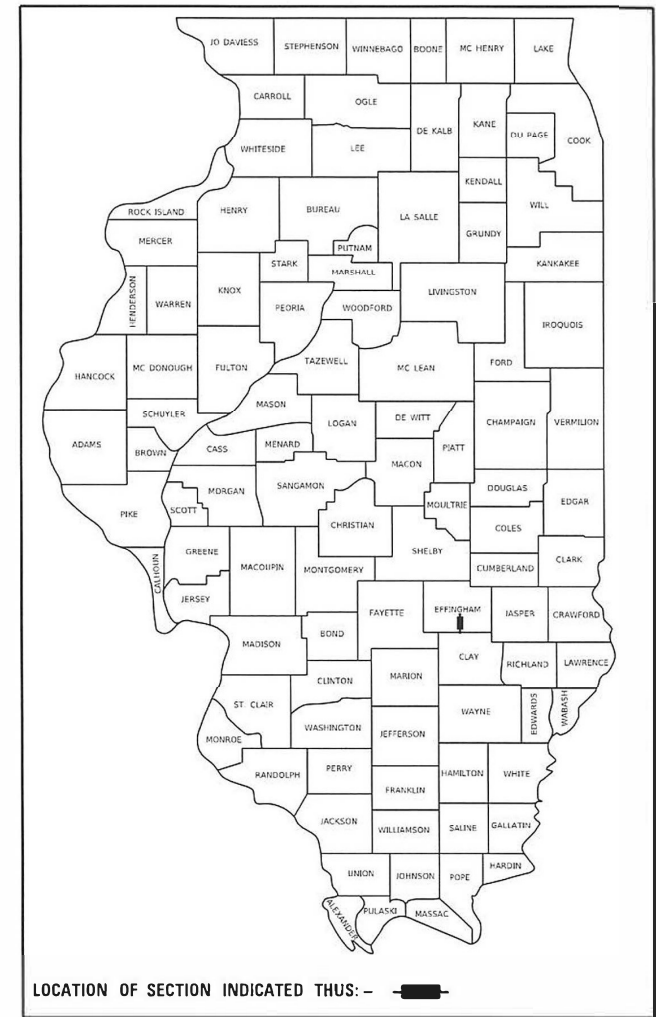

SN 025-0089  
STA 1065+23

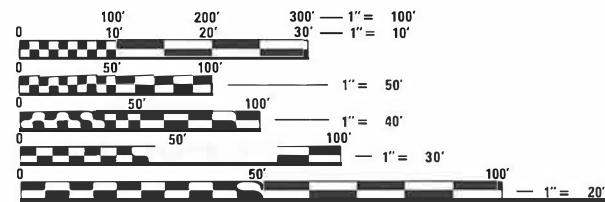
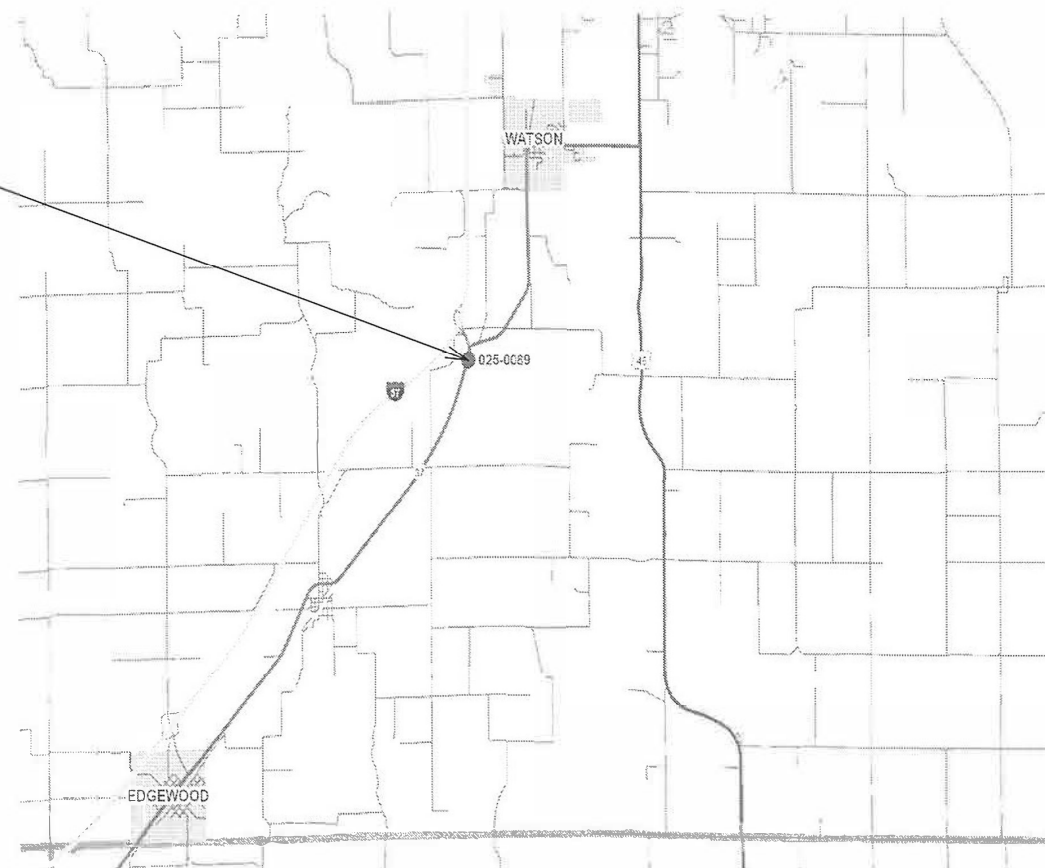

FULL SIZE PLANS HAVE BEEN PREPARED USING STANDARD ENGINEERING SCALES. REDUCED SIZED PLANS WILL NOT CONFORM TO STANDARD SCALES. IN MAKING MEASUREMENTS ON REDUCED PLANS, THE ABOVE SCALES MAY BE USED.

J.U.L.I.E.  
JOINT UTILITY LOCATION INFORMATION FOR EXCAVATORS  
1-800-892-0123  
OR 811

PROJECT ENGINEER BRIAN LEWIS  
PROJECT MANAGER ANDREW NIEMERG

CONTRACT NO. 74B34

GROSS LENGTH = 376 FT. = 0.071 MILE  
NET LENGTH = 376 FT. = 0.071 MILE

STATE OF ILLINOIS  
DEPARTMENT OF TRANSPORTATION

SUBMITTED AUGUST 23, 2023  
Jeffrey P. Myer  
REGIONAL ENGINEER

October 13, 2023  
Scott A. Etkin  
ENGINEER OF DESIGN AND ENVIRONMENT

October 13, 2023  
Stephen M. Smith  
DIRECTOR OF HIGHWAYS PROJECT IMPLEMENTATION

PRINTED BY THE AUTHORITY  
OF THE STATE OF ILLINOIS

## GENERAL NOTES

THE WORK IN THIS SECTION CONSISTS OF BRIDGE DECK OVERLAY, BRIDGE JOINT REPLACE/REPAIR, BRIDGE APPROACH ROADWAY, BRIDGE DECK REPAIRS, PCC BASED COURSE WIDENING, PAVEMENT MARKING, AND ALL OTHER WORK NEEDED TO COMPLETE THIS SECTION.

THE PROPOSED PROJECT ON STRUCTURE #025-0089 IS LOCATED 0.5 MILES SOUTH OF I-57 OVER THE LITTLE WABASH RIVER ON FAS 2701 (IL-37)

THE FOLLOWING MIXTURE REQUIREMENTS ARE APPLICABLE TO THIS PROJECT:

LOCATION	MIXTURE USE	PG	DESIGN AIR VOIDS	MIXTURE COMPOSITION	FRICTION AGGREGATE	MIXTURE WEIGHT	QUALITY MANAGEMENT PROGRAM	SUBLOT SIZE	MATERIAL TRANSFER DEVICE (REQUIRED?)
MAINLINE	HMA SURFACE COURSE, IL-9.5, MIX "C", N70	PG 64-22	4.0% @ N=70	IL - 9.5	MIXTURE C	N70	QC/QA	3000	N/A

## INDEX OF SHEETS

SHEET NO.	DESCRIPTION
1	COVER SHEET
2	GENERAL NOTES, INDEX OF SHEETS, HIGHWAY STANDARDS
3 - 4	SUMMARY OF QUANTITIES
5	TYPICAL CROSS SECTIONS
6	SCHEDULE OF QUANTITIES
7 - 9	STAGE CONSTRUCTION DETAILS
10 - 18	BRIDGE REPAIR PLANS
19	TRANSITION DETAILS
20 - 23	PAVEMENT MARKING DETAILS

THE FOLLOWING STANDARDS ARE A PART OF THESE PLANS AND ARE INCLUDED AFTER THE LAST NUMBERED SHEET OF THE PLANS

STANDARD NO.	DESCRIPTION
000001-08	STANDARD SYMBOLS, ABBREVIATIONS, AND PATTERNS
001001-02	AREAS OF REINFORCEMENT BARS
001006	DECIMAL OF AN INCH AND OF A FOOT
420001-10	PAVEMENT JOINTS
701001-02	OFF-ROAD OPERATIONS, 2L, 2W, MORE THAN 15' AWAY
701006-05	OFF-ROAD OPERATIONS, 2L, 2W, 15' TO 24" FROM PAVEMENT EDGE
701201-05	LANE CLOSEURE, 2L, 2W, DAY ONLY
701301-04	LANE CLOSURE, 2L, 2W, SHORT TIME OPERATIONS
701311-03	LANE CLOSURE, 2L, 2W, MOVING OPERATIONS, DAY ONLY
701321-18	LANE CLOSURE, 2L, 2W, BRIDGE REPAIR WITH BARRIER
701326-04	LANE CLOSEURE, 2L, 2W, PAVEMENT WIDENING
701901-08	TRAFFIC CONTROL DEVICES
704001-08	TEMPORARY CONCRETE BARRIER
780001-05	TYPICAL PAVEMENT MARKINGS
782006-01	GUARDRAIL AND BARRIER WALL REFLECTOR MOUNTING DETAILS

REV. - MS

MODEL: Default  
 FILE NAME: P:\11111111\Bentley.com\PROJECTS\DOT\Office\DOT\11111111\CADD\DATA\CAD\Sheets\0714B34-811-000001.dgn

USER NAME = jessica.hille	DESIGNED -	REVISED -
	DRAWN -	REVISED -
PLOT SCALE = 100.0000' / in.	CHECKED -	REVISED -
PLOT DATE = 8/25/2023	DATE -	REVISED -

**STATE OF ILLINOIS  
DEPARTMENT OF TRANSPORTATION**

**INDEX OF SHEETS &  
GENERAL NOTES**

SCALE: SHEET OF SHEETS STA. TO STA.

F.A.S. RTE.	SECTION	COUNTY	TOTAL SHEETS	SHEET NO.
2701	D7 BRIDGE REPAIRS 2024-8	EFFINGHAM	23	2
ILLINOIS FED. AID PROJECT				

80% FED  
20% STATE

80% FED  
20% STATE

SUMMARY OF QUANTITIES			TOTAL QUANTITIES	CONSTRUCTION TYPE CODE		
CODE NO	ITEM	UNIT		0047		
35300500	PORTLAND CEMENT CONCRETE BASE COURSE 10"	SO YD	207	207		
40600290	BITUMINOUS MATERIALS (TACK COAT)	POUND	291	291		
40600982	HOT-MIX ASPHALT SURFACE REMOVAL - BUTT JOINT	SO YD	213	213		
40600990	TEMPORARY RAMP	SO YD	41	41		
40604052	HOT-MIX ASPHALT SURFACE COURSE, IL-9.5, MIX "C", N70	TON	37	37		
50102400	CONCRETE REMOVAL	CU YD	5.6	5.6		
50300100	FLOOR DRAINS	EACH	56	56		
50300255	CONCRETE SUPERSTRUCTURE	CU YD	6.2	6.2		
50300300	PROTECTIVE COAT	SO YD	1288	1288		
50800205	REINFORCEMENT BARS, EPOXY COATED	POUND	960	960		
50800515	BAR SPLICERS	EACH	12	12		
52000110	PREFORMED JOINT STRIP SEAL	FOOT	68	68		
67000400	ENGINEER'S FIELD OFFICE, TYPE A	CAL MO	5	5		

SUMMARY OF QUANTITIES			TOTAL QUANTITIES	CONSTRUCTION TYPE CODE		
CODE NO	ITEM	UNIT		0047		
67100100	MOBILIZATION	L SUM	1	1		
70100405	TRAFFIC CONTROL AND PROTECTION, STANDARD 701321	EACH	1	1		
70100450	TRAFFIC CONTROL AND PROTECTION, STANDARD 701201	L SUM	1	1		
70100500	TRAFFIC CONTROL AND PROTECTION, STANDARD 701326	L SUM	1	1		
70106500	TEMPORARY BRIDGE TRAFFIC SIGNALS	EACH	1	1		
70107005	PAVEMENT MARKING BLACKOUT TAPE, 5"	FOOT	1168	1168		
70107025	CHANGEABLE MESSAGE SIGN	CAL DA	28	28		
70300150	SHORT TERM PAVEMENT MARKING REMOVAL	SO FT	486	486		
70400100	TEMPORARY CONCRETE BARRIER	FOOT	687.5	687.5		
70400200	RELOCATE TEMPORARY CONCRETE BARRIER	FOOT	625	625		
70600250	IMPACT ATTENUATORS, TEMPORARY (NON-REDIRECTIVE), TEST LEVEL 3	EACH	2	2		
70600350	IMPACT ATTENUATORS, RELOCATE (NON-REDIRECTIVE), TEST LEVEL 3	EACH	2	2		

REV. - MS

MODEL: Default  
 FILE: \\mfs1-pw-bentley.com\FWIDOT\Documents\DOT Offices\District 7\Projects\74B34\CADD\Drawings\CAD\Sheet\74B34-SP-S00.dgn

USER NAME = jessica.hille	DESIGNED -	REVISED -
PLOT SCALE = 100.0000' / in.	DRAWN -	REVISIONS -
PLOT DATE = 8/25/2023	CHECKED -	REVISIONS -
	DATE -	REVISIONS -

**STATE OF ILLINOIS  
DEPARTMENT OF TRANSPORTATION**

**SUMMARY OF QUANTITIES**

SCALE: SHEET 1 OF 2 SHEETS STA. TO STA.

F.A.S. RTE.	SECTION	COUNTY	TOTAL SHEETS	SHEET NO.
2701	D7 BRIDGE REPAIRS 2024-8	EFFINGHAM	23	3
ILLINOIS FED. AID PROJECT			CONTRACT NO. 74B34	



**EXISTING TYPICAL SECTION**

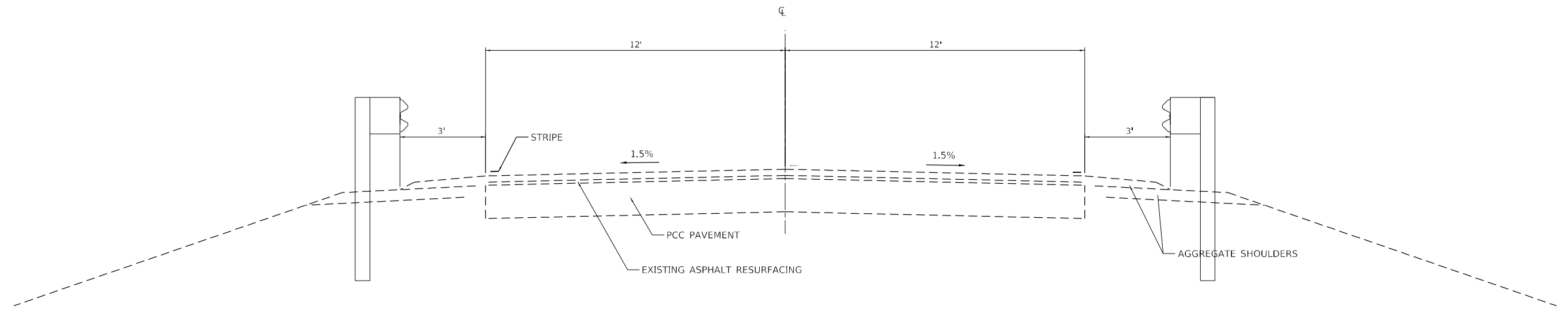

**PROPOSED TYPICAL SECTION**

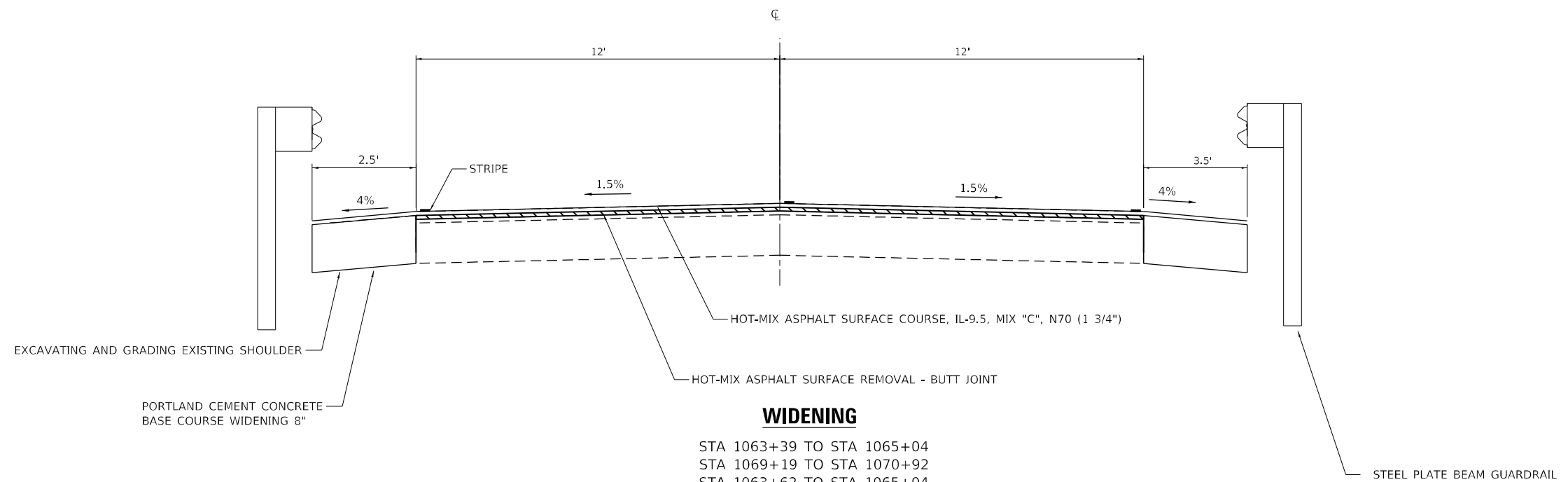

MODEL: Default  
 FILE: \\na11c1-pw-bentley.com\PW\DOT\Documents\DOT Office\Shirley\_T\Project\74B34\CADD\DATA\CAD\Sheet\DOT74B34-1-1-1-1.dgn

USER NAME = jessica.hille	DESIGNED -	REVISED -
	DRAWN -	REVISED -
PLOT SCALE = 100,0000' / in.	CHECKED -	REVISED -
PLOT DATE = 8/25/2023	DATE -	REVISED -

**STATE OF ILLINOIS  
 DEPARTMENT OF TRANSPORTATION**

<b>TYPICAL SECTIONS</b>			
SCALE:	SHEET 1	OF 1 SHEETS	STA. TO STA.

F.A.S. RTE.	SECTION	COUNTY	TOTAL SHEETS	SHEET NO.
2701	D7 BRIDGE REPAIRS 2024-8	EFFINGHAM	23	5
CONTRACT NO. 74B34				
ILLINOIS FED. AID PROJECT				

HOT-MIX ASPHALT SURFACE REMOVAL - BUTT JOINT									
STATIONING		LENGTH (FEET)	WIDTH (FEET)	WIDTH SHOULDER (FEET)	TOTAL EOP WIDTH (FEET)	AREA MAINLINE (SQ FT)	AREA SHOULDER (SQ FT)	AREA COMBINED (SQ FT)	AREA (SQ YD)
FROM	TO								
1064+64	1065+04	40	24.0	--	24.0	960	--	960	106.7
1069+20	1069+60	40	24.0	--	24.0	960	--	960	106.7
TOTALS									213

TEMPORARY RAMP					
LOCATION		RAMP WIDTH (FOOT)	DROP- OFF DEPTH (INCH)	RAMP LENGTH (FOOT)	RAMP AREA (SQ YD)
STATION	SIDE				
1065+23.50	CL	30.8	1.75	6.0	20.5
1068+99.50	CL	30.8	1.75	6.0	20.5
TOTAL					41

BITUMINOUS MATERIALS (TACK COAT)								
STATIONING		LENGTH (FEET)	WIDTH (FEET)	WIDTH SHOULDER (FEET)	AREA MAINLINE (SQ FT)	AREA SHOULDER (SQ FT)	AREA COMBINED (SQ FT)	40600290 BITUMINOUS MATERIALS (TACK COAT) MAINLINE (POUND)
FROM	TO							
1064+63.50	1065+23.50	60	30.0	18.5	1,800	1,110	2,910	145.5
1068+99.50	1069+59.50	60	30.0	18.5	1,800	1,110	2,910	145.5
TOTAL								291

TRAFFIC CONTROL SCHEDULE					
STATIONING		70400100 TEMPORARY CONCRETE BARRIER (FEET)	70400200 RELOCATE TEMPORARY CONCRETE BARRIER (FEET)	70600250 IMPACT ATTENUATORS TEMPORARY (NON- REDIRECTIVE), TEST LEVEL 3 (EACH)	70600350 IMPACT ATTENUATORS, RELOCATE (NON REDIRECTIVE), TEST LEVEL 3 (EACH)
FROM	TO				
STAGE 1					
1063+68	1070+55	687.5		2	
STAGE 2					
1063+99	1070+24		625		2

HOT-MIX ASPHALT SURFACE COURSE, IL-9.5, MIX "C", N70							
STATIONING		LENGTH (FEET)	WIDTH (FEET)	WIDTH SHOULDER (FEET)	AVG LIFT THICKNESS (INCH)	AREA MAINLINE (SQ FT)	HMA SURFACE COURSE IL-9.5 N70 (TON)
FROM	TO						
1064+63.50	1065+23.50	60	30.0	--	1.63	1,800	18.3
1068+99.50	1069+59.50	60	30.0	--	1.63	1,800	18.3
TOTALS							37

PCC BASE COURSE WIDENING 10"						
STATIONING				WIDENING WIDTH (FOOT)	WIDENING LENGTH (FOOT)	WIDENING AREA (SQ YD)
FROM	TO	RT	LT			
1063+39	1065+04	RT	RT	3.5	165.0	64.2
1069+19	1070+92	RT	RT	3.5	173.0	67.3
1063+62	1065+04	LT	LT	2.5	142.0	39.4
1069+19	1070+50	LT	LT	2.5	131.0	36.4
TOTAL						207

PAVEMENT MARKING SCHEDULE							
STATION		SIDE	LENGTH FOOT	PAVEMENT MARKING BLACKOUT TAPE, 5" FOOT	SHORT TERM PAVEMENT MARKING REMOVAL SQ FT	PAINT PAVEMENT MARKING LINE 4"	
FROM	TO					SOLID EDGE WHITE FOOT	SKIP DASH YELLOW FOOT
STAGE 1							
1061+97	1064+28	CL	231	58	24		
1063+39	1070+92	RT	753	753	314		
1069+95	1072+20	CL	225	56	23		
STAGE 2							
1063+62	1065+18	LT	156	156	65		
1069+05	1070+50	LT	145	145	60		
1061+97	1072+20	CL	1023				256
1061+97	1072+20	LT/RT	1023			2046	
TOTAL					1168	486	256

MODEL: Default  
 FILE: \\na11e-pls\ultra-cw-bendray.com\PIV\DOT\Documents\1\DOT Office\Director\_7\Project\74B34\CAD\DATA\CAD\Sheet\DOT74B34-Pls\Reschedule.dwg  
 PLOT DATE = 8/25/2023

USER NAME = jessica.hille	DESIGNED -	REVISED -
	DRAWN -	REVISED -
PLOT SCALE = 100,0000' / in.	CHECKED -	REVISED -
PLOT DATE = 8/25/2023	DATE -	REVISED -

**STATE OF ILLINOIS  
 DEPARTMENT OF TRANSPORTATION**

SCHEDULE OF QUANTITIES			
SCALE:	SHEET	OF	SHEETS
	1	1	

F.A.S RTE.	SECTION	COUNTY	TOTAL SHEETS	SHEET NO.
2701	D7 BRIDGE REPAIRS 2024-8	EFFINGHAM	23	6
				CONTRACT NO. 74B34
ILLINOIS FED. AID PROJECT				

TEMPORARY CONCRETE BARRIER		
STAGE 1		FOOT
1063+68	1070+55	687.5

IMPACT ATTENUATORS, TEMP (NON-REDIRECTIVE) TL 3		
STAGE 1		
1063+68	1	EACH
1070+55	1	EACH
TOTALS	2	EACH

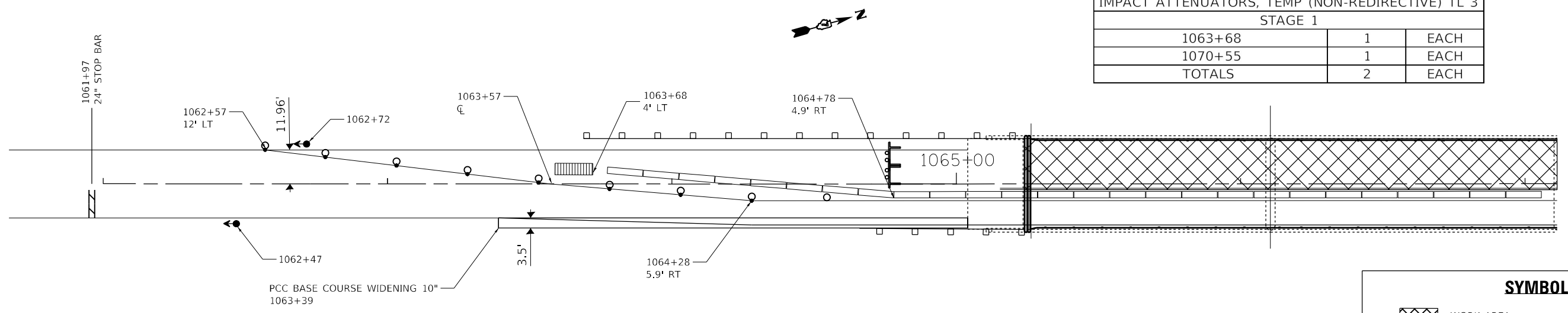

PAVEMENT MARKING BLACKOUT TAPE, 5"			
STAGE 1			
1061+97.00	1064+28.00	58.0	FOOT
1063+39.00	1070+92.00	753.0	FOOT
1069+95.00	1072+20.00	56.0	FOOT
	STAGE 1 TOTALS	867	FOOT

SHORT TERM PAVEMENT MARKING REMOVAL				
STAGE 1				
1061+97.00	1064+28.00	24.0	SQ FT	
1063+39.00	1070+92.00	314.0	SQ FT	
1069+95.00	1072+20.00	23.0	SQ FT	
	STAGE 1 TOTALS	361	SQ FT	

**SYMBOLS**

- WORK AREA
- DRUM WITH STEADY BURNING BI-DIRECTIONAL LIGHT
- TEMPORARY CONCRETE BARRIER
- TYPE III BARRICADE WITH FLASHING LIGHTS
- TRAFFIC SIGNAL
- IMPACT ATTENUATOR
- DRUM

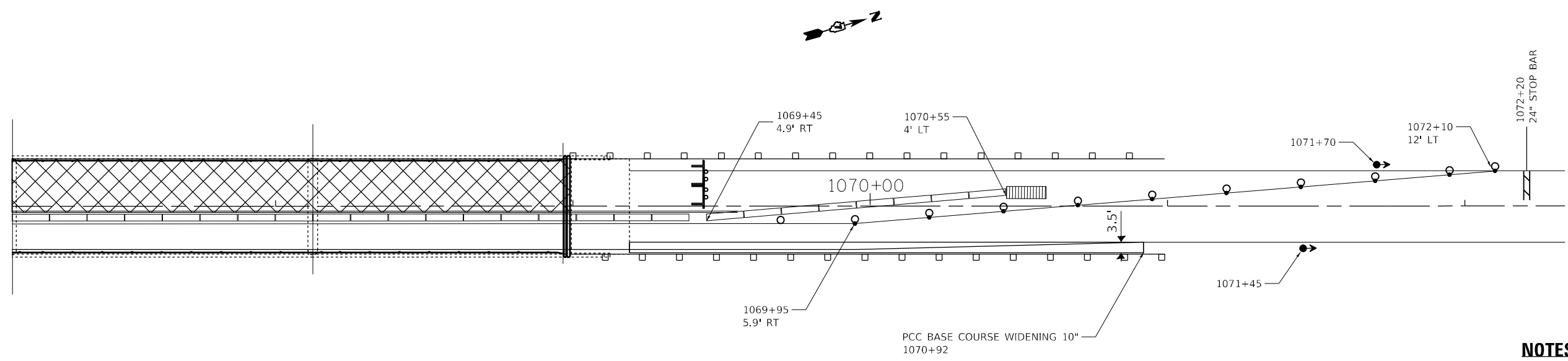

**NOTES**  
SEE TRAFFIC CONTROL AND PROTECTION STANDARD 701321 FOR INFORMATION NOT SHOWN ON THIS SHEET.

MODEL: Default  
FILE NAME: p:\ultra-cw-bead\p\com\p\w\dot\Documents\DOT Office\Director\_7\Projects\74B34\CADD\DATA\CAD\Sheet\74B34-1-1-1.dwg

USER NAME = jessica.wille	DESIGNED -	REVISED -
	DRAWN -	REVISED -
PLOT SCALE = 40,0000 * / in.	CHECKED -	REVISED -
PLOT DATE = 8/23/2023	DATE -	REVISED -

**STATE OF ILLINOIS  
DEPARTMENT OF TRANSPORTATION**

STAGE 1 DETAILS			
SCALE:	SHEET 1	OF 1 SHEETS	STA. TO STA.

F.A.S. RTE.	SECTION	COUNTY	TOTAL SHEETS	SHEET NO.
2701	D7 BRIDGE REPAIRS 2024-8	EFFINGHAM	23	7
				CONTRACT NO. 74B34
ILLINOIS FED. AID PROJECT				

RELOCATE TEMPORARY CONCRETE BARRIER		
STAGE 2		(FOOT)
1063+99	1070+24	625

IMPACT ATTENUATORS, RELOCATE (NON-REDIRECTIVE) TL 3		
STAGE 2		
1070+24	1	EACH
1063+99	1	EACH
TOTALS	2	EACH

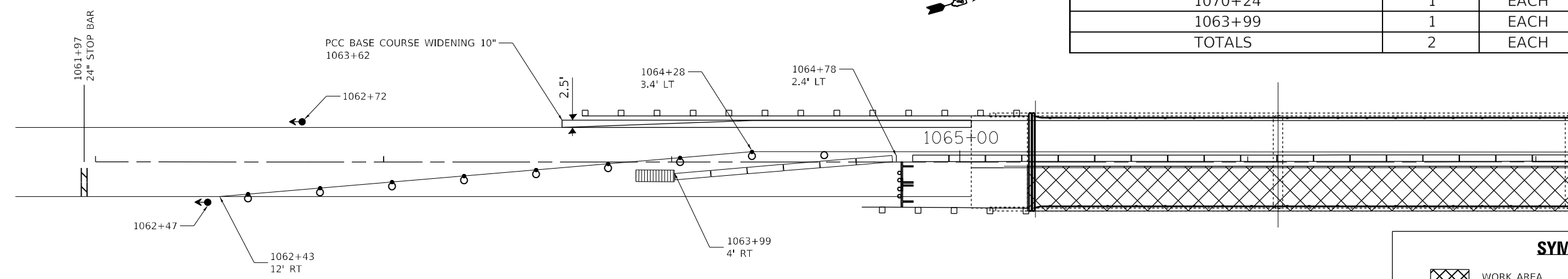

PAVEMENT MARKING BLACKOUT TAPE, 5"			
STAGE 2			
1063+62.00	1065+18.00	156.0	EACH
1069+05.00	1070+50.00	145.0	EACH
	STAGE 2 TOTALS	301	EACH

SHORT TERM PAVEMENT MARKING REMOVAL			
STAGE 2			
1063+62.00	1065+18.00	65.0	SQ FT
1069+05.00	1070+50.00	60.0	SQ FT
	STAGE 2 TOTALS	125	SQ FT

SYMBOLS	
	WORK AREA
	DRUM WITH STEADY BURNING BI-DIRECTIONAL LIGHT
	TEMPORARY CONCRETE BARRIER
	TYPE III BARRICADE WITH FLASHING LIGHTS
	TRAFFIC SIGNAL
	IMPACT ATTENUATOR
	DRUM

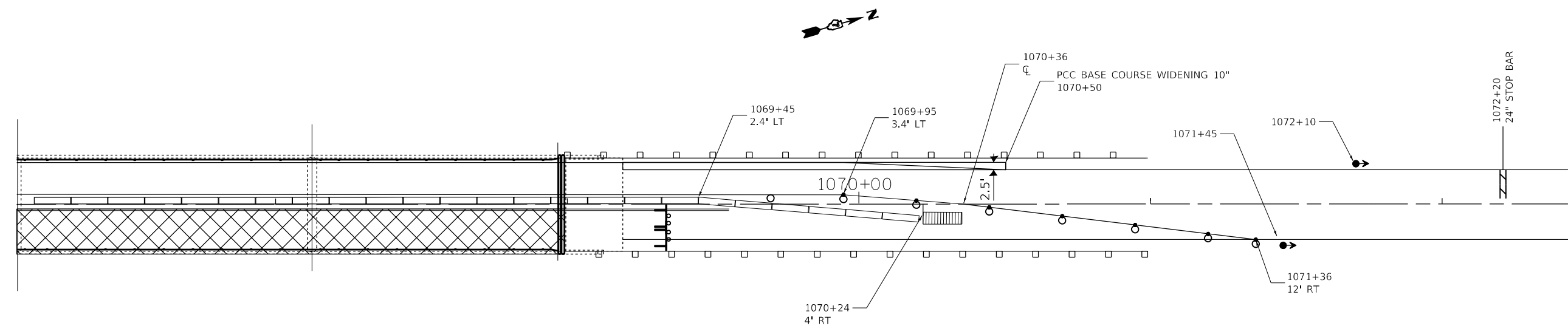

**NOTES**  
SEE TRAFFIC CONTROL AND PROTECTION STANDARD 701321 FOR INFORMATION NOT SHOWN ON THIS SHEET.

MODEL: Default  
FILE: \\nafile:pub\ultra-cw-beadley.com\PI\DOT\Documents\DOT Office\Director\_7\Projects\74B34\CADD\Drawings\CAD\Sheet\074B34-1-1-1.dwg

USER NAME = jessica.ville	DESIGNED -	REVISED -
	DRAWN -	REVISED -
PLOT SCALE = 40,0000 * / in.	CHECKED -	REVISED -
PLOT DATE = 8/23/2023	DATE -	REVISED -

**STATE OF ILLINOIS  
DEPARTMENT OF TRANSPORTATION**

STAGE 2 DETAILS			
SCALE:	SHEET 1	OF 1 SHEETS	STA. TO STA.

F.A.S. RTE.	SECTION	COUNTY	TOTAL SHEETS	SHEET NO.
2701	D7 BRIDGE REPAIRS 2024-8	EFFINGHAM	23	8
				CONTRACT NO. 74B34
ILLINOIS FED. AID PROJECT				



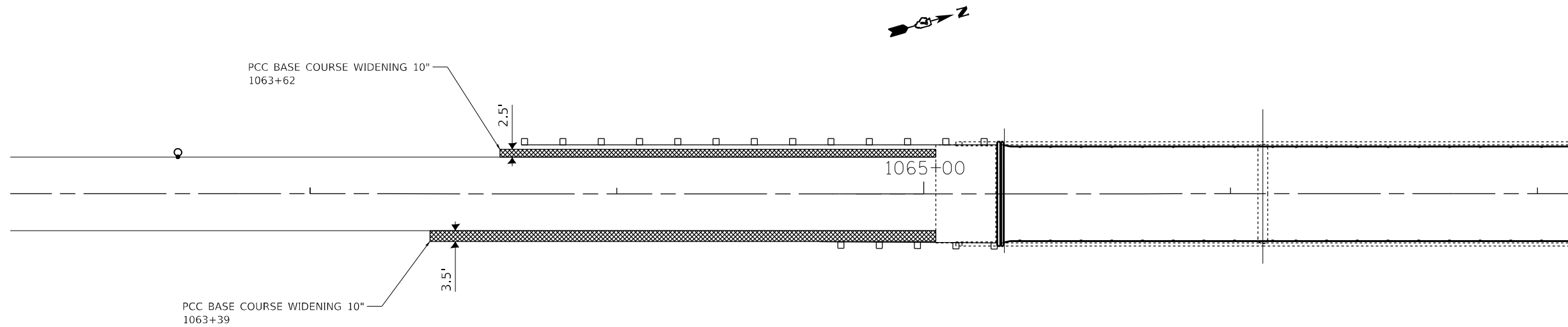

PCC BASE COURSE WIDENING 10"						
STATIONING				WIDENING WIDTH (FOOT)	WIDENING LENGTH (FOOT)	WIDENING AREA (SQ YD)
FROM		TO				
1063+39	RT	1065+04	RT	3.5	165.0	64.2
1069+19	RT	1070+92	RT	3.5	173.0	67.3
1063+62	LT	1065+04	LT	2.5	142.0	39.4
1069+19	LT	1070+50	LT	2.5	131.0	36.4
TOTAL						207

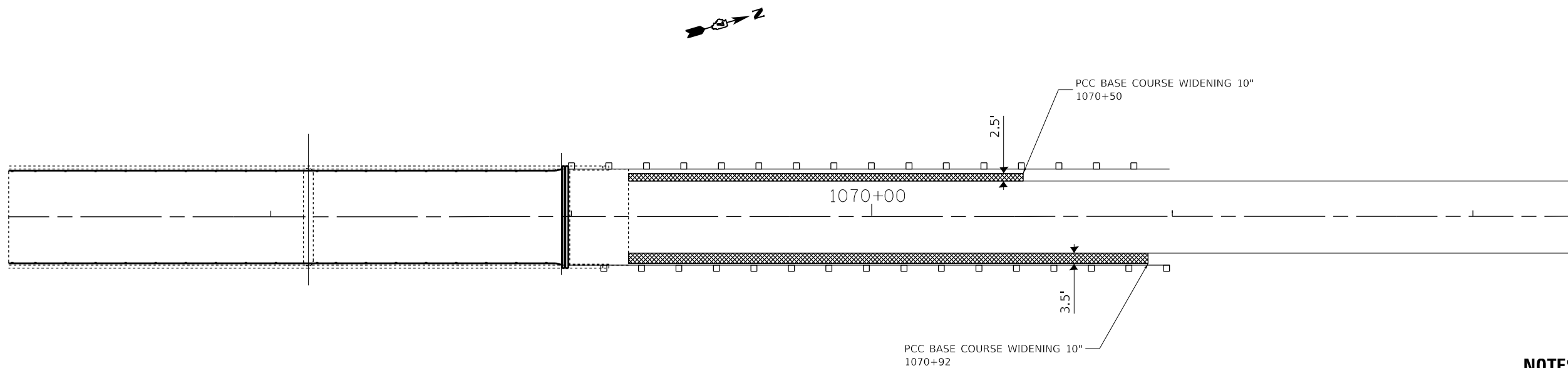

**NOTES**

SEE TRAFFIC CONTROL AND PROTECTION STANDARD 701326 FOR INFORMATION NOT SHOWN ON THIS SHEET.

MODEL: Default  
 FILE: \\na11e01-pw-bentley.com\PW\DOT\Documents\DOT Offices\Director\_7\Projects\74B34\CADD\Drawings\CAD\Sheet\74B34-1-1-1.dwg

USER NAME = jessica.hille	DESIGNED -	REVISED -
	DRAWN -	REVISED -
PLOT SCALE = 40,0000 * / in.	CHECKED -	REVISED -
PLOT DATE = 8/25/2023	DATE -	REVISED -

**STATE OF ILLINOIS  
DEPARTMENT OF TRANSPORTATION**

**WIDENING DETAILS**

SCALE: SHEET 1 OF 1 SHEETS STA. TO STA.

F.A.S. RTE.	SECTION	COUNTY	TOTAL SHEETS	SHEET NO.
2701	D7 BRIDGE REPAIRS 2024-8	EFFINGHAM	23	9
CONTRACT NO. 74B34				
ILLINOIS FED. AID PROJECT				

EXISTING STRUCTURE: SN 025-0089 carries ILL 37 over Little Wabash River. The four span, P.C.C. I-beam structure was built in 1981. The proposed project consists of replacement of the expansion joints with new strip seals, replacement of deck drains, full depth deck patching, scarification & concrete overlay.

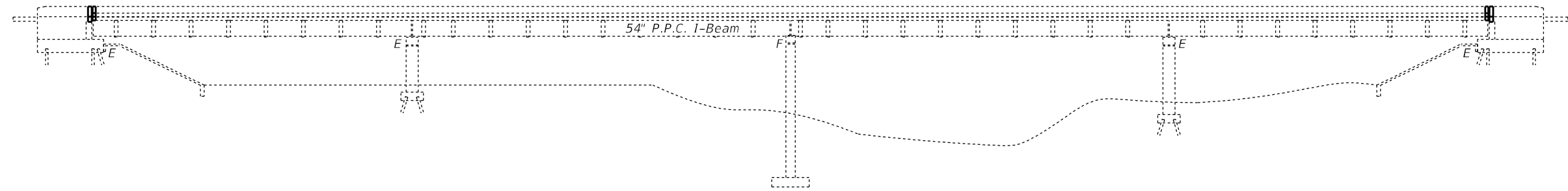

ELEVATION

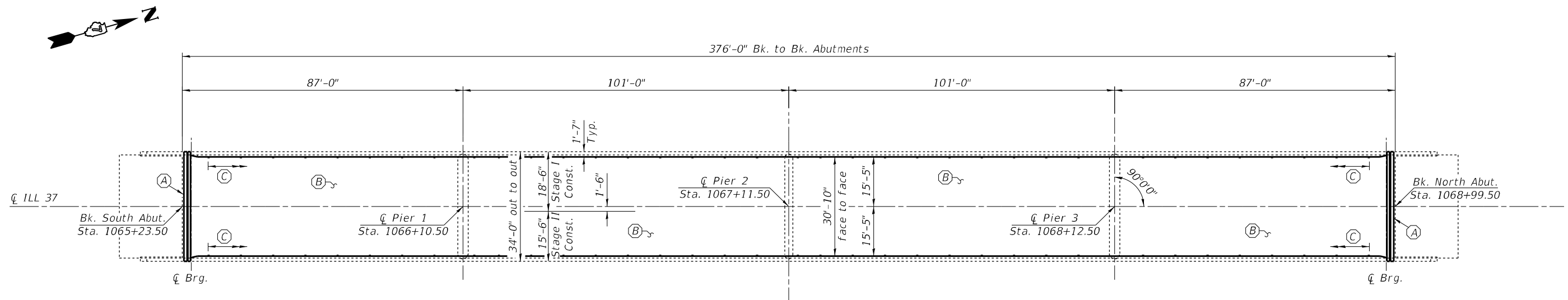

PLAN

- (A) - Remove Existing Joints and Construct Strip Seal Expansion Joint
- (B) - Bridge Deck Scarification  $\frac{3}{4}$ " , Deck Patching, Bridge Deck Fly Ash or GGBF Slag Concrete Overlay  $2\frac{1}{2}$ " , Diamond Grinding (Bridge Section)
- (C) - Remove and Replace Existing Floor Drains

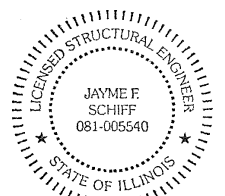

Expires 11-30-2024

*Jayme F. Schiff*

MODEL: Default  
 FILE: 3dmodel.pia  
 PROJECT: 74834\CADD\Drawings\DOT Office\District 7\Projects\74834\CADD\Drawings\DOT Office\District 7\Projects\74834-025-0089 Bridge Repair

USER NAME = jessica.hille	DESIGNED - T. Walk	REVISED -
	DRAWN - T. Walk	REVISED -
PLOT SCALE = 100,0000' / in.	CHECKED - D. Macklin	REVISED -
PLOT DATE = 8/23/2023	DATE - September 2022	REVISED -

STATE OF ILLINOIS  
DEPARTMENT OF TRANSPORTATION

GENERAL PLAN & ELEVATION  
S.N. 025-0089

SCALE: SHEET 1 OF 9 SHEETS STA. TO STA.

F.A.S. RTE.	SECTION	COUNTY	TOTAL SHEETS	SHEET NO.
2701	D7 BRIDGE REPAIRS 2024-8	EFFINGHAM	23	10
ILLINOIS FED. AID PROJECT			CONTRACT NO. 74834	

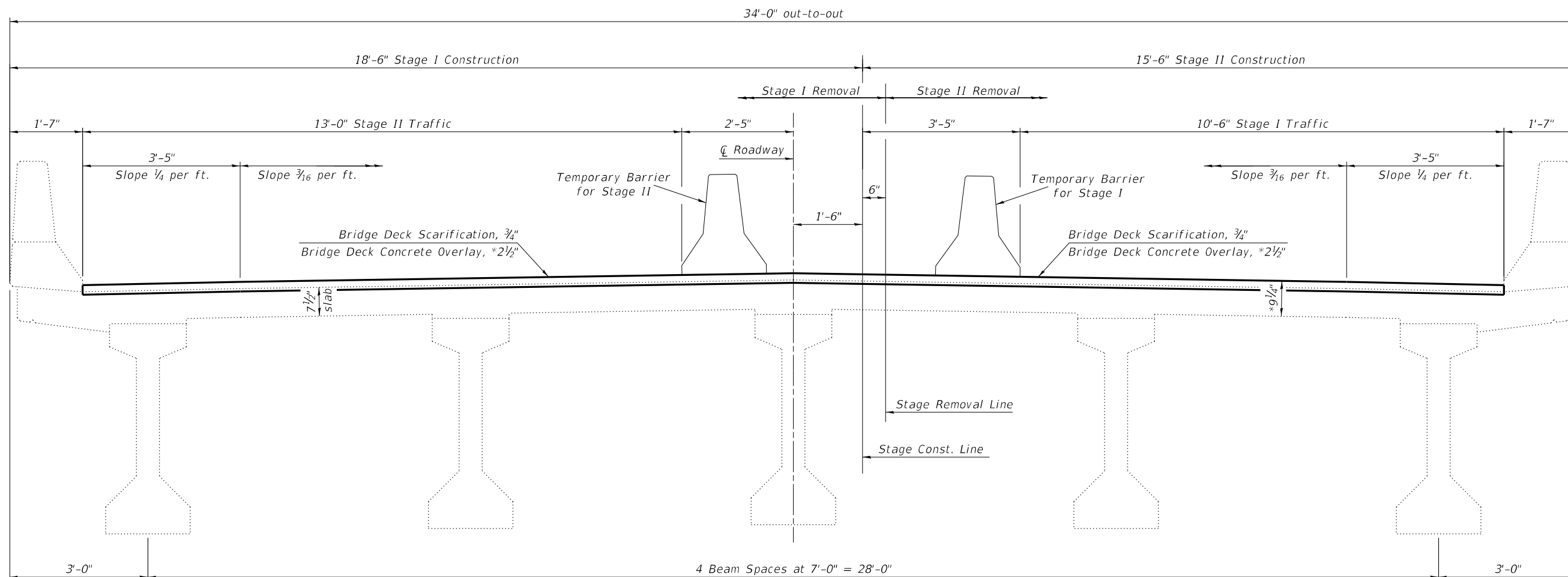

\* Overlay thickness prior to grinding

**STAGE CONSTRUCTION DETAIL**  
Looking North

**GENERAL NOTES**

Plan dimensions and details relative to existing plans are subject to nominal construction variations. The Contractor shall field verify existing dimensions and details affecting new construction and make necessary approved adjustments prior to construction or ordering of materials. Such variations shall not be cause for additional compensation for a change in scope of the work, however, the Contractor will be paid for the quantity actually furnished at the unit price bid for the work.

Reinforcement Bars designated (E) shall be epoxy coated.

Existing reinforcement bars extending into the removal area shall be cleaned, straightened and incorporated into the new construction. Any reinforcement bars that are damaged during concrete removal operations shall be replaced with an approved bar splicer or anchorage system. Cost included with CONCRETE REMOVAL.

It is anticipated that a full depth deck slab repair will be necessary at each existing floor drain location. Removal and disposal of the existing floor drains shall be included in the contract unit price for Deck Slab Repair (Full Depth, Type I).

Protective Coat to be applied to areas of new concrete only, including bridge deck concrete overlay.

Joint openings shall be adjusted according to Article 520.04 of the Standard Specifications when the deck is poured at an ambient temperature other than 50 °F.

Areas of deck repairs shown are estimated. The Engineer shall show actual locations of deck repairs on as-built plans.

Full depth deck slab repairs performed in the exterior bays of the bridge deck (between the parapet walls and the first interior beams) shall be limited to individual lengths no greater than 10'. In these portions of the deck, repair areas longer than 10' shall be divided into segments not greater than 10' in length, and the segments shall be poured in alternating sequence. Subsequent segments repaired in sequence shall not be removed until 72 hours shall have elapsed from the end of the previous, adjacent pour, and the adjacent pour shall have attained a minimum modulus of rupture of 650psi.

**TOTAL BILL OF MATERIAL**

ITEM	UNIT	QUANTITY
Concrete Removal	Cu. Yd.	5.6
Concrete Superstructure	Cu. Yd.	6.2
Reinforcement Bars, Epoxy Coated	Pound	960
Bar Splicers	Each	12
Bridge Deck Scarification, 3/4"	Sq. Yd.	1,271
Bridge Deck Fly Ash or GGBF Slag Concrete Overlay, 2 1/2"	Sq. Yd.	1,271
Diamond Grinding (Bridge Section)	Sq. Yd.	1,112
Bridge Deck Grooving (Longitudinal)	Sq. Yd.	992
Preformed Joint Strip Seal	Foot	68
Protective Coat	Sq. Yd.	1,288
Deck Slab Repair (Full Depth, Type I)	Sq. Yd.	26.0
Deck Slab Repair (Full Depth, Type II)	Sq. Yd.	8.0
Approach Slab Repair (Partial Depth)	Sq. Yd.	1.0
Floor Drains	Each	56

MODEL: 34002ELNAMES  
FILE NAME: STS15

USER NAME = \$USERS	DESIGNED - T. Walk	REVISED -
	DRAWN - T. Walk	REVISED -
PLOT SCALE = \$SCALE\$	CHECKED - D. Macklin	REVISED -
PLOT DATE = \$DATE\$	DATE - September 2022	REVISED -

**STATE OF ILLINOIS  
DEPARTMENT OF TRANSPORTATION**

**STAGE CONSTRUCTION, GENERAL NOTES, &  
BILL OF MATERIALS S.N. 025-0089**

SCALE: SHEET 2 OF 9 SHEETS STA. TO STA.

F.A.S RTE.	SECTION	COUNTY	TOTAL SHEETS	SHEET NO.
2701	D7 BRIDGE REPAIRS 2024-8	EFFINGHAM	23	11
ILLINOIS FED. AID PROJECT			CONTRACT NO. 74B34	

For Sections A-A & B-B See Sheet 4 of 9



Note: Hatched area indicates removal.

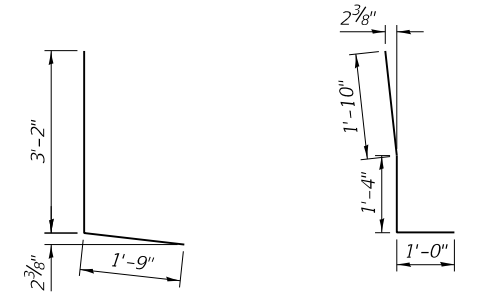
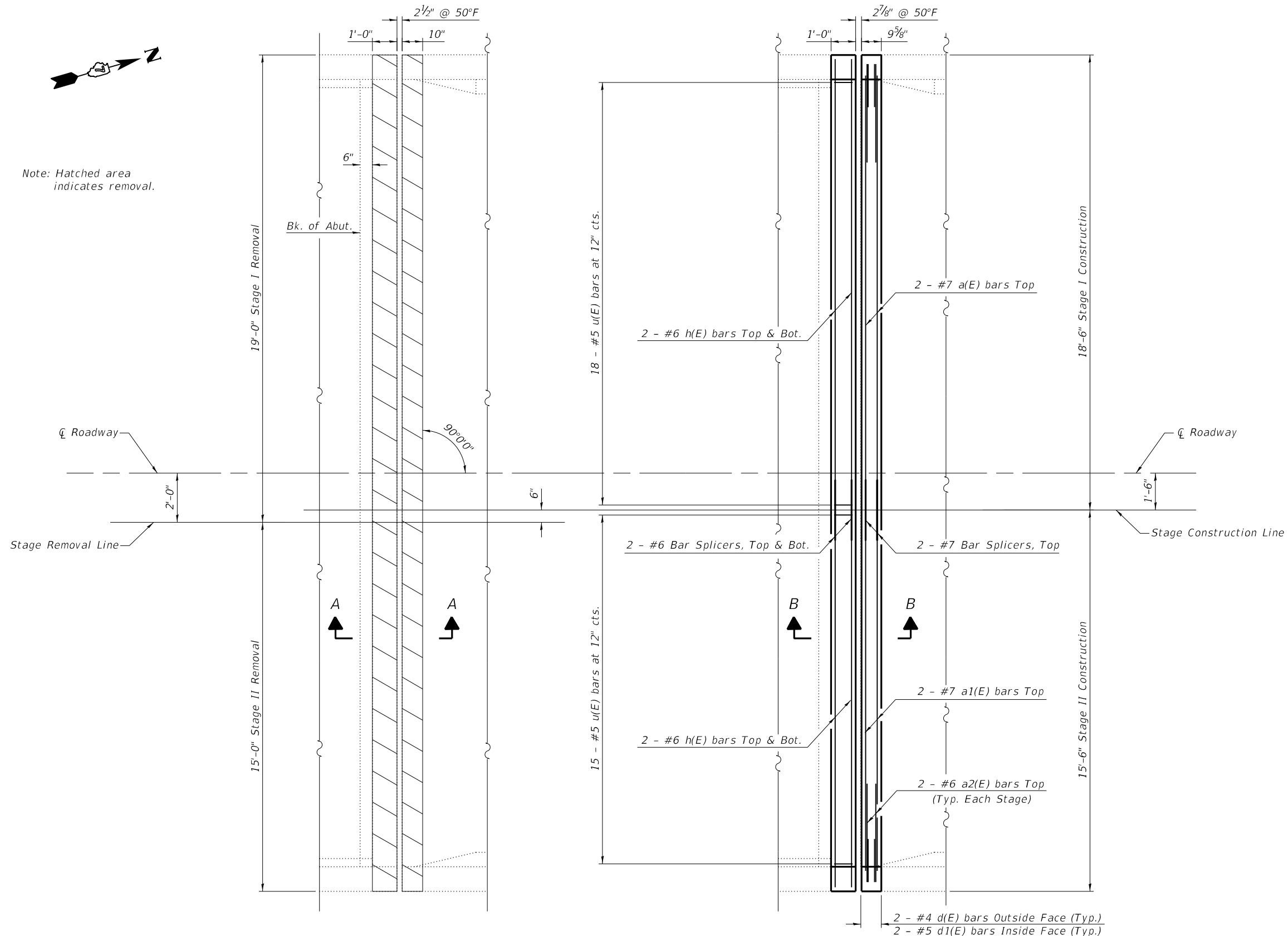

BAR d(E)      BAR d1(E)

BAR u(E)

**REMOVAL PLAN**  
South Abutment Shown  
North Abutment Similar

**REINFORCEMENT PLAN**  
South Abutment Shown  
North Abutment Similar

**BILL OF MATERIAL - TWO ABUTMENTS**

Bar	No.	Size	Length	Shape
a(E)	4	#7	17'-6"	—
a1(E)	4	#7	14'-6"	—
a2(E)	8	#6	4'-0"	—
h(E)	8	#6	18'-2"	—
h1(E)	8	#6	15'-2"	—
d(E)	8	#4	4'-11"	L
d1(E)	8	#5	4'-2"	L
u(E)	66	#5	2'-9"	U
ITEM		UNIT	QUANTITY	
Concrete Removal		Cu. Yd.	5.6	
Concrete Superstructure		Cu. Yd.	6.2	
Reinforcement Bars, Epoxy Coated		Pound	960	
Bar Splicers		Each	12	

MODEL: \$MODELNAME\$  
FILE NAME: \$FILE\$

USER NAME = \$USERS	DESIGNED - T. Walk	REVISED -
PLOT SCALE = \$SCALE\$	DRAWN - T. Walk	REVISED -
PLOT DATE = \$DATE\$	CHECKED - D. Macklin	REVISED -
	DATE - September 2022	REVISED -

**STATE OF ILLINOIS  
DEPARTMENT OF TRANSPORTATION**

**EXPANSION JOINT REPLACEMENT DETAILS  
S.N. 025-0089**

SCALE: SHEET 3 OF 9 SHEETS STA. TO STA.

F.A.S. RTE.	SECTION	COUNTY	TOTAL SHEETS	SHEET NO.
2701	D7 BRIDGE REPAIRS 2024-8	EFFINGHAM	23	12
ILLINOIS FED. AID PROJECT			CONTRACT NO. 74B34	

Note: Hatched areas indicate removal

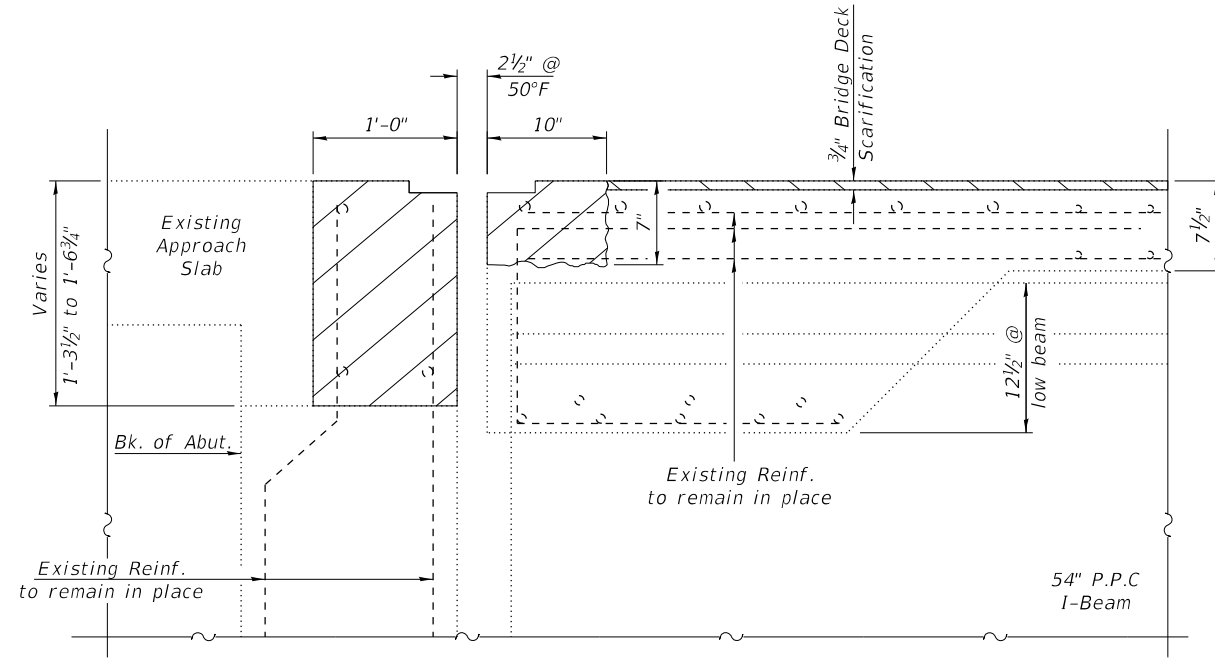

SECTION A-A

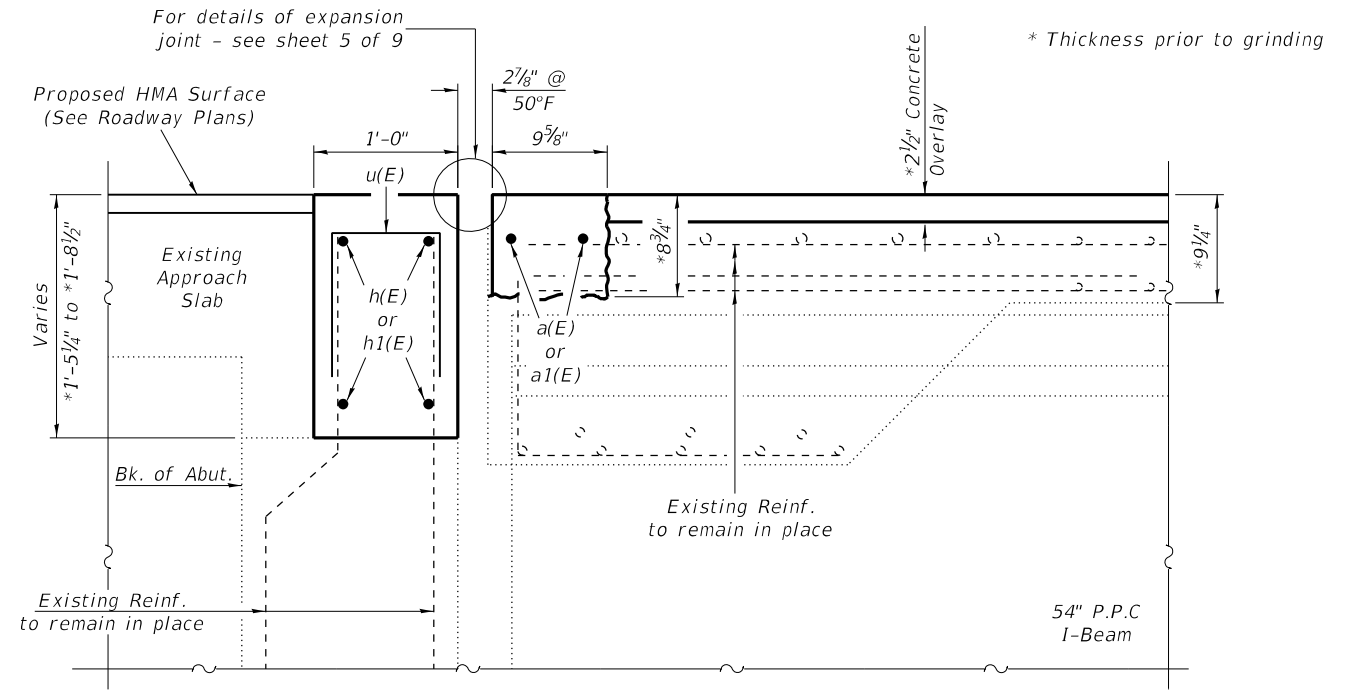

SECTION B-B

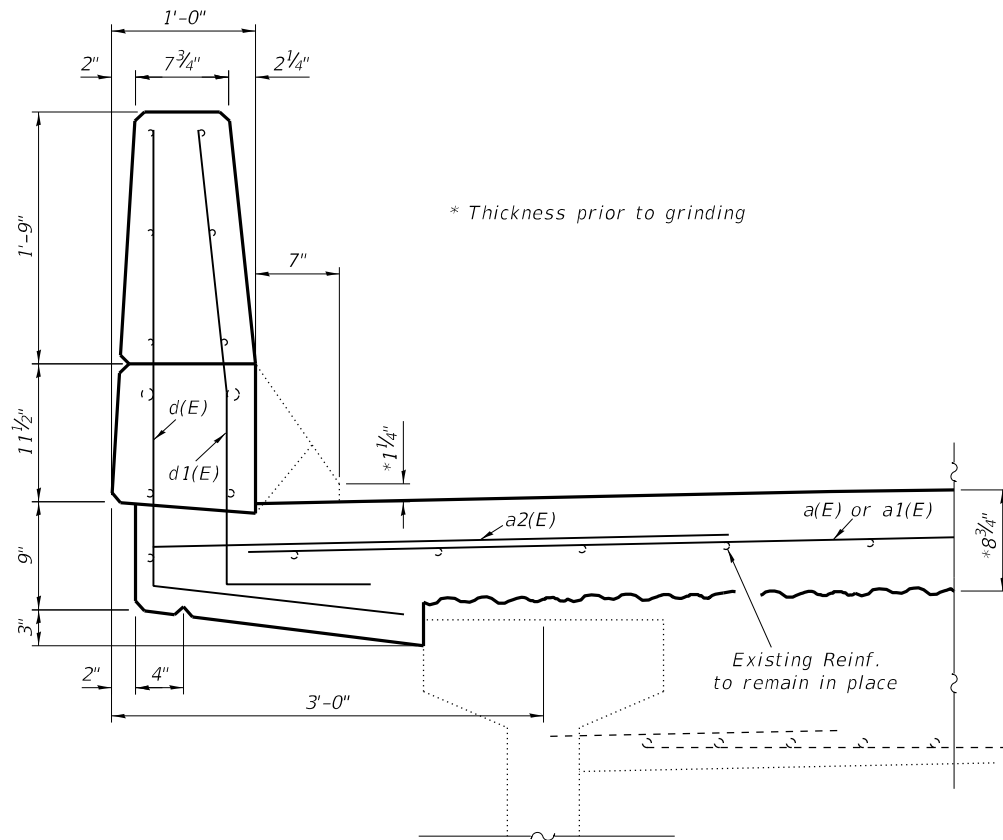

SECTION THRU DECK PARAPET

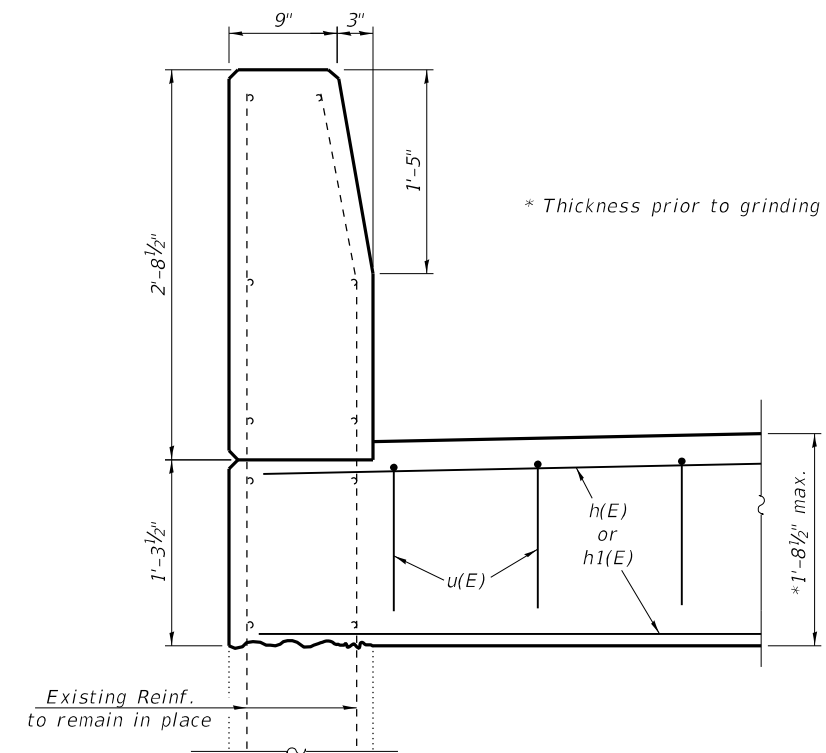

SECTION THRU APPROACH PARAPET

MODEL: 3408ELNAMES  
FILE NAME: STEEL5

USER NAME = \$USERS	DESIGNED - T. Walk	REVISED -
	DRAWN - T. Walk	REVISED -
PLOT SCALE = \$SCALE\$	CHECKED - D. Macklin	REVISED -
PLOT DATE = \$DATE\$	DATE - September 2022	REVISED -

STATE OF ILLINOIS  
DEPARTMENT OF TRANSPORTATION

EXPANSION JOINT REPLACEMENT DETAILS  
S.N. 025-0089

SCALE: SHEET 4 OF 9 SHEETS STA. TO STA.

F.A.S. RTE.	SECTION	COUNTY	TOTAL SHEETS	SHEET NO.
2701	D7 BRIDGE REPAIRS 2024-8	EFFINGHAM	23	13
CONTRACT NO. 74B34				
ILLINOIS FED. AID PROJECT				

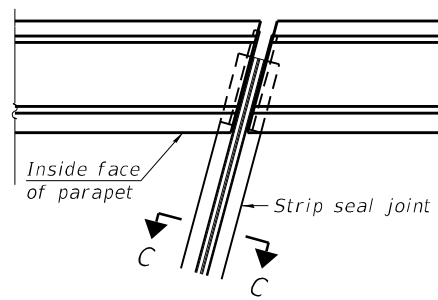

**PLAN AT PARAPET**

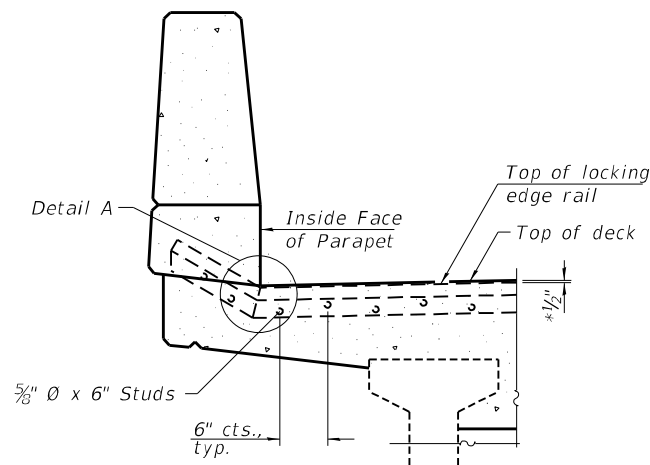

**ELEVATION AT PARAPET**

(Skews > 30° shown. Skews ≤ 30° similar except as shown in plan view.)

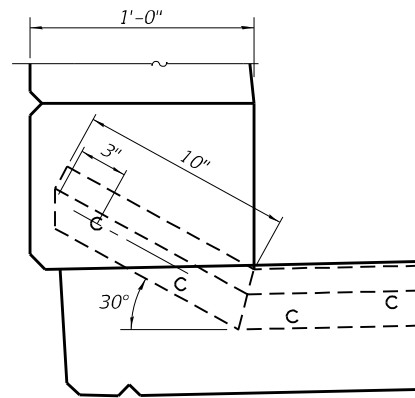

**DETAIL A**

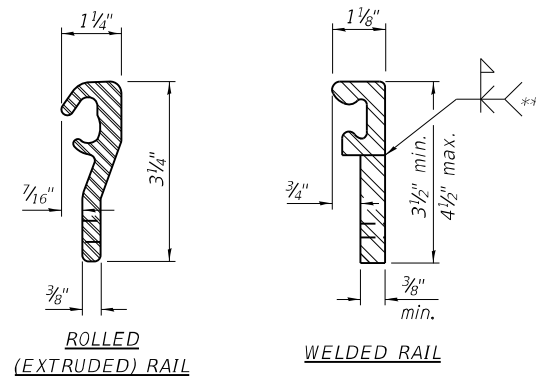

**LOCKING EDGE RAILS**

\*\*\* Back gouge not required if complete joint penetration is verified by mock-up.

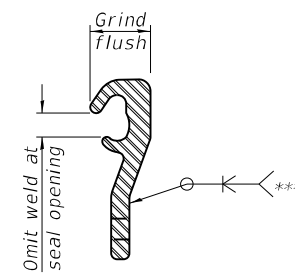

**LOCKING EDGE RAIL SPLICE**

The inside of the locking edge rail groove shall be free of weld residue. Rolled rail shown, welded rail similar.

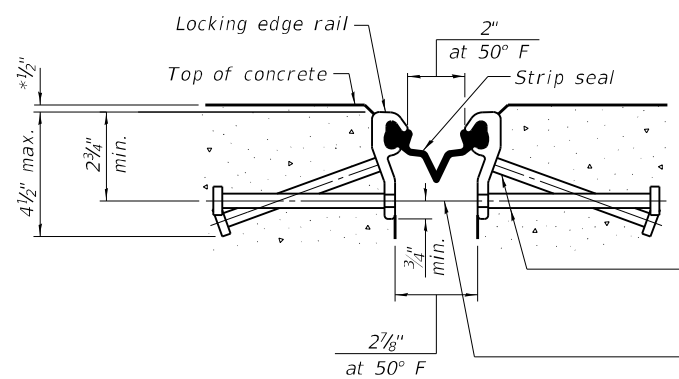

**SHOWING ROLLED RAIL JOINT**

\* Thickness prior to grinding

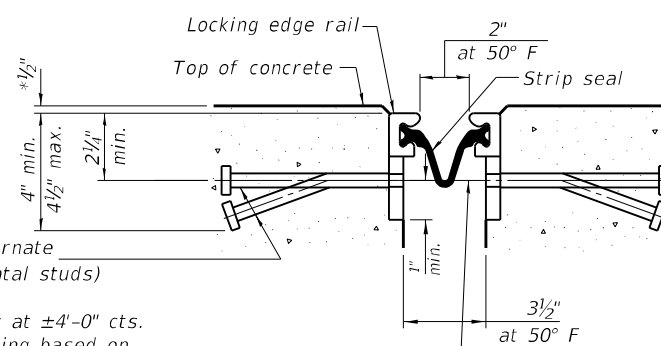

**SHOWING WELDED RAIL JOINT**

\*\* 5/8" Ø x 6" studs @ 6" cts. (alternate angled/bent studs with horizontal studs)

3/8" Ø threaded rods in 3/16" Ø holes at ±4'-0" cts. for holding the proper joint opening based on the temperature during the deck pour. Place to miss studs. All rods shall be burned, or sawed off flush with the plates after concrete is set.

**SECTION C-C**

\*\* Granular or solid flux filled headed studs conforming to Article 1006.32 of the Std. Specs., automatically end welded.

**Notes:**

The strip seal shall be made continuous and shall have a minimum thickness of 1/4". The configuration of the strip seal shall match the configuration of the locking edge rails. Open or "webbed" strip seal gland configurations are not permitted. The gland shall be sized for a maximum rated movement of 4 inches.

The locking edge rails depicted are configured for typical applications and are conceptual only. The actual configuration of the locking edge rails and matching strip seal may vary from manufacturer to manufacturer provided they fit the application and meet the minimum anchorage shown. Flanged edge rails, however, will not be allowed. Locking edge rails may exceed the 4 1/2" maximum depth provided the anchorage system is revised according to the manufacturer's recommendation.

The manufacturer's recommended installation methods shall be followed.

All steel components shall be galvanized after fabrication according to Article 520.03 of the Standard Specifications.

The Maximum space between locking edge rail segments shall be 3/16" and sealed with a suitable sealant; however, any rail joint within 10' measured perpendicular to the face of the curb or parapet shall be welded as shown in the locking edge rail splice detail.

The concrete opening below the strip seal will vary based on the locking edge rail chosen by the Contractor. Deck and parapet lengths shown elsewhere in the plans are dimensioned to the concrete opening, not the joint opening, and are based on the rolled locking edge rail. If the Contractor elects to use a different locking edge rail, dimensional adjustments may be required. One exception to this would be the strip seal joint at the end of the precast bridge approach slab. For these cases the pavement connector length shall be adjusted, not the length of the bridge approach slab.

**BILL OF MATERIAL**

Item	Unit	Total
Preformed Joint Strip Seal	Foot	68

MODEL: Default FILE: 304162-2023-08-25-10-08-09-0809 Bridge Repair

USER NAME = jessica.hille	DESIGNED - T. Walk	REVISED -
PLOT SCALE = 100,0000' / in.	DRAWN - T. Walk	REVISED -
PLOT DATE = 8/23/2023	CHECKED - D. Macklin	REVISED -
	DATE - September 2022	REVISED -

**STATE OF ILLINOIS  
DEPARTMENT OF TRANSPORTATION**

**PREFORMED JOINT STRIP SEAL DETAIL  
S.N. 025-0089**

SCALE: SHEET 5 OF 9 SHEETS STA. TO STA.

F.A.S RTE.	SECTION	COUNTY	TOTAL SHEETS	SHEET NO.
2701	D7 BRIDGE REPAIRS 2024-8	EFFINGHAM	23	14
ILLINOIS FED. AID PROJECT			CONTRACT NO. 74B34	

Note: Hatched area indicates removal.

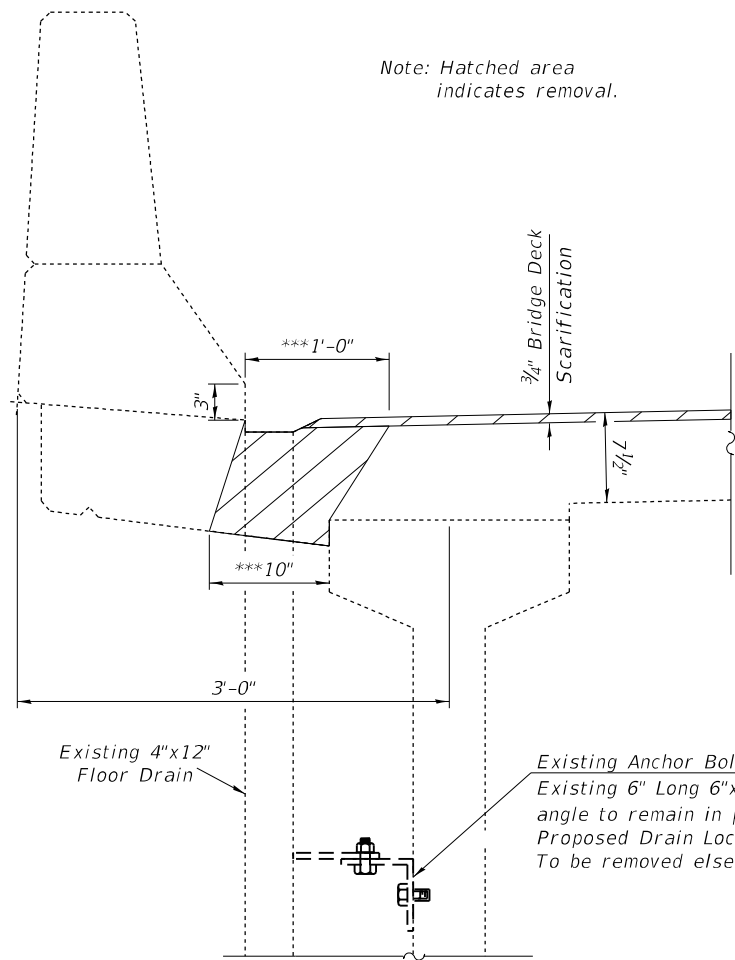

SECTION THRU EXISTING FLOOR DRAIN

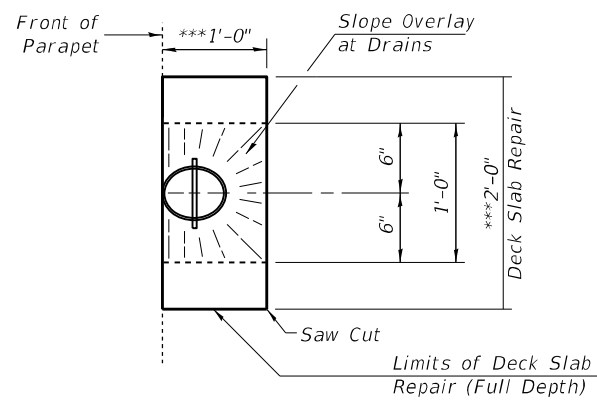

TOP PLAN DECK REPAIR AT PROPOSED DRAINS

\*\*\* Actual dimensions of Deck Slab Repair shall be determined by the Engineer

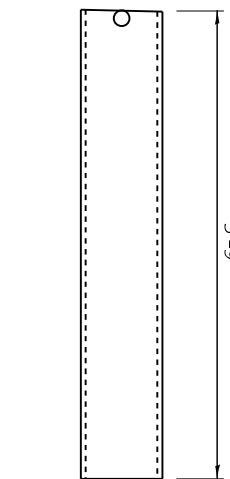

DRAIN DETAIL

56 Required

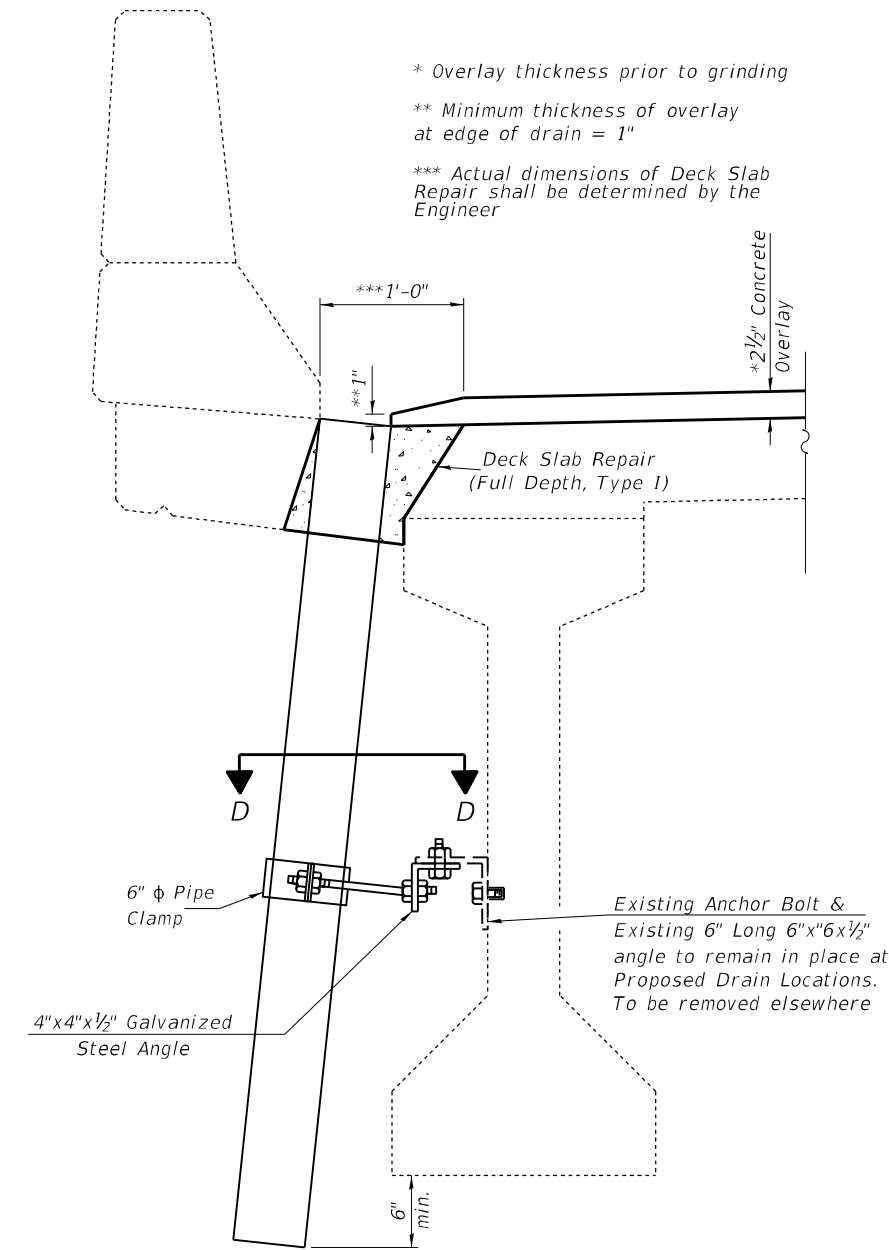

DRAIN REPLACEMENT DETAIL

NOTES

- Fiberglass pipe drain option not allowed.
- Galvanize clamping device according to AASHTO M232. Cost of clamping device, bolts and galvanizing is included with Floor Drains.
- Concrete removal and replacement quantities and locations for drains are included in Deck Slab Repair (Full Depth, Type 1) as shown on "Bridge Deck Patching" see sheets 7 & 8 of 9.
- Extreme care must be used when removing concrete near the top flange of the Precast Concrete I-Beams. The contractor is responsible for any damage to the beams.

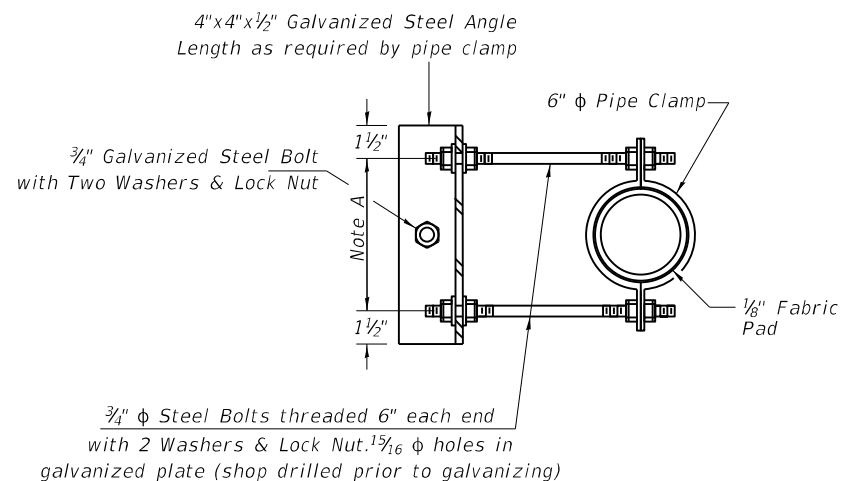

SECTION D-D

Note A: Dimension as required by Pipe Clamp

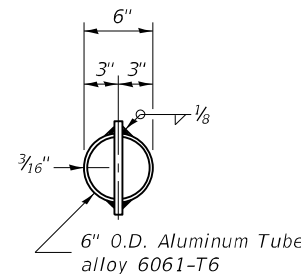

TOP PLAN

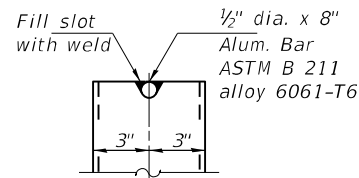

ALUMINUM TUBE

MODEL: Default  
FILE: I:\MISC\_Plan\Subcontract\aw\_bec\paw.com\FIN\DOT\Documents\DOT Office\Dir\drdr: 7\Project\74B34\CADD\Bids\CADD\Revised\74B34-025-0089 Bridge Repair

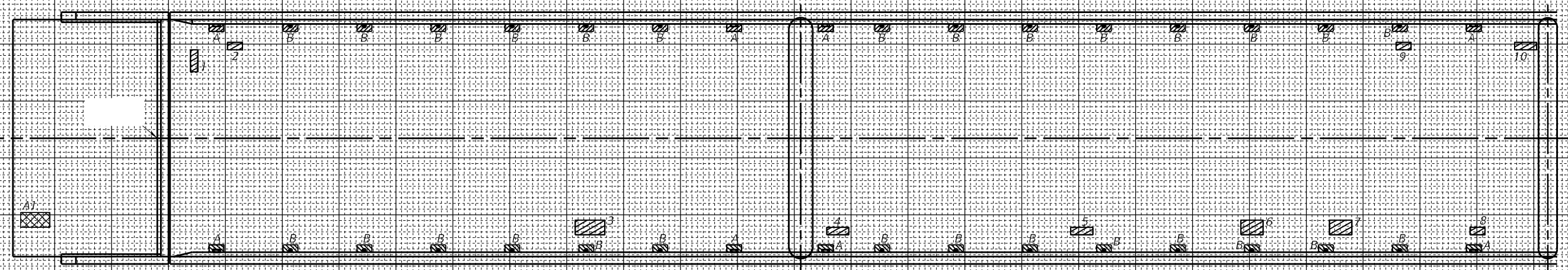
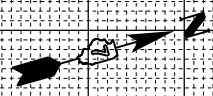

PATCH NO.	SIZE		DECK SLAB REPAIR (FD TY I)	DECK SLAB REPAIR (FD TY II)
	LENGTH	WIDTH	SQ YD	SQ YD
1	1.0	3.0	0.3	
2	2.0	1.0	0.2	
3	4.0	2.0		0.9
4	3.0	1.0	0.3	
5	3.0	1.0	0.3	
6	3.0	2.0		0.7
7	3.0	2.0		0.7
8	2.0	1.0	0.2	
9	2.0	1.0	0.2	
10	3.0	1.0	0.3	
A - Remove Drain, 8 ea			1.8	
B - Replace Drain, 28 ea			6.2	
TOTAL ROUNDS TO:			10.0	3.0

PATCH NO.	SIZE		APPROACH SLAB REPAIR (PARTIAL DEPTH)
	LENGTH	WIDTH	SQ YD
A1	4.0	2.0	0.9
TOTAL ROUNDS TO:			1.0

Note: Extreme care must be used when removing concrete near the top flange of the Precast Concrete I-Beams. The contractor is responsible for any damage to the beams.

**ESTIMATED PAY QUANTITIES**

DECK SLAB REPAIR (FULL DEPTH, TYPE I) = 10.0 SQ YD  
 DECK SLAB REPAIR (FULL DEPTH, TYPE II) = 3.0 SQ YD  
 APPROACH SLAB REPAIR (PARTIAL DEPTH) = 1.0 SQ YD  
 FLOOR DRAINS = 28 EACH

A & B = Deck Slab Repair (Full Depth, Type I)  
 2ft<sup>2</sup> = .22yd<sup>2</sup> Each

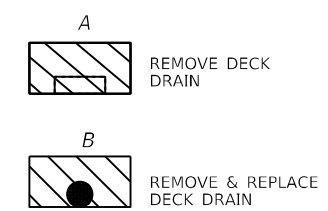

THE LOCATIONS AND SIZES SHOWN GRAPHICALLY ABOVE ARE APPROXIMATE. SEE THIS TABLE FOR ACTUAL SIZES.

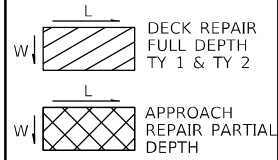

DATE OF SURVEY: 7-12-2022  
 SURVEY BY: DPM & TMW  
 METHOD OF SURVEY: VISUAL

MODEL: Default  
 FILE NAME: p:\w\p\w\benley.com\p\p\DOT\Documents\DOT - Offices\District 7\Projects\74834\CAD\Drawings\DOT\74834-025-0089 - Bridge - Repair

USER NAME = jessica.hille	DESIGNED - T. Walk	REVISED -
	DRAWN - T. Walk	REVISED -
PLOT SCALE = 100,000' / in.	CHECKED - D. Macklin	REVISED -
PLOT DATE = 8/23/2023	DATE - September 2022	REVISED -

**STATE OF ILLINOIS  
 DEPARTMENT OF TRANSPORTATION**

**BRIDGE DECK PATCHING, SPANS 1 & 2  
 SN. 025-0089**

SCALE: SHEET 7 OF 9 SHEETS STA. TO STA.

F.A.S. RTE.	SECTION	COUNTY	TOTAL SHEETS	SHEET NO.
2701	D7 BRIDGE REPAIRS 2024-8	EFFINGHAM	23	16
CONTRACT NO. 74B34				
ILLINOIS FED. AID PROJECT				



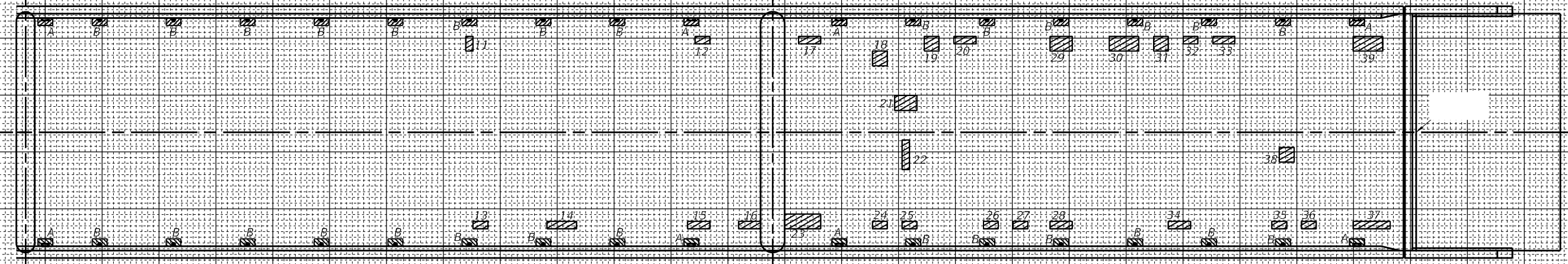
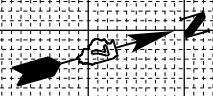

PATCH NO.	SIZE		DECK SLAB REPAIR (FD TY I)	DECK SLAB REPAIR (FD TY II)
	LENGTH	WIDTH	SQ YD	SQ YD
11	1.0	2.0	0.2	
12	2.0	1.0	0.2	
13	2.0	1.0	0.2	
14	4.0	1.0	0.4	
15	3.0	1.0	0.3	
16	3.0	1.0	0.3	
17	3.0	1.0	0.3	
18	2.0	2.0	0.4	
19	2.0	2.0	0.4	
20	3.0	1.0	0.3	
21	3.0	2.0		0.7
22	1.0	4.0	0.4	
23	5.0	2.0		1.1
24	2.0	1.0	0.2	
25	2.0	1.0	0.2	
26	2.0	1.0	0.2	

PATCH NO.	SIZE		DECK SLAB REPAIR (FD TY I)	DECK SLAB REPAIR (FD TY II)
	LENGTH	WIDTH	SQ YD	SQ YD
27	2.0	1.0	0.2	
28	3.0	1.0	0.3	
29	3.0	2.0		0.7
30	4.0	2.0		0.9
31	2.0	2.0	0.4	
32	2.0	1.0	0.2	
33	3.0	1.0	0.3	
34	3.0	1.0	0.3	
35	2.0	1.0	0.2	
36	2.0	1.0	0.2	
37	5.0	1.0	0.6	
38	2.0	2.0	0.4	
39	4.0	2.0		0.9
A - Remove Drain, 8 ea			1.8	
B - Replace Drain, 28 ea			6.2	
TOTAL ROUNDS TO:			16.0	5.0

Note: Extreme care must be used when removing concrete near the top flange of the Precast Concrete I-Beams. The contractor is responsible for any damage to the beams.

**ESTIMATED PAY QUANTITIES**

DECK SLAB REPAIR (FULL DEPTH, TYPE I) = 16.0 SQ YD  
 DECK SLAB REPAIR (FULL DEPTH, TYPE II) = 5.0 SQ YD  
 FLOOR DRAINS = 28 EACH

A & B = Deck Slab Repair (Full Depth, Type I)  
 2ft<sup>2</sup> = .22yd<sup>2</sup> Each

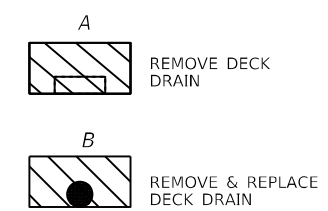

THE LOCATIONS AND SIZES SHOWN GRAPHICALLY ABOVE ARE APPROXIMATE. SEE THIS TABLE FOR ACTUAL SIZES.

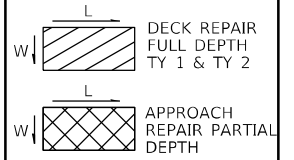

DATE OF SURVEY: 7-12-2022  
 SURVEY BY: DPM & TMW  
 METHOD OF SURVEY: VISUAL

MODEL: Default  
 FILE NAME: p:\w\p\w\benley.com\p\p\DOT Documents\DOT Offices\District 7\Projects\74834\CAD\Drawings\74834-025-0089\_Bridge\_Repair

USER NAME = jessica.hille	DESIGNED - T. Walk	REVISED -
PLOT SCALE = 100,000' / in.	DRAWN - T. Walk	REVISED -
PLOT DATE = 8/23/2023	CHECKED - D. Macklin	REVISED -
	DATE - September 2022	REVISED -

**STATE OF ILLINOIS  
 DEPARTMENT OF TRANSPORTATION**

<b>BRIDGE DECK PATCHING, SPANS 3 &amp; 4</b>			
<b>SN. 025-0089</b>			
SCALE:	SHEET 8	OF 9 SHEETS	STA. TO STA.

F.A.S. RTE.	SECTION	COUNTY	TOTAL SHEETS	SHEET NO.
2701	D7 BRIDGE REPAIRS 2024-8	EFFINGHAM	23	17
CONTRACT NO. 74B34				
ILLINOIS FED. AID PROJECT				

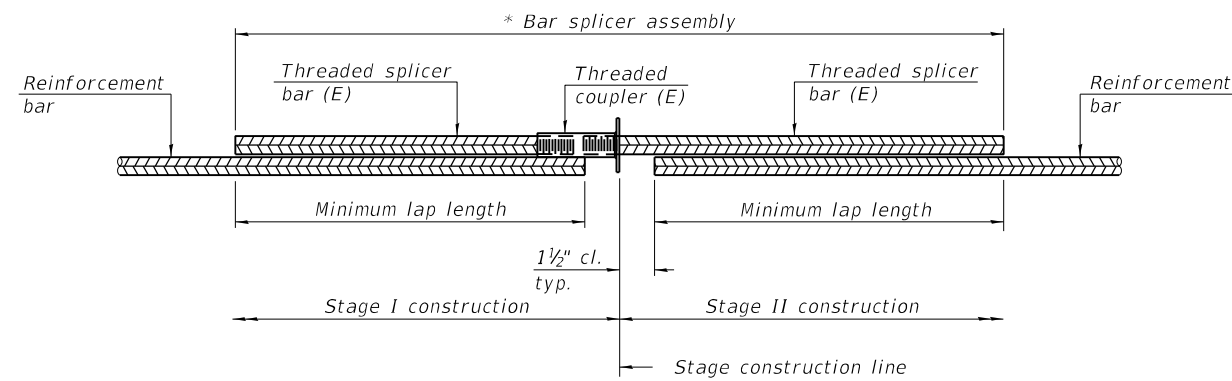

**STANDARD BAR SPLICER ASSEMBLY PLAN**  
 (All components shall be provided from one supplier)

Threaded splicer bar length = min. lap length + 1 1/2" + thread length

\* Epoxy not required on Bar Splicer Assembly components used in conjunction with black bars.

Location	Bar size	No. assemblies required	Minimum lap length
Deck	#7	4	6'-3"
Approach	#6	8	4'-0"

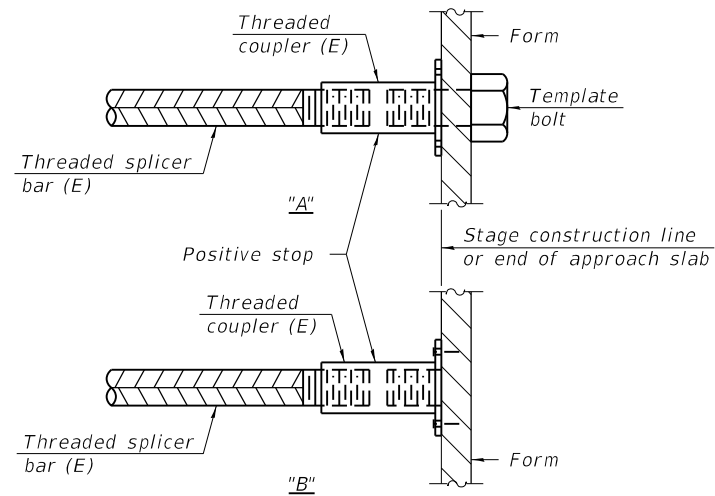

**INSTALLATION AND SETTING METHODS**

"A" : Set bar splicer assembly by means of a template bolt.

"B" : Set bar splicer assembly by nailing to wood forms or cementing to steel forms.

(E) : Indicates epoxy coating.

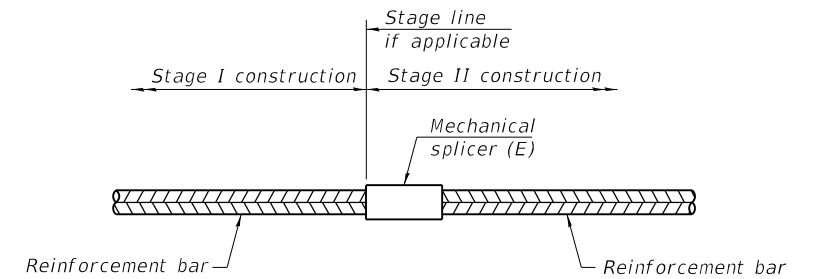

**STANDARD MECHANICAL SPLICER**

Location	Bar size	No. assemblies required

**Notes:**

Splicer bars shall be deformed with threaded ends and have a minimum 60 ksi yield strength.

All reinforcement shall be lapped and tied to the splicer bars.

Bar splicer assemblies shall be epoxy coated according to the requirements for reinforcement bars. See Section 508 of the Standard Specifications.

See approved list of bar splicer assemblies and mechanical splicers for alternatives.

MODEL: 3400BENAMES  
FILE NAME: SFLC13

BSD-1

1-1-2020

USER NAME = \$USERS	DESIGNED - T. Walk	REVISED -
	DRAWN - T. Walk	REVISED -
PLOT SCALE = \$SCALE\$	CHECKED - D. Macklin	REVISED -
PLOT DATE = \$DATES	DATE - September 2022	REVISED -

**STATE OF ILLINOIS  
 DEPARTMENT OF TRANSPORTATION**

**BAR SPLICER ASSEMBLY AND MECHANICAL SPLICER DETAILS**  
**S.N. 025-0089**

SCALE: SHEET 9 OF 9 SHEETS STA. TO STA.

F.A.S RTE.	SECTION	COUNTY	TOTAL SHEETS	SHEET NO.
2701	D7 BRIDGE REPAIRS 2024-8	EFFINGHAM	23	18
ILLINOIS			FED. AID PROJECT	

CONTRACT NO. 74B34

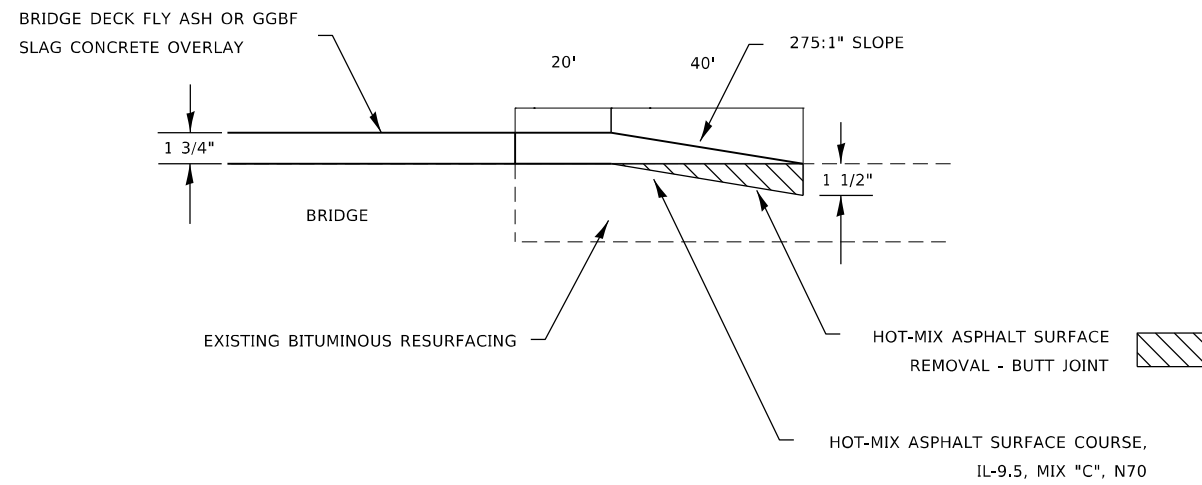

**BUTT JOINT DETAIL**

STA 1069+00 TO STA 1069+60

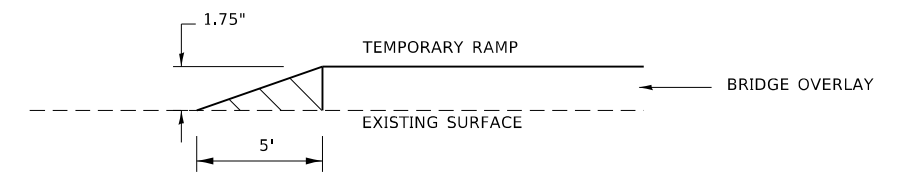

**TEMPORARY RAMP**

STA 1064+64 TO STA 1065+24  
STA 1069+00 TO STA 1069+60

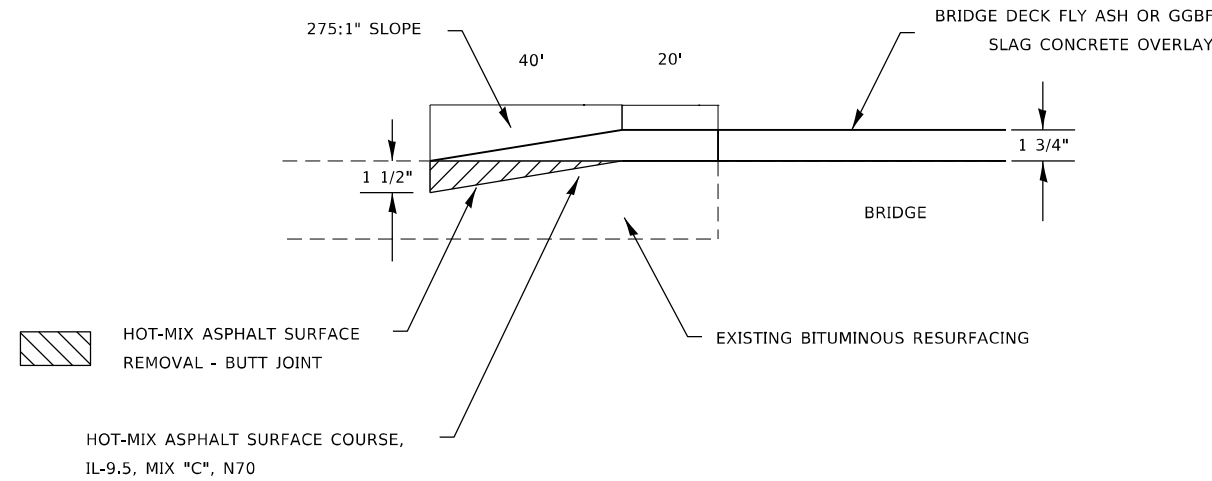

**BUTT JOINT DETAIL**

STA 1064+64 TO STA 1065+24

NOT TO SCALE

Note: All dimensions are in INCHES (millimeters) unless otherwise shown.

\* D7 BRIDGE REPAIRS 2024-8

MODEL: Default  
 FILE: \\mari... \public\aw\_bentley.com\PIV\DOT\Documents\DOT Office\Dir\dr... \Project\74B34\CADD\DATA\CAD\Sheet\D74B34-8-1.dwg

USER NAME = jessica.ville	DESIGNED -	REVISED -
	DRAWN -	REVISED -
PLOT SCALE = 100,0000' / in.	CHECKED -	REVISED -
PLOT DATE = 8/25/2023	DATE -	REVISED -

**STATE OF ILLINOIS  
DEPARTMENT OF TRANSPORTATION**

**TRANSITION DETAILS**

SCALE: SHEET 1 OF 1 SHEETS STA. TO STA.

F.A.S RTE.	SECTION	COUNTY	TOTAL SHEETS	SHEET NO.
2701	D7 BRIDGE REPAIRS 2024-8	EFFINGHAM	23	19
CONTRACT NO. 74B34				
ILLINOIS		FED. AID PROJECT		

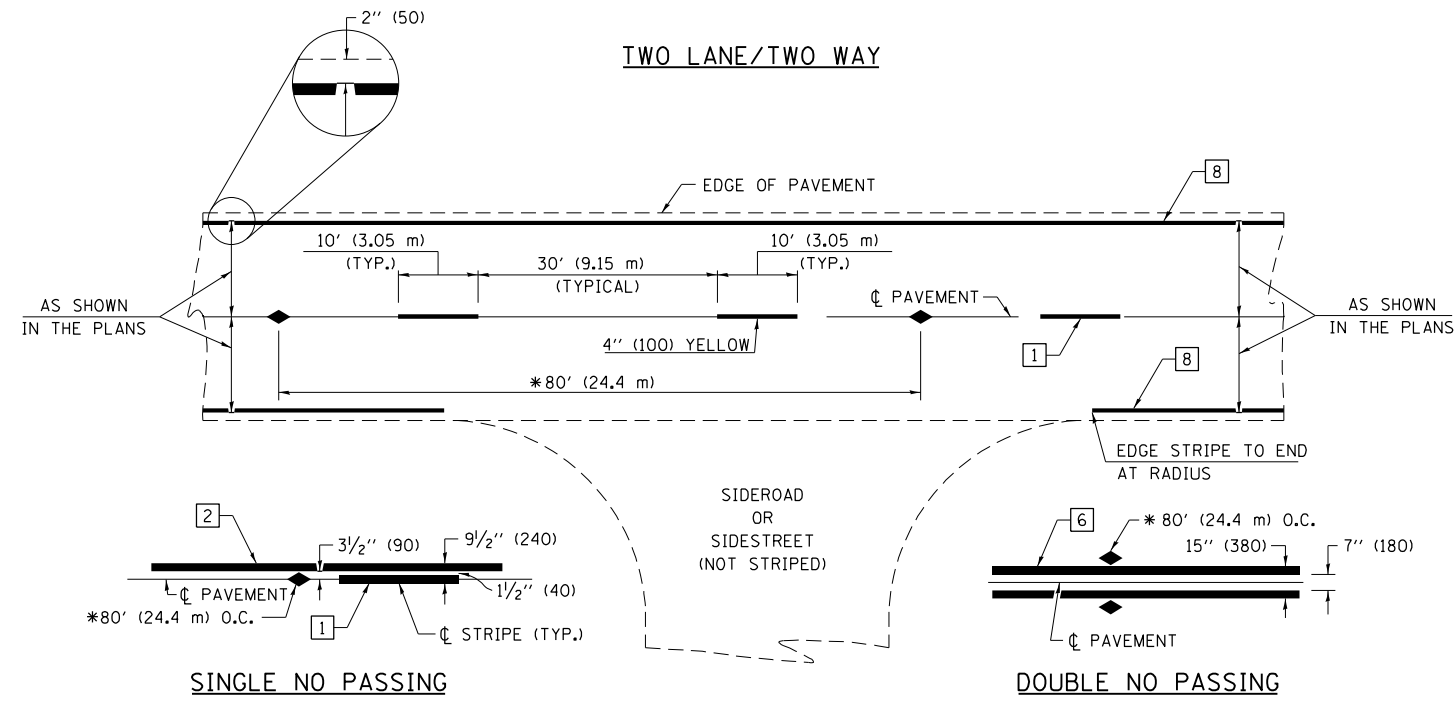

\* REDUCE TO 40' (12.2 m) O.C. ON CURVES WITH POSTED OR ADVISORY SPEEDS OF 45 mph (70 km/h) OR LESS.

PAVEMENT MARKING LEGEND

- 1 4" (100) SKIP-DASH (YELLOW)
- 2 4" (100) SOLID (YELLOW)
- 3 12" (300) DIAGONAL (YELLOW)
- 4 4" (100) DOUBLE YELLOW (NARROW)
- 5 12" (300) SOLID WHITE
- 6 4" (100) DOUBLE YELLOW (WIDE)
- 7 6" (150) SKIP-DASH (WHITE)
- 8 4" (100) SOLID (WHITE)
- 9 12" (300) DIAGONAL (WHITE)
- 10 6" (150) SOLID (WHITE)
- 11 24" (600) STOP BAR (WHITE)
- 12 8" (200) SOLID (WHITE)
- 13 4" (100) PARKING WHITE

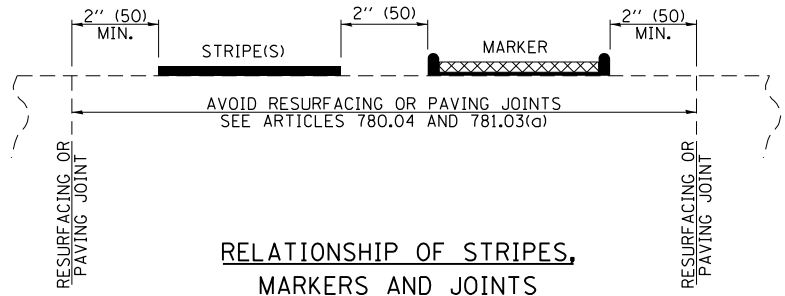

TYPICAL PAVEMENT MARKERS LEGEND

- ◆ TWO-WAY AMBER MARKER
- ▶ ONE-WAY AMBER MARKER
- ▷ ONE-WAY CRYSTAL MARKER

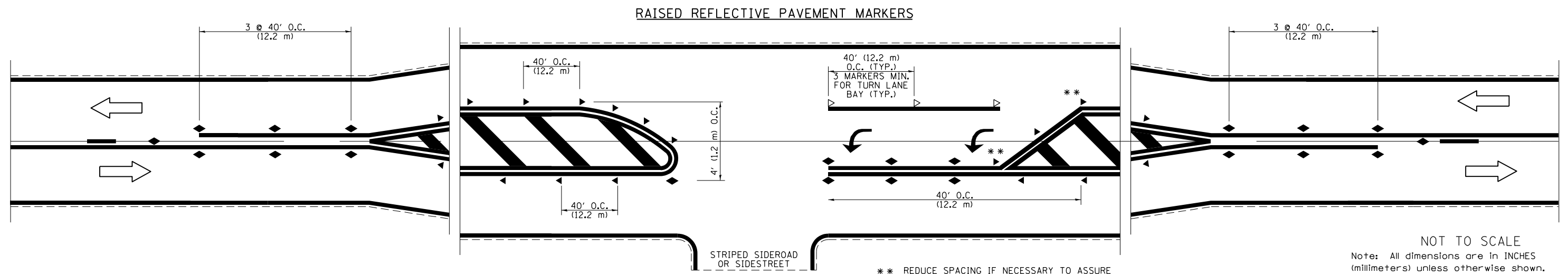

NOT TO SCALE  
Note: All dimensions are in INCHES (millimeters) unless otherwise shown.

FILE NAME =	USER NAME = jessica.hille	DESIGNED -	REVISED - NAS 06/22
pw:\1ldot-pw\bentley.com\PWIDOT\Documents\DOT Offices\District 7\Projects\74B34\CADD\Drawings\Drawings\74B34-sht-details.dgn		CHECKED -	REVISED -
		DATE -	REVISED -
PLOT SCALE = 100.0000' / in.			
PLOT DATE = 8/25/2023			

STATE OF ILLINOIS  
DEPARTMENT OF TRANSPORTATION

PAVEMENT MARKING AND RAISED REFLECTIVE PAVEMENT MARKERS  
(RURAL & URBAN APPLICATIONS)

SCALE: SHEET NO. 1 OF 4 SHEETS STA. TO STA.

DISTRICT 7 DETAIL NO. 78000001				
F.A.P. RTE.	SECTION	COUNTY	TOTAL SHEETS	SHEET NO.
2701	D7 BRIDGE REPAIRS 2024-8	EFFINGHAM	23	20
			CONTRACT NO. 74B34	
ILLINOIS FED. AID PROJECT				

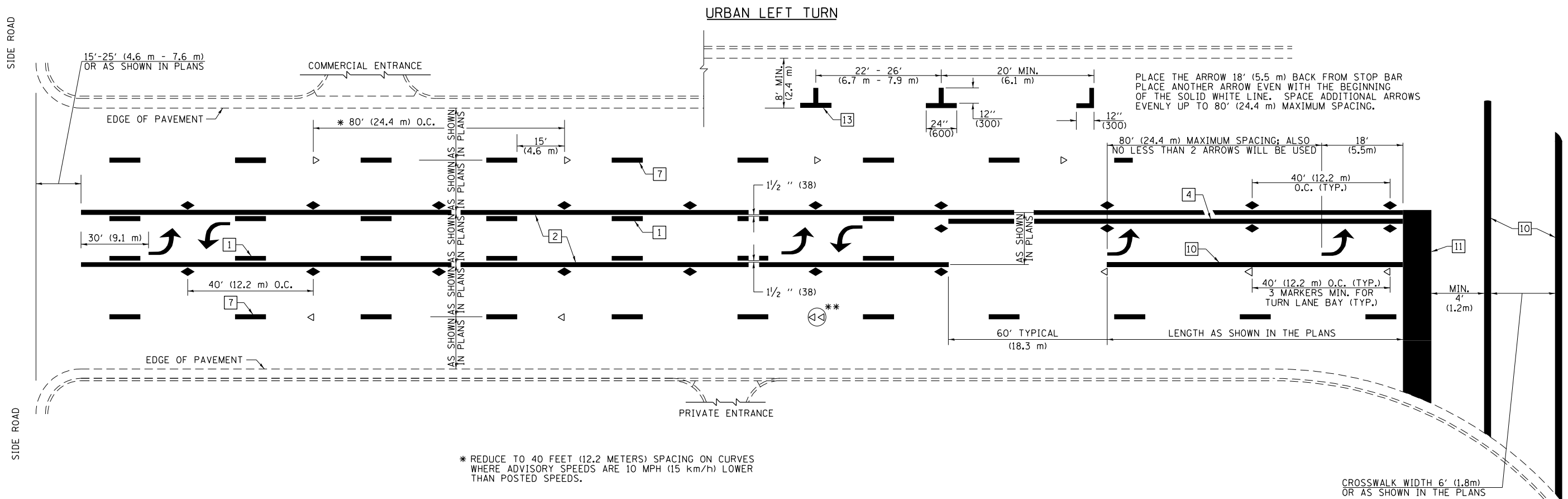

- \* REDUCE TO 40 FEET (12.2 METERS) SPACING ON CURVES WHERE ADVISORY SPEEDS ARE 10 MPH (15 km/h) LOWER THAN POSTED SPEEDS.
- \*\* DOUBLE LANE LINE MARKERS SHALL BE SPECIFIED AND SPACED AS SHOWN IN HIGHWAY STANDARD 781001 FOR MULTI-LANE DIVIDED AND UNDIVIDED HIGHWAYS.

**PAVEMENT MARKING LEGEND**

- |    |                                 |  |
|----|---------------------------------|--|
| 1  | 4" (100) SKIP-DASH (YELLOW)     |  |
| 2  | 4" (100) SOLID (YELLOW)         |  |
| 3  | 12" (300) DIAGONAL (YELLOW)     |  |
| 4  | 4" (100) DOUBLE YELLOW (NARROW) |  |
| 5  | 12" (300) SOLID WHITE           |  |
| 6  | 4" (100) DOUBLE YELLOW (WIDE)   |  |
| 7  | 6" (150) SKIP-DASH (WHITE)      |  |
| 8  | 4" (100) SOLID (WHITE)          |  |
| 9  | 12" (300) DIAGONAL (WHITE)      |  |
| 10 | 6" (150) SOLID (WHITE)          |  |
| 11 | 24" (600) STOP BAR (WHITE)      |  |
| 12 | 8" (200) SOLID (WHITE)          |  |
| 13 | 4" (100) PARKING WHITE          |  |

**GENERAL NOTES**

1. TURN ARROW PAIRS SHALL BE PLACED AT 250' (75 m) INTERVALS AND SHALL BE EVENLY SPACED BETWEEN BOTH ENDS OF THE BIDIRECTIONAL LEFT TURN LANE. USE A MINIMUM OF TWO PAIRS PER BLOCK.
2. THE SOLID YELLOW PAVEMENT MARKINGS [2] SHOULD GENERALLY START OR END NEAR THE RADIUS POINT OF EACH STREET RETURN EXCEPT WHERE ONE OR BOTH ENDS WOULD INCLUDE STOP BARS.
3. THE SKIP-DASH PAVEMENT MARKINGS [1] OR [7] SHOULD BE CENTERED BETWEEN BOTH ENDS OF EACH CITY BLOCK AND SHALL BE PLACED SO THEY LINE UP ACROSS FROM EACH OTHER.
4. USE LARGE ARROW SIZE FOR BOTH RURAL AND URBAN LOCATIONS. (SEE SECTION 780 FOR SYMBOLS TABLE)
5. LANE LINE EXTENSIONS SHALL BE THE SAME COLOR AND WIDTH AS THE LANE LINE BEING EXTENDED.
6. ALL WHITE SKIP-DASH LINES SHALL BE 6" IN WIDTH.

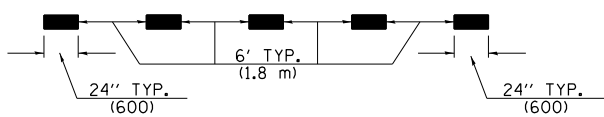

**LANE LINE EXTENSIONS**

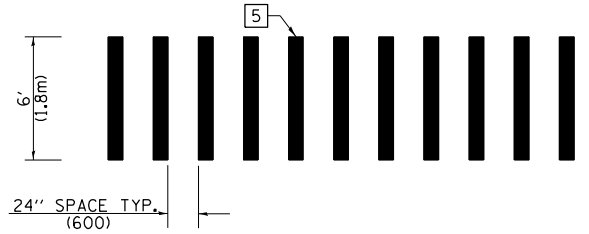

**CROSSWALK DETAIL (DECATUR CITY LIMITS ONLY)**

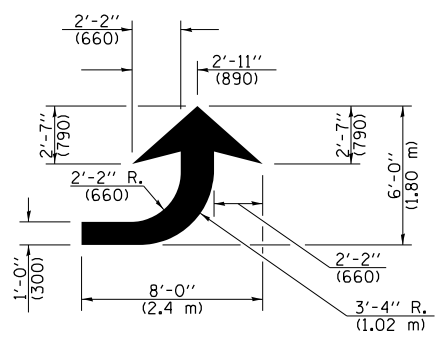

**LEFT ARROW**

REVERSE FOR RIGHT ARROW  
AREA = 15.6 SQ. FT. (1.47 m<sup>2</sup>)  
(WHITE)

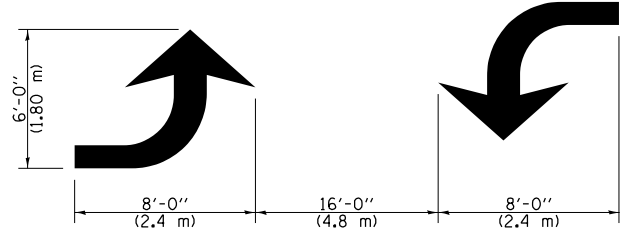

**TYPICAL DOUBLE TURN ARROWS (WHITE)**

NOT TO SCALE

Note: All dimensions are in INCHES (millimeters) unless otherwise shown.

**DISTRICT 7 DETAIL NO. 7800001**

FILE NAME =	USER NAME = jessica.hille	DESIGNED -	REVISED - NAS 06/22	<b>STATE OF ILLINOIS DEPARTMENT OF TRANSPORTATION</b>	<b>PAVEMENT MARKING AND RAISED REFLECTIVE PAVEMENT MARKERS (RURAL &amp; URBAN APPLICATIONS)</b>			F.A.P. RTE.	SECTION	COUNTY	TOTAL SHEETS	SHEET NO.
pw:\idot-pw\bentley.com\PWIDOT\Documents\IDOT Offices\District 7\Projects\74B34\CADD\Drawings\Drawings\74B34-sht-details.dgn	PLOT SCALE = 100.0000' / 1" =	CHECKED -	REVISED -					2701	D7 BRIDGE REPAIRS 2024-8	EFFINGHAM	23	21
PLOT DATE = 8/25/2023	DATE -	REVISED -	REVISED -		CONTRACT NO. 74B34							
					ILLINOIS FED. AID PROJECT							

**ISLANDS**

**OPTION 1**

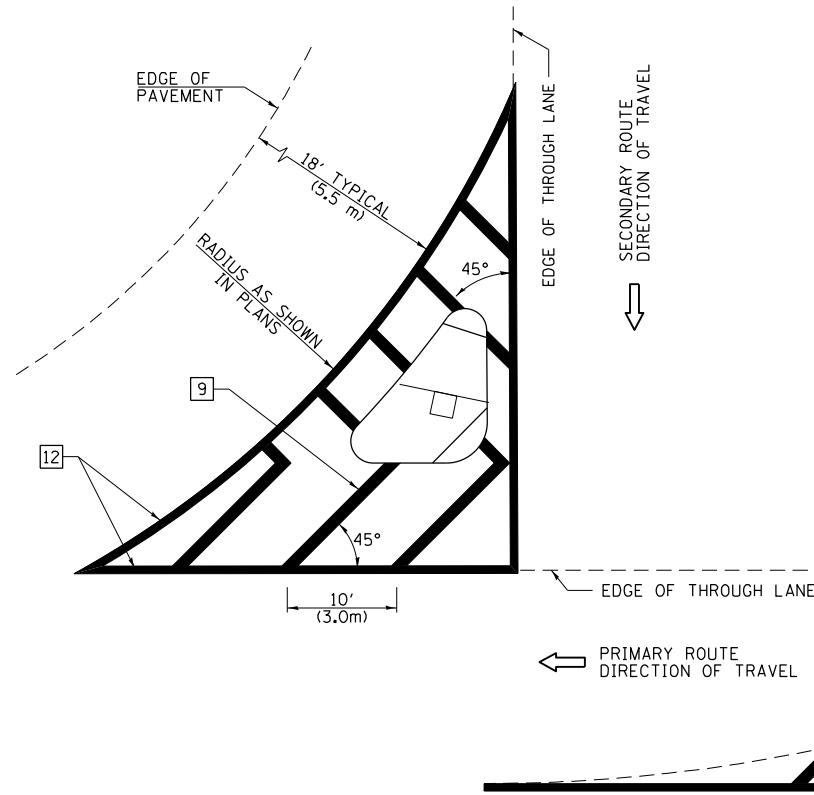

**GENERAL NOTES**

1. RAISED AND CORRUGATED MEDIANS SHALL BE OUTLINED WITH [2].
2. SOME OF THE INFORMATION INCLUDED WITH THIS DETAIL MAY NOT BE APPLICABLE TO THIS IMPROVEMENT.
3. PAVEMENT MARKINGS ARE TO BE EXTENDED THROUGH OMISSIONS WHEN APPLICABLE.
4. FINAL PAVEMENT MARKINGS SHALL BE IN PLACE PRIOR TO PLACING ANY RAISED REFLECTIVE PAVEMENT MARKERS.
5. THE FOLLOWING CRITERIA SHALL BE USED FOR SELECTING THE DIAGONAL PAVEMENT MARKING SPACING:
 

< 30 MPH (< 50 km/h)	15' (4.5 m)
30-45 MPH (50-75 km/h)	20' (6.0 m)
> 45 MPH (> 75 km/h)	30' (9.0 m)
6. THE USE OF ISLAND STRIPING OPTION 1 OR OPTION 2 SHALL BE AS SHOWN ON THE PLANS.

**PAVEMENT MARKING LEGEND**

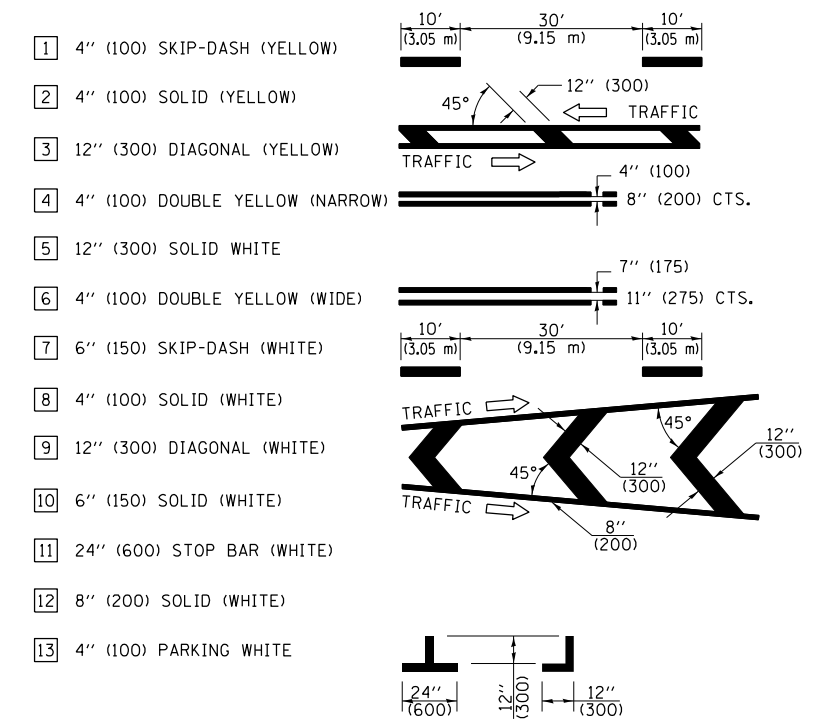

**OPTION 2**

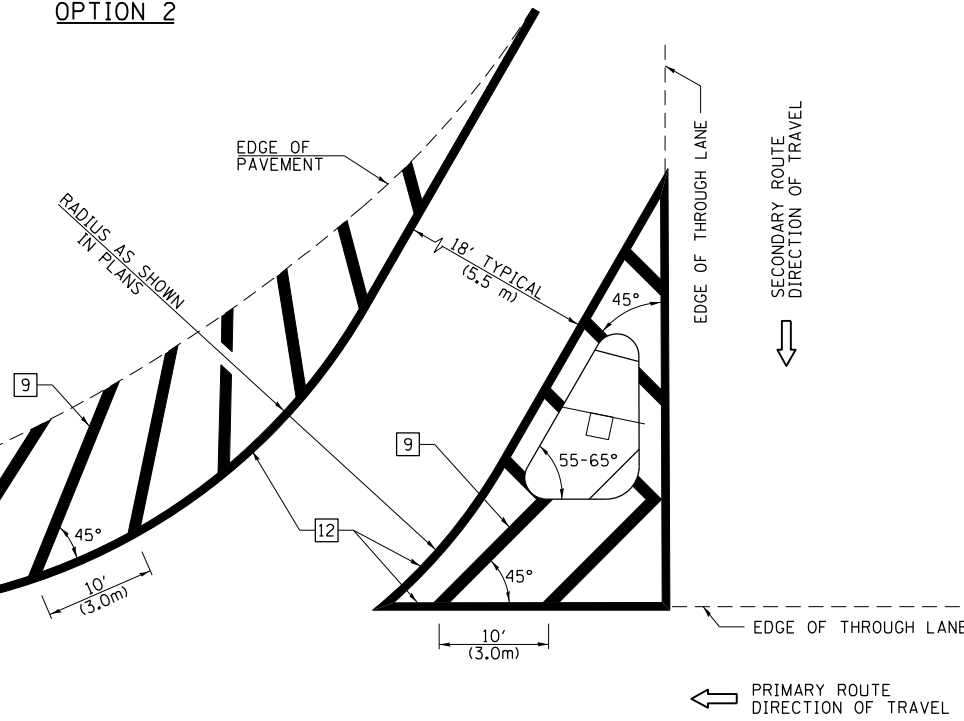

**RURAL LEFT TURN STRIPING**

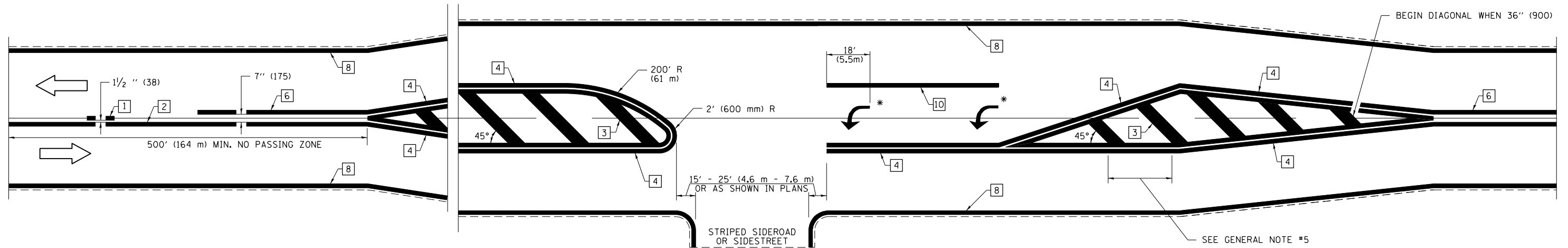

\* PLACE AN ARROW 18' (5.5 m) BACK FROM END OF THE SOLID WHITE LINE. PLACE ANOTHER ARROW EVEN WITH THE BEGINNING OF THE SOLID WHITE LINE. SPACE ADDITIONAL ARROWS EVENLY UP TO 80' (24.4 m) MAXIMUM SPACING. USE MINIMUM OF 2 ARROWS.

NOT TO SCALE

Note: All dimensions are in INCHES (millimeters) unless otherwise shown.

**DISTRICT 7 DETAIL NO. 7800001**

FILE NAME =	USER NAME = jessica.hille	DESIGNED -	REVISED - NAS 06/22
p:\dot-pw-bentley.com\PWIDOT\Documents\DOT Offices\District 7\Projects\74B34\CADD\Drawings\Drawings\74B34-sht-details.dgn		CHECKED -	REVISED -
PLOT SCALE = 100.0000' / 1"		DATE -	REVISED -
PLOT DATE = 8/25/2023			

**STATE OF ILLINOIS  
DEPARTMENT OF TRANSPORTATION**

**PAVEMENT MARKING AND RAISED REFLECTIVE PAVEMENT MARKERS  
(RURAL & URBAN APPLICATIONS)**

SCALE: SHEET NO. 1 OF 4 SHEETS STA. TO STA.

F.A.P. RTE.	SECTION	COUNTY	TOTAL SHEETS	SHEET NO.
2701	D7 BRIDGE REPAIRS 2024-8	EFFINGHAM	23	22
CONTRACT NO. 74B34				
ILLINOIS FED. AID PROJECT				

# SUPPLEMENTAL PAVEMENT MARKING TREATMENT FOR RAILROAD-HIGHWAY GRADE CROSSING

## PAVEMENT MARKING LEGEND

- 1 4" (100) SKIP-DASH (YELLOW)
  - 2 4" (100) SOLID (YELLOW)
  - 3 12" (300) DIAGONAL (YELLOW)
  - 4 4" (100) DOUBLE YELLOW (NARROW)
  - 5 12" (300) SOLID WHITE
  - 6 4" (100) DOUBLE YELLOW (WIDE)
  - 7 6" (150) SKIP-DASH (WHITE)
  - 8 4" (100) SOLID (WHITE)
  - 9 12" (300) DIAGONAL (WHITE)
  - 10 6" (150) SOLID (WHITE)
  - 11 24" (600) STOP BAR (WHITE)
  - 12 8" (200) SOLID (WHITE)
  - 13 4" (100) PARKING WHITE
- 

### PAVEMENT MARKINGS AT RAILROAD-HIGHWAY GRADE CROSSING

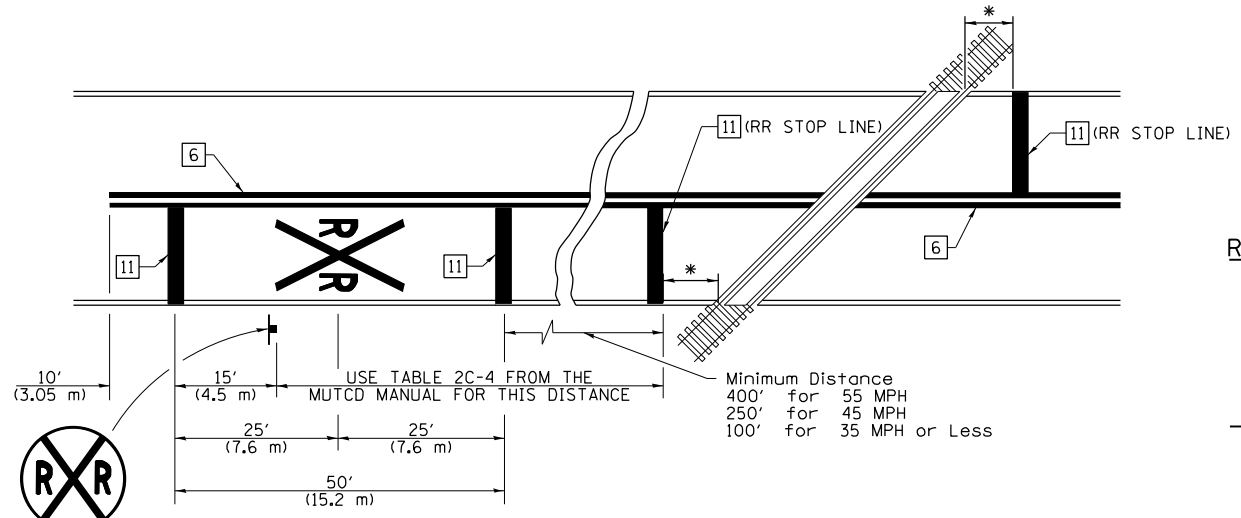

### NOTES

THE TRAVERSE SPREAD OF THE "X" MAY VARY ACCORDING TO LANE WIDTH.

ON MULTI-LANE ROADS, THE STOP LINES SHALL EXTEND ACROSS ALL APPROACH LANES AND SEPARATE RRR SYMBOLS SHALL BE PLACED ADJACENT TO EACH OTHER IN EACH LANE.

WHEN THE PAVEMENT MARKING SYMBOL IS USED, A PORTION OF THE SYMBOL SHOULD BE LOCATED DIRECTLY ADJACENT TO THE ADVANCE WARNING SIGN (W10-1) AS PLACED BY TABLE II-1, CONDITION B OF THE MUTCD.

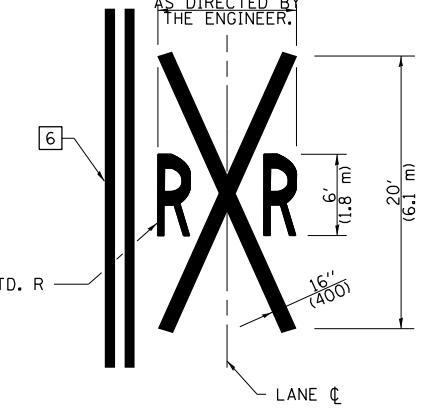

### RAILROAD CROSSING WITH NON-SIGNALIZED INTERSECTION

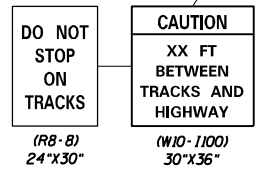
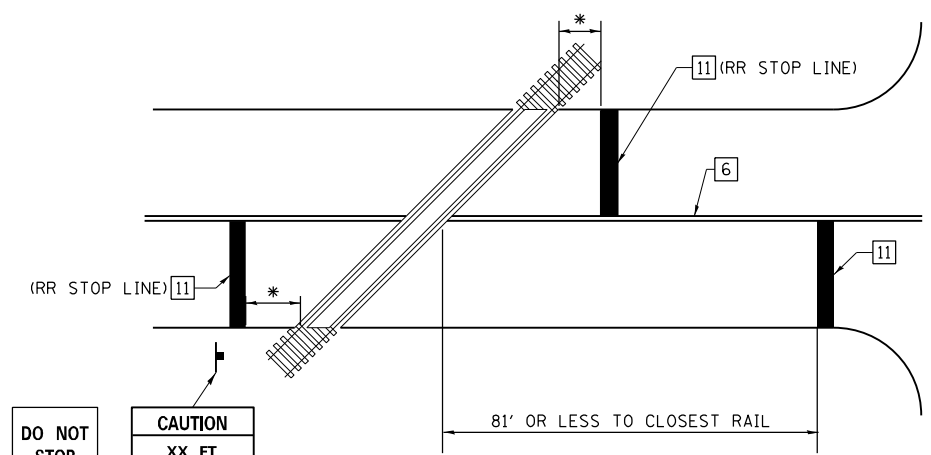

### RAILROAD CROSSING WITH INTERCONNECT AND PRE-SIGNALS

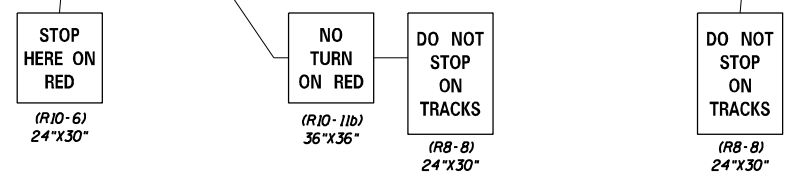
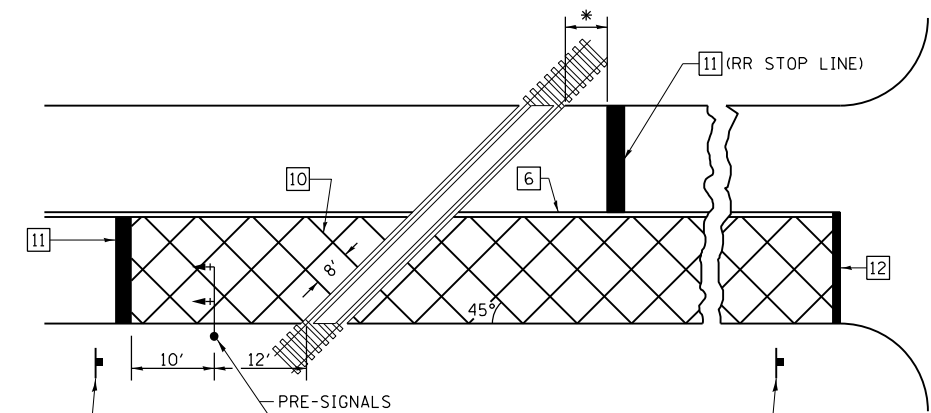

### RAILROAD CROSSING WITH INTERCONNECT ONLY

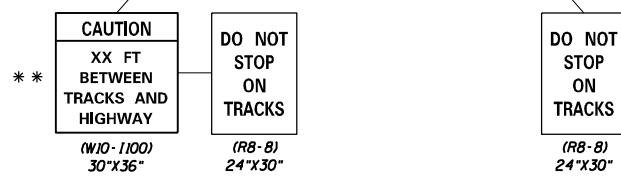
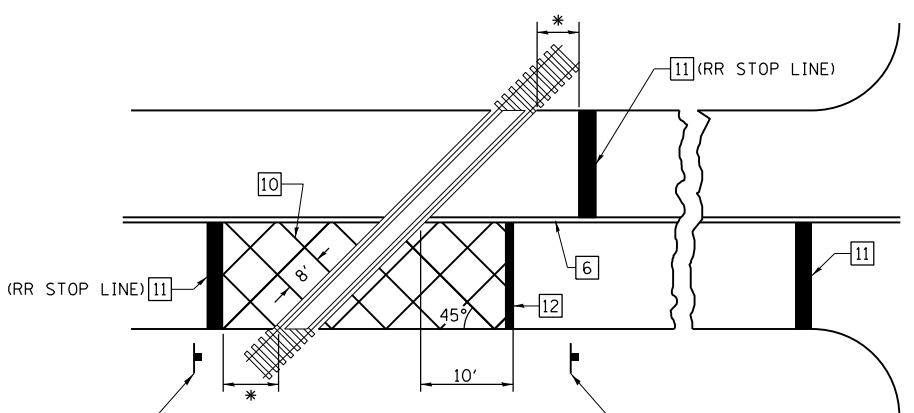

- ### GENERAL NOTES
- SUPPLEMENTAL PAVEMENT MARKINGS TO BE INSTALLED ONLY ON APPROACHES TO INTERSECTIONS CONTROLLED BY TRAFFIC SIGNALS WHICH ARE INTERCONNECTED WITH THE RAILROAD WARNING SIGNALS.
  - EXTEND PAVEMENT MARKINGS TO THE INTERSECTION ONLY WHERE PRE-SIGNALS ARE USED.
  - WHEN PEDESTRIAN SIGNALS ARE PRESENT WITH INTERCONNECTED SIGNALS, WARNING SIGN W10-1101 (18"X24") SHALL BE PLACED NEAR EACH PEDESTRIAN SIGNAL HEAD. COUNTDOWN PEDESTRIAN SIGNAL HEADS SHALL NOT BE UTILIZED ALONG WITH INTERCONNECTED SIGNALS.
  - PLEASE REFER TO THE IDOT BUREAU OF OPERATION MEMO OPS T-06 DATED DECEMBER 1, 2020 FOR ADDITIONAL INFORMATION.

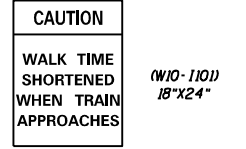

\* 15' FROM NEAR RAIL OR 8' FROM AND PARALLEL TO GATE IF PRESENT

\*\* WARNING SIGN W10-1100 SHALL BE USED AS AN INTERIM MEASURE AT INTERCONNECTED SIGNAL LOCATIONS WHERE PRE-SIGNALS ARE TO BE INSTALLED IN THE FUTURE. THIS SIGN SHALL BE REMOVED WHEN THE PRE-SIGNALS ARE INSTALLED AND THE PAVEMENT MARKINGS ARE EXTENDED TO THE INTERSECTION.

NOT TO SCALE  
Note: All dimensions are in INCHES (millimeters) unless otherwise shown.

### DISTRICT 7 DETAIL NO. 7800001

FILE NAME =	USER NAME = jessica.hille	DESIGNED -	REVISED - NAS 06/22
pw:\idot-pw\bentley.com\PIDOT\Documents\IDOT Offices\District 7\Projects\74B34\CADD\Drawings\Drawings\74B34-sht-details.dgn		CHECKED -	REVISED -
PLOT SCALE = 100.0000' / in.		DATE -	REVISED -
PLOT DATE = 8/25/2023			

STATE OF ILLINOIS  
DEPARTMENT OF TRANSPORTATION

PAVEMENT MARKING AND RAISED REFLECTIVE PAVEMENT MARKERS  
(RURAL & URBAN APPLICATIONS)

SCALE: SHEET NO. 1 OF 4 SHEETS STA. TO STA.

F.A.P. RTE.	SECTION	COUNTY	TOTAL SHEETS	SHEET NO.
2701	D7 BRIDGE REPAIRS 2024-8	EFFINGHAM	23	23
CONTRACT NO. 74B34				
ILLINOIS FED. AID PROJECT				