

PROFILE	SURVELED	DATE
NOTE BOOK	GRADES CHECKED	
NO.	BY	
	DATE	

F.A.I. RTE.	SECTION	COUNTY	TOTAL SHEETS	SHEET NO.
94	2005-037 L	COOK	45	40
STA. 2021+00.00		TO STA. 2365+00.00		
FED. ROAD DIST. NO.		ILLINOIS FED. AID PROJECT		

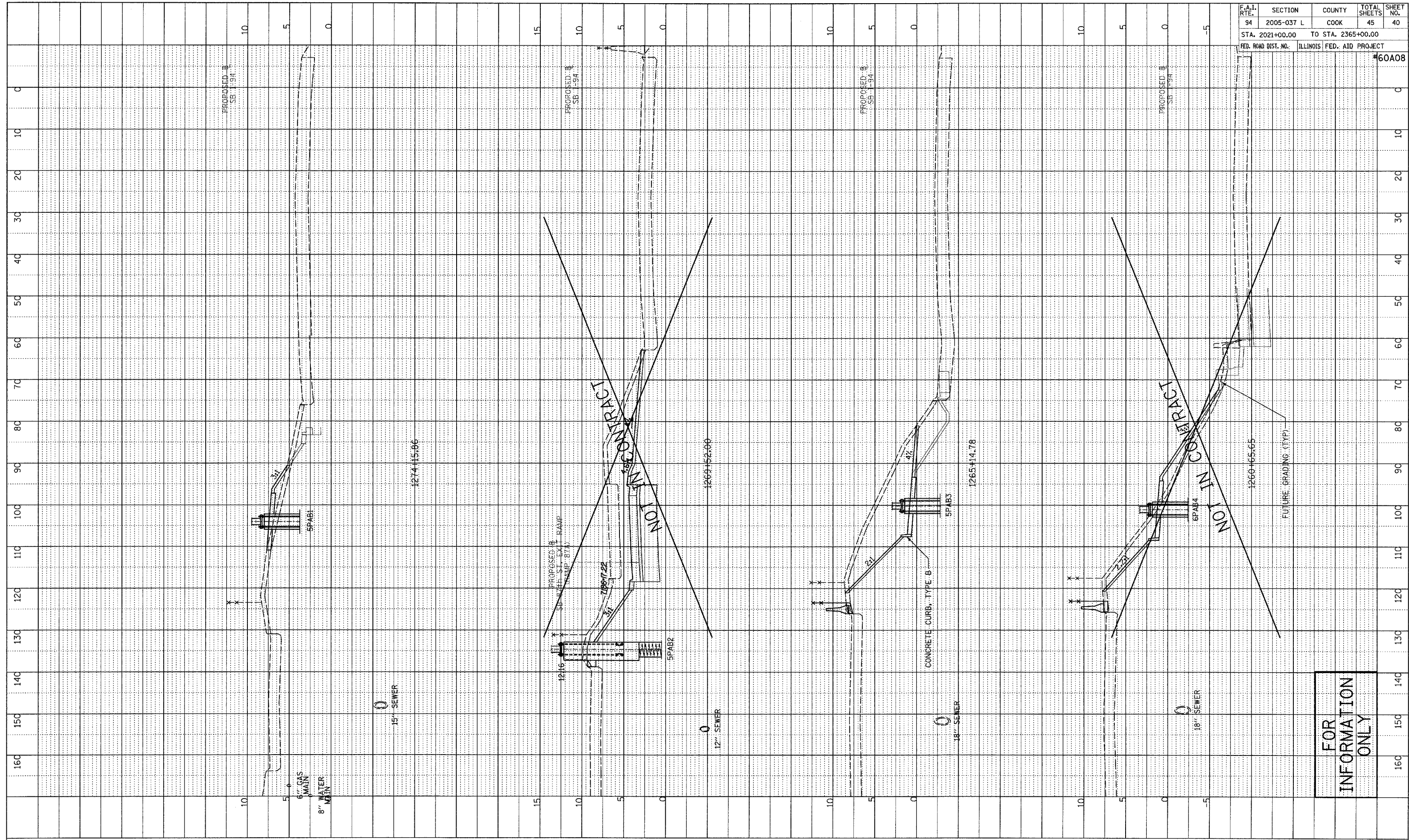

FOR  
INFORMATION  
ONLY

TYLIN INTERNATIONAL

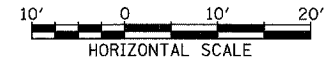

SB I-94 (DAN RYAN EXPRESSWAY)  
STA. 1260+65.65 TO STA. 1274+15.86

D:\02313\000\400\SP4400\SS18B1.dgn