

F. A. L. NO.	SECTION	COUNTY	TOTAL SHEETS	SHEET NO.
80/94		COOK	231	189
STA.	TO STA.			
FED. ROAD DIST. NO. 7	ILLINOIS	FED. AID PROJECT		
•(0203.1 & 0304) R-6			CONTRACT # 62105	

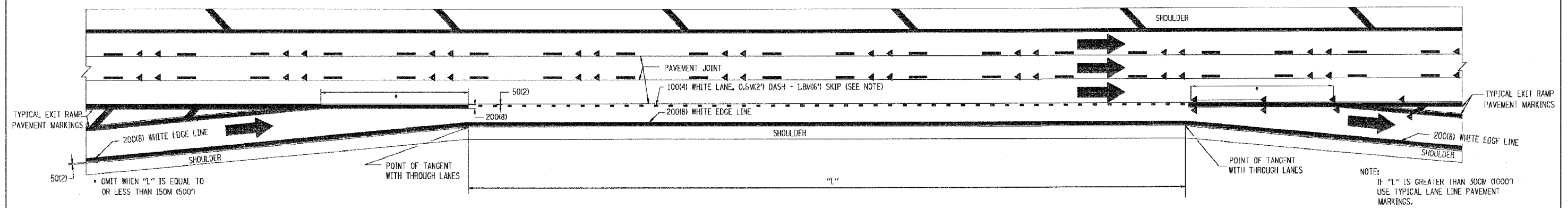

TYPICAL ENTRANCE/EXIT RAMP COMBINATION PAVEMENT MARKINGS

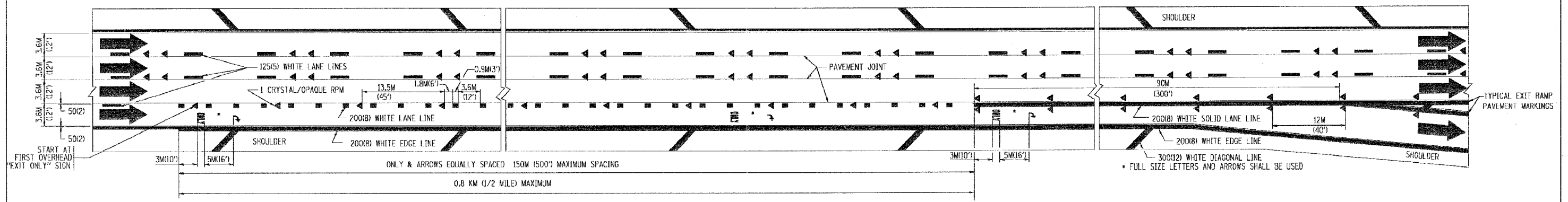

TYPICAL EXIT ONLY LANE PAVEMENT MARKINGS

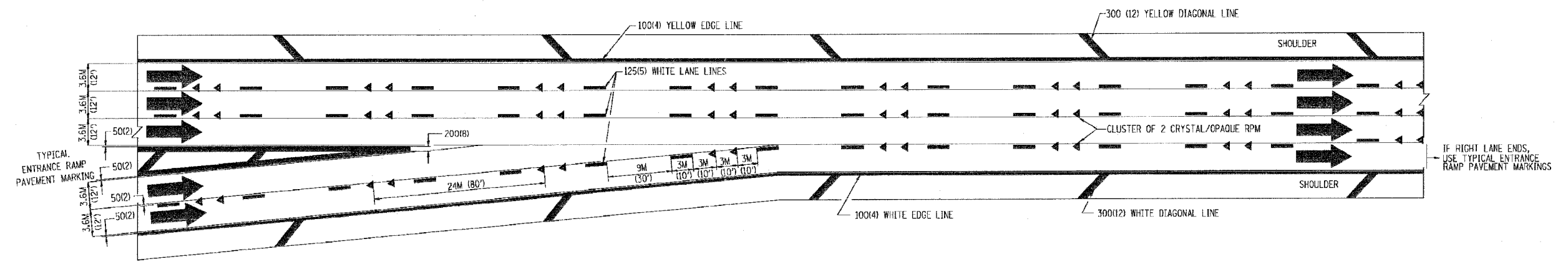

TYPICAL TWO LANE ENTRANCE RAMP PAVEMENT MARKINGS

•DATE-TIME•
•DCN-SPEC•
VI-TC12

REVISIONS	
NAME	DATE
DWS	1/90
DWS	5/91

ILLINOIS DEPARTMENT OF TRANSPORTATION

**MULTI-LANE FREEWAY
PAVEMENT MARKING
DETAILS**

SCALE: NONE
DATE: **DATE**

DRAWN BY C.A.D.D.
CHECKED BY

SHEET 2 OF 2
TC-12

9/18/2005 1:34:42 PM
 C:\inetpub\wwwroot\...