

F.A.I. RTE.	SECTION	COUNTY	TOTAL SHEETS	SHEET NO.
80/94 (0203.1 & 0304R-6)		COOK	231	195
STA.	TO STA.			
FED. ROAD DIST. NO. 1	ILLINOIS FED. AID PROJECT			

CONTRACT # 62105

45 40 35 30 25 20 15 10 5 0 5 10 15 20 25 30 35 40

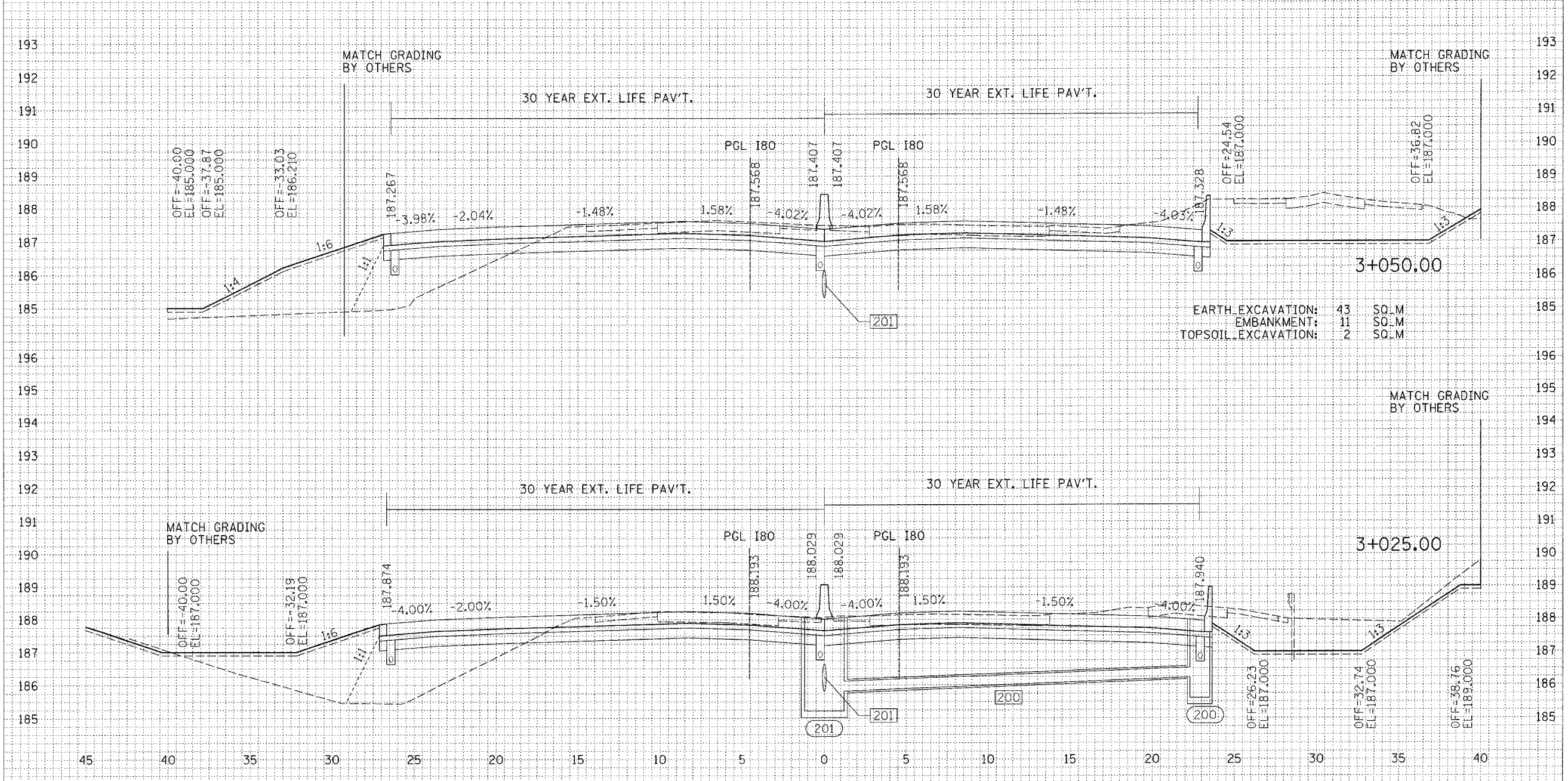

EARTH EXCAVATION: 43 SQ.M
 EMBANKMENT: 11 SQ.M
 TOPSOIL EXCAVATION: 2 SQ.M

EARTH EXCAVATION: 38 SQ.M
 EMBANKMENT: 22 SQ.M
 TOPSOIL EXCAVATION: 3 SQ.M

REVISIONS	
NAME	DATE

ILLINOIS DEPARTMENT OF TRANSPORTATION
 F.A.I. ROUTE 80/94 (INTERSTATE 80/294)

CROSS SECTIONS
 I-80

HORIZ. SCALE: 1:250
 VERT. SCALE: 1:125
 DATE: JULY 18, 2005

DRAWN BY: CTT
 CHECKED BY: RCH

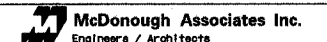

FINAL SURVEY	BY	DATE

ORIGINAL SURVEY	BY	DATE