

F.A.I. RTE.	SECTION	COUNTY	TOTAL SHEETS	SHEET NO.
80/94 (0203J) & 0304R-6		COOK	231	202
STA.	TO STA.			
FED. ROAD DIST. NO. 1	ILLINOIS FED. AID PROJECT			

CONTRACT # 62105

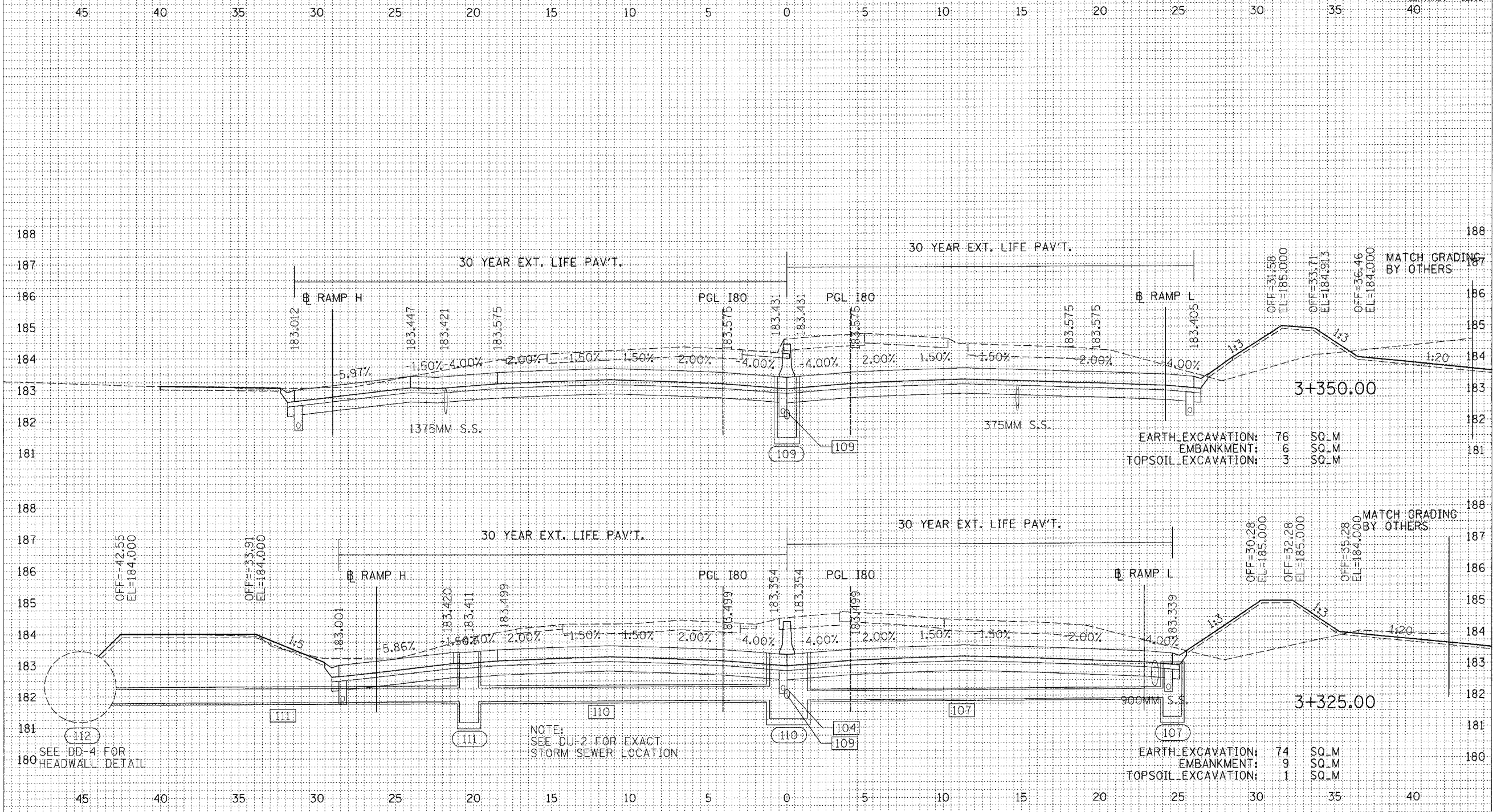

EARTH EXCAVATION: 76 SQ.M
 EMBANKMENT: 6 SQ.M
 TOPSOIL EXCAVATION: 3 SQ.M

EARTH EXCAVATION: 74 SQ.M
 EMBANKMENT: 9 SQ.M
 TOPSOIL EXCAVATION: 1 SQ.M

REVISIONS	
NAME	DATE

ILLINOIS DEPARTMENT OF TRANSPORTATION
 F.A.I. ROUTE 80/94 (INTERSTATE 80/294)

CROSS SECTIONS
 I-80

HORIZ. SCALE: 1:250
 VERT. SCALE: 1:125
 DATE: JULY 18, 2005

DRAWN BY: CTT
 CHECKED BY: RCH

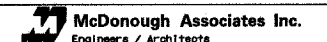

FINAL SURVEY	BY	DATE
PLOTTED		
NOTE BOOK		
AREAS CHECKED		
NO.		

ORIGINAL SURVEY	BY	DATE
PLOTTED		
NOTE BOOK		
AREAS CHECKED		
NO.		

SEE DD-4 FOR HEADWALL DETAIL

NOTE:
 SEE DU-2 FOR EXACT
 STORM SEWER LOCATION