

F.A.I. RTE.	SECTION	COUNTY	TOTAL SHEETS	SHEET NO.
80/94		COOK	631	70
STA.	TO STA.		FED. AID PROJECT	
(2425 & 2626) R-2			CONTRACT NO. 62111	

PRELIMINARY SURVEY	BY	DATE
SURVEY PLOTTED		
NOTE BOOK TEMPLATE		
NO. AREAS CHECKED		

ORIGINAL SURVEY	BY	DATE
SURVEY PLOTTED		
NOTE BOOK TEMPLATE		
NO. AREAS CHECKED		

\FERT02P2ALDCL\A89902ALDCL\VERT02P2ALDCL
 P:\8-2005\000848\T\DOCUMENT\897050\DMA\DCAN\PF7642A.DGN
 2,3,4,5,6,7,8,9,10,11,12,13,14,15,16,17,18,19,20,21,22,23,24,25,26,27,28,29,30,31,32,33,34,35,36,37,38,39,40,41,42,43,44,45,46,47,48,49,50,51,52,53,54,55,56,57,58,59,60,61,62,63
 HAJZEKJ

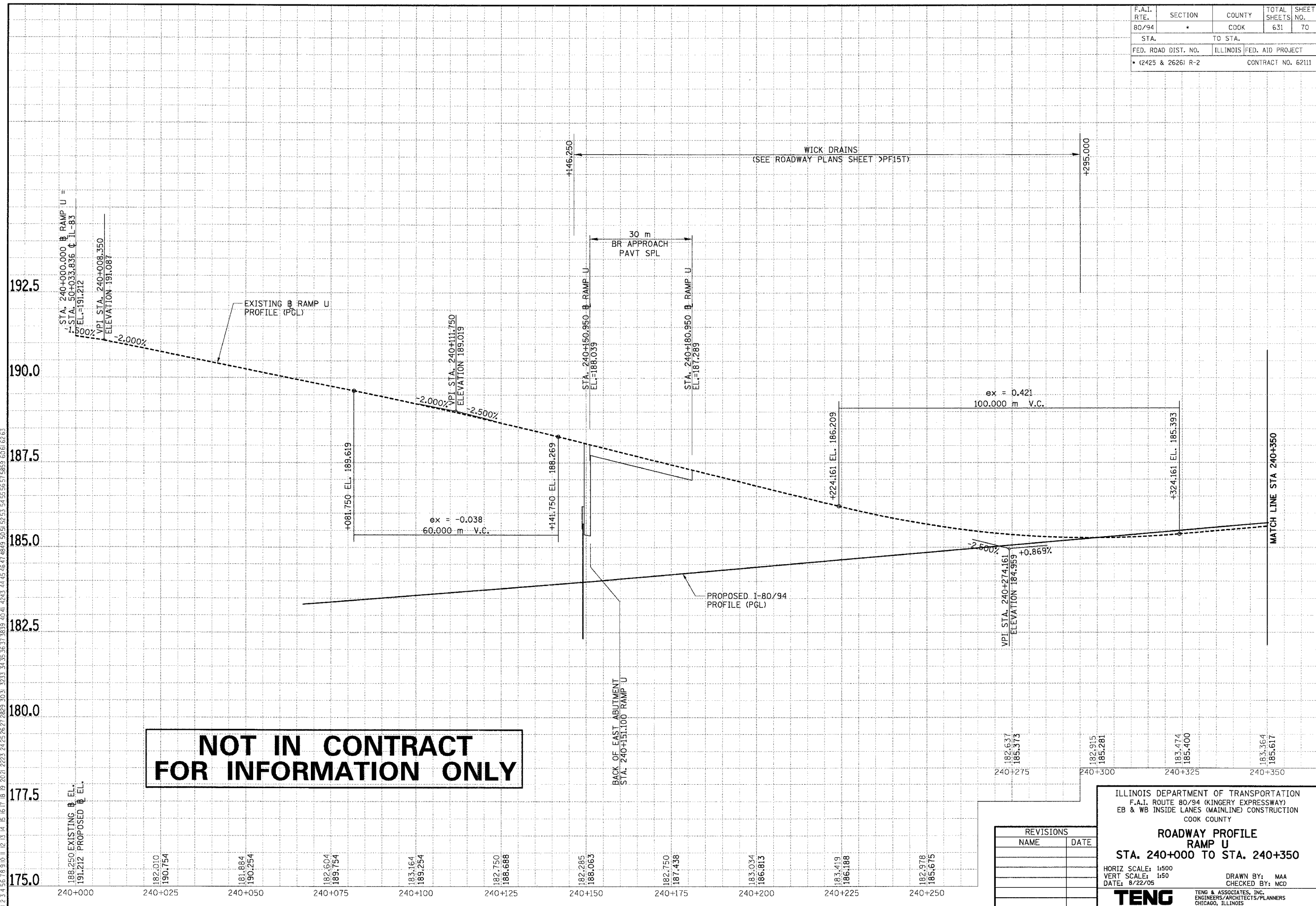

NOT IN CONTRACT
 FOR INFORMATION ONLY

REVISIONS	
NAME	DATE

ILLINOIS DEPARTMENT OF TRANSPORTATION
 F.A.I. ROUTE 80/94 (KINGERY EXPRESSWAY)
 EB & WB INSIDE LANES (MAINLINE) CONSTRUCTION
 COOK COUNTY

ROADWAY PROFILE
 RAMP U
 STA. 240+000 TO STA. 240+350

HORIZ SCALE: 1:500
 VERT SCALE: 1:50
 DATE: 8/22/05

DRAWN BY: MAA
 CHECKED BY: MCD

TENG

TENG & ASSOCIATES, INC.
 ENGINEERS/ARCHITECTS/PLANNERS
 CHICAGO, ILLINOIS