

F.A.I. 80/94 (KINGERY EXPRESSWAY) BORING LOCATION ILLINOIS DEPARTMENT OF TRANSPORTATION, COOK COUNTY		F.A.I. RTE.	SECTION	COUNTY	TOTAL SHEETS	SHEET NO.
DRAWN BY: M.S. [REDACTED] CHECKED BY: M.S. [REDACTED]		80/94	*	COOK	631	110
Wong Engineering, Inc. 1146 North Street Lombard, IL 60248 Geo-Environmental Engineers 630-953-9928		STA.	TO STA.		FED. ROAD DIST. NO.	
BASED ON DRAWINGS PREPARED BY TENG & ASSOCIATES 255-08-04		(2425 & 2626) R-2		ILLINOIS FED. AID PROJECT		CONTRACT NO. 62111

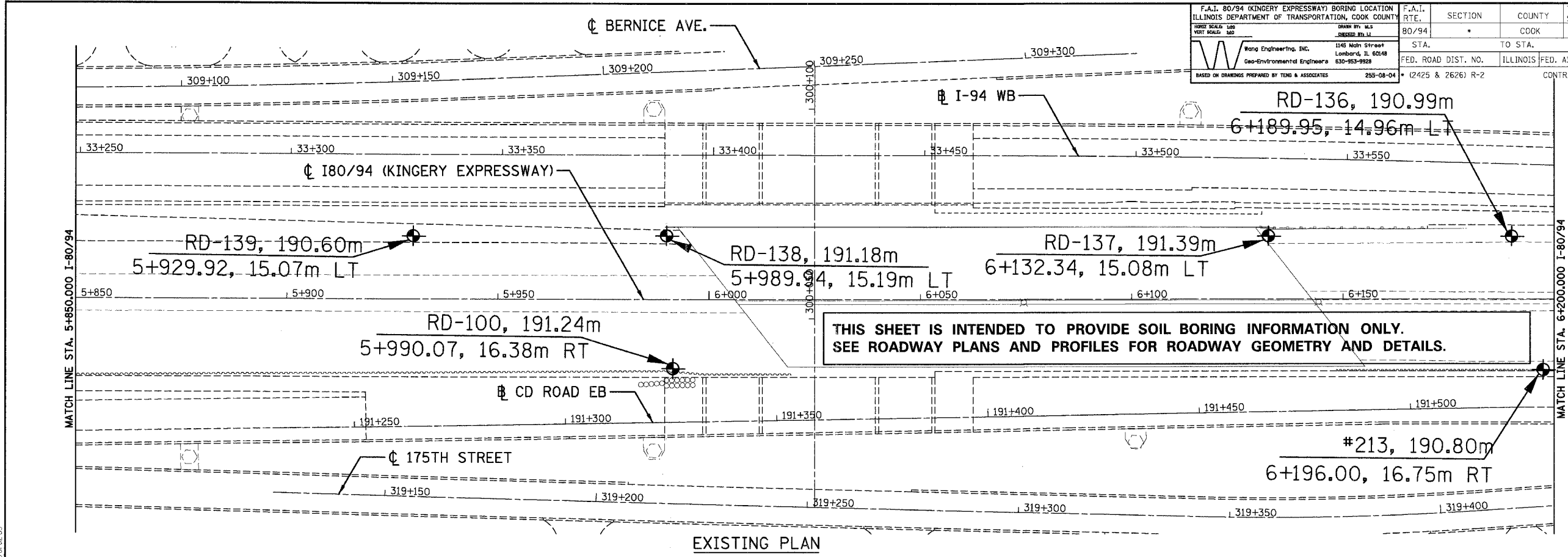

THIS SHEET IS INTENDED TO PROVIDE SOIL BORING INFORMATION ONLY.
SEE ROADWAY PLANS AND PROFILES FOR ROADWAY GEOMETRY AND DETAILS.

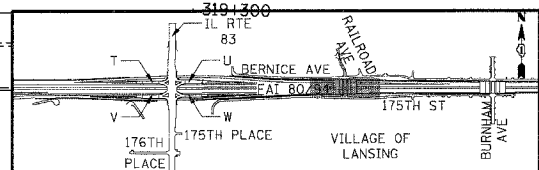
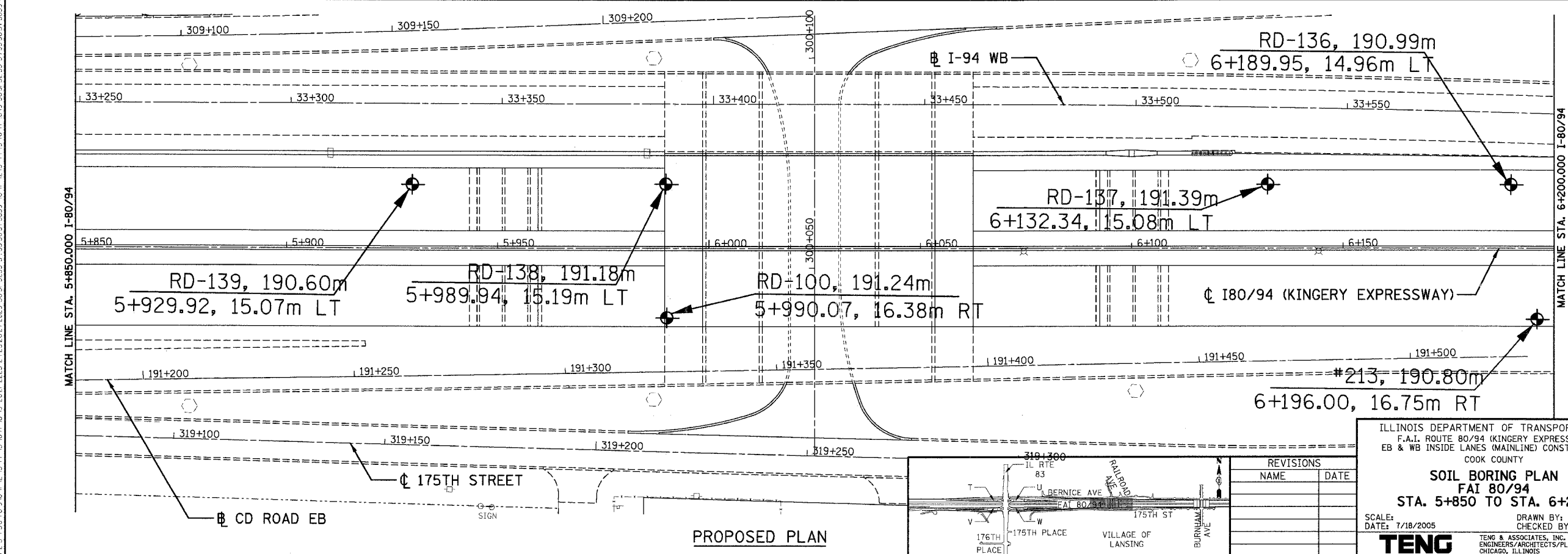

REVISIONS	
NAME	DATE

ILLINOIS DEPARTMENT OF TRANSPORTATION
F.A.I. ROUTE 80/94 (KINGERY EXPRESSWAY)
EB & WB INSIDE LANES (MAINLINE) CONSTRUCTION
COOK COUNTY

SOIL BORING PLAN
FAI 80/94
STA. 5+850 TO STA. 6+200

SCALE: DATE: 7/18/2005
DRAWN BY: CHECKED BY:

TENG
TENG & ASSOCIATES, INC.
ENGINEERS/ARCHITECTS/PLANNERS
CHICAGO, ILLINOIS

\\RE-5850-62000.DGN, \\VIB99002AJEN
 7-18-2005, 10:45:15
 T:\DOCUMENT\183150\CHIL\JGON\B070052\CDGN
 1, 2, 3, 4, 5, 6, 7, 8, 9, 10, 11, 12, 13, 14, 15, 16, 17, 18, 19, 20, 21, 22, 23, 24, 25, 26, 27, 28, 29, 30, 31, 32, 33, 34, 35, 36, 37, 38, 39, 40, 41, 42, 43, 44, 45, 46, 47, 48, 49, 50, 51, 52, 53, 54, 55, 56, 57, 58, 59, 60, 61, 62, 63