

F.A.I. RTE. 80/94	SECTION *	COUNTY COOK	TOTAL SHEETS 631	SHEET NO. 213
STA.		TO STA.		
FED. ROAD DIST. NO.		ILLINOIS FED. AID PROJECT		
• (2425 & 2626) R-2		CONTRACT NO. 62111		

PRELIMINARY SURVEYED	BY	DATE
SURVEY PLOTTED		
NOTE BOOK		
AREAS CHECKED		
NO.		

ORIGINAL SURVEYED	BY	DATE
SURVEY PLOTTED		
NOTE BOOK		
AREAS CHECKED		
NO.		

\FERIT002A.DGN, \DRIT0052A.DGN, \VERT002A.DGN, \FERIT002A.DGN, \A889000A.DGN, \BALZENKJ
 8-18-2005 10:46:47 T:\PROJECTS\8094\DRAIN\DRAIN\DRIT005A.DGN 52.53 54.55 56.57 58.59 60.61 62.63
 2.3 4.56 7.8 9 10 11 12 13 14 15 16 17 18 19 20 21 22 23 24 25 26 27 28 29 30 31 32 33 34 35 36 37 38 39 40 41 42 43 44 45 46 47 48 49 50

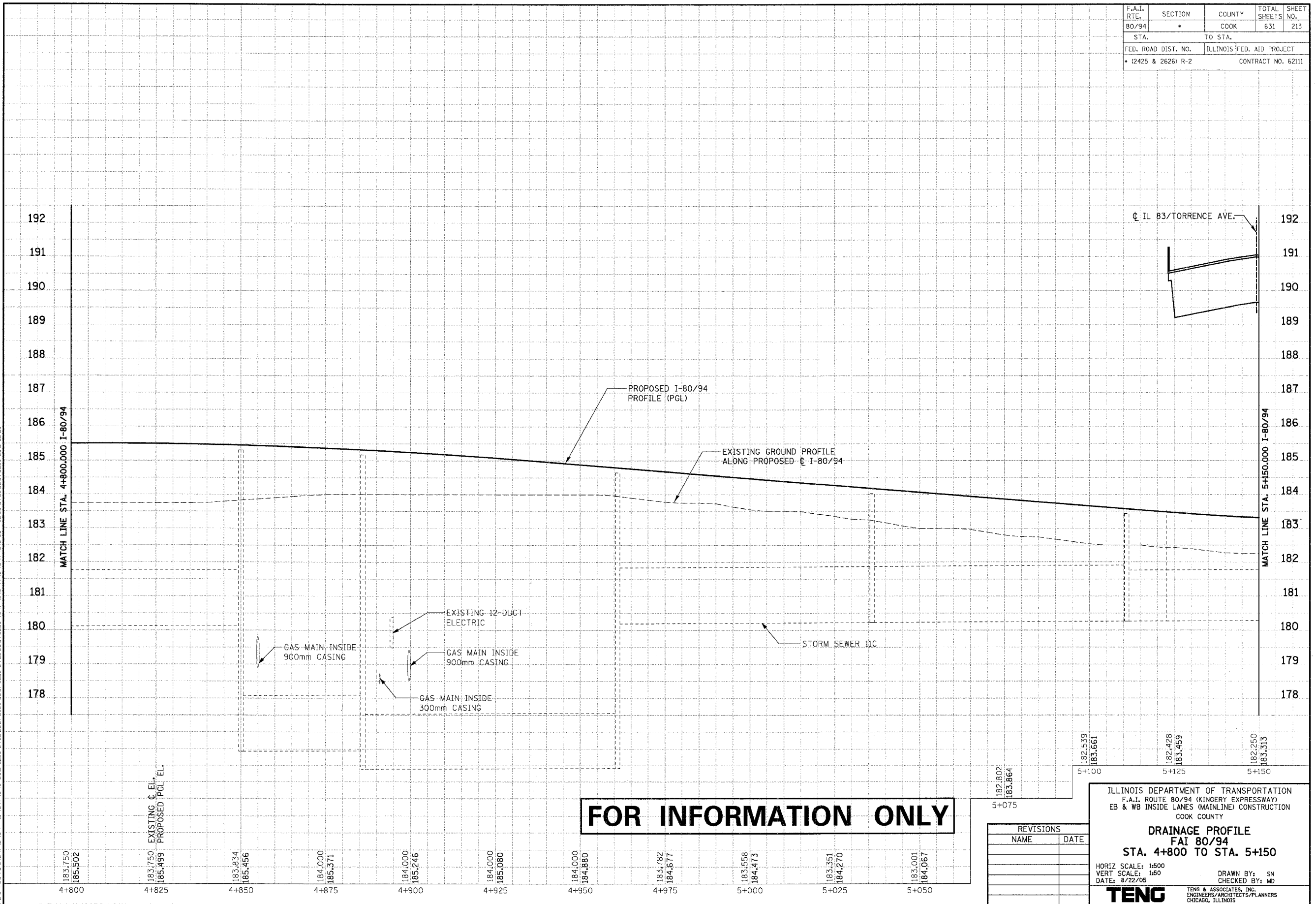

FOR INFORMATION ONLY

REVISIONS	
NAME	DATE

ILLINOIS DEPARTMENT OF TRANSPORTATION
 F.A.I. ROUTE 80/94 (KINGERY EXPRESSWAY)
 EB & WB INSIDE LANES (MAINLINE) CONSTRUCTION
 COOK COUNTY
DRAINAGE PROFILE
FAI 80/94
STA. 4+800 TO STA. 5+150

HORIZ SCALE: 1:500
 VERT SCALE: 1:50
 DATE: 8/22/05

DRAWN BY: SN
 CHECKED BY: MD

TENG

TENG & ASSOCIATES, INC.
 ENGINEERS/ARCHITECTS/PLANNERS
 CHICAGO, ILLINOIS