

F.A.I. RTE.	SECTION	COUNTY	TOTAL SHEETS	SHEET NO.
80/94		COOK	631	302
STA.	TO STA.			
FED. ROAD DIST. NO.	ILLINOIS	FED. AID PROJECT		
• (2425 & 2626) R-2		CONTRACT NO. 62111		

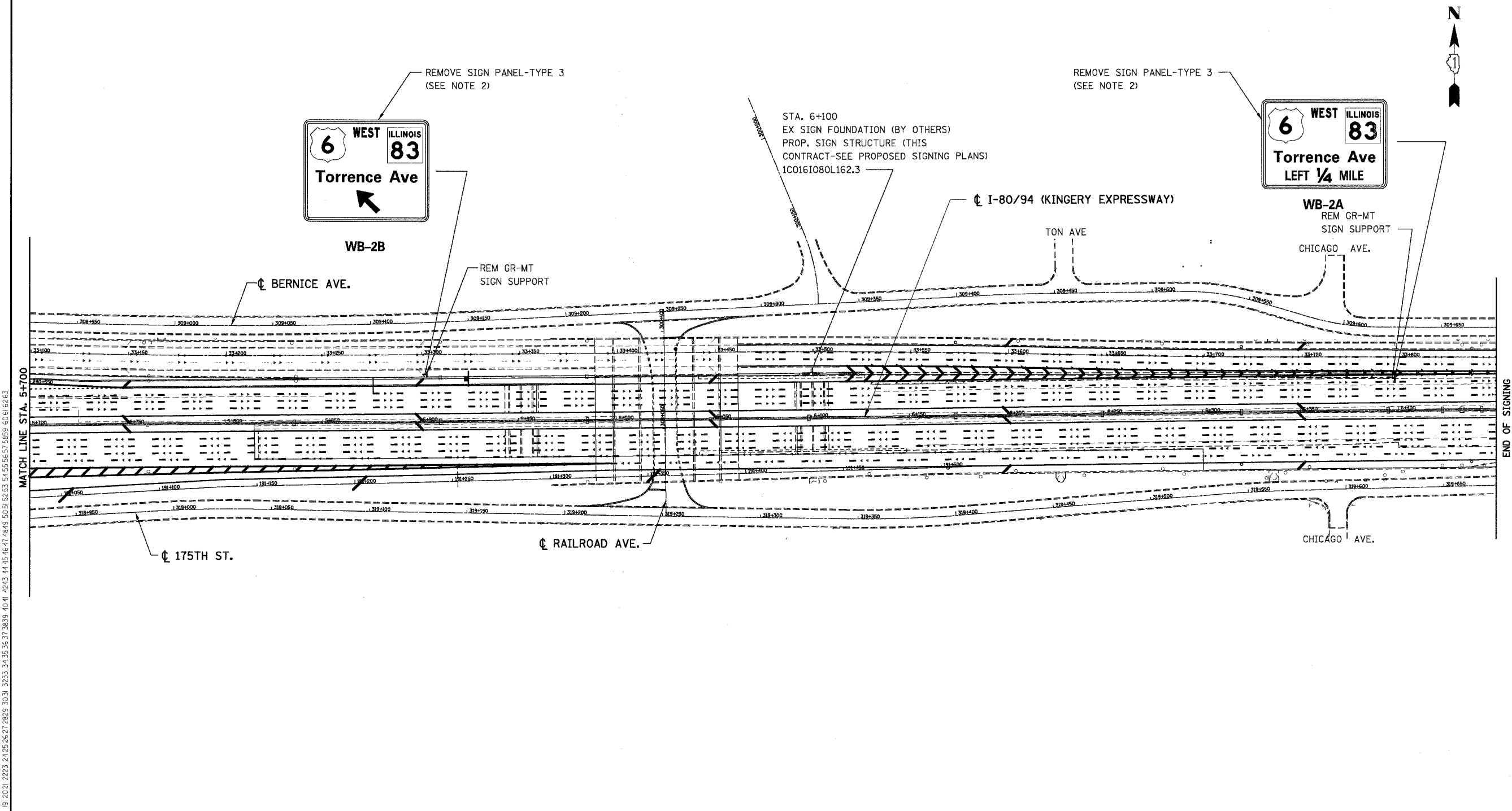

\\PRIT002A.DGN, \\SRT0002A.DGN, \\MR7002A.DGN, \\AB99002A.DGN, \\PRIT002A.DGN, \\NPMIA002A.DGN
 8-18-2005, 09:28
 1 2 3 4 5 6 7 8 9 10 11 12 13 14 15 16 17 18 19 20 21 22 23 24 25 26 27 28 29 30 31 32 33 34 35 36 37 38 39 40 41 42 43 44 45 46 47 48 49 50 51 52 53 54 55 56 57 58 59 60 61 62 63

- NOTES:
- SEE DETAILS SHEETS 303 AND SHEET 304 FOR DETAILS OF EXISTING TEMPORARY INFORMATION SIGNING.
 - SIGN PANELS TO BE REMOVED SHALL BE MAINTAINED IN PLACE UNTIL TRAFFIC STAGING PERMITS THEIR REMOVAL AS DIRECTED BY THE ENGINEER.

REVISIONS	
NAME	DATE

ILLINOIS DEPARTMENT OF TRANSPORTATION
 F.A.I. ROUTE 80/94 (KINGERY EXPRESSWAY)
 EB & WB INSIDE LANES (MAINLINE) CONSTRUCTION
 COOK COUNTY

EXISTING SIGNING
FAI 80/94
STA. 5+700 TO STA. 6+450

SCALE: 1/1000
 DATE: 8/22/05

DRAWN BY: FS
 CHECKED BY: RJM

TENG & ASSOCIATES, INC.
 ENGINEERS/ARCHITECTS/PLANNERS
 CHICAGO, ILLINOIS