

P.A. ATEL.	SECTION	COUNTY	TOTAL SHEETS	SHEET NO.
	*		631	519
STA.	TO STA.			
FED. ROAD DIST. NO. 1	ILLINOIS	FED. AID PROJECT		
*(2425 & 2626) R-2		CONTRACT NO. 5211		

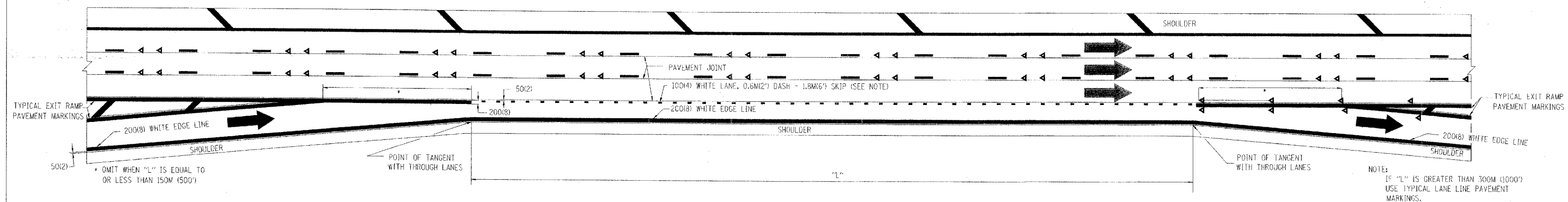

TYPICAL ENTRANCE/EXIT RAMP COMBINATION PAVEMENT MARKINGS

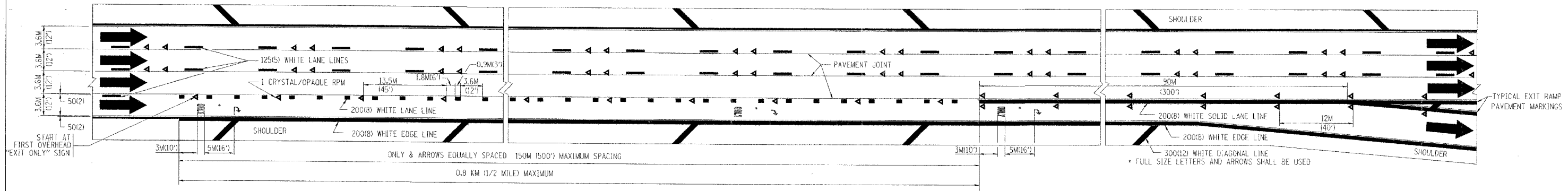

TYPICAL EXIT ONLY LANE PAVEMENT MARKINGS

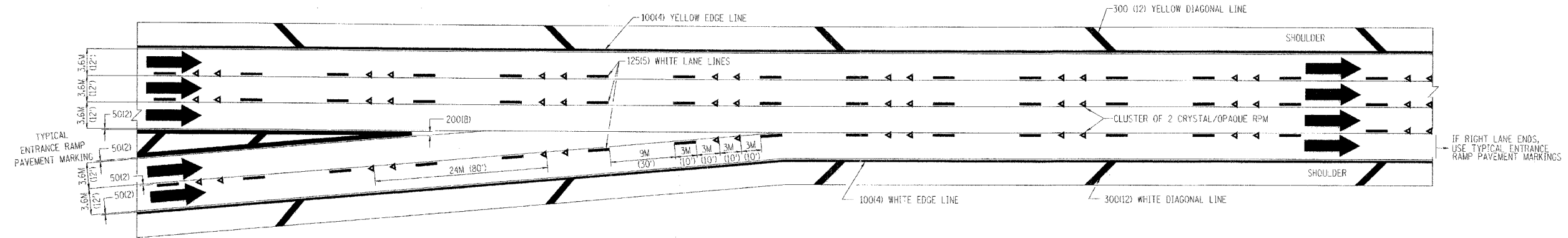

TYPICAL TWO LANE ENTRANCE RAMP PAVEMENT MARKINGS

REVISIONS	
NAME	DATE
DWS	1/90
DWS	5/91

ILLINOIS DEPARTMENT OF TRANSPORTATION

**MULTI-LANE FREEWAY
PAVEMENT MARKING
DETAILS**

SCALE: NONE
DATE: **DATE**

DRAWN BY C.A.D.D.
CHECKED BY

DATE-TIME
DWM-SPEC
VI-TCL