

F.A.I.	SECTION	COUNTY	TOTAL SHEETS	SHEET NO.
94/90	2003-028F	COOK	419	126
STA.	TO STA.			
FED. ROAD DIST. NO.	ILLINOIS	FED. AID PROJECT		

62580

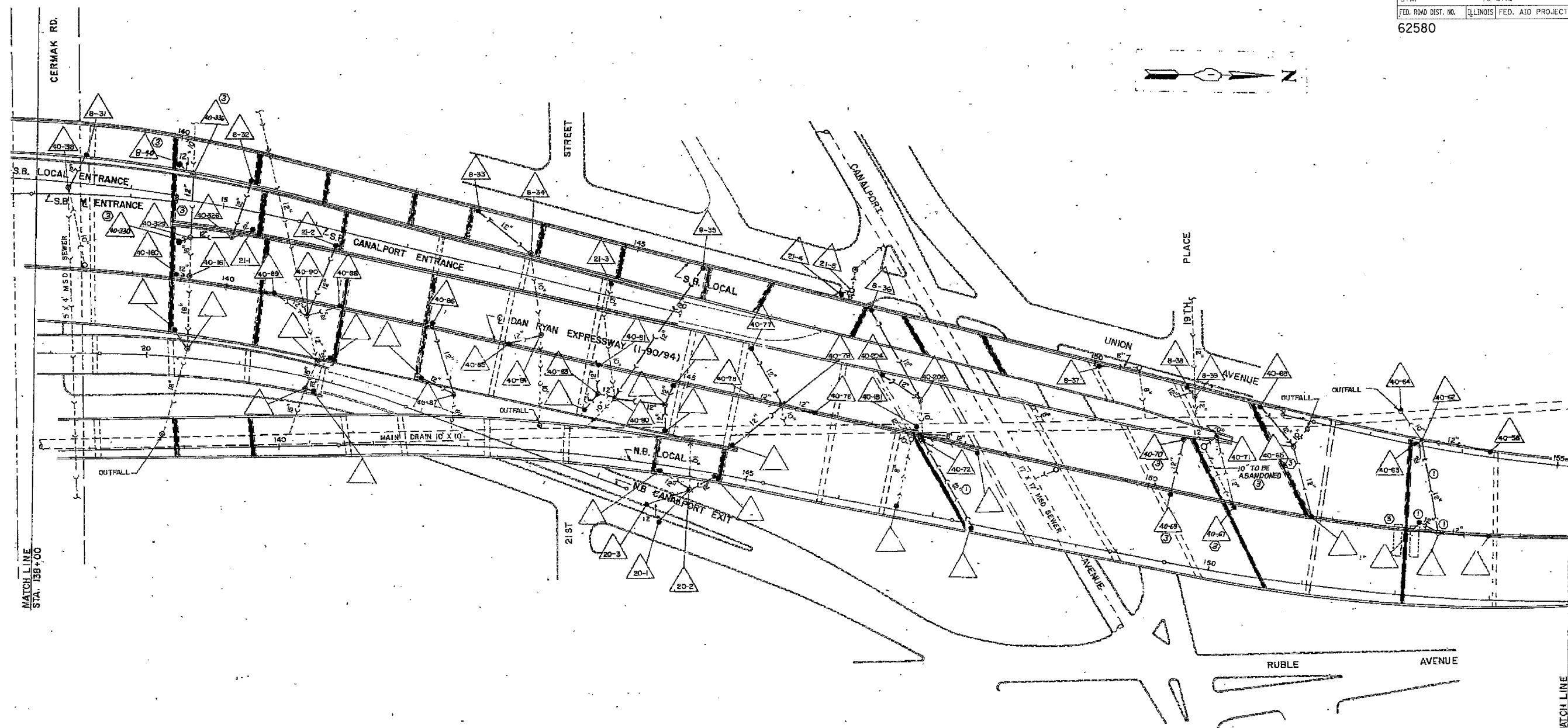
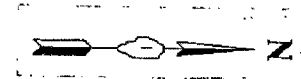

BOWMAN, BARRETT & ASSOCIATES INC
CONSULTING ENGINEERS
Chicago, Illinois
312.228.0100
www.bbandainc.com

FOR INFORMATION ONLY

NOTE:
Information from 1988-89 As-Builts to show probable location of existing catch basins collecting bridge drainage. Field verify location with Engineer. Clean all catch basins receiving drainage from NB viaduct.

REVISIONS	
NAME	DATE

ILLINOIS DEPARTMENT OF TRANSPORTATION
F.A.I. 94/90 (DAN RYAN EXPRESSWAY)
NB DAN RYAN ELEVATED BRIDGE
REPAIR FROM 15TH TO 28TH STREETS
EXISTING DRAINAGE SYSTEM
DETAILS

SCALE: NTS
DATE: 7/22/2005

DRAWN BY: BDC
CHECKED BY: BLU