

SECTION	COUNTY	TOTAL SHEETS	SHEET NO.
2004-083 1	COOK	40	24
STA. TO STA.		FED. ROAD DIST NO. 7 ILLINOIS FED AID PROJECT	

62825

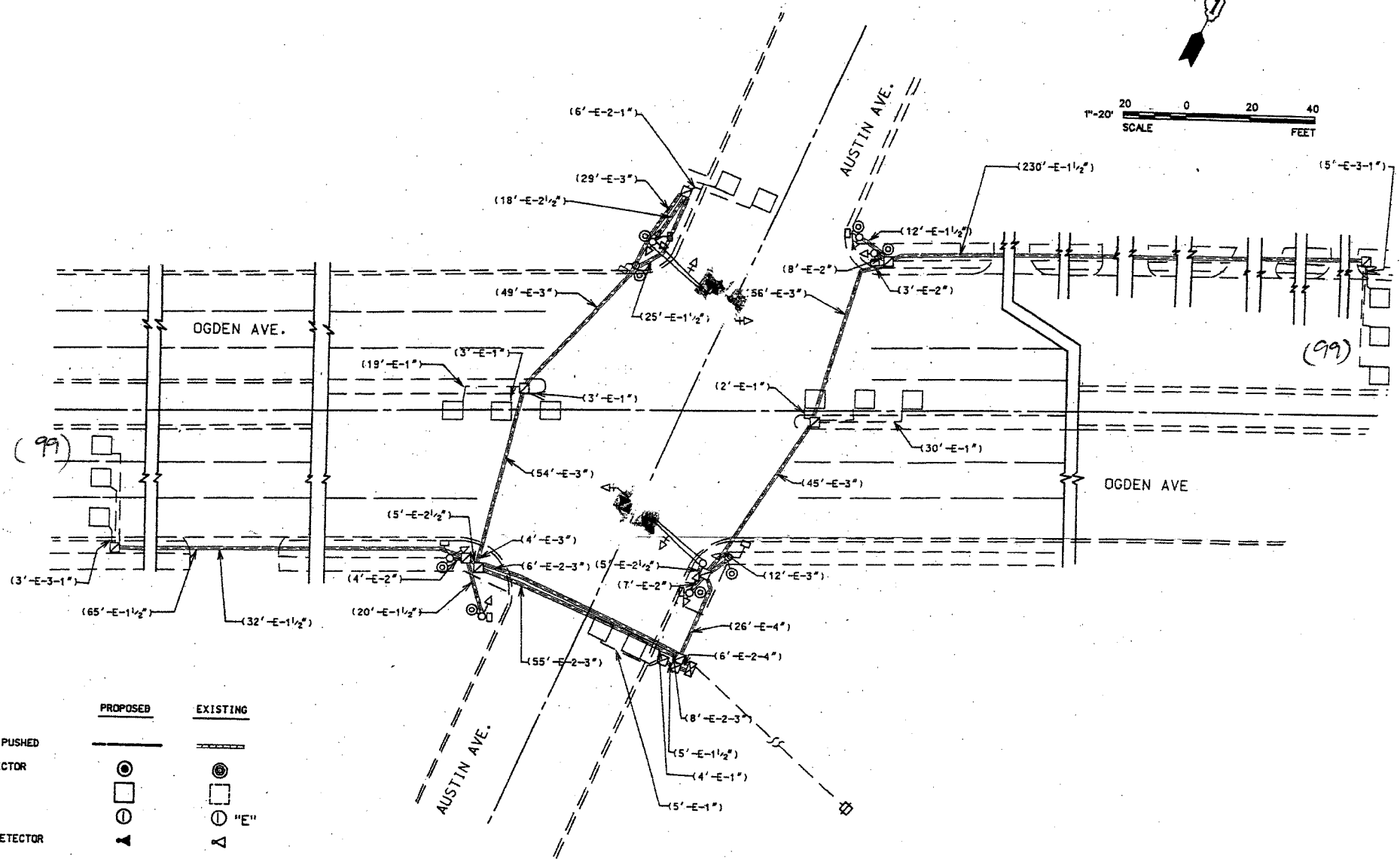
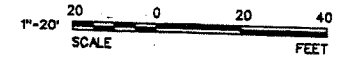

TRAFFIC SIGNAL LEGEND

PROPOSED		EXISTING		
CONTROLLER	[Symbol]	[Symbol]	[Symbol]	G.S. CONDUIT IN TRENCH OR PUSHED
SERVICE INSTALLATION	[Symbol]	[Symbol]	[Symbol]	PEDESTRIAN PUSHBUTTON DETECTOR
SIGNAL HEAD	[Symbol]	[Symbol]	[Symbol]	DETECTOR LOOP
SIGNAL HEAD WITH BACKPLATE	[Symbol]	[Symbol]	[Symbol]	CAST IRON JUNCTION BOX
SIGNAL HEAD, PEDESTRIAN	[Symbol]	[Symbol]	[Symbol]	EMERGENCY VEHICLE SYSTEM DETECTOR
SIGNAL POST	[Symbol]	[Symbol]	[Symbol]	CONFIRMATION BEACON
MAST ARM ASSEMBLY AND POLE, STEEL	[Symbol]	[Symbol]	[Symbol]	SIGNAL HEAD OPTICALLY PROGRAMMED
MAST ARM ASSEMBLY AND POLE, ALUMINUM	[Symbol]	[Symbol]	[Symbol]	CONDUIT SPLICE
COMMON TRENCH	[Symbol]	[Symbol]	[Symbol]	WOOD POLE
UNIT DUCT	[Symbol]	[Symbol]	[Symbol]	RACEWAY FOR MAGNETIC DETECTOR, TYPE I OR TYPE II
HANDHOLE	[Symbol]	[Symbol]	[Symbol]	VEHICLE DETECTOR, NON-COMPENSATED MAGNETIC TYPE
HEAVY DUTY HANDHOLE	[Symbol]	[Symbol]	[Symbol]	RAILROAD CONTROL CABINET
DOUBLE HANDHOLE	[Symbol]	[Symbol]	[Symbol]	

REPLACE ALL DETECTOR LOOPS AS SHOWN

(WITHIN THE RESURFACING LIMITS)

CODE NO.	QUANTITY	UNIT	ITEM
86600600	198	Foot	Detector Loop Replacement

REVISIONS	
NAME	DATE

NOTE:
THIS PLAN IS FOR THE PURPOSE OF REPLACING THE DETECTOR LOOPS ONLY. ALL OTHER INFORMATION SHOWN IS NOT RELATED AND WILL BE DISREGARDED.

ILLINOIS DEPARTMENT OF TRANSPORTATION
DETECTOR LOOP REPLACEMENT
U.S. 34 (OGDEN AV.) @ AUSTIN AVENUE
SCALE: 1" = 20'
DATE: AUG. 05
DRAWN BY: J.E.
DESIGNED BY: J.E.
CHECKED BY: J.E.