

F.A.I. RTE.	SECTION	COUNTY	TOTAL SHEETS	SHEET NO.
57	99-1-N	WILL	52	13
STA.		TO STA.		
FED. ROAD DIST. NO.		ILLINOIS FED. AID PROJECT		

CONTRACT NO. 62834

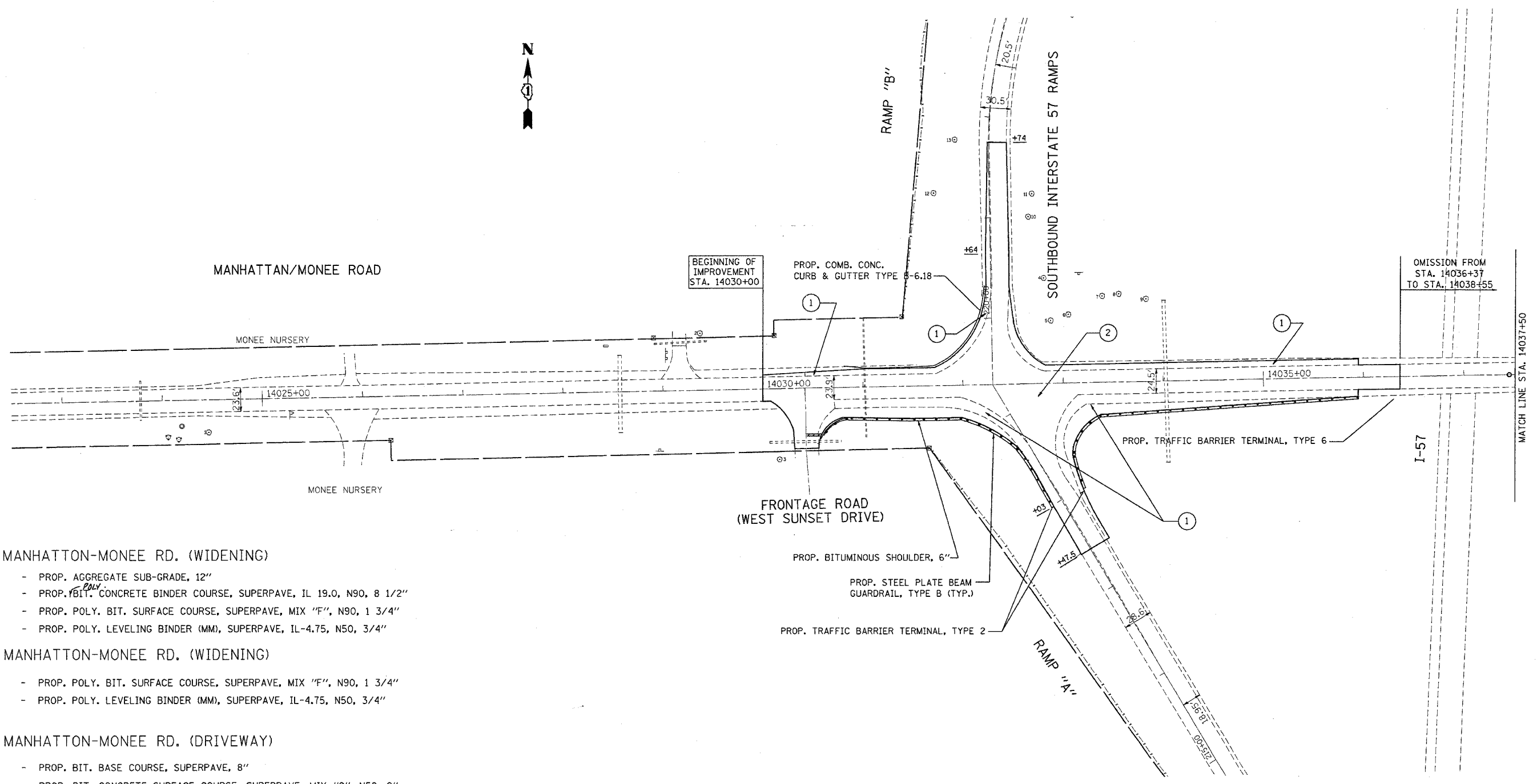

- ① MANHATTAN-MONEE RD. (WIDENING)
  - PROP. AGGREGATE SUB-GRADE, 12"
  - PROP. <sup>204</sup>BIT. CONCRETE BINDER COURSE, SUPERPAVE, IL 19.0, N90, 8 1/2"
  - PROP. POLY. BIT. SURFACE COURSE, SUPERPAVE, MIX "F", N90, 1 3/4"
  - PROP. POLY. LEVELING BINDER (MM), SUPERPAVE, IL-4.75, N50, 3/4"
- ② MANHATTAN-MONEE RD. (WIDENING)
  - PROP. POLY. BIT. SURFACE COURSE, SUPERPAVE, MIX "F", N90, 1 3/4"
  - PROP. POLY. LEVELING BINDER (MM), SUPERPAVE, IL-4.75, N50, 3/4"
- ③ MANHATTAN-MONEE RD. (DRIVEWAY)
  - PROP. BIT. BASE COURSE, SUPERPAVE, 8"
  - PROP. BIT. CONCRETE SURFACE COURSE, SUPERPAVE, MIX "C", N50, 2"

REVISIONS	
NAME	DATE

ILLINOIS DEPARTMENT OF TRANSPORTATION  
 FAI 57/ I-57  
 © MANHATTAN-MONEE ROAD  
 PROPOSED ROADWAY

SCALE: VERT. 1"=50'  
 HORIZ. DATE

DRAWN BY  
 CHECKED BY

PLOT DATE = 9/20/2009  
 PLOT NAME = 1403601A\_14037+50.dwg  
 PLOT SCALE = 1/4"=50'  
 REFERENCE = REF#