

F.A.I. RTE.	SECTION	COUNTY	TOTAL SHEETS	SHEET NO.
94		COOK	30	8
STA. 1200+00.00 TO STA. 1330+00.00		ILLINOIS FED. AID PROJECT		
FED. ROAD DIST. NO.		• (1516.1, 1717 & 1818) I-4		

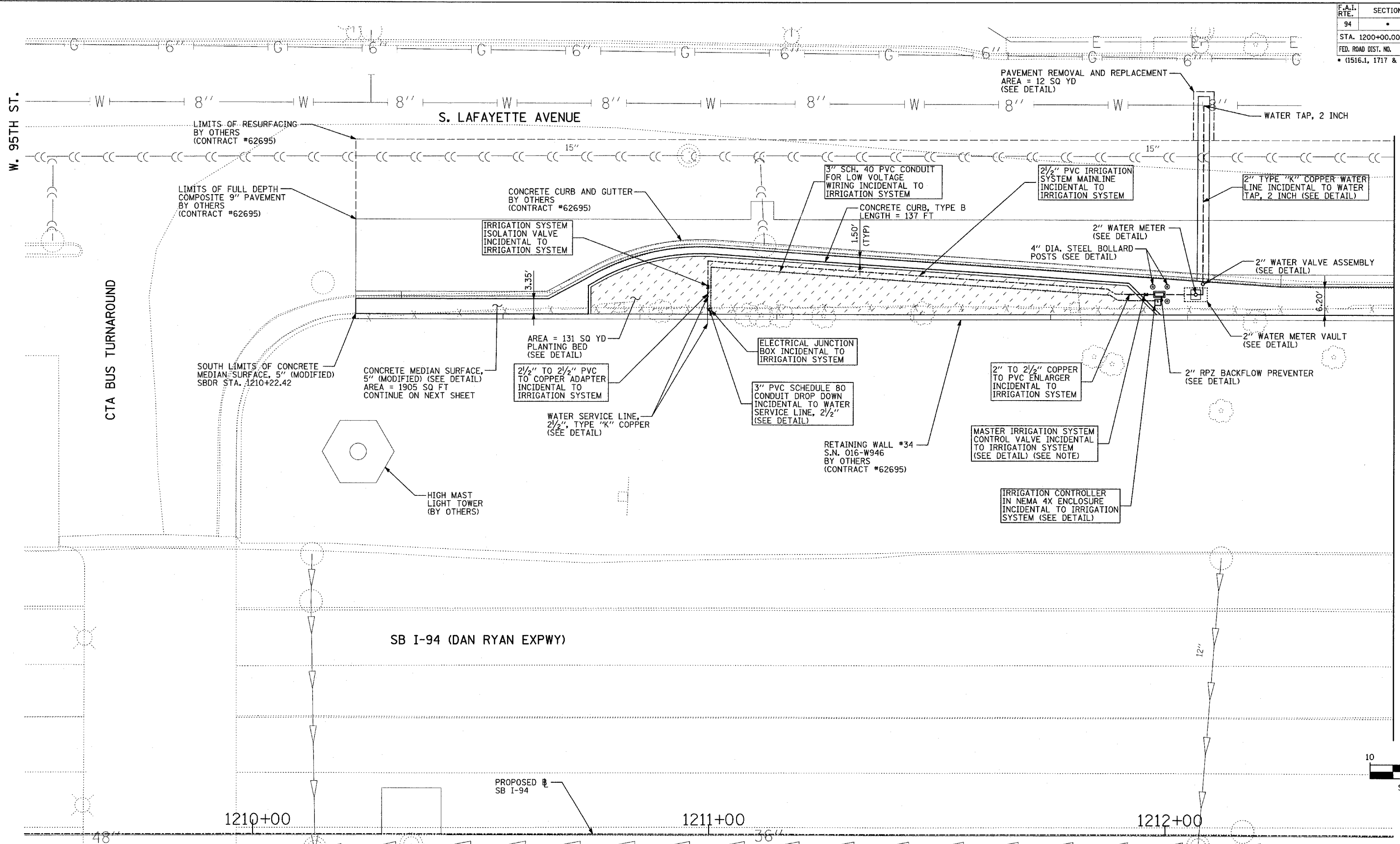

CTA BUS TURNAROUND

MATCHLINE SB I-94 STA. 1212+50

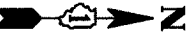
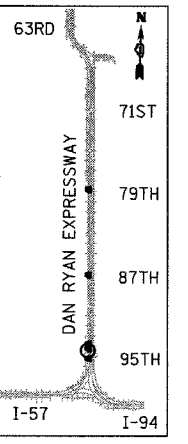

LOCATION MAP

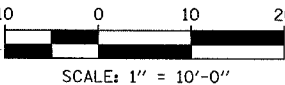

TYLIN INTERNATIONAL

NOTES:
 MASTER IRRIGATION CONTROL VALVE IS TO BE INSTALLED AT THE DESIGNATED LOCATION SPECIFIED BY THE CITY OF CHICAGO DURING CONSTRUCTION AND ON PUBLIC PROPERTY.

THERMOPLASTIC PAVEMENT MARKING QUANTITIES HAVE BEEN PROVIDED IN THE EVENT THAT THE TRENCHING AND PATCHING OPERATIONS REMOVES EXISTING PAVEMENT MARKINGS.

REVISIONS	
NAME	DATE

ILLINOIS DEPARTMENT OF TRANSPORTATION
 F.A.I. 94 (DAN RYAN EXPRESSWAY)
PLANTING BED AT LAFAYETTE AVENUE NORTH OF 95th STREET SB I-94 STA. 1209+50 TO 1212+50
 SHEET 1 OF 2
 SCALE: 1"=10'-0"
 DATE: SEPTEMBER 2, 2005
 DRAWN BY: JDF
 CHECKED BY: RTM