

F.A.P. RTE.	SECTION	COUNTY	TOTAL SHEETS	SHEET NO.
646	(102)BR-3	WHITESIDE	57	12
STA. TO STA.		FED. ROAD DIST. NO. [ILLINOIS] FED. AID PROJECT		
		CONTRACT NUMBER: 64426		

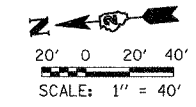

PHASE	A	B	C
INTERVAL	1	2	3
NORTHBOUND	G	Y	R
SOUTHBOUND	R	R	G
EASTBOUND	R	R	R
WESTBOUND	R	R	R

### STAGE I

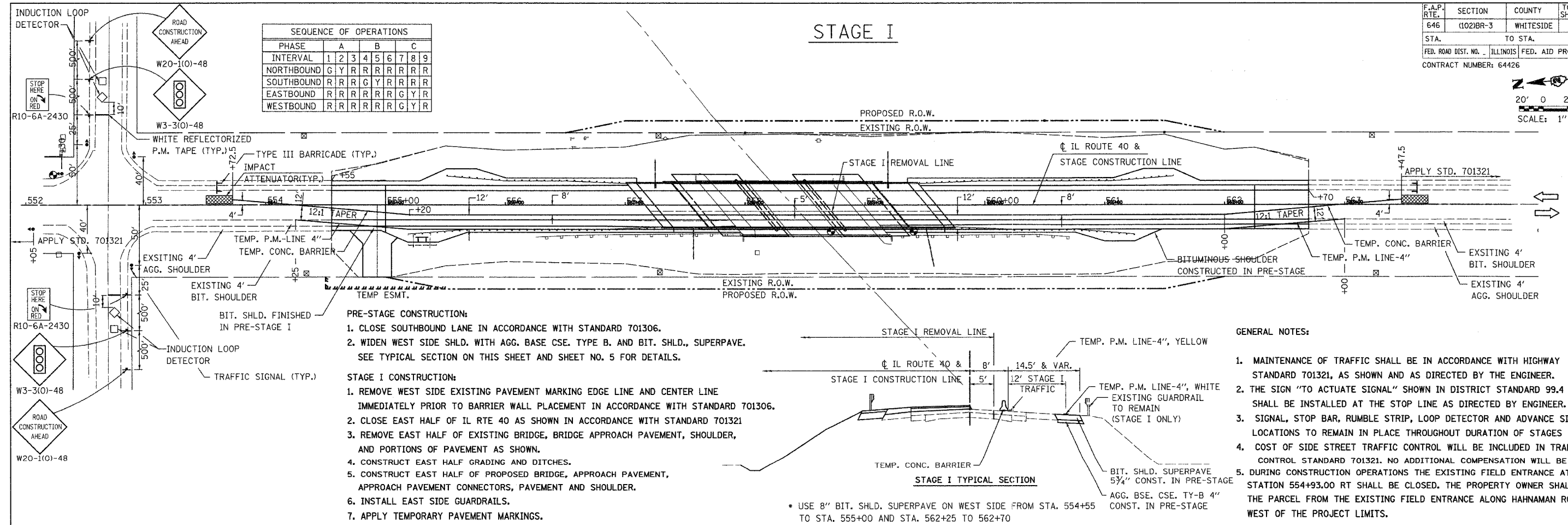

- PRE-STAGE CONSTRUCTION:**
- CLOSE SOUTHBOUND LANE IN ACCORDANCE WITH STANDARD 701306.
  - WIDEN WEST SIDE SHLD. WITH AGG. BASE CSE. TYPE B. AND BIT. SHLD., SUPERPAVE. SEE TYPICAL SECTION ON THIS SHEET AND SHEET NO. 5 FOR DETAILS.

- STAGE I CONSTRUCTION:**
- REMOVE WEST SIDE EXISTING PAVEMENT MARKING EDGE LINE AND CENTER LINE IMMEDIATELY PRIOR TO BARRIER WALL PLACEMENT IN ACCORDANCE WITH STANDARD 701306.
  - CLOSE EAST HALF OF IL RTE 40 AS SHOWN IN ACCORDANCE WITH STANDARD 701321
  - REMOVE EAST HALF OF EXISTING BRIDGE, BRIDGE APPROACH PAVEMENT, SHOULDER, AND PORTIONS OF PAVEMENT AS SHOWN.
  - CONSTRUCT EAST HALF GRADING AND DITCHES.
  - CONSTRUCT EAST HALF OF PROPOSED BRIDGE, APPROACH PAVEMENT, APPROACH PAVEMENT CONNECTORS, PAVEMENT AND SHOULDER.
  - INSTALL EAST SIDE GUARDRAILS.
  - APPLY TEMPORARY PAVEMENT MARKINGS.

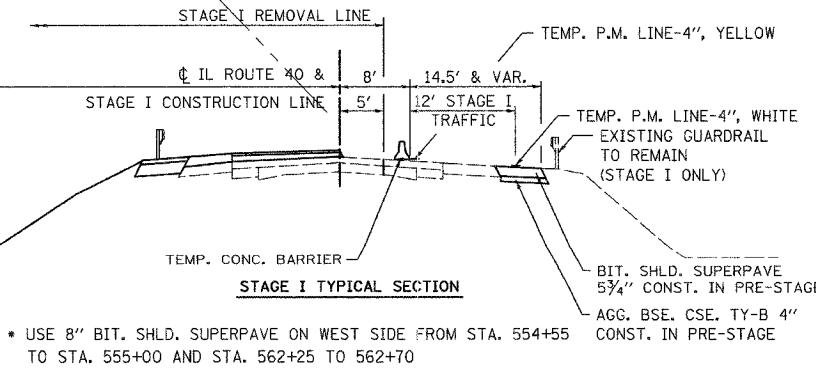

- GENERAL NOTES:**
- MAINTENANCE OF TRAFFIC SHALL BE IN ACCORDANCE WITH HIGHWAY STANDARD 701321, AS SHOWN AND AS DIRECTED BY THE ENGINEER.
  - THE SIGN "TO ACTUATE SIGNAL" SHOWN IN DISTRICT STANDARD 99.4 SHALL BE INSTALLED AT THE STOP LINE AS DIRECTED BY ENGINEER.
  - SIGNAL, STOP BAR, RUMBLE STRIP, LOOP DETECTOR AND ADVANCE SIGN LOCATIONS TO REMAIN IN PLACE THROUGHOUT DURATION OF STAGES I & II.
  - COST OF SIDE STREET TRAFFIC CONTROL WILL BE INCLUDED IN TRAFFIC CONTROL STANDARD 701321. NO ADDITIONAL COMPENSATION WILL BE MADE.
  - DURING CONSTRUCTION OPERATIONS THE EXISTING FIELD ENTRANCE AT STATION 554+93.00 RT SHALL BE CLOSED. THE PROPERTY OWNER SHALL ACCESS THE PARCEL FROM THE EXISTING FIELD ENTRANCE ALONG HAHNAMAN ROAD JUST WEST OF THE PROJECT LIMITS.

\* USE 8" BIT. SHLD. SUPERPAVE ON WEST SIDE FROM STA. 554+55 TO STA. 555+00 AND STA. 562+25 TO 562+70

### STAGE II

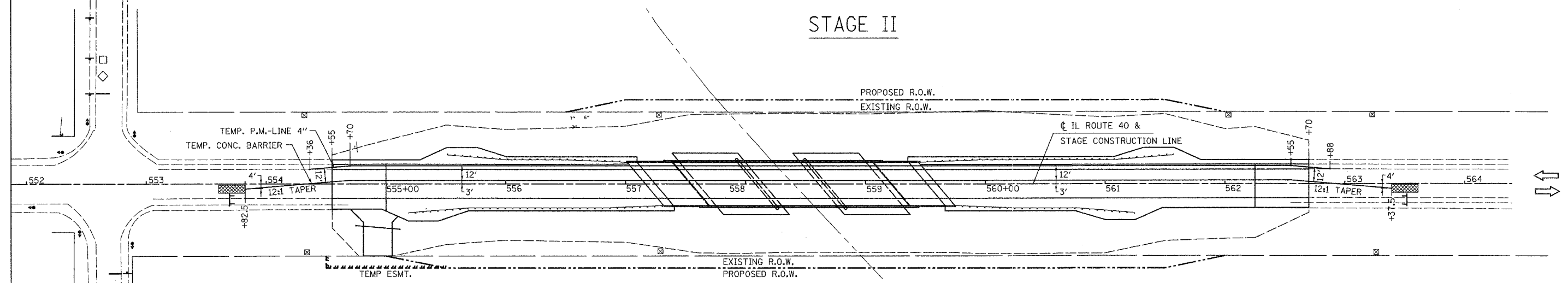

- STAGE II CONSTRUCTION:**
- CLOSE WEST HALF OF IL RTE 40 AS SHOWN IN ACCORDANCE WITH STANDARD 701321
  - REMOVE WEST HALF OF EXISTING BRIDGE, APPROACH PAVEMENT, SHOULDER, AND PORTIONS OF PAVEMENT.
  - CONSTRUCT WEST HALF GRADING AND DITCHES.
  - CONSTRUCT WEST HALF OF PROPOSED BRIDGE, APPROACH PAVEMENT, APPROACH PAVEMENT CONNECTORS, PROPOSED PAVEMENT AND SHOULDER.
  - CONSTRUCT FIELD ENTRANCE AND CULVERT.
  - INSTALL WEST SIDE GUARDRAILS.

- STAGE III CONSTRUCTION:**
- APPLY PERMANENT PAVEMENT MARKINGS UNDER STD. 701311.

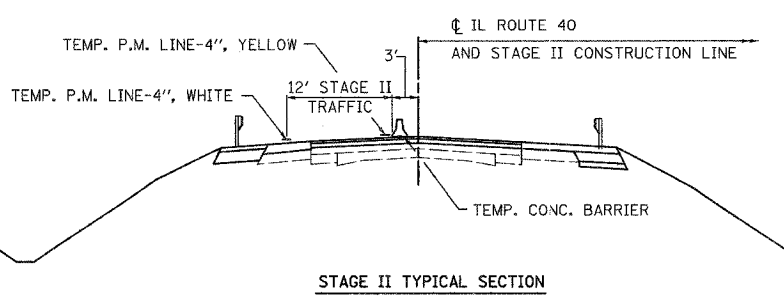

NAME	DATE

ILLINOIS DEPARTMENT OF TRANSPORTATION  
**MAINTENANCE OF TRAFFIC PLAN**  
 SCALE: 1"=40'  
 DATE: AUGUST, 2005  
 DRAWN BY: JH  
 CHECKED BY: FML