

F.A. RTE.	SECTION	COUNTY	TOTAL SHEETS	SHEET NO.
573	116R-4	DEKALB	416	182
STA.		TO STA.		
FED. ROAD DIST. NO.		ILLINOIS	FED. AID PROJECT	

STAGE 1

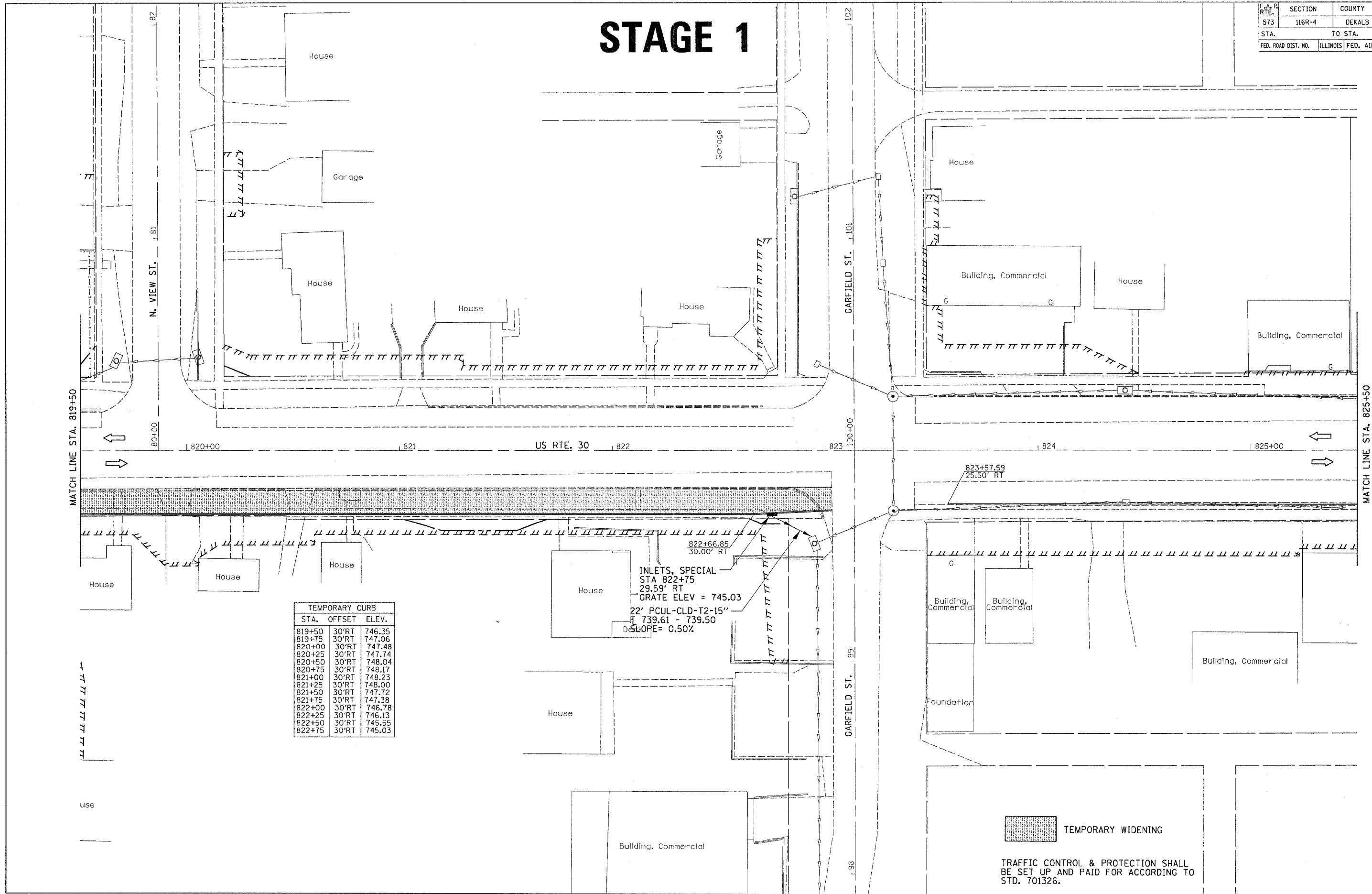

TEMPORARY CURB		
STA.	OFFSET	ELEV.
819+50	30'RT	746.35
819+75	30'RT	747.06
820+00	30'RT	747.48
820+25	30'RT	747.74
820+50	30'RT	748.04
820+75	30'RT	748.17
821+00	30'RT	748.23
821+25	30'RT	748.00
821+50	30'RT	747.72
821+75	30'RT	747.38
822+00	30'RT	746.78
822+25	30'RT	746.13
822+50	30'RT	745.55
822+75	30'RT	745.03

INLETS, SPECIAL
 STA 822+75
 GRATE ELEV = 745.03
 22' PCUL-CLD-T2-15"
 T 739.61 - 739.50
 SLOPE = 0.50%

 TEMPORARY WIDENING

TRAFFIC CONTROL & PROTECTION SHALL BE SET UP AND PAID FOR ACCORDING TO STD. 701326.

FILE NAME = #STILES
 LEVELS = #LEVELS
 PLOT SCALE = #PLOTSCALE
 PLOT DATE = #PLOTDATE
 DRAFTER = #DRAFTER
 REF = #REF