

F.A. R. RTE.	SECTION	COUNTY	TOTAL SHEETS	SHEET NO.
573	116R-4	DEKALB	416	225
STA.		TO STA.		
FED. ROAD DIST. NO.		ILLINOIS FED. AID PROJECT		

STAGE 6

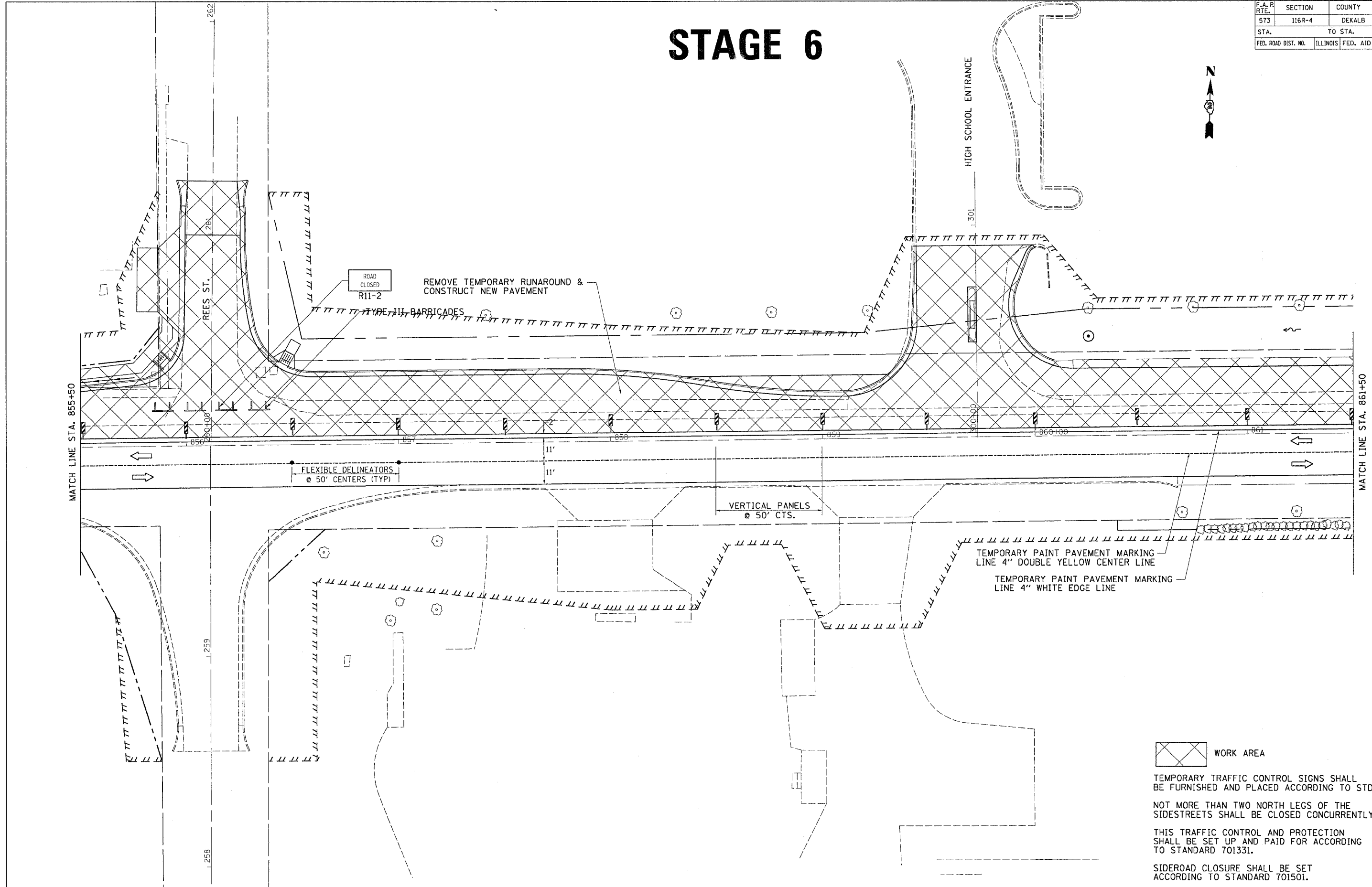

MATCH LINE STA. 855+50

MATCH LINE STA. 861+50

FILE NAME = #FILES
 LEVELS = #LEVELS
 PLOT SCALE = #PLOTS/SCALE
 PLOT DATE = FRI Sep 02 07:37:09 2005
 OPERATOR = Jordanhd
 REF REF REF

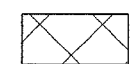
 WORK AREA

TEMPORARY TRAFFIC CONTROL SIGNS SHALL BE FURNISHED AND PLACED ACCORDING TO STD. 701331.

NOT MORE THAN TWO NORTH LEGS OF THE SIDESTREETS SHALL BE CLOSED CONCURRENTLY.

THIS TRAFFIC CONTROL AND PROTECTION SHALL BE SET UP AND PAID FOR ACCORDING TO STANDARD 701331.

SIDEROAD CLOSURE SHALL BE SET ACCORDING TO STANDARD 701501.