

F.A. RTE.	SECTION	COUNTY	TOTAL SHEETS	SHEET NO.
525	#	BOONE	11	1

- FOR INDEX OF SHEETS**
- 1 COVER SHEET
 - INDEX OF SHEETS
 - STANDARDS
 - 2 SUMMARY OF QUANTITIES
 - 3 UTILITIES
 - 4 GENERAL NOTES
 - SIGNAL PLANS SHEETS LEGEND
 - 5-6 PLANS SHEETS
 - 7-8 CABLE DETAIL
 - 9 DISTRICT STANDARD 94.2
 - DISTRICT STANDARD 93.4
 - 10-11 DISTRICT STANDARD 41.1

STANDARDS

- 424001-04 CURB RAMPS FOR SIDEWALKS
- 780001-01 TYPICAL PAVEMENT MARKING
- 805001 ELECTRICAL SERVICE INSTALLATION DETAILS
- 880006 TRAFFIC SIGNAL MOUNTING DETAILS
- 701006-02 OFF-ROAD OPERATIONS 2L, 2W 4.5m(15') TO PAVEMENT EDGE FOR SPEEDS > 45 MPH
- 701101-01 OFF-ROAD OPERATIONS, MULTILANE LESS THAN 4.5m (15') AWAY FOR SPEEDS >45 MPH
- 701301-02 LANE CLOSURE , 2L, 2W SHORT TIME OPERATIONS
- 701426-02 LANE CLOSURE, MULTILANE INTERMITTENT OR MOVING MOVING OPERATION, FOR SPEEDS > 45 MPH
- 701501-03 URBAN LANE CLOSURE 2L, 2W UNDIVIDED
- 701701-04 URBAN LANE CLOSURE MULTILANE INTERSECTION
- 701801-03 LANE CLOSURE MULTILANE 1W OR 2W CROSSWALK OR SIDEWALK CLOSURE FOR SPEEDS > 45MPH
- 702001-05 TRAFFIC CONTROL DEVICES
- 857001 STANDARD PHASE DESIGNATION DIAGRAMS AND PHASE SEQUENCES

STATE OF ILLINOIS
DEPARTMENT OF TRANSPORTATION
DIVISION OF HIGHWAYS
PROPOSED
HIGHWAY PLANS

FAP ROUTE 525 (US 20)
SECTION (6,14,15)R-TS-1
PROJECT ACHS-0525 (110)
BOONE COUNTY

C92-110-05

PROJECT LOCATION
 US 20 AT PEARL AND STATE ST

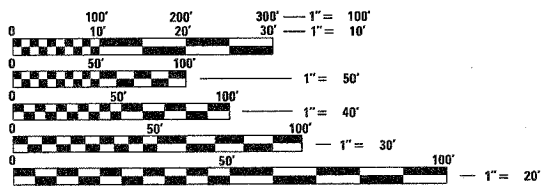
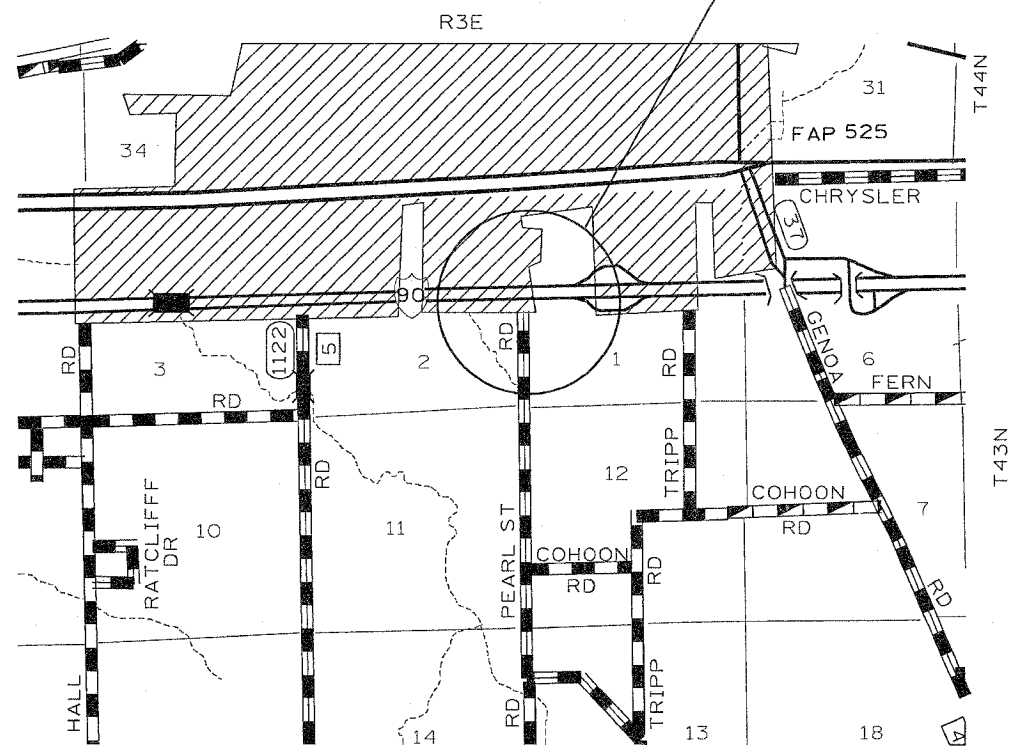

FULL SIZE PLANS HAVE BEEN PREPARED USING STANDARD ENGINEERING SCALES. REDUCED SIZED PLANS WILL NOT CONFORM TO STANDARD SCALES. IN MAKING MEASUREMENTS ON REDUCED PLANS, THE ABOVE SCALES MAY BE USED.

J.U.L.I.E.
 JOINT UTILITY LOCATION INFORMATION FOR EXCAVATION
 1-800-892-0123

CONTRACT NO. 64B32

STATE OF ILLINOIS
 DEPARTMENT OF TRANSPORTATION
 DIVISION OF HIGHWAYS

SUBMITTED September 1, 2005

Handwritten Signature
 DEPUTY DIRECTOR OF HIGHWAYS, REGION ENGINEER

October 14, 2005
Mike Hane
 ENGINEER OF DESIGN AND ENVIRONMENT

October 14, 2005
Eric E. Hahn
 DEPUTY DIRECTOR OF HIGHWAYS, CHIEF ENGINEER

**PRINTED BY THE AUTHORITY
 OF THE STATE OF ILLINOIS**