

FAI ROUTE	SECTION	COUNTY	TOTAL SHEETS	SHEET NO.
74	92(11,12,12-1)RS-1,I	VERMILION	13	1

D-95-024-05
CONTRACT # 70477

STATE OF ILLINOIS
DEPARTMENT OF TRANSPORTATION
DIVISION OF HIGHWAYS
**PLANS FOR PROPOSED
HIGHWAY IMPROVEMENT**

FOR INDEX OF SHEETS, SEE SHEET NO. 2
FOR SUMMARY OF QUANTITIES, SEE SHEET NO. 3

PLAN: 1" = 20'
PROFILE HORIZ.: N.A.
PROFILE VERT.: N.A.
SCALES CROSS SECTIONS - HORIZONTAL: 1" = 10' VERTICAL: 1" = 5'

**F.A.I. ROUTE 74 (I-74 EASTBOUND EXIT RAMP)
SECTION 92(11,12,12-1)RS-1,I
VERMILION COUNTY
PROJECT H S -074-6(146)216**

C-95-024-05
SHOULDER RECONSTRUCTION

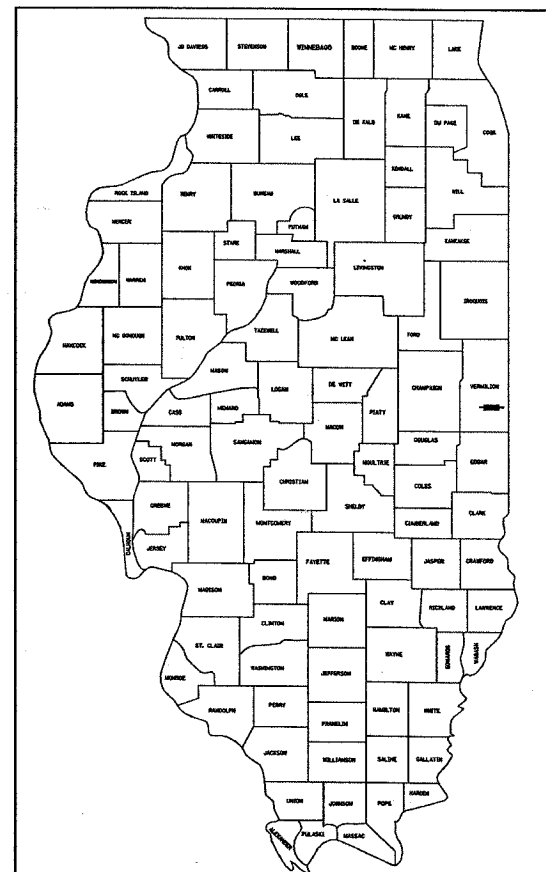

LOCATION OF SECTION INDICATED THUS: - ■ -

DESIGN TRAFFIC

2003	4,750 ADT
2023	5,200 ADT
PU	4,925 ADT
SU	165 ADT
MU	110 ADT

DESIGN PERIOD 20

% PU	94.7
% SU	3.2
% MU	2.1
TRAFFIC FACTOR =	
SN =	N/A

**DESIGN DESIGNATION
N.A.**

STRUCTURE NO. 092-0084
PERRYSVILLE AVE. OVER I-74

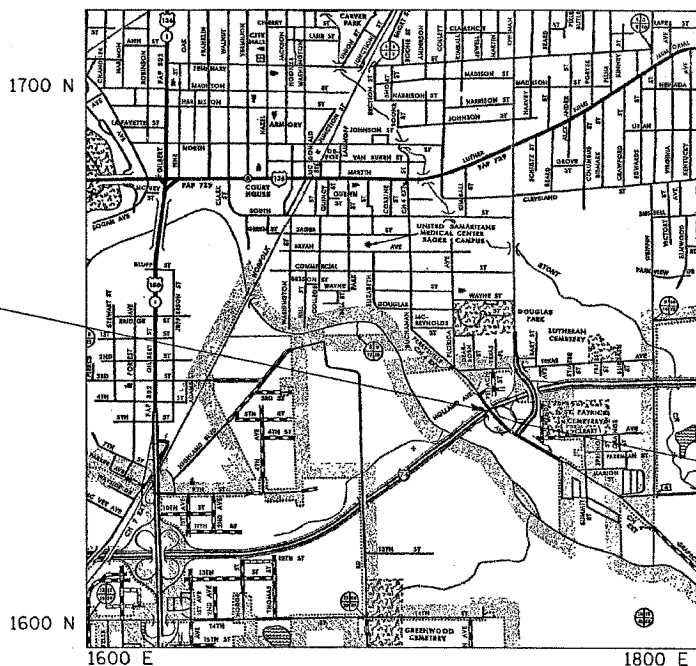

SECTION 92(11,12,12-1)RS-1,I
INCLUDES SHOULDER RECONSTRUCTION

TOTAL LENGTH OF SECTION & PROJECT = 400.0 FEET = 0.076 MILES
NET LENGTH OF SECTION & PROJECT = 400.0 FEET = 0.076 MILES

STATE OF ILLINOIS
DEPARTMENT OF TRANSPORTATION
DIVISION OF HIGHWAYS

SUBMITTED 7/7 2005
Joseph R. Coore REGIONAL ENGINEER

EXAMINED August 19 2005
Mike Shea ENGINEER OF DESIGN AND ENVIRONMENT

APPROVED August 19 2005
Victor Maden DIRECTOR, DIVISION OF HIGHWAYS

FOR UNDERGROUND UTILITY
LOCATIONS CALL
TOLL FREE J.U.L.I.E. TELEPHONE NO.
1-800-892-0123
DANVILLE TOWNSHIP

PRINTED BY AUTHORITY OF THE STATE OF ILLINOIS

DESIGNED BY: JEFF ALLEN PROJECT ENGINEER: SCOTT NEIHART (217) 465 - 4181

CONTRACT NO. 70477

F.A.I. ROUTE 74 SECTION 92(11,12,12-1)RS-1,I VERMILION COUNTY

GENERAL NOTES

G. N. -100
ENGLISH UNITS OF MEASUREMENT SHALL GOVERN OVER AND SUPERSEDE ANY METRIC UNITS SHOWN IN THIS CONTRACT. WHERE INCLUDED, METRIC UNITS ARE FOR INFORMATION ONLY.

G. N. -1004.01
COARSE AGGREGATE GRADATION CA-10 MAY BE USED WHENEVER COARSE AGGREGATE CA-6 IS SPECIFIED IN THE STANDARD SPECIFICATIONS.

G. N. -105.07B
EXISTING STATE-OWNED AND MAINTAINED UTILITY LINES ARE SHOWN ON THE PLANS TO INDICATE THEIR PRESENCE AND APPROXIMATE LOCATION. THE CONTRACTOR SHALL SECURE AN APPROVED LOCATING FIRM TO LOCATE STATE-OWNED UTILITIES PRIOR TO COMMENCING ANY EXCAVATION IN THE VICINITY OF THESE LINES IN ACCORDANCE TO SECTION 803 OF THE STANDARD SPECIFICATIONS. SHOULD ANY OF THE LINES BE DAMAGED BY THE CONTRACTOR'S OPERATION, THE CONTRACTOR SHALL REPAIR THEM TO THE SATISFACTION OF THE ENGINEER AT NO COST TO THE STATE.

ALSO THERE MAY BE UTILITIES PRESENT WHICH WERE INSTALLED BY THE STATE BUT ARE MAINTAINED BY OTHERS (CITY, TOWN, ETC.) THE APPROXIMATE LOCATIONS OF THESE LINES ARE ALSO SHOWN ON THE PLANS ALONG WITH THE NAME OF THE MAINTAINING AGENCY. THE CONTRACTOR SHALL COORDINATE THE LOCATION OF THESE LINES WITH THE LOCAL AGENCY PRIOR TO COMMENCING ANY EXCAVATION OR BORING IN THEIR VICINITY. SHOULD THESE LINES BE DAMAGED BY THE CONTRACTOR'S OPERATIONS, THE CONTRACTOR SHALL REPAIR THEM TO THE SATISFACTION OF, AND AT NO COST TO, THE LOCAL AGENCY AND THE STATE.

G. N. -105.09A
ALL ELEVATIONS SHOWN IN THE PLANS ARE BASED ON NORTH AMERICAN VERTICAL DATUM OF 1988. (NAVD 88)

G. N. -202
GRADING SHALL BE DONE BY HAND AROUND LIGHT POLES, UTILITY POLES, SIGN POSTS, SHRUBS, TREES OR OTHER NATURAL OR MAN-MADE OBJECTS WHERE SHALLOW FILLS OR CUTS ARE ADJACENT TO THE ITEMS. IT IS THE INTENT THAT THE LIMITS OF CONSTRUCTION BE SUCH AS TO PRESERVE IN THE ORIGINAL STATE AS MUCH AREA OF TEMPORARY EASEMENTS AS POSSIBLE. THE DECISION AS TO ITEMS TO REMAIN IN PLACE SHALL BE AS DIRECTED BY THE ENGINEER.

THIS WORK WILL NOT BE PAID FOR SEPARATELY, BUT SHALL BE CONSIDERED INCLUDED IN THE CONTRACT UNIT PRICE PER CUBIC YARD FOR EARTH EXCAVATION AND NO ADDITIONAL COMPENSATION WILL BE ALLOWED.

G. N. -250C
SEEDING, CLASS 7 AND MULCH, METHOD 2 IS INCLUDED IN THIS CONTRACT TO SEED NEW EARTH SHOULDERS DURING TIME PERIODS WHEN PERMANENT SEEDING IS NOT ALLOWED. SOME OR ALL OF THE CLASS 7 SEEDING AND MULCH WILL BE DELETED IF IT IS POSSIBLE TO PLACE PERMANENT SEEDING ON EARTH SHOULDERS AT THE TIME OF THEIR COMPLETION.

G. N. -406H
MIXTURE REQUIREMENTS
THE FOLLOWING MIXTURE REQUIREMENTS ARE APPLICABLE FOR THIS PROJECT:

LOCATION: I-74 BOWMAN RAMP
MIXTURE USE: BIT SHOULDER
AC/PC: PG 58-22
RAP % (MAX.): 30
DESIGN AIR VOIDS: 3.0 % @ Ndes = 30
MIX COMP (GRADATION): IL 9.5L
FRICTION AGGREGATE: MIX C

G. N. -482
ALL MATERIAL PLACED AS BITUMINOUS SHOULDERS SUPERPAVE SHALL BE COMPACTED TO 94.0-98.4 PERCENT OF THE MAXIMUM THEORETICAL DENSITY. THIS REQUIREMENT SHALL APPLY TO BOTH B.A.M. AND IL 9.5L GRADATION SHOULDER MIXES. THIS MAXIMUM DENSITY SHALL BE DETERMINED FROM THE MOVING AVERAGE OF FOUR TESTS AS IN OTHER QC/QA TESTING. A NUCLEAR GAUGE DENSITY/CORE CORRELATION SHALL BE PERFORMED FOR BOTH THE B.A.M. AND IL 9.5L MIXES USING STANDARD CORRELATION PROCEDURES.

F.A.I. RTE.	SECTION	COUNTY	TOTAL SHEETS	SHEET NO.
74	*	VERMILION	13	2

*92111,12,12-1RS-1,I

INDEX OF SHEETS

SHEET NO.	ITEM
1	COVER SHEET
2	GENERAL NOTES, INDEX OF SHEETS & STANDARDS IN THE PLANS
3	SUMMARY OF QUANTITIES
4	PROPOSED TYPICAL CROSS SECTIONS
5	SCHEDULE OF QUANTITIES
6	ROADWAY PLAN SHEET
7	TYPICAL APPLICATION OF PAVEMENT MARKINGS FOR INTERSTATE AND MULTI-LANE DIVIDED HIGHWAYS
8	SPECIAL DETAIL FOR RAMP WORK AREAS
9-13	CROSS SECTIONS

HIGHWAY STANDARDS IN THE PLANS

280001-02	TEMPORARY EROSION CONTROL SYSTEMS
482011-01	BIT. SHOULDER STRIPS/SHOULDERS WITH RESURFACING OR WIDENING AND RESURFACING PROJECTS
702001-05	TRAFFIC CONTROL DEVICES
000001-04	STANDARD SYMBOLS, ABBREVIATIONS, AND PATTERNS
001006	DECIMAL OF AN INCH AND OF A FOOT

STATE OF ILLINOIS
DEPARTMENT OF TRANSPORTATION
DISTRICT FIVE

REVIEWED BY: *O. L. Madwell*
DISTRICT ENGINEER OF PROGRAM DEVELOPMENT

DATE: 7/7/05

EXAMINED BY: *W. J. ...*
DISTRICT ENGINEER OF PROJECT IMPLEMENTATION

...
DISTRICT ENGINEER OF BUREAU OF OPERATIONS

F.A.I. RYE.	SECTION	COUNTY	TOTAL SHEETS	SHEET NO.
74	*	VERMILION	13	3

*9211,12,12-DRS-1,1

SUMMARY OF QUANTITIES

LOCATION OF WORK:

URBAN
 FAI 74
 EB EXIT RAMP
 90% FED.
 10% STATE

CONSTRUCTION TYPE CODE:

SFTY - 2A

CODE NO	ITEM	UNIT	TOTAL QUANTITY	
20200100	EARTH EXCAVATION	CU YD	5.0	5.0
20400800	FURNISHED EXCAVATION	CU YD	20.0	20.0
25000200	SEEDING CLASS 2	ACRE	0.1	0.1
25000350	SEEDING CLASS 7	ACRE	0.1	0.1
25000400	NITROGEN FERTILIZER NUTRIENT	POUND	9.0	9.0
25000500	PHOSPHORUS FERTILIZER NUTRIENT	POUND	9.0	9.0
25000600	POTASSIUM FERTILIZER NUTRIENT	POUND	9.0	9.0
25100115	MULCH METHOD 2	ACRE	0.1	0.1
28000400	PERIMETER EROSION BARRIER	FOOT	425.0	425.0
40600100	BITUMINOUS MATERIALS PRIME COAT	GAL	20.0	20.0
44001430	BITUMINOUS SHOULDER REMOVAL	SQ YD	197.0	197.0
48100100	AGGREGATE SHOULDERS, TYPE A	TON	15.0	15.0
48202110	BITUMINOUS SHOULDERS SUPERPAVE, 3 1/2 "	SQ YD	197.0	197.0
63500120	DELINEATOR REMOVAL	EACH	4.0	4.0
67100100	MOBILIZATION	L SUM	1.0	1.0
70103815	TRAFFIC CONTROL SURVEILLANCE	CAL DA	5.0	5.0
• 78003110	PREFORMED PLASTIC PAVEMENT MARKING TAPE TYPE B - LINE 4"	FOOT	400.0	400.0
• 20029650	HIGH TENSION CABLE MEDIAN BARRIER SYSTEM	FOOT	371.5	371.5
•	SPECIALITY ITEM			

F.A.I. RTE.	SECTION	COUNTY	TOTAL SHEETS	SHEET NO.
74	.	VERMILION	13	4

*92(11,12,12-1)RS-1.I

AS-BUILT TYPICAL RAMP CROSS SECTION BOWMAN AVENUE INTERCHANGE

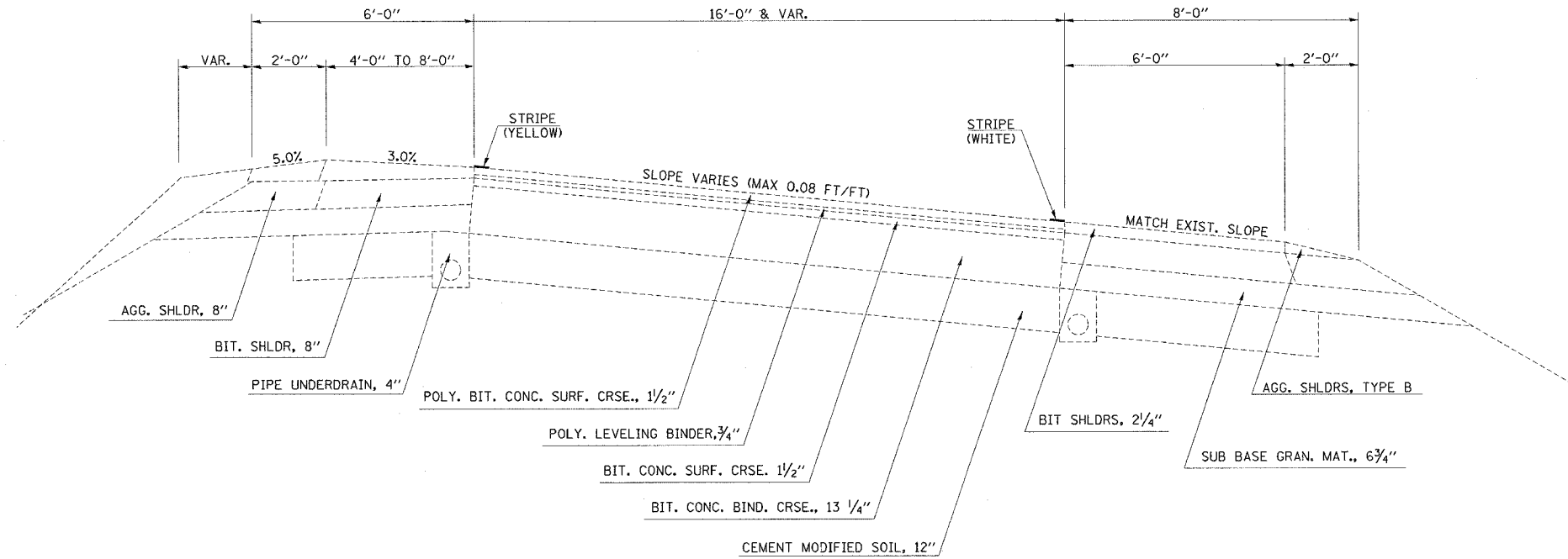

PROPOSED TYPICAL RAMP CROSS SECTION BOWMAN AVENUE INTERCHANGE

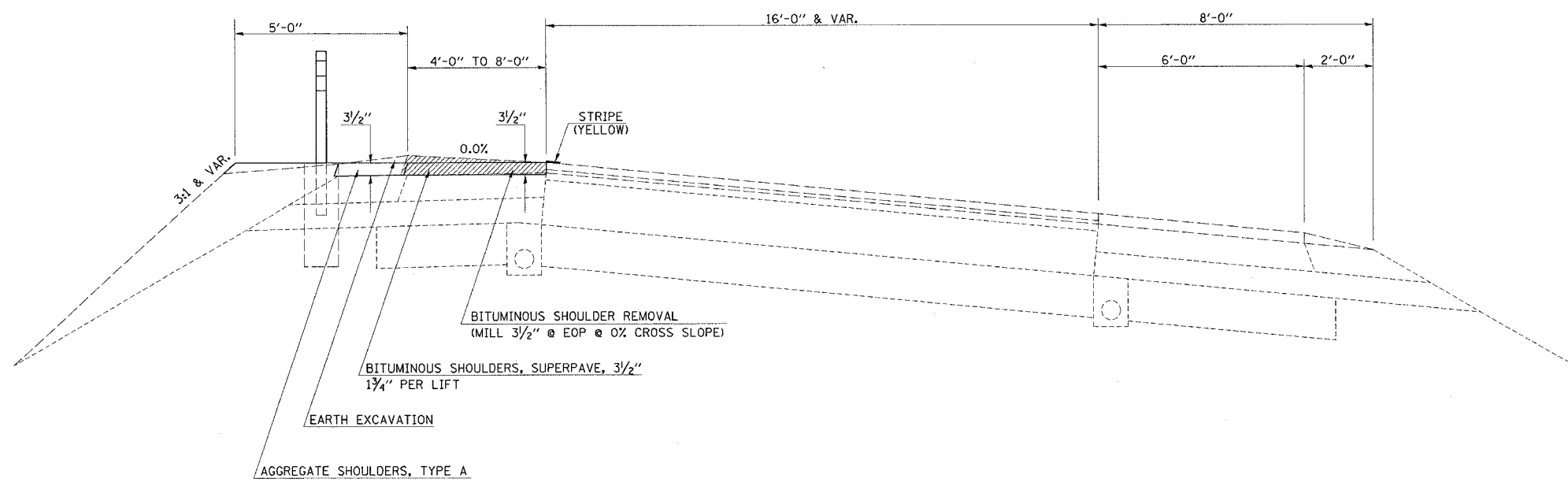

SCHEDULE OF QUANTITIES

F.A.I. RTE.	SECTION	COUNTY	TOTAL SHEETS	SHEET NO.
74	*	VERMILTON	13	5

*92(11,12,12-1)RS-1,1

PREF PL PM TAPE TB LINE 4

<u>LOCATION</u>	<u>FOOT</u>
LT. STA. 11+00 - 15+00	400

LOCATION	EARTH EXCAVATION CU YD	EARTH EXC ADJ FOR SHRINKAGE	EMBANKMENT CU YD	BALANCE (-) FILL CU YD (2)
STA. 11+00 TO 15+00	3.0	2.3	22.0	-19.75
TOTAL	5.0		25.0	20.0

NOTES:

- 1- NO SHRINKAGE FACTOR APPLIED TO THE EMBANKMENT QUANTITY
- 2- A 25% EXPANSION FACTOR WAS USED IN COMPUTING BORROW QUANTITY

5 CUYDS EARTH EXCAVATION
25 CUYDS FURNISHED EXCAVATION

BITUMINOUS SHOULDER SUPERPAVE 3 1/2"

<u>LOCATION</u>	<u>SQ. YD.</u>
LT. 11+39.66 - LT. 14+63.79	197.0

ITEM	QUANTITY	UNIT
SEEDING CLASS 2	0.1	ACRE
SEEDING CLASS 7	0.1	ACRE
NITROGEN FERTILIZER NUTRIENT	9.0	POUND
PHOSPHOROUS FERTILIZER NUTRIENT	9.0	POUND
POTASSIUM FERTILIZER NUTRIENT	9.0	POUND
MULCH METHOD 2	0.1	ACRE

SEEDING, FERTILIZER, AND MULCH METHOD QUANTITIES WERE
CALCULATED FROM LOCATIONS OFF OF THE CROSS SECTIONS.

BITUMINOUS SHOULDER REMOVAL

<u>LOCATION</u>	<u>SQ. YD.</u>
LT. 11+39.66 - LT. 14+63.79	197.0

AGGREGATE SHOULDERS, TYPE A

<u>LOCATION</u>	<u>TON</u>
LT. 11+39.66 - LT. 14+63.79	15.0

F.A.I. RTE.	SECTION	COUNTY	TOTAL SHEETS	SHEET NO.
74		VERMILION	13	6

92(11.12.12-1)RS-1J

I-74 EB EXIT RAMP



BEGIN HIGH TENSION CABLE
MEDIAN BARRIER SYSTEM
(EXPERIMENTAL BRIFEN)
STATION 11+06, 27.8' LEFT

HIGH TENSION CABLE MEDIAN BARRIER SYSTEM
(EXPERIMENTAL BRIFEN)
371.5 FEET, POST SPACING AT 5.25' INTERVALS

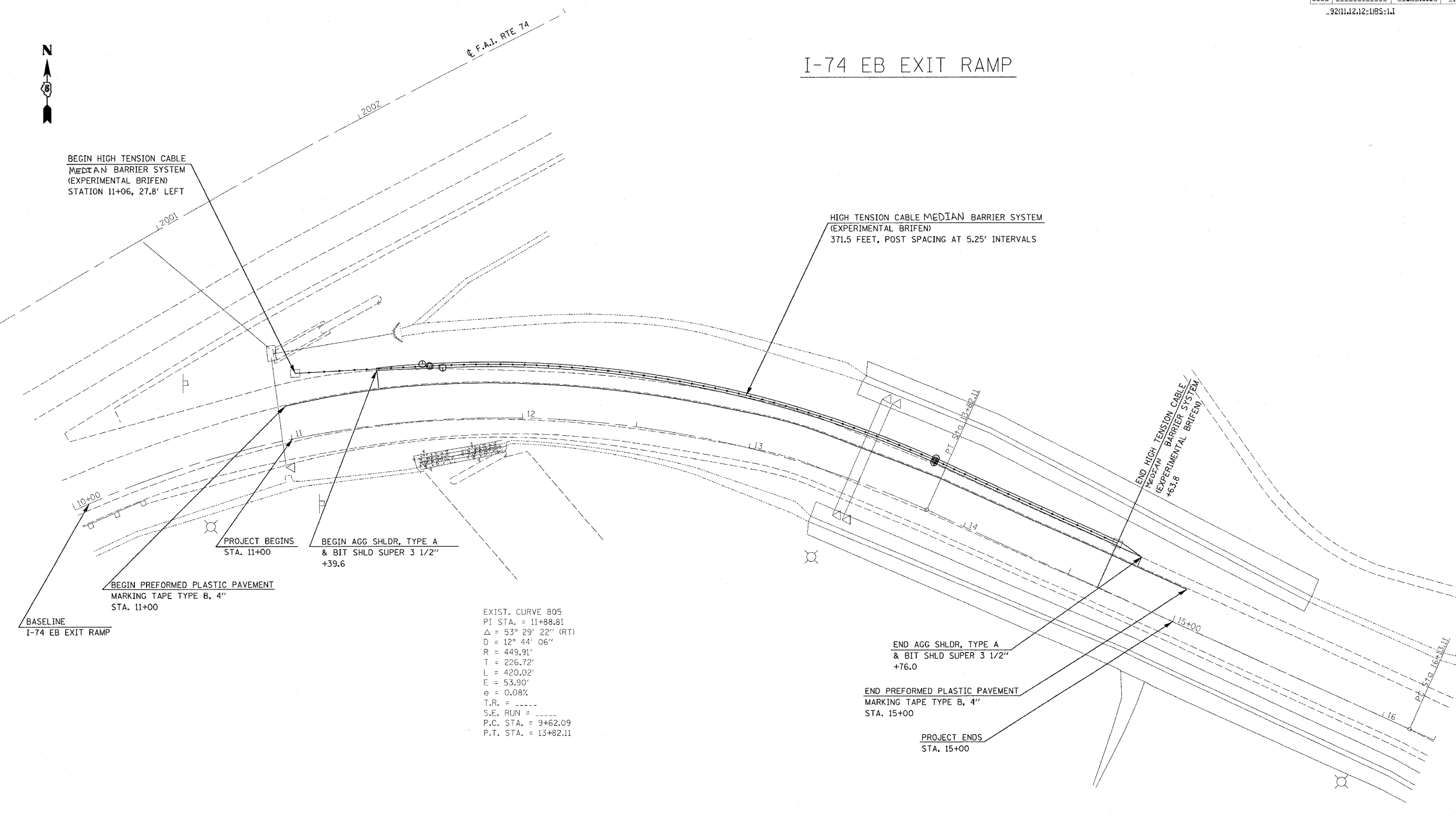

PROJECT BEGINS
STA. 11+00

BEGIN AGG SHLDR, TYPE A
& BIT SHLD SUPER 3 1/2"
+39.6

BEGIN PREFORMED PLASTIC PAVEMENT
MARKING TAPE TYPE B, 4"
STA. 11+00

BASELINE
I-74 EB EXIT RAMP

EXIST. CURVE 805
PI STA. = 11+88.81
Δ = 53° 29' 22" (RT)
D = 12° 44' 06"
R = 449.91'
T = 226.72'
L = 420.02'
E = 53.90'
e = 0.08%
T.R. = ---
S.E. RUN = ---
P.C. STA. = 9+62.09
P.T. STA. = 13+62.11

END AGG SHLDR, TYPE A
& BIT SHLD SUPER 3 1/2"
+76.0

END PREFORMED PLASTIC PAVEMENT
MARKING TAPE TYPE B, 4"
STA. 15+00

PROJECT ENDS
STA. 15+00

PLOT DATE = 04/15/14
FILE NAME = 041514
PLOT SCALE = AS SHOWN
USER NAME = JLSB

F.A.I. RTE.	SECTION	COUNTY	TOTAL SHEETS	SHEET NO.
74		VERMILION	13	7

*92(11,12,12-1)RS-1.1

TYPICAL APPLICATION OF PAVEMENT MARKINGS FOR INTERSTATE AND MULTI-LANE DIVIDED HIGHWAYS

TYPICAL ENTRANCE RAMP TERMINAL

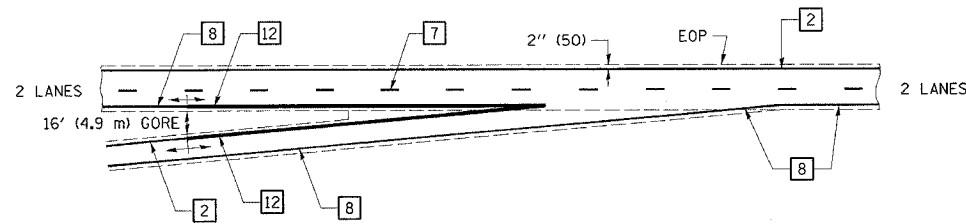

TYPICAL EXIT RAMP TERMINAL

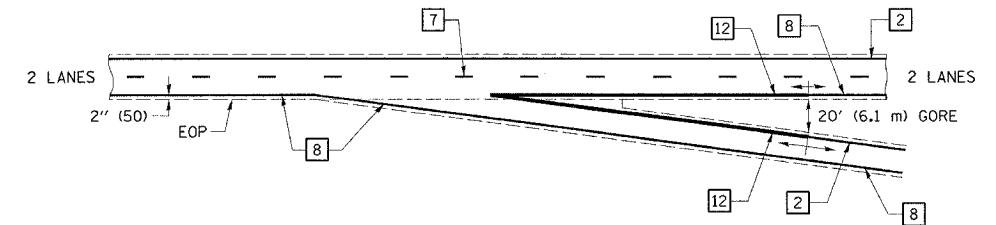

CENTERLINE INTERSTATE OR MULTI-LANE TWO WAY DIVIDED HIGHWAY

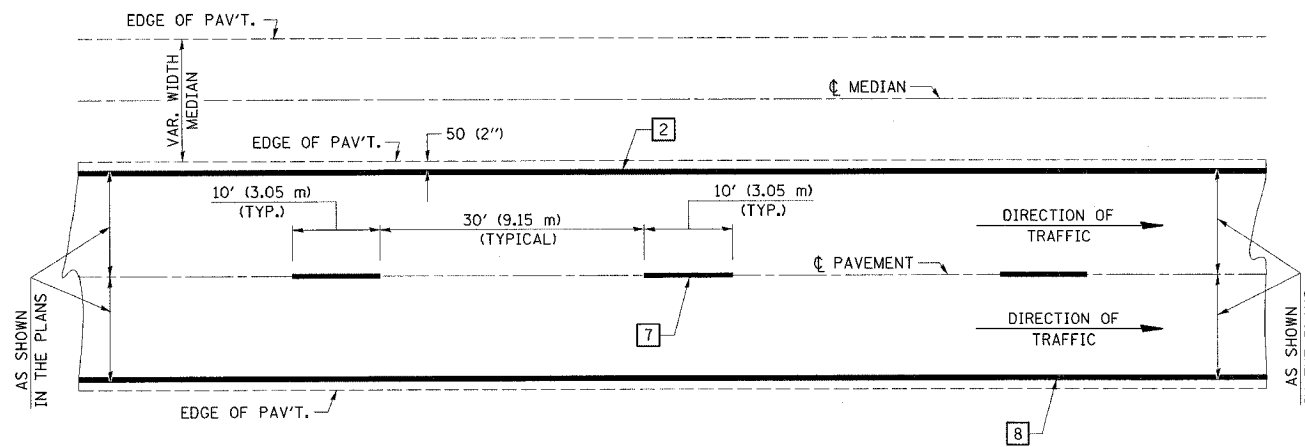

NOTE: PAVEMENT MARKINGS ARE TO BE EXTENDED THROUGH OMISSIONS WHEN APPLICABLE.

NOTE: SEE ARTICLES 780.04 & 781.03 FOR LOCATION OF STRIPES AND MARKERS RELATIVE TO EDGES OR JOINTS.

FOR RAISED REFLECTIVE PAVEMENT MARKERS, REFER TO STANDARD 781001.

TYPICAL PAVEMENT MARKING LEGEND

- 1 4" (100) SKIP-DASH (YELLOW)
- 2 4" (100) SOLID (YELLOW)
- 3 12" (300) DIAGONAL (YELLOW)
- 4 4" (100) DOUBLE YELLOW (NARROW)
- 5 4" (100) DOUBLE YELLOW (WIDE)
- 6 RESERVED
- 7 4" (100) SKIP-DASH (WHITE)
- 8 4" (100) SOLID (WHITE)
- 9 12" (300) DIAGONAL (WHITE)
- 10 6" (150) CROSS WALK (WHITE)
- 11 24" (600) STOP BAR (WHITE)
- 12 8" (200) SOLID (WHITE)
- 13 4" (100) LANE LINE EXTENSIONS (WHITE)
- 14 RESERVED

ENTRANCE RAMP TERMINAL with EXCLUSIVE LANE

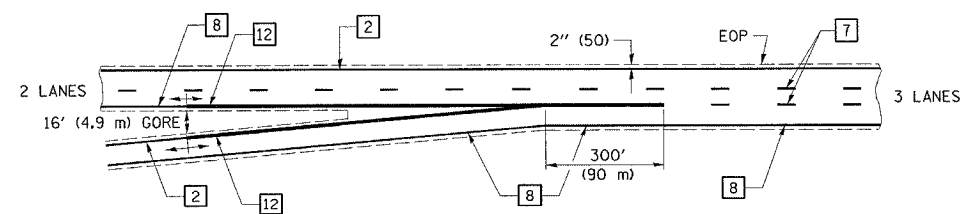

EXIT RAMP TERMINAL with EXCLUSIVE (auxiliary) LANE

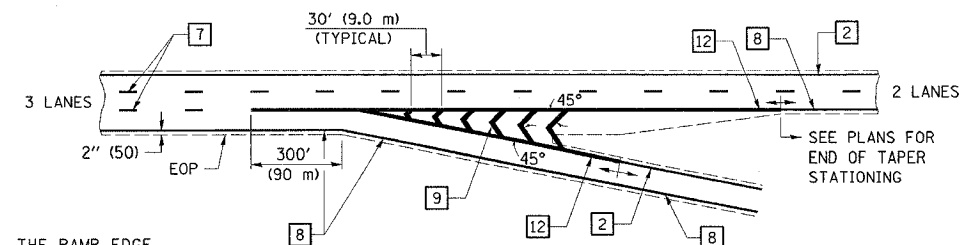

WHEN RAMPS ARE SURFACED, THE RAMP EDGE LINES SHALL BE AS SHOWN IN THE PLANS.

	NAME	DATE	REVISIONS	
DESIGNED	P.E.E.	03/89	NAME	DATE
CHECKED	C.T.D.	04/89	D.L.P.	08/97
CADD NO.	F-5,22		K.A.G.	08/04

ALL DIMENSIONS ARE IN INCHES (MILLIMETERS) UNLESS OTHERWISE SHOWN.

F.A.I. RTE.	SECTION	COUNTY	TOTAL SHEETS	SHEET NO.
74	*	VERMILION	13	8

*92(11.12.12-URS-1.I

SPECIAL DETAIL FOR RAMP WORK AREAS

TYPICAL APPLICATION OF TRAFFIC CONTROL DEVICES

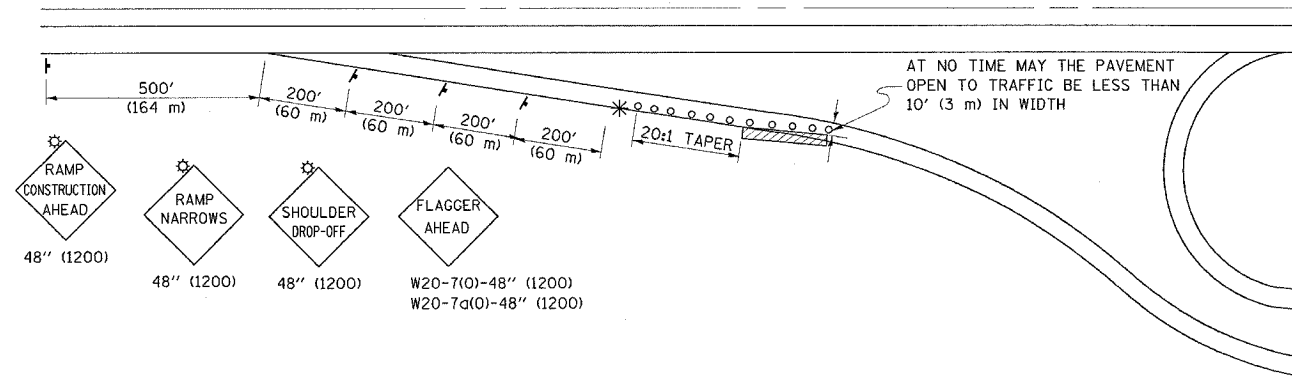

SYMBOLS

- ◊ TYPE I OR II BARRICADES OR DRUMS @ 50' (15 m) CTS.
- * FLAGGER PLACED AS DIRECTED BY THE ENGINEER DURING DAYTIME CONSTRUCTION
- † SIGN ON PORTABLE OR PERMANENT SUPPORT
- ▨ WORK AREA
- ◊ FLASHING LIGHT

GENERAL NOTES

1. CONSTRUCTION OPERATIONS SHALL BE CONFINED TO AN AREA NARROW ENOUGH THAT A MINIMUM OF 10' (3 m) OF PAVEMENT SHALL BE OPEN TO TRAFFIC AT ALL TIMES.
2. CONES MAY BE SUBSTITUTED FOR BARRICADES DURING DAY OPERATIONS, AT 25' (7.5 m) SPACING.
3. FLASHING LIGHTS REQUIRED ON SIGNS IF DROP-OFF EXISTS DURING NON-WORKING HOURS.
4. WHEN NO WORK IS BEING PERFORMED, THE FLAGGER WILL NOT BE REQUIRED. IF THE FLAGGER IS NOT PRESENT, THE FLAGGER SIGNS SHALL BE REMOVED OR COVERED.
5. ALL SIGNS SHALL BE POST MOUNTED IF WORK IN THE AREA EXCEEDS FOUR DAYS OF DAYTIME OPERATIONS.
6. LONGITUDINAL DIMENSIONS MAY BE ADJUSTED SLIGHTLY TO FIT FIELD CONDITIONS.
7. ALL VEHICLES, EQUIPMENT, WORKERS (EXCEPT FLAGGER) AND THEIR ACTIVITIES ARE RESTRICTED AT ALL TIMES TO ONE SIDE OF THE PAVEMENT UNLESS OTHERWISE AUTHORIZED BY THE DISTRICT ENGINEER.
8. TYPE I OR II BARRICADES, VERTICAL BARRICADES, OR DRUMS WITH LIGHTS REQUIRED TO MARK HAZARD DROP-OFF.

REVISIONS

D.L.P.	NAME	DATE
3-95		08/00
F-5.01	K.A.G.	01/05

ALL DIMENSIONS ARE IN INCHES (MILLIMETERS) UNLESS OTHERWISE SHOWN.

F.A.I. RTE.	SECTION	COUNTY	TOTAL SHEETS	SHEET NO.
74	92011212-085-14	VERMILION	13	9
STA. 11+00.00 TO STA. 11+50.00				
FED. ROAD DIST. NO. ILLINOIS FED. AID PROJECT				

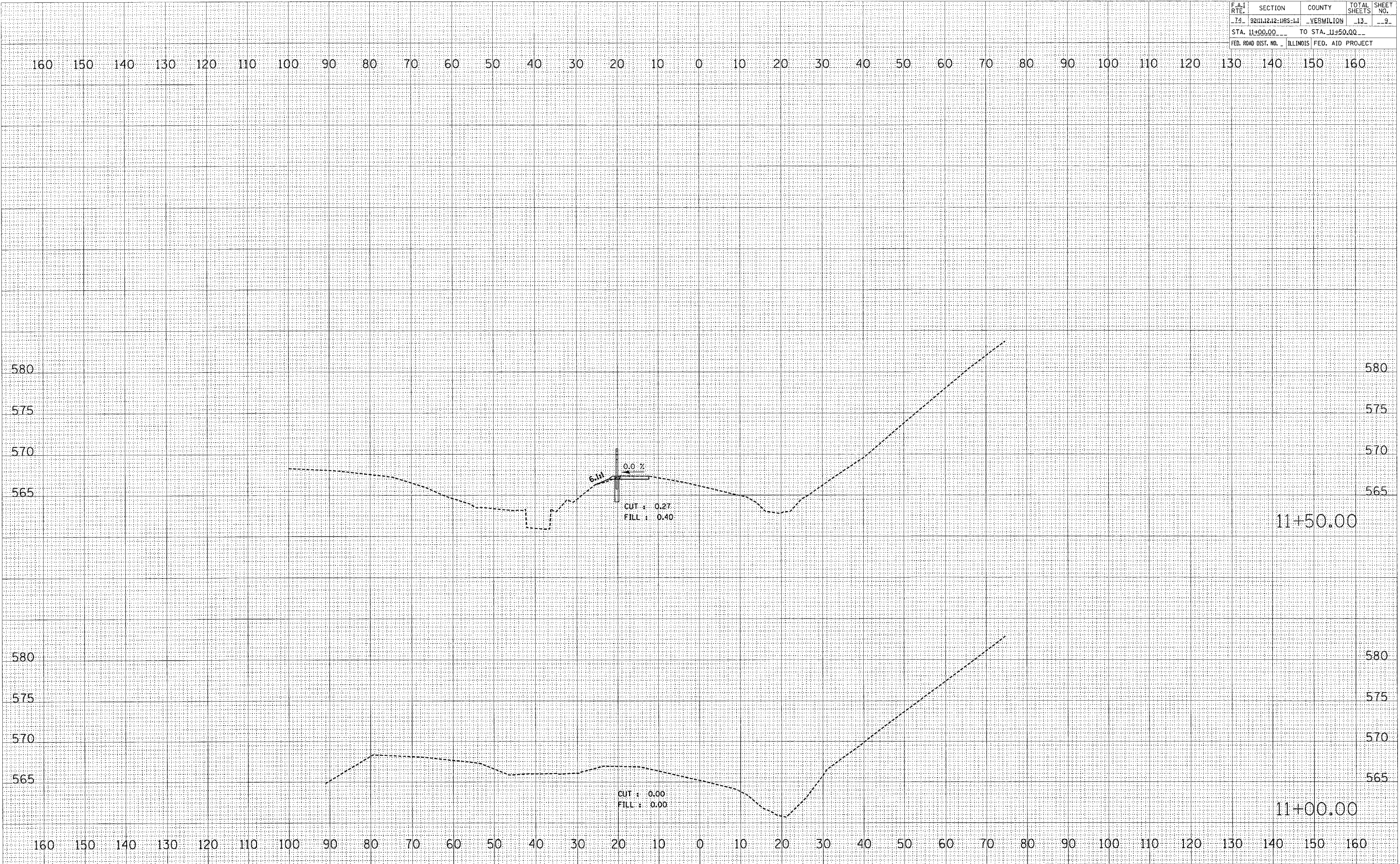

DATE: _____ BY: _____

FINAL SURVEY: _____

NOTE BOOK NO.: _____

AREAS CHECKED: _____

DATE: _____ BY: _____

ORIGINAL SURVEY: _____

NOTE BOOK NO.: _____

AREAS CHECKED: _____

PLOT DATE * DATE

FILE NAME * FILE

PLOT SCALE * SCALE

USER NAME * USER

F.A.I. RTE.	SECTION	COUNTY	TOTAL SHEETS	SHEET NO.
74	220J12-185-L1	VERMILION	13	10
STA. 12+00.00		TO STA. 12+50.00		
FED. ROAD DIST. NO.		ILLINOIS FED. AID PROJECT		

BY _____ DATE _____

FINAL SURVEY _____

NOTE BOOK _____

AREAS CHECKED _____

BY _____ DATE _____

ORIGINAL SURVEY _____

NOTE BOOK _____

AREAS CHECKED _____

PLOT DATE = \$DATE\$
 FILE NAME = \$FILES\$
 PLOT SCALE = \$SCALE\$
 USER NAME = \$USER\$

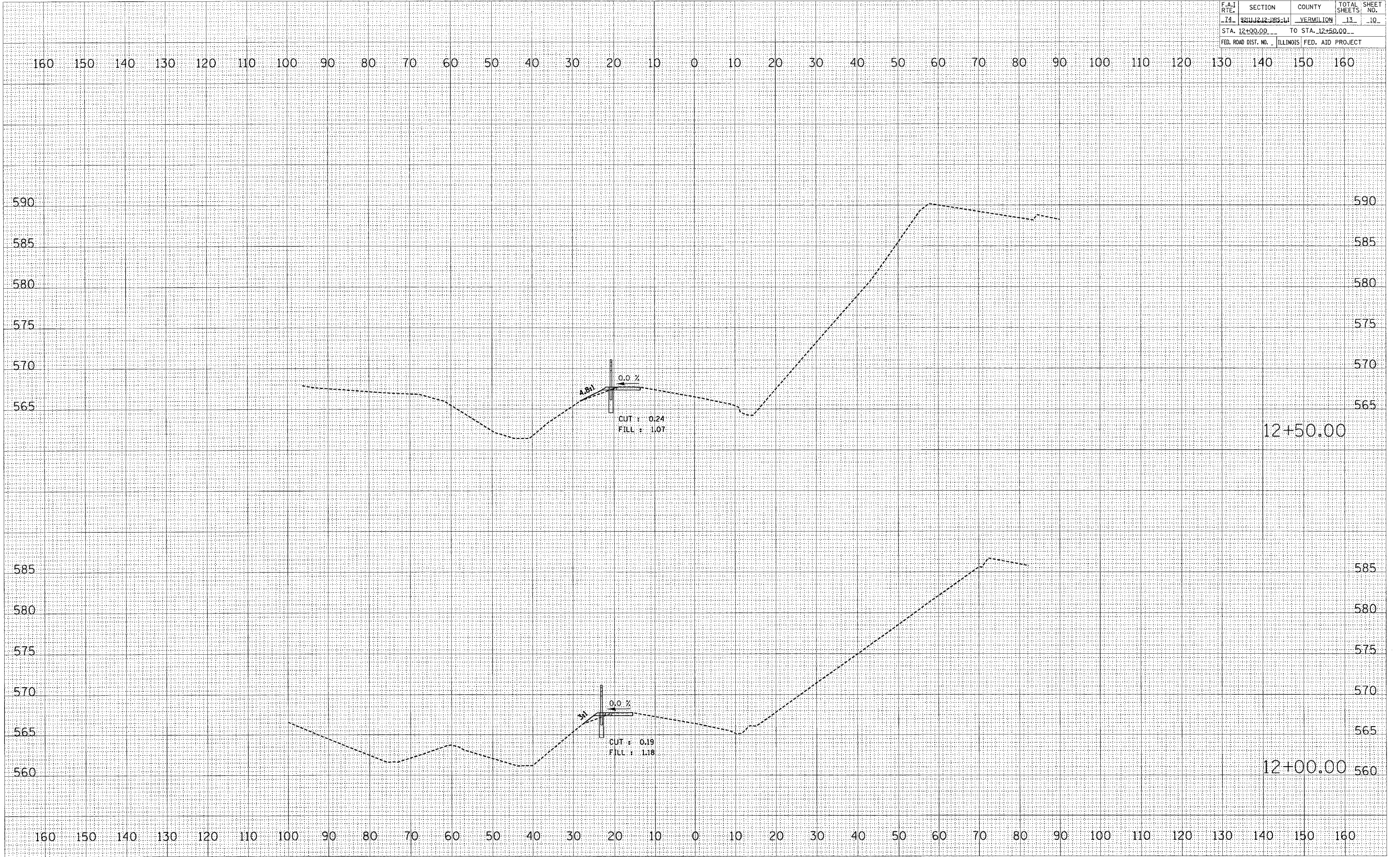

F.A.I. RTE.	SECTION	COUNTY	TOTAL SHEETS	SHEET NO.
74	2200J22-JB5-L1	VERMILION	13	11
STA. 13+00.00		TO STA. 13+50.00		
FED. ROAD DIST. NO. ILLINOIS FED. AID PROJECT				

FINAL SURVEY	DATE
NOTE BOOK	BY
AREAS CHECKED	

ORIGINAL SURVEY	DATE
NOTE BOOK	BY
AREAS CHECKED	

PLOT DATE = 08/25/04
FILE NAME = 041111
PLOT SCALE = 1"=40'
USER NAME = MUSER

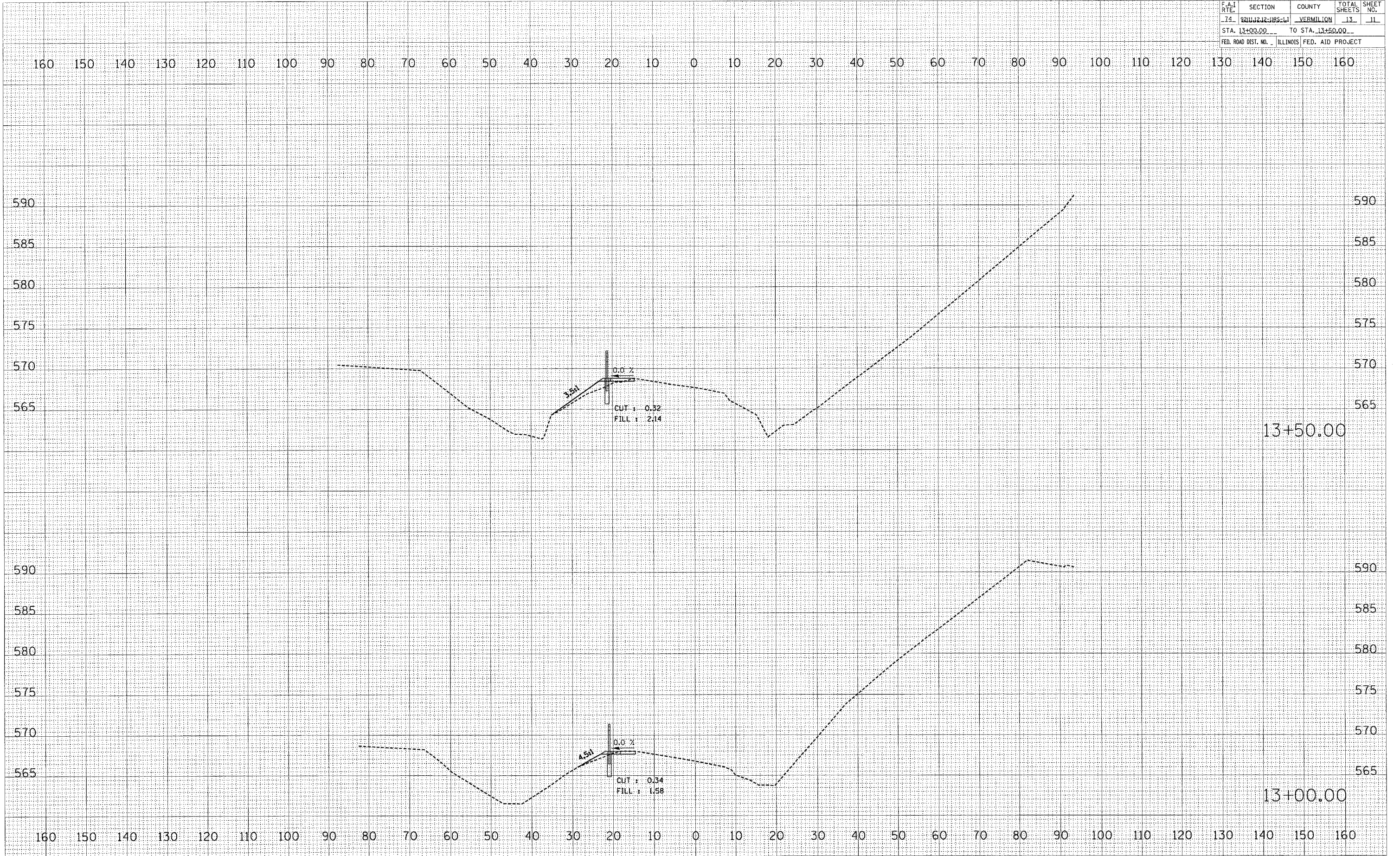

F.A.I. RTE.	SECTION	COUNTY	TOTAL SHEETS	SHEET NO.
74	2200242-JRS-L1	VERMILION	13	12
STA. 14+00.00		TO STA. 14+50.00		
FED. ROAD DIST. NO. ILLINOIS FED. AID PROJECT				

FINAL SURVEY BY DATE
 SURVEYED BY
 CHECKED BY
 TEMPLATE NO.
 NOTE BOOK NO.
 AREAS CHECKED

ORIGINAL SURVEY BY DATE
 SURVEYED BY
 CHECKED BY
 TEMPLATE NO.
 NOTE BOOK NO.
 AREAS CHECKED

PLOT DATE * DDTEA
 FILE NAME * \$FILEA
 PLOT SCALE * \$SCALEA
 USER NAME * \$USERA

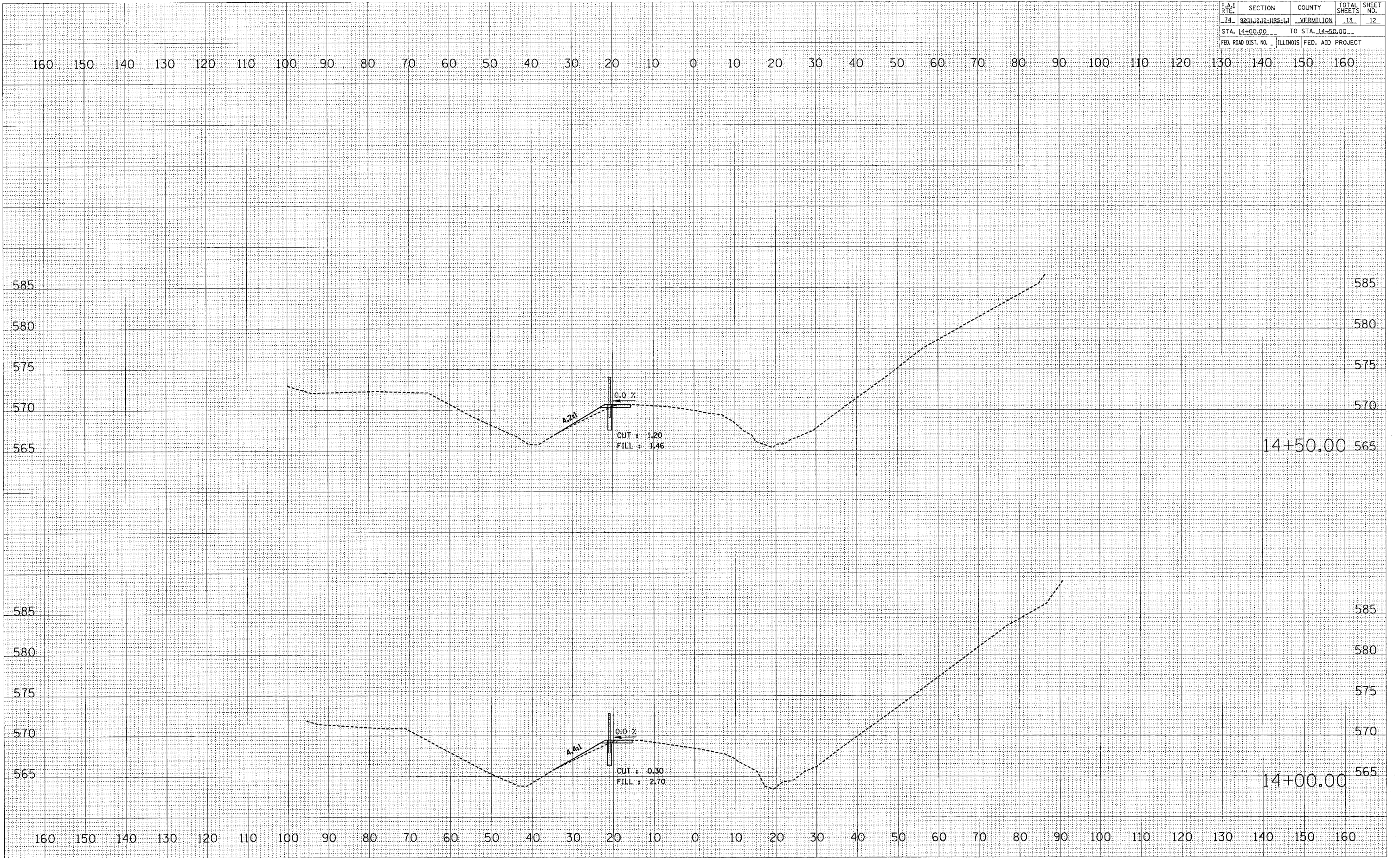

F.A.I. RTE.	SECTION	COUNTY	TOTAL SHEETS	SHEET NO.
74	3211J22-185-11	VERMILION	13	13
STA. 15+00.00		TO STA. 15+00.00		
FED. ROAD DIST. NO.		ILLINOIS FED. AID PROJECT		

FINAL SURVEY	DATE
NOTE BOOK	BY
NO.	
APPROVED	
SCHEMATIC	
TEMPLATE	
AREAS	
CHECKED	

ORIGINAL SURVEY	DATE
NOTE BOOK	BY
NO.	
APPROVED	
SCHEMATIC	
TEMPLATE	
AREAS	
CHECKED	

PLOT DATE = *****
FILE NAME = *****
PLOT SCALE = *****
USER NAME = *****

