

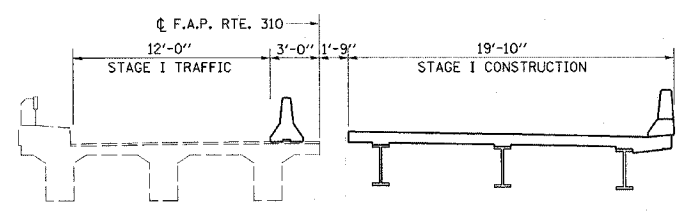

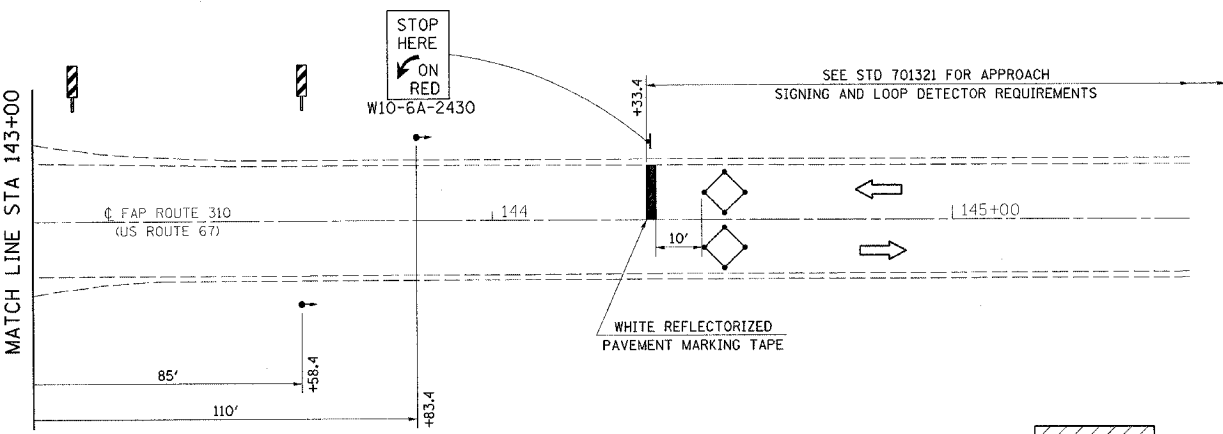

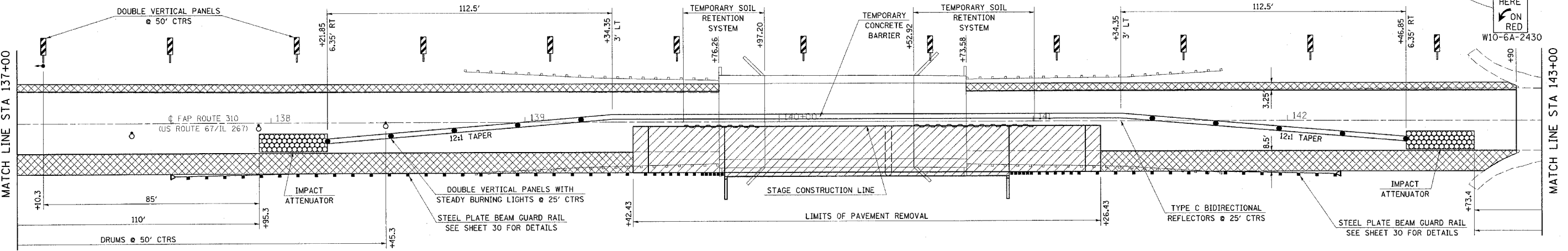

F.A.P. RTE.	SECTION	COUNTY	TOTAL SHEETS	SHEET NO.
310	81B-1	MORGAN	114	18
STA.		TO STA.		
CONTRACT NO. 72528				

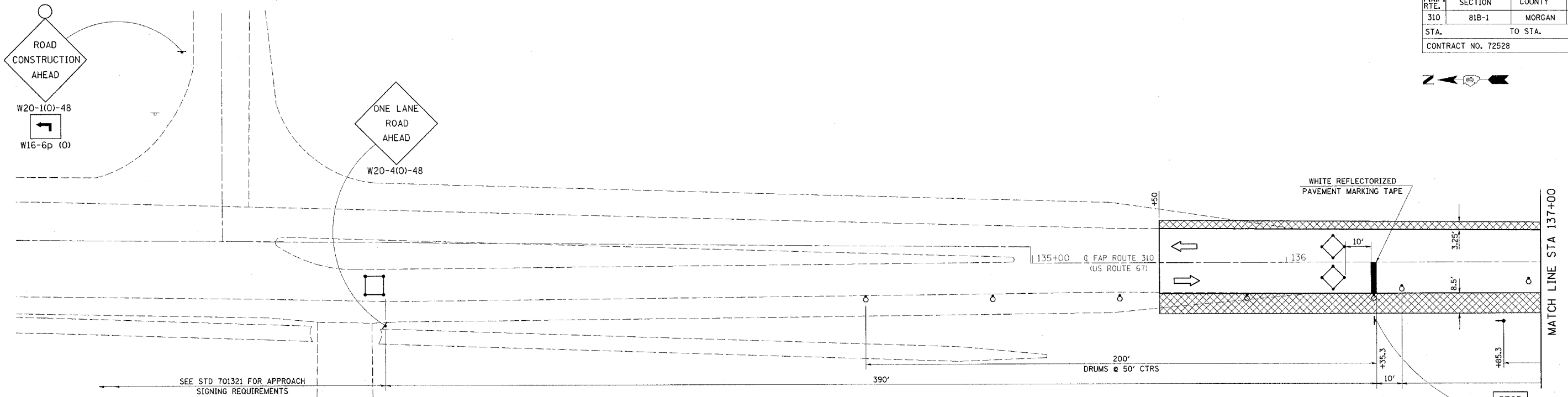
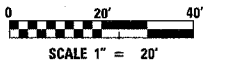

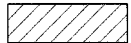
TYPICAL SECTION
STAGE I CONSTRUCTION

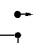
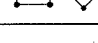
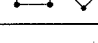
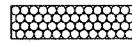

LEGEND

-  WORK AREA
-  BITUMINOUS BASE COURSE SUPERPAVE 8" TO BE COMPLETED BEFORE STAGE I
-  SIGN
-  DRUM WITH STEADY BURNING LIGHT
-  TRAFFIC SIGNAL
-  INDUCTION LOOP DETECTOR
-  IMPACT ATTENUATOR
-  DOUBLE VERTICAL PANELS
-  TYPE C BIDIRECTIONAL REFLECTOR
-  STEADY BURNING LIGHTS AND DOUBLE VERTICAL PANELS

REVISIONS	
NAME	DATE

ILLINOIS DEPARTMENT OF TRANSPORTATION
**TRAFFIC CONTROL AND PROTECTION,
 STAGE I, SANDY CREEK**
 FAP ROUTE 310 (US 67/IL 267)
 SECTION 81B-1
 MORGAN COUNTY

DATE 3-04

DRAWN BY RCB
 CHECKED BY JWS