

| F.A.P. RTE.        | SECTION | COUNTY          | TOTAL SHEETS | SHEET NO. |
|--------------------|---------|-----------------|--------------|-----------|
| 310                | 81B-1   | MORGAN          | 114          | 21        |
| STA. 1003+00       |         | TO STA. 1009+00 |              |           |
| CONTRACT NO. 72528 |         |                 |              |           |

EXISTING CURVE 300  
 PI STA 1006+62.18  
 $\Delta = 4^\circ 20' 25''$  (RT)  
 $D = 0^\circ 17' 58''$   
 $T = 725.35'$   
 $R = 19,141.10'$   
 $L = 1,450.00'$   
 $E = 13.75'$   
 PC STA 999+36.84  
 PT STA 1013+86.84

**SECTION 81B-1  
 LOCATION 1  
 ENDS  
 STATION 1014+00.00**

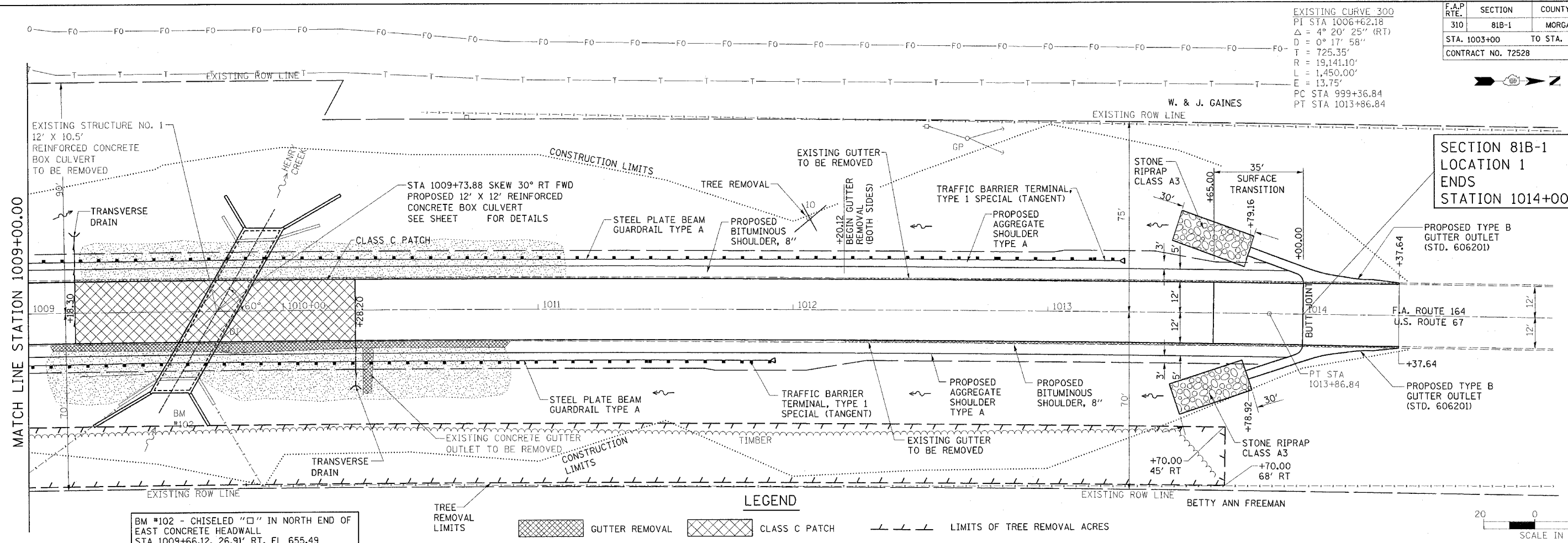

BM #102 - CHISELED "□" IN NORTH END OF EAST CONCRETE HEADWALL  
 STA 1009+66.12, 26.91' RT. EL. 655.49

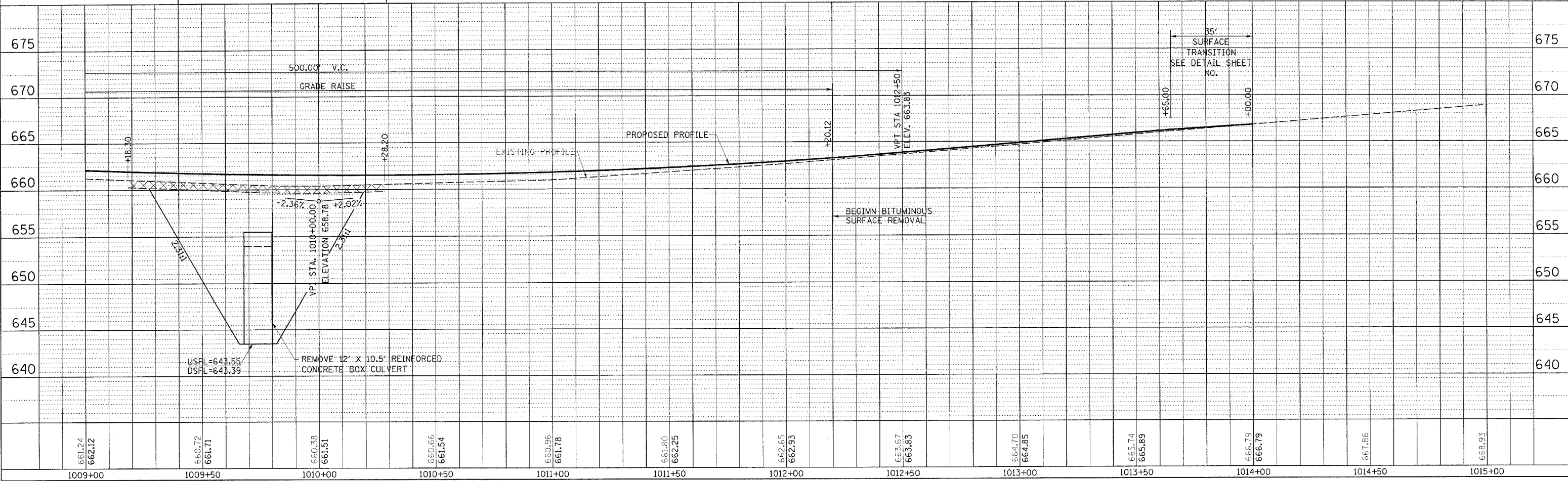

PLAN AND PROFILE, US 67/IL 267 LOCATION 1, STA 1009+00 TO STA 1014+00

DATE: \_\_\_\_\_  
 BY: \_\_\_\_\_  
 CHECKED: \_\_\_\_\_  
 NO. \_\_\_\_\_  
 NOTE: BACKGROUND MAY BE CHECKED  
 ADD FILE NAME

DATE: \_\_\_\_\_  
 BY: \_\_\_\_\_  
 CHECKED: \_\_\_\_\_  
 NO. \_\_\_\_\_  
 NOTE: BACKGROUND MAY BE CHECKED  
 STRUCTURE NOTATIONS CHECKED

\*DCN-SPEC\*  
 \*DATE-TIME\* \$TIME\$ \*USER\*