

F.A. RTE.	SECTION	COUNTY	TOTAL SHEETS	SHEET NO.
310	81B-1	MORGAN	114	37
STA. 220+00.00 TO STA. 1158+50.00				
CONTRACT NO. 72528				

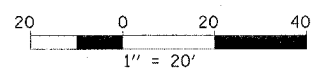
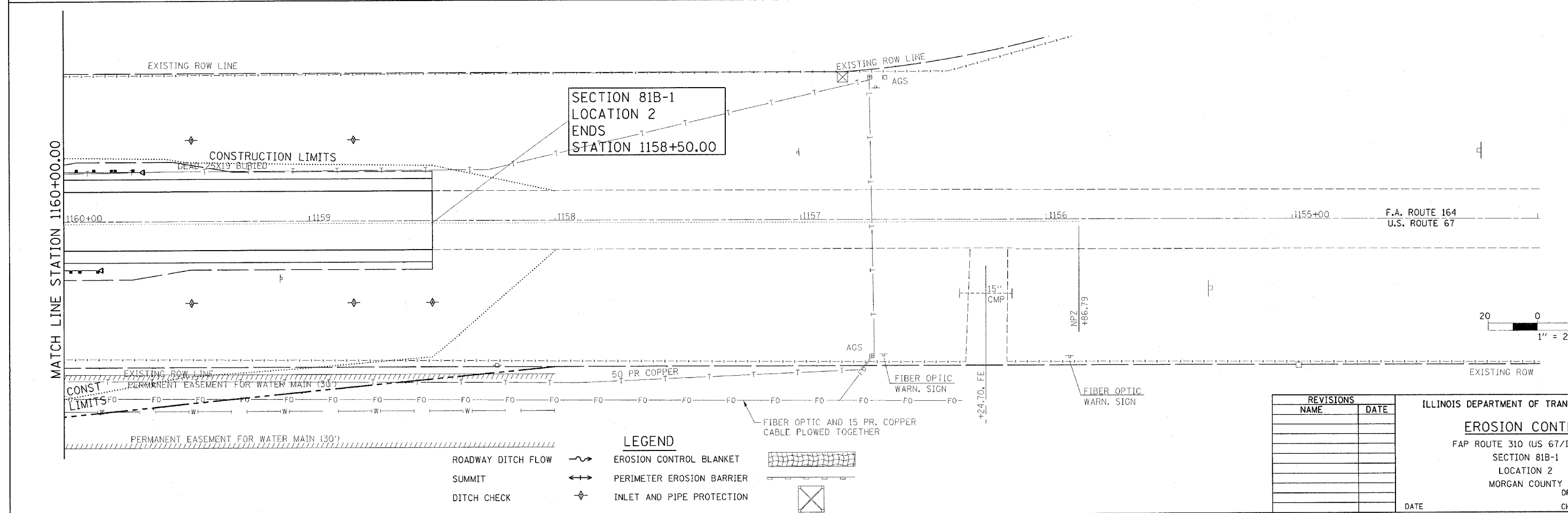
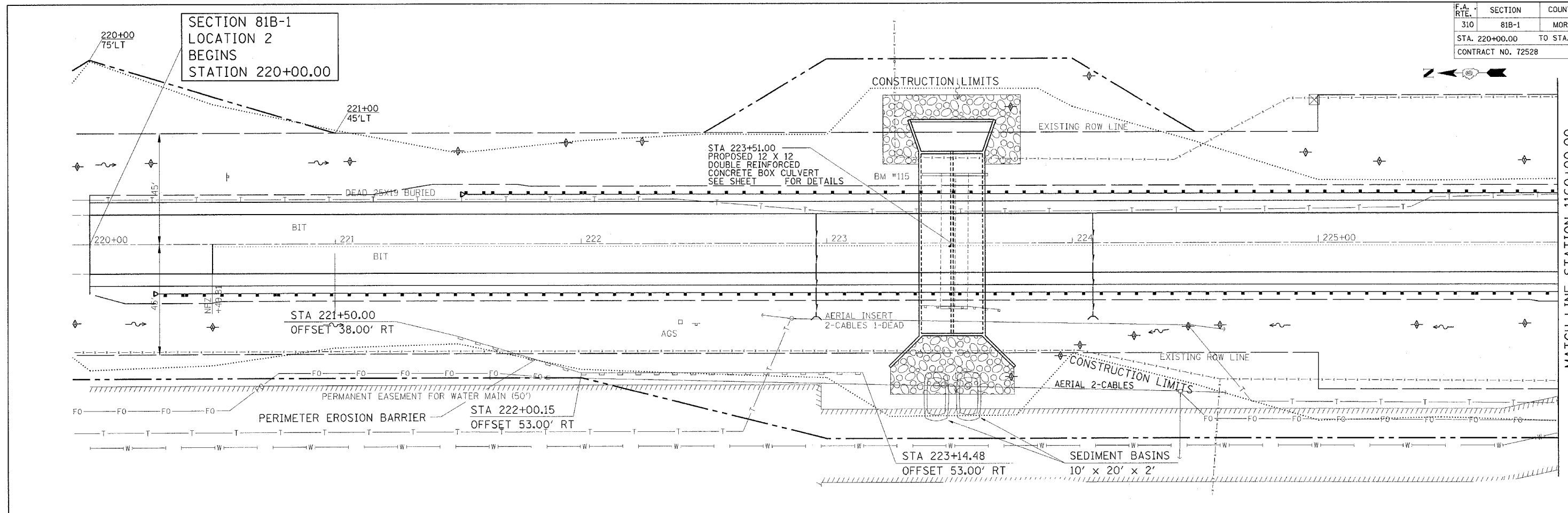

SECTION 81B-1
LOCATION 2
ENDS
STATION 1158+50.00

LEGEND

- ROADWAY DITCH FLOW
- SUMMIT
- DITCH CHECK
- EROSION CONTROL BLANKET
- PERIMETER EROSION BARRIER
- INLET AND PIPE PROTECTION

REVISIONS	
NAME	DATE

ILLINOIS DEPARTMENT OF TRANSPORTATION
EROSION CONTROL
FAP ROUTE 310 (US 67/IL 267)
SECTION 81B-1
LOCATION 2
MORGAN COUNTY
DRAWN BY BANDY
CHECKED BY STEUART
DATE

DGN-SPEC
DATE-TIME \$TIME\$ *USER*