

F.A.P. RTE.	SECTION	COUNTY	TOTAL SHEETS	SHEET NO.
310	81B-1	MORGAN	114	83
STA. 219+00.00 TO STA. 219+50.00			CONTRACT NO. 72528	

EAST SIDE

WEST SIDE

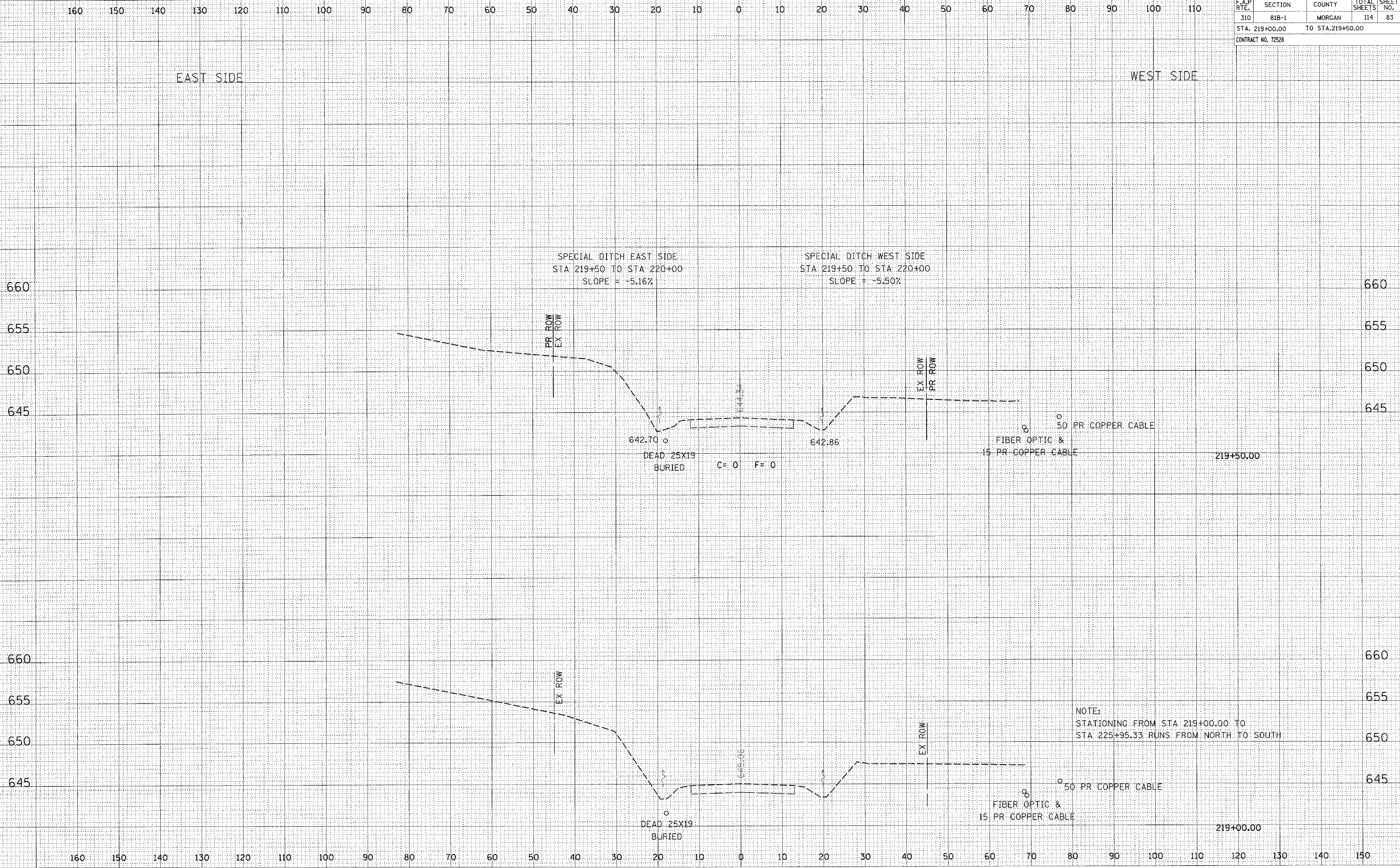

SPECIAL DITCH EAST SIDE  
STA 219+50 TO STA 220+00  
SLOPE = -5.16%

SPECIAL DITCH WEST SIDE  
STA 219+50 TO STA 220+00  
SLOPE = -5.50%

642.70  
DEAD 25X19  
BURIED

642.86

C= 0 F= 0

FIBER OPTIC &  
15 PR COPPER CABLE

50 PR COPPER CABLE

219+50.00

NOTE:  
STATIONING FROM STA 219+00.00 TO  
STA 225+95.33 RUNS FROM NORTH TO SOUTH

DEAD 25X19  
BURIED

FIBER OPTIC &  
15 PR COPPER CABLE

50 PR COPPER CABLE

219+00.00

CROSS SECTION, BRUSHY CREEK, US 67 LOCATION 2, STA 219+00.00 TO STA 219+50.00