

F.A.P. RTE.	SECTION	COUNTY	TOTAL SHEETS	SHEET NO.
310	818-1	MORGAN	114	87
STA. 223+00.00		TO STA. 223+50.00		
CONTRACT NO. 12528				

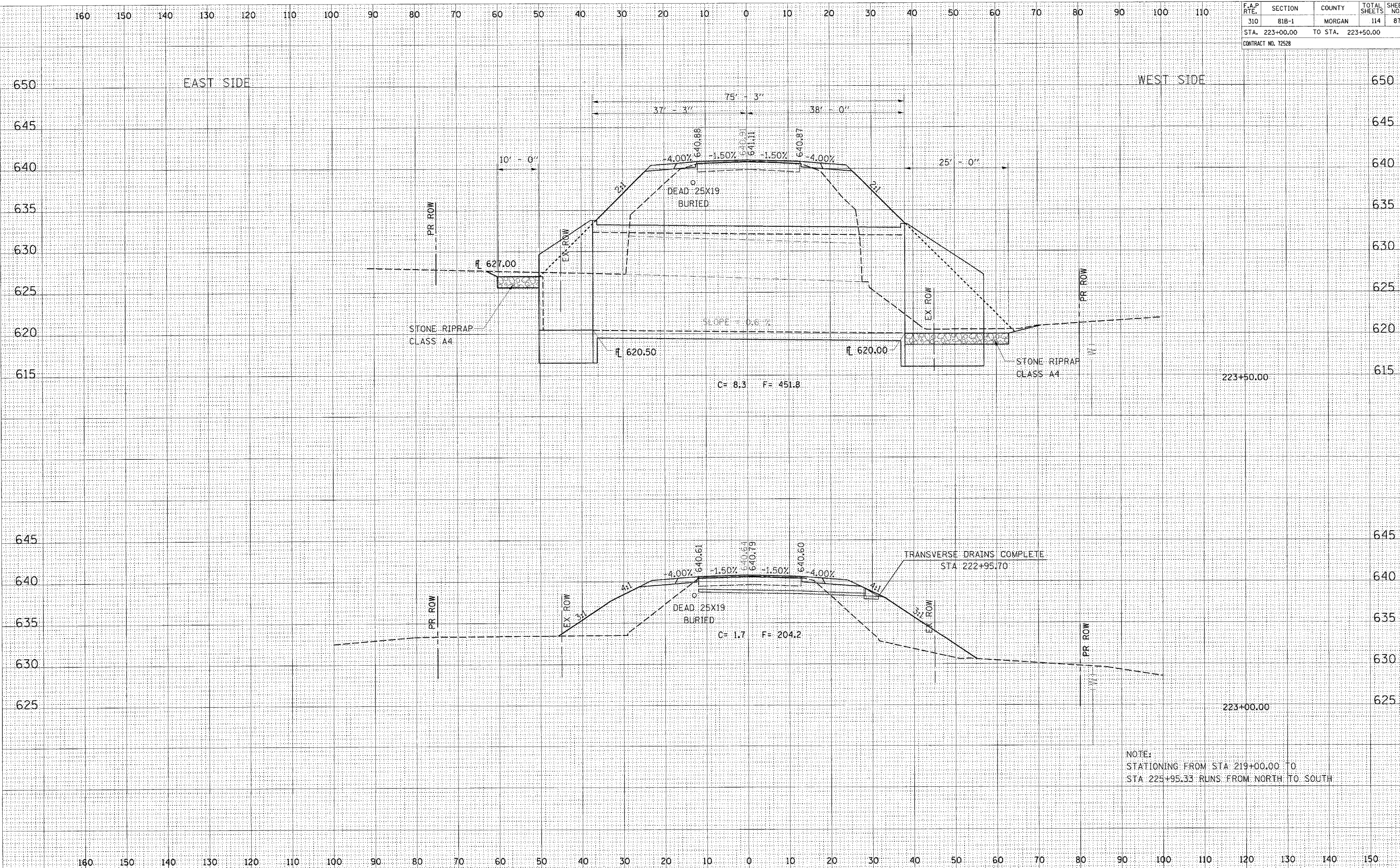

NOTE:  
STATIONING FROM STA 219+00.00 TO  
STA 225+95.33 RUNS FROM NORTH TO SOUTH

CROSS SECTION, BRUSHY CREEK, US 67 LOCATION 2, STA 223+00.00 TO STA 223+50.00

BY	DATE
BY	DATE

FINAL SURVEY	SURVEYED
NOTE BOOK	NOTED
AREAS CHECKED	AREAS CHECKED
NO.	NO.

ORIGINAL SURVEY	SURVEYED
NOTE BOOK	NOTED
AREAS CHECKED	AREAS CHECKED
NO.	NO.