

F.A.P. RTE.	SECTION	COUNTY	TOTAL SHEETS	SHEET NO.
562	117(B-4)	SCOTT	39	12
STA.	TO STA.			
FED. ROAD DIST. NO.	ILLINOIS	FED. AID PROJECT		
STATE CONTRACT NO. 72818				

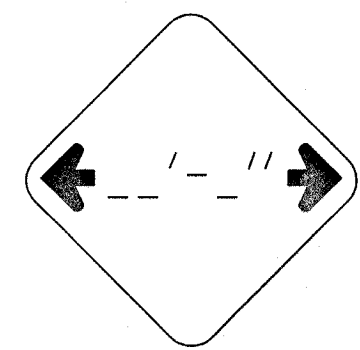

W12-2(O)-48
SIGN A

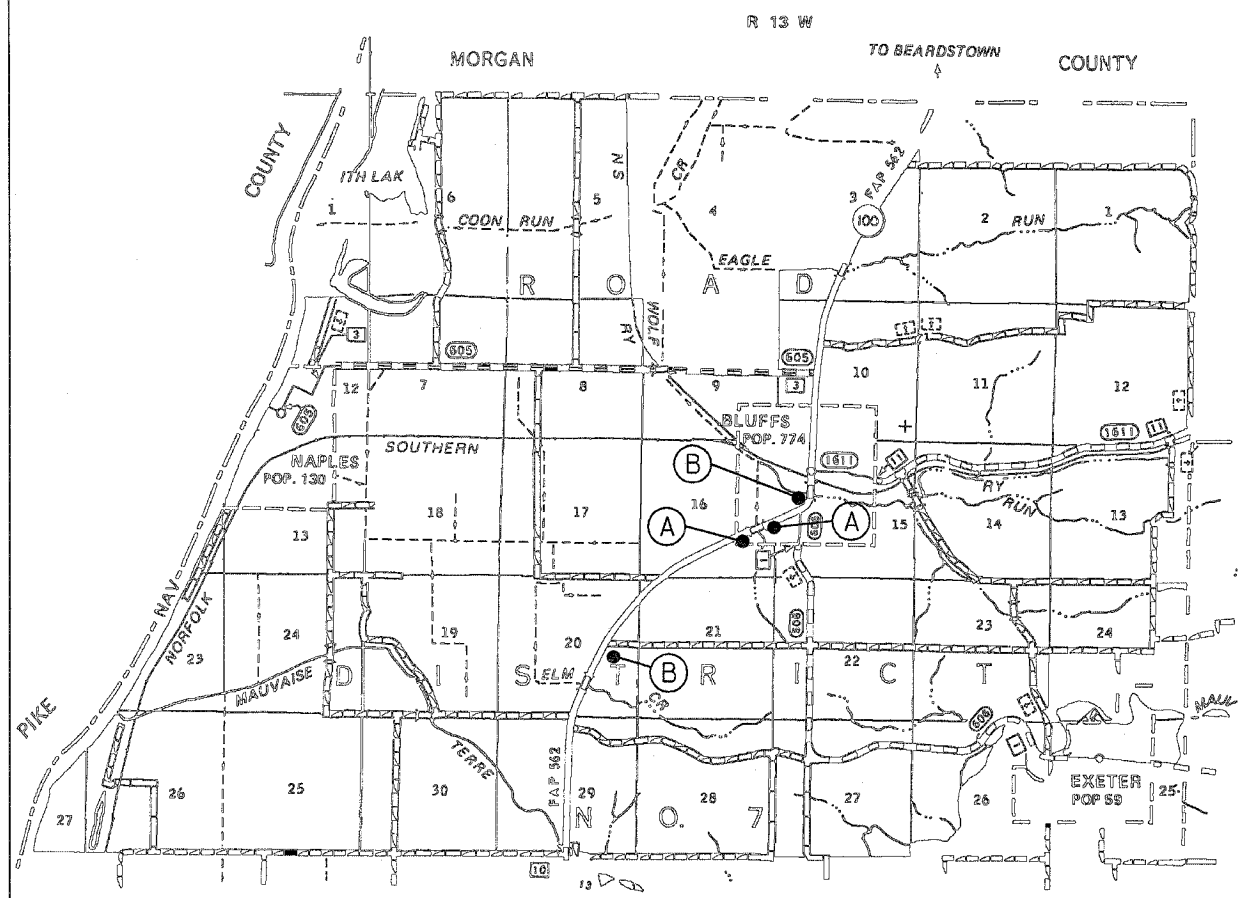
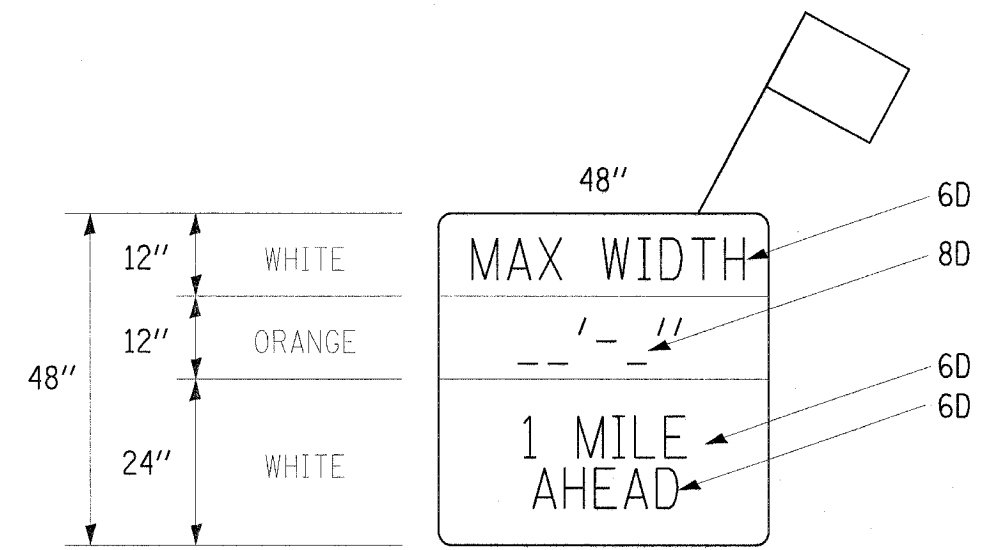

SIGN PANEL, TYPE II
SIGN B

SIGN A - 2 SIGNS - (W12-2(O)-48) ARE TO BE PLACED AT EACH END OF THE PROJECT JUST BEFORE SIGNING FOR TC&P STANDARD 702321 SIGNING.

SIGN B - (SIGN PANEL, TYPE II AS SHOWN) ARE TO BE PLACED AT THE JUNCTION OF IL 100 SB AND PEARL ST. AND AT THE JUNCTION OF IL 100 NB AND BANGERT RD. ONE AT EACH LOCATION.

THESE SIGNS SHALL BE INSTALLED WITH FLAGS
WILL BE PAID FOR AS PER LUMP SUM

REVISIONS	
NAME	DATE

ILLINOIS DEPARTMENT OF TRANSPORTATION
WIDTH RESTRICTION SIGNAGE
F.A.P. 310 (US 67)
MORGAN COUNTY
SCALE: VERT. NONE
HORIZ. NONE
DATE 04/07/05
DRAWN BY AJP
CHECKED BY SRD

Plot Date: 4/27/2005
Plot Time: 2:02:44 PM
Pen: Table
File Name: s:\0402\1100\cod\1\signs\trac\1100\plans\12_max_width_1100.dgn