

| | | | | |
|--|---------|---------------------------|--------------|-----------|
| F.A. RTE. | SECTION | COUNTY | TOTAL SHEETS | SHEET NO. |
| | | SCHUYLER | 139 | 3 |
| STA. | | TO STA. | | |
| FED. ROAD DIST. NO. | | ILLINOIS FED. AID PROJECT | | |
| * OTHER ROUTE 1 (WEINBERG KING STATE PARK) ** WEIN KING ST PK INT ROADS NO. 2 | | | | |

| TOTAL LENGTH OF IMPROVEMENTS | | | | |
|------------------------------|-----------|-----------|------------|--|
| BASE LINE | STA. | TO STA. | LENGTH | |
| RV CAMPGROUND ROAD | 90+70.00 | 131+05.49 | 4,035.49' | |
| HUNTER PARKING AREA NO. 1 | 0+00.00 | 2+69.01 | 269.01' | |
| HUNTER ACCESS ROAD | 500+04.60 | 570+09.08 | 7,004.48' | |
| | | TOTAL = | 11,308.98' | |

DISTRICT SIX

EXAMINED Aug 8 2005
Sam J. Adams
 OPERATIONS ENGINEER

EXAMINED Aug 15 2005
W.B. Frey
 PROGRAM IMPLEMENTATION ENGINEER

EXAMINED AUGUST 26 2005
William E. Mote
 PROGRAM DEVELOPMENT ENGINEER

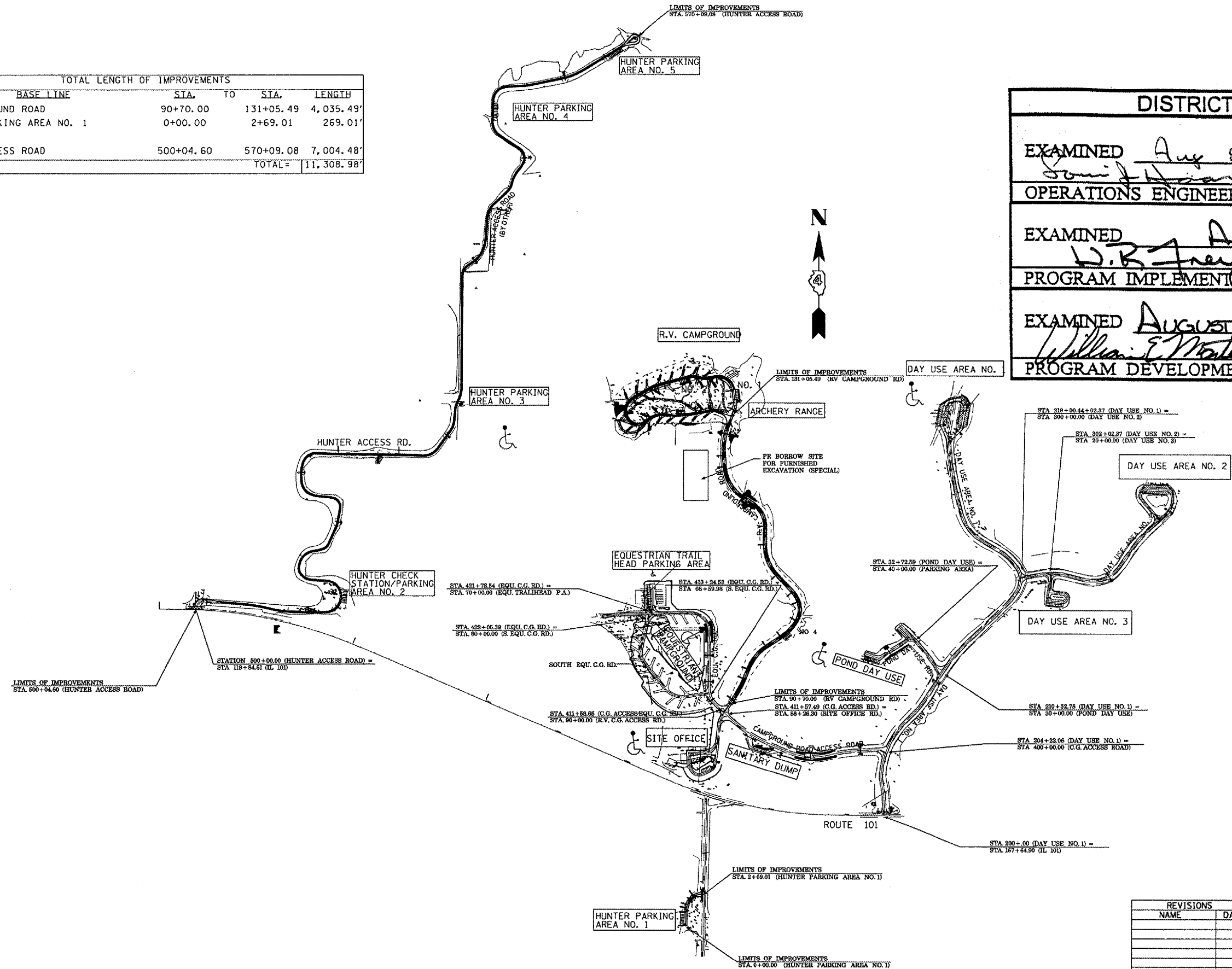

PLOT DATE = 07/24/2005
 PLOT NAME = ED50902/COVERSHEET.DGN
 PLOT SCALE = 60/2534' / IN.
 REFERENCE = REF#9

| REVISIONS | |
|-----------|------|
| NAME | DATE |
| | |
| | |
| | |
| | |
| | |
| | |
| | |
| | |
| | |
| | |

ILLINOIS DEPARTMENT OF TRANSPORTATION
 DETAILED LOCATION MAP
 WEINBERG KING STATE PARK

SCALE: VERT. _____
 HORIZ. _____
 DATE _____

DRAWN BY BDK
 CHECKED BY JCN