

F.A. RTE.	SECTION	COUNTY	TOTAL SHEETS	SHEET NO.
*	**	SCHUYLER	139	21
STA.		TO STA.		
FED. ROAD DIST. NO.		ILLINOIS	FED. AID PROJECT	
* OTHER ROUTE 1 (WEINBERG KING STATE PARK)				
** WEIN KING ST PK INT RDS 2				

PAVEMENT MARKING LEGEND

- ① PREFORMED PLASTIC PAVEMENT MARKING - LINE 5" (YELLOW)
- ② PREFORMED PLASTIC PAVEMENT MARKING - LINE 8" (YELLOW) @ 5' CTS.
- ③ PREFORMED PLASTIC PAVEMENT MARKING - LINE 24" (WHITE)
- ④ PREFORMED PLASTIC PAVEMENT MARKING - LETTERS & SYMBOLS (WHITE)

NOTE : NO PROPOSED EDGE LINE STRIPING, EXCEPT AS CALLED OUT.

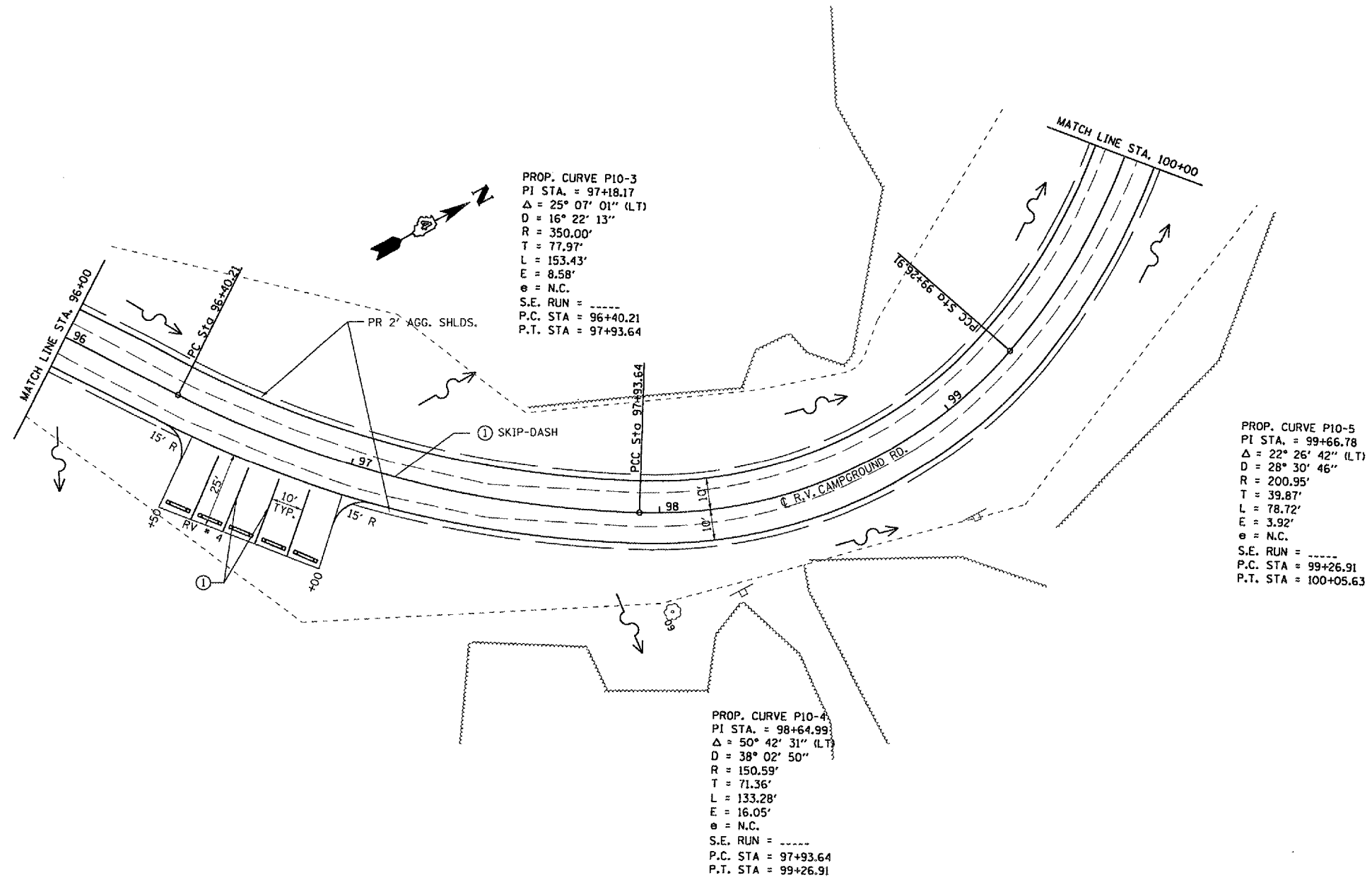

PLOT DATE = 9/24/2005
 PLOT SCALE = 43.375' / IN.
 USER NAME = kemdb

REVISIONS	
NAME	DATE

ILLINOIS DEPARTMENT OF TRANSPORTATION

PLAN VIEW

WEINBERG KING STATE PARK

SCALE: VERT. _____
 HORIZ. _____

DATE _____ DRAWN BY BOK
 CHECKED BY JCN