

F.A. RTE.	SECTION	COUNTY	TOTAL SHEETS	SHEET NO.
*	**	SCHUYLER	139	61
STA.		TO STA.		
FED. ROAD DIST. NO.		ILLINOIS	FED. AID PROJECT	
* OTHER ROUTE 1 (WEINBERG KING STATE PARK)				
** WEIN KING ST PK INT RDS 2				

**PAVEMENT MARKING LEGEND**

- ① PREFORMED PLASTIC PAVEMENT MARKING - LINE 5" (YELLOW)
- ② PREFORMED PLASTIC PAVEMENT MARKING - LINE 8" (YELLOW) @ 5' CTS.
- ③ PREFORMED PLASTIC PAVEMENT MARKING - LINE 24" (WHITE)
- ④ PREFORMED PLASTIC PAVEMENT MARKING - LETTERS & SYMBOLS (WHITE)

NOTE : NO PROPOSED EDGE LINE STRIPING, EXCEPT AS CALLED OUT.

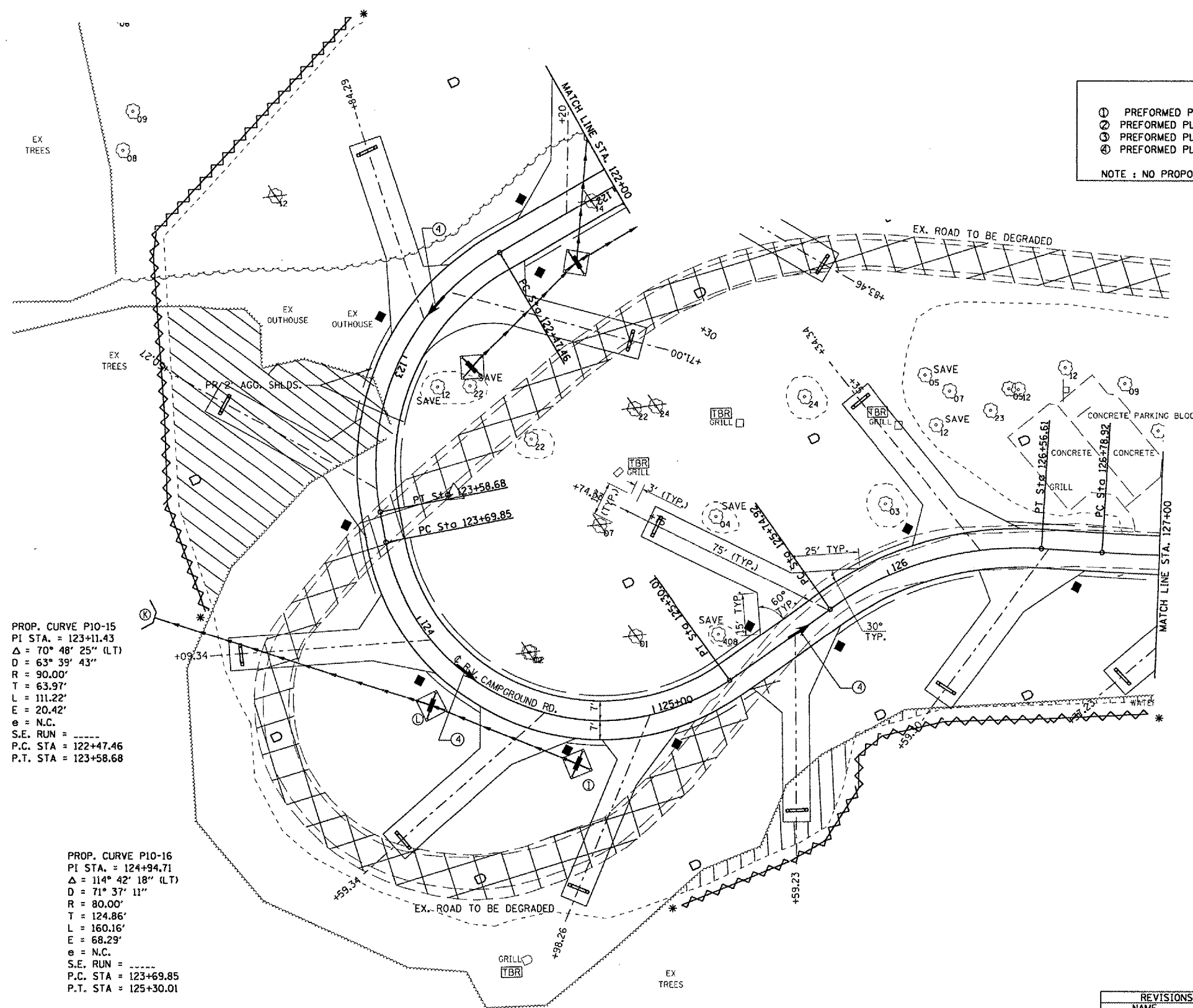

PROP. CURVE P10-15  
 PI STA. = 123+11.43  
 $\Delta = 70^\circ 48' 25''$  (LT)  
 $D = 63^\circ 39' 43''$   
 $R = 90.00'$   
 $T = 63.97'$   
 $L = 111.22'$   
 $E = 20.42'$   
 $e = \text{N.C.}$   
 S.E. RUN = -----  
 P.C. STA = 122+47.46  
 P.T. STA = 123+58.68

PROP. CURVE P10-16  
 PI STA. = 124+94.71  
 $\Delta = 114^\circ 42' 18''$  (LT)  
 $D = 71^\circ 37' 11''$   
 $R = 80.00'$   
 $T = 124.86'$   
 $L = 160.16'$   
 $E = 68.29'$   
 $e = \text{N.C.}$   
 S.E. RUN = -----  
 P.C. STA = 123+69.85  
 P.T. STA = 125+30.01

- 1-PR CONC. HDWL. FOR PIPE DRAIN
- ① 88.0' RT STA 123+75.00 DSFL = 591.55
- 4-PR INLET, T-A W/T-8G (STD 602301 & 604036)
- ② 17.0' LT STA 122+50.00 TOG=591.00 INV.=589.58 (16'')
- ③ 17.0' LT STA 122+90.00 TOG=591.40 INV.=589.98 (16'')
- ④ 24.0' RT STA 124+75.00 TOG=598.10 INV.=596.68 (16'')
- ⑤ 17.0' RT STA 124+25.00 TOG=596.70 INV.=595.28 (16'')
- PR PIPE DRAIN 8" x 233.0 FEET
- ⑥ - ⑦ = 65.0 FEET @ +0.62%
- ⑧ - ⑨ = 58.0 FEET @ -2.41%
- ⑩ - ⑪ = 110.0 FEET @ -3.39%



PLOT DATE = 8/24/2005  
 FILE NAME = \\s:\projects\72996\contract 2\dwg\pl\_rvcampground.dgn  
 PLOT SCALE = 43.3735' / IN.  
 USER NAME = kmvtd

REVISIONS	
NAME	DATE

ILLINOIS DEPARTMENT OF TRANSPORTATION

**SWPPP**

WEINBERG KING STATE PARK

SCALE: VERT. \_\_\_\_\_  
 HORIZ. \_\_\_\_\_

DATE \_\_\_\_\_ DRAWN BY BOK  
 CHECKED BY JCN