

F.A. RTE.	SECTION	COUNTY	TOTAL SHEETS	SHEET NO.
*	**	SCHUYLER	139	62

STA. TO STA.  
 FED. ROAD DIST. NO. ILLINOIS FED. AID PROJECT

- \* OTHER ROUTE 1 (WEINBERG KING STATE PARK)
- \*\* WEIN KING ST PK INT RDS 2

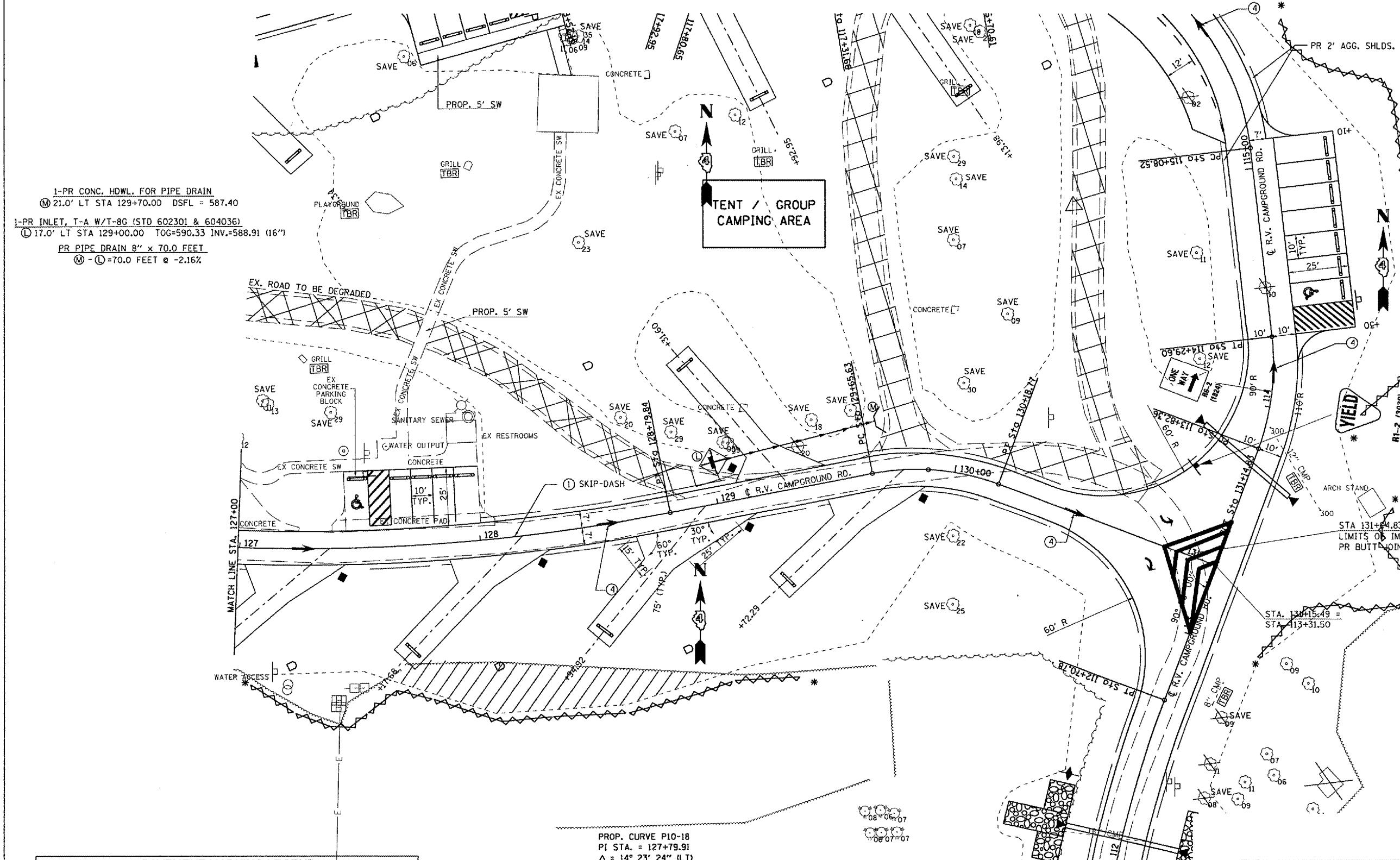

1-PR CONC. HDWL. FOR PIPE DRAIN  
 M 21.0' LT STA 129+70.00 DSFL = 587.40  
 1-PR INLET, T-A W/T-8G (STD 602301 & 604036)  
 L 17.0' LT STA 129+00.00 TOG=590.33 INV.=588.91 (16")  
 PR PIPE DRAIN 8" x 70.0 FEET  
 M - L=70.0 FEET @ -2.16%

PROP. CURVE P10-11  
 PI STA. = 116+13.67  
 $\Delta = 92^\circ 52' 22''$  (LT)  
 D = 57' 17' 45"  
 R = 100.00'  
 T = 105.14'  
 L = 162.09'  
 E = 45.10'  
 e = N.C.  
 S.E. RUN = -----  
 P.C. STA = 115+08.52  
 P.T. STA = 116+70.61

PROP. CURVE P10-18  
 PI STA. = 127+79.91  
 $\Delta = 14^\circ 23' 24''$  (LT)  
 D = 7' 09' 43"  
 R = 800.00'  
 T = 100.99'  
 L = 200.92'  
 E = 6.35'  
 e = N.C.  
 S.E. RUN = -----  
 P.C. STA = 126+78.92  
 P.T. STA = 128+79.84

**PAVEMENT MARKING LEGEND**

- ① PREFORMED PLASTIC PAVEMENT MARKING - LINE 5" (YELLOW)
  - ② PREFORMED PLASTIC PAVEMENT MARKING - LINE 8" (YELLOW) @ 5' CTS.
  - ③ PREFORMED PLASTIC PAVEMENT MARKING - LINE 24" (WHITE)
  - ④ PREFORMED PLASTIC PAVEMENT MARKING - LETTERS & SYMBOLS (WHITE)
- NOTE : NO PROPOSED EDGE LINE STRIPING, EXCEPT AS CALLED OUT.

REVISIONS	
NAME	DATE

ILLINOIS DEPARTMENT OF TRANSPORTATION  
**SWPPP**  
 WEINBERG KING STATE PARK  
 SCALE: VERT. \_\_\_\_\_  
 HORIZ. \_\_\_\_\_  
 DATE \_\_\_\_\_  
 DRAWN BY: BDK  
 CHECKED BY: JCN

PLOT DATE = 8/24/2009  
 PLOT SCALE = 1/4" = 100'  
 USER NAME = kmb3d