

F.A. RTE.	SECTION	COUNTY	TOTAL SHEETS	SHEET NO.
*	**	SCHUYLER	139	69
STA.		TO STA.		
FED. ROAD DIST. NO.		ILLINOIS	FED. AID PROJECT	
* OTHER ROUTE 1 (WEINBERG KING STATE PARK)				
** WEIN KING ST PK INT RDS 2				

FARM FIELD

FARM FIELD



STA 529+60.00 (0° SKEW)
 PR PIPE CULVERT, 18" Ø x 40'
 T-1, CS/A
 (N 1299518.03, E 2089956.08) 20' LT USFL = 543.90
 (N 1299486.04 E 2089956.87) 20' RT DSFL = 543.70
 2-METAL END SEC 15" Ø
 (STD 542401)

POT. STG. 527+00.00 (Q SURVEY) =
 N 1299505.60
 E 2089956.63
 PI STA 527+00.00 (Q CONSTRUCTION)

POT. STG. 530+99.73 (Q SURVEY) =
 N 1299501.11
 E 2090096.47
 PI STA 530+99.73 (Q CONSTRUCTION)

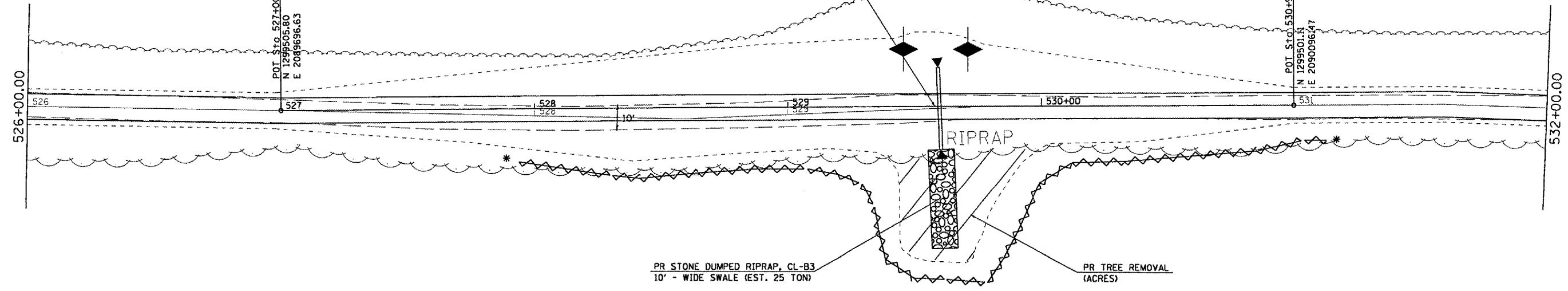

NOTE: STA 528+50 TO STA 530+60
 -SEE PROFILE SHEET FOR REPROFILING PAVEMENT AREA

WOODS

WOODS

PLOT DATE = 8/24/2005
 PLOT SCALE = 43.3735' = 1" IN.
 USER NAME = kmtbd

REVISIONS	
NAME	DATE

ILLINOIS DEPARTMENT OF TRANSPORTATION

SWPPP

WEINBERG KING STATE PARK

SCALE: VERT. _____
 HORIZ. _____

DATE _____ DRAWN BY BDK
 CHECKED BY JCN