

B.M. #17 R.R. Spike in 16" Tree 60 ft Sta. 255+08 Elev. 529.66  
 Exist. Structure: Built as FAS 891 Sec. 76 BR-1 Sta. 252+20  
 Superstr. is RC Thru Girders. Substr. is  
 RC Closed Abuts. Contractor shall remove existing  
 Superstr. only. No Salvage.  
 Temporary Bridge req'd

STATE OF ILLINOIS

ROUTE NO.	DISTRICT	PROJECT	TOTAL SHEETS	SHEET NO.	SHEET NO. 1
76BR-1	St. Clair	11	5	5	5 SHEETS

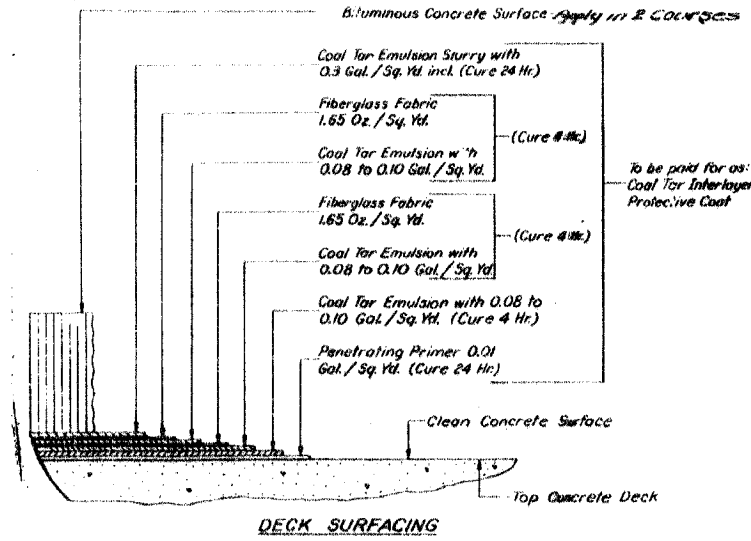
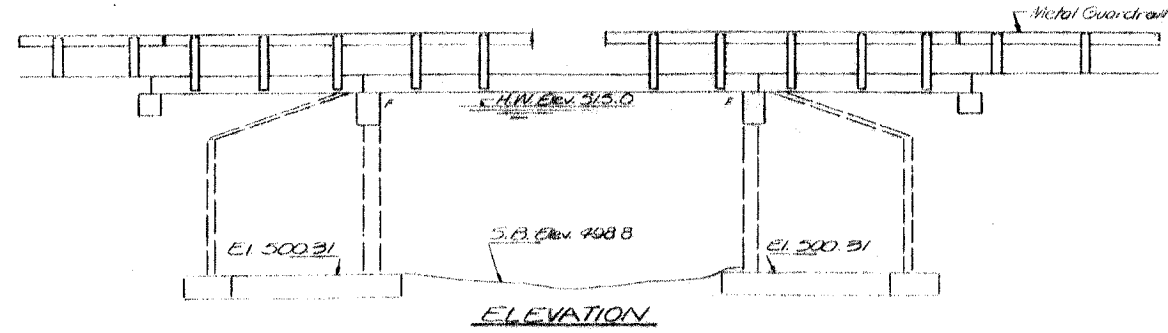

**GENERAL NOTES**  
 All reinforcement bars shall be lapped 24 diameters unless otherwise shown.  
 It shall be the responsibility of the contractor to verify all dimensions & conditions existing in the field prior to construction & ordering of materials.  
 An alternate strand pattern using extra high strength prestressing strand (270 k.s.f.) is permitted.  
 Shoulder transition to wing wall shall be shaped with broken concrete. Cost incidental.  
 Limits of coal tar interlayer protective coat shall be back to back of abutments & out to out of deck.  
 Expansion bolts shall consist of self-drilling expansion shields & 3/4" hooked bolts.  
 Hooked bolts shall extend a minimum of 12" into new concrete except as otherwise shown.

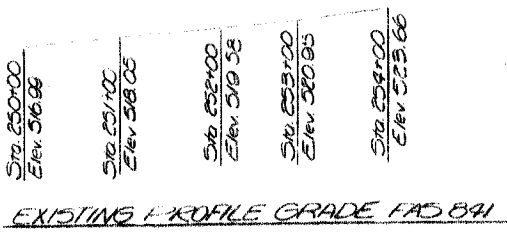
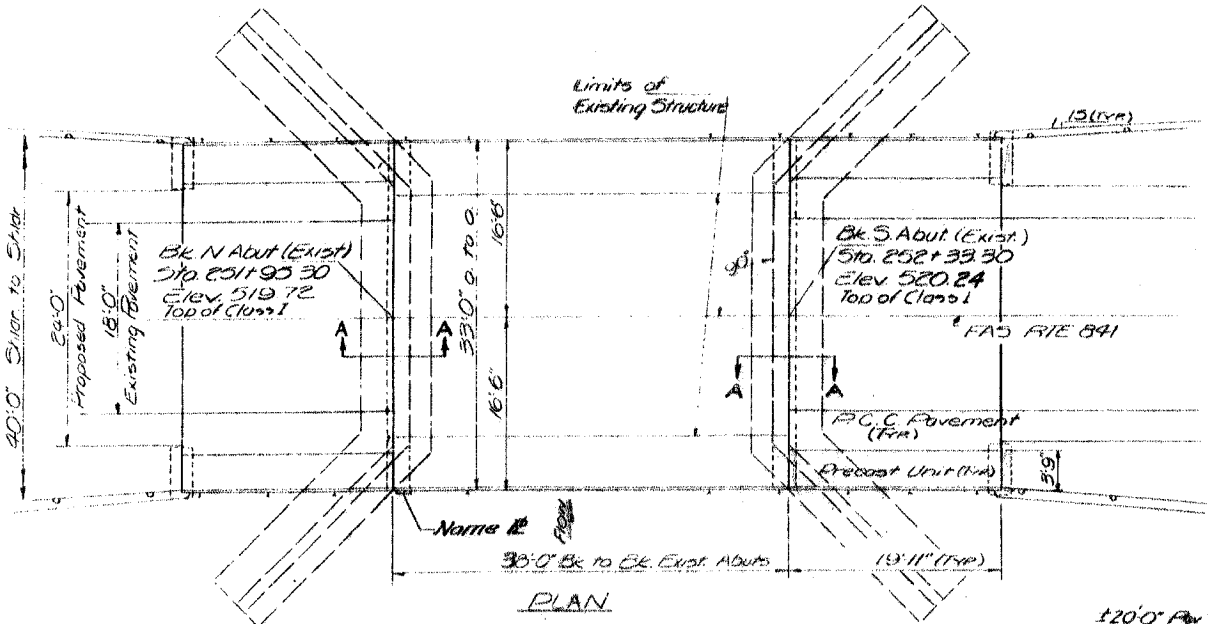

**TOTAL BILL OF MATERIAL**

ITEM	UNIT	SUB.	SUPER	TOTAL
P.C.C. Pavement (10')	Sq. Yds.			33
Pavement Fabric	Sq. Yds.			33
Concrete Removal	Cu. Yds.	8.2		8.2
Expansion Bolts (3/4")	Each		84	84
Class X Concrete	Cu. Yds.	15.1		15.1
Precast Conc. Bridge Slab	Sq. Ft.			299
Precast Prestressed Concrete Deck Beams (1/4")	Sq. Ft.		1,249	1,249
Steel Railing Type S	Lf. Ft.		156	156
Reinforcement Bars	Lbs.	2070		2070
Name Plates	Each			1
Removal of Existing Superstructures	Each			1
Coal Tar Interlayer Protective Coat	Sq. Yds.		140	140
Bituminous Concrete Surface Course, Class I	Tons		16	16
Temporary Bridge Complete	Each			1

**DESIGN STRESSES**

**FIELD UNITS**  
 Fc = 1000 psi (Sub)  
 Fs = 20000 psi (Reinf)  
 vs. 75 psi (Footings)  
 n = 10

**PRECAST PRESTRESSED UNITS**  
 Fc = 5000 psi  
 Fci = 4000 psi  
 Fs = 248,000 psi (5 Strands)  
 Fci = 173,600 psi (5 Strands)

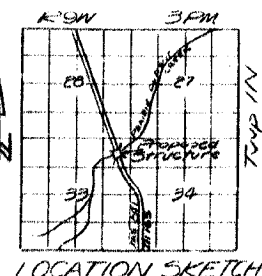
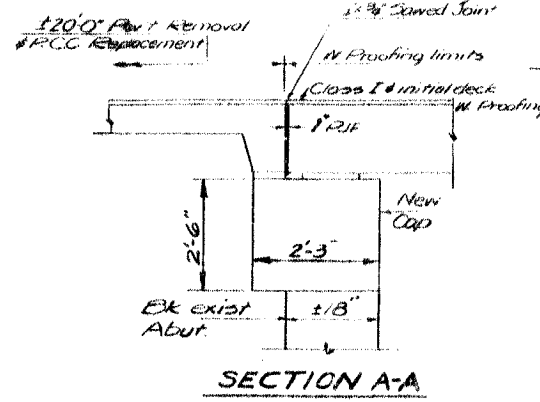

STATION 252+20  
 PRAIRIE DUPONT CREEK  
 RE-BUILT 197 BY  
 F.A.S. RT. 891 SEC. 76BR-1  
 LOADING HS-20  
**NAME PLATE**  
 See Std. 2113-1

DESIGNED: K. A. S. (nd)  
 CHECKED: M. J. C. (nd)  
 DRAWN: L.H.  
 CHECKED: M.O.  
 MAY 5 1971  
 EXAMINED: [Signature]  
 PASSED: W. B. Baumann  
 APPROVED: [Signature]

GENERAL PLAN & ELEVATION  
 FAS RTE 891 OVER  
 PRAIRIE DUPONT CREEK  
 FAS RTE 891 SEC. 76BR-1  
 ST. CLAIR COUNTY  
 STA. 252+20