

FAS ROUTE	SECTION	COUNTY	TOTAL SHEETS	SHEET NO.
754	4RS-2, 4BR	CALHOUN	87	50
STA. _____ TO STA. _____		EXISTING CONDITIONS:		
CONTRACT NO. 76269				



**ELEMENTS CONTROLLING DESIGN**

- DESIGN DESIGNATION FAS 754 (PARK STREET), MAJOR COLLECTOR NORTH COUNTY ROAD, LOCAL ROAD, ADT 4900 (2002) 6000 (2022)
- FAS 754 (PARK STREET) IS THE PREFERENCE ROUTE
- TRAFFIC CONTROL TO BE STOP SIGN ON NORTH COUNTY ROAD

**GENERAL NOTES**

- PROFILES ARE PROVIDED, SINCE APPROACH GRADES ARE GREATER THAN 1%
- TYPE B-6.24 CURB AND GUTTER TO BE USED ON OUTER EDGES OF PAVEMENT
- ALL DIMENSIONS ARE SHOWN F-F OF CURB, UNLESS SHOWN OTHERWISE
- PRIVATE AND COMMERCIAL ENTRANCES SHALL COMPLY WITH IDOT POLICY, "ACCESS TO STATE HIGHWAYS" AND DETAILS SHOWN ON THE PLANS
- PAVEMENT MARKING SHALL BE THERMOPLASTIC, WHERE APPLICABLE. PAVEMENT MARKING AND SIGNS SHALL BE IN ACCORDANCE WITH THE ILLINOIS MANUAL ON UNIFORM TRAFFIC CONTROL DEVICES AND IDOT PRACTICES, CURRENT EDITION.

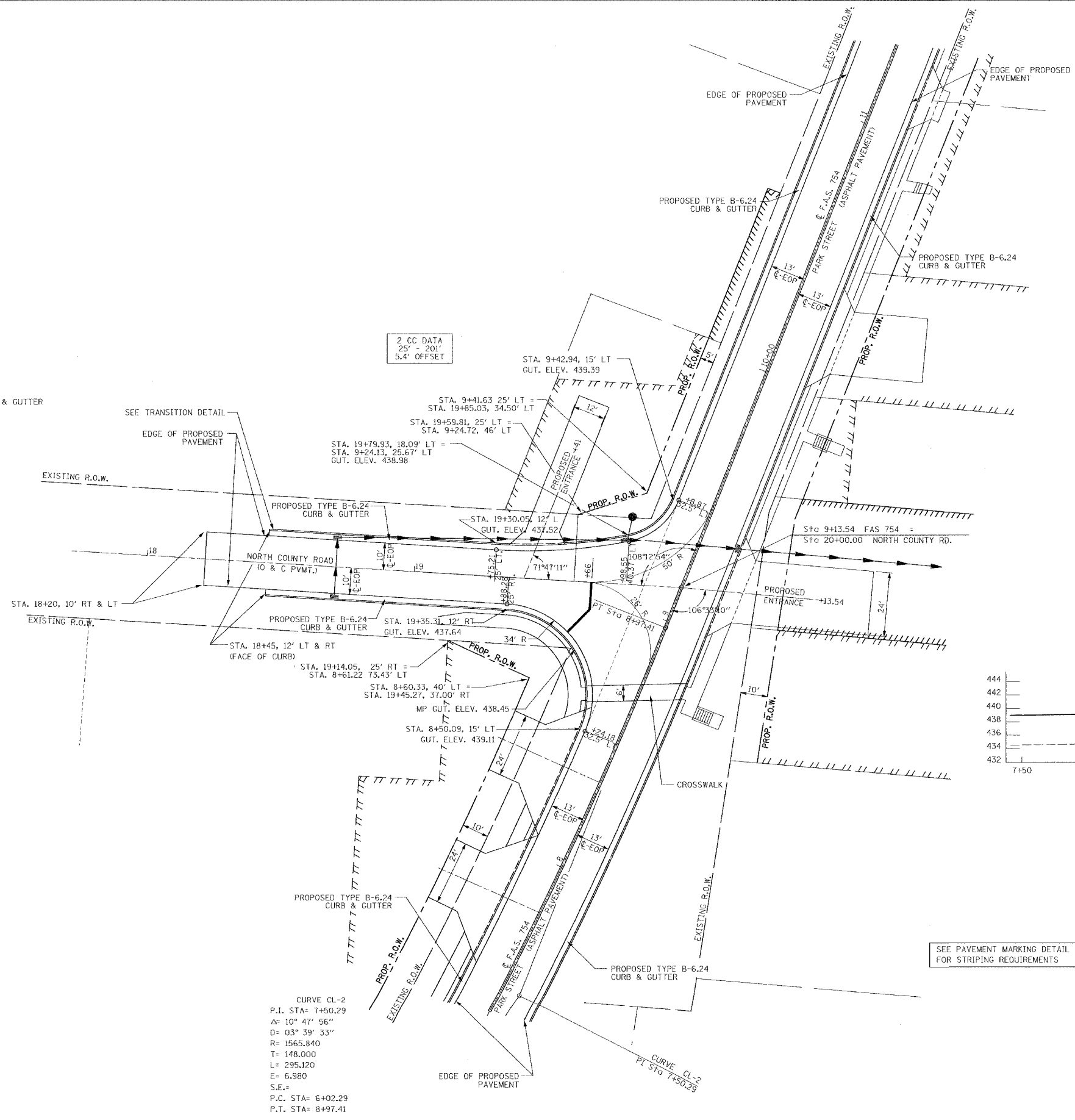
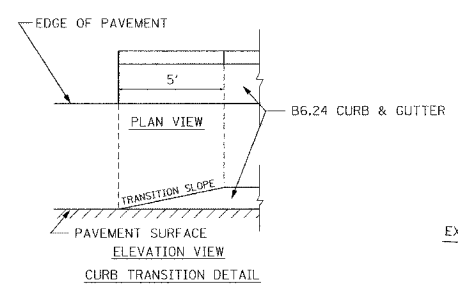

2 CC DATA  
25' - 20'  
5.4' OFFSET

SEE PAVEMENT MARKING DETAIL SHEET FOR STRIPING REQUIREMENTS

CURVE CL-2  
P.I. STA= 7+50.29  
Δ= 10° 47' 56"  
D= 03° 39' 33"  
R= 1565.840  
T= 148.000  
L= 295.120  
E= 6.980  
S.E.=  
P.C. STA= 6+02.29  
P.T. STA= 8+97.41

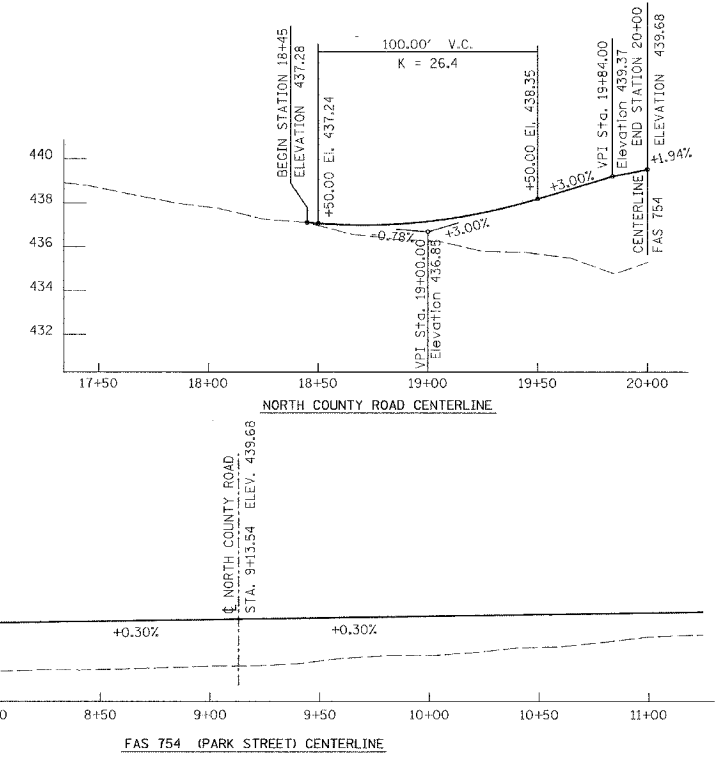

REVISIONS	
NAME	DATE

ILLINOIS DEPARTMENT OF TRANSPORTATION  
**INTERSECTION DETAIL**  
FAS ROUTE 754 (PARK ST.)  
SECTION 4RS-2, 4BR  
CALHOUN COUNTY  
DATE: MAY, 2003  
DRAWN BY: WJS  
CHECKED BY: MKC