

F. A. MILE	SECTION	COUNTY	TOTAL SHEETS	SHEET NO.
754	4RS-2, 4BR	CALHOUN	87	81
STA. 11+80		TO STA. 12+20		
FED. ROAD DIST. NO.	ELIQUIS	FED. AID PROJECT		

CONTRACT NO. 76269

70 80

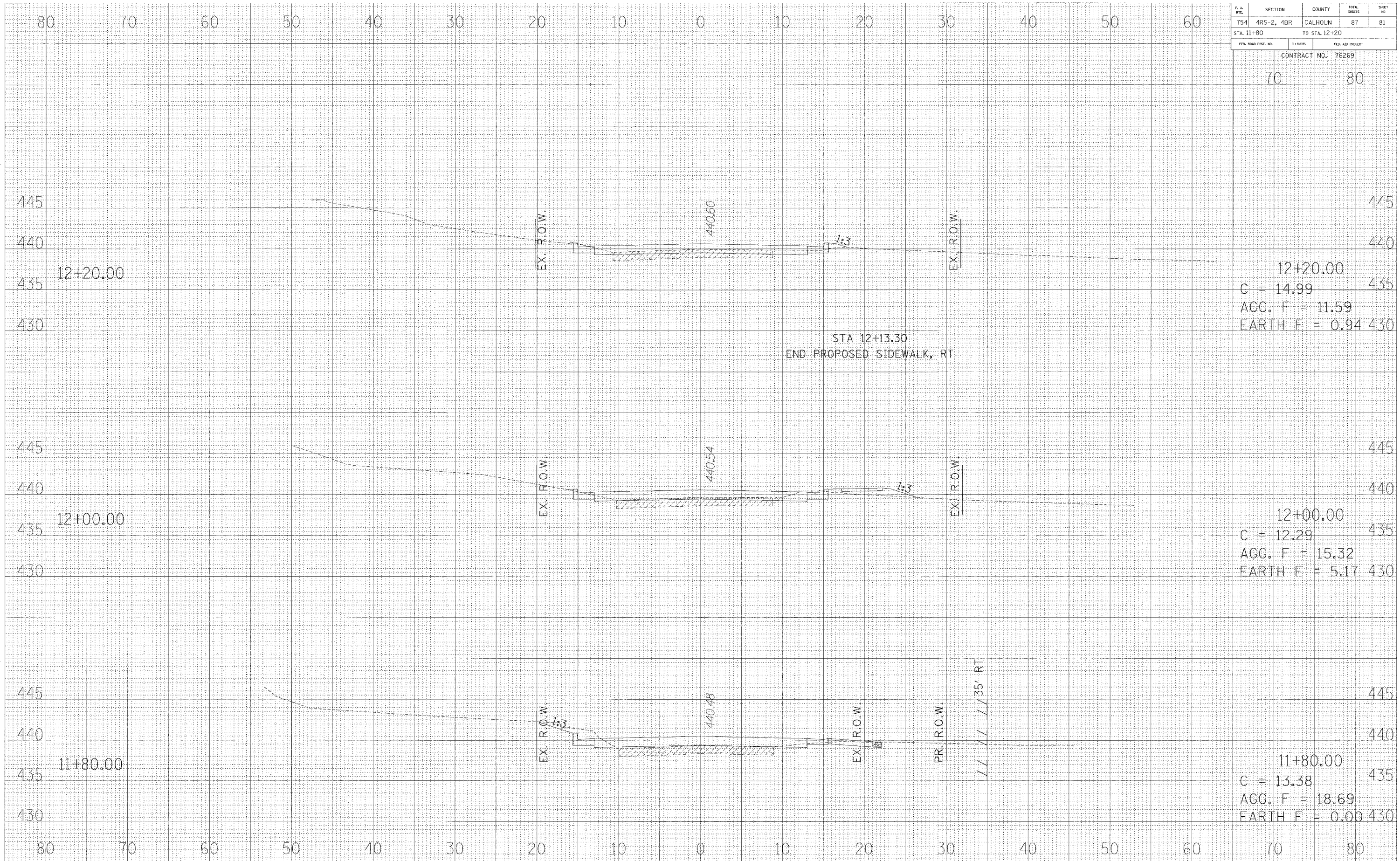

12+20.00  
 C = 14.99  
 AGG. F = 11.59  
 EARTH F = 0.94

12+00.00  
 C = 12.29  
 AGG. F = 15.32  
 EARTH F = 5.17

11+80.00  
 C = 13.38  
 AGG. F = 18.69  
 EARTH F = 0.00

STA 12+13.30  
 END PROPOSED SIDEWALK, RT

PR. R.O.W.  
 // 35' RT