

LEGEND

- SIGN ON PORTABLE OR PERMANENT SUPPORT
- SIGN DESCRIPTION NUMBER
- TWO-WAY TRAFFIC FLOW
- FLASHING LIGHT (TYPE A)
- DETOUR ROUTE
- WORK AREA

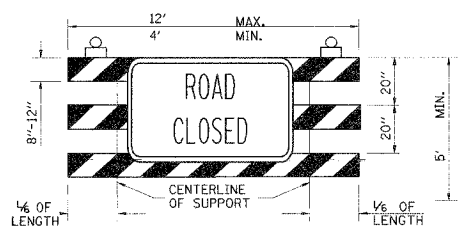

1 ROAD CLOSED TO ALL TRAFFIC
TYPE III BARRICADE
STANDARD FLASHING
(IDOT HWY STD 702001)
W/ R11-2 (48" x 30")

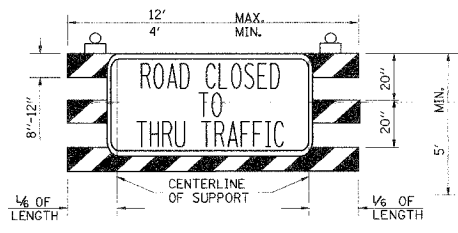

10 ROAD CLOSED TO THRU TRAFFIC
TYPE III BARRICADE
STANDARD FLASHING
(IDOT HWY STD 702001)
W/ R11-4 (60" x 30")

- 2 END DETOUR
- 3 M4-8A 48" X 48" STANDARD FLASHING (REFLECTORIZED)
- 4 M4-9 30" X 24" BLACK ON ORANGE (REFLECTORIZED)
- 5 M4-9(BL) 30" X 24" BLACK ON ORANGE (REFLECTORIZED)
- 6 M4-9(BR) 30" X 24" BLACK ON ORANGE (REFLECTORIZED)
- 7 M4-9R 30" X 24" BLACK ON ORANGE (REFLECTORIZED)
- 8 M4-9L 30" X 24" BLACK ON ORANGE (REFLECTORIZED)
- 9 W20-3A 48" X 48" STANDARD FLASHING
- 10 ROAD CLOSED AHEAD
- 11 M4-10L 48" X 24" BLACK ON ORANGE (REFLECTORIZED)
- 12 W20-1 (O)-48 ROAD CONSTRUCTION AHEAD
- 13 W21-1(O)-48
- 14 M4-10R 48" X 24" BLACK ON ORANGE (REFLECTORIZED)
- 15 CHANGEABLE MESSAGE SIGN

McCORMICK BLVD
NORTHBOUND
McCORMICK BLVD
SOUTHBOUND

g. W17-1100 (2 EACH)
24" X 12"
BLACK ON ORANGE
(REFLECTORIZED)

b. W17-1100 (2 EACH)
24" X 12"
BLACK ON ORANGE
(REFLECTORIZED)

NOTES:

1. SEE STATE STANDARDS AND MAINTENANCE OF TRAFFIC PLANS FOR SIGNING AND BARRICADES ALONG MCCORMICK BOULEVARD.
2. LOCAL ACCESS FOR ALL RESIDENTS AND BUSINESSES SHALL BE MAINTAINED AT ALL TIMES AS SHOWN IN THE PLANS.
3. ALL DETOUR SIGNING FOR ALL CONSTRUCTION STAGES SHALL BE INCLUDED IN THE CONTRACT LUMP SUM PRICE FOR TRAFFIC CONTROL AND PROTECTION.

REVISIONS	
NAME	DATE

ILLINOIS DEPARTMENT OF TRANSPORTATION
DETOUR PLAN
CONSTRUCTION STAGES 1 AND 2
MCCORMICK BOULEVARD

NO SCALE

DATE 9/03/04
DRAWN BY CEW
CHECKED BY PAS

4002DETOUR1.2.SHT

TRANS SYSTEMS CORPORATION