

F.A.U.	SECTION	COUNTY	TOTAL SHEET SHEETS, NO.
2832	00-00218-00-FP	COOK	108 28
STA 49+00	TO STA 60+00		
FED. ROAD DIST. NO. 7 ILLINOIS		FED. AID PROJECT	

CONTRACT NO. 83773

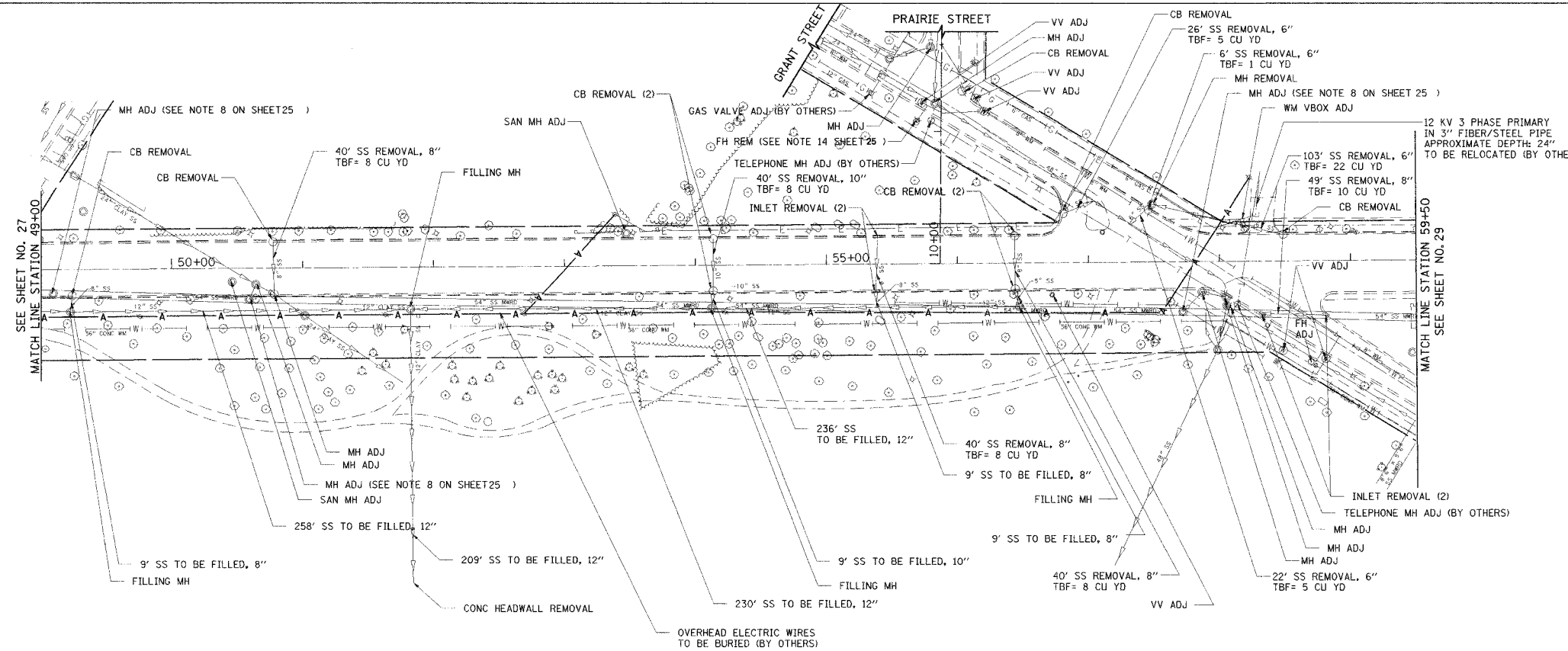

EXISTING

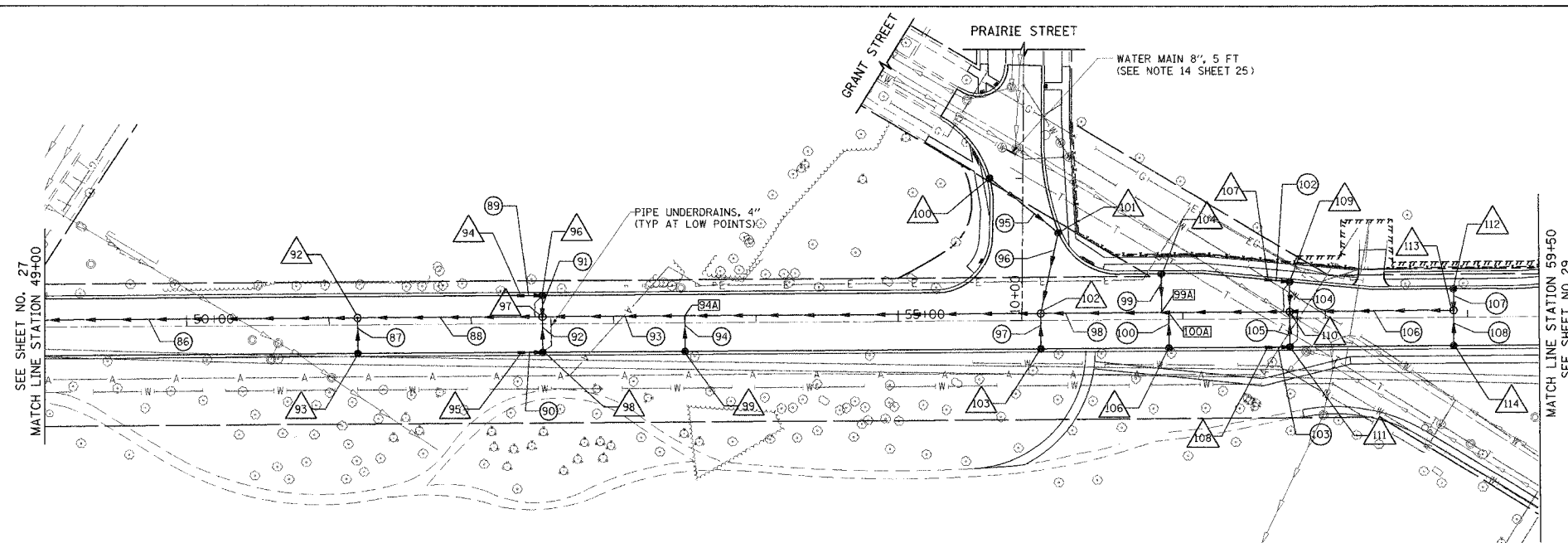

PROPOSED

SCHEDULE OF STORM SEWER PIPES:

PIPE NO.	ITEM	CLASS	TYPE	SIZE	LENGTH (FT)	SLOPE	TBF (CU YD)
86	SS	A	2	27"	250.0	0.15%	284
87	SS	A	1	12"	20.5	1.00%	4
88	SS	A	2	24"	125.0	0.17%	122
89	SS	A	1	12"	12.0	1.00%	2
90	SS	A	1	12"	12.0	1.00%	2
91	SS	A	1	12"	10.5	1.00%	2
92	SS	A	1	12"	20.5	1.00%	4
93	SS	A	2	21"	345.0	0.21%	267
94	SS	A	2	12"	22.1	1.00%	16
95	SS	A	1	12"	57.4	1.00%	10
96	SS	A	2	18"	53.6	1.00%	20
97	SS	A	1	12"	20.5	1.00%	4
98	SS	A	2	18"	170.5	0.26%	93
99	SS	A	2	12"	24.3	1.00%	11
100	SS	A	2	12"	22.3	1.00%	10
101	SS			NOT USED			
102	SS	WM REOMTS	1	12"	12.1	1.00%	2
103	SS	A	1	12"	12.0	1.00%	2
104	SS	WM REOMTS	1	12"	16.9	1.00%	4
105	SS	A	1	12"	21.0	1.00%	4
106	SS	WM REOMTS	2	12"	111.0	0.44%	44
107	SS	A	1	12"	11.0	1.00%	2
108	SS	A	1	12"	21.0	1.00%	4

SCHEDULE OF STORM SEWER STRUCTURES:

STR. NO.	STATION	OFFSET (FT)	TYPE	FRAME & GRATE	RIM ELEV.	NORTH EAST	NORTH WEST	SOUTH EAST	SOUTH WEST	EAST	WEST
92	51+20.0	5.0	LT	MH TA 5 DIA	TIF CL	599.50	591.03	595.75	590.78		
93	51+20.0	20.0	RT	CB TA 4 DIA	T3F&G	599.18		595.93			
94	52+35.0	20.0	LT	INLETS TA	T3F&G	598.73	595.48				
95	52+35.0	20.0	RT	INLETS TA	T3F&G	598.73	595.48				
96	52+50.0	20.0	LT	CB TA 4 DIA	T3F&G	598.72		595.26	595.36		
97	52+50.0	5.0	LT	MH TA 5 DIA	TIF CL	599.04	591.54	595.16	591.24		
98	52+50.0	20.0	RT	CB TA 4 DIA	T3F&G	598.72		595.26	595.36		
99	53+50.0	20.0	RT	CB TA 4 DIA	T3F&G	599.05		592.34			
100	55+65.0	100.3	LT	CB TA 4 DIA	T3F&G	597.89	594.64				
101	56+12.7	61.7	LT	CB TA 4 DIA	T3F&G	597.95		593.97	594.07		
102	56+00.0	5.0	LT	MH TA 5 DIA	TIF CL	599.09	592.56	593.43	595.32	592.26	
103	56+00.0	20.0	RT	CB TA 4 DIA	T3F&G	598.77		595.52			

SCHEDULE OF STORM SEWER STRUCTURES:

STR. NO.	STATION	OFFSET (FT)	TYPE	FRAME & GRATE	RIM ELEV.	NORTH EAST	NORTH WEST	SOUTH EAST	SOUTH WEST	EAST	WEST
104	56+85.0	32.0	LT	CB TA 4 DIA	T3F&G	598.10		593.27			
105				NOT USED							
106	56+90.0	20.0	RT	CB TA 4 DIA	T3F&G	598.32		593.26			
107	57+60.0	27.4	LT	INLETS TA	T3F&G	597.94	594.69				
108	57+60.0	20.0	RT	INLETS TA	T3F&G	598.09	594.84				
109	57+75.0	25.9	LT	CB TA 4 DIA	T3F&G	597.96					
110	57+75.0	5.0	LT	MH TA 4 DIA	TIF CL	598.40		593.31	594.30	594.47	594.57
111	57+75.0	20.0	RT	CB TA 4 DIA	T3F&G	598.08		594.62	594.22	594.72	
112	58+90.0	20.0	LT	CB TA 4 DIA	T3F&G	598.46			595.21		
113	58+90.0	5.0	LT	MH TA 4 DIA	TIF CL	598.78		595.10	595.00	593.80	
114	58+90.0	20.0	RT	CB TA 4 DIA	T3F&G	598.46		595.21			

SCHEDULE OF STORM SEWER TEES AT BLIND CONNECTS:

TEE NO.	TYPE OF TEE	LARGER PIPE INV
94A	RCP, 21" PIPE WITH 12" RISER	591.74
99A	RCP, 18" PIPE WITH 12" RISER	592.78
100A	RCP, 18" PIPE WITH 12" RISER	592.79

REVISIONS

NAME	DATE
PAS/CEC	5/23/05
PAS/CEC	9/06/05

ILLINOIS DEPARTMENT OF TRANSPORTATION
DRAINAGE AND UTILITIES PLAN
 McCORMICK BOULEVARD
 STATION 49+00 TO STATION 60+00
 DATE 9/03/04
 DRAWN BY CEW
 CHECKED BY PAS

