

STATE OF ILLINOIS
DEPARTMENT OF TRANSPORTATION

ROUTE NO.	SECTION	COUNTY	TOTAL SHEETS	SHEET NO.
F.A.P. 309	7HBR-1	WHITESIDE	146	42
FED. ROAD DIST. NO. 7	ILLINOIS	FED. AID PROJECT		

SHEET NO. 5
23 SHEETS

Contract #84883

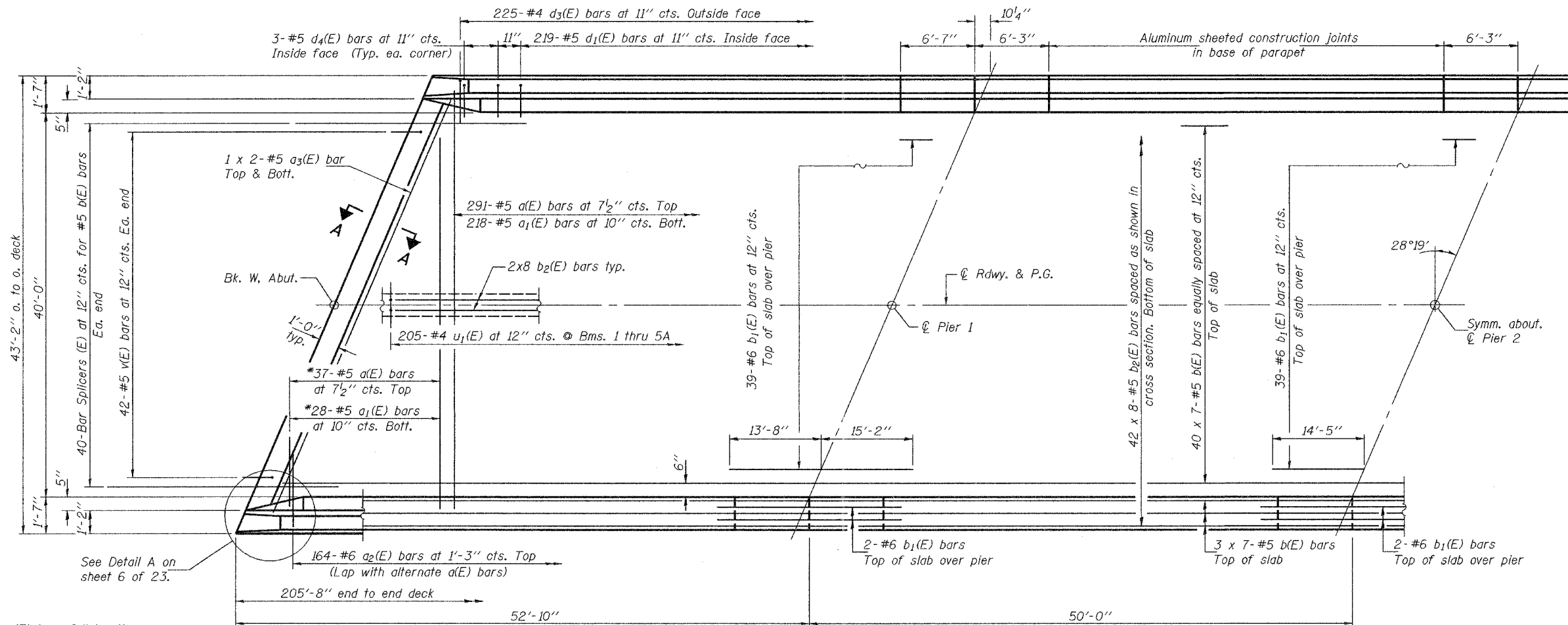

*Order a(E) and a₁(E) bars full length. Cut to fit skew and use remainder of bars in opposite end.

MIN. BAR LAP
#5 bars = 1'-8"

Notes:
 See sheet 6 of 23 for superstructure details and Bill of Material.
 Reinforcement bars designated (E) shall be epoxy coated.
 Bars indicated thus 20 x 3-#5 etc. indicates 20 lines of bars with 3 lengths per line.
 See sheet 6 of 23 for parapet reinforcement.
 See sheet 7 of 23 for Section A-A.

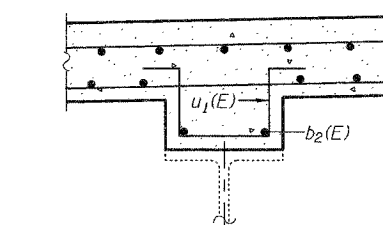
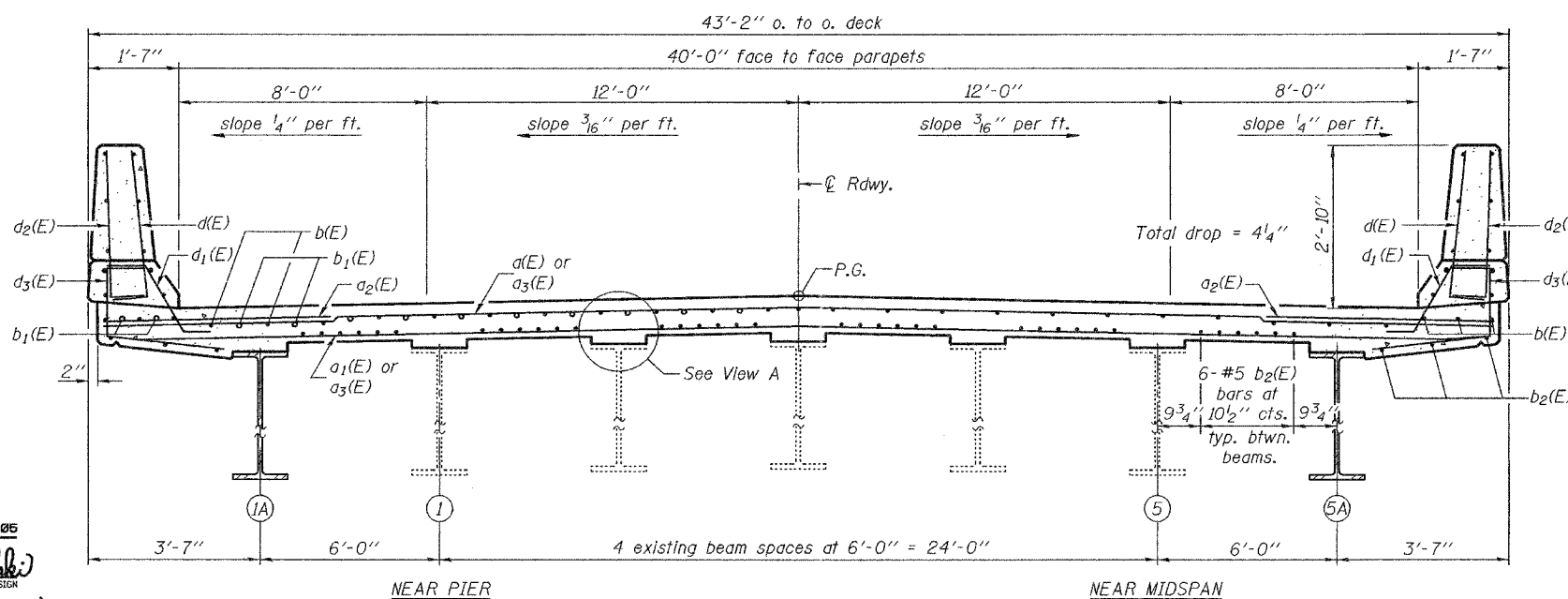

VIEW A

DESIGNED	CCC
CHECKED	DPN
DRAWN	h.t. duong
CHECKED	CCC/DPN

Oct. 11, 2005
 EXAMINED *Thomas J. Samagalki*
 ENGINEER OF BRIDGE DESIGN
 PASSED *Ralph E. Anderson*
 ENGINEER OF BRIDGES AND STRUCTURES

SUPERSTRUCTURE
 F.A.P. RTE. 309 - SEC. 7HBR-1
 WHITESIDE COUNTY
 STATION 51+17.83
 STRUCTURE NO. 098-6000