

FAP RTE	SECTION	COUNTY	TOTAL SHEETS	SHEET NO.
729	34Z-4	VERMILION	285	31
FED. ROAD DIST. NO.		ILLINOIS	FED. AID PROJECT	

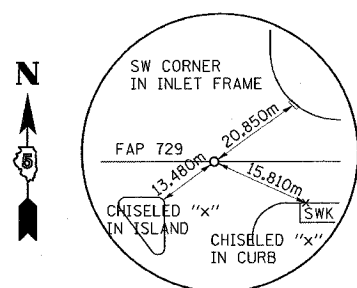

POT STATION 90+127.728
N 384054.606, E 359480.666
PSM IN VAULT

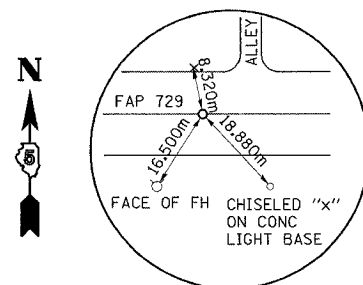

PI STATION 90+429.187
N 384059.091, E 359782.092
IP W/CAP

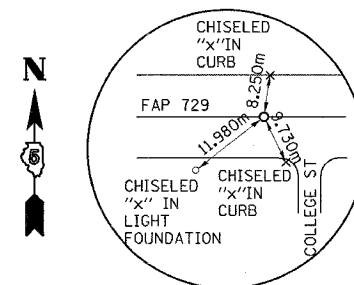

PI STATION 90+987.078
N 384066.565, E 360339.933
IP W/CAP

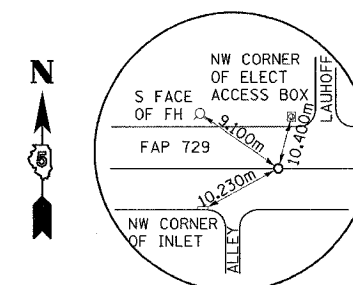

PI STATION 91+140.411
N 384068.931, E 360493.247
IP W/CAP

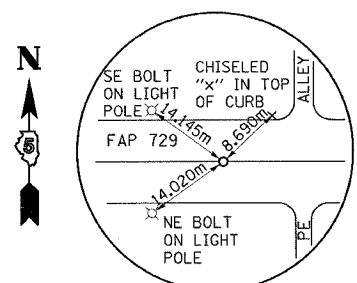

PI STATION 91+391.597
N 384072.255, E 360744.411
IP W/CAP

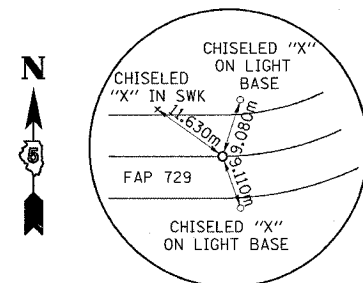

PC STATION 91+506.214
N 384073.683, E 360859.019
PK NAIL

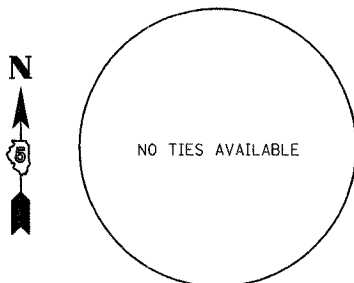

PI STATION 91+665.829
N 384075.672, E 361018.622

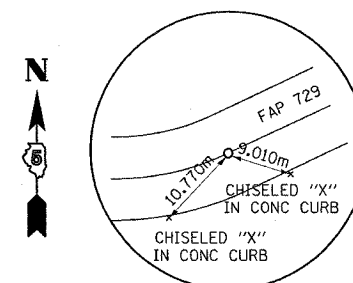

PT STATION 91+821.280
N 384138.948, E 361165.160
PK NAIL

NOTE: ALL COORDINATES ARE GROUND COORDINATES.

BENCH MARKS

BM #1	CHISELED " X " ON NE BOLT OF THE SOUTH CANTILEVER SIGN FOUNDATION, STATION 90+264.410, ELEV 181.795	BM #7	CHISELED " □ " IN THE NE CORNER OF A LIGHT POLE FOUNDATION, STATION 91+079.700, ELEV 182.283
BM #2	CHISELED " □ " IN THE SE CORNER OF A TRAFFIC SIGNAL FOUNDATION, STATION 90+475.110, ELEV 182.685	BM #8	CHISELED " □ " IN THE NE CORNER OF A STREET LIGHT FOUNDATION, STATION 91+223.920, ELEV 181.571
BM #3	CHISELED " □ " IN THE NW CORNER OF A SIGNAL FOUNDATION, STATION 90+589.920, ELEV 183.282	BM #9	CHISELED " □ " IN THE NE CORNER OF A STREET LIGHT FOUNDATION, STATION 91+318.600, ELEV 180.627
BM #4	CHISELED " □ " IN THE NW CORNER OF A SIGNAL FOUNDATION, STATION 90+738.480, ELEV 182.871	BM #10	CHISELED " □ " IN THE NE CORNER OF AN ABANDONED SIGN FOUNDATION, STATION 91+446.170, ELEV 177.843
BM #5	CHISELED " □ " IN THE SE CORNER OF A LIGHT POLE, STATION 90+829.290, ELEV 182.571	BM #11	NE CORNER OF THE BOTTOM STEP TO THE UNITED CHURCH OF CHRIST, STATION 91+536.950, ELEV 175.110
BM #6	CHISELED " □ " IN THE NW CORNER OF A CONCRETE SLAB, STATION 90+942.390, ELEV 182.466	BM #12	BRASS DISK IN THE SIDEWALK AT THE SW CORNER OF THE BRIDGE, STATION 91+658.020, ELEV 174.157

FAP 729
REFERENCE TIES
AND
BENCH MARKS