

FAP RTE	SECTION	COUNTY	TOTAL SHEETS	SHEET NO.
729	34Z-4	VERMILION	285	32
FED. ROAD DIST. NO.		ILLINOIS FED. AID PROJECT		

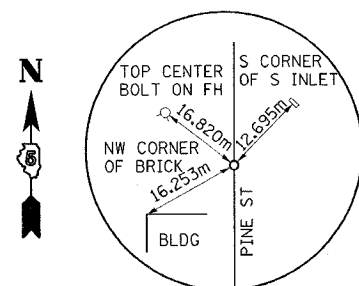

POT STATION 1+000.000 (PINE ST)  
N 384055.838, E 359563.473  
PK NAIL

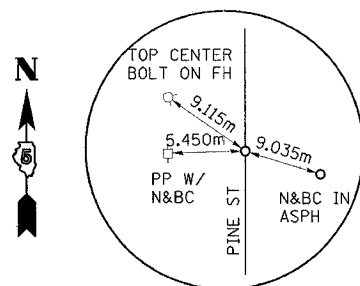

POT STATION 1+099.394 (PINE ST)  
N 384155.225, E 359562.292  
PK NAIL

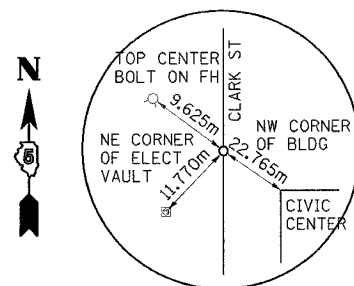

POT STATION 2+000.000 (CLARK ST)  
N 384058.138, E 359718.065  
PK NAIL

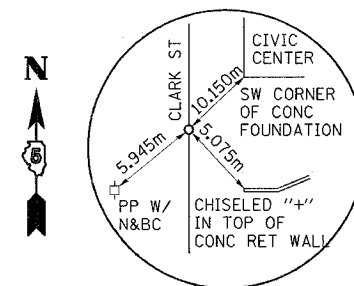

POT STATION 1+933.817 (CLARK ST)  
N 384991.971, E 359719.508  
PK NAIL

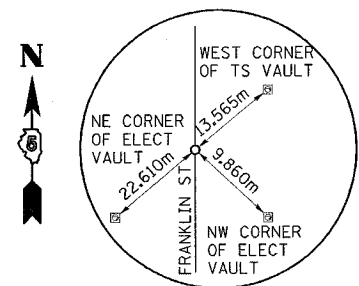

POT STATION 3+000.000 (FRANKLIN ST)  
N 384058.335, E 359731.271  
PK NAIL

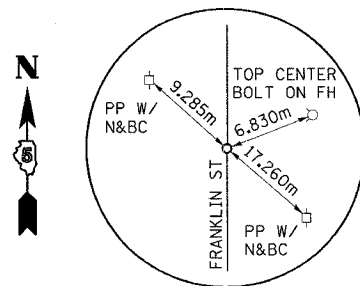

POT STATION 3+100.604 (FRANKLIN ST)  
N 384158.919, E 359729.268  
PK NAIL

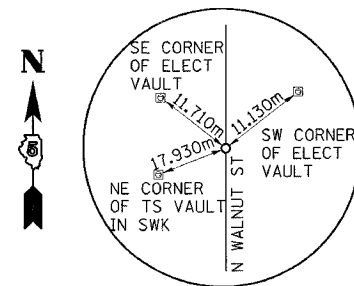

POT STATION 4+000.000 (N WALNUT ST)  
N 384059.884, E 359841.269  
PK NAIL

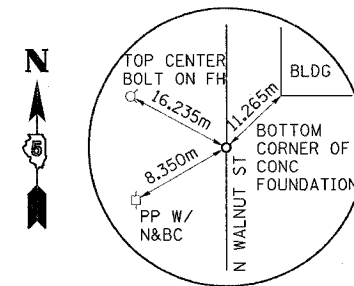

POT STATION 4+100.934 (N WALNUT ST)  
N 384160.803, E 359839.511  
PK NAIL

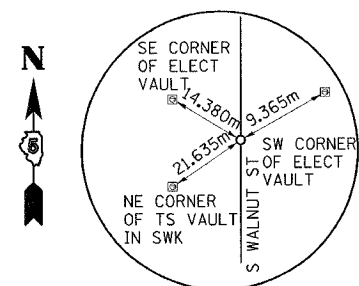

POT STATION 5+000.000 (S WALNUT ST)  
N 384059.934, E 359845.007  
PK NAIL

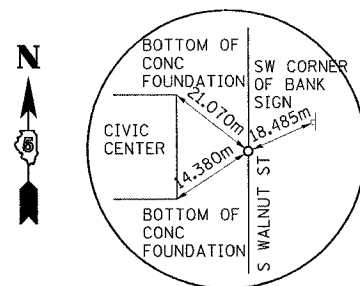

POT STATION 4+904.469 (S WALNUT ST)  
N 383964.421, E 359846.852  
PK NAIL

SW CORNER OF BANK SIGN

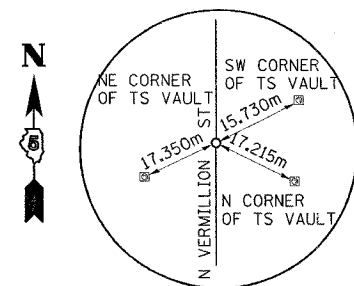

POT STATION 6+000.000 (N VERMILLION ST)  
N 384061.420, E 359955.887  
PK NAIL

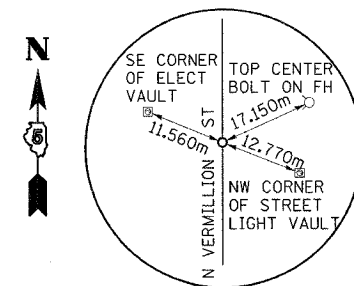

POT STATION 6+093.720 (N VERMILLION ST)  
N 384155.125, E 359954.234  
PK NAIL

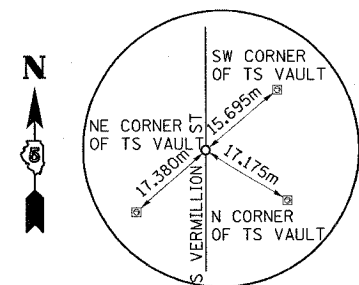

POT STATION 7+000.000 (S VERMILLION ST)  
N 384061.420, E 359955.937  
PK NAIL

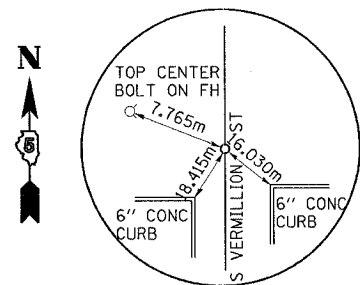

POT STATION 6+960.764 (S VERMILLION ST)  
N 384022.190, E 359956.602  
PK NAIL

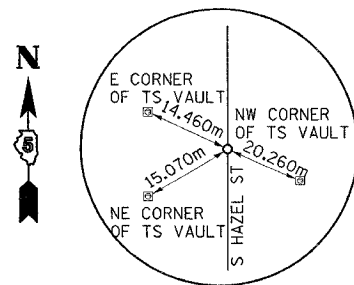

POT STATION 8+000.000 (N HAZEL ST)  
N 384063.033, E 360076.326  
PK NAIL

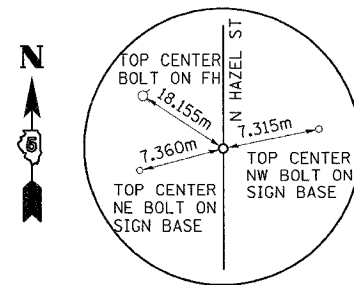

POT STATION 8+094.060 (N HAZEL ST)  
N 384157.082, E 360074.880  
PK NAIL

NOTE: ALL COORDINATES ARE GROUND COORDINATES.

SIDESTREET REFERENCE TIES

20001A002