

F.A.P. RTE.	SECTION	COUNTY	TOTAL SHEETS	SHEET NO.
729	34Z-4	VERMILION	285	38
STA.		TO STA.		
FED. ROAD DIST. NO.		ILLINOIS FED. AID PROJECT		

SEASON 1

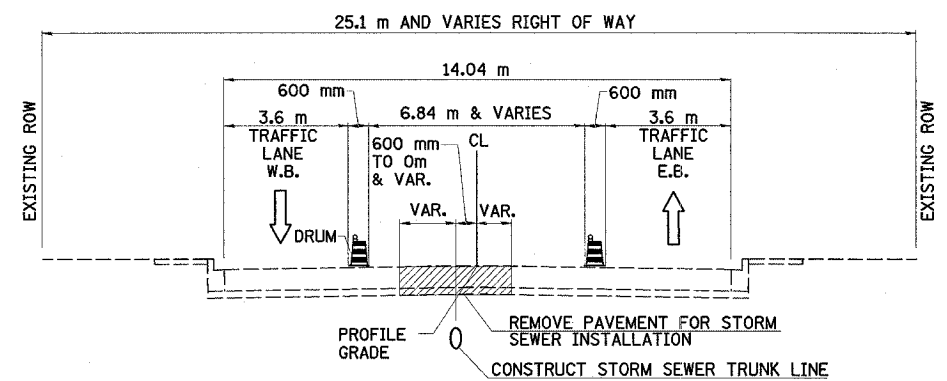

**AREA 1 - TYPICAL SECTION
STAGE 1**

RT STA 91+566.534 TO RT STA 91+658.000
LT STA 91+575.417 TO LT STA 91+658.000

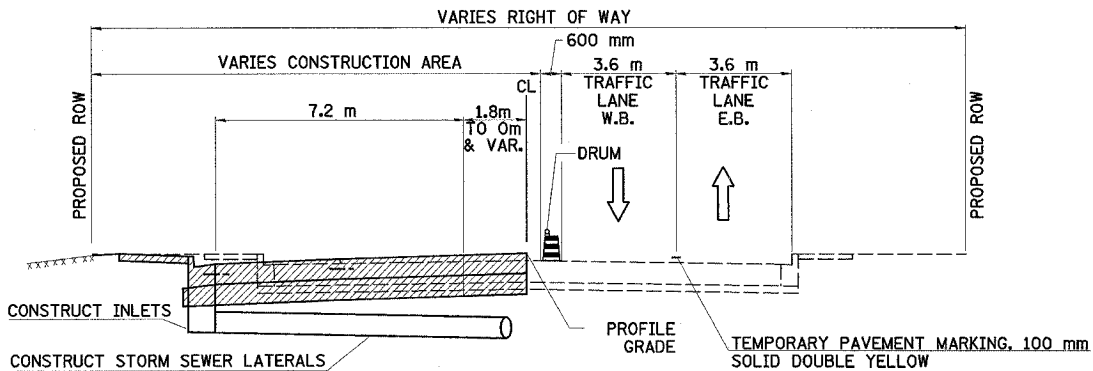

**AREA 1 - TYPICAL SECTION
STAGE 2**

RT STA 91+566.534 TO RT STA 91+658.000
LT STA 91+575.417 TO LT STA 91+658.000

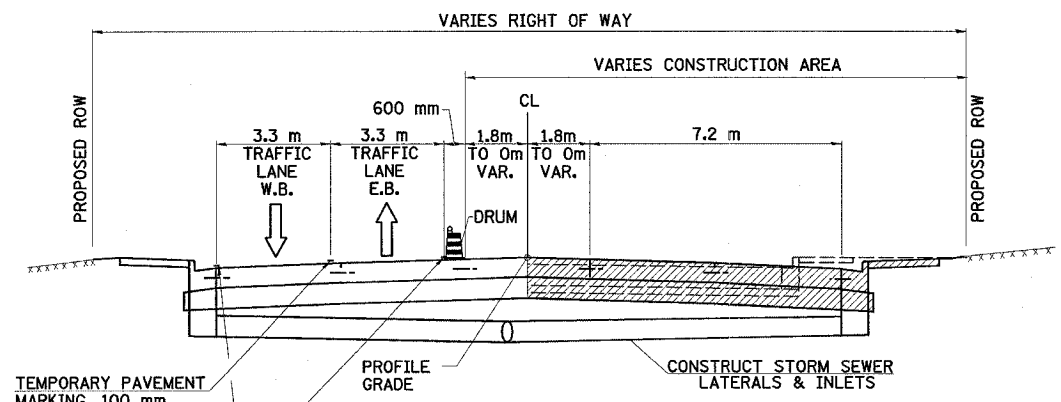

**AREA 1 - TYPICAL SECTION
STAGE 3**

RT STA 91+566.534 TO RT STA 91+658.000
LT STA 91+575.417 TO LT STA 91+658.000

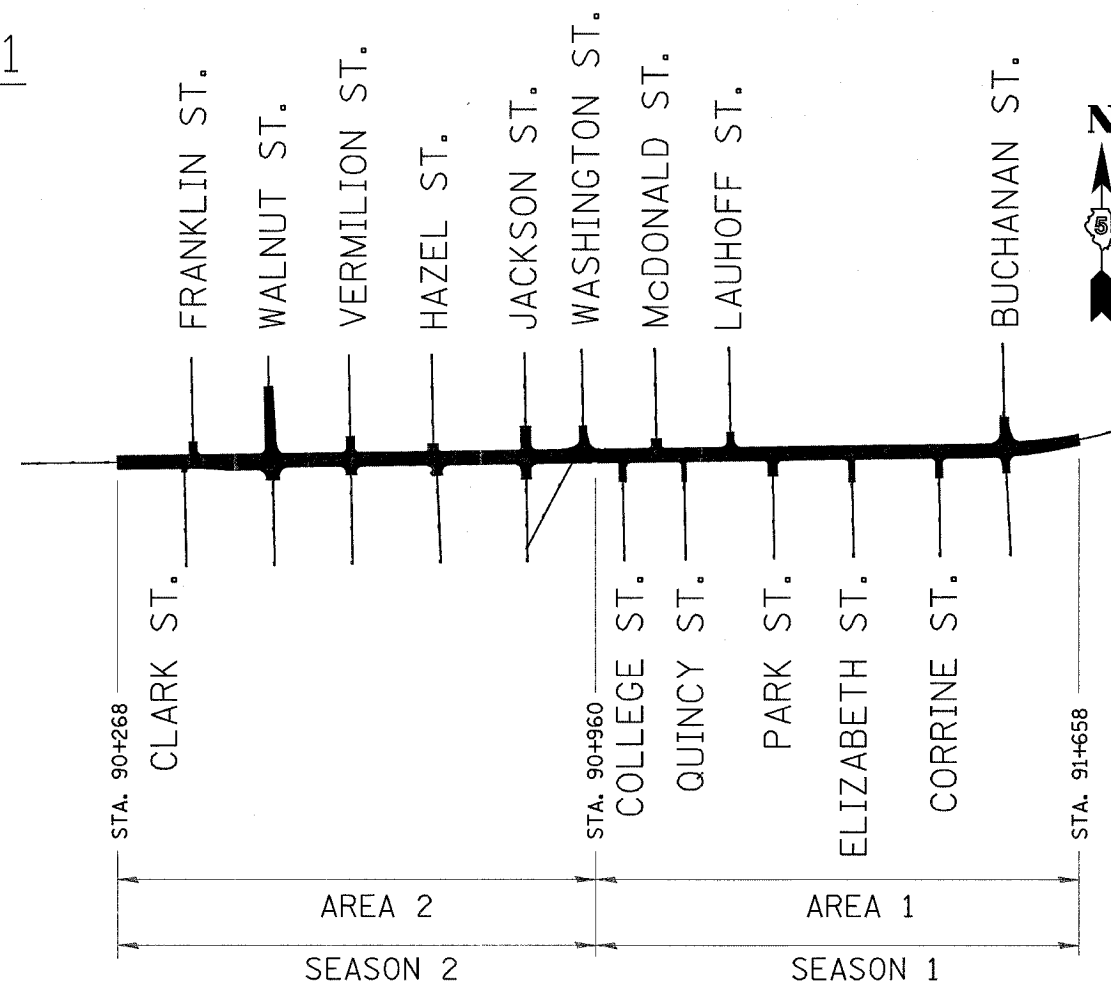

PLAN

NOTE:

SPACING FOR THE BARRICADES SHALL BE AT 15 m CENTERS. BARRICADES WILL BE PLACED OUTSIDE THE WORK AREA, BUT WILL NOT ENCROACH MORE THAN 600 mm INTO THE OPEN TRAFFIC LANE.

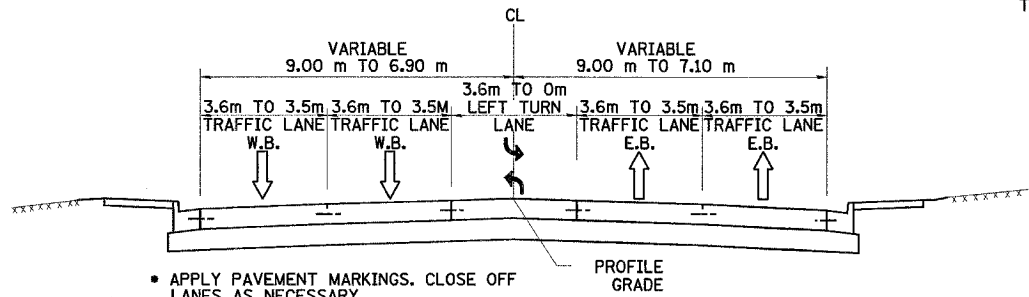

**AREA 1 - TYPICAL SECTION
STAGE 4**

RT STA 91+566.534 TO RT STA 91+658.000
LT STA 91+575.417 TO LT STA 91+658.000

LEGEND

↑ DIRECTION OF TRAFFIC FLOW

▨ PROPOSED CONSTRUCTION

REVISIONS	
NAME	DATE

ILLINOIS DEPARTMENT OF TRANSPORTATION

MAINTENANCE OF TRAFFIC PLANS

U.S. ROUTE 136

SCALE 1:500 DRAWN BY FML
DATE 5/03 CHECKED BY IYL