

F.A.P. RTE.	SECTION	COUNTY	TOTAL SHEETS	SHEET NO.
729	34Z-4	VERMILION	285	44
STA. 91+430		TO STA. 91+975		
FED. ROAD DIST. NO.		ILLINOIS FED. AID PROJECT		

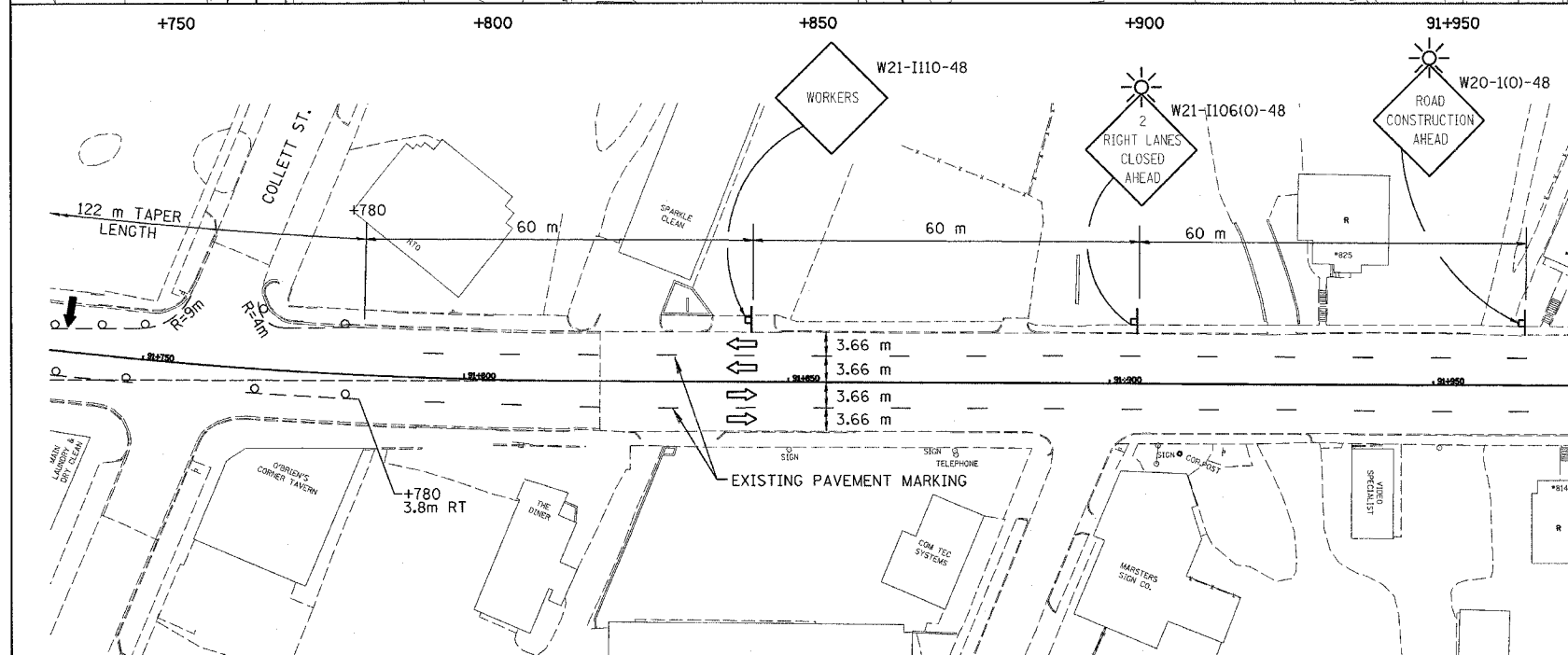
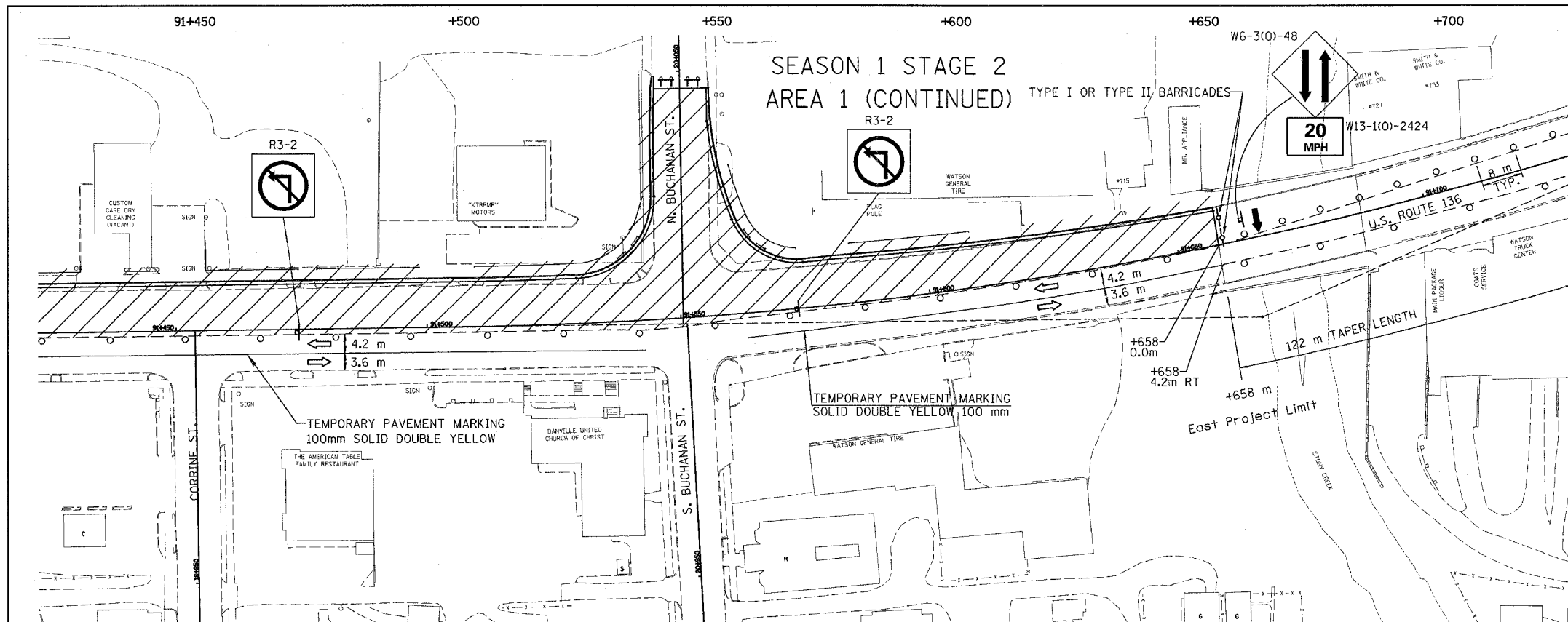

U.S. ROUTE 136

1. CLOSE PORTIONS OF U.S. ROUTE 136 AS SHOWN IN ACCORDANCE WITH STD. 701606.
2. DRUMS SHALL BE PLACED AT 15 m CENTERS.
3. REMOVE EXISTING PAVEMENT MARKINGS AS REQUIRED.
4. ALL SIDEROAD CLOSURES SHALL CONFORM TO DISTRICT 5 SPECIFICATIONS. ALL SIDEROADS ADJOINING TO PARTIALLY CLOSED U.S. ROUTE 136 SHALL CONFORM TO STD. 701606.
5. CONSTRUCTION ZONE SPEED LIMIT SHALL BE 20 MPH.
6. ALL LEFT TURNS ARE PROHIBITED THROUGHOUT THE WORK ZONE.
7. IF SEASONS 1 & 2 ARE TO BE PERFORMED CONCURRENTLY, N. VERMILION ST. & N. BUCHANAN ST. SHALL REMAIN OPEN AT THE SAME TIME.

SIDE ROAD CLOSURE PATTERNS

- | | |
|---------------------------|-------------------------|
| 1. MC DONALD ST. CLOSED | 1. MC DONALD ST. OPEN |
| 2. LAUHOFF ST. OPEN | 2. LAUHOFF ST. CLOSED |
| 3. N. BUCHANAN ST. CLOSED | 3. N. BUCHANAN ST. OPEN |

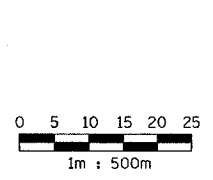

LEGEND	
	WORK AREA
	CONE OR BARRICADE WITH LIGHT
	ARROW BOARD
	DIRECTION OF TRAFFIC
	TYPE III BARRICADE WITH FLASHING LIGHT
	BARRICADE WITH FLASHING LIGHT
	SIGN ON PORTABLE SUPPORT

REVISIONS	
NAME	DATE

ILLINOIS DEPARTMENT OF TRANSPORTATION
MAINTENANCE OF TRAFFIC PLANS
U.S. ROUTE 136

SCALE 1:500 DRAWN BY FML
 DATE 5/03 CHECKED BY IYL