

F.A.P. RTE.	SECTION	COUNTY	TOTAL SHEETS	SHEET NO.
729	34Z-4	VERMILION	285	46
STA. 91+520		TO STA. 91+890		
FED. ROAD DIST. NO.		ILLINOIS FED. AID PROJECT		

SEASON 1 STAGE 3
AREA 1 (CONTINUED)

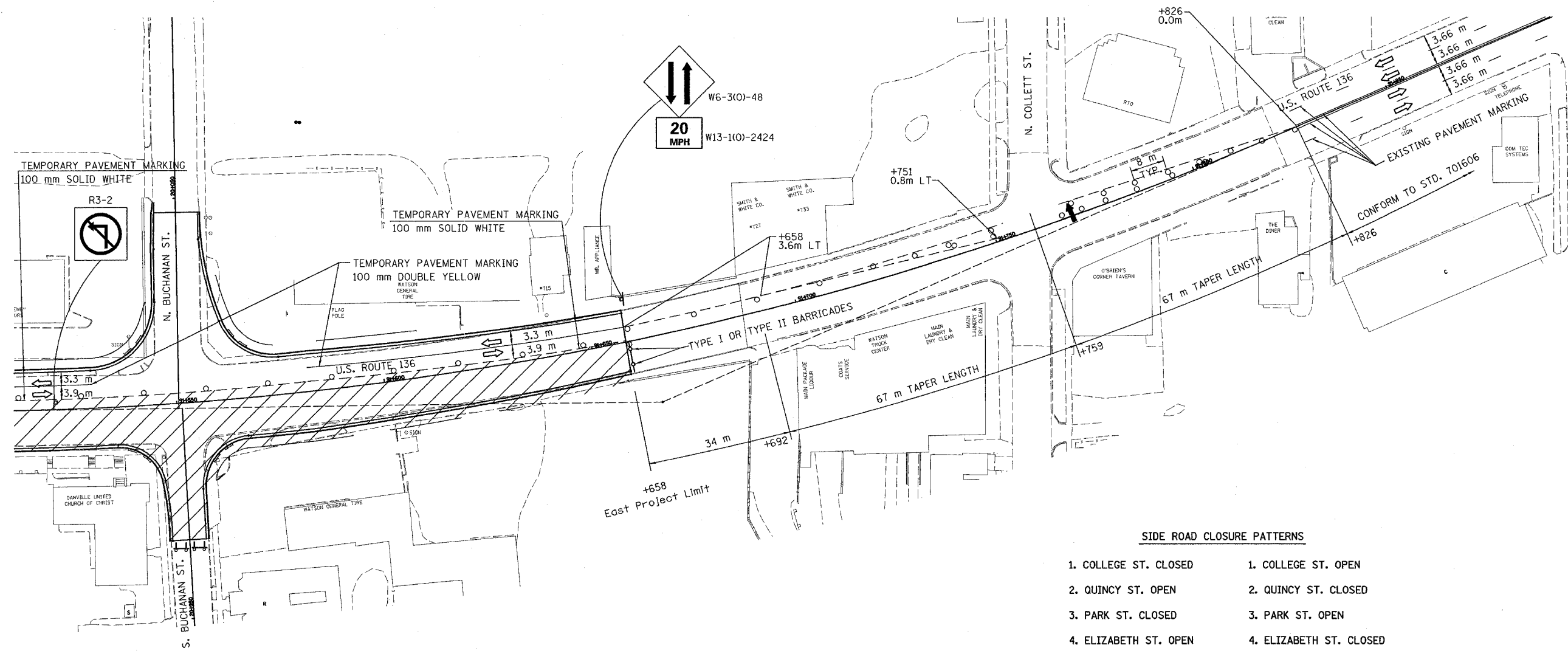

SIDE ROAD CLOSURE PATTERNS

- | | |
|-------------------------|---------------------------|
| 1. COLLEGE ST. CLOSED | 1. COLLEGE ST. OPEN |
| 2. QUINCY ST. OPEN | 2. QUINCY ST. CLOSED |
| 3. PARK ST. CLOSED | 3. PARK ST. OPEN |
| 4. ELIZABETH ST. OPEN | 4. ELIZABETH ST. CLOSED |
| 5. CORRINE ST. CLOSED | 5. CORRINE ST. OPEN |
| 6. S. BUCHANAN ST. OPEN | 6. S. BUCHANAN ST. CLOSED |

U.S. ROUTE 136

- CLOSE PORTIONS OF U.S. ROUTE 136 AS SHOWN IN ACCORDANCE WITH THE STD. 701606.
- DRUMS SHALL BE PLACED AT 15 m CENTERS.
- REMOVE EXISTING PAVEMENT MARKINGS AS REQUIRED.
- ALL SIDEROAD CLOSURES SHALL CONFORM TO DISTRICT 5 SPECIFICATIONS. ALL SIDEROADS ADJOINING TO PARTIALLY CLOSED U.S. ROUTE 136 SHALL CONFORM TO STD. 701606.
- CONSTRUCTION ZONE SPEED LIMIT SHALL BE 20 MPH.
- ALL LEFT TURNS ARE PROHIBITED THROUGHOUT THE WORK ZONE.
- IF SEASONS 1 & 2 ARE TO BE PERFORMED CONCURRENTLY, S. BUCHANAN ST. AND S. JACKSON ST. SHALL REMAIN OPEN AT THE SAME TIME.

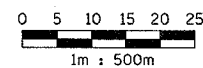

LEGEND

- WORK AREA
- CONE OR BARRICADE WITH LIGHT
- ARROW BOARD
- DIRECTION OF TRAFFIC
- TYPE III BARRICADE WITH FLASHING LIGHT
- BARRICADE WITH FLASHING LIGHT
- SIGN ON PORTABLE SUPPORT

REVISIONS	
NAME	DATE

ILLINOIS DEPARTMENT OF TRANSPORTATION
MAINTENANCE OF TRAFFIC PLANS
U.S. ROUTE 136

SCALE 1:500 DRAWN BY FML
 DATE 5/03 CHECKED BY IYL