

F.A.P. RTE.	SECTION	COUNTY	TOTAL SHEETS	SHEET NO.
729	34Z-4	VERMILION	285	52
STA. 90+120		TO STA. 90+780		
FED. ROAD DIST. NO.		ILLINOIS	FED. AID PROJECT	

SEASON 2 STAGE 3-A
AREA 2

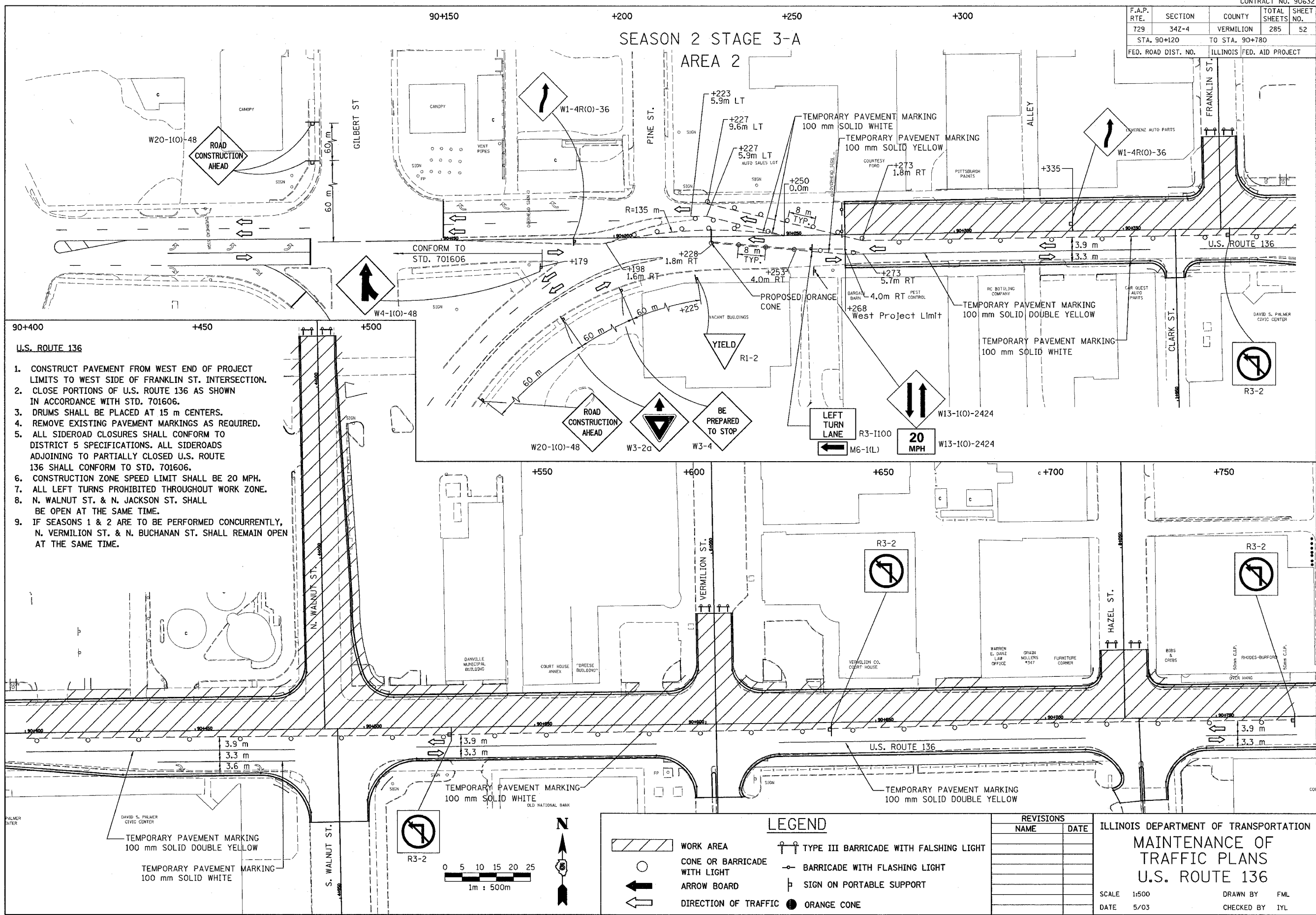

- U.S. ROUTE 136**
1. CONSTRUCT PAVEMENT FROM WEST END OF PROJECT LIMITS TO WEST SIDE OF FRANKLIN ST. INTERSECTION.
 2. CLOSE PORTIONS OF U.S. ROUTE 136 AS SHOWN IN ACCORDANCE WITH STD. 701606.
 3. DRUMS SHALL BE PLACED AT 15 m CENTERS.
 4. REMOVE EXISTING PAVEMENT MARKINGS AS REQUIRED.
 5. ALL SIDEROAD CLOSURES SHALL CONFORM TO DISTRICT 5 SPECIFICATIONS. ALL SIDEROADS ADJOINING TO PARTIALLY CLOSED U.S. ROUTE 136 SHALL CONFORM TO STD. 701606.
 6. CONSTRUCTION ZONE SPEED LIMIT SHALL BE 20 MPH.
 7. ALL LEFT TURNS PROHIBITED THROUGHOUT WORK ZONE.
 8. N. WALNUT ST. & N. JACKSON ST. SHALL BE OPEN AT THE SAME TIME.
 9. IF SEASONS 1 & 2 ARE TO BE PERFORMED CONCURRENTLY, N. VERMILION ST. & N. BUCHANAN ST. SHALL REMAIN OPEN AT THE SAME TIME.

LEGEND

	WORK AREA		TYPE III BARRICADE WITH FLASHING LIGHT
	CONE OR BARRICADE WITH LIGHT		BARRICADE WITH FLASHING LIGHT
	ARROW BOARD		SIGN ON PORTABLE SUPPORT
	DIRECTION OF TRAFFIC		ORANGE CONE

REVISIONS

NAME	DATE

ILLINOIS DEPARTMENT OF TRANSPORTATION
MAINTENANCE OF TRAFFIC PLANS
U.S. ROUTE 136

SCALE 1:500
 DATE 5/03
 DRAWN BY FML
 CHECKED BY IYL