

F.A.P. RTE.	SECTION	COUNTY	TOTAL SHEETS	SHEET NO.
729	342-4	VERMILION	285	53
STA. 90+120		TO STA. 90+780		
FED. ROAD DIST. NO.		ILLINOIS FED. AID PROJECT		

SEASON 2 STAGE 3-B
AREA 2

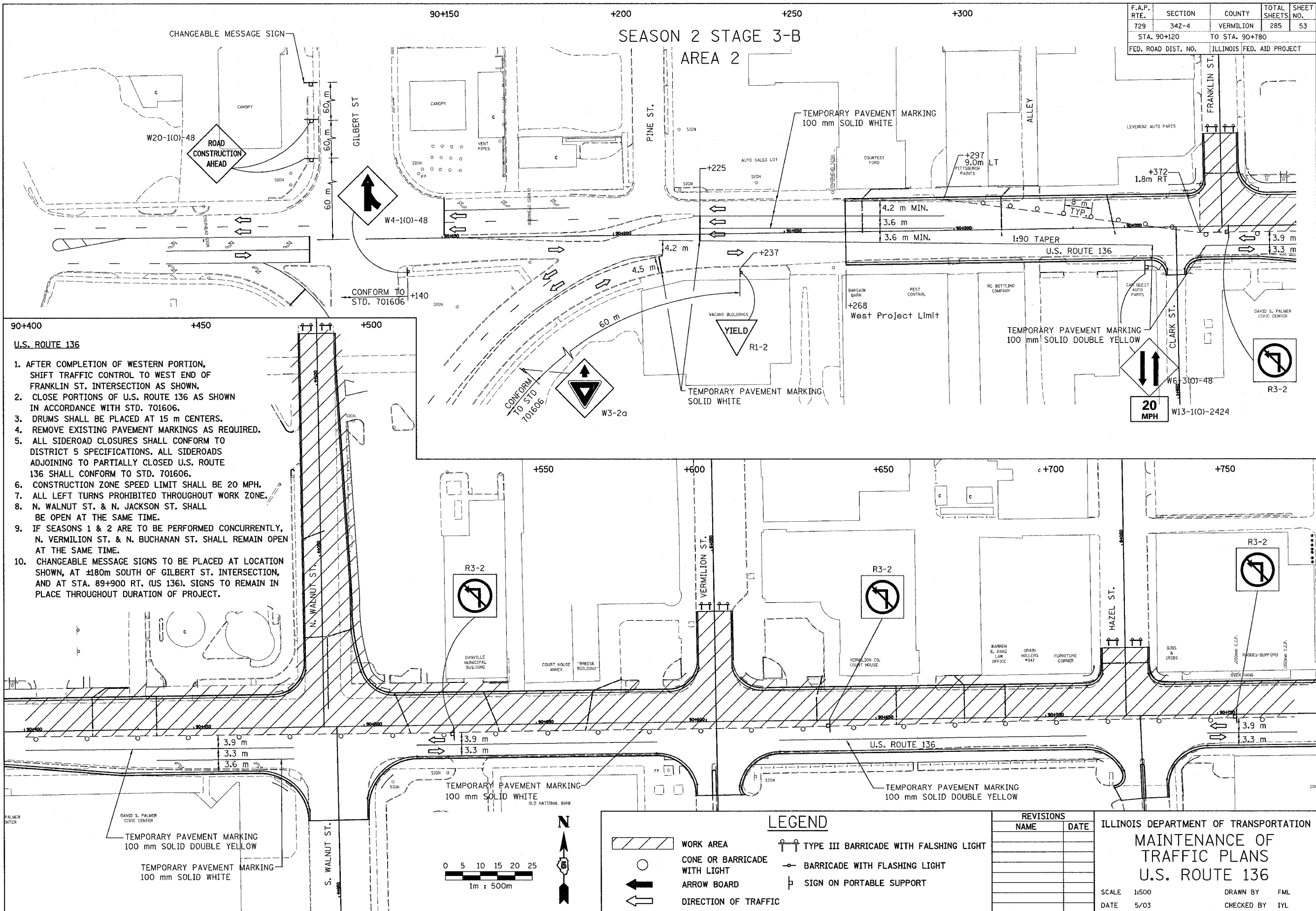

- 90+400 +450 +500
- U.S. ROUTE 136**
1. AFTER COMPLETION OF WESTERN PORTION, SHIFT TRAFFIC CONTROL TO WEST END OF FRANKLIN ST. INTERSECTION AS SHOWN.
 2. CLOSE PORTIONS OF U.S. ROUTE 136 AS SHOWN IN ACCORDANCE WITH STD. 701606.
 3. DRUMS SHALL BE PLACED AT 15 m CENTERS.
 4. REMOVE EXISTING PAVEMENT MARKINGS AS REQUIRED.
 5. ALL SIDEROAD CLOSURES SHALL CONFORM TO DISTRICT 5 SPECIFICATIONS. ALL SIDEROADS ADJOINING TO PARTIALLY CLOSED U.S. ROUTE 136 SHALL CONFORM TO STD. 701606.
 6. CONSTRUCTION ZONE SPEED LIMIT SHALL BE 20 MPH.
 7. ALL LEFT TURNS PROHIBITED THROUGHOUT WORK ZONE.
 8. N. WALNUT ST. & N. JACKSON ST. SHALL BE OPEN AT THE SAME TIME.
 9. IF SEASONS 1 & 2 ARE TO BE PERFORMED CONCURRENTLY, N. VERMILION ST. & N. BUCHANAN ST. SHALL REMAIN OPEN AT THE SAME TIME.
 10. CHANGEABLE MESSAGE SIGNS TO BE PLACED AT LOCATION SHOWN, AT ±180m SOUTH OF GILBERT ST. INTERSECTION, AND AT STA. 89+900 RT. (US 136). SIGNS TO REMAIN IN PLACE THROUGHOUT DURATION OF PROJECT.

LEGEND

	WORK AREA		TYPE III BARRICADE WITH FLASHING LIGHT
	CONE OR BARRICADE WITH LIGHT		BARRICADE WITH FLASHING LIGHT
	ARROW BOARD		SIGN ON PORTABLE SUPPORT
	DIRECTION OF TRAFFIC		

REVISIONS

NAME	DATE

ILLINOIS DEPARTMENT OF TRANSPORTATION
MAINTENANCE OF TRAFFIC PLANS
U.S. ROUTE 136

SCALE 1:500 DRAWN BY FML
DATE 5/03 CHECKED BY IYL