

F.A.P. RTE.	SECTION	COUNTY	TOTAL SHEETS	SHEET NO.
729	34Z-4	VERMILION	285	124
STA. 90+408.09		TO STA. 90+448.00		
FED. ROAD DIST. NO.		ILLINOIS FED. AID PROJECT		

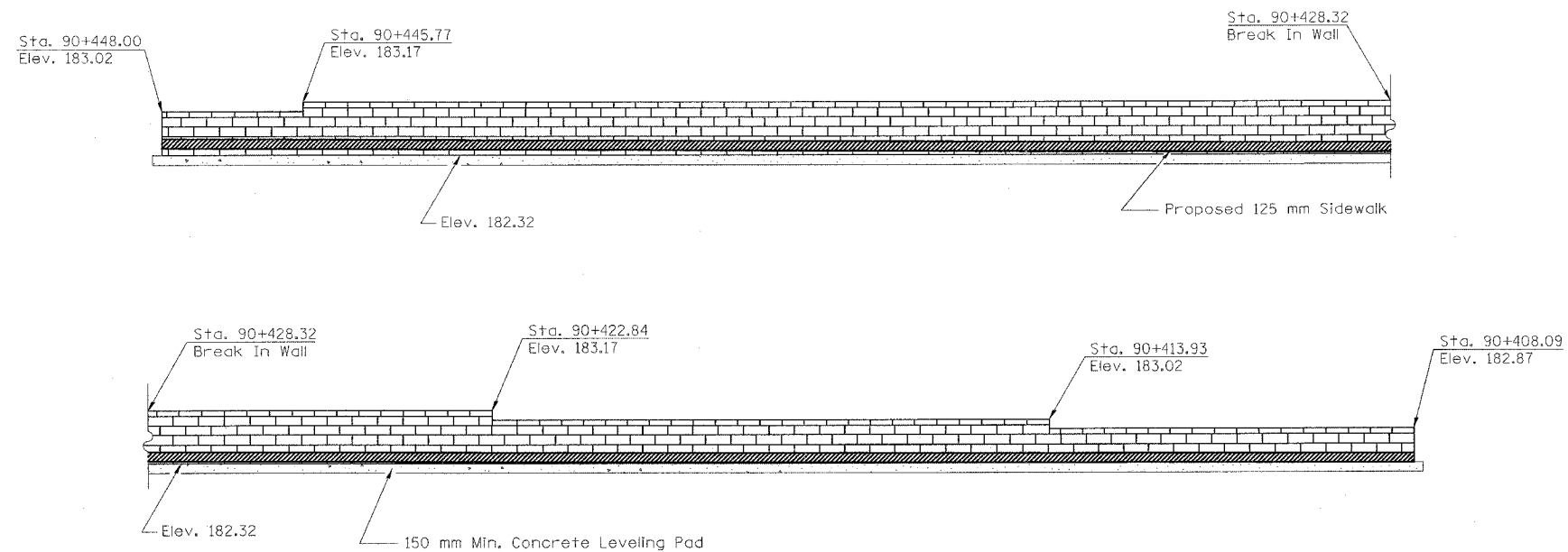
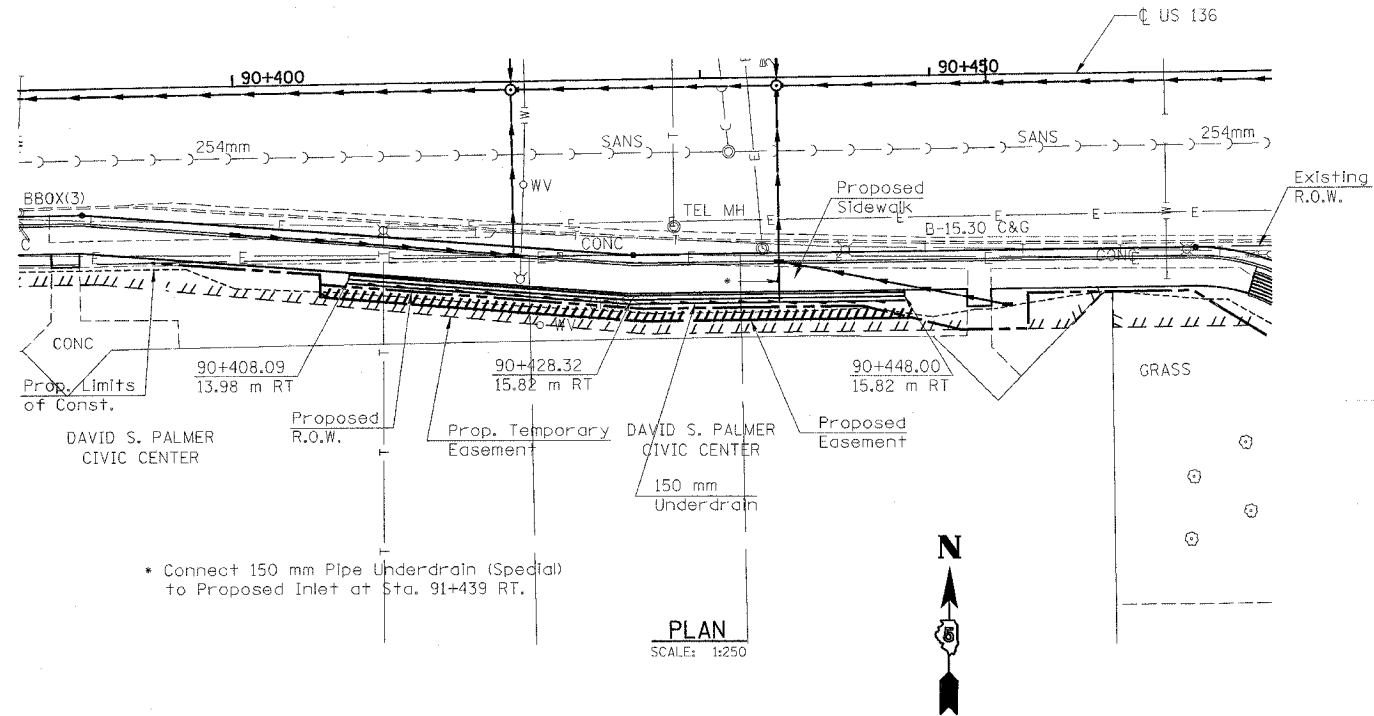

NOTES

- Offsets Refer to the Distance from \downarrow Roadway to the Back Face of the Lowest Block of the Retaining Wall at the Given Station.
- Refer to Sheet for Typical Cross-Section of the Block Retaining Wall.

REVISIONS	
NAME	DATE

ILLINOIS DEPARTMENT OF TRANSPORTATION
BLOCK RETAINING WALL DETAILS
U.S. ROUTE 136

SCALE --- DRAWN BY MTH
 DATE 5/03 CHECKED BY KRG