

FOR INDEX OF SHEETS, SEE SHEET NO. 2

STATE OF ILLINOIS DEPARTMENT OF TRANSPORTATION DIVISION OF HIGHWAYS

PLANS FOR PROPOSED FEDERAL HIGHWAY PROJECT

**F.A.P. ROUTE 750 (IL RTE. 185)
SECTION (112,113)Y,WRS
PROJECT: FAF-0750(007)
WIDENING AND RESURFACING**

**FAYETTE COUNTY
C-97-070-01**

DESIGN DESIGNATION - RURAL MINOR ARTERIAL

F.A.P. RTE.	SECTION	COUNTY	TOTAL SHEETS	SHEET NO.
750	(112,113) Y, WRS	FAYETTE	178	1
STA.	TO STA.			
FED. ROAD DIST. NO. 7	ILLINOIS		FED. AID PROJECT	
CONTRACT NO. 94927				

D-97-049-01

STATION EQUATIONS

STA 158+90.22 BK = STA 159+04.08 AH
STA 244+30.07 BK = STA 247+61.08 AH
STA 300+61.14 BK = STA 304+12.23 AH
STA 342+93.47 BK = STA 344+40.40 AH
STA 372+40.19 BK = STA 372+45.78 AH
STA 401+14.24 BK = STA 401+27.51 AH
STA 432+14.33 BK = STA 432+96.82 AH

STRUCTURES

STATION	NUMBER
282+21.5	026-0065
412+77.5	026-0097

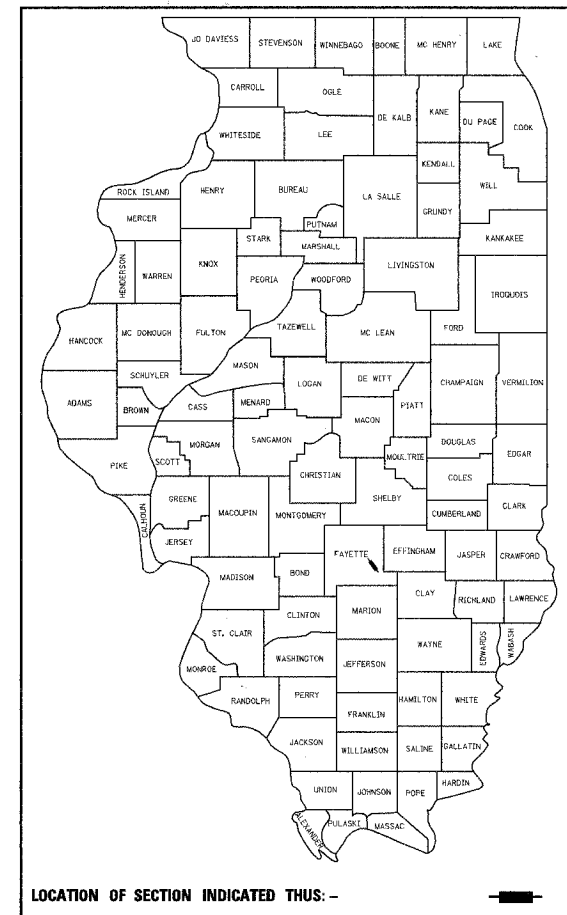

RONALD C. YEAGER
 LICENSED PROFESSIONAL ENGINEER
 License Expires 11/30/2005

AUGUST 5, 2005
DATE

STATE OF ILLINOIS
DEPARTMENT OF TRANSPORTATION
DIVISION OF HIGHWAYS

SUBMITTED Aug. 16, 2005

Christine M. Reed
CHRISTINE M. REED, P.E. DEPUTY DIRECTOR OF HIGHWAYS
 REGION FOUR ENGINEER

October 14, 2005
Mike Hise
ENGINEER OF DESIGN AND ENVIRONMENT

October 14, 2005
Eric E. Stamm
DEPUTY DIRECTOR, DIVISION OF HIGHWAYS

PREPARED BY: KUHLMANN DESIGN GROUP, BELLVILLE, ILLINOIS

**PRINTED BY THE AUTHORITY
OF THE STATE OF ILLINOIS**

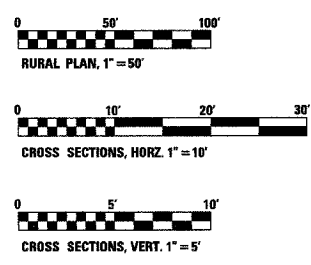

FULL SIZE PLANS HAVE BEEN PREPARED USING STANDARD ENGINEERING SCALES, REDUCED SIZED PLANS WILL NOT CONFORM TO STANDARD SCALES, IN MAKING MEASUREMENTS ON REDUCED PLANS, THE ABOVE SCALES MAY BE USED.

J.U.L.I.E.
JOINT UTILITY LOCATION INFORMATION FOR EXCAVATION
1-800-892-0123

CONTRACT NO. 94927

HOLD IT! CALL BEFORE YOU DIG!
Phone J.U.L.I.E.

The owner would like to remind you that underground utility facilities can be damaged by shovel blades or other digging equipment. You can prevent damage or possible personal danger by phoning 800/892-0123 at least 48 hours before you dig. That's the toll-free number for J.U.L.I.E., which stands for Joint Utility Location Information for Excavations.

If there are any pipes, cables, lines or mains in the excavation area, utility personnel will be out to mark the facilities so you can work around them.

Toll Free 800/892-0123

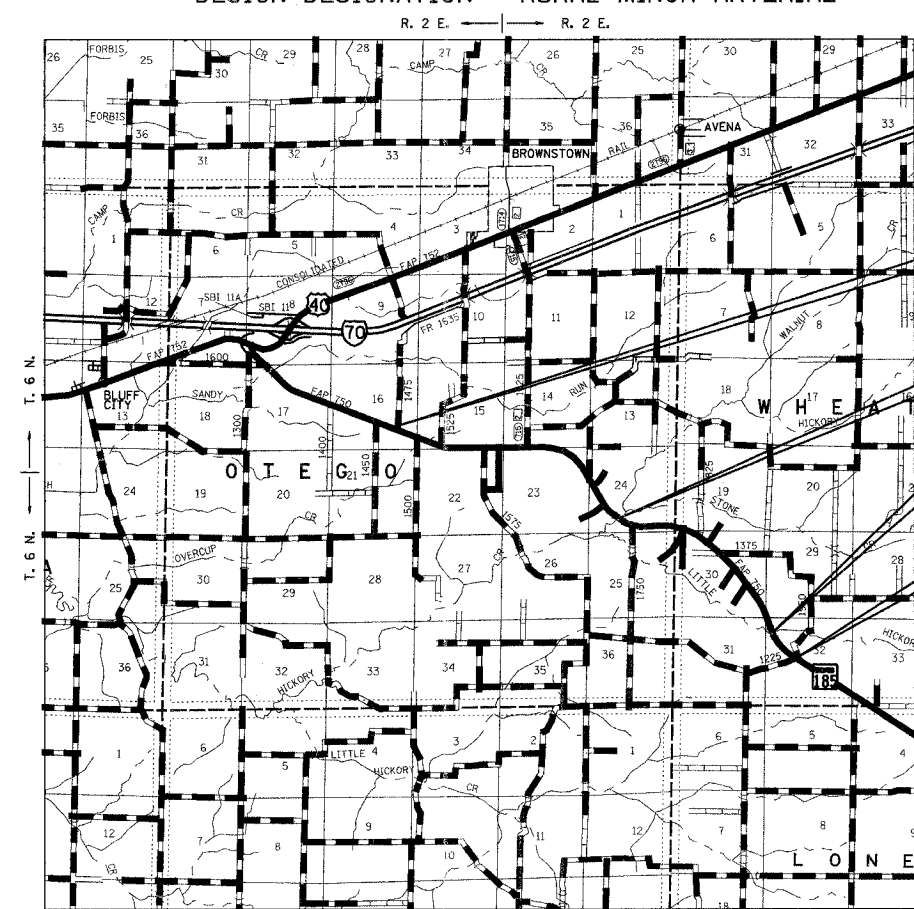

PROJECT BEGINS
STA. 120+00.00

BRIDGE OMISSION
BRIDGE 026-0065
STA. 281+49.53
TO 283+05.71

BRIDGE OMISSION
BRIDGE 026-0097
STA. 412+32.00
TO 413+38.95

PROJECT ENDS
STA. 436+00.00

LOCATION MAP
(NO SCALE)

GROSS PROJECT LENGTH = 31,600 FEET = 5.985 MILES
 NET PROJECT LENGTH = 30,921.18 FEET = 5.856 MILES
 ADT: CURRENT (2003) 1300