

F.A.P. R/E	SECTION	COUNTY	TOTAL SHEETS	SHEET NO.
750	(112,113) Y, WRS	FAYETTE	178	136
STA.		TO STA.		
FED. ROAD DIST. NO. 7		ILLINOIS FED. AID PROJECT		
<b>CONTRACT NO. 94927</b>				

FINAL SURVEY	SURVEYED	DATE
NOTE BOOK	PLOTTED	
	TEMPLATE	
	AREAS CHECKED	

ORIGINAL SURVEY	SURVEYED	DATE
NOTE BOOK	PLOTTED	
	TEMPLATE	
	AREAS CHECKED	

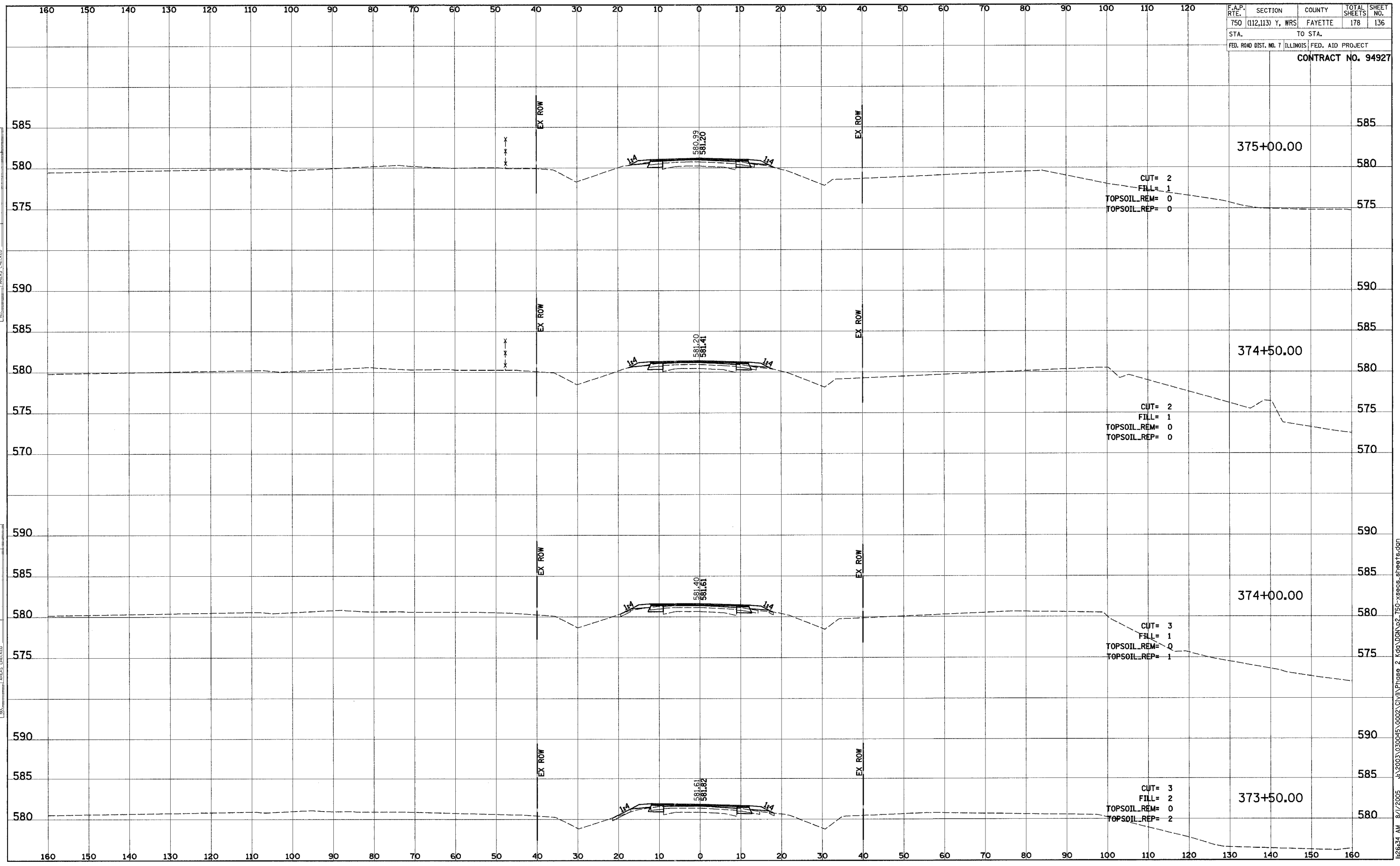

J:\2003\030045\0002\CIVIL\Phase 2\Kap\DRN\p2\_750-xsecs.sheets.dgn 8/1/2005 10:26:34 AM